

# sonisk Pulse Toothbrush

EN

Everyday oral freshness

Sonisk Pulse Toothbrushes cleans even hard to reach surfaces with its 31,000 sonic strokes per minute.

## Parts

- A. Vented-Cap
- B. Battery Cover/Base
- C. Brush Head
- D. Power Button
- E. Battery Compartment
- F. Battery

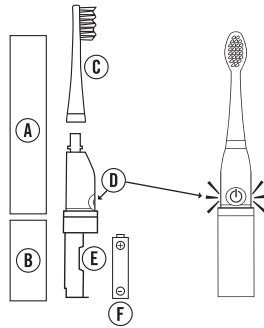

## How to Use

1. Push the power button firmly until vibration begins.
2. Brush teeth as recommended by your dental professional.
3. To turn Pulse Toothbrush off, press power button firmly until vibration stops.

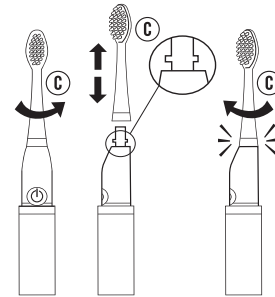
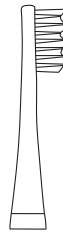

## Changing the Replaceable Brush Head

**Caution:** Do not pull the brush head straight off.

1. Hold the base of the toothbrush firmly in one hand, and with the other hand, turn brush head counter clockwise and pull up.
2. Align new brush head and turn clockwise until brush head clicks into place.

**Note:** Notches on neck should align with inner notches of toothbrush head to lock in place.

## Ordering Extra Brush Heads

Please check with your place of purchase or visit [www.sonisk.com](http://www.sonisk.com) for replacement brush heads.

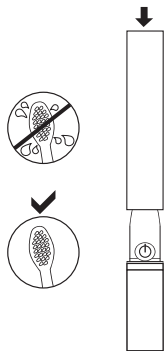

## Care Instructions

1. After each use, rinse the brush head thoroughly with water.
2. Shake excess water from bristles. Wipe the handle dry after each use. Dry your brush head before covering and storing.
3. Remove batteries if not used for an extended period of time.
4. To clean your Pulse Toothbrush, wipe surface with a damp cloth. Make sure the battery cover is closed securely to prevent water from getting into the battery compartment.

## Caution

- Do not immerse your Pulse Toothbrush in water.
- Keep out of reach of children and pets as this product may be dangerous for them.
- **Warning: Choking hazard** - this product contains small parts. Seek immediate medical attention if swallowed or inhaled.
- Do not use this product for other purposes.
- Do not expose this product to any chemical solvent, direct sunlight or high temperature.
- If an unexpected event happens when operating, please report it to [info@sonisk.com](mailto:info@sonisk.com).

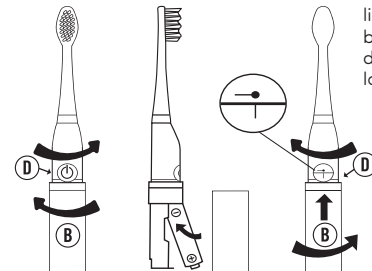

line on back of base aligns with dot on body to lock in place

## Replacing the Battery

Alkaline batteries are recommended.

1. Hold the battery cover with one hand and grip firmly around both sides of the power button section with your other hand.
2. Turn the battery cover clockwise and pull down, exposing the battery compartment.
3. Remove the old battery. Insert a new AAA battery.
4. Replace the battery cover and turn counter clockwise until it is securely in place.

**Note:** When battery is low, vibration will weaken and product may stop working. This is not a malfunction. You will need to replace your battery.

## Battery Disposal

Follow applicable laws and regulations for transport, shipping and disposal of batteries. Contact your local recycling service.

Dispose of at public collection point in the EU countries – 2002/96/EC WEEE Directive.

