

HP Tuners Setup Instructions

Thank You
for Buying



Before proceeding with these instructions
your ECU must be sent to HP Tuners and
unlocked. Once you have your ECU back and
reinstalled then follow these instructions.

HP Tuners Setup Instructions

Start by downloading the TDN app on your smartphone.
(Available for both IOS and Android)

Once the app has downloaded, open it and select "account" then follow the prompts to create your own account. (Note: If you are a dealer we recommend using your customer's email and a generic password so that your customer can access the tunes as needed. During the sign up process you will need to get a verification code from whatever email you use)

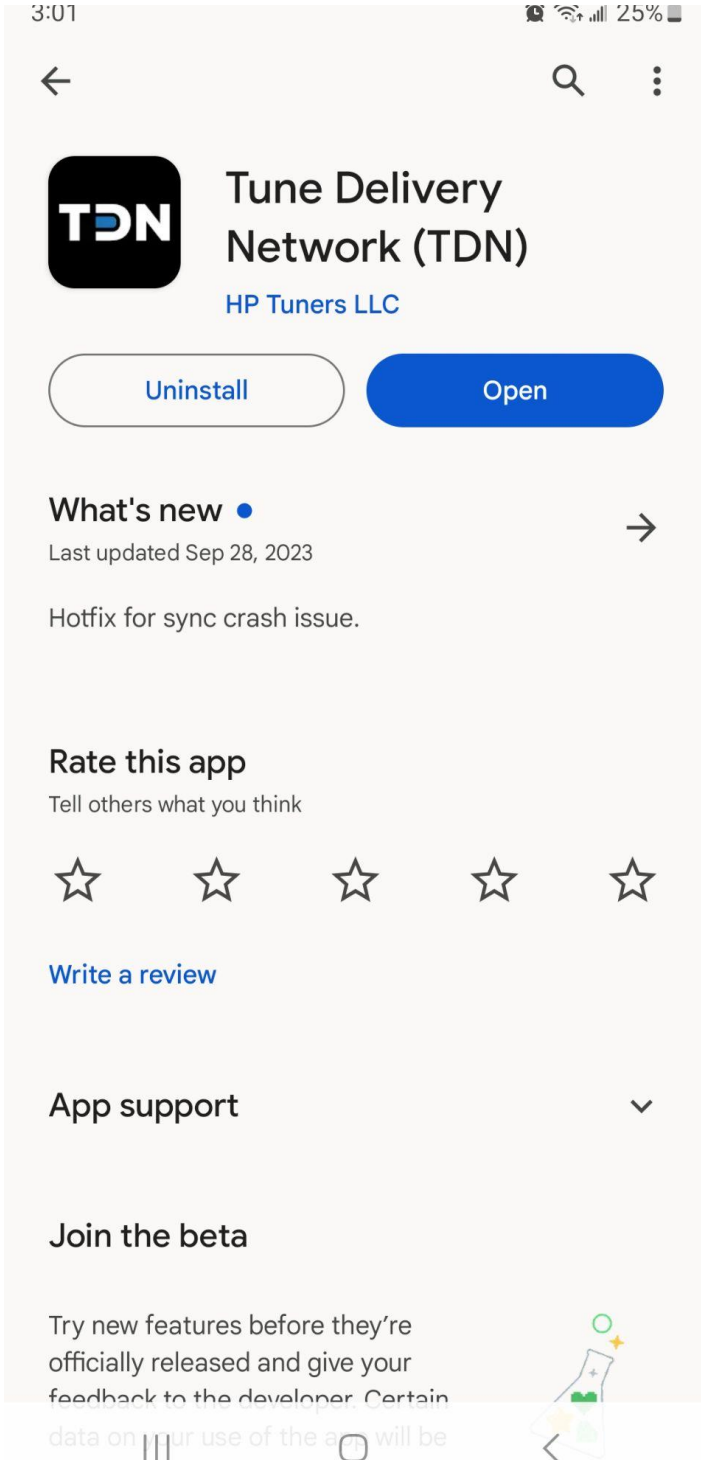

HP Tuners Setup Instructions

Once you have set up your account you will see this screen.
Enter the invite code shown and click join. After you are accepted it will show Boondocker under your linked tuners.

Once you have linked to Boondocker you will go back to the home screen and select "tools"

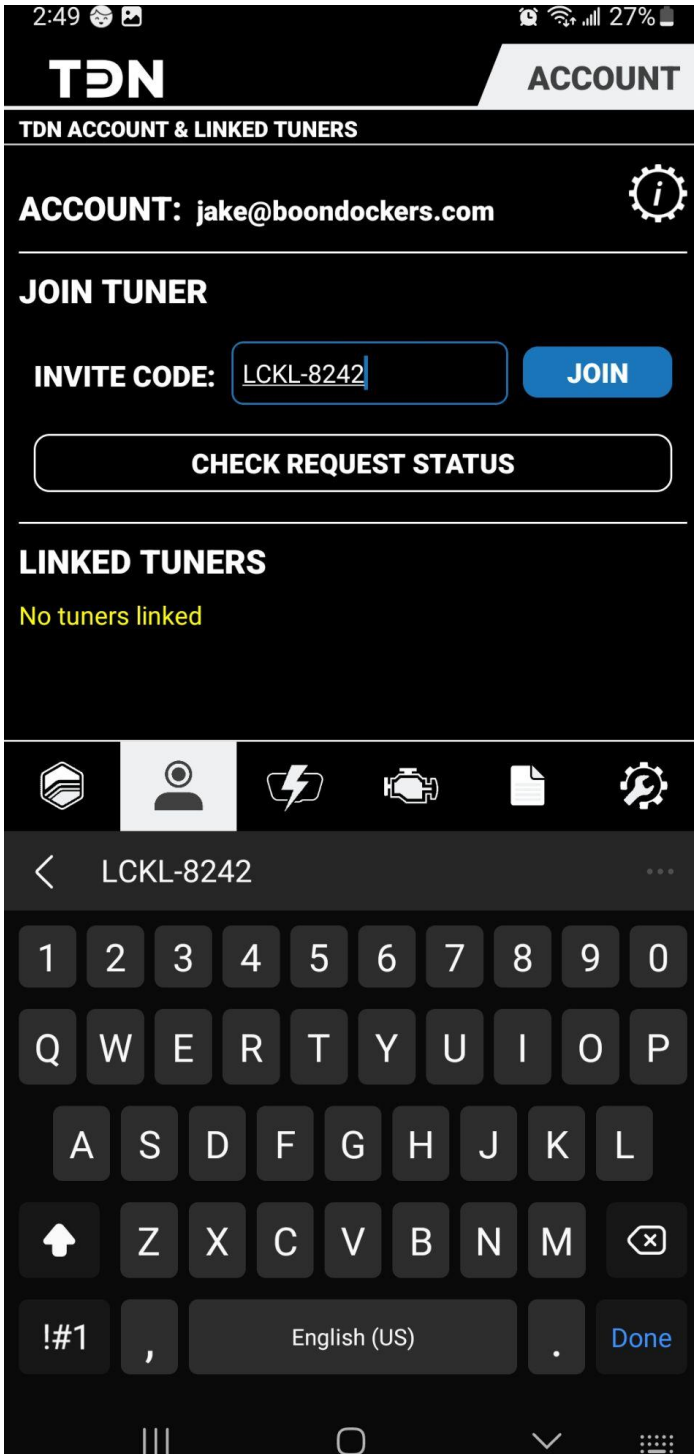

HP Tuners Setup Instructions

Select RTD First Time Setup

DO NOT SELECT UPDATE RTD FIRMWARE!

Follow the on screen prompts to link your RTD.

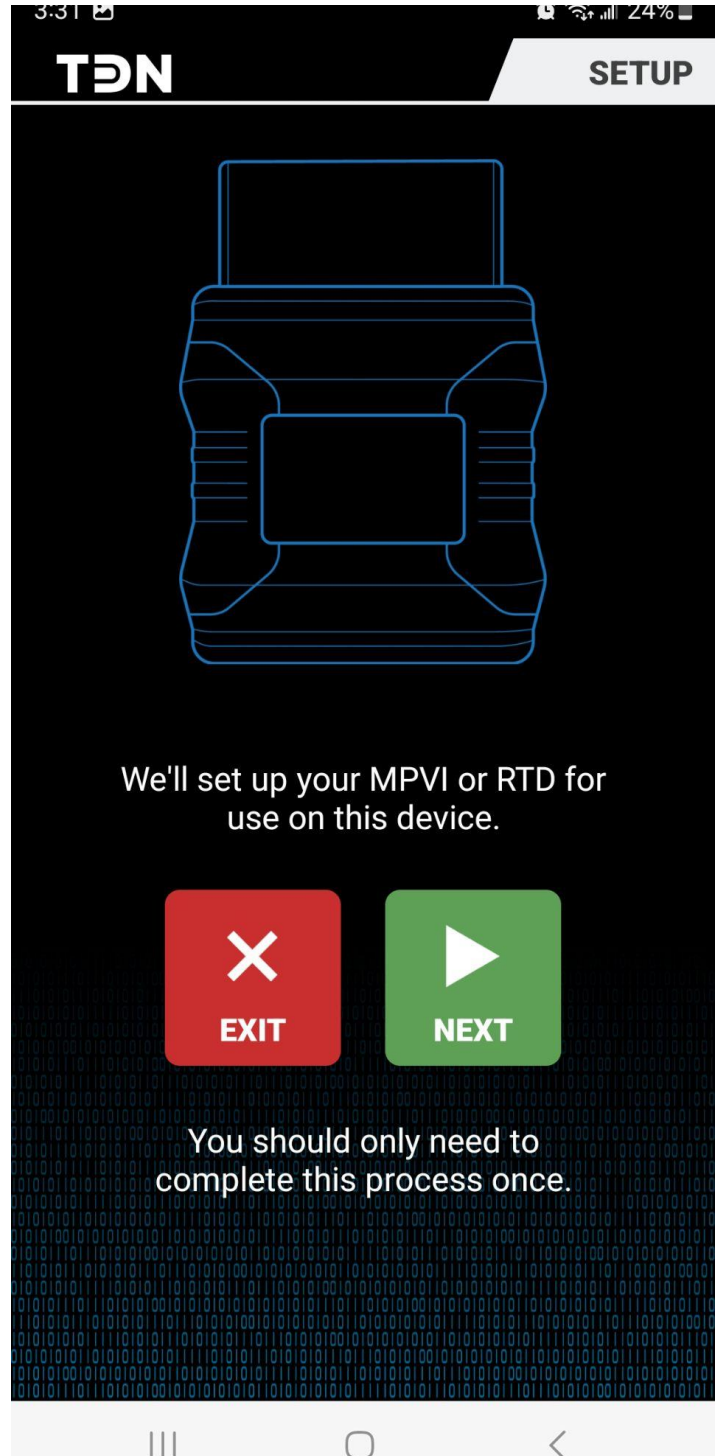
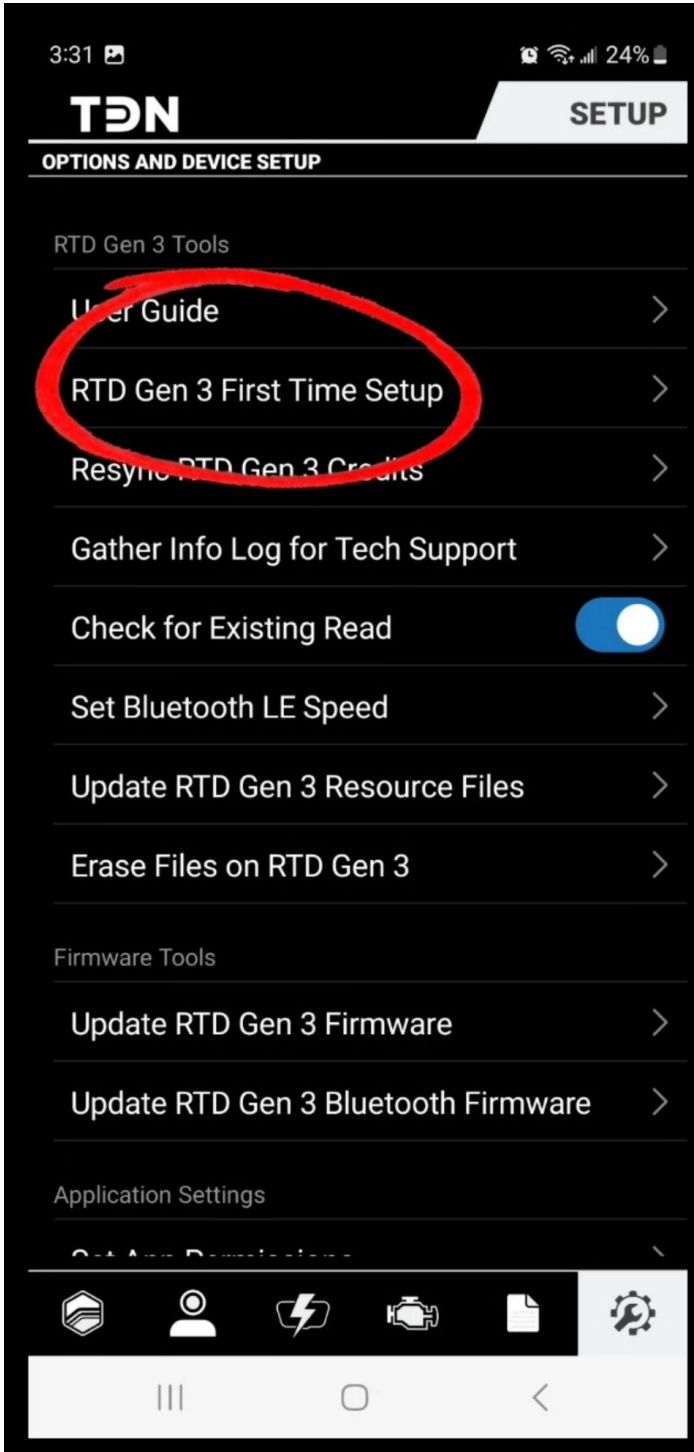

HP Tuners Setup Instructions

Next, go back to the home screen and select flash

Select Read Vehicle. This will read off the stock flash and automatically send it to Boondocker. This step may take up to 15 minutes

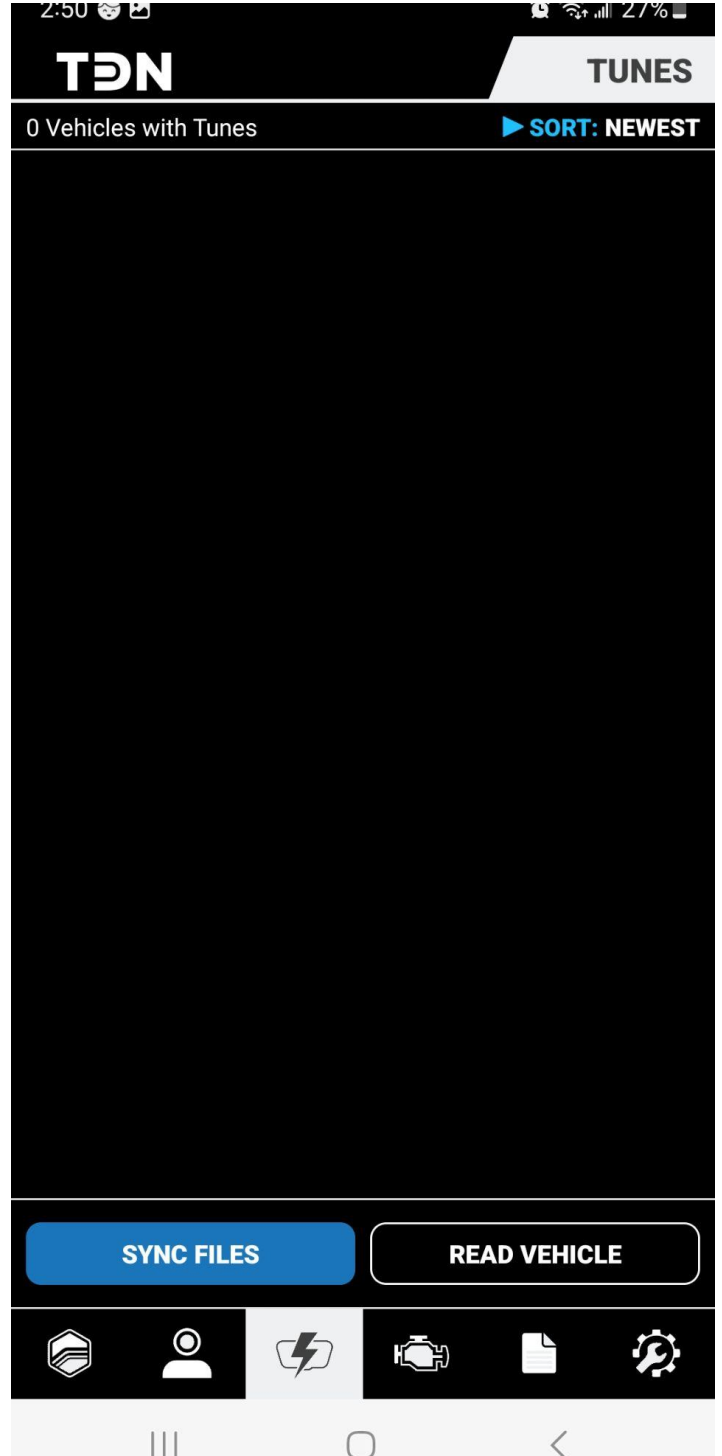

HP Tuners Setup Instructions

Call us and let us know you're ready for your tunes, we need to go over what octane you plan on running and are happy to answer any other questions you've had along the way.

Once Boondocker sends you your tune files you will go back into flash and click sync files.

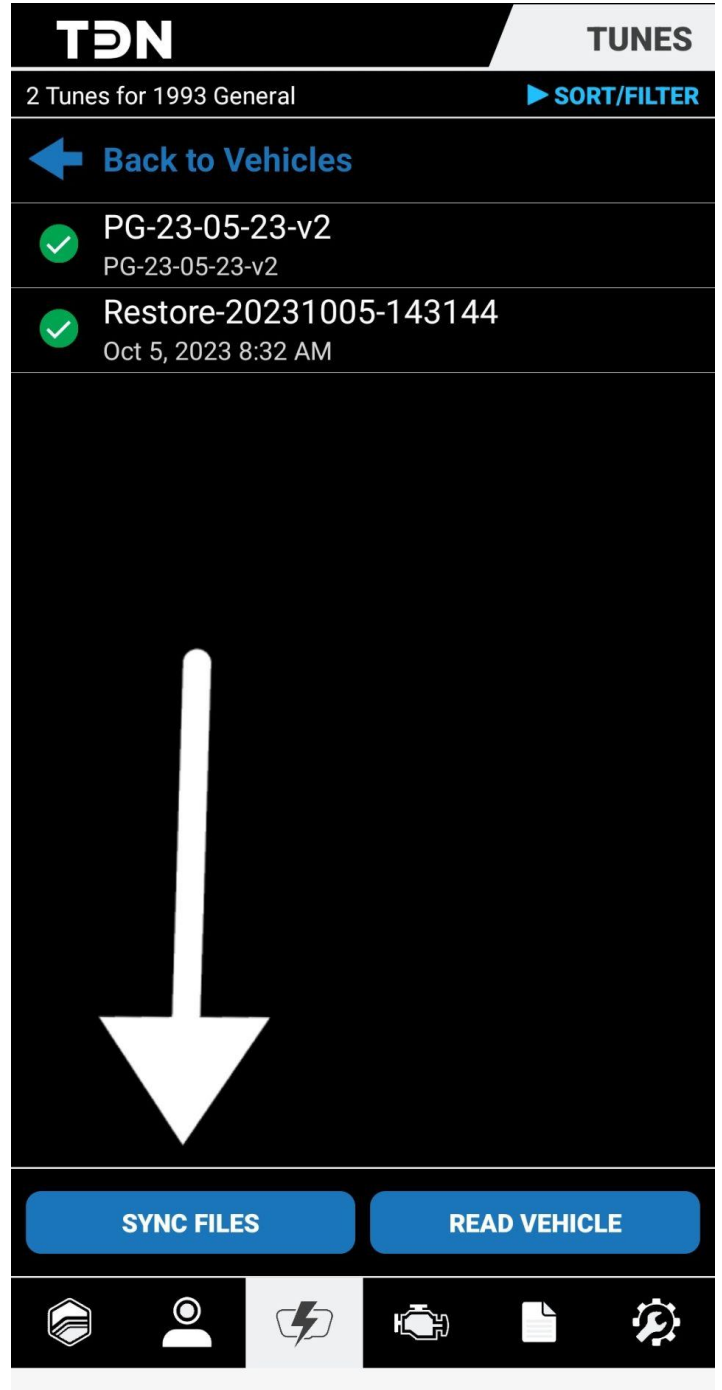

HP Tuners Setup Instructions

After you sync files your tune files will pop up as shown. You will also have a "restore" file to return to stock if ever necessary

Press and hold on your preferred tune file and select "full write" it is very important that you select full write the first time. Once the write is complete your vehicle is ready to run and you can unplug the RTD or mount it permanently if you so choose.

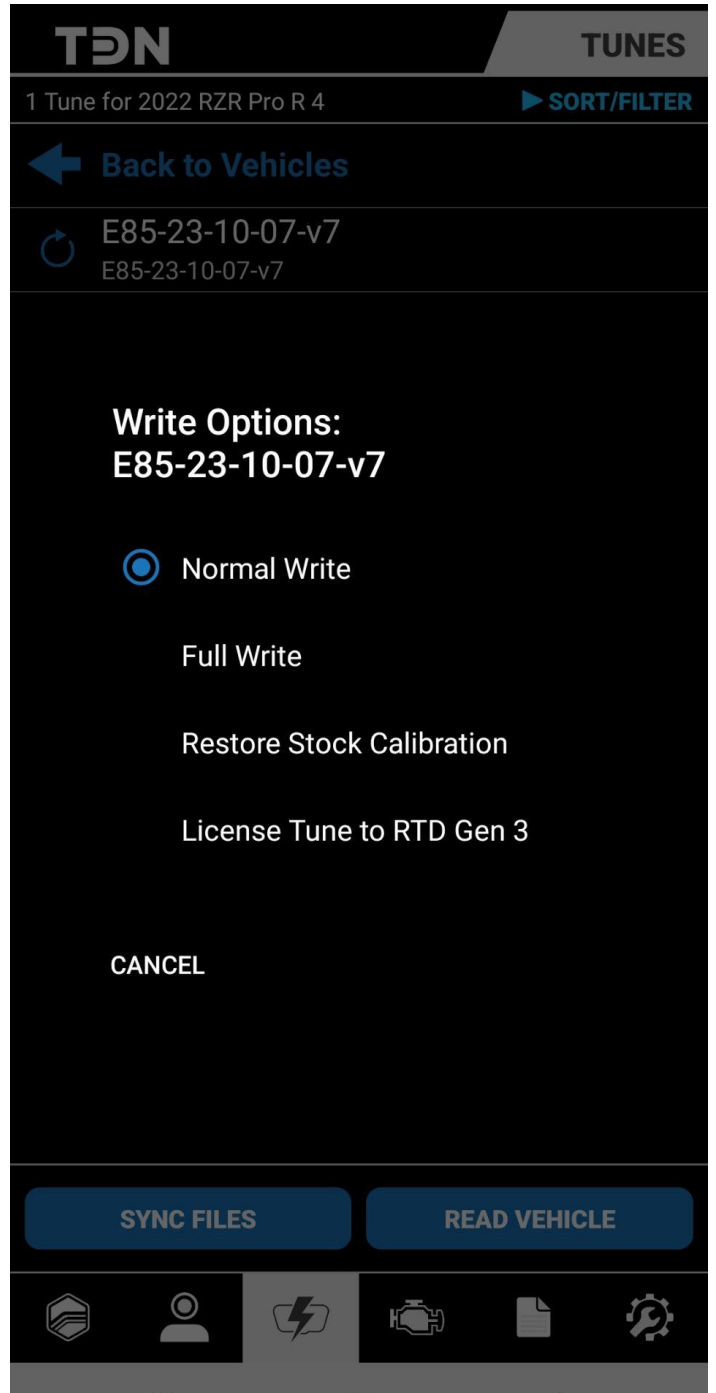

HP Tuners Setup Instructions

DO NOT UPDATE DEVICE FIRMWARE!

Performing this installation is at your own risk. These instructions act as a general guideline, and may not include some steps.

As the installer, YOU take responsibility for the entirety of the installation.

YOU must ensure proper routing, fitment, shielding, etc. to prevent melted parts, chaffed wires, poor performance, etc.

Improper installation, of any type, is not covered as a defect under any warranty, implied or written.