

ELECTRIC
**QUAD PRO
MAXI CHOPPER**

CLEARLINE[®]
APPLIANCES

Life made smart!



INSTRUCTION MANUAL

IMPORTANT: Please read these instructions fully before using the appliance.
Kindly retain these instructions for future reference.

KNOW YOUR HEATER

S.N.	PART	FUNCTION
1	Push Button	Main switch for operating the chopper
2	Motor Housing	Houses the motor
3	LID	Covers the bowl (stainless steel 304 food grade)
4	Main Blade	It is placed on the bowl shaft
5	Auxiliary Blade	Install above the main blade for chopping Vegetables and mincing meat more efficiently
6	Bowl	Stainless steel food grade 304 bowl
7	Non Slip-Mat	Place the bowl on the mat to reduce the Noise/vibration and prevent it from slipping

INSTRUCTIONS TO USE

1. Please clean the appliance before use with a soft and damp cloth.
2. Make sure the voltage of the socket complies to that of the product.
3. Follow the following steps to use the chopper -

- Place the bowl on the non-slip mat
- Install the blades properly
- Put vegetables/meat in the bowl and place the lid.
- Place the top properly. The metal coupler on the motor unit should sit on the blade coupler properly.

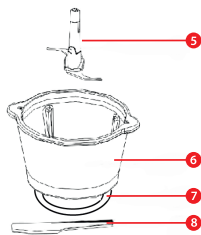
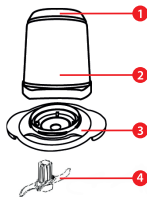

- Keep the switch pressed to operate
- Most of the Chopping and Mincing operation will be done with in a matter of few seconds.
- Do not use the chopper for more than 30 seconds at a time to avoid damage to the motor.
- Wait for the motor to cool down incase it becomes hot. Intentional damage caused to the motor by over-use/mis-use is not covered under warranty.

IMPORTANT SAFEGUARDS

- Kindly make sure the voltage of the socket complies to that of the product.
- Disconnect the power supply before and after using the appliance.
- Please check the power wire, plug and other components before starting the machine.
- If there is any damage to the product, please do not use the appliance and contact us on our customer care for further clarification and help.
- The food volumes should correspond to the guide in the manual.
- Do not use the appliance with an empty bowl.
- Please do not put the appliance/container in the microwave.
- This machine is not suitable for grinding solid foods.
- If the machine stops while you are using it, allow it to cool down as the temperature of the motor has exceeded normal limits. Give the chopper 10 to 15 minutes to cool down.
- The motor housing is not water-proof. Kindly do not immerse in water or any other liquid.

HOW TO CLEAN

- After using the product, please clean the bowl, blades and lid.
- The blades of the machine are very sharp. Do not touch them directly to avoid injury.
- Motor housing cannot be soaked to clean, kindly wipe it with the wet cloth to clean it.
- Dry the parts and store carefully.

TROUBLESHOOTING

FAULT	REASON	TROUBLESHOOTING
The machine does not switch on after connecting to power	The metal coupling of the motor unit and blade are not properly set	Set both the couplings in place and try again
There is an odour/smell when i switch on my chopper for the first time	It is normal for all appliances to release a bad smell/odour for the first time when they are first switched on	The smell will not re-occur after first use.
The chopper stops while in operation	The voltage is too low The motor has heated due to excessive load and excess use	Check the voltage. Stop using the chopper for 10 - 20 minutes and allow it to cool down
Abnormal Vibrations and Sounds	The blades have not been installed properly The surface area is not stable Excessive load on the chopper	Install the blades properly Place on a stable flat surface. Do not exceed the maximum capacity of the chopper
Blade rotating too slow	The food to be chopped is not sliced properly The chopper is exceeding maximum capacity	Slice the food to be chopped into pieces before chopping. Reduce the ingredients in the chopper and try again

GUIDE TO QUANTITY OF CHOPPING

Food Type	Quantity	Food Type	Quantity
Vegetable	4/5 of the bowl	Dried Chillies & Pepper	1/2 of the bowl
Melon & Fruit	1/2 of the bowl	Boneless Meat (TO MINCE)	1/3 of the bowl

CLEARLINE CUSTOMER SERVICE

This product carries a warranty of 12 months from the date of purchase against defects caused by faulty workmanship and materials. The warranty excludes defects caused by the product not being used in accordance with instructions, mis-use, accidental damage and tampering with by un-authorized persons. In the event of any defect arising during warranty period, the same should be taken to your nearest dealer or wholesaler. It will then be taken care of as per the discretion of the company's representative. The warranty does not cover damage/defects caused by the events beyond control like acts of god, lightning, abnormal power supply, voltage fluctuations.

WARRANTY CARD

Serial No. _____

Bill No. _____

Model No. _____

Maxi Chopper

Customer's Name : _____

Address : _____

Dealer's Name & Stamp

Date of Purchase : _____

Marketed By:

CLEARLINE APPLIANCES LIMITED

177G, Industrial Area, Phase-I, Chandigarh - 160002

Incase of any complaints

please contact: +91 172 4647707, 4626036, 4626027

Whatsapp us at : 98882 27707

or email us at customercare@clearline.co.in or

write to us at the above mentioned address

www.clearline.co.in

CLEARLINE[®]
APPLIANCES

Life made smart!