



DUKERS
Quality Commercial Refrigeration

Dukers

2 YEARS PARTS & LABOR
**PREMIUM
WARRANTY**

5 YEAR COMPRESSOR

BACK BAR COOLER

MODEL DBB48-S2

Sliding Glass Door



TECHNICAL SPECIFICATIONS

Voltage/Frequency	115V/60Hz
Refrigerant	R290
Type of Defrost	Automatic
Interior Material	Stainless Steel
Exterior Material	Black Textured Finish
Temperature Range °F	33 ~ 38°F
Compressor Power (HP)	1/3
Nema Config.	NEMA5-15P



PRODUCT FEATURES



The side mount compressor structure is placed in an easy access area, provides quick and convenient access.



R290 Natural Refrigerant promotes faster cool down and efficient energy consumption.



Precision digital temperature controls allow pinpoint accuracy with temperatures from 33-38°F.



Stainless steel top, sealed interior floors, and rounded cabinet corners for easy cleaning.



Adjustable, heavy-duty epoxy coated shelves.



Constructed of commercial-grade body panels in black textured finish to fit all decors and living spaces.



Featured in a large size and double pane tempered glass block UV light to safely keep all types of drinks ready to serve.



LED interior lighting for bright product display.



Optional casters with breaks available upon request for better cleaning and mobility.



HEAVY-DUTY CABINET FRAME & ROBUST DESIGN



DUKERS

Los Angeles | San Francisco | Dallas
Houston | Florida | Chicago | New Jersey

1-800-931-8628

@ info@dukersusa.com

www.DukersUSA.com

DETAILS & SPECIFICATIONS

BACK BAR COOLER

Front View

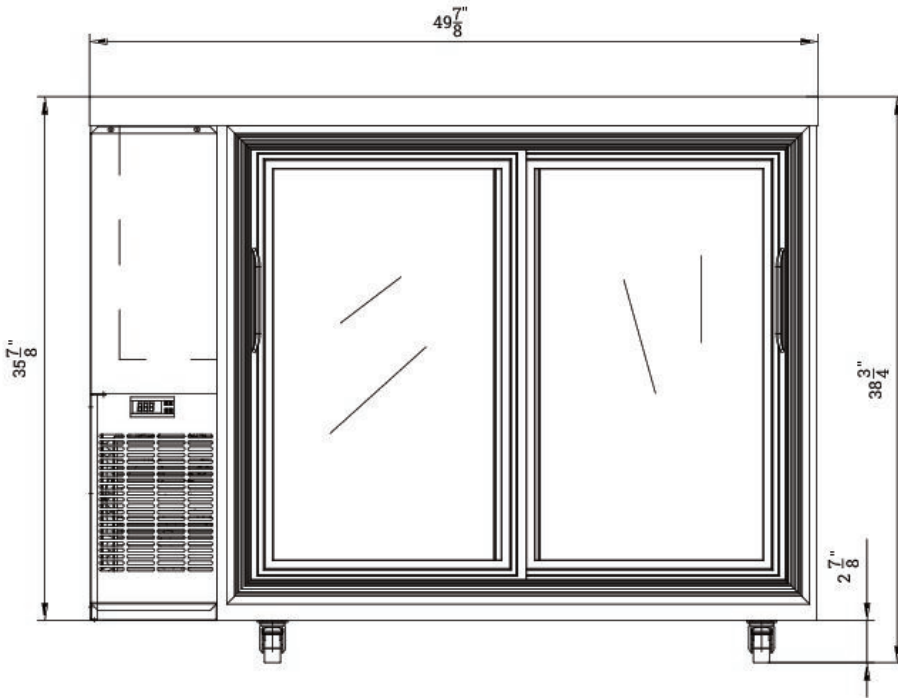

Side View

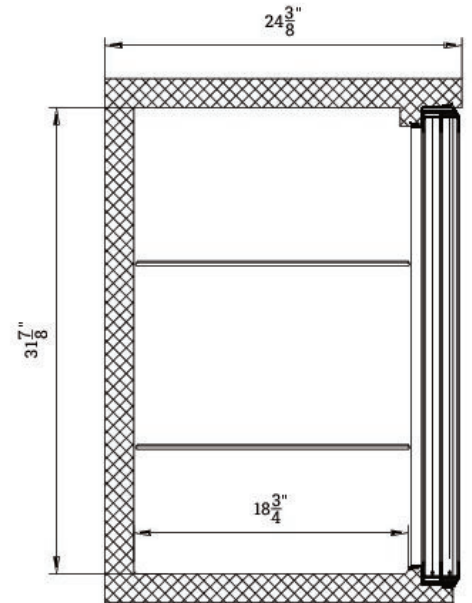

MODEL DBB48-S2

Rated Voltage	115V
Rated Frequency	60Hz
Total Input Power	284W
Total Current	2.66A
Total Capacity	11.23 cu ft
Climatic Category	4-5
Protection Type	I
Design Pressure High Side	385 PSIG
Design Pressure Low Side	150 PSIG
Insulation Blowing Gas	C-Pentane
Refrigerant	R290/3.17 oz



115/60/1
NEMA-6-15P



Intertek



Intertek



MODEL	EXTERNAL DIMENSION WXDXH (INCHES)	PACKAGING DIMENSION WXDXH (INCHES)	PRODUCT NET WEIGHT	# OF SHELVES	40FT (PCS)
DBB48-S2	49 7/8"x24 3/8"x38 3/4"	51 5/8"x26 3/8"x43 1/4"	198 lbs	4	54



Los Angeles | San Francisco | Dallas
Houston | Florida | Chicago | New Jersey

1-800-931-8628

info@dukersusa.com

www.DukersUSA.com