

MELSTONE SERIES

ELECTRIC PIZZA OVEN



MS45E-2

MS59E-2



FEATURES

- The Pegasus Ovens are reliable and versatile solutions designed for professional baking applications.
- Each oven chamber features refractory baking deck with an 8" deck height.
- Choose from two different deck areas and overall oven widths (45" and 59") to suit your needs.
- The series is constructed with heavy duty angle iron frame, which is fully welded to allow for double-stacking.
- Oven exteriors are all heavy duty stainless steel and are fully insulated for cooler outer temperatures and consistent interior temperatures.
- Electric-operated oven with thermostatic temperature control.
- 15 or 20 kW Electric Power.
- Up to: 752 °F temperature range.
- 28" x 28" interior baking compartment.
- Refractory baking bedplate.
- 8" (203 mm) deck height.
- All stainless steel interior and exteriors.
- Spring balanced, lift up oven door with tempered door.
- Rear electrical connection.
- Fully insulated throughout.
- One year limited warranty (USA & Canada only).

ELECTRIC PIZZA OVEN

TOP VIEW

FRONT VIEW

SIDE VIEW

MS45E-2

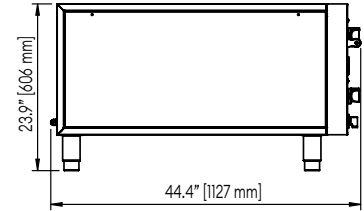
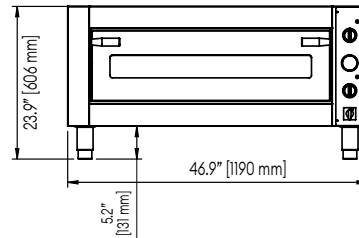
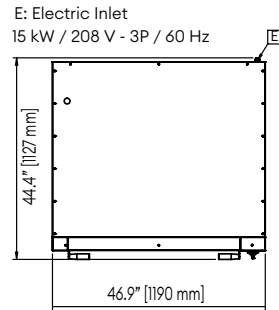

MS59E-2

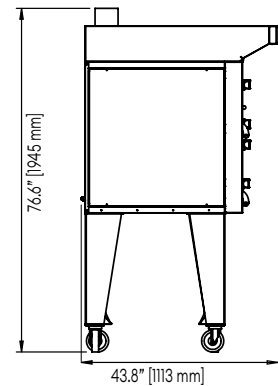
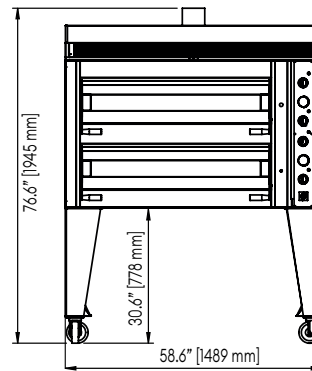
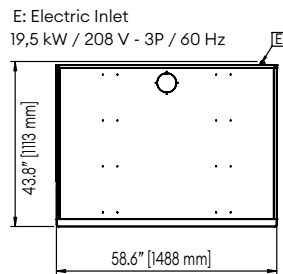

TECHNICAL SPECIFICATIONS:

	MS45E-2	MS59E-2
Power	15,000 W	19,500 W
Voltage	208 V	208 V
Phase	3P (field convertible to 1P)	3P (field convertible to 1P)
Nominal Amps (208V - 3P)	41.7A	54.2A
Nominal Amps (208V - 1P)	72.1A	93.8A
Deck Height	8"	8"
Deck Size	27.8" x 27.6" x 8.0" (705 x 700 x 203 mm)	27.8" x 27.6" x 8.0" (705 x 700 x 203 mm)
Decks	1	2
Thermostat	Up to 752 F	Up to 752 F
Dimensions (W x H x D)	44.8" x 45.6" x 43.0" (1137 x 1158 x 1091 mm)	58.5" x 45.6" x 43.0" (1486 x 1158 x 1091 mm)
Shipping Dim. (W x H x D)	46.1" x 52.5" x 38.7" (1176 x 1334 x 983 mm)	60.5" x 78.5" x 45.0" (1536 x 1994 x 1141 mm)
Ship Wt.	529 lb (240 kg)	683 lb (310 kg)

REQUIRED CLEARANCES:

	Non-Combustible	Combustible
Left	0" (00 mm)	1" (25 mm)
Right	0" (00 mm)	3" (76 mm)
Back	2" (51 mm)	3" (76 mm)



Galaxy Group reserves the right to modify specifications or discontinue models without incurring obligation. Dimensions are nominal.