



USER MANUAL

SDG TELLIS DROPPER POST

Congratulations on the purchase of your new SDG Tellis dropper seat post! The Tellis dropper post is designed to offer quick seat height adjustments while on the fly. Please be sure to carefully read the following instruction manual, as failure to properly install the seat post can cause failure resulting in serious injury or death. If you have any questions on how to install your Tellis post, please visit your nearest authorized retailer or contact SDG Components directly.



Contact SDG COMPONENTS
for ANY questions or info:

SDG Components
17451 Nichols Ln. Unit H
Huntington Beach, CA 92647 USA

Web: sdgcomponents.com
USA HQ Phone: 1 (714) 375-9333
General Email: info@sdgcomponents.com
Support: support@sdgcomponents.com

INSTALLATION

Tools Required

- 2/3/5mm Hex Wrenches
- Masking Tape
- Torque Wrench
- Grease or Carbon Paste (depends on frame)

Installing the lever

1. Remove M4 clamp bolt from remote so it opens freely.
2. Place lever on left-hand side of the handlebar. Position to what feels comfortable and re-install the M4 clamp bolt.
3. Torque bolt to 1.6 Nm (14 lbs-in).

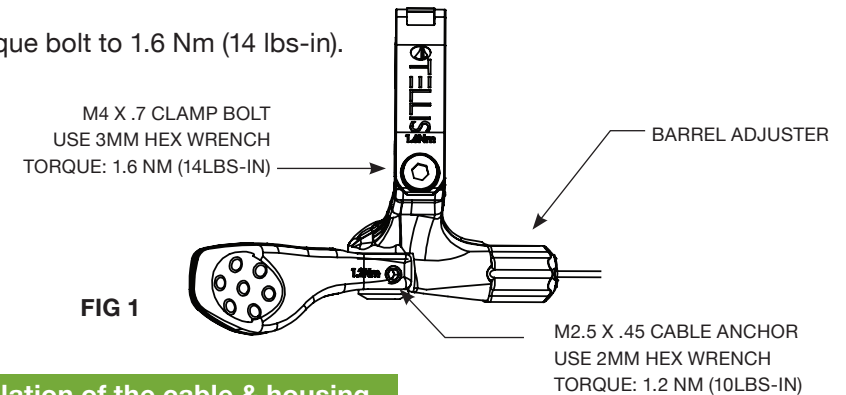

Installation of the cable & housing

1. Insert the seat post into the bike to determine the depth of the seat post. You must install a saddle at this point in order to determine saddle height.
2. Mark the seat post tube (FIG 2) with masking tape at the seat post binder and remove the seat post. (Do not remove the tape as it will be used to install the cable at the end)
3. Measure from marked tape to bottom of the seat post and write down measurement for use later in installation process.

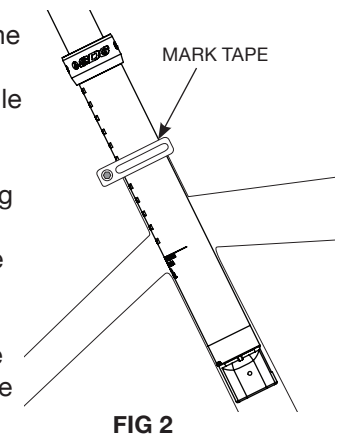

4. Route the housing from the lever through the frame and insert the end into the barrel adjuster (with end cap installed). Rotate the bars to ensure the cable is long enough, does not bind, does not stretch and does not interfere with other cables or parts.
5. Once the length is determined, put a piece of tape on the housing to mark the spot where it sticks out of the seat tube. (FIG 3)
6. From the marked tape on the housing, cut the length (Using measurement from Step 3) below the mark. You will need to feed the housing up and out of the seat tube.

7. Install end cap to cable housing at seat post end. Secure the inner cable head into the actuator coupler and insert cable into seat post end of housing (with end cap installed). (FIG 4)

8. Install cable housing thru housing and thru barrel adjuster so the inner cable comes out the back side (FIG 5).

9. Remove all slack in the cables before tightening the cable anchor screw to 1.2Nm (10 lbs-in). Be sure the housing is sitting flush in barrel adjuster and actuator before tightening cable. Trim any excess inner cable and install cable end cap to trimmed end of cable.

10. Check for optimum distance from housing end cap to cable head of 10mm prior to inserting seat post into frame.

11. Press the lever to stretch the cable and confirm cable housing is seated properly. Remove additional slack by unscrewing the barrel adjuster until play in lever is gone.

13. Insert the seat post into the frame down to the tape while simultaneously pulling on the cable and housing from the opposite end.

14. Secure remote onto handlebar to 1.6Nm.

Minimum Insertion Point	100mm
Saddle Rail Compatibility	7x7 mm & 7x9 mm

Service videos are available on sdgcomponents.com

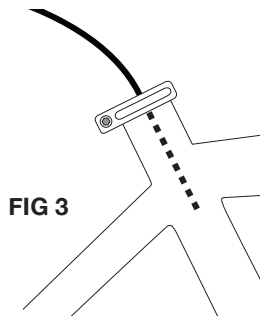

FIG 3

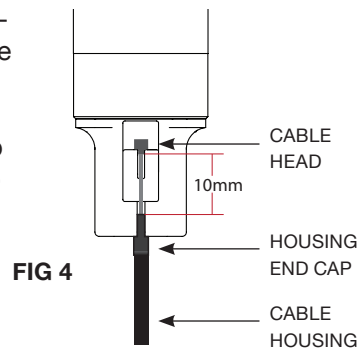

FIG 4

*Optimum Distance for Actuation

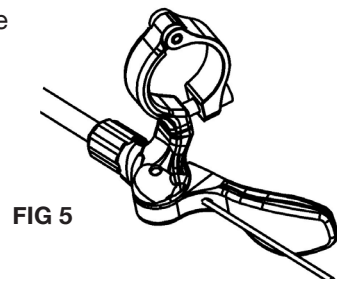

FIG 5

MAINTENANCE

- **After Every Ride:** Clean dirt and debris away from post and specifically ensure seal is clear of any dirt, mud or debris.
- **Every 120 Hours Of Ride Time:** Loosen collar to clean old grease and apply a liberal application of new suspension specific grease underneath the collar. Tighten collar back down and cycle post 5-10 times to spread grease.
- **Every 400+ Hours:** Inspect internals for wear items and replace as needed. Please visit www.sdgcomponents.com for disassembly instructions.

WARRANTY

- **SDG Limited Two (2) Year Warranty on Tellis Dropper Seat Post**
- Subject to limitations, SDG warrants, to the original owner (non-transferable), that the Tellis post be free from defects in materials and workmanship. This limited warranty expires two (2) year from the date the original SDG post was purchased from an authorized dealer or from an authorized Original Equipment Manufacturer. (Receipt required to validate)

Terms of Warranty

- Shall this product fail under normal conditions, while properly maintained per the maintenance schedule, SDG or an authorized agent, at their sole and final discretion, will repair, replace and or service.
- This limited warranty does not apply to normal wear and tear, malfunctions that resulted from improper assembly, failure to follow maintenance, alteration, crash, or any other improper or excessive use.
- **Contact SDG COMPONENTS for ANY warranty questions.**

PLEASE READ!

- **If you have any questions or are unclear on any steps of the install process, please either contact SDG directly or your local bike shop to ensure correct installation. Failure to do so can cause the post to malfunction causing serious injury or death.**
- Follow installation instructions closely. Failure to do so can result in post malfunction causing serious injury or death.
- Ensure post is inserted to at least the minimum insertion line. If minimum insertion line is exposed it can cause the post and / or frame to fail.
- Following any crash, please have a certified mechanic inspect your post and bike for damage to ensure the post is still safe to ride.
- Always wear a helmet and ride within your limits.

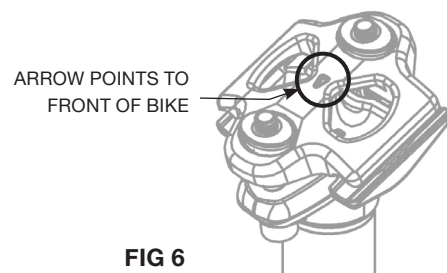

FIG 6

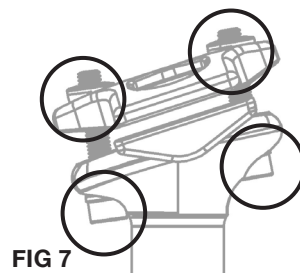

FIG 7

GREASE CONTACT POINTS