

Catalog:	
Project:	
Type:	Date:
Notes:	

CCT & Watt Selection Full Cut-off Wallpack

TK-WPX2™ Series

Description

TekTron's LED Full Cut-off wallpack is a durable and energy-efficient lighting solution for outdoor wet locations. It features a die-casting aluminum housing and heatsink with a PC material lens and type III short distribution, which can be adjusted to different angles and mounted on the wall.



Applications

This is an ideal commercial out door fixture for buildings, and easily replace to any semi cut-off & full cut-off wall packs.

Quick Ship

TK-WPX2S-65830/40/50
 TK-WPX2M-100830/40/50
 TK-WPX2S-65830/40/50
 TK-WPX2M-100830/40/50

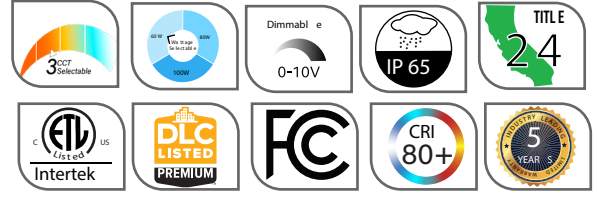

Specification Features

Controls / Dimming

0-10V dimming, 3 lumens & 3 wattage output selectable by The DIP switch. Die-casting aluminum housing and heatsink. IP65 rated and suitable for using in outdoor wet location. Photocell sensor and Motion sensor options available with field installation.

Certification

It complies with ETL Listing, DLC Premium, TITILE 24, and IP65 Rated.

Warranty

5 Years Limited Warranty.
 For more information visit us at,
www.technoledlights.com/warrantyinfo

Installation / Mounting

The installation process is straight forward and offers a range of mounting possibilities. Up or Down installation available. Optional for outlet box for surface wall mount.

Ordering Information Example: TK-WPX2S-100830/40/50

TK	WPX2	S	100	8	30/40/50	D1	BR	[BLANK]
Brand	Series	Size	Watts <small>(Wattage Changeable)</small>	CRI	Color Temp	Dimming	Finish	[Voltage]
TK - TekTron	WPX2 - Wall Pack X2	S - Small M - Medium	65 - 30W/50W/65W 100 - 60W/80W/100W	8 - 80+ CRI	30K - 3000K T - 40K - 4000K 50K - 5000K } CCT Selectable 30 - 3000K 35 - 3500K 40 - 4000K 50 - 5000K 65 - 6500K } Single Color Optional	D1- Dimming 0-10V with 12	BR-Brown W - White B- Black	Blank - 120-277V 347 - 120-347V [Options] SPD Outlet Box EMBB Photocell Motion Sensor

Specification Features

Input Voltage	120-277 VAC / 120-347 50/60HZ
Color Temperature (CCT)	3CCT - 3000K/4000K/5000K
Luminous efficacy (Lm/W)	120 - 140 Lm/W (5050 SMD LED)
Color Rendering Index (CRI)	Ra>80
Dimmable	0-10V
Power Factor	>0.90
Operating Temperature	-30°C ~ 45°C
Life Span	50,000+ Hrs

Product Dimension

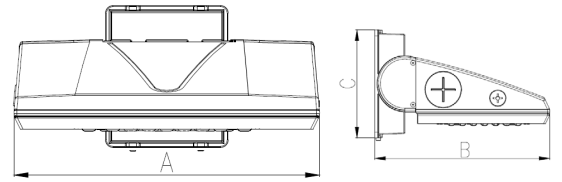

Part Number	A (Length)	B (Width)	C (Height)
TK-WPX2S	9.71 Inches	8.74 Inches	5.92 Inches
TK-WPX2M	12.78 Inches	12.78 Inches	5.92 Inches

Photometric

Medium 100W 5000K

DATA OF LAMP		PHOTOMETRIC DATA Eff: 135.82 lm/W			
MODEL		Imax(cd)	8133	η street_up(%)	0.0
NOMINAL POWER (W)	100	LOR(%)	100.0	η street_down(%)	70.3
RATED VOLTAGE (V)	120	TOTAL FLUX(lm)	13054	η house_up(%)	0.0
NOMINAL FLUX (lm)	13053.9	MAXIMUM @ (C, γ)	150,63.5	η house_down(%)	29.7
LAMPS INSIDE	1	η up(%)	0.0	76 FLASHAREA(m2)	
TEST VOLTAGE (V)	120.7	η down(%)	100.0	SLI	

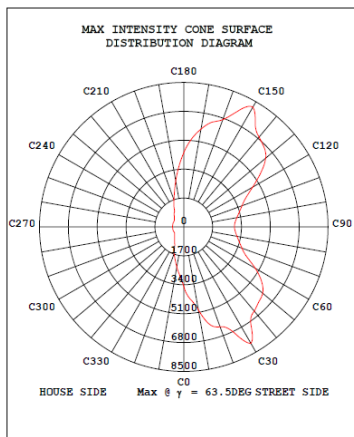
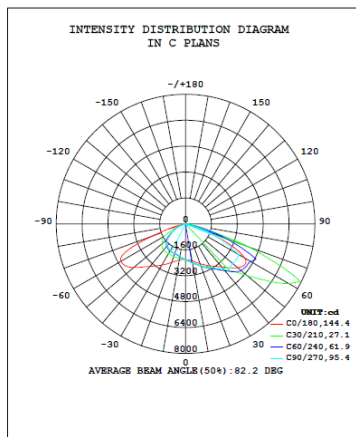

Medium 40W 5000K

DATA OF LAMP		PHOTOMETRIC DATA Eff: 145.58 lm/W			
MODEL		Imax(cd)	5695	η street_up(%)	0.0
NOMINAL POWER (W)	60	LOR(%)	100.0	η street_down(%)	70.3
RATED VOLTAGE (V)	120	TOTAL FLUX(lm)	9138	η house_up(%)	0.0
NOMINAL FLUX (lm)	9138	MAXIMUM @ (C, γ)	150,63.5	η house_down(%)	29.7
LAMPS INSIDE	1	η up(%)	0.0	76 FLASHAREA(m2)	
TEST VOLTAGE (V)	120.7	η down(%)	100.0	SLI	

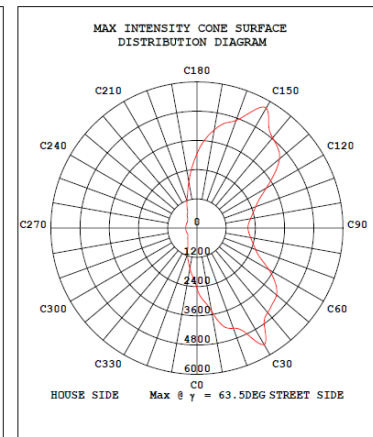
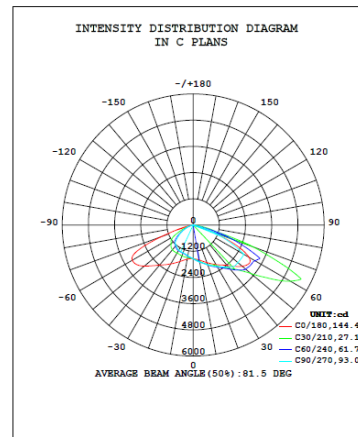

CCT And Wattage Changeable Switch

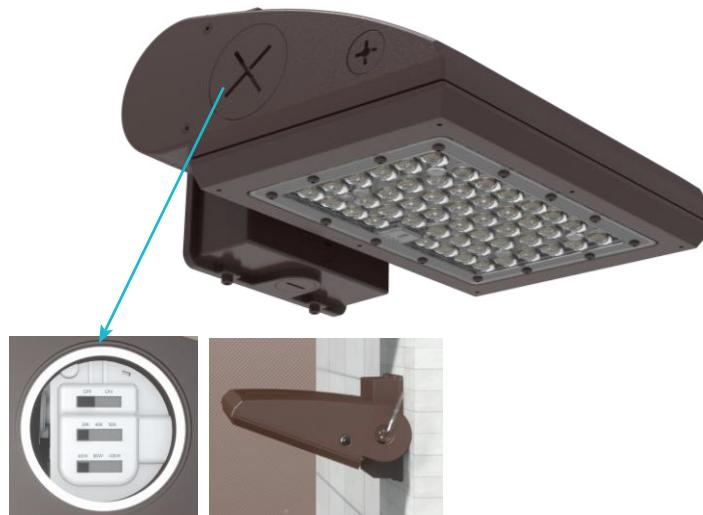

Optional Accessories



Outlet Box



9W EMBB



10KV SPD

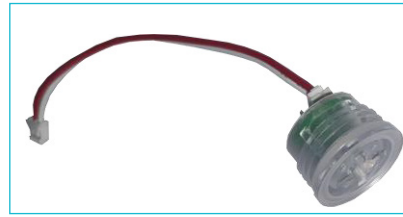

Photocell



Dimmers

For Reference Only (Compatible Dimmer Listings)

The testing done by TekTron's does not mean or guarantee that the product meets the standards or certifications of any independent laboratory or other authority. For more details on the product's standards and certifications, please refer to the manufacturer specifications. Before installing the product, please check with the dimmer manufacturer to make sure they are compatible.

Manufacturer	Product/PartNumber	Part Number	Dimmed Light Output Range
Lithonia	Slide Dimmer, 0-10V DC, 1500W for LED and CFL Lighting, Single Pole, 3-Way Wiring, Allows on/offswitching without disturbing light level, Fits Standard Single or Multi-gang switch boxes.	ISD BC 120/277 WH	5% - 100%
Cooper	Slide Dimmer, 0-10V, 120/277VAC 60Hz, 1200/1600W for LED and CFL Lighting, Single Pole, 3-Way Operation, Commercial/Residential Application, Title 24 Compliant.	SF10P-W	5% - 100%
Lutron	Diva Dimmer, 0-10V, 120 to 277VAC 50/60Hz, 8 Amp, 2216W for LED and CFL Lighting, Single Pole, 3-Way Operation. Commercial/Residential, Indoor Application.	DVSTV-WH	5% - 100%
Leviton	IllumaTech Mark 7 Dimmer, 0-10V, 120/277VAC 60Hz, 1200/1500W for LED and CFL Lighting, Electro Mechanical Preset On/Off Switch, Single Pole, 3-Way Operation, Commercial/Residential Application.	IP710-DLZ	5% - 100%

Installation

1. Fix the installation J-BOX plate



2. Fix the aircraft cable and wires



3. Fix the fixture.

