

Contents

Two 10-mL Red Top Vacutainer

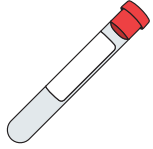

10-mL Serum Transfer Tube

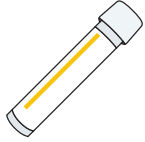

Crush-Proof Cardboard Box



Disposable Transfer Pipette

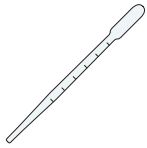

Resealable Bag

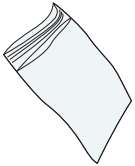

Absorbant Pad

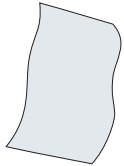

Test Requisition Form



*Shipments to Canada also include the following:

- Shipping Label
- Waybills
- Self-Adhesive Pouch

Shipping Within US and Canada

FedEx Express Clinical Pak & Billable Stamp

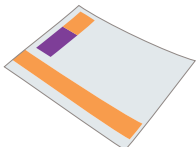

or

USPS Priority Mail Small Flat Rate Box
WA, AK, HI, & PR

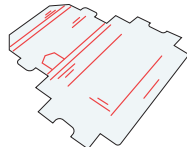

Diet & Medications

It is suggested that you maintain your usual dietary habits and consume a variety of foods when possible within a couple weeks prior to blood collection, unless advised otherwise by your healthcare practitioner.

Avoid eating foods that may have potentially resulted in a previous adverse reaction and/or anaphylaxis, as secondary exposure may prove fatal.

Immunosuppressive drugs such as oral or intranasal corticosteroids (e.g. prednisone, beclomethasone, fluticasone, triamcinolone) and topical cortisone suspensions and creams, in addition to immune-modulating drugs, may affect test results for antibody assessment.

Important

Food, Inhalant, & Mold Panels

The lab must receive specimen within 14 days at ambient temperature from date of collection

Celiac Antibody Panel

The lab must receive specimen within 10 days at ambient temperature from date of collection

US BioTek Laboratories is NOT a Medicare or Medicaid provider. Our test procedures are not reimbursable by either.

Avoid Specimen Rejection

Label Serum Transfer Tube with Patient Full Name, Date of Birth AND Specimen Collection Date. A specimen tube missing this information will be rejected.

Patient Name on Serum Transfer Tube must exactly match Patient Name on Test Requisition Form. Do NOT use nicknames or abbreviations.

For IgE Inhalant Panel, patient's zip code is required.

SERUM COLLECTION & SHIPPING INSTRUCTIONS

Food, Inhalant & Mold Antibody Assessment Panels
Candida Antibodies & Antigen Panel
Celiac Antibody Panel



Read this document carefully before using the contents of this package.

Celiac & Specific-IgA Panels are not suitable for breast-fed infants. Total IgE is not available for ages less than 10 years.



16020 Linden Ave North, Shoreline, WA 98133-5672, USA

P: 1.206.365.1256

F: 1.206.363.8790

Toll Free: 1.877.318.8728

USBioTek.com



Important Shipping Instructions

Clearly print Patient Name (First & Last), Date of Birth & Specimen Collection Date on Serum Transfer Tube and Test Requisition Form.

Test Requisition Form must also include:

- Practitioner's Name
- Requested Test
- Specimen Storage
- Payment Information

Missing or incomplete test request information will delay processing and extend turn-around time. Specimen may be safely shipped at ambient temperature. For tracking purposes, keep a copy of your tracking number.

Shipping Within the US

Complete FedEx Express Billable Stamp and stick onto Clinical Pak.

Stamps are prepaid for FedEx 2-Day delivery for lower 48 states.

Contact FedEx for pickup: 1.800.463.3339.

Do NOT initiate or request Saturday pickup or delivery from FedEx. Additional shipping charges will be incurred.

Attention **Washington, Alaska, Hawaii, & Puerto Rico**

Mail specimen via US Postal Service with the prepaid Priority Mail Small Flat Rate Box provided. A more immediate delivery is at the cost of the practitioner.

Shipping from Canada

Shipping Contents Include:

- 1 Large Clinical Pak
- 1 FedEx self-adhesive pouch
- 3 Labels
 - 1 Mailing Label (top 1/3)
 - 2 Waybills (bottom 2/3)
- 1 commercial invoice

Open pre-sealed purple flap on self-adhesive pouch

Place inside: 2 waybills and commercial invoice

Adhere self-adhesive pouch outside of the FedEx Clinical Pak. Put mailing label on outside of pouch.

Contact FedEx for pickup: 1.800.463.3339.

Shipping Outside of US & Canada

Client is responsible for the shipping cost.

Specimen Collection Instructions

Follow collection instructions carefully.

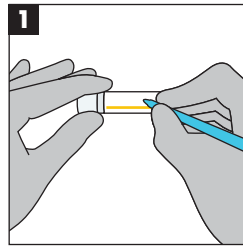

Clearly print Patient Name (First & Last), Date of Birth & Specimen Collection Date on Serum Transfer Tube.

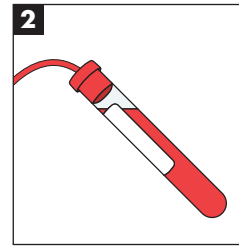

Draw the blood utilizing the Red Top Vacutainer tubes provided.

1 fully drawn Red Tube Vacutainer OR Serum Separating Tubes (SST) will usually yield about 3-4 mL of serum.

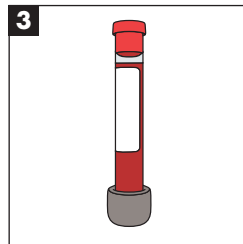

Allow the blood to clot at ambient temperature for 30 minutes.

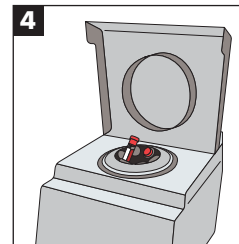

Centrifuge at 3000 RPM for 15 minutes.

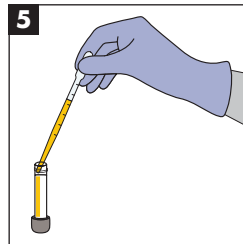

With the Disposable Transfer Pipette, transfer serum from the Red Top Vacutainer into Serum Transfer Tube.

Do NOT transfer red blood cells to the Serum Transfer Tube.

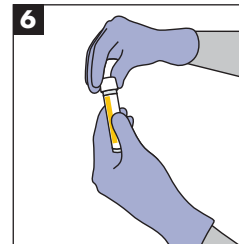

Secure tightly.

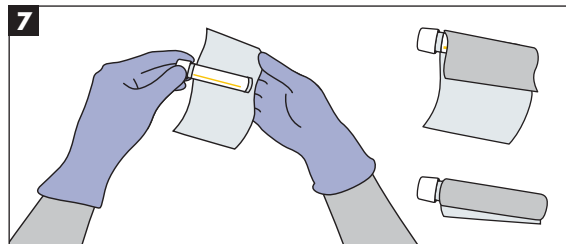

Wrap Serum Transfer Tube with Absorbent Pad and seal.

Specimen Collection Instructions Cont.

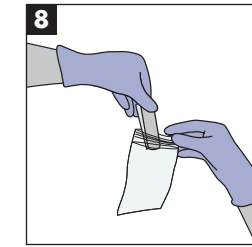

Place Serum Transfer Tube into the Small Resealable Bag.

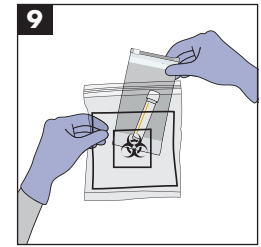

Place this Bag into the Provided Biohazard Bag.

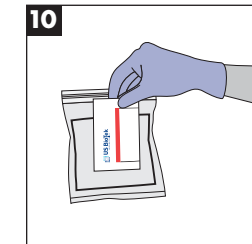

Put the completed requisition form in the outside pocket of the Biohazard Bag.

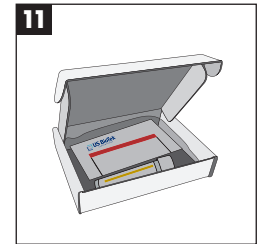

Place the Biohazard Bag with all contents into the Crush-Proof Cardboard Box.

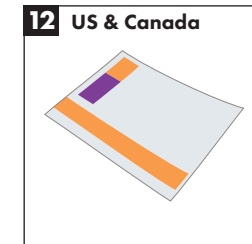

Put the Crush-Proof Cardboard Box into the FedEx Express Clinical Pak. Seal securely.

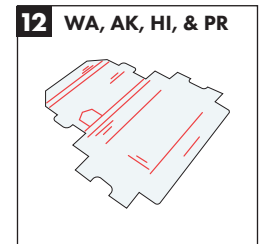

Put the Crush-Proof Cardboard Box into the USPS Priority Mail Small Flat Rate Box. Seal securely.

or

Serum Requirements

Serum volumes are listed on the Test Requisition Form. An insufficient sample may result in the inability to complete testing for all panels ordered. Notification of the panels that could not be completed is issued with the partial items.

Hemolyzed, lipemic or icteric sera will be rejected.