

MODEL: IRT-MR67GTCOMBO
UNDERCOUNTER:
Granite top pizza prep tables.

General Strengths

- ✓ **Higher energy efficiency.** R290 refrigerant with electronic fans and evaporative tray without electric heaters.
- ✓ **Sanitation.** The interior cabinet is built with rounded corners (extensive radius for easy cleaning). Quick ability to take off shelves and slides for interior cleaning. Each cabinet has a drain at the bottom of the unit. When cleaning the unit make sure the drain hose is routed to a floor drain.
- ✓ **Doors & Drawers.** Self-closing door system with permanent pressure. Stay open feature included when door remains open after 95 degrees. All doors include triple chamber door gaskets, easy to remove and snap in.
- ✓ **Control systems.** Greater ability for the adjustment of temperature range as per the end user's requirements.
- ✓ **100% Tested.** All condenser units are 100% tested, in helium chambers for refrigerant leak detections.
- ✓ **Certified.** Audited and Certified by INTERTEK for compliance with UL 471 and NSF 7. AENOR audited and certified by internationally recognized firm. ISO 9001:2015 (Quality); ISO 14001:2015 (Environmental); OSHAS 18001:2007 (Prevention and Worker Safety)



MODEL		Dimensions (inches) (mm)			Nº Doors	Nº Shelves	Ref.	Ref. Weight (Lbs.) (gr.)	Temp. Range (°F) (°C)	Capacity (Cu. Ft.) (L)	Cond. Unit. H.P.	Case Amps 115 V.	Crated Weight (Lbs.) (Kg.)
		W	D	H									
IRT-MR67GT Combo	Tables	68-7/8 1751	32-5/8 830	59-3/8 1508	2	4	R290	0.24 110	35°F/41°F +2°C/+5°C	17 480	3/8	7.1	955 433
	VIPS	68-1/4 173	16-1/4 413	17-3/4 450	-	-	R134a	0.46 215	39°F/41°F +3°C/+5°C	1.83 52	1/6	1.82	

FTL LISTED TO UL471 STANDARD AND SANITATION CLASSIFIED TO NSF7 - WE RESERVE THE RIGHT TO CHANGE SPECIFICATIONS WITHOUT PRIOR NOTICE

MODEL: IRT-MR67GTCOMBO
UNDERCOUNTER:
Granite top pizza prep tables.
STANDARD FEATURES
➤ Exterior

- AISI 304 Stainless Steel Top,
- AISI 430 Stainless Steel.

➤ Interior

- AISI 430 Stainless Steel,
- Internal drain plugs for easy cleaning,
- Sealed interior floors and rounded cabinet corners.

➤ Doors

- Polyurethane insulated doors,
- Self-closing doors with stay open feature,
- Stainless Steel heavy-duty hinges,
- Triple chamber snap in door gaskets for easy removal and cleaning,
- Door locks,
- Door opening: WxH= 22-7/8"x20-5/8" (580x525 mm).

➤ Insulation

- CFC-Free polyurethane insulation, entire cabinet structure is foamed-in using a high-density polyurethane insulation,
- Low GWP & Zero ODP effect.

➤ Casters

- 4" diameter casters,
- Locks provided on front set.

➤ Shelving

- (2) Plastic coated wire shelves per section,
- Guides and shelves easy to take off for cleaning,
- Dimensions WxD: 20-7/8"x25-5/8" (GN 2/1) (530x650 mm),
- Compatible with 18"x26" (457x660 mm) sheet pans.

➤ Refrigeration

- Digital temperature controller with automatic defrost system,
- Energy-saving non-electric condensate Pan,
- Forced air refrigeration system,
- Extractable condensing unit for easy service,
- Evaporator coil coated with anti-corrosion material 100% Polyester,
- Electronic fans,
- Refrigeration capacity: 2126 Btu/h (14°F) / 623 W (-10°C) (Table) + 478 Btu/h (14°F) / 140 W (-10°C) (VIP).

➤ Electrical

- Cord and NEMA 5-15P plug.
- Electrical connection is 115V / 1ph / 60 Hz.
- 15 AMP breakers required,

➤ ETL Listed to UL471 Standard and Sanitation classified to NSF7.
OPTIONAL FEATURES

- ✓ Set of 6" legs, height adjustable from 5" to 8",
- ✓ Stainless Steel wire shelves,
- ✓ Additional slide kits,
- ✓ Drawer kit,
- ✓ Electrical connection is: 230 V / 1ph / 50 Hz (plug type varies).

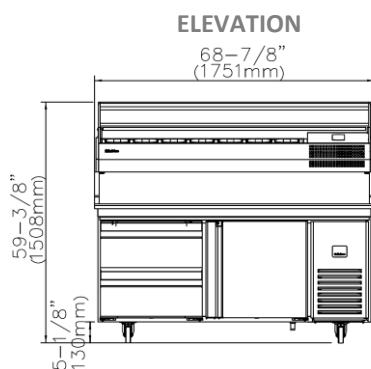
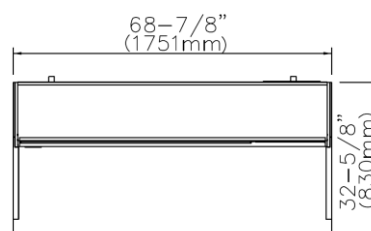
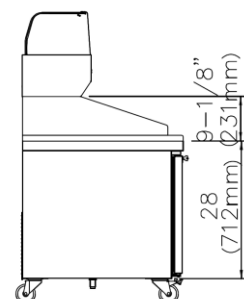
PLAN VIEW

PLAN VIEW

RIGHT VIEW

ETL LISTED TO UL471 STANDARD AND SANITATION CLASSIFIED TO NSF7 - WE RESERVE THE RIGHT TO CHANGE SPECIFICATIONS WITHOUT PRIOR NOTICE