

JAMES MCCABE

BELFAST ♦ LONDON

INSTRUCTION
MANUAL

BAJA

BAJA
Chronograph Watch

Mecha-Quartz Chronograph

This watch is powered by a Japanese made “Mecha-Quartz” movement. It combines a battery regulated engine with a mechanical chronograph module. The result is a watch which delivers the meticulous pinpoint precision of a quartz movement along with the crisp, flyback handfeel and visual charm of mechanical watches.

For more details on operating this Chronograph please refer to the enclosed booklet or visit

mccabewatches.com

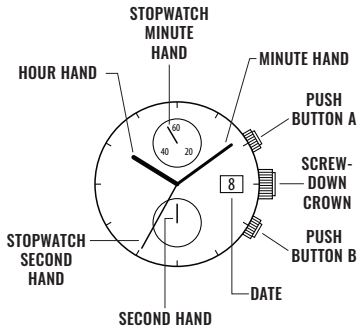

PLEASE READ THE FOLLOWING BEFORE UNSCREWING THE CROWN:

SCREW-DOWN CROWN

Screw-down crowns are used to ensure water resistance. **ALWAYS** be certain that your crown is securely screwed down (Position [0] is secured. Positions [1], [2] and [3] are not secured for water resistance).

Do **NOT** unscrew your crown while you are in any environment where moisture is present.

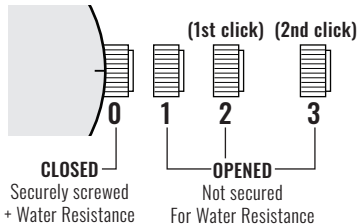

USING THE SCREW-DOWN CROWN

DO **NOT** PULL THE CROWN UNLESS IT IS *UNSCREWED* FIRST:

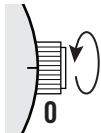

TO UNSCREW: Turn the crown anti-clockwise until it turns freely without tension. GENTLY pull the crown out to the other desired positions for watch setting (see specific operating instructions on the following pages).

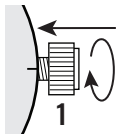

TO SCREW: Push the crown ALL THE WAY IN (towards the watch) THEN begin to turn clockwise until it is securely screwed down.

NOTE: Failure to SECURELY screw down the crown after setting the watch may affect its water resistance.

HOW TO SET THE TIME

1. Unscrew the crown and pull it out to position [3].
2. Turn the crown to set the correct time.
3. Push the crown in then screw it securely.

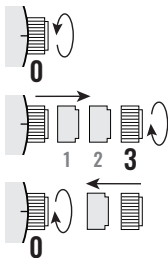

- * Take a.m./p.m. into consideration when setting the hour and minute hands to the desired time.
- * When the crown is at the position [3], do not press any button, otherwise the chronograph hands will move.

HOW TO SET THE DATE

1. Unscrew the crown and pull it out to position [2].
2. Turn the crown clockwise to set the correct date.
3. Push the crown in then screw it securely.

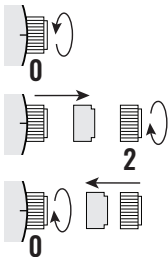

* Do not set the date between 9:00 P.M. and 3:00 A.M. , otherwise the day may not change properly. If it is necessary to set the date during the time period, first change the time to any time outside it, set the date and then reset the correct time.

STOPWATCH FUNCTION

- The measurement of time is indicated by the stopwatch hands that move independently of the center hands.
- The stopwatch can measure up to 60 minutes.

STANDARD MEASUREMENT

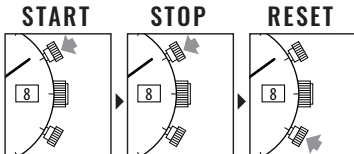

ACCUMULATED ELAPSED TIME MEASUREMENT

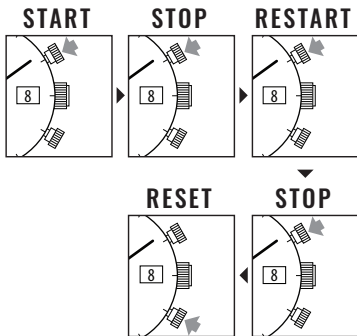

Restart and stop of the stopwatch can be repeated by pressing the button **A**.

STOPWATCH HANDS POSITION ADJUSTMENT

If the stopwatch hands are not in the [0] position (12 o'clock position), follow the procedure below to set them to the [0] position.

If the stopwatch is in use, press the buttons in the following order to reset, and then, check if the hands return to [0] position.

- If the stopwatch is counting: **A** -> **B**
- If the stopwatch is stopped: **B**

If either of the stopwatch hands are not in the [0] position, reset them following the procedure below.

1. Unscrew the crown and pull it out to position[3].
 2. Press button **A** or **B** to reset all stopwatch hands to [0] position.
- * The stopwatch minute hand moves correspondingly with the stopwatch second hand.

Tips: The hands move quickly if the respective buttons are kept pressed.

3. Push the crown in and screw it securely.

WATER RESISTANCE

Note that the water resistance chart serves only as a guide (please refer to the water resistance chart on the next page). Actual water resistance may vary depending on a number of factors including water temperature, water salinity, and use under water.

The water resistance of your timepiece may eventually be compromised over time with general wear and tear and use of your timepiece under adverse conditions.

Always remember to employ the screw down crown if available to maintain the water resistance of your timepiece. Warranty may be voided if the screw down crown has not been properly employed.

Note that you should **never** wear your watch in a jacuzzi or steam room where steam may enter the case despite the water tight seals used to protect your watch. This may cause condensation inside your watch which may effect and damage the inner workings of your watch.

WATER RESISTANCE CHART	30M/ 3ATM	50M/ 5ATM	100M/ 10ATM	150M/ 15ATM	200M/ 20ATM
SPLASH/ SHOWERING	<input checked="" type="checkbox"/>	<input checked="" type="checkbox"/>	<input checked="" type="checkbox"/>	<input checked="" type="checkbox"/>	<input checked="" type="checkbox"/>
SWIMMING/ BATHING	<input type="checkbox"/>	<input checked="" type="checkbox"/>	<input checked="" type="checkbox"/>	<input checked="" type="checkbox"/>	<input checked="" type="checkbox"/>
BRIEF SWIMMING/ WATER SPORTS	<input type="checkbox"/>	<input type="checkbox"/>	<input checked="" type="checkbox"/>	<input checked="" type="checkbox"/>	<input checked="" type="checkbox"/>
PROLONGED SWIMMING/ FREE DIVING	<input type="checkbox"/>	<input type="checkbox"/>	<input type="checkbox"/>	<input checked="" type="checkbox"/>	<input checked="" type="checkbox"/>
SCUBA DIVING	<input type="checkbox"/>	<input type="checkbox"/>	<input type="checkbox"/>	<input type="checkbox"/>	<input type="checkbox"/>
PROFESSIONAL DEEP SEA DIVING	<input type="checkbox"/>	<input type="checkbox"/>	<input type="checkbox"/>	<input type="checkbox"/>	<input type="checkbox"/>