

Teg Tab

THE FUTURE OF TEGULAR CEILINGS

**Taking the acoustic
ceiling industry
by STORM!**

A revolutionary new approach to tegular ceiling installation!



- *Eliminates the need to hand-reveal edges on tegular ceiling tiles while creating a perfect finished perimeter.*
- *Revolutionary design snaps easily into place - and stays in place!*
- *Prevents future damage to panel edges from removal and replacement of tiles.*
- *Facilitates easy future replacement of stained or discolored tiles.*
- *Durable material allows riveting right through the TegTab for grid stability.*
- *Eliminates most debris from the installation process, as well as residual dust after installation is complete.*
- *Third-party tested for seismic compliance.*

“The ceiling looks as good as the day we installed the panels! I have not had to replace any broken tiles!”

-G.S., Yonkers, NY

The old way...

HANG GRID

INSTALL THE GRID SO THAT IT RESTS IN THE WALL MOLD. THEN MEASURE THE OPENINGS FOR THE PERIMETER TILES - THE FIRST OF MANY TRIPS UP THE LADDER...



MEASURE & CUT

THE TILE NEEDS TO BE CUT TO FIT THE FULL WIDTH TO THE WALL. (IF YOU HAD INSTALLED TEGTABS, YOU'D BE DONE BY NOW...)



SCORE EDGES

ANOTHER TRIP UP THE LADDER TO SCORE A LINE FOR THE REVEALED EDGE. ALSO, ANOTHER OPPORTUNITY FOR DAMAGE TO TILE EDGES AS PANELS ARE INSERTED AND REMOVED.



HAND-CUT REVEAL

THE REVEALED EDGE REQUIRES TWO CUTS, VERTICAL AND HORIZONTAL. BESIDES TAKING TIME, IT ALSO WEAKENS THE EDGE AND CAN LEAD TO BROKEN CORNERS.



CLEAN UP EDGES

HAND-CUTTING THE REVEAL ALSO LEAVES AN UNEVEN, CRUMBLY EDGE THAT NEEDS TO BE TRIMMED AND CLEARED OF DEBRIS.



CHECK FIT

UP THE LADDER AGAIN TO CHECK THE FIT BEFORE ANY FINAL ADJUSTMENTS FOR A PERFECT FIT.



ADDED DETAILS

IF THE REVEALED EDGE IS VISIBLE, OR IF THE ENVIRONMENT NEEDS TO BE DUST-FREE, YOU NEED TO PAINT THE EDGE TO SEAL THE FIBERS AND GET A FINISHED LOOK.



The TegTab way!

SNAP TEGTABS ON

WITH THE WALL MOLD INSTALLED 1/4" OR 3/8" BELOW THE GRID, THE TEGTABS SIMPLY SNAP ONTO THE GRID AND SLIDE INTO THE WALL MOLD.



MEASURE & CUT

MEASURE THE OPENING AND CUT THE TILE AS YOU NORMALLY WOULD, WITHOUT THE REVEALED EDGES

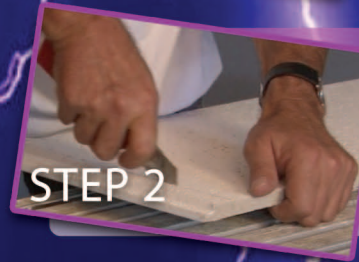

SET TILE

SIMPLY DROP THE TILE INTO PLACE... NO TRIMMING NECESSARY.



YOU'RE DONE!

YOU HAVE A BEAUTIFUL, CLEAN FINISHED EDGE, WITH FAR LESS CHANCE OF FUTURE DAMAGE.



- **No more hand revealing edges**
- **No more broken tiles**
- **No messy clean-up**
- **Easy replacement of stained tiles**
- **Seismically tested and fire rated**
- **Durable material supports riveting**