

MeacoHeat PTC Ceramic Heaters

MeacoHeat Motion Eye 1.8kW



MeacoHeat MotionMove Eye 2.0kW



PLEASE READ ALL INSTRUCTIONS CAREFULLY BEFORE OPERATING.



INSTRUCTION MANUAL [EN]
MeacoHeat

SAFETY INFORMATION – PLEASE READ BEFORE USE



WARNING: DO NOT COVER

In order to avoid overheating, do not cover the heater.

WARNING: In order to avoid overheating, do not cover the appliance with anything, especially flammable materials, such as clothes or paper.

CAUTION: In order to avoid hazards due to inadvertent resetting of the thermal cutout, this appliance must not be operated through an external switching device, such as timers, programmers, separate remote-control system or connected to a circuit that is regularly switched on and off by the utility.

CAUTION: Some parts of this product can become very hot and cause scalding. Particular attention has to be given where children and vulnerable people are present.

In case of a failure whilst under warranty we will collect the heater from you for repair/replacement, therefore please save the packaging and keep it safe away from children. When you do dispose of the packaging please recycle.

When turned on do not touch the air outlet as it will be hot in operation.

WARNING - This appliance is intended for use in a domestic environment only. Any other use is not recommended by the manufacturer and may cause fire, electrical shocks or other injury to person or property. When using electrical appliances, basic safety precautions should always be followed:

1. **Keep Children Away:** Do not allow children to play with or around this unit, which could result in injury. Be sure the unit is inaccessible to children when not attended.
2. This appliance can be used by children aged from 8 years and above and persons with reduced physical, sensory or mental capabilities or lack of experience and knowledge if they have been given supervision or instruction concerning use of the appliance in a safe way and understand the hazards involved.
3. Ensure that the air inlets and outlets are not blocked or covered.
Do not place the unit too close to curtains or other objects - min 10cm.
4. **Keep Unit Grounded:** Always operate the unit with a grounding plug and a grounded electrical outlet. A grounding plug is an essential safety feature that helps reduce the risk of shock or fire.
5. **Protect Power Cord from Damage:** Never operate a unit with a damaged power cord, as this may lead to electrical or fire hazards. If the power supply cord is damaged, it must be replaced by manufacturer, its service agent or similarly qualified persons in order to avoid a hazard.
6. **Protect against electrical shocks,** do not immerse unit, plug or cord in water, or spray with liquids.
Do not run power cord under carpeting, or cover with rugs or runners. Arrange the cord away from areas where it may be tripped over.
7. **Extension Cords:** Extension cords must be grounded and able to deliver the appropriate voltage to the unit.
8. Where possible, avoid the use of an extension cable as they may overheat and cause a risk of fire. Only use an extension cord after ensuring it is in perfect condition. Extension leads can also cause voltage drop which will affect the heater. This is more likely when being used in garages and out buildings.
9. **Handle with Care:** Do not drop, throw or crash the heater. Rough treatment can damage the components or wiring and create a hazardous condition.
10. **Run on Stable Surface:** Always operate the unit on a stable, level surface, for example the floor or a strong counter, so that the heater cannot fall and cause injury. Use on a deep pile carpet should be avoided as this could prevent the tip over switch from activating.
11. **Keep Out of Water:** Never operate the unit in pooled or standing water, as this may create a risk of injury from electrical shock. Do not store or operate outdoors. If electrical wiring or components become wet, thoroughly dry them before using the unit. If in doubt do not use the heater and consult a qualified electrician or a Meaco approved engineer.
12. **Keep Air Intakes/outlets Clear:** Do not clog or block the air intakes/outlets by placing the heater too close to curtains, walls or anything that will restrict the air inlet. This may cause the unit to overheat and result in a fire or electrical hazard.
13. **Keep Filter Clean:** Always use a clean air filter. Do not allow any material to clog the filter, as this may cause the heater to overheat. Never use without a filter. Always check, and if necessary, clean the filter before switching

the heater on. Do not allow oil, grease, or other contaminants to be drawn into the heater. Do not clean the heater with organic solvents.

14. Never unplug the power cord without pressing the "ON/OFF" button first, as this could damage the unit. Never unplug the heater before the fan has stopped blowing. Always unplug the unit when not in use or moving location. To disconnect from the power supply, grip the plug and pull from the power socket. Never pull by the cord.
15. Keep Electrical Components Dry: Never allow water inside the heater's electrical components. If these areas become wet for any reason, thoroughly dry them before using the heater. If in doubt do not use the heater and consult a qualified electrician or a Meaco approved engineer.
16. The operator must make the operating instruction available for the user and make sure that the user does understand the manual.
17. To repair the unit, take it to a qualified service engineer. Repairs carried out by unqualified people may cause damage to the unit or injury to persons or property and void the warranty.

ATTENTION: The heater is fitted with a **thermal cut out** and a **tip-over** switch so if the heater starts to overheat or if it falls over then it will automatically turn off.

UK PLUG WIRING

Wiring Instructions: Should it be necessary to change the plug please note the wires in the mains lead are coloured in accordance with the following code:

BLUE - NEUTRAL
BROWN - LIVE

As the colours of the wires in the mains lead of this appliance may not correspond with the coloured markings identifying the terminals in your plug, proceed as follows:

1. The **BLUE** wire is the **NEUTRAL** and must be connected to the terminal that is marked with the letter **N** or coloured **BLACK**.
2. The **BROWN** wire is the **LIVE** and must be connected to the terminal that is marked with the letter **L** or coloured **RED**.
3. Always ensure that the cord grip is positioned and fastened correctly.

If a **13A (BS 1363)** fused plug is used it must be fitted with a **13A (BS 1362)** fuse. If in doubt consult a qualified electrician.

Wiring for a 13 Amp Plug (BS 1363)

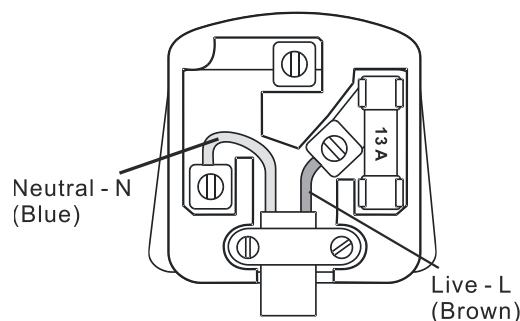

1. GENERAL ADVICE

Before putting your heater into operation for the first time, the instruction manual should be studied carefully.

After receiving the unit, you should check your heater for any transport damage. In case of damage, you should inform the sender immediately.

Keep the packaging for the heater in a safe place in order to be able to repack the heater safely if it requires a service. In order to save space, you can simply cut through the adhesive tape and flat pack the cardboard box.

2. SETUP and INITIAL USE

- ⇒ The air inlet and the air outlet must not be covered whilst the heater is in operation.
- ⇒ Before moving the heater it must be switched off by its ON-OFF switch. The mains plug is to be removed from the socket only after the fan has stopped running.
- ⇒ For transportation the heater should be secured on a level base and must be prevented from rolling around.
- ⇒ This heater must be used exclusively for heating the air.

3. PRODUCT IDENTIFICATION

MeacoHeat Motion Eye 1.8kW

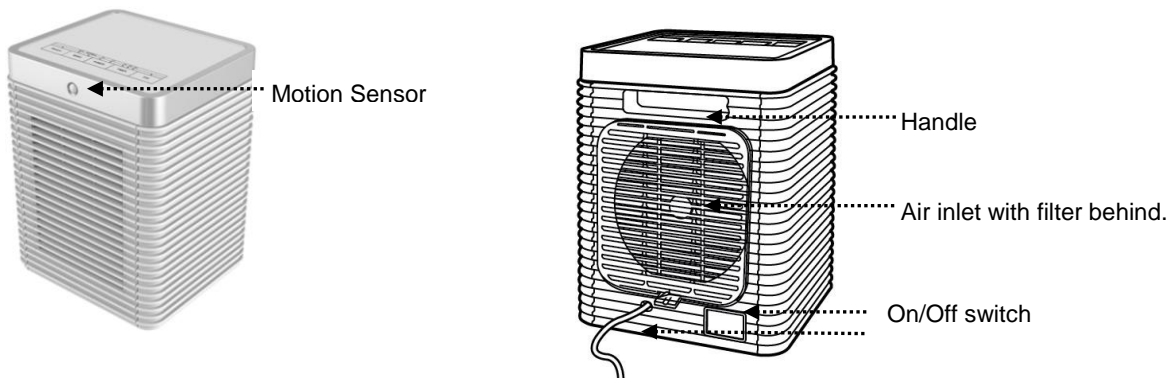

MeacoHeat MotionMove Eye 2.0kW

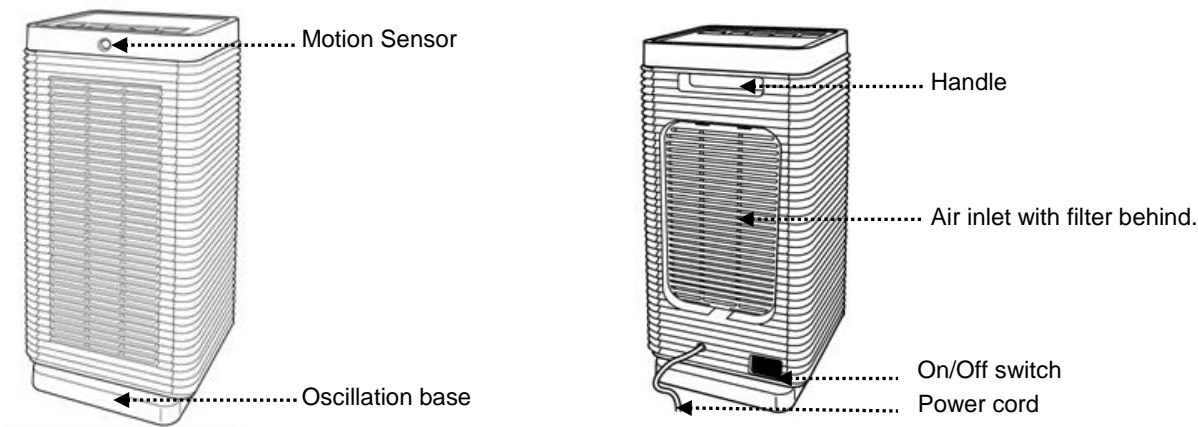

1. ODOURS

When first used or when being used after a long time in storage you may notice a slight smell coming from the unit. This is normal and as long as disperses after a short period of use then it is not an issue.

2. CONTROL PANEL

MeacoHeat Motion Eye 1.8kW

	LOW	HI		1H	2H	4H	SENSOR ON	SENSOR OFF
	○	○	○	○	○	○	○	○
ON/OFF	OUTPUT		FAN ONLY	OFF TIMER			MOTION DETECTION	

MeacoHeat MotionMove Eye 2.0kW

	FAN ONLY	LOW	HI		L	M	H	SENSOR ON	SENSOR OFF
	○	○	○	○	○	○	○	○	○
ON/OFF	OUTPUT			OSC	STAT			MOTION DETECTION	

- ⇒ **ON/OFF** - press the button once to turn the heater on or off. The heater will start in high output and continuous no sensor mode.
- ⇒ **Output** – selects either low or high heat. On the MeacoHeat MotionMove Eye 2.0kW it can also be used to switch to fan only mode with no heat output.
- ⇒ **Fan Only** – on the MeacoHeat Motion Eye 1.8kW this selects fan only mode with no heat output.
- ⇒ **OSC** – on the MeacoHeat MotionMove Eye 2.0kW this starts or stops the heater from turning left and right through 60°.
- ⇒ **OFF Timer** - on the MeacoHeat Motion Eye 1.8kW this allows you to have the heater automatically turn off after a maximum of 7 hours of operation. This is not a daily run timer and the unit will not turn back on until you next press the ON/OFF button.
- ⇒ **STAT** - on the MeacoHeat MotionMove Eye 2.0kW this controls the temperature that the heater works to and turns the heater on and off at this point automatically. You can select from either a low, medium or high heat depending on how you like your room to feel.
- ⇒ **Motion Detection** – the heater has a motion SENSOR at the top centre of the heater. When movement is detected 1 meter in front of the heater the heater will turn on, when no motion has been detected for 1 minute the heater will turn off until movement is detected again. If you select Sensor Off then all movement is ignored.

3. HEATER COOLDOWN

The heater will run its fan after you press the off button to cool itself down for approximately one minute.

After four hours of use the heater will turn itself off.

In Motion mode if the heater has not detected anyone present for 12 hours it will turn itself off.

4. OUTPUT

Model	Low	High
MeacoHeat Motion Eye 1.8kW	900 watts	1800 watts
MeacoHeat MotionMove Eye 2.0kW	1000 watts	2000 watts

5. SAFETY

This unit has a safety system, which automatically switches the appliance off, when it is overheating. If this happens unplug the heater and allow cooling down for 20 minutes. Inspect and remove any objects on or adjacent to your heater. If the defect occurs again do not attempt to repair the unit yourself. Unplug the heater from the power socket and take it to an authorised service engineer for repair.

6. MAINTENANCE

Always turn off the power and disconnect the main cable before performing maintenance procedures. All service procedures below are to **be executed with the unit unplugged**. Perform before each use or as needed.

Inspect the electrical cord for damage at regular intervals.

The working performance of the heater will be greatly reduced if the filter is blocked with dust. Check the filter at least weekly. Clean the filter if it gets clogged.

1. Remove the filter
2. Vacuum any debris from the filter.
3. Re-install the filter into the heater.

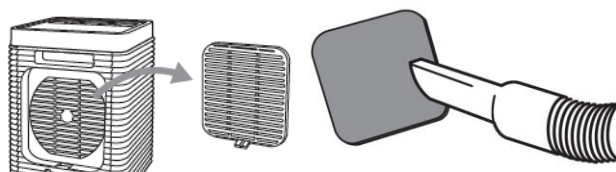

7. STORAGE

Follow the guidelines below when storing the unit:

1. Unplug the heater.
2. Prior to storing the unit, clean the filter.
3. Protect from dust and strong sunlight during storage, ideally use the original packaging.

11. WARRANTY AND CUSTOMER SERVICE

There is a two year warranty on your heater from the date of purchase.

All material or manufacturing defects will be repaired free of charge.

The following applies:

- Any repairs or replacement of components during the warranty period will not result in an extension of the warranty period.
- The warranty will expire if any alterations have been made, not genuine components have been fitted or if the heater has been repaired by a third party.
- Components subject to normal wear and tear, such as the air filter, are not covered by the warranty.
- The warranty is only valid on presentation of the original, unaltered, and date-stamped purchase receipt.
- The warranty does not cover damage caused by actions that deviate from those as described in the user's manual or by neglect.
- The warranty does not cover faults caused by dirt of third party products.
- The warranty does not cover accidental damage.
- All claims for compensation, including consequential damage, will not be entertained.

To prevent unnecessary expenses, we recommend that you always carefully read the user's manual first. If this does not provide a solution, call Meaco and we will be happy to help.

This appliance is not intended for use by person (including children) with reduced physical, sensory or mental capabilities, or lack of experience and knowledge, unless they have been given supervision or instruction concerning use of the appliance by a person responsible for their safety.

Children should be supervised to ensure that they do not play with the appliance.

This heater has been imported into the U.K. by;

Meaco (U.K.) Limited
Meaco House
Parklands
Railton Road
Guildford
GU2 9JX

Telephone: 01483 234900
Email: sales@meaco.com
Website: www.meaco.com
Fax: 01483 232700

Please record, for future reference, your date of purchase and where you bought the heater from here.

Date of purchase.....

Purchased from www.meaco.com (if not then please record the supplier's name below).

.....

Meaco are specialists in heaters and would welcome your comments and questions on this heater. If you do develop a fault within the first year then please do call us and if we cannot fix the problem over the phone we will be happy to collect the heater from you at our expense and repair or replace as appropriate.

Please save the box just in case this happens.

Meaco 07/17 – version 1.0

