

Goldair™

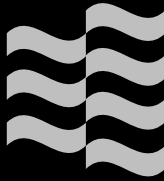

Installation Instructions

Portable Air Conditioner Window Kit



Model: GCPACWK

INSTALLATION INSTRUCTIONS

Thank you for choosing this Goldair product. This kit includes:

- Material Window Seal
- 8m Velcro Tape

Please keep these instructions in a safe place for future reference.

Install the window seal in a window where the air conditioner is used. Ensure the window is thoroughly cleaned and dry before installation.

Please refer to your portable air conditioner's user manual for instructions on how to operate the device and how to attach the hose.

Applying the velcro tape

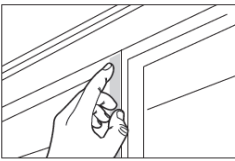

Step 1

On a clean and dry window frame, attach the adhesive Velcro tape

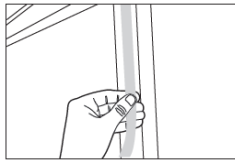

Step 2

Install the self-adhesive Velcro tape all the way down to the bottom of the frame

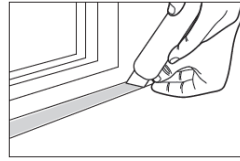

Step 3

Cut the Velcro tape to size.

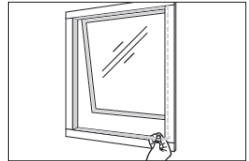

Step 4

Repeat the same steps on the window

Attaching the window seal

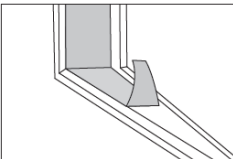

Step 1

Attach the window seal to the Velcro tape you applied on the window and frame

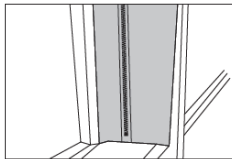

Step 2

Ensure that both sides are aligned as you attach to the entire frame

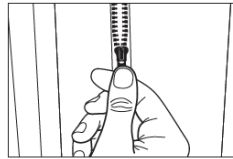

Step 3

Unzip the window seal and insert the hose

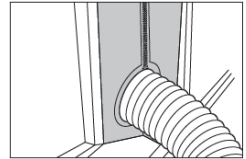

Step 4

Zip up the seal to secure the hose in place

You can cut the window seal to fit. Ensure you do not cut through the zip.

Goldair™

Goldair – New Zealand
Monday – Friday 8am-5pm
Phone +64 (0)9 917 4000
Phone 0800 232 633
info@cdb.co.nz

SUPPORT AND TECHNICAL ADVICE

Goldair – Australia
Monday – Friday 8am-5pm
Phone +61 (0)3 9365 5100
Phone 1300 465 324
info@cdbgoldair.com.au