



# SPOOL MATE LITE ASSEMBLY INSTRUCTIONS

# HARDWARE

ITEM #	QUANTITY	PART #	DESCRIPTION
1	1	SML-Weldment	Spool Mate Lite Weldment
2	1	SLH HANDLE	Spool Mate Cutting Handle
3	2	104	3/8" – 16 x 3/4" Carriage Bolt
4	1	251	3/8" – 16 x 2 1/4" Button head
5	1	305	3/8" Nylon Lock Nut
6	1	ATR-SLB	Spool Line Bar Assembly
7	1	739	1 1/4" x 2" Cap
8	2	307	3/8" – 16 Hex Flange Nut

TOOLS REQUIRED: Drill with 10 mm chuck, 10mm drill bit, 9/16" or equivalent wrench.

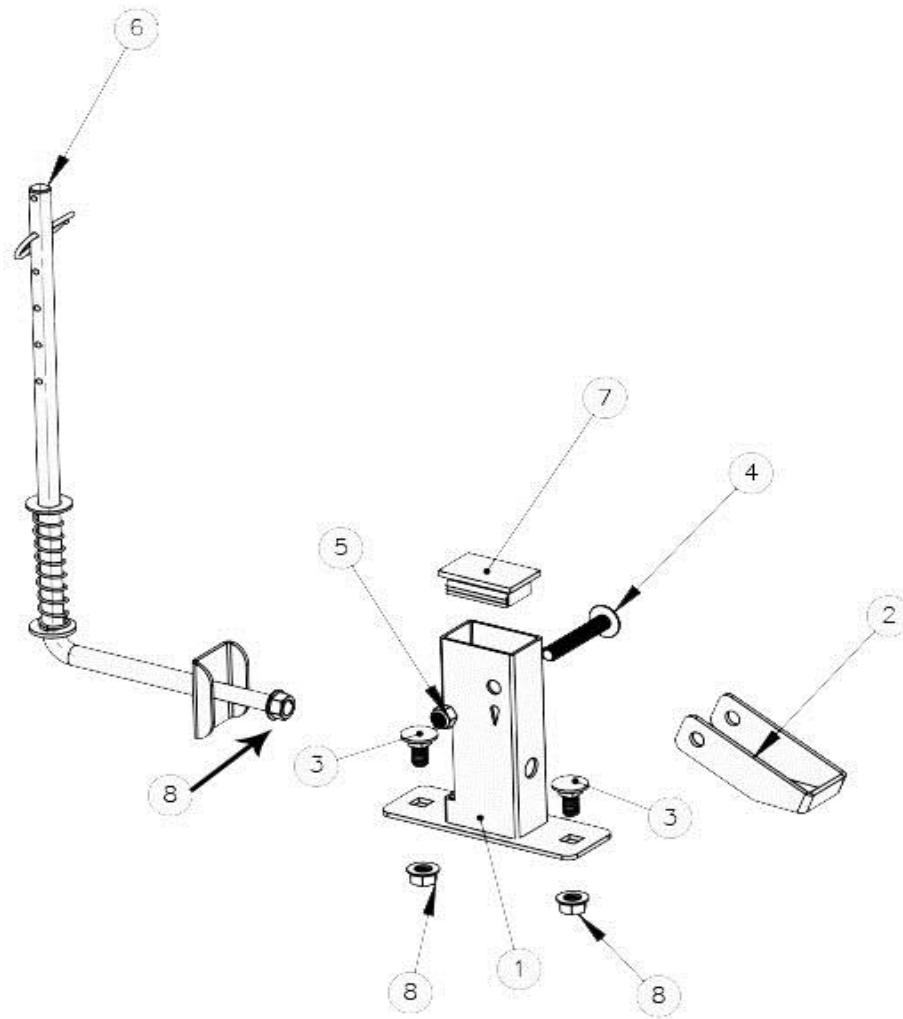

# ASSEMBLY

## **Step 1**

Snap 2" Cap #7 (739) into Spool Mate Lite Weldment #1 (SLH-001).

## **Step 2**

Attach Cutting Handle #2 (SLH-001 Handle) to Weldment using Button head socket cap screw # 4 (251) and Lock nut # 5 (305). Tighten but allow enough play for handle to move up and down with ease.

## **Step 3**

Determine desired location on trailer rail, then mark and drill two 10mm holes. Attach weldment to trailer using two carriage bolts #3 (104) and two flange nuts #8 (307).

## **Step 4**

Attach Spool Line bar #6 (ATR-SLB) using the flange nut attached to the bar. Please note that all hardware needed for the ATR-SLB is included in the poly bag.

## **Step 5**

After mounting the ATR-SLB, remove the cotter pin, washers & spring. Do not remove bottom washer. Place your spool of trimmer line (not included) on the ATR-SLB followed by one washer, compression spring, and the other flat washer. Compress the spring down onto the spool and retain it by installing the provided cotter pin through one of the five holes in the spool holder bar as shown in the parts diagram. Make sure the spring is compressed enough against the spool to prevent it from spinning freely on the spool holder.

## **Step 6**

Run the trimmer line from the spool through the trimmer line hole on the back (spool line is on left) of the Spool Mate Lite. The trimmer line can then be dispensed through that hole, cut and secured for next use.