

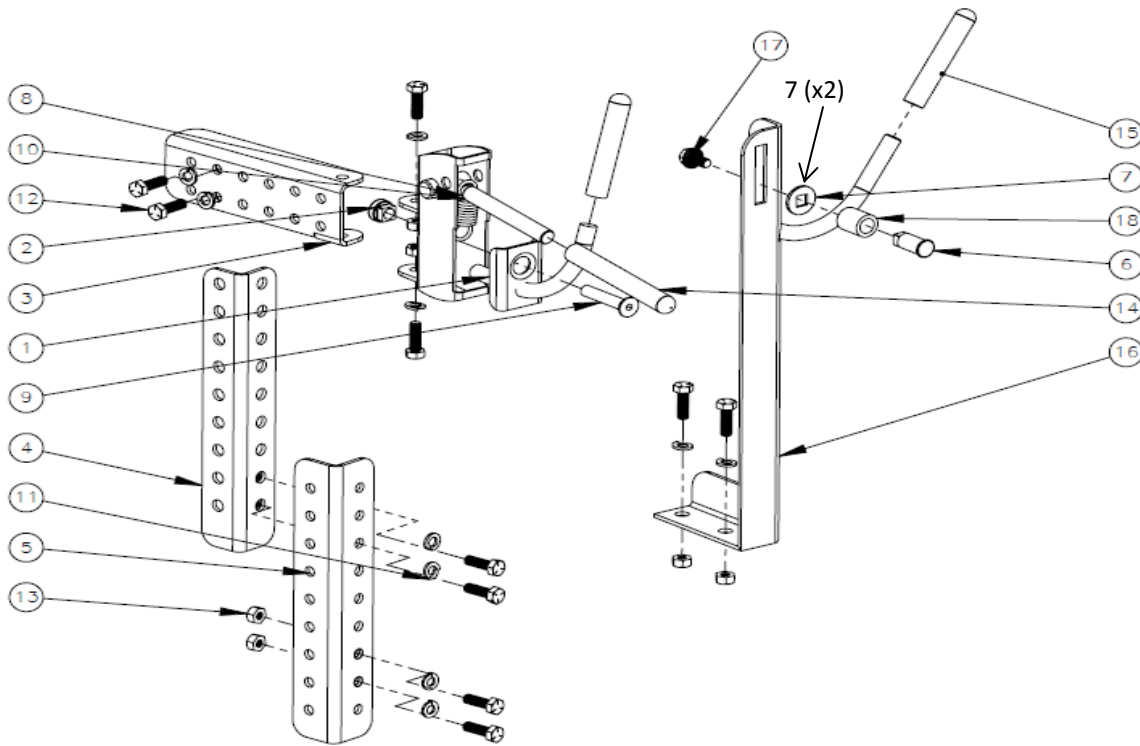

**MTR
ASSEMBLY
INSTRUCTIONS**



ITEM #	PART NUMBER	DESCRIPTION	QTY
1	ATR-TH	TRIMMER HOOK WELDMENT	1
2	ATR-LN	LOCKING NUT	1
3	MTR-HBRACE	HORIZONTAL BRACE	1
4	MTR-UPPER V	UPPER VERTICAL SUPPORT	1
5	MTR-LOWER V	LOWER VERTICAL SUPPORT	1
6	ATR-CP	COMPRESSION PIN	1
7	ATR-WASH	3/8" SQUARE WASHER	2
8	MTR-MW	LOCKING POLE ASSEMBLY	1
9	206	3/8" - 16 x 2 1/4" FLAT HEAD SOCKET SCREW	1
10	502	TRAILER MATE EXTENSION SPRING	1
11	424	5/16" SPLIT LOCK WASHER	10
12	214	5/16" - 18 x 1" HEX CAP SCREW	10
13	308	5/16 - 18 HEX FLANGE NUT	10
14	VINYL - 4.5	1/2" x 4 1/2" VINYL	1
15	VINYL - 3.75	1/2" x 3 3/4" VINYL	2
16	MTR-SSW2	SHAFT SUPPORT WELDMENT	1
17	101	5/16" - 18 x 5/8" SERRATED BOLT	1
18	711	1/2" x 1" HOSE	1

ASSEMBLY & MOUNTING INSTRUCTIONS

- 1 Attach the locking pole assembly (# 8 – MTR-MW) to the horizontal brace (# 3 – MTR-HBRACE) with two 5/16” hex cap screws (#12), two split lock washers (#11), and two hex flange nuts (#13) as shown in **Figure 1**. Leave the hardware loose until the angle is adjusted.
- 2 Attach the (#4 — upper vertical support) to the (#8 & #3 — horizontal brace assembly from step 1 using two 5/16” hex cap screws (#12), two split lock washers (#11) and two flange nuts (#13). Next attach the (#5 — lower vertical support) to the (#4) upper vertical support using two 5/16” hex cap screws (#12) , two split lock washers (#11) and two flange nuts (#13) as shown in **Figure 2**. Leave all hardware loose until angle is adjusted.
- 3 To assemble the compression pin, take the ½” hose (#18) and slide over the pin and place the two ATR-WASH (#7) on the end. Next, line up the assembled pin with the slot in the (#16 — SHAFT SUPPORT WELDMENT) and connect using the 5/8” serrated flange bolt (#17) as shown in **Figure 3**. Do not tighten the assembly until after step 6.
- 4 Next, determine the best placement on the mower. Before drilling holes, clamp the MTR in the desired position and place the trimmer into the rack to make sure trimmer is easily accessed and doesn’t interfere with any **operations of mower**. Make sure the trimmer clears the mower engine, exhaust and any moving components the mower may have.
- 5 Once satisfied with the location, mark the location of the holes in the (#5 — lower vertical support) on the mower frame and (#16 — shaft support on the deck. Drill 5/16” holes at the marked locations and attach using two 5/16” hex cap screws (#12), two split lock washers (#11) and two flange nuts (#13) for each support. Securely tighten all hardware from steps 1 & 2.
- 6 Finally, put a trimmer in the MTR and slide the compression pin assembly down in the slot until it rests on top of the trimmer shaft. Remove the trimmer and slide compression pin assembly down another 1/16” and tighten securely. The trimmer should not rotate in the rack when the compression pin is in the correct position on the trimmer.

