

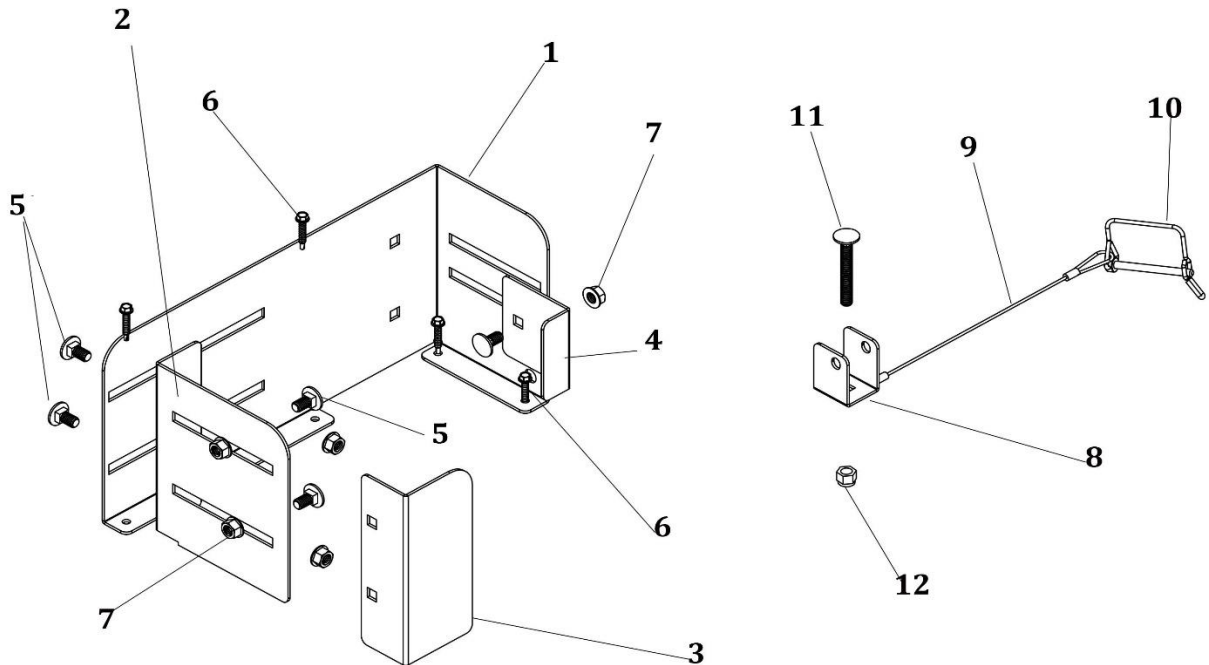

# Jungle Boot Large Instructions

REF.	PART #	DESCRIPTION	QTY
1	JB-LG-MF	Main Frame	1
2	JB-LG-GRIP	Main Grip	1
3	JB-LG-GRIP2	Adjustment Grip	1
4	JB-LG-GRIP3	Back Adjustment Grip	1
5	104	3/8"-16 x 3/4" Carriage Bolt	5
6	220	Self-Tapping Screw	4
7	307	3/8" – 16 Hex Flange Nut	5
8	JB-LG-LOCK	Lock Bracket	1
9	507	12" Lanyard	1
10	508	Easy Snap Clevis Pin	1
11	109	3/8"-16 x 2-3/4" Carriage Bolt	1
12	302	3/8" x 16 Nylon Lock Nut	1



# ASSEMBLY INSTRUCTIONS

1. Attach the three grips (#2, #3, & #4) to the main frame (#1) by using five (#5) carriage bolts and five (#7) flange nuts as shown in the diagram.
2. Determine a spot on the trailer floor you want to mount the Boot and use four (#6) self-tapping screws to attach.
3. Once secured, place the spreader in the Boot and adjust accordingly. If the spreader has a cross bar, it can be locked using the lock bracket (#8).
4. To attach the bracket, first align spreader and cross bar to determine where the lock bracket should be mounted on the trailer floor. Mark location, then drill out hole with a 3/8" drill bit. When ready to attach the (#8) lock bracket, first take (#11) carriage bolt and slip through one loop of the lanyard (#9), then put it through the lock bracket and into the pre-drilled hole on the trailer floor. Tighten using the (#12) lock nut.
5. Next, attach the (#10) snap clevis pin through the other loop end of the lanyard or a padlock (not included) to slide through the pre-existing holes on the top of the lock bracket to further secure the spreader.