



1TR ASSEMBLY INSTRUCTIONS

Parts List

#	PART#	DESCRIPTION	QTY
1	1TR-MC	1 Trimmer Rack, Locking Channel	1
2	1TR-CC	1 Trimmer Rack, Compression Channel	1
3	ATR-TH	Trimmer Hook	1
4	502	Extension Spring	1
5	206	M10*50mm Flat Head Socket Screw	1
6	VINYL 95	13mm I.D. x 95mm I.L. Vinyl	2
7	ATR-CP	Compression Pin	1
8	711	13mm x 26mm Hose	1
9	ATR-WASH	M10 Square Washer	2
10	101	M8*16 Serrated Flange Bolt	1
11	104	M10*20mm Carriage Bolt	4
12	307	M10 Hex Flange Nut	4
13	DECAL – JUNGLE	Jungle Jim's Decal	1
14	ATR-LN	M10 Locking Nut	1
15	VINYL 114	13mm I.D. x 114mm I.L. Vinyl	1

Parts

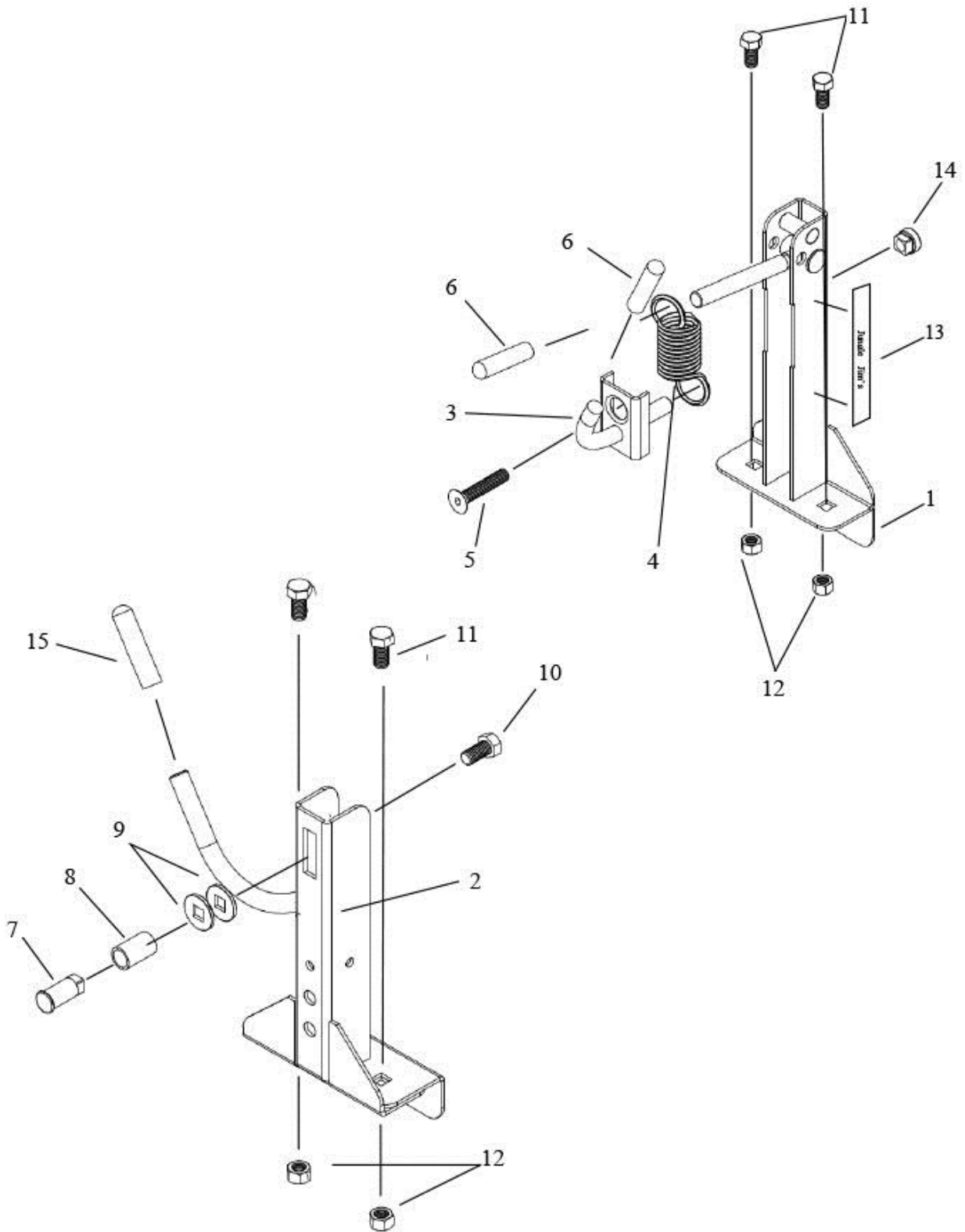

Instructions for 1 Trimmer Rack, 1TR*

*Patents Pending

Installation

TOOLS REQUIRED: Drill with a 10mm drill bit, 14mm or equivalent wrench.

1. Position the channels on the trailer to suit your space needs or requirement. The bottom figure shows a suggested mounting detail on the passenger side of the trailer. (Please note, the locking channel MUST be installed to the right of the compression pole). Once a suitable location is found, mark and drill two 10mm holes through the top of the trailer rail to mount the locking pole.
2. Mount the locking channel to the trailer with 2 (#11) M10*20mm carriage bolts and 2 (#12) M10 hex flange nuts provided as illustrated below.
3. Position the compression channel on the trailer to the left of the locking pole as shown below (we recommend the poles be approximately 40" apart, but you can space them to fit your needs). Mark and drill two 10mm holes through the top of the trailer rail to mount the compression pole.
4. Mount the compression pole to the trailer with 2 (#11) M10*20mm carriage bolts and 2 (#12) M10 hex flange nuts provided as illustrated below.

NOTE: To lock your trimmer rack, install a padlock (not included) through both holes on the locking pole.

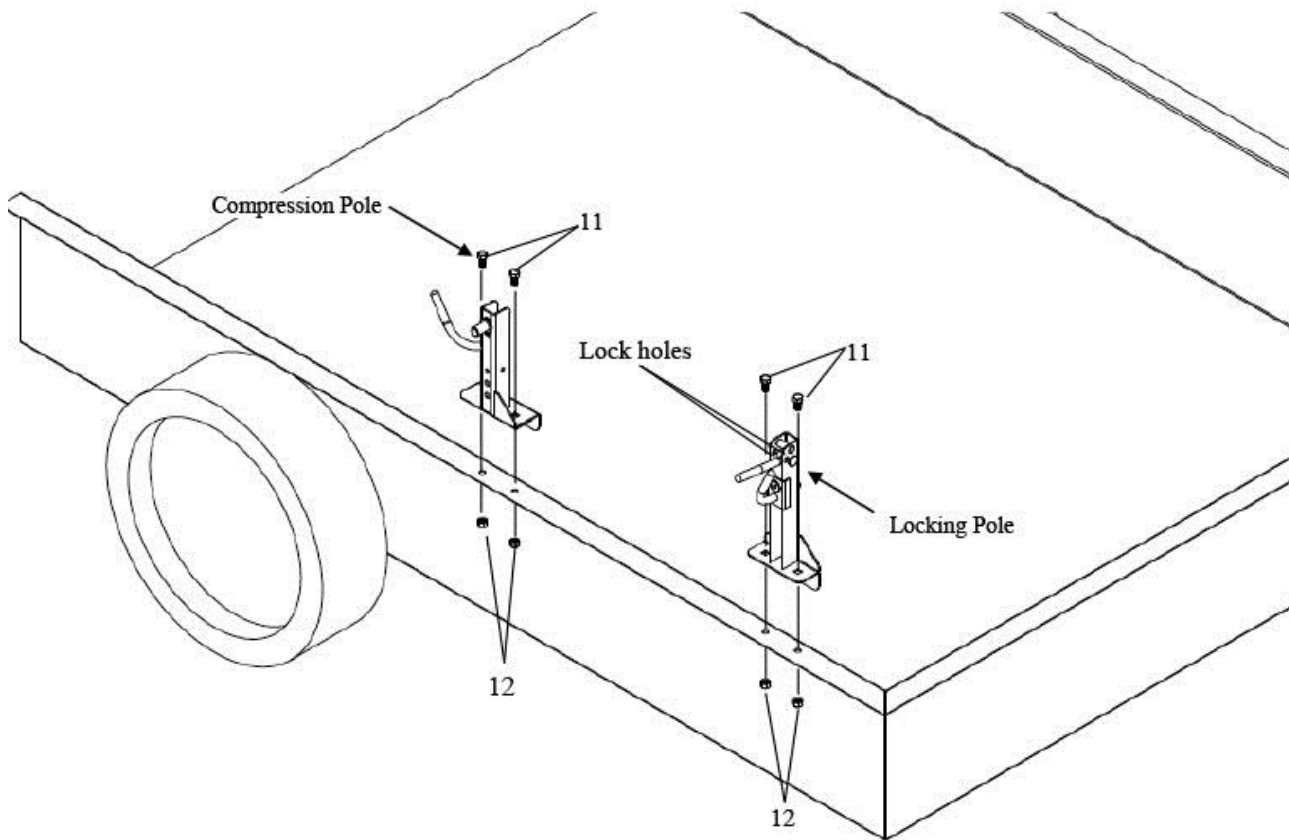

Adjustment

TOOLS REQUIRED: 13mm socket wrench with extension or 13mm deep socket.

1. Place the trimmer in the rack by putting the cutting end of the shaft into the hook on the compression pole. Lift the engine end of the trimmer up and into the hook on the locking pole. The trimmer should be positioned so that the handle is resting in the hook on the engine end. Be careful not to damage the throttle trigger when placing the trimmer onto the rack.
2. Tighten the compression pin assembly; Insert the (#7) compression pin into (#8) 26mm hose, and 2 (#9) M10 square washer and from the other side attach (#10) M8*16mm serrated flange bolt as shown in the figures below. Slide the pin down until it is touching the trimmer shaft and tighten the bolt.
3. In order for your Trimmer Rack to prevent the trimmer from rotating while in the rack, the compression pins on the compression pole must be adjusted properly. Remove the trimmer from the rack. Use a marker and make a mark on the pin an aligning mark on the pole as shown in the figure below. Make another mark on the pole 1/8" below the first one. Carefully loosen the bolt securing the compression pin and slide the pin down until the mark on the pin lines up with the lower mark on the pole. Tighten the bolt holding the pin securely.
4. Place the trimmer in the rack and test to see that the rack keeps the trimmer from rotating easily. If it does not, re-adjust the compression pin down in 1/16" increments until the rack holds the trimmer firmly.

NOTE: The black vinyl sleeves installed over the hooks and bars on your trimmer rack are to prevent your trimmer from getting scratched and worn while in the trimmer rack. These sleeves will wear over time with the use of the trimmer rack and should be replaced annually or as needed.

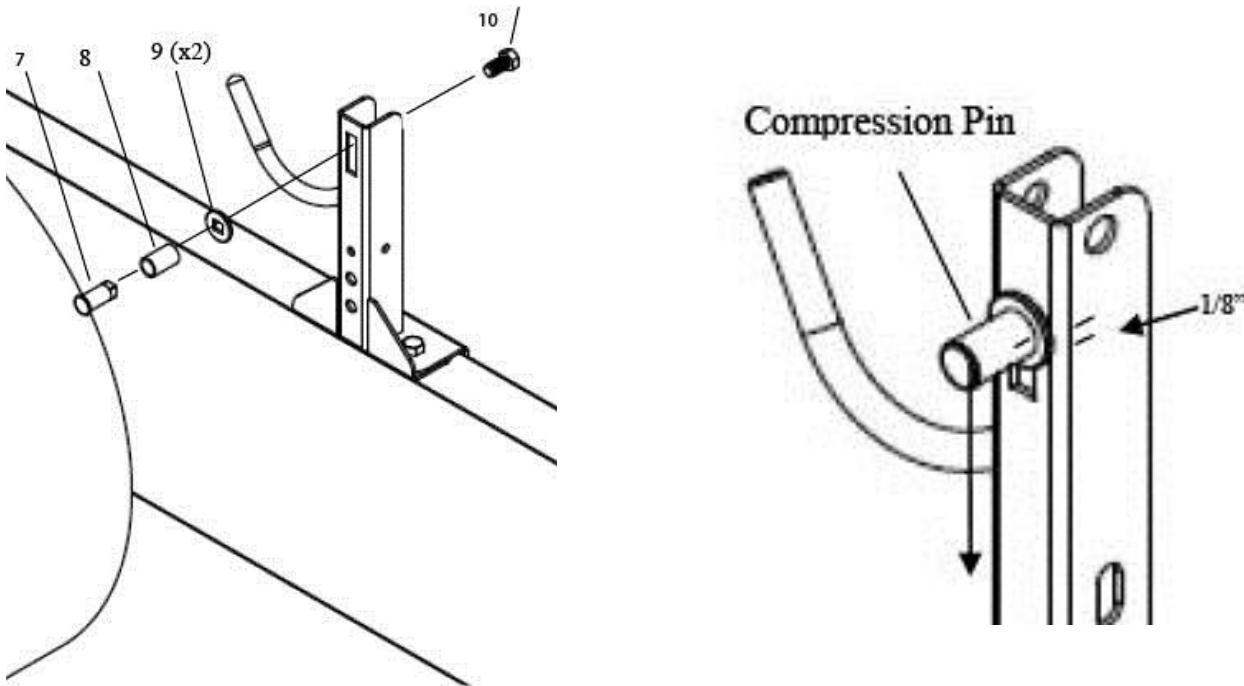

Replacement Parts

TOOLS REQUIRED: 5mm Allen wrench

Replacement parts are available for your trimmer rack, should you ever need to replace anything. Below are instructions for replacing the trimmer hook on your rack.

1. Remove the hook by unscrewing the M10*50mm flat head socket screw. If you are replacing the spring, you will need to carefully cut off the 95mm vinyl on the locking arm and slide the spring off.
2. Place a new spring on the locking arm. Be sure that the eye-holes on the ends of the spring are oriented as shown in the figure below. Slide the spring onto the locking arm so, that the eye-hole sits in the notch on the locking arm. After the spring is installed, slide a new 95 vinyl onto the locking arm.
3. Place a trimmer hook on the pole. Insert the M10*50mm flat head socket screw through the trimmer hook, through the bottom eye-hole on the spring, and into the locking nut. Be sure the bolt goes through the hole in the spring and tighten securely with a 5mm Allen wrench.

