

# **TITAN REMOTE CONTROL**

## INSTRUCTION MANUAL

*Agua*  
CANADA

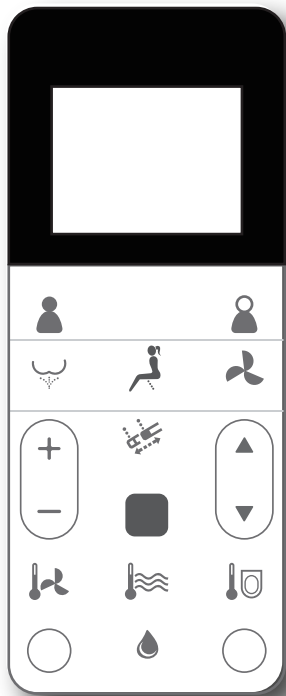

# TITAN REMOTE CONTROL

## INSTRUCTION

## MANUAL

Before using this product. Please read the following instructions carefully and keep this brochure for future reference.

# REMOTE CONTROL HANGER INSTALLATION

- 1** Drill a hole of 6mm on the wall with depth of 35mm. Make sure end-user be able to reach the remote control when sitting on the seat.

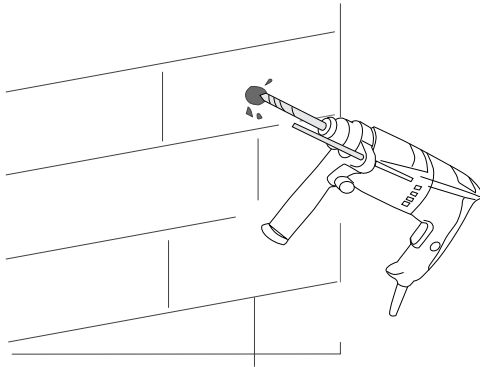

- 2** Tear the paster on back of hanger.

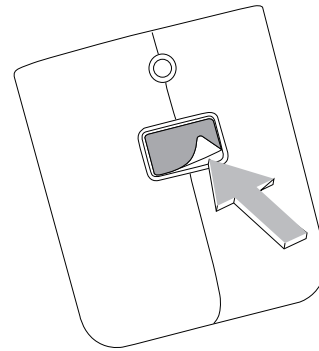

- 3** Insert expansion tube into the hole on the wall, install the hanger to the wall with a screw, and paste the double faced adhesive tape on hanger to the wall, tighten the screw.

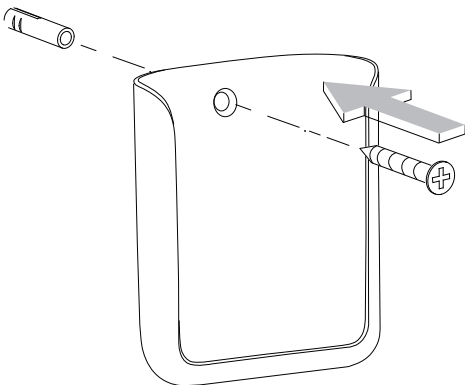

- 4** Install battery and place remote control to the hanger.

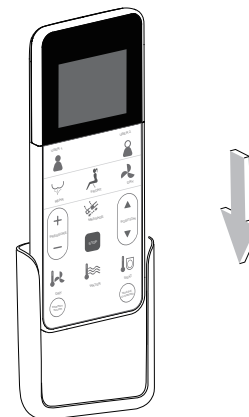

**Notice:** Please do not install and use the product in moist place, such as steam room, and prohibit to place in the space where is easily got wet.

# FUNCTION BUTTONS

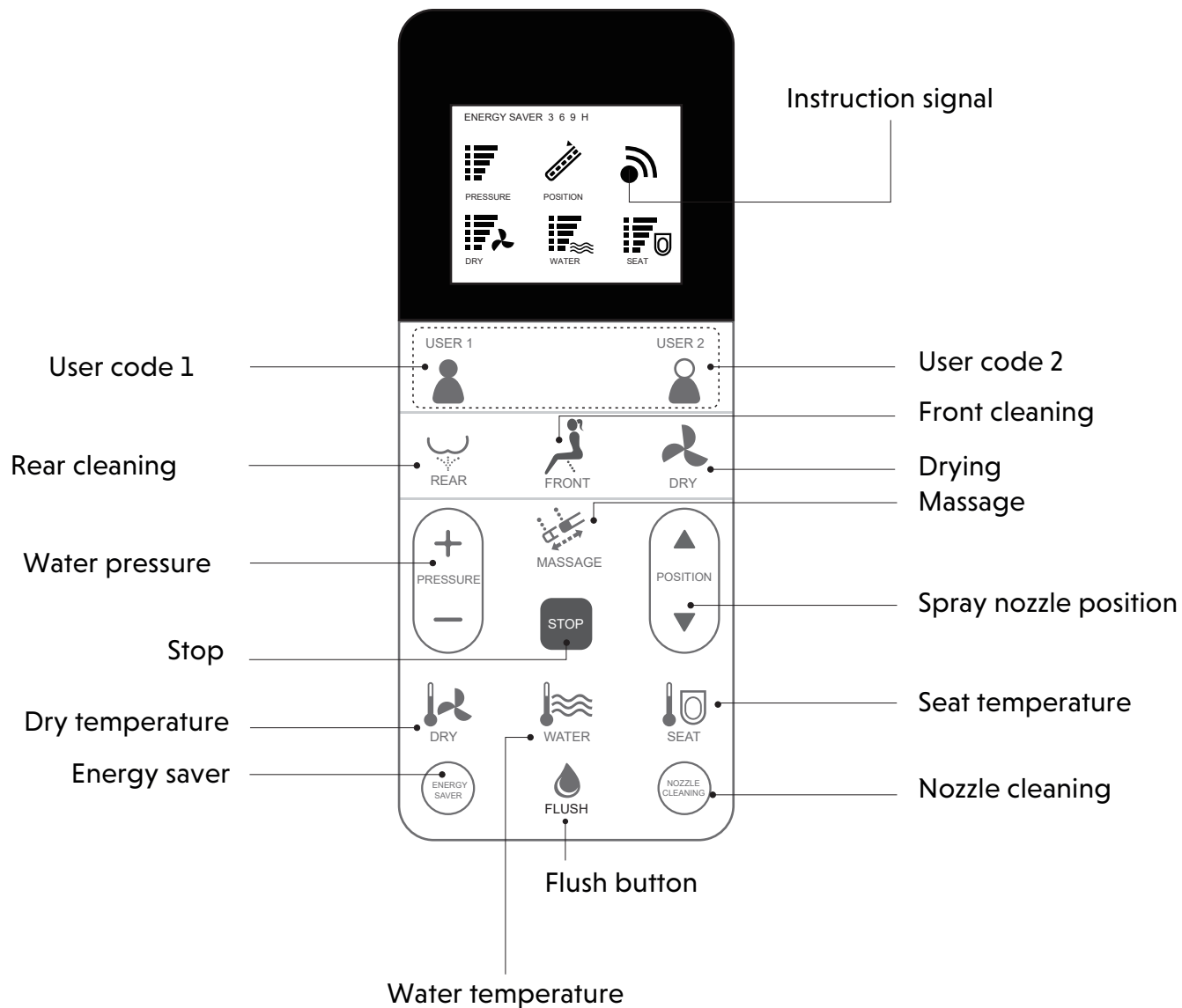

# FUNCTIONS AND ADJUSTMENTS

## Rear/Front cleaning

Press "REAR"/"FRONT" button, the water comes out of wand to clean the rear/front portion of the body. It automatically stops after a cycle of cleaning. If you press "STOP" button when using, the function will stop immediately.

## Drying Operation

Press "DRY" button, warm wind comes out of wand to dry. After a cycle or user leaves the seat, it automatically stops.

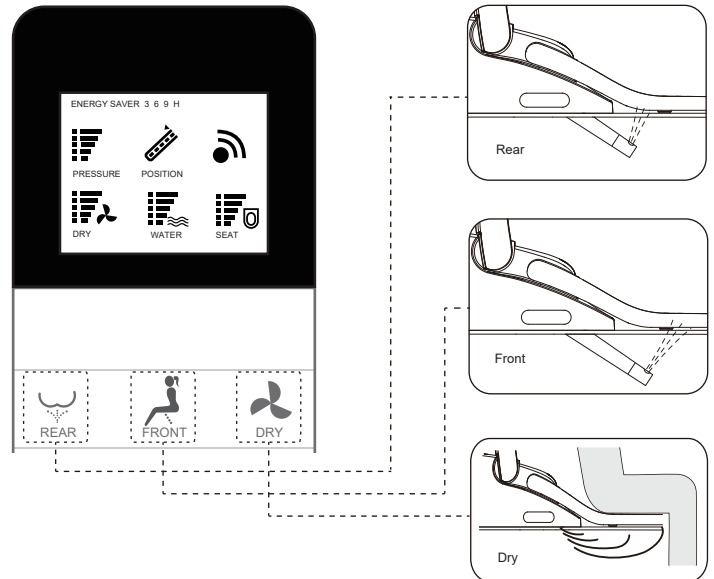

## Massage

Press "MASSAGE" button to activate massage function, the nozzle moves forward and back to extend the cleaning scope; Press "MASSAGE" button again to stop the function.

## Spray nozzle position adjustment

During "REAR" or "FRONT", press spray nozzle button of "◀" and "▶", to move the position forward and backward by adjusting 5 levels.

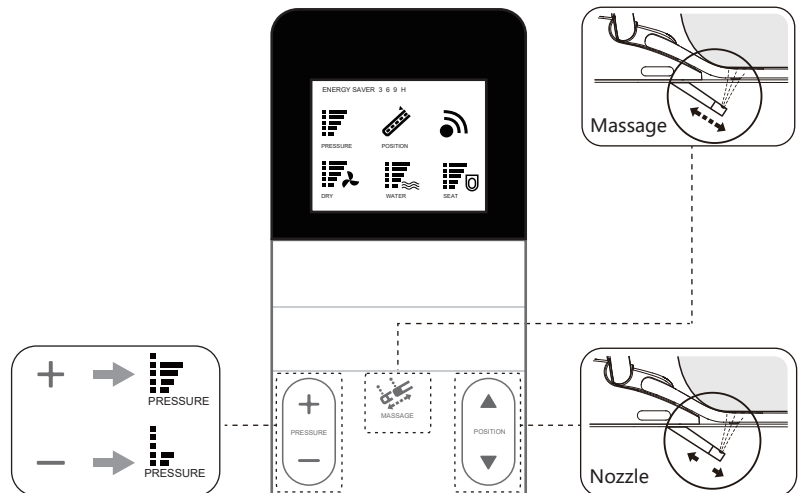

## Water pressure adjustment

During "REAR" or "FRONT", press water pressure button of "+" and "-", to adjust pressure for rear and front cleaning.

# TEMPERATURE ADJUSTMENT

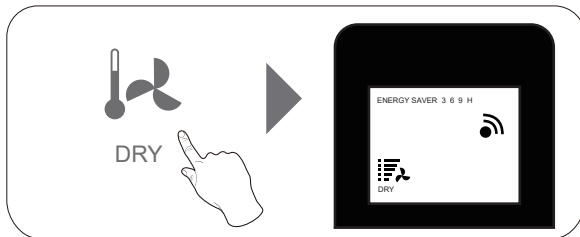
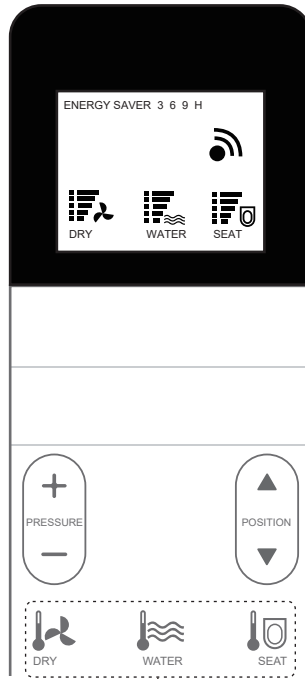

## Dry temperature adjustment:

Press "DRY" button to adjust temperature for drying. The LCD display of 1 to 5 lines means level 1 to 5. NO display means normal temperature. To adjust level by up and down cycle.

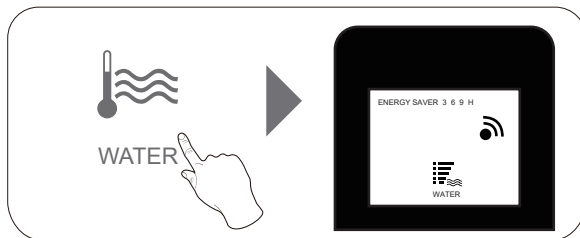

## Water temperature adjustment:

Press "WATER" button to adjust temperature for rear and front cleaning. The LCD display of 1 to 5 lines means level 1 to 5. NO display means normal temperature. To adjust level by up and down cycle.

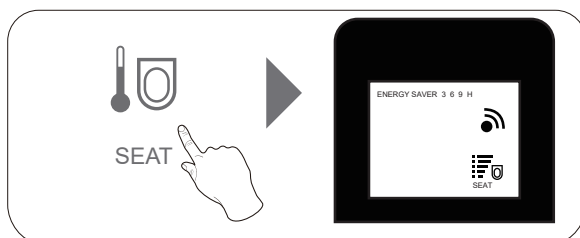

## Seat temperature adjustment:

Press "SEAT" button to adjust temperature of seat. The LCD display of 1 to 5 lines means level 1 to 5. NO display means normal temperature. To adjust level by up and down cycle.

# ENERGY SAVING

## Setting energy saver time

Press "ENERGY SAVER" button, LCD screen shows energy saver and figures. It shows three options of energy saver period as 3-6-9-off, which can be selected accordingly. For example, user can set from 9:00 to 15:00 as energy saver according to following operation.

**1** Press "ENERGY SAVER" button, LCD screen shows "ENERGY SAVER" icon.

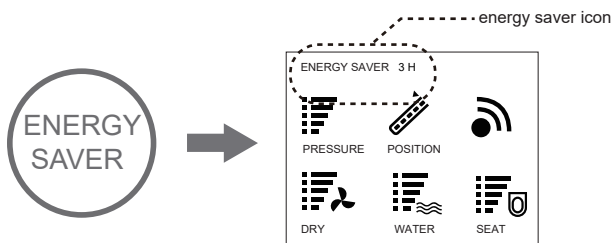

**2** Press "ENERGY SAVER" button again, LCD screen shows figure "6", and the "ENERGY SAVER" icon disappear after 3 seconds, the setting succeeds. The toilet enters the energy saver mode from 9:00 to 15:00 every day. During this period, power light is off, and the energy saver light is on. It goes back to normal operation mode after energy saver time.

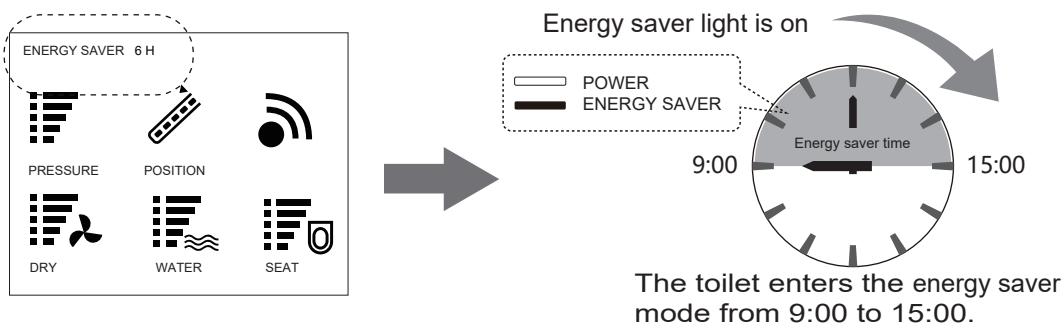

**3** Cancel energy saver set: Press "ENERGY SAVER" button continuously until this function is cancelled. (Nothing display on the screen.) The toilet will be under energy saver mode automatically after setting. Under energy saver mode, seat temperature is on low temperature status (first level) to achieve energy saver.

### Remark :

If the user sits on the seat, the energy saver mode is paused, and enters into the function mode, the seat starts to heat immediately (under opening seat temperature circumstances). The energy saver mode restores after user leaves. When the energy saver mode is set, the icon disappears automatically, which is a normal set.

# NOZZLE CLEANING AND UDER SETTINGS

## Nozzle cleaning

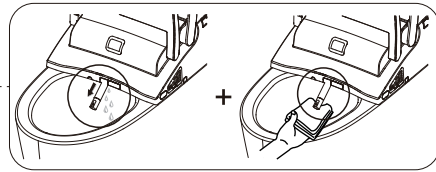

### Nozzle self-cleaning by quick press:

Quick press "NOZZLE CLEANING" button, the nozzle self-cleans for a while and move to the front position (no spray). People can continue to clean nozzle manually.

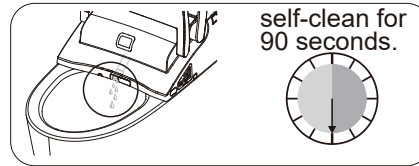

### Nozzle self-cleaning by long press:

Long press "NOZZLE CLEANING" button, the spray won't move forward and nozzle self-cleans for 90 seconds.

## User settings

Long press "USER 1" or "USER 2" button to save the parameters, including current pressure, nozzle position, dry temperature, water temperature, seat temperature and massage status. Quick press "USER 1" or "USER 2" button to use saved parameter.

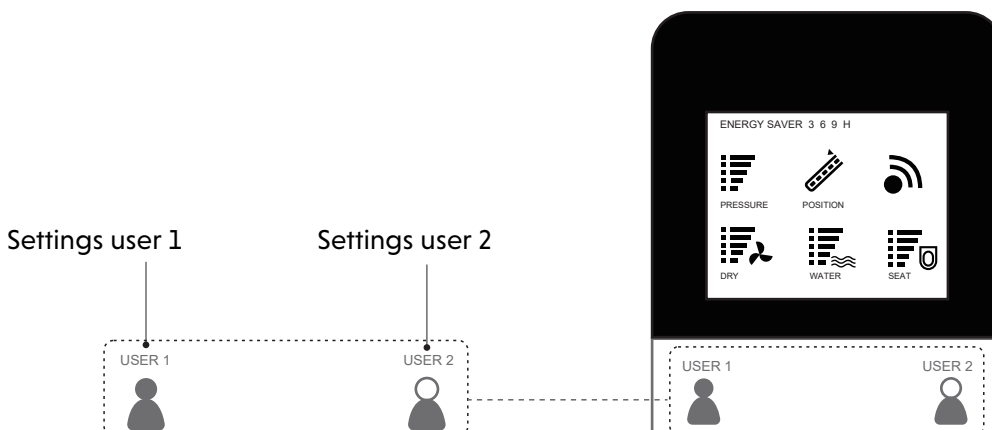



# SETTINGS SPECIFICATIONS

## Night light

Press "STOP" button, then "DRY" button, night light will often be in the off state; Repeat the process, night light will switch to intelligent state. Repeat above process constantly, the night light will switch between off state and intelligent state.

## Quiet mode

Press "STOP" button and then "MASSAGE" button to turn off the buzzer to avoid noise in the night; Repeat the process to start buzzer function.

## User code

The user code needs to be set to avoid disturbance from remote controls when more than one toilets are used in the house. Turn on the toilet for setting while turn off others. (1) Press "STOP" button and then "REAR" button to enter into user code setting. The remote control shows only water pressure and spray position level, and characters are blinking on the screen. (2) Press water pressure buttons of "+" and "-", to choose user code 1-9. (3) Press "STOP" button and then "REAR" button again, remote control will save the setting and exit user code setting windows, the buzzer will ring "click" to indicate successful setting. The sum of water pressure and position level on LCD is the user code. Restart to clear the user code and re-set.

## Remark:

In case of power cut during wand's spray operation, the wand cannot go back to place, please wait until the power is reset. In case of a power cut for a long period, please push the wand softly back by hand. Do not push hard, to avoid damage to wand and electrical machine.