

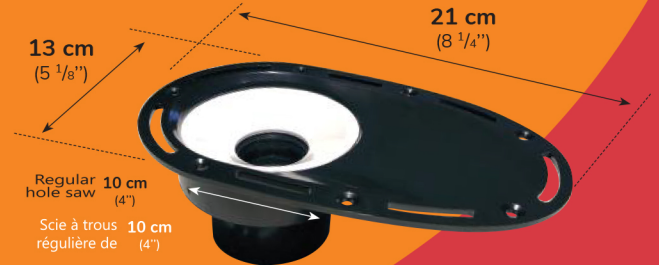

Connecteur rapide de drain pour bain autoportant

Quick drain connector for free standing bathtub



Caractéristiques

- Facilite l'assemblage et la jonction entre le drain et le renvoi
- Réduit le temps d'installation
- Idéal pour installation étroite ou difficile d'accès
- Facilite l'accès pour les réparations

Features

- A fast and easy way to install a freestanding tub drain
- Less time installation
- Ideal for tight space with minimum access
- Easy access for repairs

QUICK DRAIN CONNECTOR



INSTALLATION GUIDE



1 Drill a 4 in. hole into the wood floor.



2 Measure and cut a ABS or PVC piece as needed to ensure a secure connection with the P-trap below. Note that the drain body has an outlet of 2 in. (a coupling reducer of 1 1/2 in. is included).



3 Connect the drain to the P-trap. Glue coupling reducer (if necessary) to the drain body first, then to the P-trap. Apply glue to both ends for a safe installation.



4 Secure the drain body to the wood floor using screws or cement. *Temporarily insert the plug to prevent residue from entering the drain.



5 Do not obstruct the hole of the drain body. Be sure to leave enough space around the drain body.



6 Install the piece to the tub's waste and overflow. Ensure the measurement between the base of the drain and P-trap will fit the tail piece.



7 Remove the plug. For easier insertion, apply lubricant to the tailpiece. Be sure to position the bathtub and tail piece in line with the drain body.

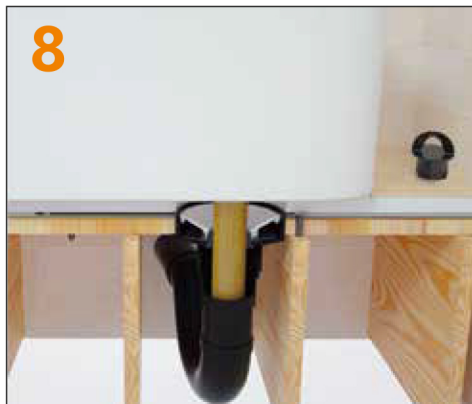

8 Carefully insert the bathtub tailpiece into the drain body until the bathtub is in place.

PRESSURE TEST PLUG



* If you wish to make a pressure test to check the watertightness of the joints it is necessary to use the plug provided for this purpose.