

UNIVERSAL XL LIFTER

BY GARAGESMART



Installation and User Guide

Garage Smart support - support.garagesmart.com

Contents

Limited Lifetime Warranty	3
Safety Information.....	5
FCC Statement	6
About the Universal XL Lifter	7
Parts Identifier	7
Installation Overview.....	8
Installing the Universal XL Lifter.....	8
Using the MyLifter App	16

Limited Lifetime Warranty

Garage Smart offers a Limited Lifetime Warranty on all products. If a defect in the hardware, or any component thereof, occurs Garage Smart will repair or replace the system, or the defective component. There is no cost to you beyond the cost of shipping the defective item to us. If your Garage Smart Product is defective, we will send replacement parts or, at our option, replace it at no charge to you after the defective product is returned to Garage Smart. If we send replacement parts for your Garage Smart Product, we may use new or reconditioned parts. If we choose to replace your Garage Smart Product, we may replace it with a new or reconditioned one of the same or similar design.

Who Makes This Warranty?

Garage Smart

Who Is Covered?

This warranty extends only to the original purchaser of the product. This warranty is intended for natural persons only and does not extend to any corporation, limited liability company, or commercial entity.

What Is Covered?

Any defect in material and workmanship from personal, normal household use in accordance with the Owner's Manual.

Warranty Does Not Cover: This warranty does not cover installation commercial use, defects resulting from accidents, damage while in transit to our service location or damage resulting from altercations misuses or abuse, lack of proper maintenance, unauthorized repair or modifications of the product, affixing of any attachment not provided with the product, staples through wiring, pinched or broken wires, broken cables power outages, use of extension cords, missing or damaged parts or discounted clearance, final sale or taped cartons, fire, flood, acts of God, or failure to follow the Owner's Manual. This warranty is the only one we will give on your Garage Smart Product. There are no other express warranties.

Where and How to Obtain Warranty Service

You can obtain warranty service from Garage Smart at the address indicated below. It is your responsibility to deliver or ship the defective product to us at your date of purchase and a description of the claimed defect, prior to the expiration of the warranty period. To obtain information regarding this warranty, you may contact us by mail, email, or phone.

Garage Smart
3000 Sierra Vista Way
Provo, UT 84606

Support@GarageSmart.com or (801) 649-4136

Exceptions and Exclusions

This warranty does not include damage or defects resulting from misuse, accident, failure to maintain, or any other causes following your purchase of the product. Use of the Lifter system with any other system or components (including affixing non Garage Smart attachments or accessories) voids this warranty. Failure to follow the owner's manual in installation or use of the Lifter system voids the warranty. Unauthorized repair or modification voids the warranty.

The Lifter system is intended for personal, indoor, home use. Garage Smart does not warrant its lift system for commercial use, and any such use voids the warranty.

TO THE GREATEST EXTENT PERMITTED BY LAW, THIS WARRANTY IS IN LIEU OF AND EXCLUDES ALL OTHER WARRANTIES NOT EXPRESSLY SET FORTH HEREIN, WHETHER EXPRESS OR IMPLIED, INCLUDING BUT NOT LIMITED TO ANY WARRANTIES OF MERCHANTABILITY AND FITNESS FOR A PARTICULAR PURPOSE. Limitation of Liability: THE SOLE REMEDIES AFFORDED UNDER THIS WARRANTY ARE REPAIR, REPLACEMENT, OR, IF REPAIR OR REPLACEMENT IS NOT COMMERCIALY PRACTICABLE OR CANNOT BE TIMELY MADE, A REFUND OF THE PURCHASE PRICE. IN NO EVENT SHALL THE LIABILITY OF GARAGE SMART RELATED TO ANY PRODUCT EXCEED THE PURCHASE PRICE OF THE PRODUCT. YOUR USE OF GARAGE SMART PRODUCTS IS AT YOUR SOLE RISK. GARAGE SMART SHALL NOT BE LIABLE UNDER ANY CIRCUMSTANCES FOR CONSEQUENTIAL, INDIRECT, SPECIAL, OR INCIDENTAL DAMAGES ARISING FROM OR IN CONNECTION WITH THE USE OF ANY GARAGE SMART PRODUCT. (SOME STATES DO NOT ALLOW THE EXCLUSION OR LIMITATION OF INCIDENTAL OR CONSEQUENTIAL DAMAGES, SO THE ABOVE LIMITATION OR EXCLUSION MAY NOT APPLY TO YOU.)

Other Legal Rights

This warranty gives you specific legal rights and you may also have other rights which vary from state to state.

Safety Information

SAFETY INFORMATION

- Read and follow all safety, installation, and operation instructions.
- Do not operate the Universal XL Lifter while hands or other body parts are near the system.
- Do not stand under the Universal XL Lifter or items lifted by the system.
- Do not use the Universal XL Lifter to lift people or animals.
- Do not use the Universal XL Lifter to lift or lower items when people or animals are under the system.
- Always balance the load before attempting to lift it.
- Total lifting capacity for the Universal XL Lifter—including the weight of the adjustable lifting frame—is 100 pounds.

If your MyLifter cable is tangled, damaged, or bent, stop using your MyLifter unit immediately.

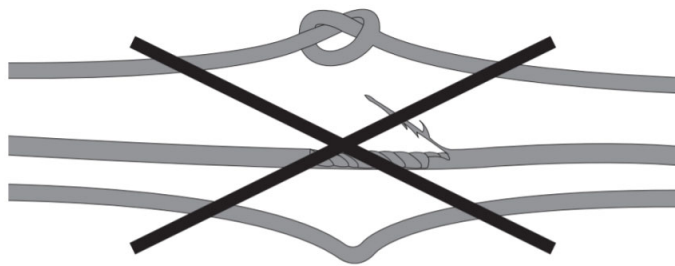

WARNING

DO NOT install Garage Smart products in any other manner than specified in the instructions. To avoid risk of electric shock and other potential injury, DO NOT open the product casing. This product is for indoor use only. Failure to follow these safety instructions could result in property damage, serious personal injury, or death.

FCC Statement

This device complies with Part 15 of the FCC Rules. Operation is subject to the following two conditions:

1. This device may not cause harmful interference, and
2. This device must accept any interference received, including interference that may cause undesired operation.

Warning: Changes or modifications not expressly approved by the party responsible for compliance could void the user's authority to operate the equipment.

NOTE: This equipment has been tested and found to comply with the limits for a Class B digital device, pursuant to Part 15 of the FCC Rules. These limits are designed to provide reasonable protection against harmful interference in a residential installation. This equipment generates uses and can radiate radio frequency energy and, if not installed and used in accordance with the instructions, may cause harmful interference to radio communications. However, there is no guarantee that interference will not occur in a particular installation. If this equipment does cause harmful interference to radio or television reception, which can be determined by turning the equipment off and on, the user is encouraged to try to correct the interference by one or more of the following measures:

- Reorient or relocate the receiving antenna.
- Increase the separation between the equipment and receiver.
- Connect the equipment into an outlet on a circuit different from that to which the receiver is connected.
- Consult the dealer or an experienced radio/TV technician for help.

RF WARNING STATEMENT: The device has been evaluated to meet general RF exposure requirement. The device can be used in portable exposure condition without restriction.

RF Warning Statement

The device has been evaluated to meet general RF exposure requirement. The device can be used in portable exposure condition without restriction

About the Universal XL Lifter

The Universal XL kit is designed to let you adjust the pulley width to accommodate large items, such as kayaks and cargo carriers, with the lifting straps spread wide to more easily stabilize your items. With the Universal XL Lifter, you can lift objects weighing under 100 pounds that can be balanced with two strap points.

Using a Bluetooth® connection, you can easily lift and lower your objects using your Android™ or iOS Device—giving you a smarter storage solution for your items.

Parts Identifier

Before you begin, check the contents of your package against the parts identifier below. If you are missing any of these parts, do not attempt to install the product and contact GarageSmart for a replacement.

Parts Identifier - Universal XL Lifter

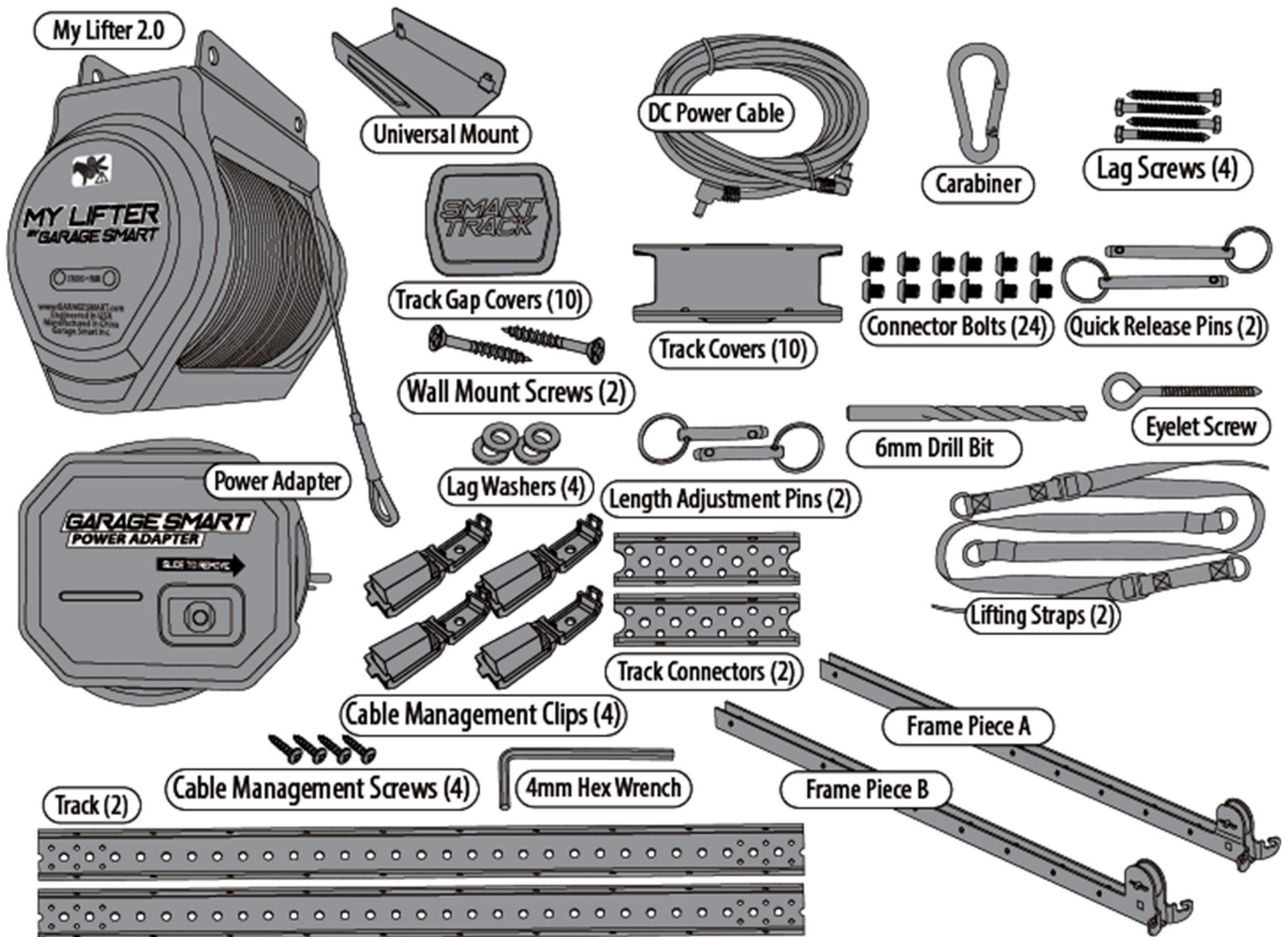

Installation Overview

The Universal XL kit can lift a total of 100 pounds, which includes the weight of the adjustable frame pieces. Before you lift an item, make sure that its weight combined with the weight of the frame pieces does not exceed 100 pounds.

Installing the Universal XL Lifter

To install the Universal XL Lifter, you will need the following tools:

- Ladder
- Stud Finder
- Pencil
- Tape Measure
- Drill
- 1/2" Socket
- Wrench or Box Wrench
- Phillips Screwdriver
- Safety Glasses

Part 1: Determine where to install the Universal XL kit

To begin you want to make sure that the object you want to lift is not too big for the space where you want to lift it.

1. Place the item on the garage floor in the area where you want it to be lifted and stored.
2. Make sure there is enough space between the item and the walls so that it won't bump into walls or shelves as it is lifted.
3. Slide Frame Piece A into Frame Piece B to make one adjustable, Universal XL frame.

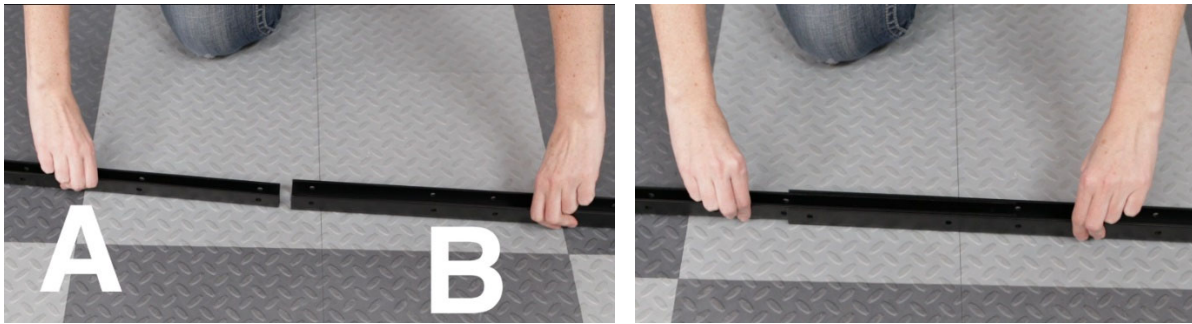

4. Insert the Quick Release pins through the holes in the Universal XL frame to secure it in place. You can remove these pins and adjust the width of the frame to suit your needs.



5. While the item is on the floor, take the Adjustable Lifting Straps and loop them around or through the item at each end.



6. Take the D Rings from the adjustable straps and attach one to the hooks at both ends of the Universal XL frame so each strap supports one side of the item.



7. Tighten the straps and lift the frame up so the straps are taut but not too tight. You want to make sure that the frame is mostly level after the straps have been tightened.
8. Measure the distance from the two closest walls to the back of the Universal XL Frame.

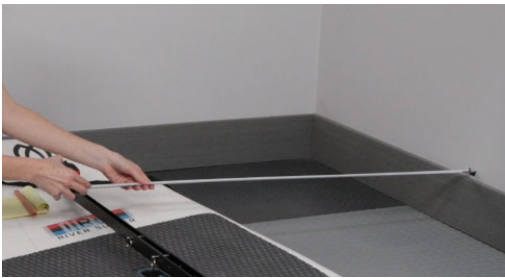

9. Use these same measurements to mark your starting point on the garage ceiling.



The starting point will be used later as a guide for installing the Smart Track and the MyLifter unit on the garage ceiling.

Part 2: Install the Smart Track

The orientation of the Universal XL Frame and the item you want to lift determine how you will need to install the Smart Track.

If your joists run parallel to the item and the Universal XL Frame, you will need to install the Smart Track along the joist that is nearest to your starting point as shown below.

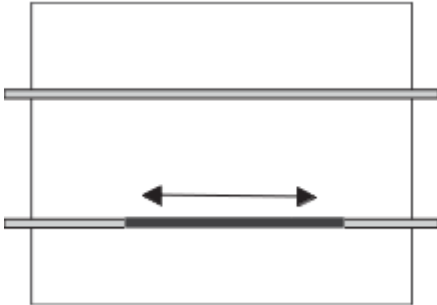

If the joists run perpendicular to the frame and the item to be lifted, you will need to install the Smart Track across the joists, as shown below.

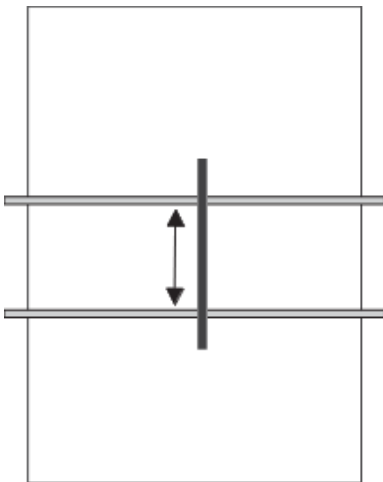

WARNING

DO NOT install the Smart Track in any manner other than what is specified in this user guide. The Smart Track is designed to be secured to flat garage ceilings. DO NOT attempt to mount the Smart Track to walls or angled ceilings. Failure to follow these instructions could result in property damage, serious injury, or death.

1. Use a stud finder to find the joist that is nearest to your starting point.
2. After you have found the nearest joist, use the stud finder to find and mark the center of it.
 - a. Mark the left edge of the joist.
 - b. Mark the right edge of the joist.
 - c. Draw an X to mark the center of the joist.

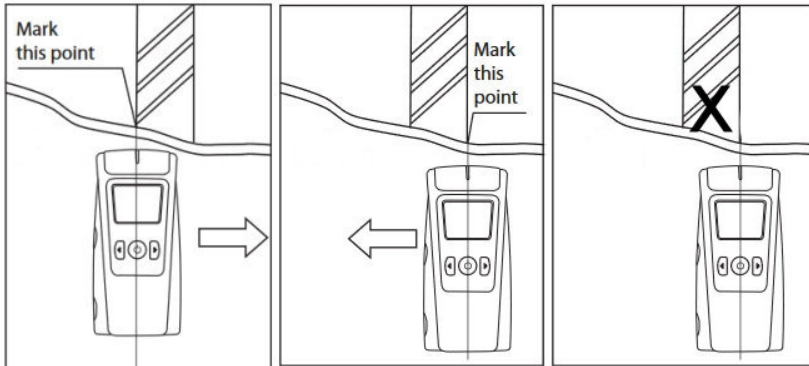

This is called the stud center method, which ensures that you will drill into the strongest part of the joist, making your lifter kit that much more secure. Make sure that the center mark you make is the same distance from the wall as your starting point mark.

3. Using the included 6mm drill bit, drill a vertical pilot hole at least three inches into the center point mark you made.

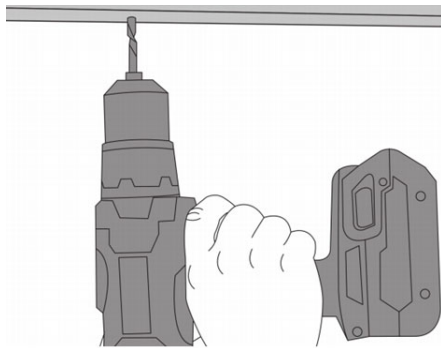

4. (Conditional) If you are extending your Smart Track, use the included Track Connector, Allen wrench, and screws to connect your two Smart Track sections.

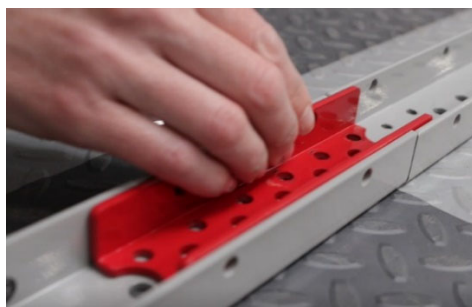

5. Hold the Smart Track in place over the pilot hole you drilled and screw in one of the included lag screws and washers. Do not screw it in all the way so you can still move the other end of the track.

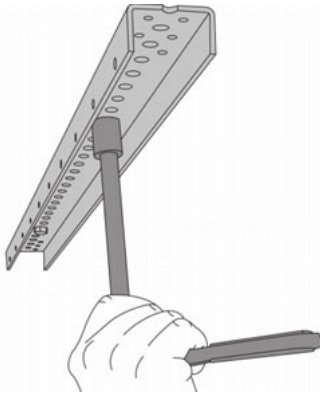

6. Use the stud center method to find the center of the joist where you will secure the other end of the Smart Track.
7. Using the Smart Track as your guide, drill a pilot hole on the opposite side at least three inches into the center of the joist.
8. Use a wrench to screw in a lag screw and washer into the pilot hole you just drilled. Be sure to tighten both lag screws so the Smart Track is flush and secure against the ceiling.

NOTE

Whenever possible, use two lags screws in each section of Smart Track to ensure a secure installation.

WARNING

Failure to mount the Smart Track and the Universal XL Lifter to secure ceiling joists or rafters could result in property damage, serious personal injury, or death.

Part 3: Installing the MyLifter unit

1. Align the holes in the MyLifter bracket with the holes on the Smart Track with the cable approximately aligned with the starting point and with one end of the Universal XL Frame.
2. Insert the included spring pins all the way through the holes in the MyLifter bracket and the Smart Track.



3. Hook the carabiner into a hole on the Smart Track.
 - a. Place the carabiner on the opposite end of the track from the lifter.
 - b. Make sure the carabiner is hooked into a hole that is on the same side of the track as the cable coming off the lifter, and on the same side as the DC cable.
 - c. Make sure that the carabiner is approximately aligned with the opposite end of the Universal XL Frame.

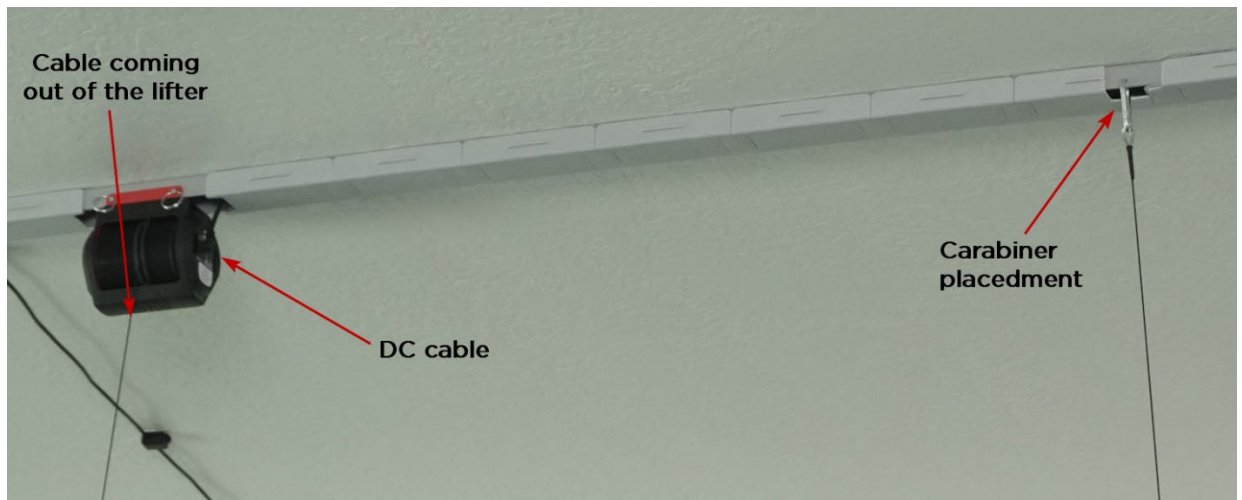

CAUTION

It is very important that you place the lifter and the carabiner so that the cable is as vertical as possible when the item is lifted. Excessively angled or crossed cables could result in damage to the MyLifter motor and to your property and could cause personal injury.

4. Plug in one end of the DC Power Cable into the Garage Smart Power Adapter.

5. Install the power adapter anywhere on the Smart Track. The universal mount attached to the bottom of the power adapter lets you easily slide and snap it into place on the track.

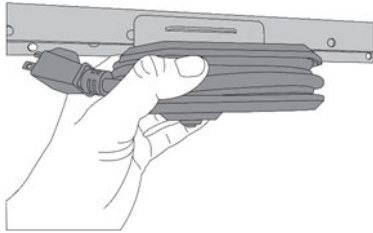

6. Plug the other end of the DC Power Cable into the MyLifter unit.
7. Plug the power adapter into the nearest outlet.
8. Secure and organize the cables.
 - a. Peel off the adhesive backing from a cable management clip and stick it where you want.

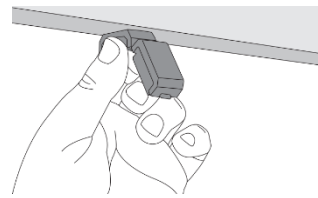
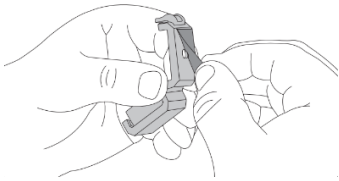

- b. Secure the cable management clip with a screw, place all wires into the clip, and securely close the clip.

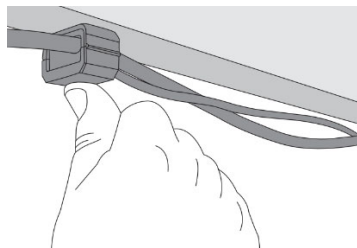
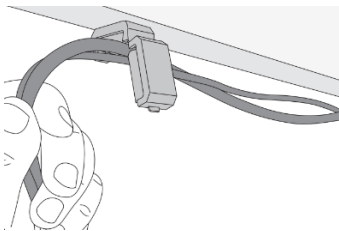

- c. You can also organize cables by winding the excess cable around the power adapter housing. Excess cable can also be stowed in the Smart Track

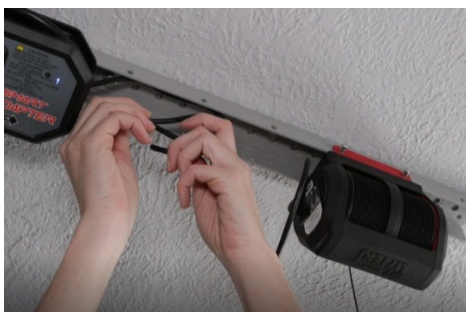

- d. Use the track covers to support and organize the cables stowed in the Smart Track.

Using the MyLifter App

The MyLifter app is paired with your MyLifter unit using a Bluetooth® connection. Be sure to enable your mobile device's Bluetooth capabilities before attempting to pair with your lifter.

1. Download the MyLifter app from the App Store or Google Play.
2. Open the app and tap **Add Devices** in the bottom right corner to open the **Available Lifters** screen.

This screen displays a list of all lifters within range of your Bluetooth communications. If you do not see any available lifters, make sure you have plugged in the power cable to the nearest outlet.

On the MyLifter unit, you should see a slow blinking yellow **Status** light.

3. Firmly press the **Pair** button next to the **Status** light.

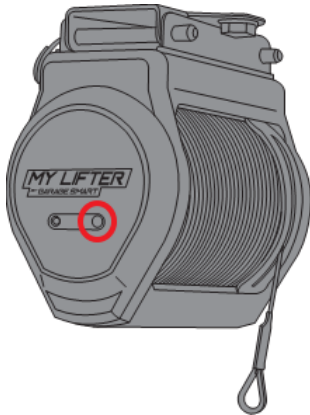

When the **Status** light blinks green, the lifter is paired with your app.

On the **Available Lifters** screen, your newly paired lifter displays with its MAC address (media access control address) as its default name.

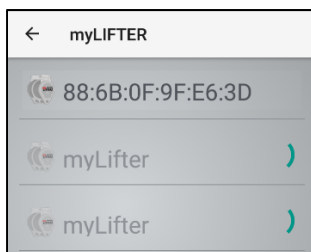

4. Tap **←** in the upper left-hand corner to go to the **Home** screen.

5. On the home screen, tap **Edit** in the upper right-hand corner of the screen.

The button name changes from **Edit** to **Exit** and the app enters Edit Mode. In Edit Mode you can rename the lifter or delete it if you need to.

6. Tap the pencil icon to rename the MyLifter unit.

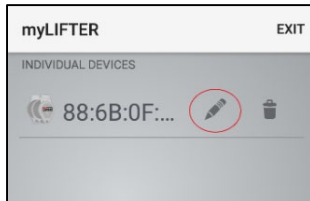

7. Type a name for the lifter and then tap **OK**.

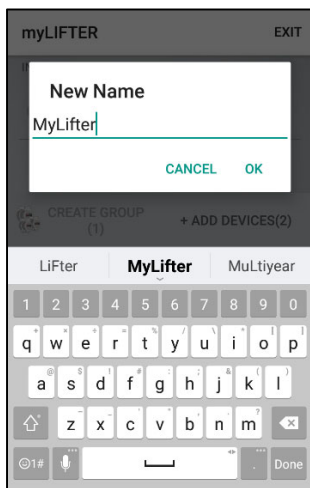

8. Tap **Exit** in the upper right-hand corner to close the Edit Mode.
9. Tap the name of your lifter to open the **Device Control** screen.

The following graphic gives you an overview of the **Device Control** screen interface with brief descriptions of its features.

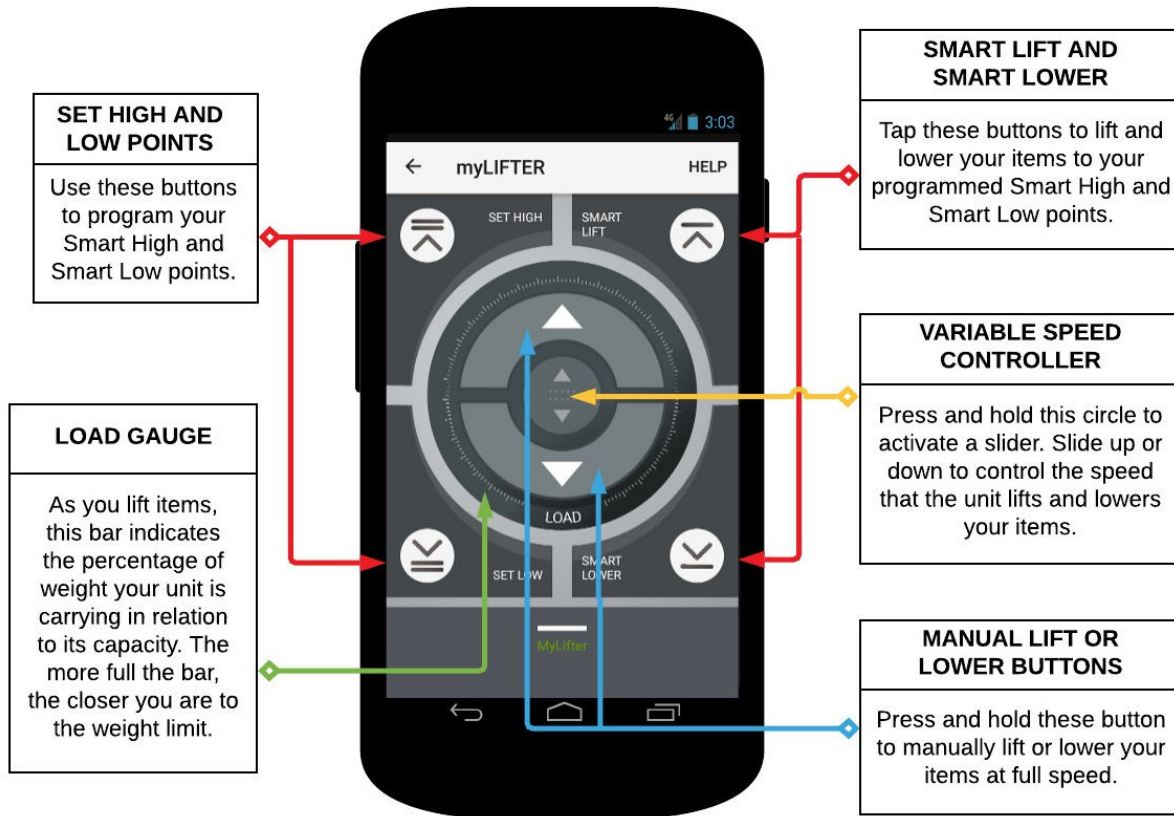

10. On the **Device Control** screen, press and hold the **Manual Lower** arrow to let out the cable enough so you can:
 - a. Run the cable under the pulleys at each end of the Universal XL Frame.
 - b. Connect the looped end of the lifter cable to the carabiner on the Smart Track.

CAUTION
<p>Make sure the cable is as vertical as possible from the lifter to the first pulley and from the second pulley to the carabiner. Improperly aligned cables could result in damage to the MyLifter motor and to your property and could cause personal injury. Move the carabiner to other holes if necessary to achieve the proper alignment.</p>

11. Use the **Manual Lift** and **Manual Lower** arrows to adjust the cable until it is taut, but still has not lifted the item off the floor.
12. With the item on the floor, tap the **Set Low** button ().

A dialog box opens asking if you are sure that you want to set the current cable position to the smart low point.

13. Tap **Set** to set the smart low point.

14. Press the **Manual Lift** arrow to lift the item a few inches off the floor. Make sure that the lifting straps are secure and that the item is level.
15. Make strap and frame adjustments as needed to secure and balance the load.
16. Press and hold the **Manual Lift** arrow to lift the item to the ceiling, leaving six inches of ceiling clearance.

CAUTION



When you use the **Manual Lift Up** button, make sure you do not run the pulley frame into the MyLifter. Running the pulley frame into the lifter could cause damage to the lifter, damage personal property, or cause personal injury.

17. Tap the **Set High** button ().

A dialog box opens asking if you are sure that you want to set the current cable position to the smart high point.

18. Tap **Set** to set the smart high point.

With your smart high and smart low points set:

- One tap on the **Smart Lower** button () lowers the item to the low point you set.
- One tap on the **Smart Lift** button () lifts the item to the high point you set.