



DAUMIER

GUARANTEE BOOKLET  
OPERATING INSTRUCTIONS

# USER MANUAL



ENGLISH



# USER MANUAL

## CONTENTS

I.	DAUMIER International Warranty Terms	4
II.	DAUMIER International Warranty Descriptions	5
III.	DAUMIER Watch Operating Instructions	
	1. Quartz Watch	6
	2. Quartz Watch (Chronograph)	12
	3. Automatic Watch	16
IV.	DAUMIER Watch General Functions & Features	
	1. Sapphire Crystal Anti-Reflective Treatment	32
	2. Leather Straps	32
V.	Specific Sections and General Information	
	1. Pictograms	33
	2. Special Recommendations	34
VI.	DAUMIER Customer Service and Repair Centers	36

## I. DAUMIER International Warranty Terms

Your DAUMIER watch is warranted by DAUMIER for a period of twenty-four months from the date of purchase under the terms and conditions of this warranty. The DAUMIER international warranty covers material and manufacturing defects that may exist at the time of delivery of the purchased DAUMIER watch. The warranty only comes into effect if the warranty certificate is dated, fully and accurately completed and stamped by an official DAUMIER dealer. Specifically, DAUMIER warranty covers movement function, water proof function and non-consumable parts including crystal, hands, etc.

This manufacture's warranty does not cover the following:

1. Operating life of the battery 24 months from the purchase date.
2. Normal wear and tear ageing (for example: cover and case scratch marks; alteration of the metal plating colour; alteration of non-metallic material based straps and bracelets).
3. Damage on any part of the watch resulting from abnormal/abusive use, lack of care, negligence, accidents (including impact, percussion, extrusion, dents, surface damage, etc.), incorrect use of the watch and non-compliance to the operating instructions provided by DAUMIER.
4. The DAUMIER watch that have been handled by non-authorized persons (for example: battery replacement, service or repair) or which has been altered from the watch's original design and condition.
5. Any consequential and indirect damage resulting from the use, failure to operate, precision defects of the DAUMIER watch.

## II. DAUMIER International Warranty Descriptions

DAUMIER has the right to refuse any requests from the purchaser beyond the standard DAUMIER warranty services. This include damage claims beyond DAUMIER's warranty services. However, this does not include the mandatory statutory rights that granted the purchaser the rights against a manufacturer.

The manufacturer's warranty:

1. Is independent of any warranty that may be provided by the seller, for which the seller carries sole responsibility.
2. Does not affect the purchaser's rights against the seller nor any other mandatory statutory rights the purchaser may have against the seller.

The DAUMIER Customers Service Centre ensures the care maintenance of your DAUMIER watch. Please contact an official DAUMIER dealer or an authorized DAUMIER Service Centre (see enclosed list) should your watch needs servicing. You are assured to receiving DAUMIER's professional maintenance and repair services.

### III. DAUMIER Watch Operating Instructions

#### 1. Quartz Watch

Watch Model No: DM9616

Calibration steps that apply to movement model: 762

##### A) DISPLAY

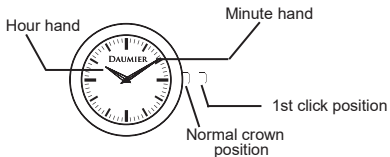

##### B) SETTING THE TIME

1. Pull the crown out to the 1st click position.
2. Turn the crown to set hour and minute hands.
3. When the crown is pushed back to the normal position.

### III. DAUMIER Watch Operating Instructions

#### 1. Quartz Watch

Watch Model No: DM9605

Calibration steps that apply to movement model: 9U13

##### A) DISPLAY

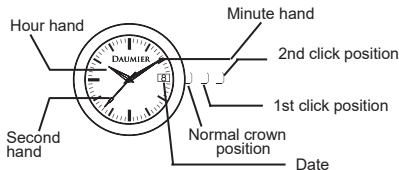

##### B) SETTING THE TIME

1. Pull the crown out to the 2nd click position.
2. Turn the crown to set hour and minute hands.
3. When the crown is pushed back to the normal position, second hand begins to run.

##### C) SETTING THE DATE

1. Pull the crown out to the 1st click position.
  2. Turn the crown counter-clockwise to set the date.
- \* If the date is set between the hours of around 9:00 PM and 1:00 AM, the date may not change the following day.
3. After the date has been set, push the crown back to the normal position.



### III. DAUMIER Watch Operating Instructions

#### 1. Quartz Watch

Watch Model No: DM9617

Calibration steps that apply to movement model: 0T45

##### A) DISPLAY

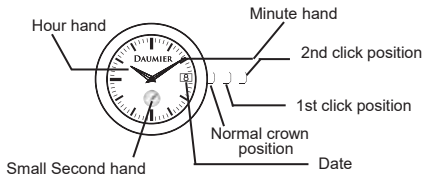

##### B) SETTING THE TIME

1. Pull the crown out to the 2nd click position.
2. Turn the crown to set hour and minute hands.
3. When the crown is pushed back to the normal position, small second hand begins to run.

##### C) SETTING THE DATE

1. Pull the crown out to the 1st click position.
  2. Turn the crown counter-clockwise to set the date.
- \* If the date is set between the hours of around 9:00 PM and 1:00 AM, the date may not change the following day.
3. After the date has been set, push the crown back to the normal position.

### III. DAUMIER Watch Operating Instructions

#### 1. Quartz Watch

Watch Model No: DM9622

Calibration steps that apply to movement model: VD32

##### A) DISPLAYS AND BUTTONS

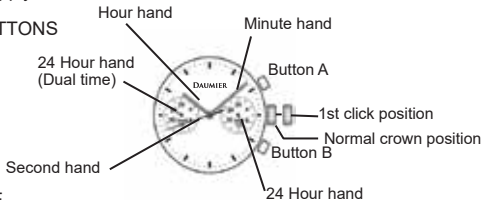

##### B) SETTING THE TIME

- 1) Pull out the crown to 1st click position when the second hand is at the 12 o'clock position.
  - 2) Turn the crown to set the hour and minute hands. (make sure 24 hour hand is set correctly).
  - 3) Push the crown back to the normal position in accordance with a time signal.
- \*24 hour hand moves linked with the center hour and minute hand.  
\*The date changes in midnight. When setting the hour hand, make sure that AM/PM is correctly set by using the 24 hour hand as an AM/PM indicator.

##### C) SETTING THE DUAL TIME

[ Quick set the dual time ]

- 1) Crown at normal position.
- 2) Adjust the time by pressing the button A or B.  
Button A : - 1 hour / push  
Button B : +1 hour / push

[ Precise adjustment of the the dual time ]

- 1) Pull out the crown to 1st click position when the second hand is at the 12 o'clock position.
- 2) Adjust the time by pressing the button A or B.  
Button A : -10 minute / push  
Button B : +10 minute / push
- 3) Push the crown back in the normal position in accordance with a time signal.

### III. DAUMIER Watch Operating Instructions

#### 1. Quartz Watch

Watch Model No: DM9620, DM9621

Calibration steps that apply to movement model: JP11

##### A) DISPLAYS AND BUTTONS

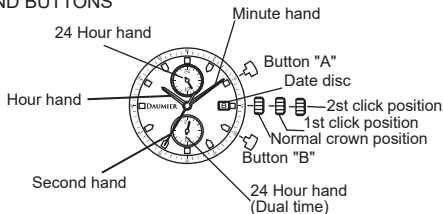

##### B) SETTING THE TIME

1. Pull the crown out to the 2nd click position.
  2. Turn the crown clockwise to set hour and minute hands.
  3. After the time has been set, push the crown back to the normal position.
- \*24 hour hand moves linked with the center hour and minute hand.

##### C) SETTING THE DATE

1. Pull the crown out to the 1st click position.
  2. Turn the crown clockwise to set the date.
- \* If the date is set between the hours of around 9:00 PM and 1:00 AM, the date may not change on the following day.
3. After the date has been set, push the crown back to the normal position.

##### D) SETTING THE DUAL TIME

Press button "A" to set the dual time hand forward in units of 15 minutes.

Press button "B" to set the dual time hand back in units of 15 minutes.

\*The dual time hand can be put rapidly by continuously pressing button "A" or "B".

### III. DAUMIER Watch Operating Instructions

#### 1. Quartz Watch

Function of TACHYMETER (For model: DM9620, DM9621):

When the second hand is at the 12 o'clock position, the measuring target begins to move. When the target reaches 1 km, the second hand points the average speed (km/h) on the scale.

\*Measurement time up to 60 seconds.

Example: Measuring the average speed of a car from A to B (A and B are 1 km apart).

Start to move the vehicle when the second hand is at the 12 o'clock position.

If the car takes 30 seconds to complete 1km, the second hand will point to 120 on the scale. The average speed of the motor vehicle is 120 km/h.

Function of TELEMETER (For model: DM9620):

TELEMETER provides a rough indication of the distance from your location to an object that emits both light and sound.

\*TELEMETER scale is graduated that sound travels at a speed of 1 km in 3 seconds.

Example: It can indicate the distance to the place where lightning struck by measuring the time elapsed after you see the flash of lightning until you hear the sound of thunder.

### III. DAUMIER Watch Operating Instructions

## 2. Quartz Watch(Chronograph)

Watch Model No.: DM-JLW006

Calibration steps that apply to movement model: VD54

#### A) DISPLAY

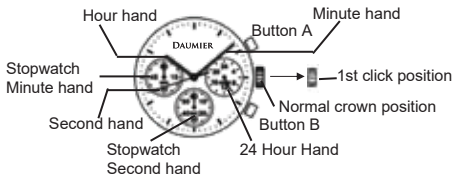

#### B) SETTING THE TIME

\* Before setting the time, check that the chronograph measurement is stopped.

- 1) Pull out the crown to the 1st click position when the second hand is at the 12 o'clock position.
- 2) Set the hands to the desired time of the day by turning the crown and make sure AM/PM is set correctly.

\* Do not press any button, otherwise the chronograph hands will move.

- 3) Push the crown back to the normal position in accordance with a time signal.

#### C) USING THE STOPWATCH

\* The measurement time is indicated by the stopwatch hands that move independently of the center hands (and 24-hour hand where applicable).

The stopwatch can measure up to 60 minutes

If either of the stopwatch hands are not in the "0" position, reset them following the procedure below.

- 1) Pull the crown out to : first click

- 2) Press button A or B to reset all stopwatch hands to "0" position.

\* The stopwatch minute hand moves correspondingly with the stopwatch second hand.

\* The hands move quickly if the respective buttons are kept pressed.

### III. DAUMIER Watch Operating Instructions

## 2. Quartz Watch(Chronograph)

### 3) Push the crown back to the normal position

#### \* Accumulated elapsed time measurement

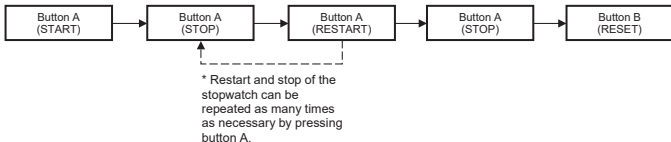

#### \* Split time measurement

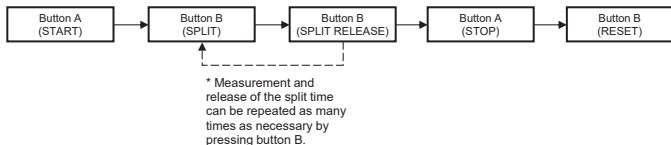

### D) Stopwatch Reset

If either of the stopwatch hands are not in the "0" position , reset them following the procedure below.

1) Pull the crown out to : 1st position.

2) Press button A or B to reset all stopwatch hands to "0" position.

\* The stopwatch minute hand moves correspondingly with the stopwatch second hand.

3) Push the crown back to the normal position.

### III. DAUMIER Watch Operating Instructions

## 2. Quartz Watch(Chronograph)

Watch Model No.: DM-JLW007

Calibration steps that apply to movement model: JS00

#### A) DISPLAYS AND BUTTONS

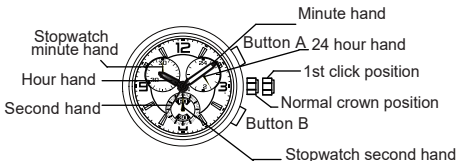

#### B) SETTING THE TIME

1. Pull the crown out to the 1st click position.
2. Turn the crown to set hour and minute hands.
3. When the crown is pushed back to the normal position in synchronization with a time signal, second hand begins to run.

#### C) USING THE STOPWATCH

\* The stopwatch can measure up to 30 minutes.

\* Button A / B does not function during resetting the stopwatch.



\* Restart and stop of the stopwatch can be repeated as many times as necessary by pressing button A.

### III. DAUMIER Watch Operating Instructions

## 2. Quartz Watch(Chronograph)

#### D) STOPWATCH RESET

This procedure should be performed when the stopwatch second hand does not return to the "0" second position after the stopwatch has been reset, and including after the battery has been replaced.

1. Pull the crown out to the 1st click position.

2. Press button "A" to set the stop watch second hand to the "0" position.

\*The stopwatch minute hand is synchronized with stopwatch second hand.

\*The stop watch second hand can be advanced rapidly by continuously pressing button "A".

3. Reset the time and push the crown back to the normal position.



### III. DAUMIER Watch Operating Instructions

#### 3. Automatic Watch

Watch Model No: DM8602, DM8603, DM8607, DM-JLW002, DM-JLW004A,  
DM-JLW008, DM-JLW009A, DM-JLW015A

Calibration steps that apply to movement model: 8215

##### A) DISPLAY

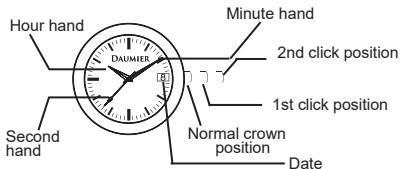

##### B) WINDING THE MAINSPRING

Automatic winding watch can be also manual-winded by turning the crown in normal crown position. Wind 15 - 20 times clockwise until second hand starts to move naturally.

##### C) SETTING THE TIME

1. Pull the crown out to the 2nd click position.
2. Turn the crown to set hour and minute hands.
3. When the crown is pushed back to the normal position, second hand begins to run.

##### D) SETTING THE DATE

1. Pull the crown out to the 1st click position.
  2. Turn the crown counter-clockwise to set the date.
- \* If the date is set between the hours of around 9:00 PM to 1:00 AM, the date may not change the following day.
3. After the date has been set, push the crown back to the normal position.

### III. DAUMIER Watch Operating Instructions

#### 3. Automatic Watch

Watch Model No: DM-JLW005, DM-JLW016, DM-JLW017, DM-JLW018,  
DM-JLW019, DM-JLW020

Movement: 8215

#### A) DISPLAYS

Watch Model No: DM-JLW005

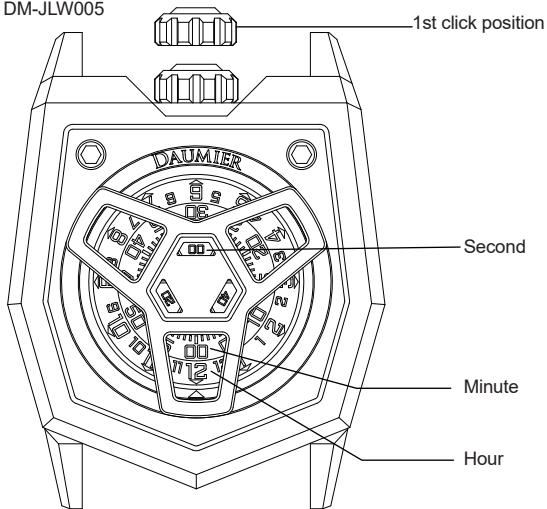

12:00:00

### III. DAUMIER Watch Operating Instructions

#### 3. Automatic Watch



3:15:10

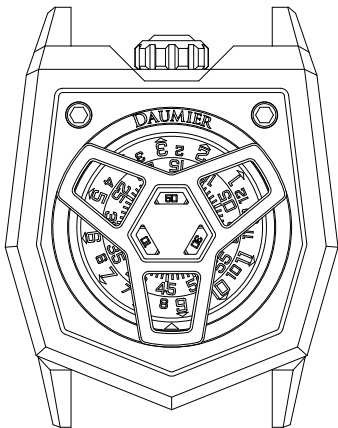

8:45:50

### III. DAUMIER Watch Operating Instructions

#### 3. Automatic Watch

Watch Model No: DM-JLW016, DM-JLW017, DM-JLW018, DM-JLW019,  
DM-JLW020

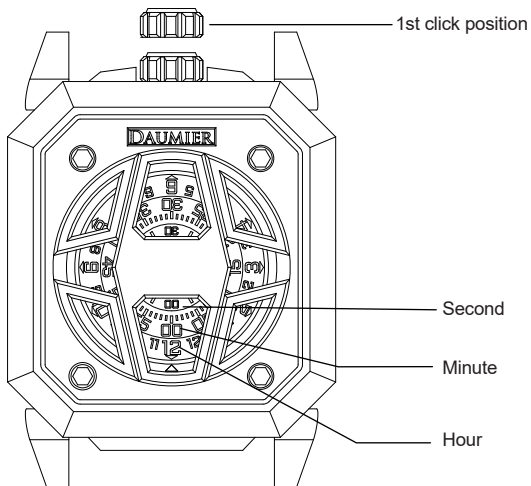

12:00:00

### III. DAUMIER Watch Operating Instructions

#### 3. Automatic Watch

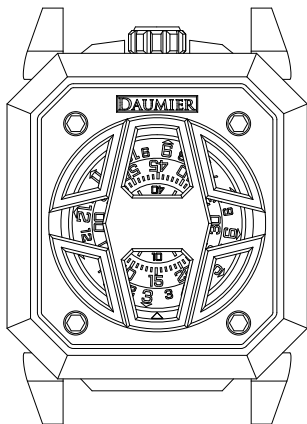

3:15:10

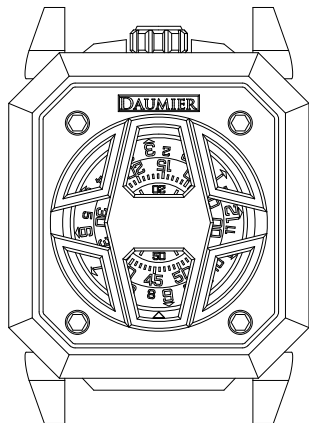

8:45:50

#### B) WINDING THE MAINSPRING

Automatic winding watch can be also manual-winded by turning the crown in normal crown position. Wind 15 - 20 times clockwise until second hand starts to move naturally.

### III. DAUMIER Watch Operating Instructions

#### 3. Automatic Watch

##### C) SETTING THE TIME

\*Please follow STEP 1 to remove the upper side of strap before time adjustment; follow STEP 5 & 6 to attach the strap after time adjustment.

1. Slide the pin with your finger.
2. Pull the crown out to the 2nd position.
3. Turn the crown to set hour and minute hands.
4. When the crown is pushed back to the normal position, second hand begins to run.
5. Insert one side of the spring bar into the hole of the watch at first.
6. Slide the pin with your finger, point the other side of the spring bar at the hole of the watch.

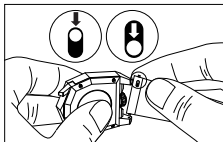

STEP 1

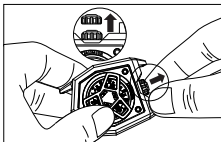

STEP 2

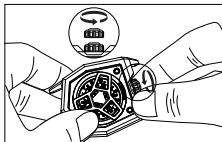

STEP 3

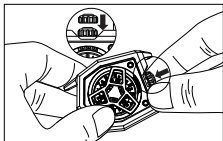

STEP 4

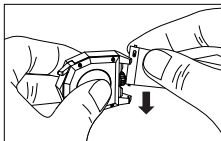

STEP 5

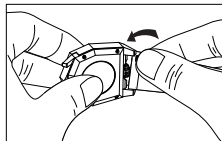

STEP 6

### III. DAUMIER Watch Operating Instructions

#### 3. Automatic Watch

Watch Model No: DM8802, DM8803, DM8807

Calibration steps that apply to movement model: 6T15

##### A) DISPLAY

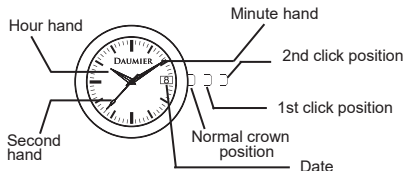

##### B) WINDING THE MAINSPRING

Automatic winding watch can be also manual-winded by turning the crown in normal crown position. Wind 15 - 20 times clockwise until second hand starts to move naturally.

##### C) SETTING THE TIME

1. Pull the crown out to the 2nd click position.
2. Turn the crown to set hour and minute hands.
3. When the crown is pushed back to the normal position, second hand begins to run.

##### D) SETTING THE DATE

1. Pull the crown out to the 1st click position.
2. Pull the crown from the 1st click position to the 2nd click position, then date advances one day.
3. After the date has been set, push the crown back to the normal position.

### III. DAUMIER Watch Operating Instructions

#### 3. Automatic Watch

Watch Model No: DM8601

Calibration steps that apply to movement model: 8205

##### A) DISPLAY

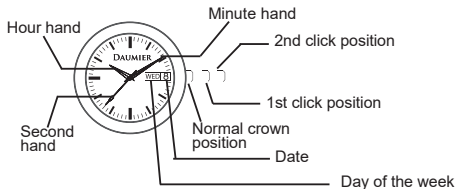

##### B) WINDING THE MAINSPRING

Automatic winding watch can be also manual-winded by turning the crown in normal crown position. Wind 15 - 20 times clockwise until second hand starts to move naturally.

##### C) SETTING THE TIME

1. Pull the crown out to the 2nd click position.
2. Turn the crown to set hour and minute hands.
3. When the crown is pushed back to the normal position, second hand begins to run.

##### D) SETTING THE DATE

1. Pull the crown out to the 1st click position.
2. Turn the crown counter-clockwise to set the date.  
\* If the date is set between the hours of around 9:00 PM to 1:00 AM, the date may not change on the following day.
3. After the date has been set, push the crown back to the normal position.

##### E) SETTING THE DAY OF THE WEEK

1. Pull the crown out to the 1st click position.
2. Turn the crown clockwise to set the day of the week.  
\* If the date is set between the hours of around 9:00 PM to 1:00 AM, the day of the week may not change the following day.
3. After the day of the week has been set, push the crown back to the normal position.



## III. DAUMIER Watch Operating Instructions

### 3. Automatic Watch

Watch Model No: DM8801

Calibration steps that apply to movement model: 6T51

#### A) DISPLAY

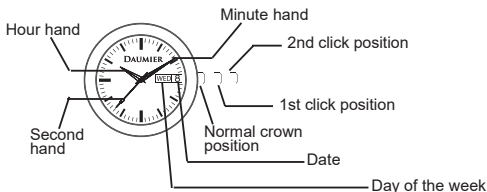

#### B) WINDING THE MAINSPRING

Automatic winding watch can be also manual-winded by turning the crown in normal crown position. Wind 15 - 20 times clockwise until second hand starts to move naturally.

#### C) SETTING THE TIME

1. Pull the crown out to the 2nd click position.
2. Turn the crown to set hour and minute hands.
3. When the crown is pushed back to the normal position, second hand begins to run.

#### D) SETTING THE DATE

1. Pull the crown out to the 1st click position.
2. Pull the crown from the 1st click position to the 2nd click position, then date advances one day.
3. After the date has been set, push the crown back to the normal position.

#### E) SETTING THE DAY OF THE WEEK

1. Pull the crown out to the 1st click position.
  2. Turn the crown clockwise to set the day of the week.
- \* If the date is set between the hours of around 9:00 PM to 1:00 AM, the day of the week may not change the following day.
3. After the day of the week has been set, push the crown back to the normal position.

### III. DAUMIER Watch Operating Instructions

#### 3. Automatic Watch

Watch Model No: DM8608

Calibration steps that apply to movement model: 82S0

##### A) DISPLAYS

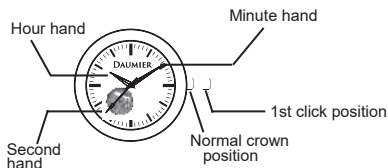

##### B) WINDING THE MAINSPRING

Automatic winding watch can also be hand wound by turning the crown clockwise in normal position. Wind several times clockwise. It will start to move naturally.

##### C) SETTING THE TIME

1. Pull the crown out to the 1st click position.
2. Turn the crown to set hour and minute hands.
3. After the time has been set, push the crown back to the normal position.

### III. DAUMIER Watch Operating Instructions

#### 3. Automatic Watch

Watch Model No: DM8615

Calibration steps that apply to movement model: 8217

##### A) DISPLAYS AND BUTTONS

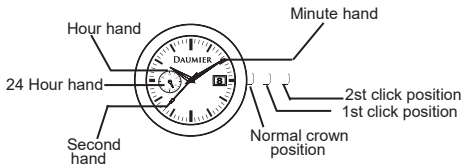

##### B) WINDING THE MAINSPRING

Automatic winding watch can also be hand wound by turning the crown clockwise in normal position. Wind several times clockwise. It will start to move naturally.

##### C) SETTING THE TIME

1. Pull the crown out to the 2nd click position.
2. Turn the crown to set hour and minute hands.
3. After the time has been set, push the crown back to the normal position.  
\*24 hour hand moves linked with the center hour and minute hand.

##### D) SETTING THE DATE

1. Pull the crown out to the 1st click position.
  2. Turn the crown counter-clockwise to set the date.
- \* If the date is set between the hours of around 9:00 PM to 1:00 AM, the date may not change on the following day.
3. After the date has been set, push the crown back to the normal position.

### III. DAUMIER Watch Operating Instructions

#### 3. Automatic Watch

Watch Model No: DM-JLW004B, DM-JLW015B

Calibration steps that apply to movement model: 8218

##### A) DISPLAY

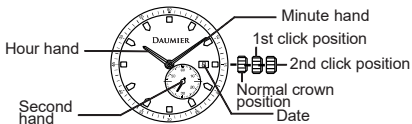

##### B) WINDING THE MAINSPRING

Automatic winding watch can also be hand wound by turning the crown clockwise in normal crown position. Wind several times clockwise. It will start to move naturally.

##### C) SETTING THE TIME

1. Pull the crown out to the 2nd click position.
2. Turn the crown to set hour and minute hands.
3. After the time has been set, push the crown back to the Normal position

##### D) SETTING THE DATE

1. Pull the crown out to the 1st click position.
  2. Turn the crown counter-clockwise to set the date.
- \* If the date is set between the hours of around 9:00 PM and 1:00 AM, the date may not change on the following day.
3. After the date has been set, push the crown back to the normal position.

### III. DAUMIER Watch Operating Instructions

#### 3. Automatic Watch

Watch Model No: DM-JLW001, DM-JLW009B

Calibration steps that apply to movement model: 8219

##### A) DISPLAY

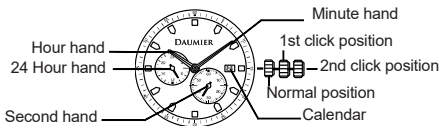

##### B) WINDING THE MAINSPRING

Automatic winding watch can also be hand wound by turning the crown clockwise in normal crown position. Wind several times clockwise. It will start to move naturally.

##### C) SETTING THE TIME

1. Pull the crown out to the 2nd click position.
2. Turn the crown to set hour and minute hands.
3. After the time has been set, push the crown back to the Normal position  
\*24 Hour hand moves linked with the center Hour and Minute hand.

##### D) SETTING THE DATE

1. Pull the crown to the 1st click position.
2. Turn the crown counter-clockwise to set the date.  
\* If the date is set between the hours of around 9:00 PM and 1:00 AM, the date may not change on the following day.
3. After the date has been set, push the crown back to the normal position.

### III. DAUMIER Watch Operating Instructions

#### 3. Automatic Watch

Watch Model No: DM8609

Calibration steps that apply to movement model: 9132

##### A) DISPLAYS AND BUTTONS

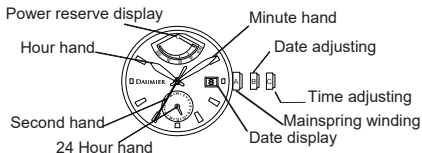

##### B) WINDING THE MAINSPRING

Automatic winding watch can be also manual-winded by turning the crown in "A" position. Wind 15~20 times clockwise until second hand starts to move naturally.

##### C) ADJUSTING DATE

Adjust the date by rotating the crown clockwise in "B" position.

##### D) ADJUSTING TIME

Rotate the crown in "C" position and adjust the standard time. Then check if it is morning or afternoon and adjust correctly.

##### E) POWER RESERVE DISPLAY

Illustrate the power reserved in the automatic movement. The energy indicator will change due to winding the mainspring.

When the energy indicator points to "(F) 40" represents that the movement's reserve energy is full; the energy indicator points to "(E) 0" indicates that the power reserve in movement is zero, winding is needed in order to maintain the normal running of the watch.

### III. DAUMIER Watch Operating Instructions

#### 3. Automatic Watch

Watch Model No: DM8620

Calibration steps that apply to movement model: 9122

##### A) DISPLAYS AND BUTTONS

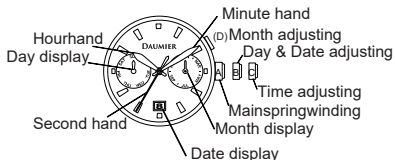

##### B) WINDING THE MAINSPRING

Automatic winding watch can be also manual-winded by turning the crown in "A" position. Wind 15 ~ 20 times clockwise until second hand starts to move naturally.

##### C) ADJUSTING DAY

Adjust the day by rotating the crown counter-clockwise in "B" position.

##### D) ADJUSTING DATE

Adjust the date by rotating the crown clockwise in "B" position.

##### E) ADJUSTING TIME

Rotate the crown in "C" position and adjust the standard time. Then check if it is morning or afternoon and adjust correctly.

##### F) ADJUSTING MONTH

Push the button "D" and adjust the month.

\* If the button is not pushed to the end, the month is not changed perfectly.

### III. DAUMIER Watch Operating Instructions

#### 3. Automatic Watch

Watch Model No: DM8613

Calibration steps that apply to movement model: 9120

##### A) DISPLAYS AND BUTTONS

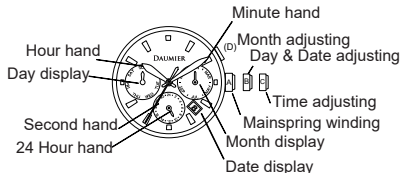

##### B) WINDING THE MAINSPRING

Automatic winding watch can be also manual-winded by turning the crown in "A" position. Wind 15~ 20 times clockwise until second hand starts to move naturally.

##### C) ADJUSTING DAY

Adjust the day by rotating the crown counter-clockwise in "B" position.

##### D) ADJUSTING DATE

Adjust the date by rotating the crown clockwise in "B" position.

##### E) ADJUSTING TIME

Rotate the crown in "C" position and adjust the standard time. Then check if it is morning or afternoon and adjust correctly.

##### F) ADJUSTING MONTH

Push the button "D" and adjust the month.

\* If the button is not pushed to the end, the month is not changed perfectly.



## IV. DAUMIER Watch General Functions & Features

### 1. Sapphire Crystal Anti-Reflective Treatment



The anti-reflective treatment on both sides of the sapphire crystal improves the visibility of your watch dial. Wear and tear may cause marks to appear on this surface treatment. These are considered normal and are therefore not covered by the warranty.

### 2. Leather Straps

DAUMIER recommends that you take the measures below to preserve the condition of your leather strap:

- Avoid contact with water and moisture to prevent discolouration and deformation.
- Avoid prolonged exposure to sunlight to prevent the colour from fading.
- Leather is permeable! Avoid contact with oil based substances and cosmetic products.
- Please contact your nearest DAUMIER retailer for professional inspection should you have a problem with your leather strap.

## V. Specific Sections and General Information

### 1. Pictograms



Automatic Movement



Quartz Movement



Calendar



Screw-down Case Back



Transparent Case Back



Sapphire Crystal



Sapphire Crystal with a Single Layer of Anti-reflective Coating on the Underside



Sapphire Crystal with Several Layers of Anti-reflective Coating on the Underside



Real Diamond



Stainless Steel



Physical Vapor Deposition



Stainless Steel / Gold 18K



Gold 18K and Parts



Genuine Leather



Water-resistant to 30 metres/100 feet



Water-resistant to 50 metres/167 feet



Water-resistant to 100 metres/330 feet



CZ Gemstone

## V. Specific Sections and General Information

### 2. Special Recommendations

Please pay attention to the following caring practice to optimize the precision performance and durability of your DAUMIER watch.

1. Magnetic fields: avoid placing your watch near loudspeakers or refrigerators since they generate powerful magnetic fields.
2. Swimming: remember to tighten the crown if you plan to wear you watch while swimming. Always rinse your watch with fresh water afterwards.
3. Impact: avoid impacts in all conditions.
4. Cleaning: for metal bracelets and water-resistant cases, you can use a tooth brush and soap to clean and rinse afterwards. Pat dry with a piece of soft cloth.
5. Chemical products: avoid direct contact with solvents, detergents, perfumes, cosmetics, etc. since they may damage the bracelet, case or gaskets.
6. Temperature: avoid exposure to extreme temperatures (greater than 60°C, or 140°F, less than 0°C, or 32°F) or extreme temperature changes.
7. Water resistance: a watch's water resistance cannot be sustained permanently. We suggest an annual water resistance check at an authorized service centre.
8. Crown and buttons: do not operate the crown and buttons when the watch is submerged in water to avoid possible water infiltration.
9. Environmental Protection: recycle old watches and dispose used batteries at authorized recycling stations.

## V. Specific Sections and General Information

### 2. Special Recommendations

What is the normal service interval?

Like any precision instrument, a watch needs regular servicing to ensure proper functioning in normal condition. We cannot suggest the frequency of service since such a need depends on the model, the climate and the owner's care of the watch. As a general rule, a watch should be serviced every 4 to 5 years at an authorized DAUMIER service centre.

Who should I contact for maintenance service or battery replacement?

We recommend that you contact an approved DAUMIER service centre or authorized DAUMIER retailers for the work. They are the only entities equipped with the tools and apparatus required to carry out the work in a professional manner. Furthermore, only these authorized entities can guarantee that their work is carried out in accordance with DAUMIER's strict quality standards.

#### Environmental Protection



This symbol indicates that this product should not be disposed of with household waste. It has to be returned to a local authorized collection system. By following this procedure you will contribute to the protection of the environment and human health. The recycling of the materials will help to conserve natural resources.

## VI. DAUMIER Customer Service and Repair Centers

### DAUMIER WATCH (SWITZERLAND)

Chemin de Saint Nicholas 26,  
2350 Saignelégier, Switzerland

### DAUMIER WATCH (FRANCE)

2, Rue de la Vierge, 25360 Gonsans, France

### DAUMIER WATCH (HONG KONG)

#### DAUMIER COMPANY LTD

Room 2103, 21/F, Peninsula Square, 18 Sung On Street,  
Hungghom, Kowloon, Hong Kong  
Tel: +852 2356 9300

### DAUMIER WATCH (CHINA)

6/F, Jueshi Building, 20 Jia Bin Road, Luo Hu Qu,  
Shenzhen, Guangdong, China  
Tel: +86 400 833 2128

## VI. DAUMIER Customer Service and Repair Centers

### DAUMIER WATCH (TAIWAN)

ZETA JEWELRY CO.,LTD

374-376 ZhōngZhèng 1st Road,  
Lingya District, Kaohsiung City, Taiwan 802  
Tel: +886 07 725 2330

### DAUMIER WATCH (SINGAPORE)

DELASAS PTE LTD

20 Maxwell Road, # 01-01 Maxwell House  
Singapore 069113.  
Tel: +65 6226 4226

TIME WATCH MALL PTE LTD

896 Dunearn Road, #04-01 Singapore 589472.  
Tel: +65 9135 4605

[www.daumierwatches.com](http://www.daumierwatches.com)



Disclaimer: The above information is intended to be for reference only and is subject to change at any time without prior notice. Please contact the DAUMIER Customer Service for the latest information. In case of any dispute, the decision of DAUMIER shall be final.

## VI. DAUMIER Customer Service and Repair Centers



盛时钟表维修

PRIME TIME WATCH & CLOCK SERVICE

DAUMIER China After-Sales Services Agency  
(Customer Service & Repair)

Customer Service Hotline: +86 400 6700 168

Service Hours: Monday to Friday 9:00 am to 5:30 pm,  
except public holidays

Sheng Xi watch repair: Shanghai Admiralty Center  
Room 1302, 13/F, Admiralty Plaza, 98 Huaihai Zhong Road, Shanghai  
Tel: +86 21 6091 9588

Sheng Xi watch repair: Shanghai Repair Store Center  
No.34 Yandang Road, Shanghai  
Tel: +86 21 6384 5283

Sheng Xi watch repair: Shanghai Yangtze River Center  
2/F, Building 7, Yangzijiang International Enterprise Plaza, No. 268, Linxin Road,  
Changning District, Shanghai  
Tel: +86 400 6700 168

Sheng clock watch repair: Beijing Hengdeli New World Center  
7/F, New World Taihua Office Building, 5 Chongwai Street, Beijing  
Tel: +86 10 6525 6100

Sheng Xi watch repair: Beijing Hengdeli Wangfujing Center  
1/F, Dan Yao Building, 172 Wangfujing Street, Dongcheng District  
Tel: +86 10 6525 0406

## VI. DAUMIER Customer Service and Repair Centers

Sheng Xi watch repair: Chengdu Xinyu Sambo Center  
Xinyu Sanbao Store, 2/F, Aerospace Science and Technology Building, No. 7  
Xinguanghua Street, Jinjiang District, Chengdud  
Tel: +86 28 8674 4169

Sheng Xi watch repair: Harbin Post Office Center  
2/F, No. 51 Jianshe Street, Nangang District, Harbin  
Tel: +86 451 84648200

Disclaimer: The above information is provided by SHENG XI WATCH REPAIR, is intended to be for reference only and is subject to change at any time without prior notice. Please contact SHENG XI WATCH REPAIR for the latest information. In case of any dispute, the decision of DAUMIER shall be final.



## VI. DAUMIER Customer Service and Repair Centers



DAUMIER China After-Sales Services Agency  
(Customer Service & Repair)

Customer Service Hotline: +86 400 8833 299

Service Hours: Monday to Saturday 9:00 am to 12:00 am,  
1:00 pm to 5:30 pm, except public holidays

### TECHNICAL SERVICE CENTERS

Macau Plaza, No.47-53 Huangzi Road, Macau

Pingdong 3rd Road, Xiangzhou District, Zhuhai City, Guangdong Province

### BEIJING CITY

Jiulong Plaza, Jiuxianqiao South Road, Chaoyang District

### SHANGHAI CITY

Dongfang Building, Chengzhong Road, Jiading District

### TIANJIN CITY

Huanghai Road, Development District

### JIANGSU PROVINCE

Jindi Plaza, Zhongshan North Road, Xuzhou City

### ZHEJIANG PROVINCE

Pacific Plaza, Jixiang Road, Dongyang City

### SHANDONG PROVINCE

Ginza Mall, Kuiwen Shengli East Street, Weifang City

Wanda Plaza Tissot Shoppe, Weifang City

Yanhua Shopping Center, Zhending Street, Zhifu District, Yantai City

## VI. DAUMIER Customer Service and Repair Centers

### GUANGDONG PROVINCE

The Sun Store, Wanli Plaza, ChencunShunlian, Shunde District, Foshan City  
Baihua Plaza, Zumiao Road, Foshan City  
Zhouyuzan Store, Shunlian International Shopping Mall, ,Foshan City  
Xinghua Plaza, Zumiao Road, Foshan City  
Fenjiang Middle Road, Chancheng District, Foshan City  
Nanhai Plaza, Nanhai District, Foshan City  
Baoliuicheng Plaza, Denghu East Road, Nanhai District, Foshan City  
Xindaxin Plaza, Xinanjiezhangbian Road, Sanshui District  
No.1 Floor, Tianyou City,Ronggui District,Foshan City  
Jiazhou Plaza, No.1 Huangqiguagnfo Road, Nanhai District, Foshan City  
No.1 Floor, C Building , Minjiang Road, Chancheng District, Foshan City  
(Crown Crowne Plaza Foshan)  
Xindaxin Plaza, Zhongshan Road, Guangzhou City  
Zhongshan Wulu, New Daxin Company, Guangzhou City  
Modeng Plaza, Jiangnan Road, Guangzhou City  
Xihu Road, Yuexiu District, Guangzhou City  
Tianhecheng Plaza , Tianhe District, Guangzhou City  
Tianhecheng Plaza ,Tianyin Building, Zhongshan Road, Tianhe District, Guangzhou City  
Guangbai Building Old Wing Building, Xihu Road,Yuexiu District , Guangzhou City  
Wende Oriental Plaza, West Lake Road, Yuexiu District, Guangzhou City  
Guangbai Times Square Plaza, Duanzhou Five Road, Zhaoqing City  
Fengdu Plaza, Zhenjiang District, Shaoguan City  
Jida Plaza, Zhuhai City  
Fenghuang South Road, Zhuhai City  
Yingbin Plaza , Zhuhai City  
Huafashangdu Shopping Mall, Zhuhai Dadao, Zhuhai City  
Wanda Plaza, Dongzong Road, Dongcheng District, Dongguan City

[www.zhouyuzan.com](http://www.zhouyuzan.com)



Disclaimer: The above information is provided by ZHOUYUZAN, is intended to be for reference only and is subject to change at any time without prior notice. Please contact ZHOUYUZAN for the latest information. In case of any dispute, the decision of DAUMIER shall be final.