

usipipe[®]

ALUMINUM PIPING SYSTEM



AIR

NITRO

VAC

HP

OIL

PRODUCT MANUAL

Super-Fast Installation

No Special Tools Needed

Pressures up to 1015 PSI

13 Pipe Sizes Available

Exceptionally Secure Joints

	The Unipipe Advantage	3 - 5	Install Special Flange	40
	Flow Rate Table	6	Install Reducer	40
	Unipipe AIR 232 PSI	7 - 13	Install Reducer in Fitting	41
	Unipipe NITRO 232 PSI	22 - 26	Install Plug in Fitting	41
	Unipipe VAC -29 inHg	27 - 32	Install Branch Pipe x Pipe 1" to 2-1/2" (25mm-63mm)	42
	Unipipe HP 1015 PSI	33 - 36	Install Saddle Branch Pipe x FNPT 1" to 10" (25mm-250mm)	43
	Unipipe OIL 1015 PSI	37 - 39	Unipipe Assembly Instructions 3/4" to 3-1/2" (20mm-90mm)	44
	Accessories	14 - 21	Unipipe Assembly Instructions 4-1/2" to 10" (110mm-250mm)	45
Quick Disconnect Nipples	Female Threaded Branches	Galvanized Loop Hangers	Stainless Steel Clamp Rings	
Quick Disconnect Coupling - Male	Offset Nipples	Wire Hangers	Fitting O-Rings	
Fitting Plugs w/ Purge Valve	Pipe to Male Thread Connectors	Pipe Clips	Flange Gaskets	
Saddle Branches Pipe x FNPT	Wall Mounted Manifolds	Reducing Bushings	Locking Ball Valve Handles	
	Valves	Hose Connectors	Pipe Cutters	
		Fitting Nuts	Miscellaneous Tools	
			Mounting Accessories	

Certificates & Declarations

ISO 9001:2008

SGS Certificate ES13/13865

CRN Number for All Canadian Provinces

- Category A - OA16981.5
- Category B - OB21369.5
- Category C - OC21414.5
- Category D - OD21371.5
- Category H - OH21366.5

Pipe Coating Quality Certificate

Pressure / Temperature Certification

6°F/3488 PSI (-15°C/240.5 Bar)
248°F / 2886 PSI (+140°C/199 Bar)

Unipipe Product Warranty - 20 Years

Conformity Declaration according to PED ASME B31.3 - B31.9 2014/68/UE



unipipe

European Directive 97/23/CE (PED)
Unipipe system components are designed, produced and controlled according to the safety essential requirements stated in article 3, section 3.

Unipipe system components meet ASME B31.3 and ASME B31.9 requirements

Pipe and Fittings Materials
Aluminum alloys meet the following standards: UNI EN 755-2, UNI EN 515, UNI EN 573-3, UNI EN 1706.

The screws meet ISO 4762 standard.

The connection "gas" threads meet ISO 7-1 standard.

Surface treatments
The Bodies have a cathodoresis surface treatment with a minimum thickness surface of 10 µm. The pipes are heat painted externally using polyester powders of not less than 60 µm thickness with "Qualicoat" certificate (i.e. 472). The internal surface is phosphatized.

Compliance with customer's order
In case of no specific request from the client, the material is foreseen to comply with Unipipe technical documentation in force at the supply date.

Certificate of Conformity

20 YEAR WARRANTY

Unipipe is offered with a warranty against defects in manufacturing or materials. It remains the responsibility of the user to ensure that the fittings and related products are suitable for the application. The installation must be carried out by a competent person in accordance with the enclosed recommendations, complying with recognized codes of practice and relevant standards, and be properly maintained. Refer to our terms and conditions.

Unipipe has a policy of continuous improvement, research, and development. We reserve the right to amend the specifications and design of all products without notice.

Terms & Conditions

- We guarantee that our products are of good quality and conform to standards mentioned in our product information.
- The guarantee is valid for twenty years from delivery date. We repair and/or replace defective items only if defects are clearly due to our production.
- Such guarantee will not be applied in the following cases:
 - If the products have been used improperly or in a condition different from the above mentioned standards.
 - If the products are not installed correctly.
 - If the products are modified and/or roughly handled.
- It is expressly understood that you are not entitled to any claim for damages (including, but not limited to, loss of profit, personal injury or property damaged) due to defects in our products.

unipipe
Safety, Reliability and Performance.

550 Allison Avenue
Schamburg, IL 60195
888.988.9007
www.UnipipeSolutions.com

Five Options - Many Applications

No Special Tools Required

Unipipe is a modular aluminum piping system available in a broad range of sizes, pressures, and fittings. The heavy-wall pipe is rated for 1015 PSI and no special tools are required for assembly or installation. All piping and fittings are 100% aluminum. It is available in the broadest range of sizes on the market - 3/4" to 10" diameters.

Pressure Capacity

The Unipipe System is suitable for a very wide pressure ranges from high vacuum to 1015 PSI.

Vast Temperature Capabilities

Unipipe offers a range of working temperature from -22°F up to 266°F (-30°C up to 130°C).

Quick & Easy

Unipipe connects together quickly and easily. Only basic, standard tools are required to create complex piping systems. No grooving or crimping are necessary.

Flexible

Unipipe's range of pipe sizes and fittings offer one of the most convenient, flexible and dynamic piping solutions on the market. It is suitable for many different applications.

Universal

Unipipe offers the widest product range for the transport of compressed air, inert gases, and vacuum, as well as high pressure air and fluids.

13 Pipe Sizes Available

20mm	3/4"
25mm	1"
32mm	1-1/4"
40mm	1-1/2"
50mm	2"
63mm	2-1/2"
75mm	3"
90mm	3-1/2"
110mm	4-1/2"
140mm	5"
160mm	6"
200mm	8"
250mm	10"

SPECIFICATIONS	UnipipeAIR	UnipipeNITRO	UnipipeVAC	UnipipeHP	UnipipeOIL
Max Working Pressure	232 PSI (16 BAR)	232 PSI (16 BAR)	25.7 (4-1/2" to 10") -29 inHg (3/4" to 3-1/2")	435-580-1015 PSI (30-40-70 BAR)	435-580-1015 PSI (30-40-70 BAR)
Plant Testing Pressure 1 hour at 20°C	348 PSI (24 BAR)	348 PSI (24 BAR)	348 PSI (24 BAR)	435-580-1015 PSI (30-40-70 BAR)	435-580-1015 PSI (30-40-70 BAR)
Quality Testing Pressure 1 hour at 20°C	928 PSI (64 BAR)	928 PSI (64 BAR)	928 PSI (64 BAR)	435-580-1015 PSI (30-40-70 BAR)	435-580-1015 PSI (30-40-70 BAR)
Continuous Working Temperature	From -4°F to 212°F (-20°C up to 100°C)				
Max Working Temperature	From -22°F Up to 266°F (-30°C Up to 130°C)				
Thread Standard	NPT National Pipe Thread complying to ANSI B1.201				
Aluminum Pipe Mechanical Resistance	According to EN-755-2/2008 standards				
Pipe Material	Aluminum Alloy EN AW 6060 - T5 according to EN 755-2/2008				
Aluminum Fittings Ma- terial	Aluminum Alloy EN Aw 6061 T6				
O-Ring & Lip Gasket Material	HNBR 65°/75° Shore A				
Clamp Ring Material	AISI 304 Stainless Steel				

The Unipipe Advantage

The Unipipe design produces a fitting with exceptionally secure joints that is superior to every other aluminum pipe system. The brilliant engineered design with quality material selection produces a system in which the actual pipes will burst before the fitting fails in destructive testing.

In-House Destructive Pressure Testing

UnipipeAIR Rated for 232 PSI
Actual Burst Pressure 4358 PSI (300 bar)
 Pipe bursts but no failure of the fittings.



Check Out The
 Pipe Burst Challenge
 Video



UnipipeHP Rated for 1015 PSI
Actual Burst Pressure 7397 PSI (510 bar)
 Pipe bursts but no failure of the fittings.



Independent Laboratory Test Report Destructive Pressure Test to Burst Point

Seal Type	Temp	Bar	PSI
FPM	5°F / -15°C	240.5	3488
HNBR	-22°F / -30°C	243.2	3527
FPM	284°F / +140°C	199	2886
HNBR	212°F / +100°C	202.9	2943



Gripping Action for Rapid Installation

A system of aluminum piping and fittings that offers fast installation and exceptionally secure joints.

The internal nut and dynamic gripping ring ensure there is no way to separate the pipe from the fittings. This innovative fitting is small and light, making this system one of the most powerful methods for transporting air, gases, and liquids. The plastic ring conveniently identifies the fluid and working pressure for each system.

Sizes $\frac{3}{4}$ " to $3\frac{1}{2}$ " (20mm—90mm)

1. Aluminum Nut
2. Colored Identification Ring
3. Stainless Steel Clamp Ring
4. HNBR O-Ring
5. Machined Aluminum Body



**The highest pressure rated
aluminum pipe system
on the market.**

**The pipe will burst
before the fitting will fail!**

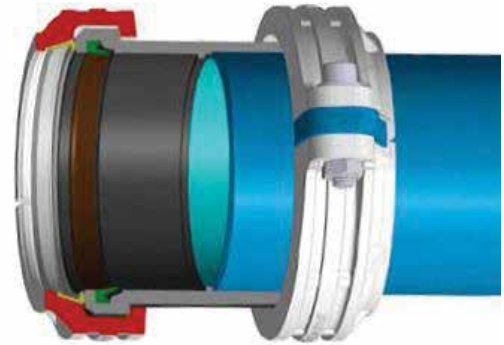

Sizes $4\frac{1}{2}$ " to 10" 110mm—250mm

1. Stainless Steel Clamp Ring
2. Half Clamp Body Ring
3. HNBR O-Ring
4. Colored Identification Mark
5. Machined Aluminum Body
6. Bolts



Flow Rate Distance from compressor to furthest outlet / 100 PSI with 4% allowed pressure loss

NI/min	Nm3/h	cfm	80'	160'	320'	500'	650'	1000'	1300'	1600'	3300'	4900'	6500'
230	14	8	20	20	20	20	20	20	20	20	25	25	25
650	39	23	20	20	20	25	25	25	32	32	32	40	40
900	54	32	20	20	25	25	32	32	32	32	40	40	40
1200	72	42	25	25	25	32	32	32	32	40	40	50	50
1750	105	62	25	25	32	32	32	40	40	40	50	50	63
2000	120	71	32	32	32	32	40	40	40	40	50	63	63
2500	150	88	32	32	32	40	40	40	50	50	63	63	63
3000	180	106	32	32	40	40	40	50	50	50	63	63	63
3500	210	123	40	40	40	40	50	50	50	50	63	63	75
4500	270	159	40	40	40	50	50	50	63	63	63	75	75
6000	360	212	50	50	50	50	50	63	63	63	75	75	90
7000	420	247	50	50	50	50	63	63	63	75	75	90	90
8500	510	300	63	63	63	63	63	63	75	75	90	90	90
12000	720	424	63	63	63	63	75	75	75	90	90	110	110
15000	900	530	75	75	75	75	75	90	90	90	110	110	140
18000	1080	635	75	75	75	75	75	90	90	90	110	140	140
21000	1260	741	90	90	90	90	90	90	90	110	110	140	140
26000	1559	918	90	90	90	90	90	110	110	110	140	140	140
31000	1859	1095	110	110	110	110	110	110	110	110	140	140	160
33000	1979	1165	110	110	110	110	110	110	110	140	140	140	160
44000	2639	1554	140	140	140	140	140	140	140	140	160	160	200
50000	2999	1766	140	140	140	140	140	140	140	140	160	200	200
58000	3479	2048	140	140	140	140	140	140	140	160	160	200	200
67000	4019	2366	160	160	160	160	160	160	160	160	200	200	200
75000	4499	2648	160	160	160	160	160	160	160	160	200	200	200
83000	4979	2931	160	160	160	160	160	160	160	160	200	200	250
92000	5519	3249	200	200	200	200	200	200	200	200	200	250	250
100000	5999	3531	200	200	200	200	200	200	200	200	200	250	250
125000	7500	4414	200	200	200	200	200	200	200	200	250	250	250
150000	9000	5297	250	250	250	250	250	250	250	250	250	250	
200000	12000	7062	250	250	250	250	250	250	250	250	250		
208333	12500	7357	250	250	250	250	250	250	250	250			
250000	15000	8828	250	250	250	250	250	250	250	250			

The pipe length shown in the table refers to an installation with a single mainline. In the case of a ring main installation, with pipes of the same diameter and length, the pressure losses will be reduced by 50% and will increase the stability of the whole system.

- Velocity less than 20 feet per second
- Velocity from 20 - 33 feet per second
- Velocity from 33 - 50 feet per second (not recommended)

UnipipeAIR Pipe 232 PSI (16 bar)

Part No.	Size mm	Size Inches	Wall Thickness mm	Length m	Length Feet	Weight
UATT0.020600	20	¾	1.0	5.8	19	2.1 lbs.
UATT0.025600	25	1	1.1	5.8	19	2.9 lbs.
UATT0.032600	32	1¼	1.2	5.8	19	4.1 lbs.
UATT0.040600	40	1½	1.3	5.8	19	5.7 lbs.
UATT0.050600	50	2	1.4	5.8	19	7.7 lbs.
UATT0.063600	63	2½	1.8	5.8	19	12.4 lbs.
UATT0.075600	75	3	2	5.8	19	17.9 lbs.
UATT0.090600	90	3½	2.4	5.8	19	23.8 lbs.
UATT0.110600	110	4½	3.0	5.8	19	35.7 lbs.
UATT0.140600	140	5	Special	Order		
UATT0.160600	160	6	4.3	5.8	19	75.4 lbs.
UATT0.200600	200	8	4	5.8	19	89.3 lbs.
UATT0.250600	250	10	5	5.8	19	141 lbs.



UnipipeAIR Pipe UPS Shipping 232 PSI (16 bar)

Part No.	Size mm	Size Inches	Wall Thickness mm	Length m	Length Feet	Weight
CUATT0.020250	20	¾	1.0	2.5	8	2.1 lbs.
CUATT0.025250	25	1	1.1	2.5	8	2.9 lbs.
CUATT0.032250	32	1¼	1.2	2.5	8	4.1 lbs.
CUATT0.040250	40	1½	1.3	2.5	8	5.7 lbs.
CUATT0.050250	50	2	1.4	2.5	8	7.7 lbs.
CUATT0.063250	63	2½	1.8	2.5	8	12.4 lbs.



Straight Coupling 232 PSI (16 bar)

Part No.	Size Ømm	Size Inches	A	L	E	S	Weight
UACC0.020020	20	¾	70	35	37	29	2.5 oz
UACC0.025025	25	1	75	37	42	36	3.4 oz
UACC0.032032	32	1¼	94	46	51	43	6.1 oz
UACC0.040040	40	1½	117	57	63	53	11.9 oz
UACC0.050050	50	2	138	68	78.5	66	1.2 lbs
UACC0.063063	63	2½	173	83	95	82	2.2 lbs
UACC0.075075	75	3	174	85.4	108	100	2.4 lbs
UACC0.090090	90	3½	190	93	132	118	3.9 lbs
UACC0.110110	110	4½	150	73	206	154	4.8 lbs
UACC0.140140	140	5	Special	Order			
UACC0.160160	160	6	272	133.5	266	221	17.2 lbs
UACC0.200200	200	8	Coming	Soon			
UACC0.250250	250	10	Coming	Soon			



Sliding Straight Coupling 232 PSI (16 bar)

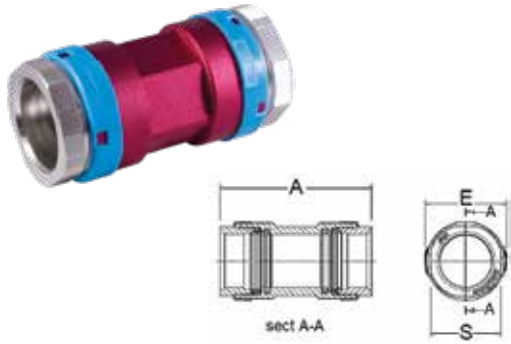

Part No.	Size mm	Size Inches	A	E	S	Weight
UACC1.020020	20	¾	70	37	29	2.5 oz
UACC1.025025	25	1	75	42	36	3.4 oz
UACC1.032032	32	1¼	94	51	33	6.1 oz
UACC1.040040	40	1½	117	63	53	11.9 oz
UACC1.050050	50	2	138	78.5	66	1.2 lbs
UACC1.063063	63	2½	173	95	82	2.2 lbs
UACC1.075075	75	3	174	108	100	2.4 lbs
UACC1.090090	90	3½	190	132	118	3.9 lbs

90° Elbow 232 PSI (16 bar)



Part No.	Size mm	Size Inches	A	E	L	S	Weight
UACC9.020020	20	¾	60	37	35	29	3 oz
UACC9.025025	25	1	76	42	37	36	4 oz
UACC9.032032	32	1¼	90	51	46	43	7.2 oz
UACC9.040040	40	1½	112	63	57	53	1.2 lbs
UACC9.050050	50	2	143	79	68	66	1.5 lbs
UACC9.063063	63	2½	168	95	83	82	2.4 lbs
UACC9.075075	75	3	190	108	85	100	2.8 lbs
UACC9.090090	90	3½	219	132	93	118	5.5 lbs
UACC9.110110	110	4½	214	206	73	154	7.6 lbs
UACC9.140140	140	5	Special	Order			
UACC9.160160	160	6	352	266	133.5	221	25.2 lbs
UACC9.200200	200	8	Coming	Soon			
UACC9.250250	250	10	Coming	Soon			

45° Elbow 232 PSI (16 bar)



Part No.	Size mm	Size Inches	A	B	E	L	S	Weight
UACC4.020020	20	¾	85	59	37	35	29	3.2 oz
UACC4.025025	25	1	95	68	42	37	36	3.9 oz
UACC4.032032	32	1¼	119	84	51	46	43	7.2 oz
UACC4.040040	40	1½	141	101	63	57	53	12 oz
UACC4.050050	50	2	171	124	78.5	68	66	1.4 lbs
UACC4.063063	63	2½	207	150	95	83	82	2.3 lbs
UACC4.075075	75	3	213	161	108	85.5	100	2.6 lbs
UACC4.090090	90	3½	238	189	132	93	118	4.2 lbs
UACC4.110110	110	4½	222	194	206	73	154	5.7 lbs
UACC4.140140	140	5	Special	Order				
UACC4.160160	160	6	358	296.5	265	133.5	221	16.6 lbs
UACC4.200200	200	8	Coming	Soon				
UACC4.250250	250	10	Coming	Soon				

Equal Tee 232 PSI (16 bar)

Part No.	Size mm	Size Inches	A	B	E	L	S	Weight
UACCT.020020	20	¾	101	68	37	35	29	4.3 oz
UACCT.025025	25	1	111	75	42	37	36	5.7 oz
UACCT.032032	32	1¼	136	93	51	46	43	10.3 oz
UACCT.040040	40	1½	162	110	63	57	53	1 lb
UACCT.050050	50	2	206	141	78.5	68	66	2 lbs
UACCT.063063	63	2½	230	160	95	83	82	3.1 lbs
UACCT.075075	75	3	260	219.9	108	85	100	4 lbs
UACCT.090090	90	3½	306	217	132	93	118	7.5 lbs
UACCT.110110	110	4½	277	214	206	73	154	10 lbs
UACCT.140140	140	5	Special	Order				
UACCT.160160	160	6	484	352	265	133.5	221	36.7 lbs
UACCT.200200	200	8	Coming	Soon				
UACCT.250250	250	10	Coming	Soon				



Tee with FNPT Branch Line 232 PSI (16 bar)

Part No.	Size mm	Size Inches	A	B	E	L	S	Weight
UACFT.020015N	20 x ½" x 20	¾ x ½ x ¾	101	48	37	35	29	3.4 oz
UACFT.025020N	25 x ¾" x 25	1 x ¾ x 1	111	57	42	37	36	4.7 oz
UACFT.032025N	32 x 1" x 32	1¼ x 1 x 1¼	136	70	51	46	43	7.8 oz
UACFT.040032N	40 x 1¼" x 40	1½ x 1¼ x 1½	162	78	63	57	53	12.8 oz
UACFT.050040N	50 x 1½" x 50	2 x 1½ x 2	206	95	78.5	66	66	1.6 lbs
UACFT.063050N	63 x 2" x 63	2½ x 2 x 2½	230	114	95	83	82	2.5 lbs



90° with MNPT 232 PSI (16 bar)

Part No.	Size mm	Size Inches	A	B	E	L	S	Weight
UACM9.020015N	20 x ½"	¾ x ½	62	48	37	35	29	1.8 oz
UACM9.025015N	25 x ½"	1 x ½	67	56	42	37	36	2.5 oz
UACM9.025020N	25 x ¾"	1 x ¾	67	57	42	37	36	2.6 oz
UACM9.032025N	32 x 1"	1¼ x 1	87	70	51	46	43	4.9 oz
UACM9.040032N	40 x 1¼"	1½ x 1¼	105	80	63	57	53	9 oz
UACM9.040040N	40 x 1½"	1½ x 1½	105	78	63	57	53	10 oz
UACM9.040050N	40 x 2"	1½ x 2	111	85	63	57	53	11 oz
UACM9.050040N	50 x 1½"	2 x 1½	126	95	78.5	66	66	14.8 oz
UACM9.063050N	63 x 2"	2½ x 2	159	114	95	83	82	1.8 lbs



MNPT Adapter 232 PSI (16 bar)

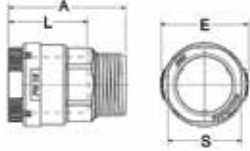

Part No.	Size mm	Size Inches	A	E	S	L	Weight
UACM0.020015N	20 x 1/2"	3/4 x 1/2	49	37	29	35	1.4 oz
UACM0.020020N	20 x 3/4"	3/4 x 3/4	51.5	37	29	35	1.4 oz
UACM0.025015N	25 x 1/2"	1 x 1/2	55	42	36	37	2 oz
UACM0.025020N	25 x 3/4"	1 x 3/4	55	42	36	37	2 oz
UACM0.025025N	25 x 1"	1 x 1	60.5	42	36	37	2 oz
UACM0.032025N	32 x 1"	1 1/4 x 1	68	51	43	46	3.9 oz
UACM0.032032N	32 x 1 1/4"	1 1/4 x 1 1/4	70	51	43	46	3.9 oz
UACM0.040032N	40 x 1 1/4"	1 1/2 x 1 1/4	81	63	53	57	6.5 oz
UACM0.040040N	40 x 1 1/2"	1 1/2 x 1 1/2	81	63	53	57	6.5 oz
UACM0.050040N	50 x 1 1/2"	2 x 1 1/2	92	78.5	66	68	11.2 oz
UACM0.050050N	50 x 2"	2 x 2	95.5	78.5	66	68	11.2 oz
UACM0.063050N	63 x 2"	2 1/2 x 2	119	95	82	83	1.2 lbs
UACM0.063063N	63 x 2 1/2"	2 1/2 x 2 1/2	121	95	82	83	1.2 lbs
UACM0.075063N	75 x 2 1/2"	3 x 2 1/2	122.9	108	100	85.4	1.4 lbs
UACM0.090075N	90 x 3"	3 1/2 x 3	130	132	118	93	2.2 lbs

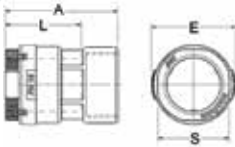

FNPT Adapter 232 PSI (16 bar)

Part No.	Size mm	Size Inches	A	E	L	S	Weight
UACF0.020015N	20 x 1/2"	3/4 x 1/2	55	37	35	29	2 oz
UACF0.025020N	25 x 3/4"	1 x 3/4	57	42	37	36	2.3 oz
UACF0.032025N	32 x 1"	1 1/4 x 1	69	51	46	43	4.1 oz
UACF0.040032N	40 x 1 1/4"	1 1/2 x 1 1/4	80	63	57	53	8.1 oz
UACF0.050040N	50 x 1 1/2"	2 x 1 1/2	95	78	66	66	11.6 oz
UACF0.063050N	63 x 2"	2 1/2 x 2	120	95	83	82	1.4 lbs

Reducer (fitting x pipe) 232 PSI (16 bar)

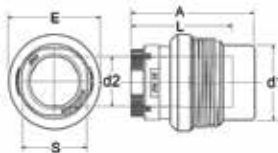

Part No.	Size Fitting d1 mm	Size Outlet d2 mm	Size Fitting d1 Inches	Size Outlet d2 Inches	A	E	L	S	Weight
UASC0.025020	25	20	1	3/4	46	33	35	29	1.8 oz
UASC0.032020	32	20	1 1/4	3/4	Coming	Soon			
UASC0.032025	32	25	1 1/4	1	52.6	42	37	36	2.9 oz
UASC0.040020	40	20	1 1/2	3/4	59.5	52	35	29	5.4 oz
UASC0.040025	40	25	1 1/2	1	60.6	52	37	36	6.1 oz
UASC0.040032	40	32	1 1/2	1 1/4	54.6	52	46	43	4.2 oz
UASC0.050032	50	32	2	1 1/4	Coming	Soon			
UASC0.050040	50	40	2	1 1/2	73	64.8	57	53	8.5 oz
UASC0.063040	63	40	2 1/2	1 1/2	86.3	79.5	57	53	13.9 oz
UASC0.063050	63	50	2 1/2	2	84	79.5	68	66	14.7 oz
UASC0.075063	75	63	3	2 1/2	93	108	85	100	1.3 lbs
UASC0.090063	90	63	3 1/2	2 1/2	111.8	114	83	82	2.5 lbs
UASC0.090075	90	75	3 1/2	3	115	114	85.4	100	2.3 lbs
UASC0.110090	110	90	4 1/2	3 1/2	117	123	93	118	2.8 lbs
UASC0.140110	140	110	5	4 1/2	Special	Order			
UASC0.160110	160	110	6	4 1/2	175	200	73	154	5.7 lbs
UASC0.200160	200	160	8	6	Coming	Soon			
UASC0.250200	250	200	10	8	Coming	Soon			

Flange Adapter 232 PSI (16 bar)

Part No.	Size mm	Size Inches	A	B	E	F	G	M	L	S	Weight
UACJF.090075	90 x 3"	3½ x 3	110	95	NA	20	NA	190	93	130	4.0 lbs
UACJF.110100	110 x 4"	4½ x 4	99	73	206	18	220	180	75	154	5.5 lbs
UACJF.140125	140 x 5"	5 x 5	Special	Order							
UACJF.160150	160 x 6"	6 x 6	184	171	221	23.5	283	240.5	133.5	221	16.4 lbs
UACJF.200200	200 x 8"	8 x 8	Coming	Soon							
UACJF.250250	250 x 10"	10 x 10	Coming	Soon							

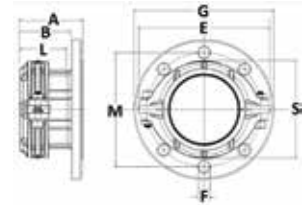
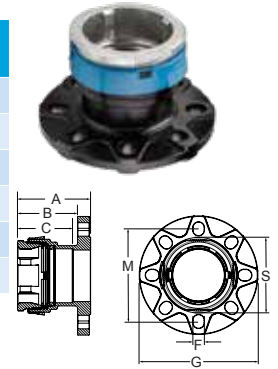

Special Flange (fitting x flange adapter) Elbow or Tee 232 PSI (16 bar)

Part No.	Pipe Size mm	Pipe Size Inches	Flange Description	A	B	F	M	S	Weight
UAZJF.110100	110	4½	DN100 - 4"	220	*	18	180	*	
UAZJF.140125	140	5	DN125 - 5"	Special	Order				
UAZJF.160150	160	6	d	283	39	23.5	240.5	186	
UAZJF.200200	200	8	DN200 - 8"	Coming	Soon				
UAZJF.250250	250	10	DN250 - 10"	Coming	Soon				

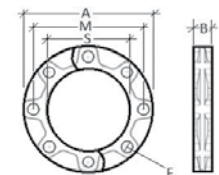

Wall Mounted Drop End 232 PSI (16 bar)

Part No.	Inlet Ømm spigot	Outlet G	No of outlets	A	B	F	G	M	Weight
UASFS.025015N	25	½"	1	99	72	6	24	83	5.1 oz
UASFD.025015N	25	½"	2	99	72	6	24	83	5.7 oz

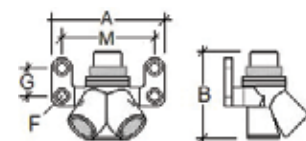

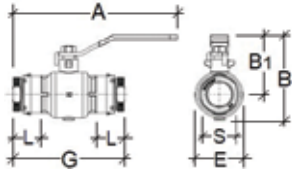

Ball Valve (pipe x pipe) 232 PSI (16 bar)

Part No.	Pipe - Pipe mm	Pipe - Pipe Inches	A	B	E	G	L	L	Weight
UACCV.020020	20	¾	131	73	40	99	35	35	8.1 oz
UACCV.025020	25 x 20	1 x ¾	131	73	40	102	37	37	8.4 oz
UACCV.025025	25	1	150	87	50	110.5	37	37	13.4 oz
UACCV.032032	32	1¼	203	111	61	137	46	46	1.5 lbs
UACCV.040040	40	1½	213	121	72	169	57	57	2.1 lbs
UACCV.050050	50	2	282	156	89	200	68	68	3.5 lbs
UACCV.063063	63	2½	306	176	109	253.5	83	83	6 lbs

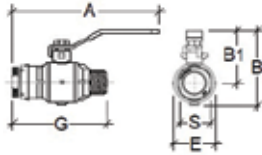

Ball Valve - (pipe x MNPT) 232 PSI (16 bar)

Part No.	Pipe mm - Thread	Pipe Inches - Thread	A	B	E	G	L	S	Weight
UACMV.020015N	20 x ½"	¾ x ½	131	73	40	94	35	29	7.4 oz
UACMV.025020N	25 x ¾"	1 x ¾	150	87	50	104.5	37	36	12.2 oz
UACMV.032025N	32 x 1"	1¼ x 1	203	111	61	132	46	43	1.3 lbs
UACMV.040032N	40 x 1¼"	1½ x 1¼	213	121	72	145.5	57	53	1.9 lbs
UACMV.050040N	50 x 1½"	2 x 1½	282	156	89	187.5	68	66	3.2 lbs
UACMV.063050N	63 x 2"	2½ x 2	306	176	109	217	83	82	5.5 lbs



Three Way Ball Valve 232 PSI (16 bar)

Part No.	Pipe mm	Pipe Inches	A	B	E	G	L	S
UACCVT.032032	32	1¼	Coming	Soon				
UACCVT.040040	40	1½	Coming	Soon				
UACCVT.050050	50	2	Coming	Soon				
UACCVT.063063	63	2½	Coming	Soon				

The Versatile Unipipe Wall Mounted Drop End

The versatile wall outlet (single or double) can be direct coupled with any of these fixtures;

- Coupling
- Tee (horizontal or vertical)
- Elbow
- Valve

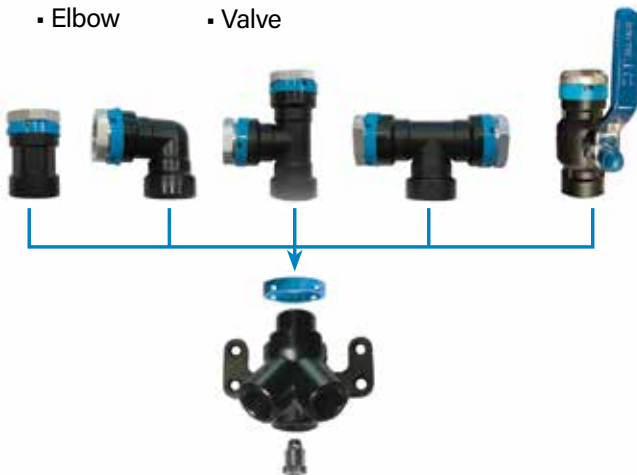

1. I.D. Ring
2. Outlet
3. Purge Valve



Wall Mounted Drop End Assembly - Single Port 232 PSI (16 bar)

Part No.	Size mm	Size Inches	Description	Weight
UASFSB.020015N	20	¾	Wall Mounted Drop End Assembly - Single Port UnipipeAIR	13.5 oz
UASFSB.025015N	25	1	Wall Mounted Drop End Assembly - Single Port UnipipeAIR	19.2 oz

Assemblies Consist of:

UASFSB.020015N	UASFSB.025015N
(1) UASFS.025015N	(1) UASFS.025015N
(1) UACCV.025020	(1) UACCV.025025



Wall Mounted Drop End Assembly - Double Port 232 PSI (16 bar)

Part No.	Size mm	Size Inches	Description	Weight
UASFDB.020015N	20	¾	Wall Mounted Drop End Assembly - Double Port UnipipeAIR	14.1 oz
UASFDB.025015N	25	1	Wall Mounted Drop End Assembly - Double Port UnipipeAIR	19.2 oz

Assemblies Consist of:

UASFDB.020015N	UASFDB.025015N
(1) UASFD.025015N	(1) UASFD.025015N
(1) UACCV.025020	(1) UACCV.025025



Wall Mounted Drop End Assembly - Single Port with Quick Disconnect 232 PSI (16 bar)

Part No.	Size mm	Size Inches	Description	Weight
UASFSBQ.020015N	20	¾	Wall Mounted Drop End Assembly - Single Port with Quick Disconnect UnipipeAIR	20.8 oz
UASFSBQ.025015N	25	1	Wall Mounted Drop End Assembly - Single Port with Quick Disconnect UnipipeAIR	27.2 oz

Assemblies Consist of:

UASFSBQ.020015N	UASFSBQ.025015N
(1) UASFS.025015N	(1) UASFS.025015N
(1) UACCV.025020	(1) UACCV.025025
(1) UAQDCM.250500	(1) UAQDCM.250500



Wall Mounted Drop End Assembly - Double Ports with Quick Disconnects 232 PSI (16 bar)

Part No.	Size mm	Size Inches	Description	Weight
UASFDBQ.020015N	20	¾	Wall Mounted Drop End Assembly - Double Port with Quick Disconnect UnipipeAIR	30.4 oz
UASFDBQ.025015N	25	1	Wall Mounted Drop End Assembly - Double Port with Quick Disconnect UnipipeAIR	35.2 oz

Assemblies Consist of:

UASFDBQ.020015N	UASFDBQ.025015N
(1) UASFD.025015N	(1) UASFD.025015N
(1) UACCV.025020	(1) UACCV.025025
(2) UAQDCM.250500	(2) UAQDCM.250500



ACCESSORIES

For use with: UnipipeAIR ▪ UnipipeNITRO ▪ UnipipeVAC ▪ UnipipeHP ▪ UnipipeOIL

Fitting Plug with Purge Valve



Part No.	Plug mm	Plug Inches	Pressure bar	Pressure PSI	Weight
UASV0.020008	20	¾	70	1015	1.1 oz
UASV0.025008	25	1	70	1015	1.4 oz
UASV0.032008	32	1¼	70	1015	2 oz
UASV0.040008	40	1½	70	1015	3.2 oz
UASV0.050008	50	2	70	1015	5.8 oz
UASV0.063008	63	2½	70	1015	10 oz
UASV0.075008	75	3	Coming	Soon	10.9 oz
UASV0.090008	90	3½	16	232	12.1 oz
UASV0.110008	110	4½	16	232	14.5 oz
UASV0.140008	140	5	Special	Order	1.9 lbs
UASV0.160008	160	6	16	232	2.7 lbs
UASV0.200008	200	8	Coming	Soon	
UASV0.250008	250	10	Coming	Soon	

Saddle Branch (pipe x FNPT) 580 PSI (40 bar) /232 PSI (16 bar)



Part No.	Size mm	Size Inches	psi	A	A1	A2	B	B1	B2	C	Weight
UCHF0.025015N	25 x ½"	1 x ½	580	62	25	37	51	17.5	17.5	33	2.5 oz.
UCHF0.032015N	32 x ½"	1¼ x ½	580	75	32	42.5	57.5	21.5	21.5	33	3.2 oz
UCHF0.040015N	40 x ½"	1½ x ½	580	89.5	41	48.5	69.5	27	27	47	5.7 oz
UCHF0.040020N	40 x ¾"	1½ x ¾	580	89.5	41	48.5	69.5	27	27	47	5.4 oz
UCHF0.050015N	50 x ½"	2 x ½	580	102	46.5	55.5	84	32	32	47	7.7 oz
UCHF0.050020N	50 x ¾"	2 x ¾	580	102	46.5	55.5	84	32	32	47	7.2 oz
UCHF0.050025N	50 x 1"	2 x 1	580	102	46.5	55.5	84	32	32	47	6.6 oz
UCHF0.063015N	63 x ½"	2½ x ½	580	122	58	64	99	40	40	58	12.9 oz
UCHF0.063020N	63 x ¾"	2½ x ¾	580	122	58	64	99	40	40	58	12.6 oz
UCHF0.063025N	63 x 1"	2½ x 1	580	122	58	64	99	40	40	58	11.8 oz
UCHF0.075025N	75 x 1"	3 x 1	232	121.6	67.8	53.8	110.5	44.8	65.7	60	9.9 oz
UCHF0.075050N	75 x 2"	3 x 2	232	121.6	67.8	53.8	122.1	44.8	77.3	80	14.1 oz
UCHF0.090025N	90 x 1"	3½ x 1	232	159.5	71.5	88	130	53	53	66	1.1 lbs
UCHF0.090050N	90 x 2"	3½ x 2	232	159.5	71.5	88	130	53	53	66	1.3 lbs
UCHF0.110025N	110 x 1"	4½ x 1	232	179.5	81	98	150	65	65	66	1.3 lbs
UCHF0.110050N	110 x 2"	4½ x 2	232	179.5	81	98	150	65	65	80	2.5 lbs
UCHF0.110075N	110 x 3"	4½ x 3	232	179.5	81	98	150	65	65	122	3.4 lbs
UCHF0.140050N	140 x 2"	5 x 2	Special	Order							
UCHF0.140075N	140 x 3"	5 x 3	Special	Order							
UCHF0.160050N	160 x 2"	6 x 2	232	263	120.5	142.5	210.5	91.5	119	121	4.3 lbs
UCHF0.160075N	160 x 3"	6 x 3	232	263	120.5	142.5	227	91.5	135.5	122	4.4 lbs
UCHF0.200050N	200 x 2"	8 x 2	Coming	Soon							
UCHF0.200075N	200 x 3"	8 x 3	Coming	Soon							
UCHF0.250050N	250 x 2"	10 x 2	Coming	Soon							
UCHF0.200075N	250 x 3"	10 x 3	Coming	Soon							

Branch (pipe x pipe) 580 PSI (40 bar)

Part No.	Size mm	Size Inches	A	A1	A2	B	B1	B2	C	S	Weight
UCIC0.025020	25 x 20	1 x ¾"	113	76.5	36.5	70	52.5	17.5	33	29	5.8 oz
UCIC0.032020	32 x 20	1¼ x ¾"	126	83.5	42.5	81	59.5	21.5	33	29	6.6 oz
UCIC0.040020	40 x 20	1½ x ¾"	142	94	48	100	73	27	38	29	12.3 oz
UCIC0.040025	40 x 25	1½ x 1"	143	95	48	100	73	27	38	36	11.4 oz
UCIC0.050020	50 x 20	2 x ¾"	150	94.5	55.5	112	80.5	31.5	38.5	29	13.7 oz
UCIC0.050025	50 x 25	2 x 1"	150	94.5	55.5	112.5	80.5	31.5	38.5	36	1.3 lbs
UCIC0.063020	63 x 20	2½ x ¾"	172	108	64	131.5	92	39.5	38	29	1.3 lbs
UCIC0.063025	63 x 25	2½ x 1"	174	110	64	131.5	92	39.5	38	36	1.2 lbs



Female Threaded Branch 580 PSI (40 bar)

Part No.	Size mm	Size Inches	A	A1	A2	B	B1	B2	C	S	Weight
UCIF0.025015N	25 x ½"	1 x ½"	113	76.5	36.5	70	52.5	17.5	33	29	5.8 oz
UCIF0.032015N	32 x ½"	1¼ x ½"	126	83.5	42.5	81	59.5	21.5	33	29	6.6 oz
UCIF0.040015N	40 x ½"	1½ x ½"	142	94	48	100	73	27	38	29	12.3 oz
UCIF0.040020N	40 x ¾"	1½ x ¾"	143	95	48	100	73	27	38	36	11.4 oz
UCIF0.050015N	50 x ½"	2 x ½"	150	94.5	55.5	112	80.5	31.5	38.5	29	13.7 oz
UCIF0.050020N	50 x ¾"	2 x ¾"	150	94.5	55.5	112.5	80.5	31.5	38.5	36	1.3 lbs
UCIF0.063015N	63 x ½"	2½ x ½"	172	108	64	131.5	92	39.5	38	29	1.3 lbs
UCIF0.063020N	63 x ¾"	2½ x ¾"	174	110	64	131.5	92	39.5	38	36	1.2 lbs

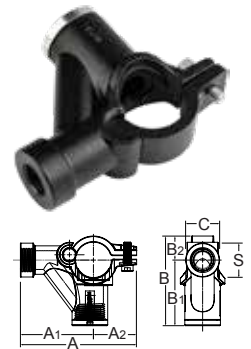

Offset Nipple 1015 PSI (70 bar)

Part No.	G	A	B	C	F	S	Weight
UCMMG.015015N	½" x ½"	56	40	20	20	19	.9 oz

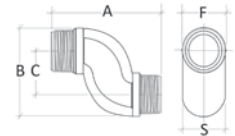

Fitting to Male Threaded Connector 1015 PSI (70 bar)

Part No.	Size mm	Size Inches	Description	A	B	S	Weight
UCSM0.020015N	20 x ½"	¾ x ½"	Fitting to Male Threaded Connector	45.5	28	25	1.2 oz
UCSM0.025020N	25 x ¾"	1 x ¾"	Fitting to Male Threaded Connector	50	33	30	1.5 oz
UCSM0.032025N	32 x 1"	1¼ x 1"	Fitting to Male Threaded Connector	63	41.5	38	3.2 oz
UCSM0.040032N	40 x 1¼"	1½ x 1¼"	Fitting to Male Threaded Connector	74	52.5	47	5.9 oz
UCSM0.050040N	50 x 1½"	2 x 1½"	Fitting to Male Threaded Connector	87.5	65.5	59	11.5 oz
UCSM0.063050N	63 x 2"	2½ x 2"	Fitting to Male Threaded Connector	109	79.5	74	1.25 lbs
UCSM0.090075N	90 x 3"	3½ x 3"	Fitting to Male Threaded Connector	134	114	100	2.5 lbs



Wall Mounted Manifold 1015 PSI (70 bar)

Part No.	G	G1	Front Ports	A	B	D	All Ports	Weight
UCFFM.015015N	½"	½"	1	50	56	-	4	7.1 oz
UCFFN.015015N	½"	½"	2	102	56	46	5	15.3 oz
UCFFP.015015N	½"	½"	4	154	56	34	7	1.4 lbs

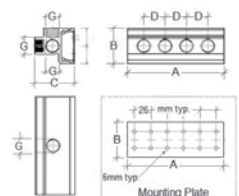

ACCESSORIES

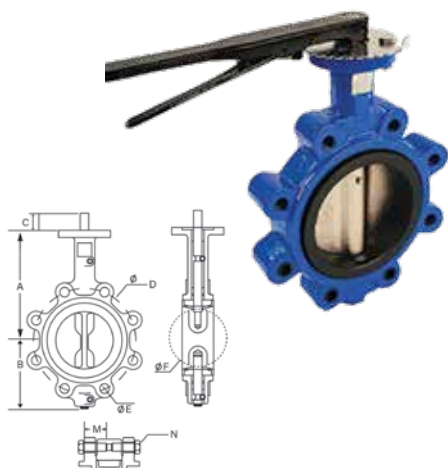

Butterfly Valves 225 PSI (15.5 bar) Lug Style - Epoxy Coated Iron Body with EPDM Seal

Part No.	Size	A	B	C	D	F	M	N	Weight
PP703001	3"	7.13	3.74	1.26	6	3.1	1.5	5/8-11UNC	11 lbs
PP703002	4"	7.87	4.49	1.26	7.5	4.09	1.75	5/8-11UNC	20 lbs
PP703003	5"	8.39	5	1.26	8.5	4.85	1.75	3/4-10UNC	24 lbs
PP703004	6"	8.9	5.47	1.26	9.51	6.13	2	3/4-10UNC	31 lbs
PP703005	8"	10.24	6.89	1.61	11.75	7.97	2	3/4-10UNC	40 lbs
PP703006	10"	11.5	3.74	1.26	6	9.86	2.25	7/8-9UNC	59 lbs



Drip Leg Valve 360 PSI (25 bar)

Part No.	Size	Description	A (in)	B (in)	Weight
DLVE15N	1/2"	Drip Leg Valve - 1/2 MNPT	1	0.82	1.6 oz



Brass Ball Valves - Male x Female 600 PSI (41 bar)

Part No.	Size	Description	A (in)	B (in)	C (in)	Weight
6510120	1/2" NPT	1/2" Male x Female, Full Flow Type	2.5	1.81	3.46	7.2 oz
6510160	3/4" NPT	3/4" Male x Female, Full Flow Type	3	2.09	4.29	12.3 oz
6510200	1" NPT	1" Male x Female, Full Flow Type	3.27	2.25	4.29	1.2 lbs

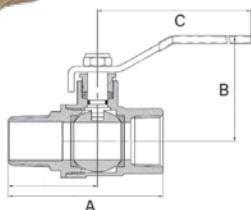

Brass Ball Valves - Female x Female 600 PSI (41 bar)

Part No.	Size	Description	A (in)	B (in)	C (in)	Weight
6510100	1/2" NPT	1/2" Female x Female, Full Flow Type	2.24	1.81	3.46	7 oz
6510140	3/4" NPT	3/4" Female x Female, Full Flow Type	2.52	2.09	4.29	12 oz
6510180	1" NPT	1" Female x Female, Full Flow Type	2.97	2.25	4.29	1.1 lbs
6510220	1 1/4" NPT	1 1/4" Female x Female, Full Flow Type	3.44	2.52	5.63	1.7 lbs
6510240	1 1/2" NPT	1 1/2" Female x Female, Full Flow Type	3.88	2.74	5.63	2.3 lbs
6510260	2" NPT	2" Female x Female, Full Flow Type	4.3	3.03	5.63	3.4 lbs
6510270	2 1/2" NPT	2 1/2" Female x Female, Full Flow Type	5.53	4.25	7.76	7.4 lbs
6510280	3" NPT	3" Female x Female, Full Flow Type	6.14	4.58	8.19	9.9 lbs

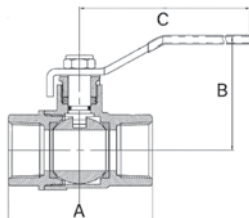

Standard Industrial Quick Disconnect Nipple - Male 600 PSI (41 bar)

Part No.	Description	Weight
UAQDNM.250250	Standard Industrial Quick Disconnect Nipple - 1/4" Body and 1/4" Male NPT Threads	3 oz
UAQDNM.250375	Standard Industrial Quick Disconnect Nipple - 1/4" Body and 3/8" Male NPT Threads	3 oz
UAQDNM.500375	Standard Industrial Quick Disconnect Nipple - 1/2" Body and 3/8" Male NPT Threads	4 oz
UAQDNM.500500	Standard Industrial Quick Disconnect Nipple - 1/2" Body and 1/2" Male NPT Threads	4 oz



Standard Industrial Quick Disconnect Nipple - Female 600 PSI (41 bar)

Part No.	Description	Weight
UAQDNF.250250	Standard Industrial Quick Disconnect Nipple - 1/4" Body and 1/4" Female NPT Threads	3 oz
UAQDNF.250375	Standard Industrial Quick Disconnect Nipple - 1/4" Body and 3/8" Female NPT Threads	3 oz
UAQDNF.500375	Standard Industrial Quick Disconnect Nipple - 1/2" Body and 3/8" Female NPT Threads	4 oz
UAQDNF.500500	Standard Industrial Quick Disconnect Nipple - 1/2" Body and 1/2" Female NPT Threads	4 oz



Universal Quick Disconnect Coupling - Male 600 PSI (41 bar)

Part No.	Description	Weight
UAQDCM.250250	Universal Quick Disconnect Coupling - 1/4" Body and 1/4" Male NPT Threads	4 oz
UAQDCM.250375	Universal Quick Disconnect Coupling - 1/4" Body and 3/8" Male NPT Threads	6 oz
UAQDCM.250500	Universal Quick Disconnect Coupling - 1/4" Body and 1/2" Male NPT Threads	8 oz
UAQDCM.500500	Universal Quick Disconnect Coupling - 1/2" Body and 1/2" Male NPT Threads	10 oz



Wall Mounted Drop End Adapter Plate Includes Hardware

Part No.	Description	Weight
UAWMDA.375	Wall Mounted Drop End Adapter Plate	2 oz



ACCESSORIES



Galvanized Loop Hanger

Part No.	Size mm	Size Inches	Description	Weight
CLH20	20	¾	20mm Galvanized Loop Hanger	1.2 oz
CLH25	25	1	25mm Galvanized Loop Hanger	1.3 oz
CLH32	32	1¼	32mm Galvanized Loop Hanger	1.3 oz
CLH40	40	1½	40mm Galvanized Loop Hanger	1.5 oz
CLH50	50	2	50mm Galvanized Loop Hanger	1.7 oz
CLH63	63	2½	63mm Galvanized Loop Hanger	4.4 oz
CLH75	75	3	75mm Galvanized Loop Hanger	4.9 oz
CLH90	90	3½	90mm Galvanized Loop Hanger	5.4 oz
CLH110	110	4½	110mm Galvanized Loop Hanger	5.9 oz
CLH160	160	6	160mm Galvanized Loop Hanger	10.0 oz



Wire Hangers

Part No.	Size	Description	Weight
AWHG.250010	1/4"	1/4" Stud Crimped onto 5/64" Cable 100lb Load Rated	3.2 oz
AWHG.2SE385010	3/8"	3/8" Stud Side Exit Wire Grip and Looped 5/64" Cable 120lb Load Rated	4.8 oz
AWHG.385010	3/8"	3/8" Stud Crimped onto 5/64" Cable 100lb Load Rated	3.5 oz
AWHG.3SE385010	3/8"	3/8" Stud Side Exit Wire Grip and Looped 1/8" Cable 240lb Load Rated	8 oz

Polypropylene Clips



Part No.	Size mm	Size Inches	Description	Weight
CL 20	20	¾	Polypropylene Clip	.2 oz
CL 25	25	1	Polypropylene Clip	.3 oz
CL 32	32	1¼	Polypropylene Clip	.4 oz
CL 40	40	1½	Polypropylene Clip	.6 oz
CL 50	50	2	Polypropylene Clip	.8 oz
CL 63	63	2½	Polypropylene Clip	1.2 oz
CL 75	75	3	Polypropylene Clip	Coming Soon
CL 90	90	3½	Polypropylene Clip	4.4 oz
CL 110	110	4½	Polypropylene Clip	Coming Soon

Insulated Zinc Bolted Clip Heads



Part No.	Size mm	Size Inches	Description	Weight
HSBC20M10INS	20	¾	Insulated Zinc Bolted Clip Head ¾"	2.8 oz
HSBC25M10INS	25	1	Insulated Zinc Bolted Clip Head 1"	2.8 oz
HSBC32M10INS	32	1¼	Insulated Zinc Bolted Clip Head 1¼"	3.4 oz
HSBC40M10INS	40	1½	Insulated Zinc Bolted Clip Head 1½"	3.4 oz
HSBC50M10INS	50	2	Insulated Zinc Bolted Clip Head 2"	3.5 oz
HSBC63M10INS	63	2½	Insulated Zinc Bolted Clip Head 2½"	3.9 oz
HSBC75M10INS	75	3	Insulated Zinc Bolted Clip Head 3"	4.3 oz
HSBC90M10INS	90	3½	Insulated Zinc Bolted Clip Head 3½"	5.6 oz
HSBC108M10INS	110	4½	Insulated Zinc Bolted Clip Head 4½"	1.3 lbs
HSBC140M10INS	140	5	Insulated Zinc Bolted Clip Head 5"	Special Order
HSBC168M10INS	160	6	Insulated Zinc Bolted Clip Head 6"	1.5 lbs
HSBC200M10INS	200	8	Insulated Zinc Bolted Clip Head 8"	Coming Soon
HSBC250M10INS	250	10	Insulated Zinc Bolted Clip Head 10"	Coming Soon

Mounting Accessories

Part No.	Size	Description	Weight
CBC3/8	3/8"	3/8" Galvanized Standard Throat Beam Clamp	4.8 oz
HSCMP10	3/8"	Mounting Plate M10 Female	2.7 oz
HSCMMP10	3/8"	Mounting Plate M10 Male	3.4 oz
HSROD10	3/8"	All thread Zinc Plated	N/A



Reducing Bushing

Part No.	Size	Description
PBMV.015010N	1/2" x 3/8"	Reducing Bushing - Brass
PBMV.015008N	1/2" x 1/4"	Reducing Bushing - Brass
PBMV.020015N	3/4" x 1/2"	Reducing Bushing - Galvanized
PBMV.025015N	1" x 1/2"	Reducing Bushing - Galvanized
PBMV.025020N	1" x 3/4"	Reducing Bushing - Galvanized
PBMV.032020N	1 1/4" x 3/4"	Reducing Bushing - Galvanized
PBMV.032025N	1 1/4" x 1"	Reducing Bushing - Galvanized
PBMV.040025N	1 1/2" x 1"	Reducing Bushing - Galvanized
PBMV.040032N	1 1/2" x 1 1/4"	Reducing Bushing - Galvanized
PBMV.050025N	2" x 1"	Reducing Bushing - Galvanized
PBMV.050032N	2" x 1 1/4"	Reducing Bushing - Galvanized
PBMV.050040N	2" x 1 1/2"	Reducing Bushing - Galvanized
PBMV.075040N	3" x 1 1/2"	Reducing Bushing - Galvanized
PBMV.075050N	3" x 2"	Reducing Bushing - Galvanized



Fitting to Fitting Hose Connector

Part No.	Size mm	Size Inches	Description
UASS0.020045N	20	3/4	18" Fitting to Fitting Hose Connector
UASS0.025045N	25	1	18" Fitting to Fitting Hose Connector
UASS0.032060N	32	1 1/4	24" Fitting to Fitting Hose Connector
UASS0.040060N	40	1 1/2	24" Fitting to Fitting Hose Connector
UASS0.050090N	50	2	36" Fitting to Fitting Hose Connector
UASS0.063090N	63	2 1/2	36" Fitting to Fitting Hose Connector



Fitting Nut

Part No.	Size mm	Size Inches	Description
UANE20	20mm	3/4	Fitting Nut
UANE25	25mm	1	Fitting Nut
UANE32	32mm	1 1/4	Fitting Nut
UANE40	40mm	1 1/2	Fitting Nut
UANE50	50mm	2	Fitting Nut
UANE63	63mm	2 1/2	Fitting Nut



ACCESSORIES

Stainless Steel Clamp Ring



Part No.	Size mm	Size Inches	Description
UACRE20	20	¾	Stainless Steel Clamp Ring
UACRE25	25	1	Stainless Steel Clamp Ring
UACRE32	32	1¼	Stainless Steel Clamp Ring
UACRE40	40	1½	Stainless Steel Clamp Ring
UACRE50	50	2	Stainless Steel Clamp Ring
UACRE63	63	2½	Stainless Steel Clamp Ring
UACRE75	75	3	Stainless Steel Clamp Ring
UACRE90	90	3½	Stainless Steel Clamp Ring
UACRE110	110	4½	Stainless Steel Clamp Ring
UACRE160	160	6	Stainless Steel Clamp Ring

Fitting O-Ring



Part No.	Size mm	Size Inches	Description
OREHNBR.020	20	¾	Fitting O-Ring
OREHNBR.025	25	1	Fitting O-Ring
OREHNBR.032	32	1¼	Fitting O-Ring
OREHNBR.040	40	1½	Fitting O-Ring
OREHNBR.050	50	2	Fitting O-Ring
OREHNBR.063	63	2½	Fitting O-Ring
OREHNBR.075	75	3	Fitting O-Ring
OREHNBR.090	90	3½	Fitting O-Ring
OREHNBR.110	110	4½	Fitting O-Ring
OREHNBR.160	160	6	Fitting O-Ring

Flange Gasket



Part No.	Size mm	Size Inches	Description
FGMV.090075	90	3½	Flange Gasket
FGMV.110100	110	4½	Flange Gasket
FGMV.160150	160	6	Flange Gasket

Locking Ball Valve Handle



Part No.	Size mm	Size Inches	Description
LBVHE20	20	¾	Locking Ball Valve Handle
LBVHE25	25	1	Locking Ball Valve Handle
LBVHE32	32	1¼	Locking Ball Valve Handle
LBVHE40	40	1½	Locking Ball Valve Handle
LBVHE50	50	2	Locking Ball Valve Handle
LBVHE63	63	2½	Locking Ball Valve Handle

Unipipe Hose Reels



Part No.	Size	Weight	Description
HRHT-250035	1/4" x 35'	25 lbs	Locking Ball Valve Handle
HRHT-250050	1/4" x 50'	30 lbs	Locking Ball Valve Handle
HRHT-375035	3/8" x 35'	28 lbs	Locking Ball Valve Handle
HRHT-375050	3/8" x 50'	50 lbs	Locking Ball Valve Handle
HRHT-375070	3/8" x 70'	54 lbs	Locking Ball Valve Handle
HRHT-500050	1/2" x 50'	57 lbs	Locking Ball Valve Handle

Pipe Cutters

Part No.	Size mm	Description
PC35/SS	15 - 35	Rotary pipe cutter Cu/ Al /SS, built in deburrer
PC76/SS	15-76	Rotary pipe cutter Cu/ Al /SS, built in deburrer
PC140	54 - 108	Rotary pipe cutter Cu/ Al /SS, built in deburrer
PEC170E	15 - 170	Powerful, lightweight and handy PipeCut 170E can be used for cutting both metal and plastic pipes. Because of its adjustable speed and steady torque feature it is ideal for cutting aluminum or stainless steel. The gripper arms adjust to the pipe diameter and keep the cut square to the pipe.



Miscellaneous Tools

Part No.	Size mm	Description
TIU160	20 - 160	Depth gauge for marking correct insertion
TR05	15 - 54	Multi reamer inside and outside. Hand operated or with adapter can be used with cordless drill
TRS05	15 - 54	Power tool adaptor for TR05
66980402	20 - 160	ID (Interior Diameter) Deburring Tool
66980503	20 - 160	OD (Outside Diameter) Deburring Tool
DTE14	14mm	Drilling Tool
DTE19	19mm	Drilling Tool
DTE24	24mm	Drilling Tool
DTE48	48mm	Drilling Tool
DTE79	79mm	Drilling Tool
WFN20	20mm	Wrench
WFN25	25mm	Wrench
WFN32	32mm	Wrench
WFN40	40mm	Wrench
WFN50	50mm	Wrench
WFN63	63mm	Wrench
WFN75	75mm	Wrench
WFN90	90mm	Wrench





Unipipe Pipe 232 PSI (16 bar)

Part No.	Size mm	Size inches	Wall Thickness mm	Length m	Length Feet	Weight
UWTT0.020600	20	¾	1.0	5.8	19	2 oz
UWTT0.025600	25	1	1.1	5.8	19	2.3 oz
UWTT0.040600	40	1½	1.3	5.8	19	8.1 oz
UWTT0.050600	50	2	1.4	5.8	19	11.6 oz
UWTT0.063600	63	2½	1.8	5.8	19	1.4 lbs



Unipipe Pipe UPS Shipping 232 PSI (16 bar)

Part No.	Size mm	Size inches	Wall Thickness mm	Length m	Length Feet	Weight
CUWTT0.020250	20	¾	1.0	2.5	8	2 oz
CUWTT0.025250	25	1	1.1	2.5	8	2.3 oz
CUWTT0.040250	40	1½	1.3	2.5	8	8.1 oz
CUWTT0.050250	50	2	1.4	2.5	8	11.6 oz

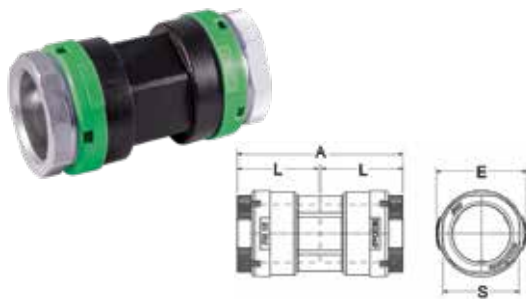

Straight Coupling 232 PSI (16 bar)

Part No.	Size mm	Size Inches	A	L	E	S	Weight
UWCC0.020020	20	¾	70	35	37	29	2.5 oz
UWCC0.025025	25	1	75	37	42	36	3.4 oz
UWCC0.040040	40	1½	117	57	63	53	11.9 oz
UWCC0.050050	50	2	138	68	78.5	66	1.2 lbs
UWCC0.063063	63	2½	173	83	95	82	2.2 lbs

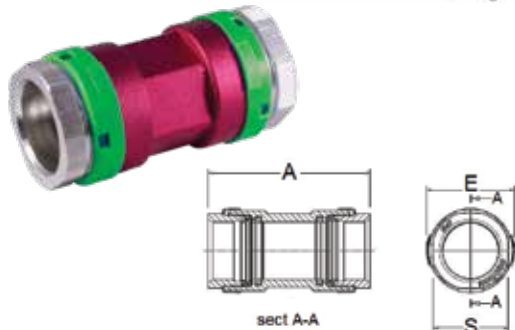

Sliding Straight Coupling 232 PSI (16 bar)

Part No.	Size mm	Size Inches	A	E	S	Weight
UWCC1.020020	20	¾	70	37	29	2.5 oz
UWCC1.025025	25	1	75	42	36	3.4 oz
UWCC1.040040	40	1½	117	63	53	11.9 oz
UWCC1.050050	50	2	138	78.5	66	1.2 lbs
UWCC1.063063	63	2½	173	95	82	2.2 lbs



90° Elbow 232 PSI (16 bar)

Part No.	Size mm	Size Inches	A	E	L	S	Weight
UWCC9.020020	20	¾	60	37	35	29	3 oz
UWCC9.025025	25	1	76	42	37	36	4 oz
UWCC9.040040	40	1½	112	63	57	53	1.2 lbs
UWCC9.050050	50	2	143	78.5	68	66	1.5 lbs
UWCC9.063063	63	2½	168	95	83	82	2.4 lbs

45° Elbow 232 PSI (16 bar)

Part No.	Size mm	Size Inches	A	B	E	L	S	Weight
UWCC4.020020	20	¾	85	59	37	35	29	3.2 oz
UWCC4.025025	25	1	95	68	42	37	36	3.9 oz
UWCC4.040040	40	1½	141	101	63	57	53	12 oz
UWCC4.050050	50	2	171	124	78.5	68	66	1.4 lbs
UWCC4.063063	63	2½	207	150	95	83	82	2.3 lbs



Equal Tee 232 PSI (16 bar)

Part No.	Size mm	Size Inches	A	B	E	L	S	Weight
UWCCT.020020	20	¾	101	68	37	35	29	4.3 oz
UWCCT.025025	25	1	111	75	42	37	36	5.7 oz
UWCCT.040040	40	1½	162	110	63	57	53	1 lb
UWCCT.050050	50	2	206	141	78.5	68	66	2 lbs
UWCCT.063063	63	2½	230	160	95	83	82	3.1 lbs



Tee with FNPT Branch Line 232 PSI (16 bar)

Part No.	Size mm	Size Inches	A	B	E	L	S	Weight
UWCFT.020015N	20 x ½" x 20	¾ x ½ x ¾	101	48	37	35	29	3.4 oz
UWCFT.025020N	25 x ¾" x 25	1 x ¾ x 1	111	57	42	37	36	4.7 oz
UWCFT.040032N	40 x 1¼" x 40	1½ x 1¼ x 1½	162	78	63	57	53	12.8 oz
UWCFT.050040N	50 x 1½" x 50	2 x 1½ x 2	206	95	78.5	66	66	1.6 lbs
UWCFT.063050N	63 x 2" x 63	2½ x 2 x 2½	230	114	95	83	82	2.5 lbs



90° Elbow with MNPT 232 PSI (16 bar)

Part No.	Size mm	Size Inches	A	B	E	L	S	Weight
UWCM9.020015N	20 x ½"	¾ x ½	62	48	37	35	29	1.8 oz
UWCM9.025015N	25 x ½"	1 x ½	67	56	42	37	36	2.5 oz
UWCM9.025020N	25 x ¾"	1 x ¾	67	57	42	37	36	2.6 oz
UWCM9.040032N	40 x 1¼"	1½ x 1¼	105	78	63	57	53	9 oz
UWCM9.040040N	40 x 1½"	1½ x 1½	105	78	63	57	53	10 oz
UWCM9.040050N	40 x 2"	1½ x 2	111	85	63	57	53	11 oz
UWCM9.050040N	50 x 1½"	2 x 1½	126	95	78.5	66	66	14.8 oz
UWCM9.063050N	63 x 2"	2½ x 2	159	114	95	83	82	1.8 lbs



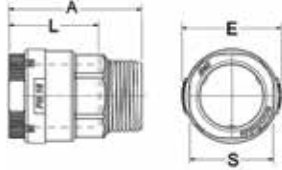

MNPT Adapter 232 PSI (16 bar)

Part No.	Size mm	Size Inches	A	E	S	L	Weight
UWCM0.020015N	20 x 1/2"	3/4 x 1/2	49	37	29	35	1.4 oz
UWCM0.020020N	20 x 3/4"	3/4 x 3/4	51.5	37	29	35	1.4 oz
UWCM0.025015N	25 x 1/2"	1 x 1/2	55	42	36	37	2 oz
UWCM0.025020N	25 x 3/4"	1 x 3/4	55	42	36	37	2 oz
UWCM0.025025N	25 x 1"	1 x 1	60.5	42	36	37	2 oz
UWCM0.040032N	40 x 1 1/4"	1 1/2 x 1 1/4	81	63	53	57	6.5 oz
UWCM0.040040N	40 x 1 1/2"	1 1/2 x 1 1/2	81	63	53	57	6.5 oz
UWCM0.050040N	50 x 1 1/2"	2 x 1 1/2	92	78.5	66	68	11.2 oz
UWCM0.050050N	50 x 2"	2 x 2	95.5	78.5	66	68	11.2 oz
UWCM0.063050N	63 x 2"	2 1/2 x 2	119	95	82	83	1.2 lbs
UWCM0.063063N	63 x 2 1/2"	2 1/2 x 2 1/2	121	95	82	83	1.2 lbs

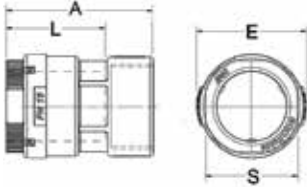

FNPT Adapter 232 PSI (16 bar)

Part No.	Size mm	Size Inches	A	E	L	S	Weight
UWCF0.020015N	20 x 1/2"	3/4 x 1/2	55	37	35	29	2 oz
UWCF0.025020N	25 x 3/4"	1 x 3/4	57	42	37	36	2.3 oz
UWCF0.040032N	40 x 1 1/4"	1 1/2 x 1 1/4	80	63	57	53	8.1 oz
UWCF0.050040N	50 x 1 1/2"	2 x 1 1/2	95	78	66	66	11.6 oz
UWCF0.063050N	63 x 2"	2 1/2 x 2	120	95	83	82	1.4 lbs

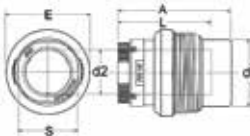

Reducer - (fitting x pipe) 232 PSI (16 bar)

Part No.	Size Fitting d1 mm	Size Outlet d2 mm	Size Fitting d1 Inches	Size Outlet d2 Inches	A	E	L	S	Weight
UWSC0.025020	25	20	1	3/4	46	33	35	29	1.8 oz
UWSC0.040020	40	20	1 1/2	3/4	59.5	52	35	29	5.4 oz
UWSC0.040025	40	25	1 1/2	1	60.6	52	37	36	6.1 oz
UWSC0.040032	40	32	1 1/2	1 1/4	54.6	52	46	43	4.2 oz
UWSC0.050040	50	40	2	1 1/2	73	64.8	57	53	8.5 oz
UWSC0.063040	63	40	2 1/2	1 1/2	86.3	79.5	57	53	13.9 oz
UWSC0.063050	63	50	2 1/2	2	84	79.5	68	66	14.7 oz

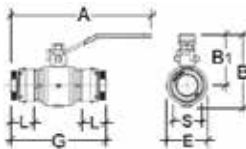

Ball Valve (pipe x pipe) 232 PSI (16 bar)

Part No.	Pipe - Pipe mm	Pipe - Pipe Inches	A	B	E	G	L	S	Weight
UWCCV.020020	20	3/4	131	73	40	99	35	35	8.1 oz
UWCCV.025020	25 x 20	1 x 3/4	131	73	40	102	37	37	8.4 oz
UWCCV.025025	25	1	150	87	50	110.5	37	37	13.4 oz
UWCCV.040040	40	1 1/2	213	121	72	169	57	57	2.1 lbs
UWCCV.050050	50	2	282	156	89	200	68	68	3.5 lbs
UWCCV.063063	63	2 1/2	306	176	109	253.5	83	83	6 lbs

Ball Valve - (pipe x MNPT) 232 PSI (16 bar)

Part No.	Pipe mm - Thread	Pipe Inches - Thread	A	B	E	G	L	S	Weight
UWCMV.020015N	20 x 1/2"	3/4 x 1/2	131	73	40	94	35	29	7.4 oz
UWCMV.025020N	25 x 3/4"	1 x 3/4	150	87	50	104.5	37	36	12.2 oz
UWCMV.040032N	40 x 1 1/4"	1 1/2 x 1 1/4	213	121	72	145.5	57	53	1.9 lbs
UWCMV.050040N	50 x 1 1/2"	2 x 1 1/2	282	156	89	187.5	68	66	3.2 lbs
UWCMV.063050N	63 x 2"	2 1/2 x 2	306	176	109	217	83	82	5.5 lbs

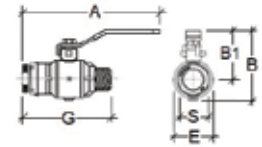

Three Way Ball Valve 232 PSI (16 bar)

Part No.	Pipe mm	Pipe Inches	A	B	E	G	L	S
UWCCVT.040040	40	1 1/2	Coming	Soon				
UWCCVT.050050	50	2	Coming	Soon				



Wall Mounted Drop End 232 PSI (16 bar)

Part No.	Inlet Ømm spigot	Outlet G	No of outlets	A	B	F	G	M	Weight
UASFS.025015N	25	1/2"	1	99	72	6	24	83	5.1 oz
UASFD.025015N	25	1/2"	2	99	72	6	24	83	5.7 oz

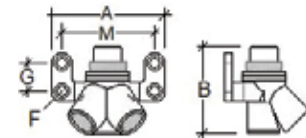

unipipe[®] The Unipipe Advantage

No Special Tools Required

Unipipe is a modular aluminum piping system available in a broad range of sizes, pressures, and fittings. The heavy-wall pipe is rated for 1015 PSI and no special tools are required for assembly or installation.

All piping and fittings are 100% aluminum. It is available in the broadest range of sizes on the market - 3/4" to 10" diameters.

Pressure Capacity

The Unipipe System is suitable for a very wide pressure ranges from high vacuum to 1015 PSI.

Vast Temperature Capabilities

Unipipe offers a range of working temperature from -4°F up to 212°F (-20°C up to 100°C).

Quick & Easy

Unipipe connects together quickly and easily. Only basic, standard tools are required to create complex piping systems. No grooving or crimping are necessary.

Flexible

Unipipe's range of pipe sizes and fittings offer one of the most convenient, flexible and dynamic piping solutions on the market. It is suitable for many different applications.

Universal

Unipipe offers the widest product range for the transport of compressed air, inert gases, and vacuum, as well as high pressure air and fluids.

13 Pipe Sizes Available

3/4"	(20mm)	3-1/2"	(90mm)
1"	(25mm)	4-1/2"	(110mm)
1-1/4"	(32mm)	5"	(140mm)
1-1/2"	(40mm)	6"	(160mm)
2"	(50mm)	8"	(200mm)
2-1/2"	(63mm)	10"	(250mm)
3"	(75mm)		



Wall Mounted Drop End Assembly - Single Port 232 PSI (16 bar)



Part No.	Size mm	Size Inches	Description	Weight
UWSFSB.020015N	20	¾	Wall Mounted Drop End Assembly - Single Port UnipipeNITRO	13.5 oz
UWSFSB.025015N	25	1	Wall Mounted Drop End Assembly - Single Port UnipipeNITRO	19.2 oz

Assemblies Consist of:

UWSFSB.020015N	UWSFSB.025015N
(1) UASFS.025015N	(1) UASFS.025015N
(1) UWCCV.025020	(1) UWCCV.025025

Wall Mounted Drop End Assembly - Double Port 232 PSI (16 bar)



Part No.	Size mm	Size Inches	Description	Weight
UWSFDB.020015N	20	¾	Wall Mounted Drop End Assembly - Double Port UnipipeNITRO	14.1 oz
UWSFDB.025015N	25	1	Wall Mounted Drop End Assembly - Double Port UnipipeNITRO	19.2 oz

Assemblies Consist of:

UWSFDB.020015N	UWSFDB.025015N
(1) UASFD.025015N	(1) UASFD.025015N
(1) UWCCV.025020	(1) UWCCV.025025

Wall Mounted Drop End Assembly - Single Port with Quick Disconnect 232 PSI (16 bar)



Part No.	Size mm	Size Inches	Description	Weight
UWSFSBQ.020015N	20	¾	Wall Mounted Drop End Assembly - Single Port with Quick Disconnect UnipipeNITRO	20.8 oz
UAWFSBQ.025015N	25	1	Wall Mounted Drop End Assembly - Single Port with Quick Disconnect UnipipeNITRO	27.2 oz

Assemblies Consist of:

UWSFSBQ.020015N	UWSFSBQ.025015N
(1) UASFS.025015N	(1) UASFS.025015N
(1) UWCCV.025020	(1) UWCCV.025025
(1) UAQDCM.250500	(1) UAQDCM.250500

Wall Mounted Drop End Assembly - Double Port with Quick Disconnects 232 PSI (16 bar)



Part No.	Size mm	Size Inches	Description	Weight
UWSFDBQ.020015N	20	¾	Wall Mounted Drop End Assembly - Double Port with Quick Disconnect UnipipeNITRO	30.4 oz
UWSFDBQ.025015N	25	1	Wall Mounted Drop End Assembly - Double Port with Quick Disconnect UnipipeNITRO	35.2 oz

Assemblies Consist of:

UWSFDB.020015N	UWSFDB.025015N
(1) UASFD.025015N	(1) UASFD.025015N
(1) UWCCV.025020	(1) UWCCV.025025
(2) UAQDCM.250500	(2) UAQDCM.250500

UnipipeVAC Pipe -29 inHg (-0.87 bar)

Part No.	Size mm	Size Inches	Wall Thickness mm	Length m	Length Feet	Weight
UVTT0.020600	20	¾	1.0	5.8	19	2.1 lbs.
UVTT0.025600	25	1	1.1	5.8	19	2.9 lbs.
UVTT0.040600	40	1½	1.3	5.8	19	5.7 lbs.
UVTT0.050600	50	2	1.4	5.8	19	7.7 lbs.
UVTT0.063600	63	2½	1.8	5.8	19	12.4 lbs.
UVTT0.075600	75	3	2	5.8	19	17.9 lbs.
UVTT0.090600	90	3½	2.4	5.8	19	23.8 lbs.
UVTT0.110600	110	4½	3.0	5.8	19	35.7 lbs.
UVTT0.140600	140	5	2.8	5.8	19	44.7 lbs.
UVTT0.160600	160	6	4.3	5.8	19	75.4 lbs.
UVTT0.200600	200	8	4	5.8	19	89.3 lbs.
UVTT0.250600	250	10	5	5.8	19	141 lbs.



UnipipeVAC Pipe UPS Shipping -29 inHg (-0.87 bar)

Part No.	Size Ømm	Size Inches	Wall Thickness mm	Length m	Length Feet	Weight
CUVTT0.020250	20	¾	1.0	2.5	8	2.1 lbs.
CUVTT0.025250	25	1	1.1	2.5	8	2.9 lbs.
CUVTT0.040250	40	1½	1.3	2.5	8	5.7 lbs.
CUVTT0.050250	50	2	1.4	2.5	8	7.7 lbs.
CUVTT0.063250	63	2½	1.8	2.5	8	12.4 lbs.



Straight Coupling -29 inHg (-0.87 bar)

Part No.	Size mm	Size Inches	A	L	E	S	Weight
UVCC0.020020	20	¾	70	35	37	29	2.5 oz
UVCC0.025025	25	1	75	37	42	36	3.4 oz
UVCC0.040040	40	1½	117	57	63	53	11.9 oz
UVCC0.050050	50	2	138	68	78.5	66	1.2 lbs
UVCC0.063063	63	2½	173	83	95	82	2.2 lbs
UVCC0.075075	75	3	174	85.4	108	100	2.4 lbs
UVCC0.090090	90	3½	190	93	132	118	3.9 lbs
UVCC0.110110	110	4½	150	73	206	154	4.8 lbs
UVCC0.140140	140	5	Special	Order			
UVCC0.160160	160	6	272	133.5	266	221	17.2 lbs
UVCC0.200200	200	8	Coming	Soon			
UVCC0.250250	250	10	Coming	Soon			



Sliding Straight Coupling -29 inHg (-0.87 bar)

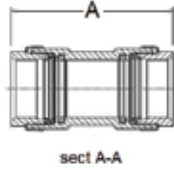

Part No.	Size mm	Size Inches	A	E	S	Weight
UVCC1.020020	20	¾	70	37	29	2.5 oz
UVCC1.025025	25	1	75	42	36	3.4 oz
UVCC1.040040	40	1½	117	63	53	11.9 oz
UVCC1.050050	50	2	138	78.5	66	1.2 lbs
UVCC1.063063	63	2½	173	95	82	2.2 lbs
UVCC1.075075	75	3	174	108	100	2.4 lbs
UVCC1.090090	90	3½	190	132	118	3.9 lbs

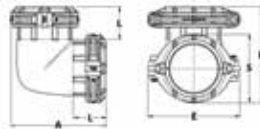
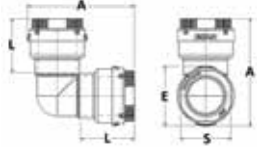

90° Elbow -29 inHg (-0.87 bar)

Part No.	Size mm	Size Inches	A	E	L	S	Weight
UVCC9.020020	20	¾	60	37	35	29	3 oz
UVCC9.025025	25	1	76	42	37	36	4 oz
UVCC9.040040	40	1½	112	63	57	53	1.2 lbs
UVCC9.050050	50	2	143	78.5	68	66	1.5 lbs
UVCC9.063063	63	2½	168	95	83	82	2.4 lbs
UVCC9.075075	75	3	189.5	108	85.4	100	2.8 lbs
UVCC9.090090	90	3½	219	132	93	118	5.5 lbs
UVCC9.110110	110	4½	214	206	73	154	7.6 lbs
UVCC9.140140	140	5	Special	Order			
UVCC9.160160	160	6	352	266	133.5	221	25.2 lbs
UVCC9.200200	200	8	Coming	Soon			
UVCC9.250250	250	10	Coming	Soon			

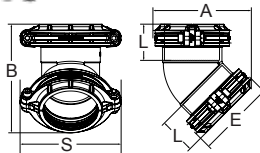
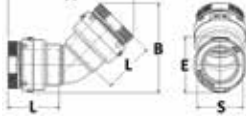

45° Elbow -29 inHg (-0.87 bar)

Part No.	Size mm	Size Inches	A	B	E	L	S	Weight
UVCC4.020020	20	¾	85	59	37	35	29	3.2 oz
UVCC4.025025	25	1	95	68	42	37	36	3.9 oz
UVCC4.040040	40	1½	141	101	63	57	53	12 oz
UVCC4.050050	50	2	171	124	78.5	68	66	1.4 lbs
UVCC4.063063	63	2½	207	150	95	83	82	2.3 lbs
UVCC4.075075	75	3	213	161	108	85.5	100	2.6 lbs
UVCC4.090090	90	3½	238	189	132	93	118	4.2 lbs
UVCC4.110110	110	4½	222	194	206	73	154	5.7 lbs
UVCC4.140140	140	5	Special	Order				
UVCC4.160160	160	6	358	296.5	265	133.5	221	16.6 lbs
UVCC4.200200	200	8	Coming	Soon				
UVCC4.250250	250	10	Coming	Soon				

Equal Tee -29 inHg (-0.87 bar)

Part No.	Size mm	Size Inches	A	B	E	L	S	Weight
UVCCT.020020	20	¾	101	68	37	35	29	4.3 oz
UVCCT.025025	25	1	111	75	42	37	36	5.7 oz
UVCCT.040040	40	1½	162	110	63	57	53	1 lb
UVCCT.050050	50	2	206	141	78.5	68	66	2 lbs
UVCCT.063063	63	2½	230	160	95	83	82	3.1 lbs
UVCCT.075075	75	3	260	219.9	108	85.4	100	4 lbs
UVCCT.090090	90	3½	306	217	132	93	118	7.5 lbs
UVCCT.110110	110	4½	277	214	206	73	154	10 lbs
UVCCT.140140	140	5	Special	Order				
UVCCT.160160	160	6	484	352	265	133.5	221	36.7 lbs
UVCCT.200200	200	8	Coming	Soon				
UVCCT.250250	250	10	Coming	Soon				



Tee with FNPT Branch Line -29 inHg (-0.87 bar)

Part No.	Size mm	Size Inches	A	B	E	L	S	Weight
UVCFT.020015N	20 x ½"x 20	¾ x ½ x ¾	101	48	37	35	29	3.4 oz
UVCFT.025020N	25 x ¾"x 25	1 x ¾ x 1	111	57	42	37	36	4.7 oz
UVCFT.040032N	40 x 1¼"x 40	1½ x 1¼ x 1½	162	78	63	57	53	12.8 oz
UVCFT.050040N	50 x 1½"x 50	2 x 1½ x 2	206	95	78.5	66	66	1.6 lbs
UVCFT.063050N	63 x 2"x 63	2½ x 2 x 2½	230	114	95	83	82	2.5 lbs



90° Elbow with MNPT -29 inHg (-0.87 bar)

Part No.	Size mm	Size Inches	A	B	E	L	S	Weight
UVCM9.020015N	20 x ½"	¾ x ½	62	48	37	35	29	1.8 oz
UVCM9.025015N	25 x ½"	1 x ½	67	57	42	37	36	2.6 oz
UVCM9.025020N	25 x ¾"	1 x ¾	67	57	42	37	36	2.6 oz
UVCM9.040032N	40 x 1¼"	1½ x 1¼	105	78	63	57	53	9 oz
UVCM9.040040N	40 x 1½"	1½ x 1½	105	78	63	57	53	10 oz
UVCM9.040050N	40 x 2"	1½ x 2	111	85	63	57	53	11 oz
UVCM9.050040N	50 x 1½"	2 x 1½	126	95	78.5	66	66	14.8 oz
UVCM9.063050N	63 x 2"	2½ x 2	159	114	95	83	82	1.8 lbs



MNPT Adapter -29 inHg (-0.87 bar)



Part No.	Size mm	Size Inches	A	E	S	L	Weight
UVCM0.020015N	20 x 1/2"	3/4 x 1/2	49	37	29	35	1.4 oz
UVCM0.020020N	20 x 3/4"	3/4 x 3/4	51.5	37	29	35	1.4 oz
UVCM0.025015N	25 x 1/2"	1 x 1/2	55	42	36	37	2 oz
UVCM0.025020N	25 x 3/4"	1 x 3/4	55	42	36	37	2 oz
UVCM0.025025N	25 x 1"	1 x 1	60.5	42	36	37	2 oz
UVCM0.040032N	40 x 1 1/4"	1 1/2 x 1 1/4	81	63	53	57	6.5 oz
UVCM0.040040N	40 x 1 1/2"	1 1/2 x 1 1/2	81	63	53	57	6.5 oz
UVCM0.050040N	50 x 1 1/2"	2 x 1 1/2	92	78.5	66	68	11.2 oz
UVCM0.050050N	50 x 2"	2 x 2	95.5	78.5	66	68	11.2 oz
UVCM0.063050N	63 x 2"	2 1/2 x 2	119	95	82	83	1.2 lbs
UVCM0.063063N	63 x 2 1/2"	2 1/2 x 2 1/2	121	95	82	83	1.2 lbs
UVCM0.075063N	75 x 2 1/2"	3 x 2 1/2	122.9	108	100	85.4	1.4 lbs
UVCM0.090075N	90 x 3"	3 1/2 x 3	130	132	118	93	2.2 lbs



FNPT Adapter -29 inHg (-0.87 bar)

Part No.	Size mm	Size Inches	A	E	L	S	Weight
UVCF0.020015N	20 x 1/2"	3/4 x 1/2	55	37	35	29	2 oz
UVCF0.025020N	25 x 3/4"	1 x 3/4	57	42	37	36	2.3 oz
UVCF0.040032N	40 x 1 1/4"	1 1/2 x 1 1/4	80	63	57	53	8.1 oz
UVCF0.050040N	50 x 1 1/2"	2 x 1 1/2	95	78	66	66	11.6 oz
UVCF0.063050N	63 x 2"	2 1/2 x 2	120	95	83	82	1.4 lbs

Reducer (fitting x pipe) -29 inHg (-0.87 bar)



Part No.	Size Fitting d1 mm	Size Outlet d2 mm	Size Fitting d1 Inches	Size Outlet d2 Inches	A	E	L	S	Weight
UVSC0.025020	25	20	1	3/4	46	33	35	29	1.8 oz
UVSC0.040020	40	20	1 1/2	3/4	59.5	52	35	29	5.4 oz
UVSC0.040025	40	25	1 1/2	1	60.6	52	37	36	6.1 oz
UVSC0.040032	40	32	1 1/2	1 1/4	54.6	52	46	43	4.2 oz
UVSC0.050040	50	40	2	1 1/2	73	64.8	57	53	8.5 oz
UVSC0.063040	63	40	2 1/2	1 1/2	86.3	79.5	57	53	13.9 oz
UVSC0.063050	63	50	2 1/2	2	84	79.5	68	66	14.7 oz
UVSC0.075063	75	63	3	2 1/2	93.5	108	85.4	100	
UVSC0.090063	90	63	3 1/2	2 1/2	111.8	114	83	82	2.5 lbs
UVSC0.090075	90	75	3 1/2	3	115	114	85.4	100	2.3 lbs
UVSC0.110090	110	90	4 1/2	3 1/2	117	123	93	118	2.8 lbs
UVSC0.140110	140	110	5	4 1/2	Special	Order			
UVSC0.160110	160	110	6	4 1/2	175	200	73	154	5.7 lbs
UVSC0.20060	200	160	8	6	Coming	Soon			
UVSC0.25000	250	200	10	8	Coming	Soon			

Flange Adapter -29 inHg (-0.87 bar)

Part No.	Size mm	Size Inches	A	B	E	F	G	M	L	S	Weight
UVCJF.090075	90 x 3"	3½ x 3	110	95	NA	20	NA	190	93	130	4.0 lbs
UVCJF.110100	110 x 4"	4½ x 4	99	73	206	18	220	180	75	154	5.5 lbs
UACJF.140125	140 x 5"	5 x 5	Coming	Soon							
UVCJF.160150	160 x 6"	6 x 6	184	171	221	23.5	283	240.5	133.5	221	16.4 lbs
UACJF.200200	200 x 8"	8 x 8	Coming	Soon							
UACJF.250250	250 x 10"	10 x 10	Coming	Soon							

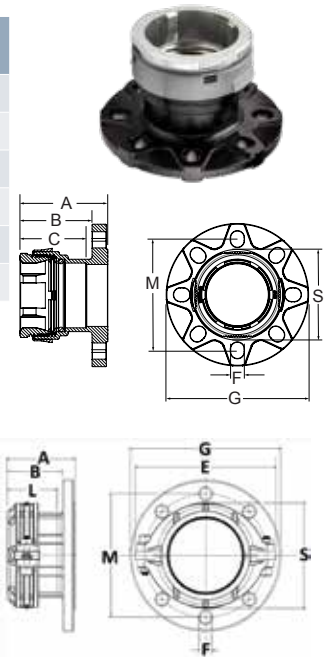

Special Flange (fitting x flange adapter) Elbow or Tee -29 inHg (-0.87 bar)

Part No.	Pipe Size mm	Pipe Size Inches	Flange Description	A	B	F	M	S
UVSC0.110100	110	4½	DN100 - 4"	220	*	18	180	*
UVSC0.140125	140	5	DN125 - 5"	Special	Order			
UVSC0.160150	160	6	DN150 - 6"	283	39	23.5	240.5	186
UVSC0.200200	200	8	DN200 - 8"	Coming	Soon			
UVSC0.250250	250	10	DN250 - 10"	Coming	Soon			

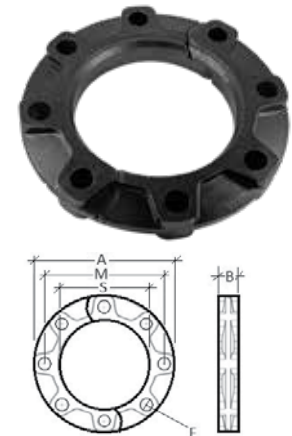

Ball Valve (pipe x pipe) -29 inHg (-0.87 bar)

Part No.	Pipe - Pipe Ømm	Pipe - Pipe Inches	A	B	E	G	L	S	Weight
UVCCV.020020	20	¾	131	73	40	99	35	35	8.1 oz
UVCCV.025020	25 x 20	1 x ¾	131	73	40	102	37	37	8.4 oz
UVCCV.025025	25	1	150	87	50	110.5	37	37	13.4 oz
UVCCV.040040	40	1½	213	121	72	169	57	57	2.1 lbs
UVCCV.050050	50	2	282	156	89	200	68	68	3.5 lbs
UVCCV.063063	63	2½	306	176	109	253.5	83	83	6 lbs





Ball Valve - (pipe x MNPT) -29 inHg (-0.87 bar)

Part No.	Pipe mm - Thread	Pipe Inches - Thread	A	B	E	G	L	S	Weight
UVCMV.020015N	20 x 1/2"	3/4 x 1/2	131	73	40	94	35	29	7.4 oz
UVCMV.025020N	25 x 3/4"	1 x 3/4	150	87	50	104.5	37	36	12.2 oz
UVCMV.040032N	40 x 1 1/4"	1 1/2 x 1 1/4	213	121	72	145.5	57	53	1.9 lbs
UVCMV.050040N	50 x 1 1/2"	2 x 1 1/2	282	156	89	187.5	68	66	3.2 lbs
UVCMV.063050N	63 x 2"	2 1/2 x 2	306	176	109	217	83	82	5.5 lbs

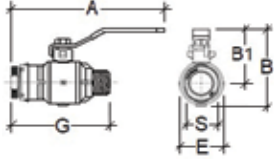

Three Way Ball Valve -29 inHg (-0.87 bar)

Part No.	Pipe mm	Pipe Inches	A	B	E	G	L	S
UVCMV.040040	40	1 1/2	Coming	Soon				
UVCMV.050050	50	2	Coming	Soon				



Wall Mounted Drop End -29 inHg (-0.87 bar)

Part No.	Inlet Ømm spigot	Outlet G	No of outlets	A	B	F	G	M	Weight
UASF.025015N	25	1/2"	1	99	72	6	24	83	5.1 oz
UASF.025015N	25	1/2"	2	99	72	6	24	83	5.7 oz

Advanced Technology for Rapid Installation

An innovative system of high pressure piping that offers fast installation and exceptionally secure joints.

Dynamic Gripping Action

The internal nut and dynamic gripping ring ensure there is no way to separate the pipe from the fittings. This innovative fitting is small and light, making this system one of the most powerful methods for transporting air, gases, and liquids.



The highest pressure rated aluminum pipe system on the market.

The pipe will burst before the fitting will fail!

UnipipeHP Pipe 1015 PSI (70 bar)

Part No.	Size mm	Size Inches	Wall Thickness mm	psi	Length m	Length Feet	Weight
UCTT0.020400	20	¾	2.0	1015	4	13	2.1 lbs
UCTT0.025400	25	1	2.5	1015	4	13	2.9 lbs
UCTT0.040400	40	1½	4.0	1015	4	13	5.7 lbs
UCTT0.050400	50	2	5.0	1015	4	13	7.7 lbs
UCTT0.063400	63	2½	6.0	1015	4	13	12.4 lbs



UnipipeHP Pipe 1015 PSI (70 bar)

Part No.	Size mm	Size Inches	Wall Thickness mm	psi	Length m	Length Feet	Weight
CUCTT0.020200	20	¾	2.0	1015	2	6.5	2.1 lbs
CUCTT0.025200	25	1	2.5	1015	2	6.5	2.9 lbs
CUCTT0.040200	40	1½	4.0	1015	2	6.5	5.7 lbs
CUCTT0.050200	50	2	5.0	1015	2	6.5	7.7 lbs
CUCTT0.063200	63	2½	6.0	1015	2	6.5	12.4 lbs



Straight Coupling 1015 PSI (70 bar)

Part No.	Size mm	Size Inches	bar	A	L	E	S	Weight
UCCC0.020020	20	¾	70	70	35	37	29	2.5 oz
UCCC0.025025	25	1	70	75	37	42	36	3.4 oz
UCCC0.040040	40	1½	70	117	57	63	53	11.9 oz
UCCC0.050050	50	2	70	138	68	78.5	66	1.2 lbs
UCCC0.063063	63	2½	70	173	83	95	82	2.2 lbs



Sliding Straight Coupling 1015 PSI (70 bar)

Part No.	Size mm	Size Inches	A	E	S	Weight
UCCC1.020020	20	¾	70	37	29	2.5 oz
UCCC1.025025	25	1	75	42	36	3.4 oz
UCCC1.040040	40	1½	117	63	53	11.9 oz
UCCC1.050050	50	2	138	78.5	66	1.2 lbs
UCCC1.063063	63	2½	173	95	82	2.2 lbs

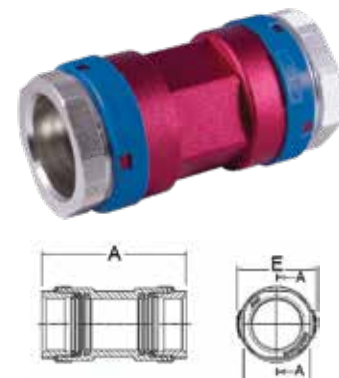



90° Elbow 1015 PSI (70 bar)

Part No.	Size mm	Size Inches	A	E	L	S	Weight
UCCC9.020020	20	¾	60	37	35	29	3 oz
UCCC9.025025	25	1	76	42	37	36	4 oz
UCCC9.040040	40	1½	112	63	57	53	1.2 lbs
UCCC9.050050	50	2	143	78.5	68	66	1.5 lbs
UCCC9.063063	63	2½	168	95	83	82	2.4 lbs



45° Elbow 1015 PSI (70 bar)

Part No.	Size mm	Size Inches	A	B	E	L	S	Weight
UCCC4.020020	20	¾	85	59	37	35	29	3.2 oz
UCCC4.025025	25	1	95	68	42	37	36	3.9 oz
UCCC4.040040	40	1½	141	101	63	57	53	12 oz
UCCC4.050050	50	2	171	124	78.5	68	66	1.4 lbs
UCCC4.063063	63	2½	207	150	95	83	82	2.3 lbs



Equal Tee 1015 PSI (70 bar)

Part No.	Size mm	Size Inches	A	B	E	L	S	Weight
UCCCT.020020	20	¾	101	68	37	35	29	4.3 oz
UCCCT.025025	25	1	111	75	42	37	36	5.7 oz
UCCCT.040040	40	1½	162	110	63	57	53	1 lb
UCCCT.050050	50	2	206	141	78.5	68	66	2 lbs
UCCCT.063063	63	2½	230	160	95	83	82	3.1 lbs



Tee with FNPT Branch Line 1015 PSI (70 bar)

Part No.	Size mm	Size Inches	A	B	E	L	S	Weight
UCCFT.020015N	20 x ½" x 20	¾ x ½ x ¾	101	48	37	35	29	3.4 oz
UCCFT.025020N	25 x ¾" x 25	1 x ¾ x 1	111	57	42	37	36	4.7 oz
UCCFT.040032N	40 x 1¼" x 40	1½ x 1¼ x 1½	162	78	63	57	53	12.8 oz
UCCFT.050040N	50 x 1½" x 50	2 x 1½ x 2	206	95	78.5	66	66	1.6 lbs
UCCFT.063050N	63 x 2" x 63	2½ x 2 x 2½	230	114	95	83	82	2.5 lbs



90° Elbow with MNPT 1015 PSI (70 bar)

Part No.	Size mm	Size Inches	A	B	E	L	S	Weight
UCCM9.020015N	20 x ½"	¾ x ½	62	48	37	35	29	1.8 oz
UCCM9.025020N	25 x ¾"	1 x ¾	67	57	42	37	36	2.6 oz
UCCM9.040032N	40 x 1¼"	1½ x 1¼	105	78	63	57	53	9 oz
UCCM9.050040N	50 x 1½"	2 x 1½	126	95	78.5	66	66	14.8 oz
UCCM9.063050N	63 x 2"	2½ x 2	159	114	95	83	82	1.8 lbs

MNPT Adapter 1015 PSI (70 bar)

Part No.	Size mm	Size Inches	A	E	S	L	Weight
UCCM0.020015N	20 x 1/2"	3/4 x 1/2	49	37	29	35	1.4 oz
UCCM0.020020N	20 x 3/4"	3/4 x 3/4	51.5	37	29	35	1.4 oz
UCCM0.025015N	25 x 1/2"	1 x 1/2	55	42	36	37	2 oz
UCCM0.025020N	25 x 3/4"	1 x 3/4	55	42	36	37	2 oz
UCCM0.025025N	25 x 1"	1 x 1	60.5	42	36	37	2 oz
UCCM0.040032N	40 x 1 1/4"	1 1/2 x 1 1/4	81	63	53	57	6.5 oz
UCCM0.040040N	40 x 1 1/2"	1 1/2 x 1 1/2	81	63	53	57	6.5 oz
UCCM0.050040N	50 x 1 1/2"	2 x 1 1/2	92	78.5	66	68	11.2 oz
UCCM0.050050N	50 x 2"	2 x 2	95.5	78.5	66	68	11.2 oz
UCCM0.063050N	63 x 2"	2 1/2 x 2	119	95	82	83	1.2 lbs
UCCM0.063063N	63 x 2 1/2"	2 1/2 x 2 1/2	121	95	82	83	1.2 lbs

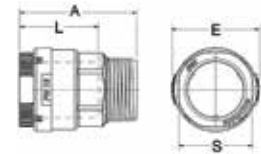

FNPT Adapter 1015 PSI (70 bar)

Part No.	Size mm	Size Inches	A	E	L	S	Weight
UCCF0.020015	20 x 1/2"	3/4 x 1/2	55	37	35	29	2 oz
UCCF0.025020	25 x 3/4"	1 x 3/4	57	42	37	36	2.3 oz
UCCF0.040032	40 x 1 1/4"	1 1/2 x 1 1/4	80	63	57	53	8.1 oz
UCCF0.050040	50 x 1 1/2"	2 x 1 1/2	95	78	66	66	11.6 oz
UCCF0.063050	63 x 2"	2 1/2 x 2	120	95	83	82	1.4 lbs

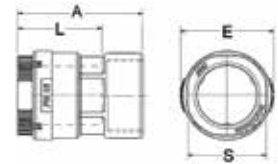

Reducer (fitting x pipe) 1015 PSI (70 bar)

Part No.	Size Fitting d1 mm	Size Outlet d2 mm	Size Fitting d1 Inches	Size Outlet d2 Inches	A	E	L	S	Weight
UCSC0.025020	25	20	1	3/4	46	33	35	29	1.8 oz
UCSC0.040020	40	20	1 1/2	3/4	59.5	52	35	29	5.4 oz
UCSC0.040025	40	25	1 1/2	1	60.6	52	37	36	6.1 oz
UCSC0.040032	40	32	1 1/2	1 1/4	54.6	52	46	43	4.2 oz
UCSC0.050040	50	40	2	1 1/2	73	64.8	57	53	8.5 oz
UCSC0.063040	63	40	2 1/2	1 1/2	86.3	79.5	57	53	13.9 oz
UCSC0.063050	63	50	2 1/2	2	84	79.5	68	66	14.7 oz

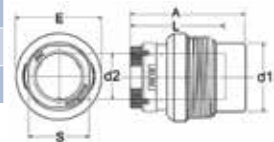



HP Ball Valve (pipe x pipe) 580 PSI (40 bar)

Part No.	Pipe - Pipe mm	Pipe - Pipe Inches	A	B	E	G	L	S	Weight
UCCCV.020020	20	¾	131	73	40	99	35	35	8.1 oz
UCCCV.025020	25 x 20	1 x ¾	131	73	40	102	37	37	8.4 oz
UCCCV.025025	25	1	150	87	50	110.5	37	37	13.4 oz
UCCCV.040040	40	1½	213	121	72	169	57	57	2.1 lbs
UCCCV.050050	50	2	282	156	89	200	68	68	3.5 lbs
UCCCV.063063	63	2½	306	176	109	253.5	83	83	6 lbs



HP Ball Valve - (pipe x MNPT) 580 PSI (40 bar)

Part No.	Pipe mm - Thread	Pipe Inches - Thread	A	B	E	G	L	S	Weight
UCCMV.020015N	20 x ½"	¾ x ½	131	73	40	94	35	29	7.4 oz
UCCMV.025020N	25 x ¾"	1 x ¾	150	87	50	104.5	37	36	12.2 oz
UCCMV.040032N	40 x 1¼"	1½ x 1¼	213	121	72	145.5	57	53	1.9 lbs
UCCMV.050040N	50 x 1½"	2 x 1½	282	156	89	187.5	68	66	3.2 lbs
UCCMV.063050N	63 x 2"	2½ x 2	306	176	109	217	83	82	5.5 lbs

Advanced Technology for Rapid Installation

An innovative system of high pressure piping that offers fast installation and exceptionally secure joints.

Dynamic Gripping Action

The internal nut and dynamic gripping ring ensure there is no way to separate the pipe from the fittings. This innovative fitting is small and light, making this system one of the most powerful methods for transporting air, gases, and liquids.



The highest pressure rated aluminum pipe system on the market.

The pipe will burst before the fitting will fail!

UnipipeOIL Pipe 1015 PSI (70 bar)

Part No.	Size mm	Size Inches	Wall Thickness mm	psi	Length m	Length Feet	Weight
UOTT0.020400	20	¾	2.0	1015	4	13	2.1 lbs
UOTT0.025400	25	1	2.5	1015	4	13	2.9 lbs



UnipipeOIL Pipe 1015 PSI (70 bar)

Part No.	Size mm	Size Inches	Wall Thickness mm	psi	Length m	Length Feet	Weight
CUOTT0.020200	20	¾	2.0	1015	2	6.5	2.1 lbs
CUOTT0.025200	25	1	2.5	1015	2	6.5	2.9 lbs



Straight Coupling 1015 PSI (70 bar)

Part No.	Size mm	Size Inches	bar	A	L	E	S	Weight
UOCC0.020020	20	¾	70	70	35	37	29	2.5 oz
UOCC0.025025	25	1	70	75	37	42	36	3.4 oz

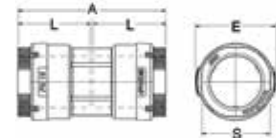

Sliding Straight Coupling 1015 PSI (70 bar)

Part No.	Size mm	Size Inches	A	E	S	Weight
UOCC1.020020	20	¾	70	37	29	2.5 oz
UOCC1.025025	25	1	75	42	36	3.4 oz

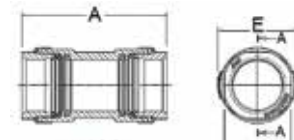

90° Elbow 1015 PSI (70 bar)

Part No.	Size mm	Size Inches	A	E	L	S	Weight
UOCC9.020020	20	¾	60	37	35	29	3 oz
UOCC9.025025	25	1	76	42	37	36	4 oz

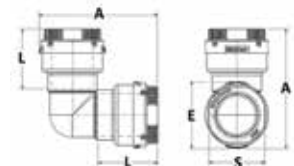

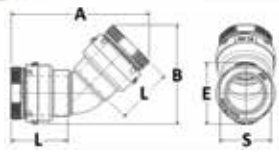

45° Elbow 1015 PSI (70 bar)

Part No.	Size mm	Size Inches	A	B	E	L	S	Weight
UOCC4.020020	20	¾	85	59	37	35	29	3.2 oz
UOCC4.025025	25	1	95	68	42	37	36	3.9 oz

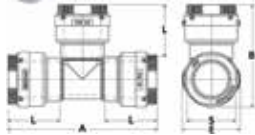

Equal Tee 1015 PSI (70 bar)

Part No.	Size mm	Size Inches	A	B	E	L	S	Weight
UOCCT.020020	20	¾	101	68	37	35	29	4.3 oz
UOCCT.025025	25	1	111	75	42	37	36	5.7 oz

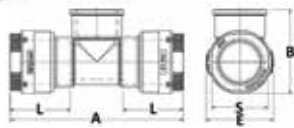

Tee with FNPT Branch Line 1015 PSI (70 bar)

Part No.	Size mm	Size Inches	A	B	E	L	S	Weight
UOCFT.020015N	20 x ½" x 20	¾ x ½ x ¾	101	48	37	35	29	3.4 oz
UOCFT.025020N	25 x ¾" x 25	1 x ¾ x 1	111	57	42	37	36	4.7 oz

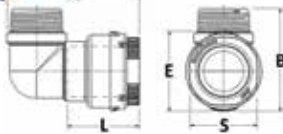

90° Elbow with MNPT 1015 PSI (70 bar)

Part No.	Size mm	Size Inches	A	B	E	L	S	Weight
UOCM9.020015N	20 x ½"	¾ x ½	62	48	37	35	29	1.8 oz
UOCM9.025020N	25 x ¾"	1 x ¾	67	57	42	37	36	2.6 oz

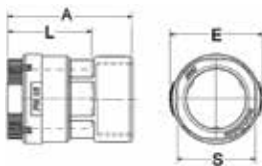

MNPT Adapter 1015 PSI (70 bar)

Part No.	Size mm	Size Inches	A	E	S	L	Weight
UOCM0.020015N	20 x ½"	¾ x ½"	49	37	29	35	1.4 oz
UOCM0.020020N	20 x ¾"	¾ x ¾"	51.5	37	29	35	1.4 oz
UOCM0.025020N	25 x ¾"	1 x ¾"	55	42	36	37	2 oz
UOCM0.025025N	25 x 1"	1 x 1"	60.5	42	36	37	2 oz

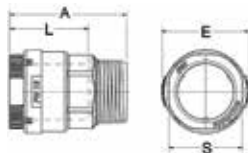

FNPT Adapter 1015 PSI (70 bar)

Part No.	Size mm	Size Inches	A	E	L	S	Weight
UOCF0.020015	20 x ½"	¾ x ½	55	37	35	29	2 oz
UOCF0.025020	25 x ¾"	1 x ¾	57	42	37	36	2.3 oz



Reducer (fitting x pipe) 1015 PSI (70 bar)

Part No.	Size Fitting d1 mm	Size Outlet d2 mm	Size Fitting d1 mm	Size Outlet d2 Inches	A	E	L	S	Weight
UOSC0.025020	25	20	1	¾	46	33	35	29	1.8 oz
UOSC0.040020	40	20	1½	¾	59.5	52	35	29	5.4 oz

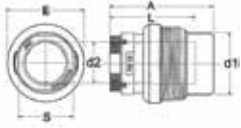

Oil Ball Valve (pipe x pipe) 580 PSI (40 bar)

Part No.	Pipe - Pipe mm	Pipe - Pipe Inches	A	B	E	G	L	S	Weight
UOCCV.020020	20	¾	131	73	40	99	35	35	8.1 oz
UOCCV.025020	25 x 20	1 x ¾	131	73	40	102	37	37	8.4 oz
UOCCV.025025	25	1	150	87	50	110.5	37	37	13.4 oz

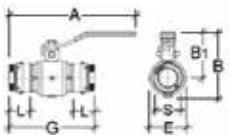

Oil Ball Valve - (pipe x MNPT) 580 PSI (40 bar)

Part No.	Pipe mm - Thread	Pipe Inches - Thread	A	B	E	G	L	S	Weight
UOCMV.020015N	20 x ½"	¾ x ½	131	73	40	94	35	29	7.4 oz
UOCMV.025020N	25 x ¾"	1 x ¾	150	87	50	104.5	37	36	12.2 oz

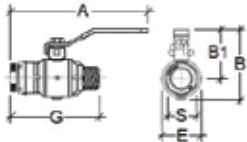

Unipipe® The Unipipe Advantage

No Special Tools Required

Unipipe is a modular aluminum piping system available in a broad range of sizes, pressures, and fittings. The heavy-wall pipe is rated for 1015 PSI and no special tools are required for assembly or installation.

All piping and fittings are 100% aluminum. It is available in the broadest range of sizes on the market - ¾" to 10" diameters.

Pressure Capacity

The Unipipe System is suitable for a very wide pressure ranges from high vacuum to 1015 PSI.

Vast Temperature Capabilities

Unipipe offers a range of working temperature from -4°F up to 212°F (-20°C up to 100°C).

Quick & Easy

Unipipe connects together quickly and easily. Only basic, standard tools are required to create complex piping systems. No grooving or crimping are necessary.

Flexible

Unipipe's range of pipe sizes and fittings offer one of the most convenient, flexible and dynamic piping solutions on the market. It is suitable for many different applications.

Universal

Unipipe offers the widest product range for the transport of compressed air, inert gases, and vacuum, as well as high pressure air and fluids.

13 Pipe Sizes Available

¾"	(20mm)	3-½"	(90mm)
1"	(25mm)	4-½"	(110mm)
1-¼"	(32mm)	5"	(140mm)
1-½"	(40mm)	6"	(160mm)
2"	(50mm)	8"	(200mm)
2-½"	(63mm)	10"	(250mm)
3"	(75mm)		



Install Special Flange Coupler • Elbow • Tee 4-1/2 to 10" (110mm - 250mm)



Typical application of Fitting Flange converting an Elbow and a Tee to Flanged connection.

Check Out The How-To Video

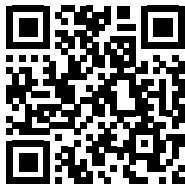

Remove the bolts, clamp ring halves and the Grip Ring leaving the end of the fitting ready for the Fitting Flange.



Fit both halves of the Fitting Flange behind the face of the body, ready to install where needed.



Install Reducer Coupler • Elbow • Tee 1" to 3-1/2" (25mm - 90mm)



Unscrew the nut and remove the grip ring and identification collar.

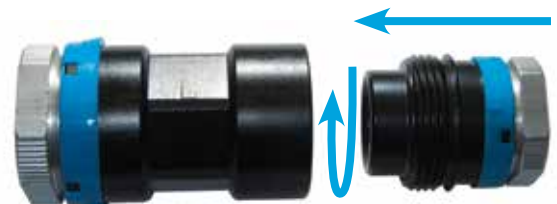

Insert and tighten the reducer in the desired position.

Install Reducer in Fitting Coupler • Elbow • Tee 4-1/2" to 10" (110mm-250mm)



Remove the bolts, clamp ring halves and the Grip Ring leaving the end of the fitting ready for the Reducer. Discard the grip ring.



Insert the Reducer in the desired position, reassemble the clamp halves and tighten the bolts and nuts at a torque value of 11 lb-ft.

Install Plug in Fitting Coupler • Elbow • Tee 1" to 3-1/2" (25mm-90mm)

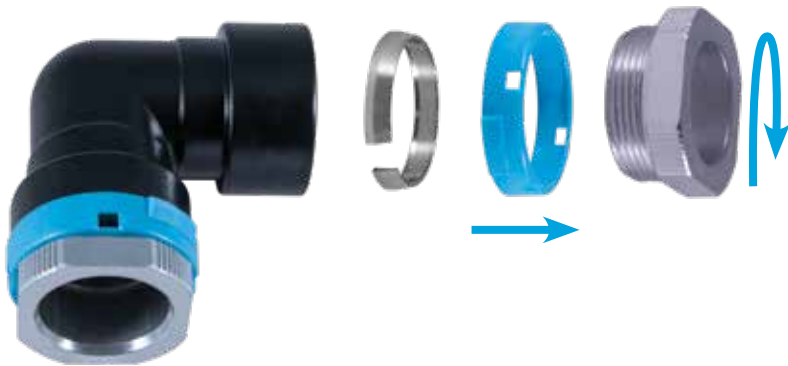

Unscrew the nut and remove the grip ring and identification collar. Discard the grip ring.

Check Out The How-To Video



Insert the Plug into the fitting. Reassemble the identification ring and firmly tighten the nut.

Install Branch 1" to 3-1/2" (25mm-63mm)



- 1. Clamp Half
- 2. Fixed Seal
- 3. Branch Body
- 4. Clamp Bolt
- 5. Plug
- 6. Grip Ring
- 7. Identification Collar
- 8. Nut



1 Verify the section of pipe where the branch is to be installed is free from scratches or dents.

Completely unscrew the clamp bolt. Separate the clamp half by sliding it sideways from the body.



2 Position the main branch body in its correct position, making sure the seal is correctly located.

Slide the clamp half back into the fitting, lining up the screw holes.

Adjust branch to its final position and tighten the bolt.



3 Unscrew the plug.



4 Drill hole in pipe using a hole saw matched for a clearance fit on the diameter of the inner hole.

Carefully deburr edges of hole and remove all swarf.



5 Replace plug and tighten.

Insert Branch line following standard procedures.

Check Out The How-To Video

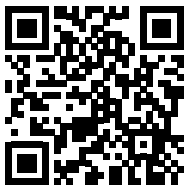

Branch Size	Hole Saw Size
25	1/2" (14mm)
32	1/2" (14mm)
40	3/4" (19mm)
50	3/4" (19mm)
63	3/4" (19mm)

Install Saddle Branch 1" to 10" (25mm-250mm)



- 1** Completely remove the bolt.
Slide the clamp half to one side until it is free.
Check the seal is in place in the Saddle Branch body.



- 2** Place the Saddle Branch body in its approximate position.
Slide the clamp half into the body.
Check final position then insert bolt and tighten.

Branch Size	Hole Saw Size
1/2"	1/2" (14mm)
3/4"	3/4" (19mm)
1"	1" (24mm)
2"	2" (48mm)
3"	3" (79mm)



- 3** Drill hole in pipe using a hole saw matched for a clearance fit on the diameter of the inner hole.
Carefully deburr edges of hole and remove all metal shavings.



Typical Application for Saddle Branch



1. Saddle Branch Body
2. Saddle Clamp Half
3. Gasket Seal
4. Washer
5. Socket Head Bolt

Unipipe Assembly Instructions 3/4" to 3-1/2" (20mm-90mm)



1 CUTTING: Cut the pipe using burr-free approved cutters. Do not use oxy-acetylene or abrasive cut off wheels.

Pipes must be cut at right angles to their axis, using a pipe cutter or fine-tooth saw, allowing for the depth of insertion into the fitting.



2 DEBURRING: All pipe cuts must be carefully deburred, both inside and outside, using a manual or electric deburring tool. Any cutting residue (swarf) must be removed to avoid damage to the O-ring when the pipe is inserted into the fitting, avoiding possible leaks.



3 MARK INSERTION DEPTH:

To ensure a correctly inserted joint, the pipe must be marked with a fine-point marker to show the insertion depth in the fitting, or by measurement using the table below. The use of a Unipipe Depth Gauge is recommended.

Insertion Depth

Pipe Diameter	20mm	25mm	32mm	40mm	50mm	63mm	75mm	90mm
Distance From End	35mm	37mm	46mm	57mm	68mm	83mm	86mm	93mm



Check Out
The Assembly
Video



4 LOOSEN NUT: Check that all components are correctly positioned inside the fitting.



5 LUBRICATION: Use soapy water, silicone spray or a lubricant that is compatible with the intended use. Lubrication is optional, but will assist inserting the pipe through the seal ring. Do not use silicone spray if intended use is for powder coating, spray painting or breathing air.



6 INSERT and TIGHTEN: Insert the pipe up to the mark, ensuring the axis of the pipe and the fitting are straight. Tighten the nut by hand and then with a wrench for 1/4-turn more or until the pipe starts to turn. DO NOT OVERTIGHTEN.

Unipipe Assembly Instructions 4-1/2" to 10" (110mm-250mm)



1 CUTTING: Cut the pipe using burr-free approved cutters. Do not use oxy-acetylene or abrasive cut off wheels. Pipes must be cut at right angles to their axis, using a pipe cutter or fine-tooth saw, allowing for the depth of insertion into the fitting.



2 DEBURRING: All pipe cuts must be carefully deburred, both inside and outside, using a manual or electric deburring tool. Any cutting residue (swarf) must be removed to preclude damage to the O-ring when the pipe is inserted into the fitting, avoiding possible leaks.



3 MARK INSERTION DEPTH:

To ensure a correctly inserted joint, the pipe must be marked with a fine-point marker to show the insertion depth in the fitting, or by measurement using the table below. The use of a Unipipe Depth Gauge is recommended.

Insertion Depth

Pipe Diameter	110mm	140mm	160mm	200mm	250mm
Distance From End	73mm	92mm	134mm	Coming Soon	Coming Soon



4 LOOSEN NUT: Loosen the nuts of the relevant clamp halves.



5 LUBRICATION: Use soapy water, silicone spray or a lubricant that is compatible with the intended use. Lubrication is optional, but will assist inserting the pipe through the seal ring.

Do not use silicone spray if intended use is for powder coating, spray painting or breathing air.

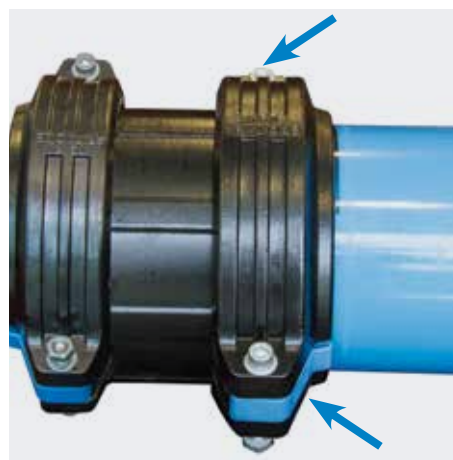

6 INSERT and TIGHTEN:

Insert the pipe into the fitting up to the depth mark, ensuring the axis of the pipe and the fitting are straight. Tighten the bolts with a spanner to a torque value of 11 lb-ft.

Traditional Black/Iron Pipe Has Hidden Costs

- Iron pipes are very heavy, so anchoring must be used with suspended piping systems.
- Iron can be difficult to cut and join, requiring a skilled plumber or welder to install. Leaks often develop along joins or welds.
- Most critically, black iron piping is highly susceptible to corrosion when it comes into contact with moisture from the air compressor.
- When rust develops inside iron piping, it can cause blockages or make its way into the compressed air stream, fouling the air lines and causing problems for production processes.
- Air treatment needed to protect from dirt, dust and corrosion
- Downtime & labor for modifications
- Low flow rates, high pressure drop, and air leaks

Rusty, Corroded, Clogged Iron Pipe



Clean, Corrosion-free Aluminum Piping

Aluminum Piping Promotes Smooth Laminar Flow

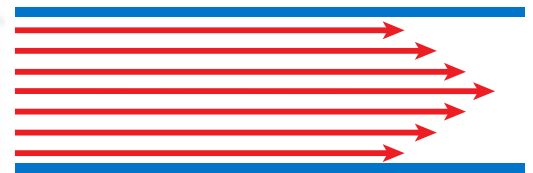

Iron Piping Promotes Rough Turbulent Flow

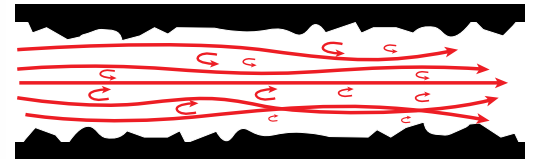

Piping for High Pressure Applications

- Rated to 1015 PSI
- High Pressure Air
- High Pressure Nitrogen
- Oils, Fluids, Coolants
- More than 2x wall thickness of UnipipeAIR

UnipipeHP



UnipipeOIL

The Only High Pressure Aluminum Piping System on the Market!



Perfect for Compressed Air, Nitrogen, Vacuum, and High Pressure Applications

- A superior alternative to traditional piping options
- Over 3 times faster to install than copper piping
- Pressure tests over 4 times higher than any competitor

Fast Installation

No Special Tools Needed

Pressures up to 1015 PSI

13 Pipe Sizes Available

Exceptionally Secure Joints



Request a Demonstration Kit and See for Yourself

Contains samples of UnipipeHP, UnipipeAIR, Saddle Branch, Equal Tee, Coupling, 90° Elbow, and MNPT Adaptor.

Assemble a miniature piping system in minutes.

Includes a video brochure that demonstrates the Unipipe system with you.

See why Unipipe is the best choice for modular aluminum piping and the best alternative to traditional iron pipe or copper options.



Unipipe is offered with a warranty against defects in manufacturing or materials. It remains the responsibility of the user to ensure that the fittings and related products are suitable for the application. The installation must be carried out by a competent person in accordance with the enclosed recommendations, complying with recognized codes of practice and relevant standards, and be properly maintained. Refer to our terms and conditions.

Unipipe has a policy of continuous improvement, research, and development. We reserve the right to amend the specifications and design of all products without notice.

unipipe®

550 Albion Avenue Suite 70
Schaumburg, IL 60193
888.966.9007

www.UnipipeSolutions.com