

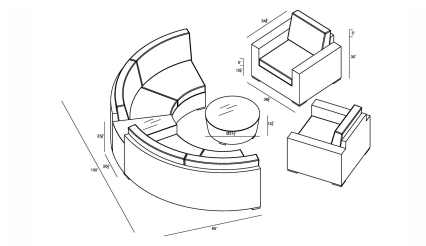

HARMONIA
LIVING

Dune 6 Piece Curve Sectional Set - Canvas Natural HL-DUNE-DW-6CSEC-CN

Product Images



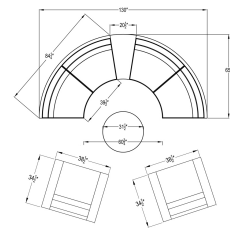
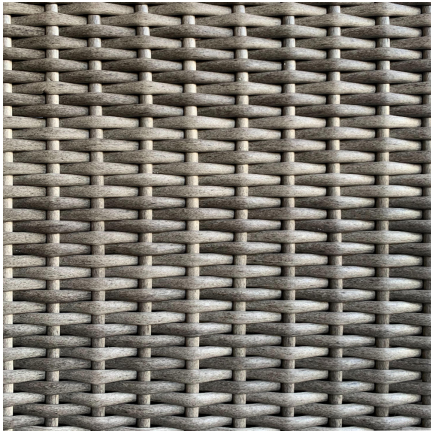

Description

Create the perfect outdoor gathering hotspot with the Dune 6 Piece Curved Sectional Set by Harmonia Living. This collection's beautiful symmetry, teak highlights and detailed wicker give it a unique visual appeal, while sturdy, all-weather construction ensures lasting performance across the seasons. The wicker is made with durable High-Density Polyethylene (HDPE) and finished in a beautifully textured Driftwood color, which gives it a natural feel. Its sturdy aluminum frames, triple reinforced seats and fade resistant cushions are made to endure in any outdoor setting, rain or shine. The tables are topped with extra strong tempered glass, a finishing touch that is ideal for frequent use. If you wish to order this set through Harmonia Living's Quick Ship program, make sure to select a Quick Ship (QS) fabric before checkout! This set comes with 2 Curved Loveseats, 1 Wedge End Table, 2 Club Chairs and 1 Round Coffee Table, perfect for standalone use or with a round fire pit.

Includes

- 2x Dune Curve Loveseats
- 2x Dune Club Chairs
- 1x Dune Round Coffee Table
- 1x Dune Wedge End Table

Dimensions

- Curve Loveseat: 84.25"W x 34.75"D x 32"H (72lbs.)
- Seat Height (No Cushion): 12.25

- Seat Height (With Cushion): 17.25
- Back Height (Seat to Top): 14.75
- Club Chair: 38.5"W x 34.75"D x 32"H (37lbs.)
- Seat Height (No Cushion): 12.25
- Seat Height (With Cushion): 17.25
- Back Height (Seat to Top): 14.75
- Arm Height: 25
- Coffee Table: 31.5"W x 31.5"D x 12.25"H (37lbs.)
- End Table: 34.75"W x 20.5"D x 23.5"H (35lbs.)

Features

- Frame Finish: Driftwood
- Seat/Back Finish: Driftwood
- Table Finish: Driftwood
- Tabletop Finish: Clear
- Country Of Origin: Country of Origin: China
- Assembly Required:
- High-Density Polyethylene (HDPE) Wicker (Driftwood Finish) is all-weather, recyclable and resistant to fading or cracking.
- Thick gauge, powder-coated aluminum frames are lightweight, durable and corrosion resistant.
- Seat frames are triple reinforced for lasting durability.
- Includes teak wood feet with plastic glides to help protect your deck or patio.
- Tempered glass table top is extra strong and made for regular outdoor exposure.
- Cushions are made with quick-drying Polyurethane foam and wrapped in Dacron, which wicks away moisture
- Available in Sunbrella fabric, which is distinctive, fade resistant and easy to clean
- Set comes with U clips (for securing sectional pieces) & cushion ties (to keep cushions in place)

Compatible Cushions

- HL-CUSH-CLSB (4)
- HL-CUSH-CLSS (4)
- HL-CUSH-27B (2)
- HL-CUSH-27S (2)

Compatible Furniture Covers

- HL-WX-GP-6CSEC

Warranty

- 5 Years Fabric
- 3 Years Frame
- 2 Years Wicker

Care And Maintenance

Hose off or wipe clean with soft cloth and water. Do not use harsh chemicals.

Available Color Options

- Canvas Charcoal: HL-DUNE-DW-6CSEC-CC
- Canvas Flax: HL-DUNE-DW-6CSEC-CF
- Cast Lagoon: HL-DUNE-DW-6CSEC-CL
- Canvas Natural: HL-DUNE-DW-6CSEC-CN
- Cast Silver: HL-DUNE-DW-6CSEC-CS
- Heather Beige: HL-DUNE-DW-6CSEC-HB
- Canvas Henna: HL-DUNE-DW-6CSEC-HN
- Spectrum Indigo: HL-DUNE-DW-6CSEC-IN
- Spectrum Peacock: HL-DUNE-DW-6CSEC-PC