

# user manual

**oliso**<sup>®</sup>  
smartiron<sup>®</sup>

hello



[www.oliso.com/downloads](http://www.oliso.com/downloads)

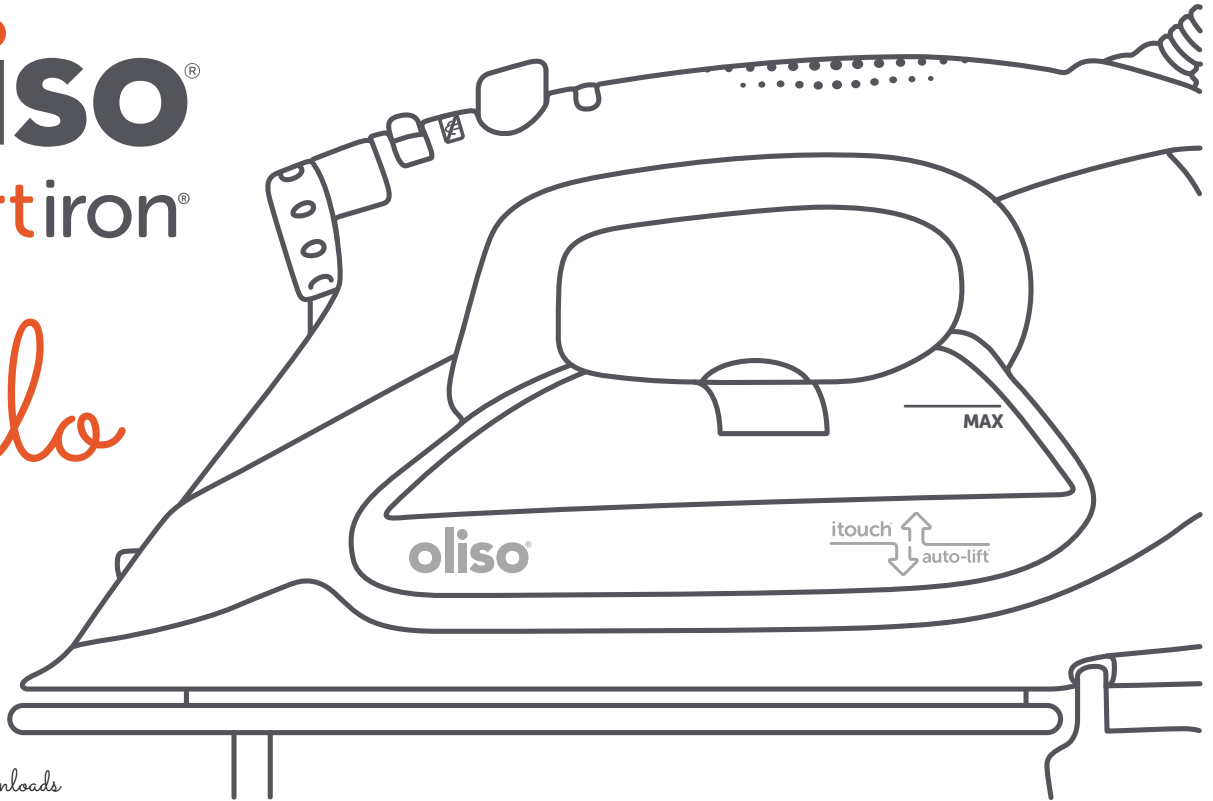

for model TG1600Pro+

# IMPORTANT SAFETY INSTRUCTIONS

When using your iron, basic safety precautions should always be followed, including the following:

**Read all instructions before using this product.**

- 1 Use iron only for its intended use.
- 2 To protect against a risk of electric shock, do not immerse the iron in water or other liquids.
- 3 The fabric setting/temperature dial should always be turned to “min” before plugging or unplugging from the outlet. Never tug cord to disconnect from the outlet; instead, grasp plug and pull to disconnect.
- 4 This product has no on/off switch and operates when plugged into the main supply source, disconnect the plug from mains after use.
- 5 This product is considered as “inappropriate for intended use” based on the EC regulation 1275/2008 ecodesign requirements of standby and off mode requirements.
- 6 Do not allow cord to touch hot surfaces. Let iron cool completely before putting away. Loop cord loosely around iron when storing.
- 7 Keep the iron and its cord out of reach of children less than 8 years of age when it is powered or cooling down.
- 8 Always disconnect iron from electrical outlet when filling with water or emptying and when not in use.
- 9 Do not operate iron with a damaged cord. The iron is not to be used if it has been dropped, if there are visible signs of damage or if it is leaking. To avoid the risk of electric shock, do not disassemble the iron. Take it to a qualified serviceman for examination and repair. Incorrect reassembly can cause a risk of electric shock when the iron is used.
- 10 This appliance can be used by children aged from 8 years and above and persons with reduced physical, sensory or mental capabilities or lack of experience and knowledge if they have been given supervision or instruction concerning use of the appliance in a safe way and understand the hazards involved. Children shall not play with the appliance. Cleaning and user maintenance shall not be made by children without supervision. Close supervision is necessary for any appliance being used near children. Do not leave iron unattended while connected or on an ironing board.
- 11 Burns can occur from touching hot metal parts, hot water, or steam. Use caution when you turn a steam iron upside down – there may be hot water in the reservoir.
- 12 If the LED flashes orange (not red or green), the iron is not operating normally. Disconnect from the power supply and have the iron serviced by qualified service personnel
- 13 The iron must be used and rested on a flat, stable surface.

**SAVE THESE INSTRUCTIONS**

# SPECIAL INSTRUCTIONS

When using your iron, basic safety precautions should always be followed, including the following:

**Read all instructions before using this product.**

- 1 The iron must be used on a stable surface. When placing the iron on a stand or resting surface, make sure the stand or surface is stable.
- 2 Oliso irons are high wattage appliances — 2000W-2400W at 220V to 240V-. To avoid a circuit overload, do not operate another high wattage appliance on the same circuit.
- 3 If an extension cord is absolutely necessary, a 12 A cord should be used. Cords rated for less amperage may overheat. Care should be taken to arrange the cord so that it cannot be pulled or tripped over.
- 4 This iron uses hot steam!
- 5 Never direct fill the iron from a water tap while the iron is plugged into a power source.
- 6 FOR HOUSEHOLD USE ONLY

## Correct Disposal of this product



This marking indicates that this product should not be disposed with other household wastes throughout the EU. To prevent possible harm to the environment or human health from uncontrolled waste disposal, recycle it responsibly to promote the sustainable reuse of material resources. To return your used device, please use the return and collection systems or contact the retailer where the product was purchased. They can take this product for environmental safe recycling.

**SAVE THESE INSTRUCTIONS**

side view

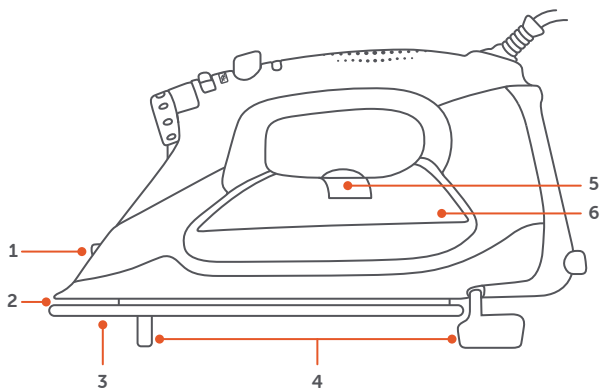

top view

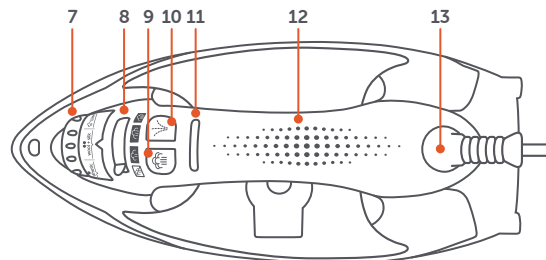

back view

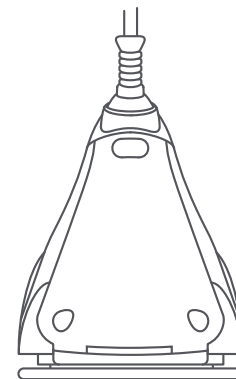

## get to know your oliso® smart iron®



**1** spray nozzle



**5** flip funnel™



**9** steam burst



**13** 360° pivot cord



**2** detailer tip



**6** water tank



**10** spray mist



**3** soleplate



**7** fabric selector



**11** status light



**4** scorch guards™



**8** steam selector



**12** itouch® handle

# 3 simple steps to start

## step 1

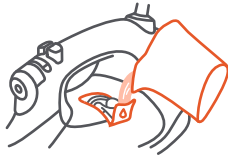

### fill unplugged

Open the flip funnel™ and add water to the tank with the fill cup or directly from a faucet.

2 fill cups equal the max capacity of the water tank.

## step 2

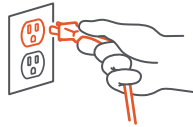

### set up

Plug in.  
Choose a fabric setting then set desired steam level.

## step 3



### iron

When the green light stops blinking and is solid, the iron is ready for use.  
Touch the handle and begin using.

# itouch<sup>®</sup> + auto-lift<sup>®</sup>

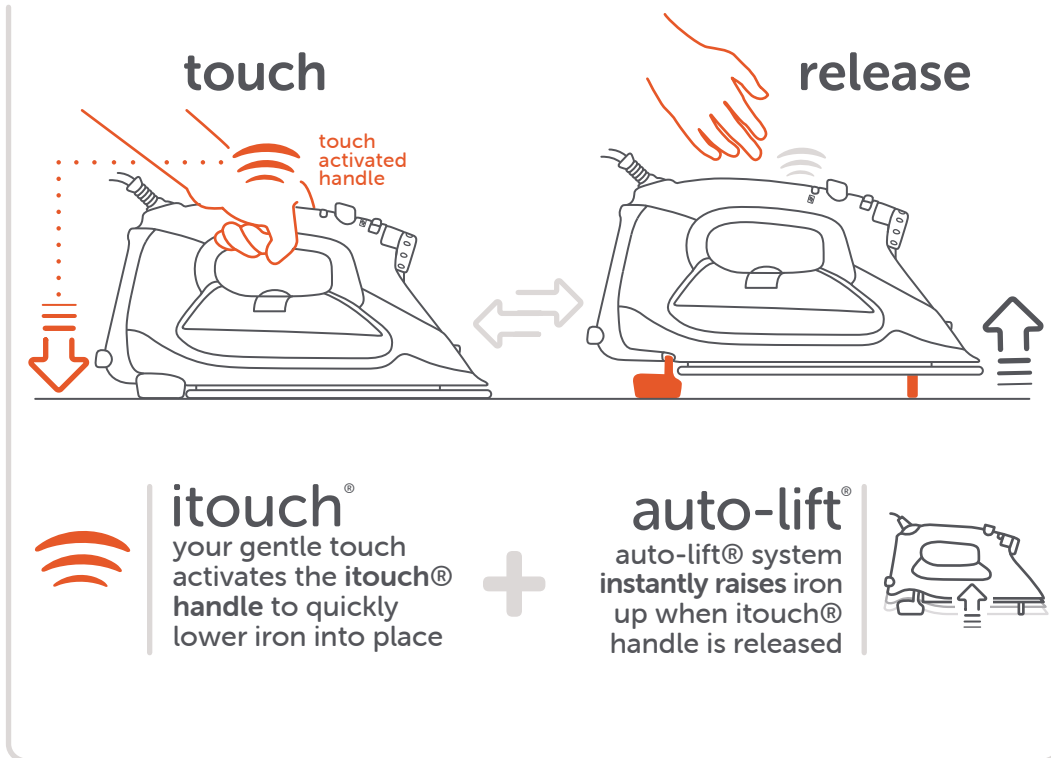

## activating itouch<sup>®</sup>



For more information regarding the auto shut-off safety feature see page 6.

# auto shut-off system

## iron position | TG1600Pro+

horizontal lifted 	30 minutes			
vertical 	30 minutes			
knocked over 	30 seconds			

If the oliso® smart iron® is not being used while it is plugged in, the status light will flash red and the iron will turn itself off.

**Simply touch the handle of the iron to restart it.**

## after ironing

### store iron properly

- 1 Turn the fabric selector to off. Slide the steam selector to off (  ).
- 2 Unplug the appliance. (Do not hold iron while unplugging or the scorch guards™ will not stay extended. Iron should always be stored with scorch guards™ extended to prevent leaking).
- 3 Allow to cool thoroughly before storing.
- 4 **Important:** Empty water from the water tank after each use. To do this, open the flip funnel™ and tilt the iron to the left over a water receptacle until the tank is empty.
- 5 For easy storage, the power cord can be wound loosely around the iron once it has cooled.

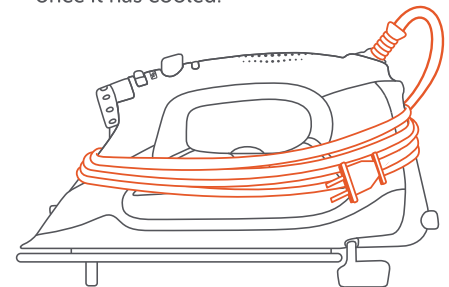

# filling water tank

## step 1



switch off

unplug iron

## step 2



open port

## step 3

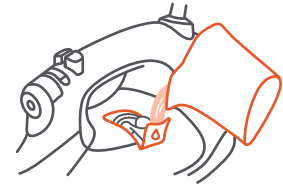

fill (cup included)

Two fill cups equal the max capacity of the water tank.

If you need to add water during ironing, unplug the iron and repeat the above steps.  
After filling, make sure the iron is fully reheated before ironing.

## max fill line

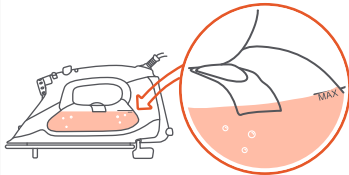

**DO NOT**

Fill the tank past the MAX line on the side of the iron.  
Close the port when done.

## alternative filling

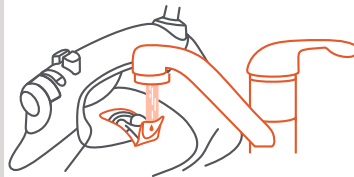

Alternatively, fill directly from a faucet holding the iron horizontally.  
Make sure iron is unplugged.

## water recommendations

This iron is designed to be used with regular tap water. If your water is over 12 grams of hardness, we recommend using either inexpensive bottled spring water or mixing half tap water with half distilled water.



**NEVER USE**

100% distilled water  
as this can cause the iron to spit and leak.

## emptying the tank

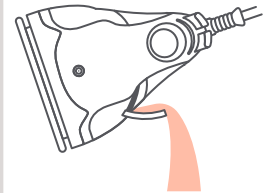

If storing the iron for more than two days, please remember to empty your tank.



# fabric selector

## fabric selector



○ min.	● synthetic	●● wool + silk	●●● linen + cotton
dry iron		steam iron	

### Turn the fabric temperature selector

to select a fabric setting. To use continuous steam or steam burst, the temperature must be set to the cotton or linen range.

## status light

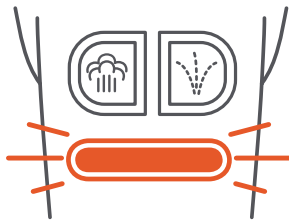

red	flashing green	solid green	flashing red
heat off	optimizing temperature	ready	auto off (heat)

The oliso® smart iron® uses a status light to display the iron's status. To ensure correct temperature, wait until the light displays solid green before ironing.

# Rapid response™ triple play® steam

## continuous steam selector

Slide the steam selector to set the amount of continuous steam.



The iron can only produce steam when the fabric selector knob is set to linen + cotton



Allow the iron to heat up (solid green status light) before activating the steam control. Steam will be produced as soon as the iron is lowered. Steam will stop when iron lifts up.

## horizontal burst

press steam button in



For a strong burst of steam from the soleplate.

## vertical steam

press steam button in



Handheld steamer for curtains and hanging clothes.

## spray

press spray button in



Helps iron heavy fabrics or difficult areas.

## dry ironing

To turn off the steam, slide the steam selector off (🚫).



## zero-drip



zero-drip system

The oliso® smart iron® has a zero-drip feature which shuts off steam any time the iron's scorch guards™ are extended.

# trouble shooting guide

problem	things to check	solution
Iron does not heat	Is fabric selector set to off?	Turn the fabric selector knob to a fabric setting.
	Is iron plugged in correctly?	Check to make sure the plug is fully plugged into the socket.
	Is auto shut-off system activated?	Touch the handle.
Scorch Guards™ do not come out	Is iron plugged in correctly?	Check to make sure the plug is fully plugged into the socket.
	Is handle activated?	Move your hand away from the iron, and the itouch® technology will raise the soleplate.
Iron does not steam	Is iron hot enough?	The fabric selector must be set to the wool, cotton or linen settings to produce continuous steam.
	Is steam selector set to off?	Steam selector must be turned to a setting.
	Is steam valve clogged?	Move the steam selector from off (🚫) to the max (🔥) settings a few times to unclog.
Iron leaks	Is iron is hot enough?	Make sure the fabric selector knob is set to the cotton or linen range to ensure proper steam production.
	Has steam burst button been overused?	Allow 3 seconds between uses of the steam burst function.
Iron is emitting a brown or white substance	Is water hardness too high?	Switch to either spring water or half tap/half distilled water mixture. See water recommendations on page 7.

## maintenance + cleaning

The soleplate should be cleaned if starch or other residue builds up. When the iron is cool, wipe the soleplate with a soft, damp cloth. Do not use abrasive cleaners or scouring pads as this will damage the iron's soleplate.

Mineral deposits from tap water can occur in the soleplate vents. To clean, fill the water tank and heat the iron to the linen fabric setting. Once the iron is fully heated, unplug the iron and hold over a sink. Press the steam button repeatedly until water begins to drip out of the soleplate. Be careful, as this creates large amounts of steam.

To ensure optimal steam production, the steam valve should be regularly cleared of accumulated debris and minerals. This is done by moving the steam selector back and forth from the off (🚫) to the max (🔥) steam settings several times.

If problems persist please visit [oliso.com/faqs](https://oliso.com/faqs)

# warranty

Oliso®  
Birch Haberdashery & Craft 104 Dougharty Road  
Heidelberg West VIC 3081 Australia

Oliso warrants that for a period of one year (TG1600Pro+ Models) from the date of the original purchase, this product will be free from defects in material and workmanship, when utilized for normal household use. Oliso will repair or replace this product or any component of the product found to be defective during the warranty period without charge to the customer. If a replacement product is sent, it will carry the remaining warranty of the original product. Replacement will be made with a new or remanufactured product or component. If the product is no longer available, replacement may be made with a similar product of equal or greater value. This is your exclusive warranty.

This warranty is valid for the original retail purchaser from the date of initial retail purchase and is not transferable. Keep the original sales receipt. Proof of purchase is required to obtain warranty performance. Oliso dealers or retail stores selling oliso products do not have the right to alter, modify or in any way change the terms and conditions of this warranty.

The liability of oliso is limited solely to the cost of repair or replacement of the product at its option. This warranty does not cover normal wear of parts and does not apply to any product that has been tampered with or used for commercial purposes. This warranty does not cover damage caused by misuse, abuse, use on improper voltage or current, use contrary to the operating instructions, negligent handling or damage due to faulty packaging or mishandling in transit. This warranty does not cover damage or defects caused by or resulting from damages from shipping or repairs, service or alteration to the product or any of its parts, which have been performed by a repair person not authorized by oliso. Further, the warranty does not cover Acts of God such as fire, flood, hurricanes, and tornadoes.

This warranty is extended to the original purchaser of the product and excludes all other legal and/or conventional warranties. The responsibility of oliso is limited to the specific obligations expressly assumed by it under the terms of the limited warranty. In no event shall oliso be liable for any incidental or consequential damages caused by breach of any express, implied or statutory warranty or condition.

Except to the extent prohibited by law, any implied warranty or condition of merchantability or fitness for a particular purchase is limited in duration to the duration of the above warranty. oliso disclaims all other warranties, conditions, or representations, express, implied, statutory or otherwise. In no event shall oliso be liable for any indirect, special, incidental or consequential losses or damages (including but not limited to interruption of business or loss of business or profit) resulting from the use of or inability to use the product, any breach of contract, fundamental or otherwise, or for any claim brought against purchaser by any other party. Some states or jurisdictions do not allow the exclusion or limitation of incidental or consequential damages or limitations on how long an implied warranty lasts, so the above limitations or exclusion may not apply to you. If you have any question regarding this warranty or would like to obtain warranty service. Please email oliso at [info@birchcreative.com.au](mailto:info@birchcreative.com.au), and a service center address will be provided to you.

**Please note:** Your oliso® smart iron® may look slightly different than the irons illustrated here.  
For a complete review of current oliso® smart iron® models, please visit [oliso.com](http://oliso.com)

For more information visit

[oliso.com](http://oliso.com)     

*we'd love to hear from you!*

If you have any further questions, you may call +61 3 9450 8900  
or mail us at Birch Haberdashery & Craft 104 Dougharty Road, Heidelberg, West VIC 3081.

[info@birchcreative.com.au](mailto:info@birchcreative.com.au)

thanks

for purchasing the

**oliso**<sup>®</sup>  
smartiron<sup>®</sup>

reinvented *for you*<sup>™</sup>