

# changing cord exit position

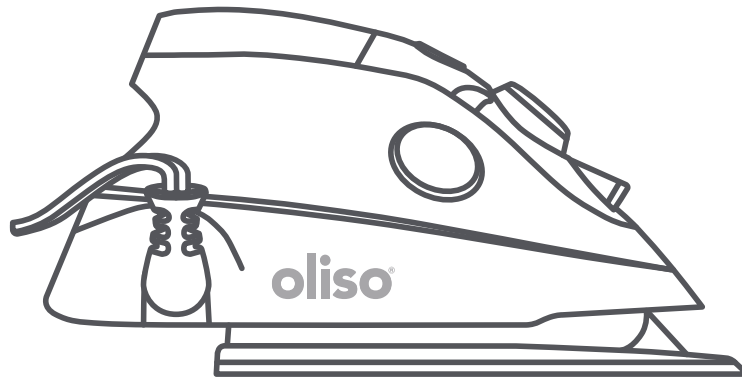

**oliso**<sup>®</sup>  
**M3PRO**  
project iron™

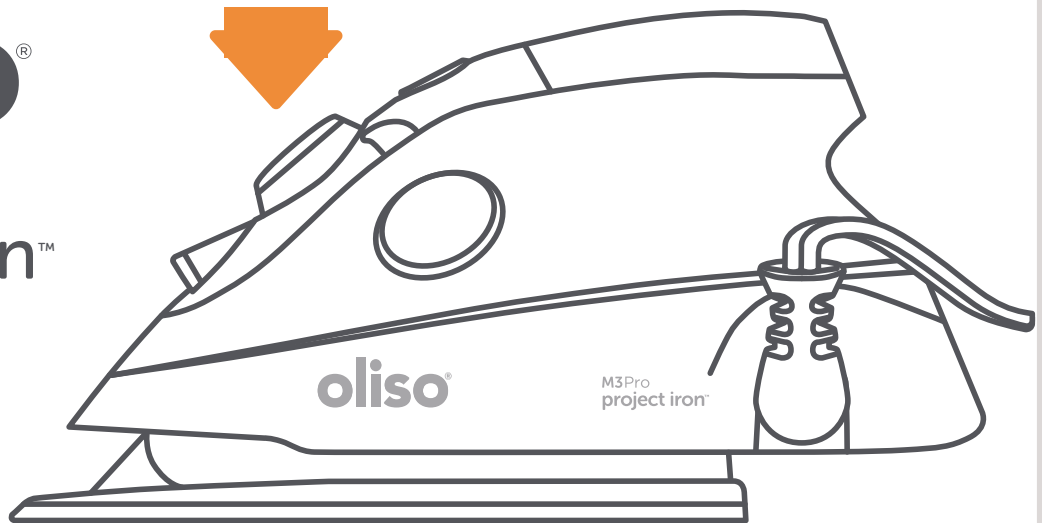

## important safety instructions

### read all instructions before starting

- 1 Before beginning conversion make sure the iron is cold and unplugged from the outlet, and empty of water.
- 2 Only use the original parts of the iron to reassemble, do not substitute or modify the parts in any way, or add additional parts or material to the iron.
- 3 Be careful to not damage the power cord with the tools. If damage occurs stop and contact oliso customer service.
- 4 Be careful not to overly twist the cord when moving.
- 5 Ensure cord is fully under retainer before closing the cover.
- 6 Be careful when fastening the cover in place not to trap the cord between the retainer as it could damage the cord.
- 7 If the cover does not fit snugly back in place, remove and check cord is in the right place.
- 8 Reassemble the cover completely and secure the screws before plugging the iron into the outlet again.
- 9 We recommend changing the cord exit position only once.

**if cord is damaged or cover does not close properly, stop and contact customer service**

# changing cord exit position

## what you will need

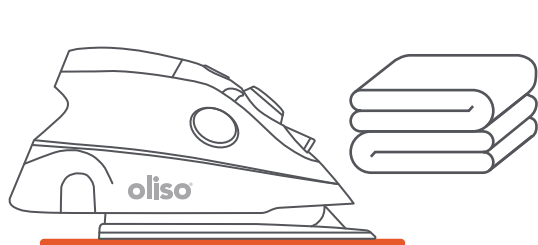

1.

Stable surface and a soft cloth or towel to protect the surface and the iron.



2.

#1 Phillips head handheld screwdriver. Do not use a powered screwdriver.

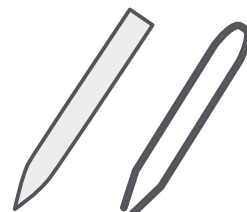

3.

A tool with a soft durable point (like a pencil or tweezers).

### step 1



switch off - unplug iron - let cool.

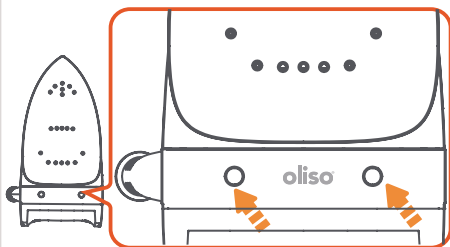

locate the silicone screw covers on either side of the label

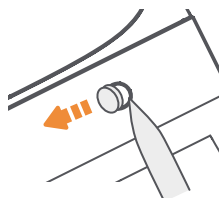

remove covers with a pointy tool or tweezers and set aside.

### step 2

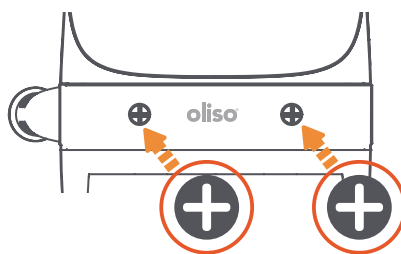

Locate Philips head screws.

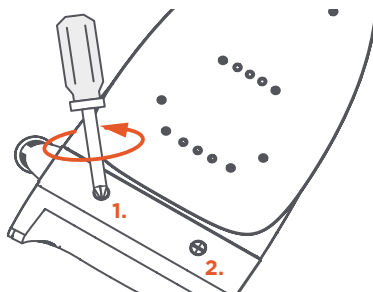

unscrew and set screws aside.

### step 3

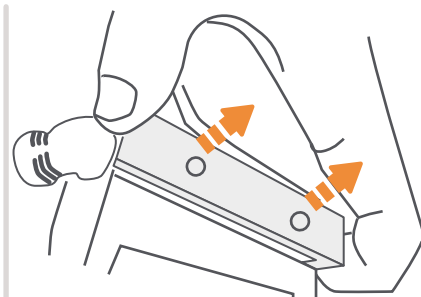

**Gently** loosen cover by lifting directly away from iron. Cable and cover will remain attached to iron.

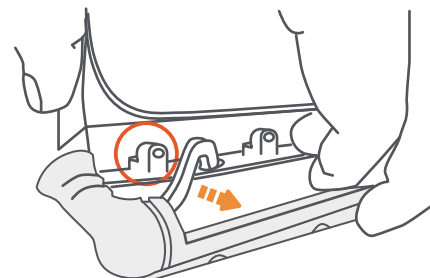

unhook cable from retainer.

# changing cord exit position

## step 4

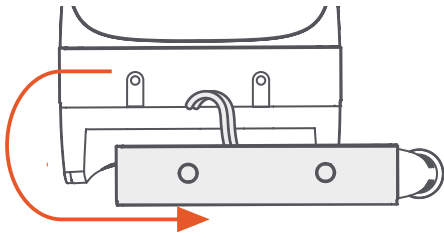

turn cover 180 degrees so cord exit is on opposite side.

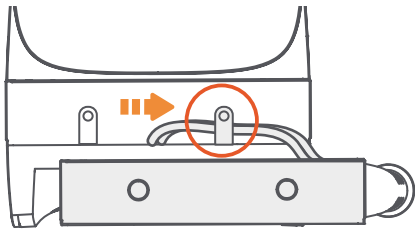

tuck power cable under retainer.

## step 5

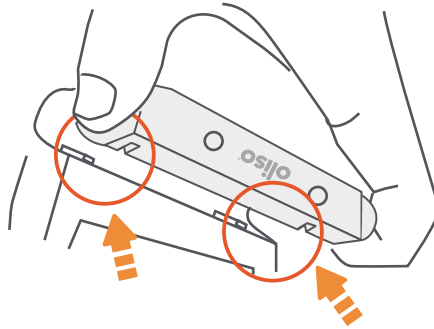

align the grooves in the grey cover with the white rails in the iron.

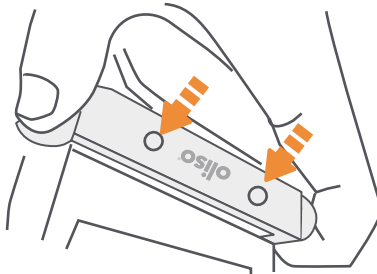

slide cover firmly in place, ensuring cable is not above retainer.  
**printed text will be upside down.**

## step 6

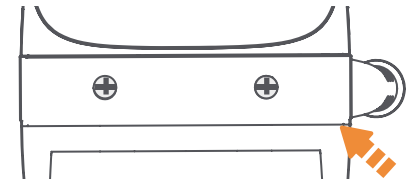

check cover fits correctly, if not remove and check cord position.

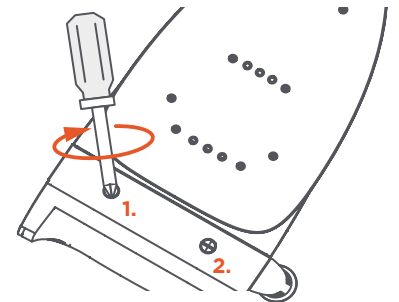

Insert screws and hand tighten only.

**Do not use iron until cover is securely fastened in place.**

## step 7

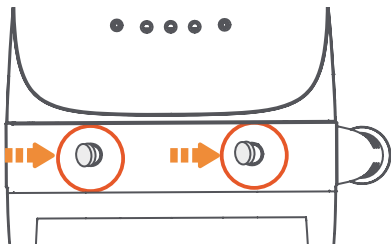

Reinsert silicone covers to complete conversion.

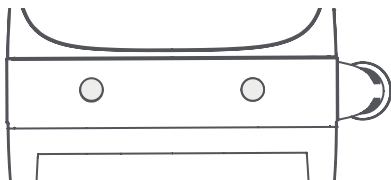

**If at any time during the conversion the cable becomes damaged or trapped, or you are unable to easily reclose the cover do not use the iron and contact oliso consumer service who will help you resolve the issue.**

## For more information visit

[oliso.com](http://oliso.com)     

*we'd love to hear from you!*

8:30am - 4:30pm (Pacific) Monday-Friday 1-800-899-5157  
or mail us at 548 Market St #89615 San Francisco, CA 94104, USA

[customerservice@oliso.com](mailto:customerservice@oliso.com)

