



THE TRMR RACK

TOYOTA TACOMA DOUBLE CAB ROOF RACK INSTRUCTION GUIDE



HARDWARE LIST



Do not install by yourself! Have a second pair of hands to assist with the installation.

DS = DRIVER SIDE / PS = PASSENGER SIDE

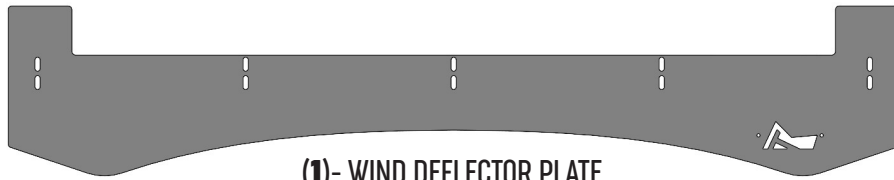

(1)- WIND DEFLECTOR PLATE

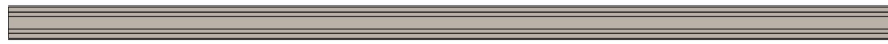

(6)- ALUMINUM EXTRUSION

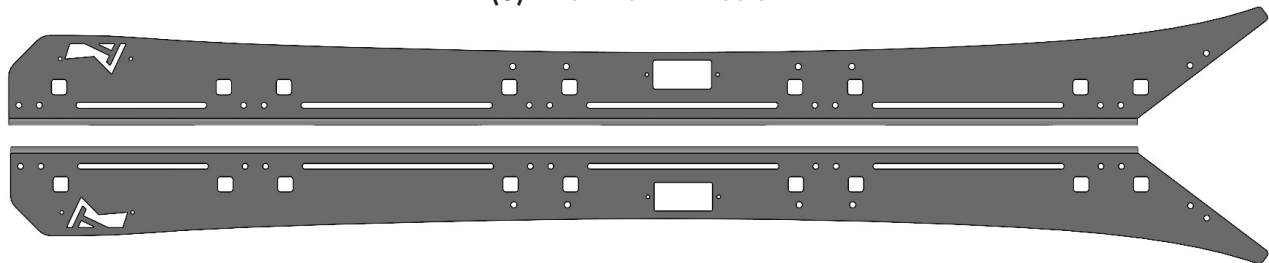

(1)- DS SIDE PANEL (1)- PS SIDE PANEL



(1)- PS FRONT BRACKET



(1)- DS FRONT BRACKET



(1)- PS REAR BRACKET



(1)- DS REAR BRACKET



(4)- SUPPORT BRACKET



(3)- LOGO PLATE



(2)- 4" X 1" FRONT RUBBER BLOCK



(2)- 4" X 1" REAR RUBBER BLOCK



(1)- WIND DEFLECTOR PLATE RUBBER SEAL



(1)- TUBE OF LOCTITE

(8)
M6-1 X 45MM



(8)
1/4"-20 X 1"



(24)
1/4"-20 X 3/4"



(10)
1/4"-20 X 1/2"



(10)
1/4"-20
T-NUT



(8)
1/4"-20 X 3/4"
SPACER



(8)
1/4" ID
RUBBER WASHER

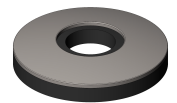

(16)
1/4"-20 X 5/8"



(6)
5-40 X 1/2"



(16)
1/4"-20
NYLON NUT



(6)
5-40 NUT



(42)
1/4" ID
WASHER



TORQUE SPECS

KEEP IN MIND, THE AVERAGE TORQUE SPECS OF A 1/4"-20 BOLT IS 75 INCH POUNDS WHICH EQUALS 6.25 FOOT POUNDS. THE HEAD OF THE BOLT SHEARS AT 15 FOOT POUNDS.



TRMR ROOF RACK PRE-ASSEMBLY



STEP 1

PLACE RUBBER SEAL ONTO WIND DEFLECTOR. MAKE SURE TO EVENLY SPACE IT ACROSS. PRESS ON FIRMLY, YOU WILL FEEL POSITIVE FEEDBACK ON THE RUBBER SEAL SEATING.

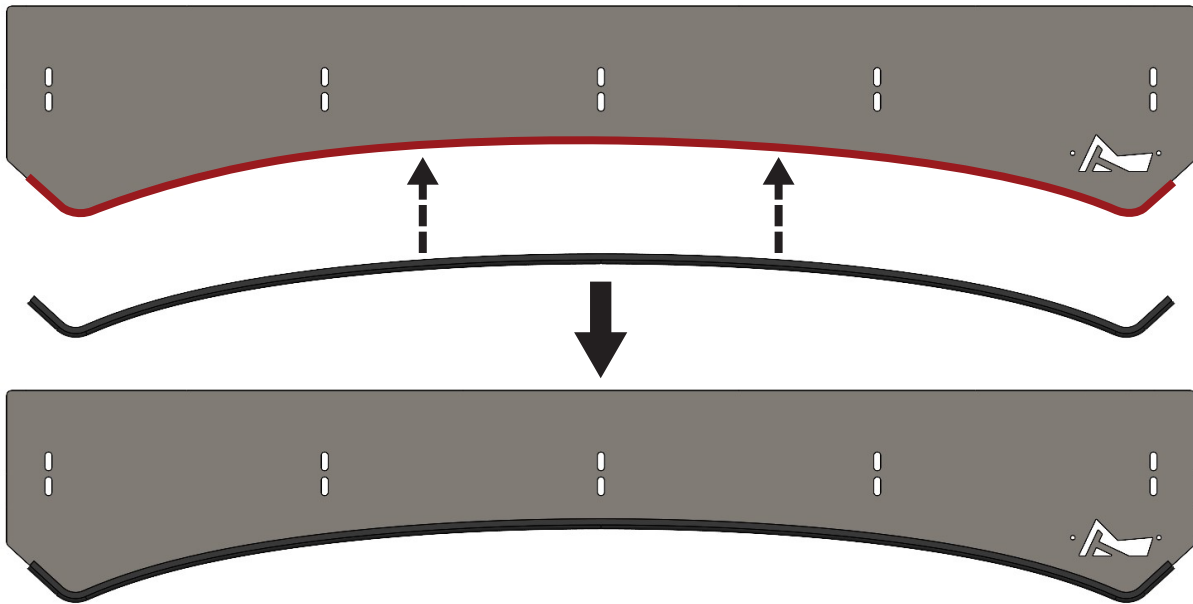

(PRO TIP: FOR BEST PLACEMENT FIND THE CENTER OF RUBBER SEAL BY FOLDING IT IN HALF. NEXT PLACE CENTER OF RUBBER SEAL IN MIDDLE OF THE WIND DEFLECTOR PLATE AND WORK FROM THE CENTER OUT.)

STEP 2

WITH THE LOGO CUT OUT ON THE DRIVER SIDE, INSTALL (10) 1/4"-20 1/2" BLACK OXIDE BUTTON HEAD BOLTS, (10) 1/4" BLACK OXIDE ID WASHERS, AND (10) 1/4" T-NUTS ONTO WIND DEFLECTOR PLATE. KEEP THE T-NUTS LOOSE FOR STEP 7.

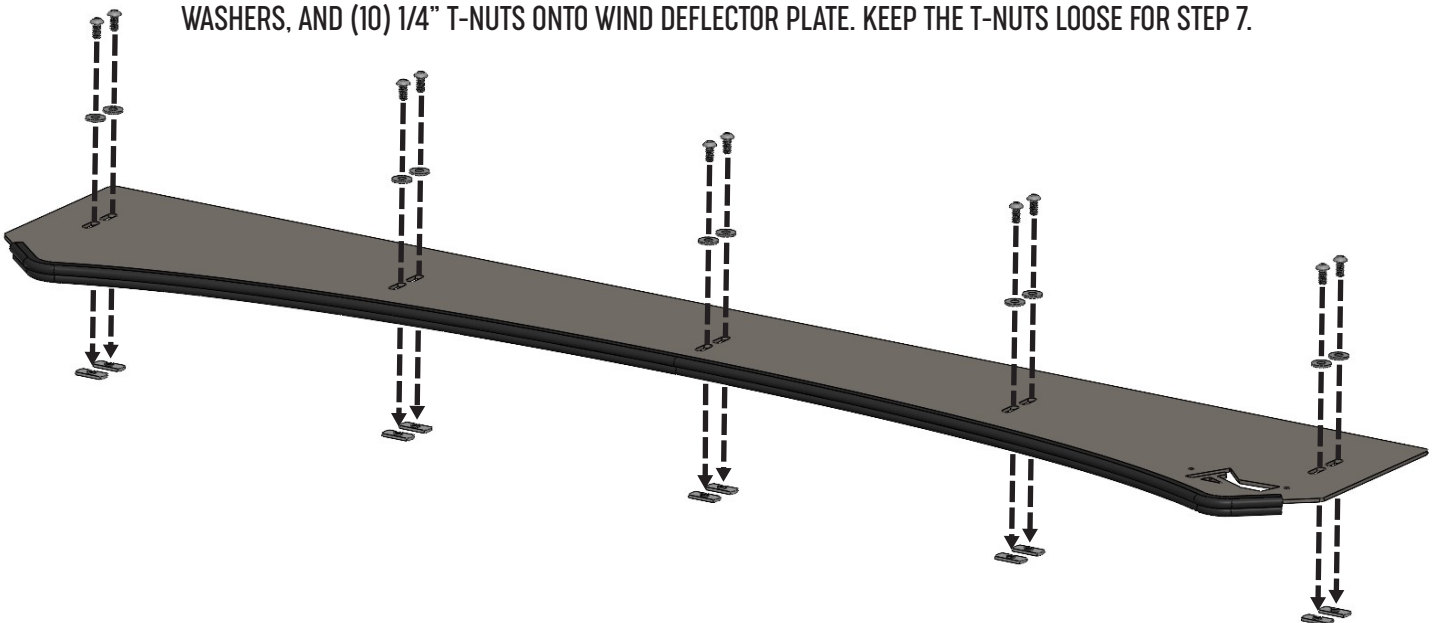

TRMR ROOF RACK PRE-ASSEMBLY



STEP 3

USE (2) 5-40 1/2" BOLTS AND (2) 5-40 NUTS TO INSTALL ONE LOGO PLATE TO THE FRONT WIND DEFLECTOR PLATE.

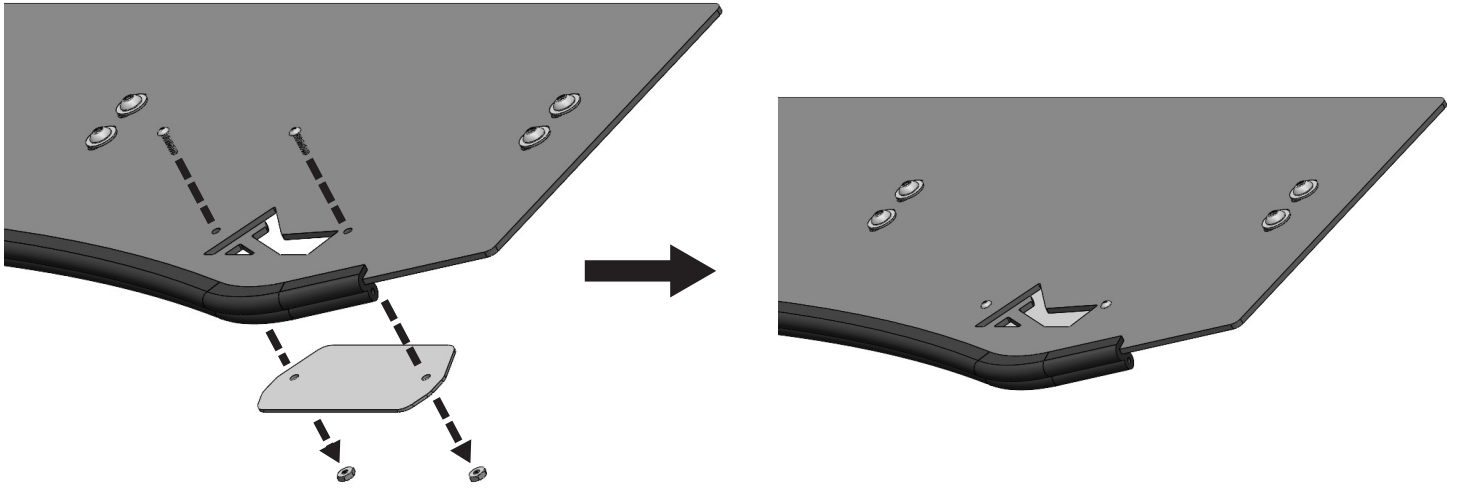

STEP 4

USE (2) 5-40 1/2" BOLTS AND (2) 5-40 NUTS TO INSTALL EACH LOGO PLATE TO THE DRIVER AND PASSENGER SIDE RAILS.

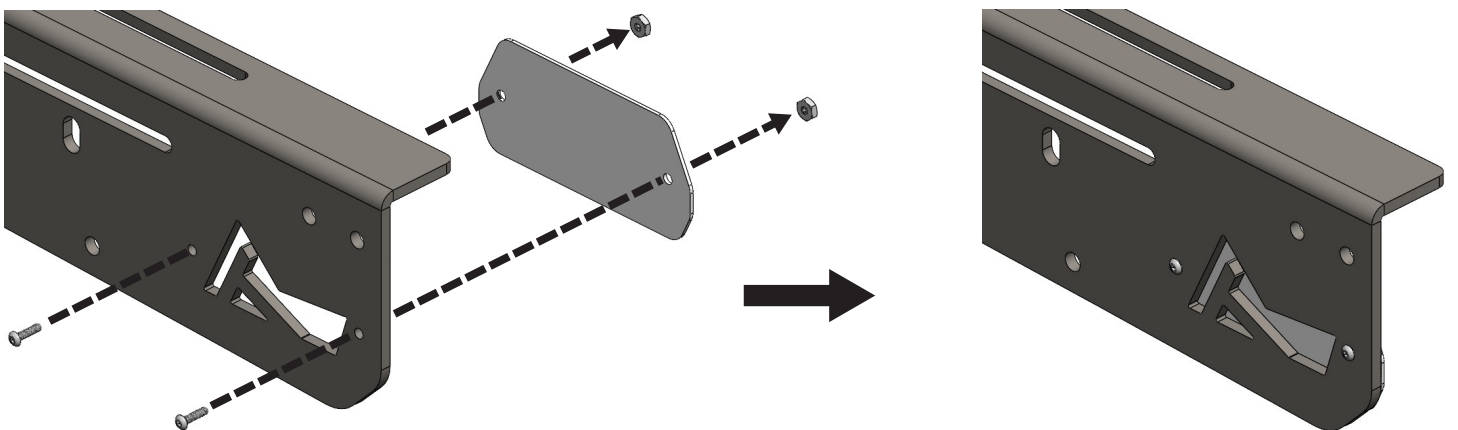



TRMR ROOF RACK ASSEMBLY



STEP 1

SLIDE ONE ALUMINUM EXTRUSION ONTO THE WIND DEFLECTOR'S T-NUTS. **DO NOT** FASTEN THE 1/4"-20 BLACK OXIDE BUTTON HEAD BOLTS AT THIS TIME.

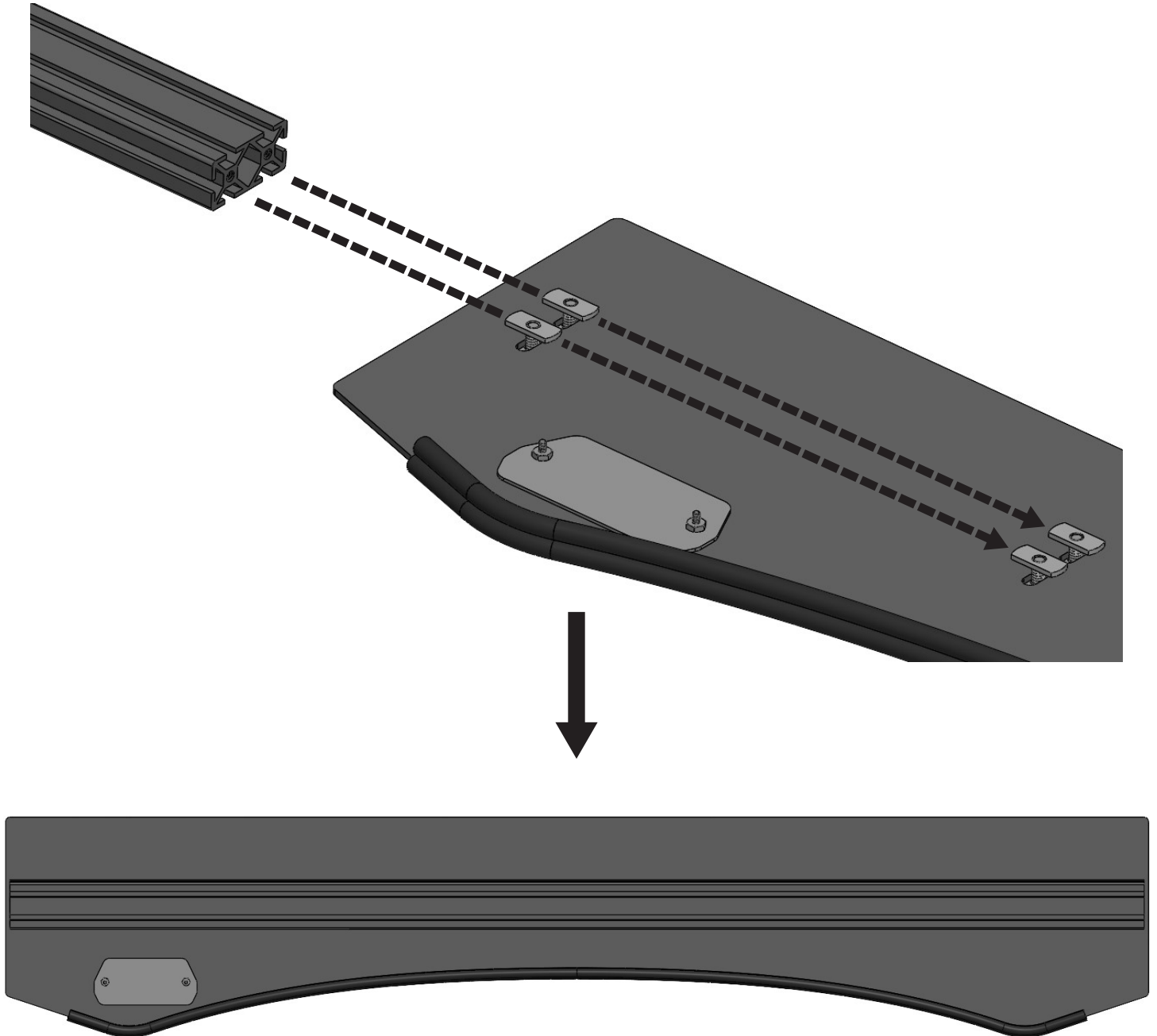



TRMR ROOF RACK ASSEMBLY



STEP 2

SLIDE IN (4) 1/4"-20 5/8" CARRIAGE BOLTS INTO THE DOUBLE SLOT FACE OF AN ALUMINUM EXTRUSION. PLACE ONE SUPPORT BRACKET ONTO EACH PAIR OF CARRIAGE BOLTS AND THREAD ON WITH 1/4"-20 NYLON LOCK NUTS. LEAVE NYLON LOCK NUTS LOOSE UNTIL **STEP 11**. REPEAT THIS STEP WITH A SEPARATE ALUMINUM EXTRUSION.

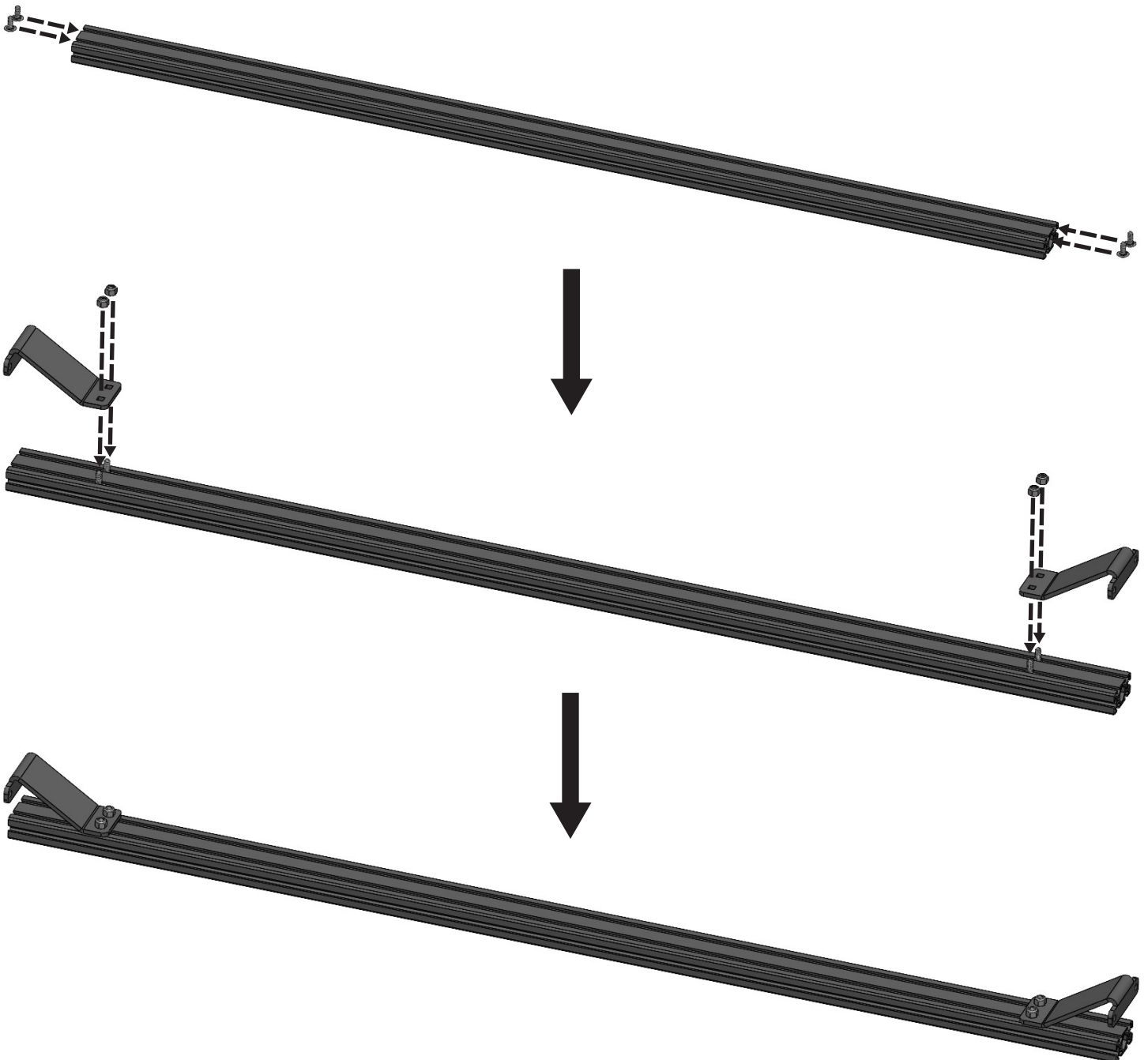



TRMR ROOF RACK ASSEMBLY



STEP 3

INSTALL WIND DEFLECTOR SUBASSEMBLY, THE TWO SUPPORT EXTRUSION SUB-ASSEMBLIES, AND ONE ALUMINUM EXTRUSION USING (4) 1/4"-20 3/4" BLACK OXIDE BUTTON HEAD BOLTS AND (4) 1/4" ID BLACK OXIDE WASHERS PER EXTRUSION. ADD A SMALL AMOUNT OF LOCTITE TO EACH BOLT. DO NOT TIGHTEN BOLTS ALL THE WAY DOWN UNTIL **STEP 11**.

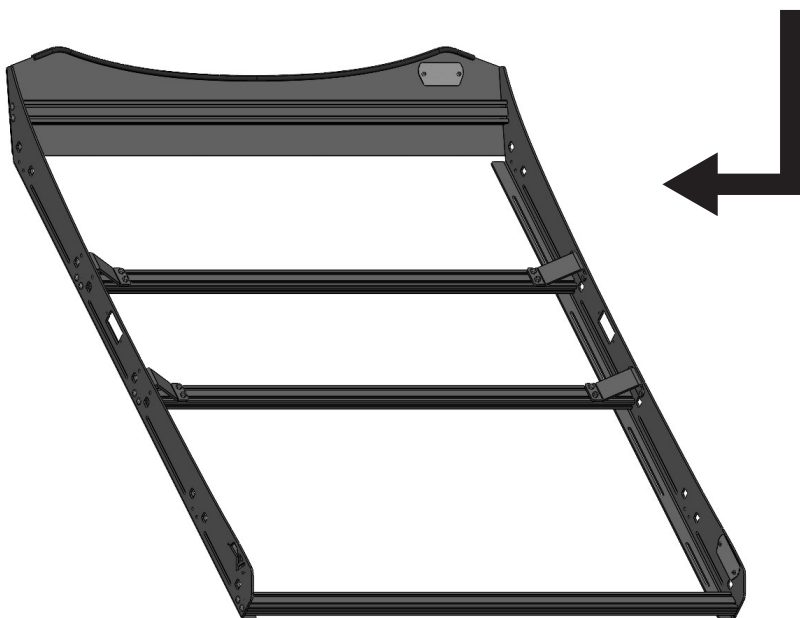
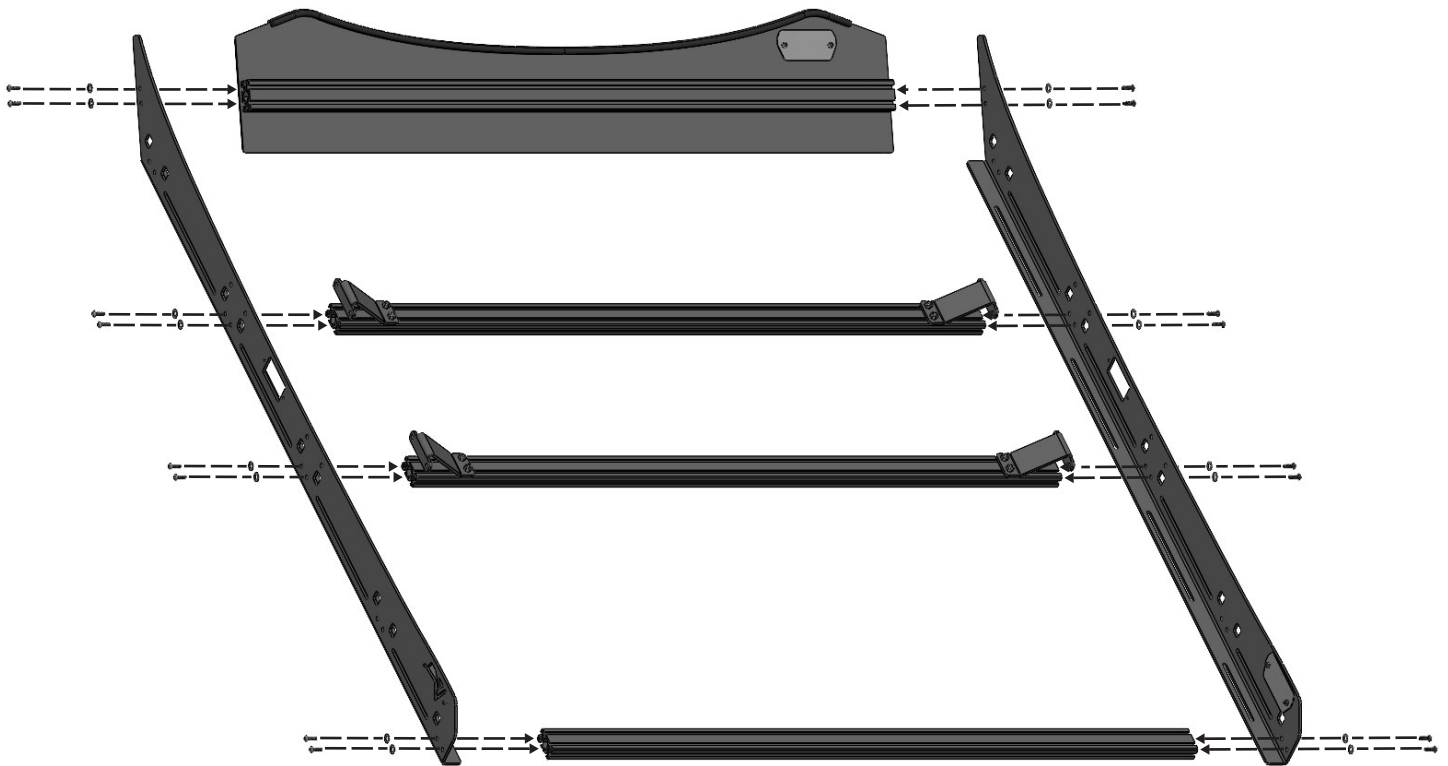

WARNING

MAKE SURE WIND DEFLECTOR REST ON TOP OF THE PASSENGER AND DRIVER SIDE RAILS.



TRMR ROOF RACK ASSEMBLY



STEP 5

SLIDE IN (4) 1/4"-20 X 5/8" CARRIAGE BOLTS INTO THE DOUBLE SLOT FACE OF AN ALUMINUM EXTRUSION. PLACE THE DOUBLE ARROW MOUNTING BRACKETS ONTO EACH PAIR OF CARRIAGE BOLTS WITH ARROWS FACING SAME DIRECTION. THREAD ON EACH 1/4"-20 NYLON LOCK NUTS AND LEAVE LOOSE. REPEAT THE PROCESS AGAIN WITH THE SINGLE ARROW MOUNTING BRACKETS.

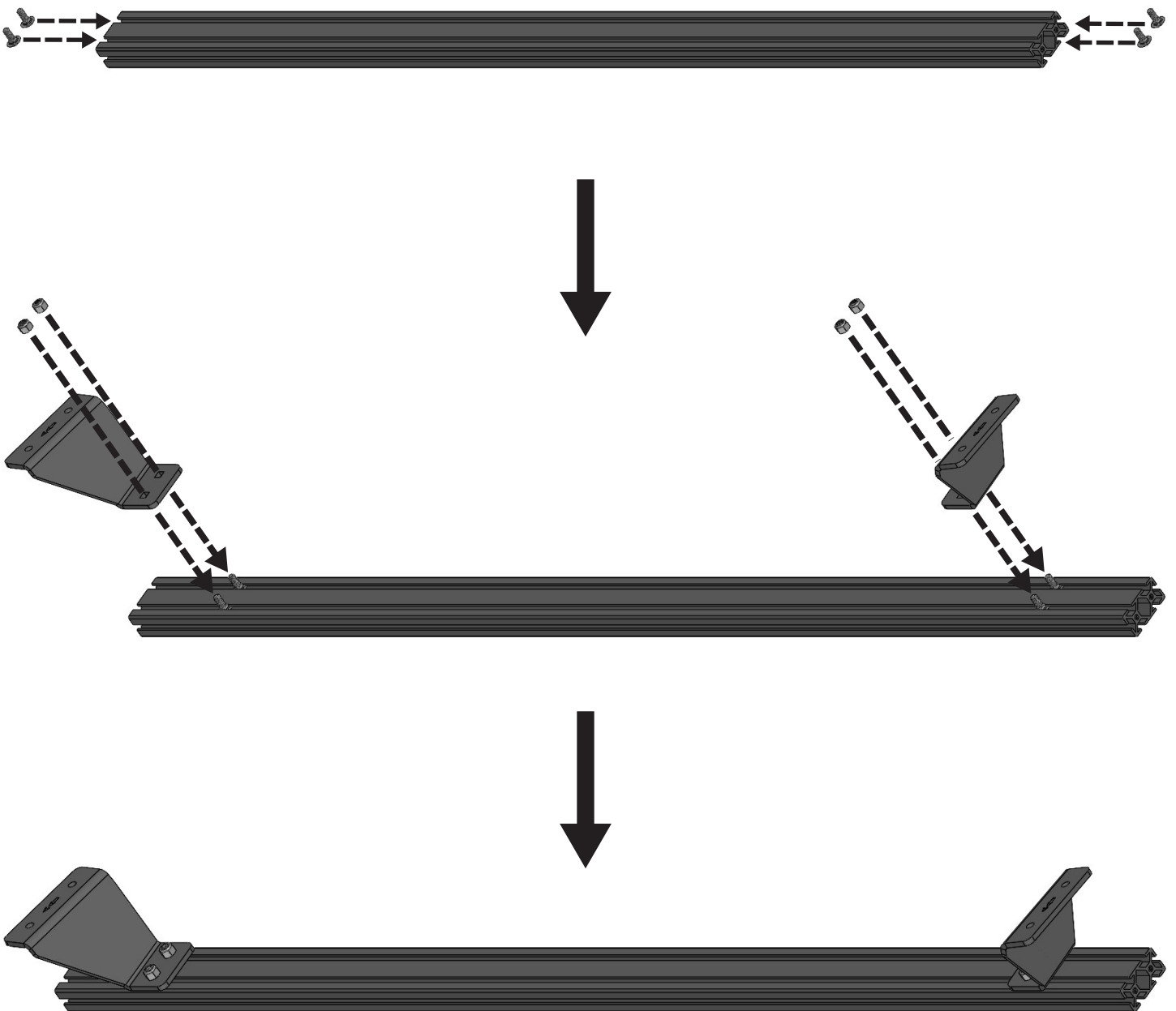



TRMR ROOF RACK ASSEMBLY



STEP 6

REMOVE THE UPPER TWO RUBBER ROOF MOLDINGS.

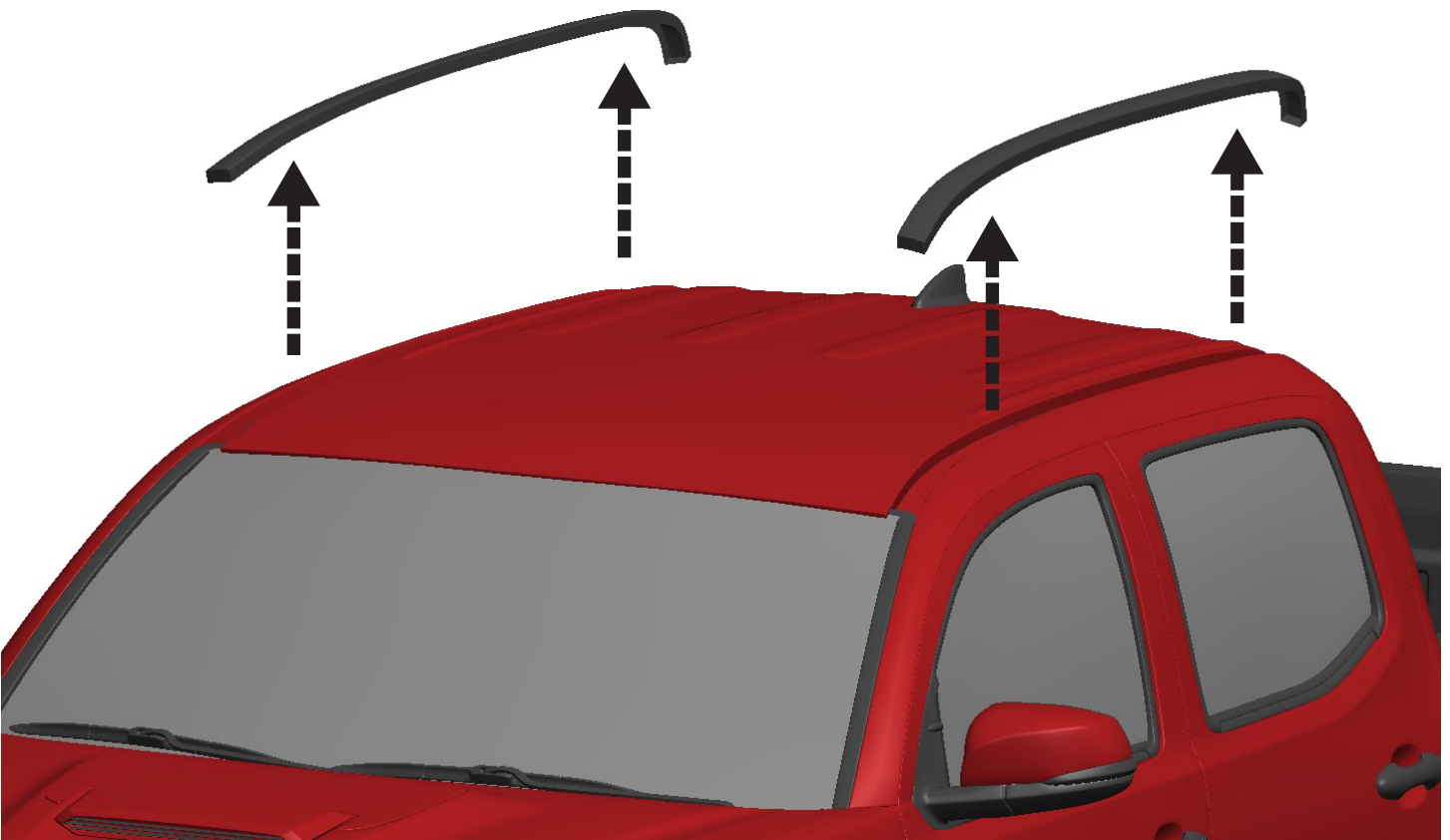

TRMR ROOF RACK ASSEMBLY



STEP 7

PRESS IN (2) 1/4 ID X 3/4" SPACERS INTO EACH RUBBER BLOCK.

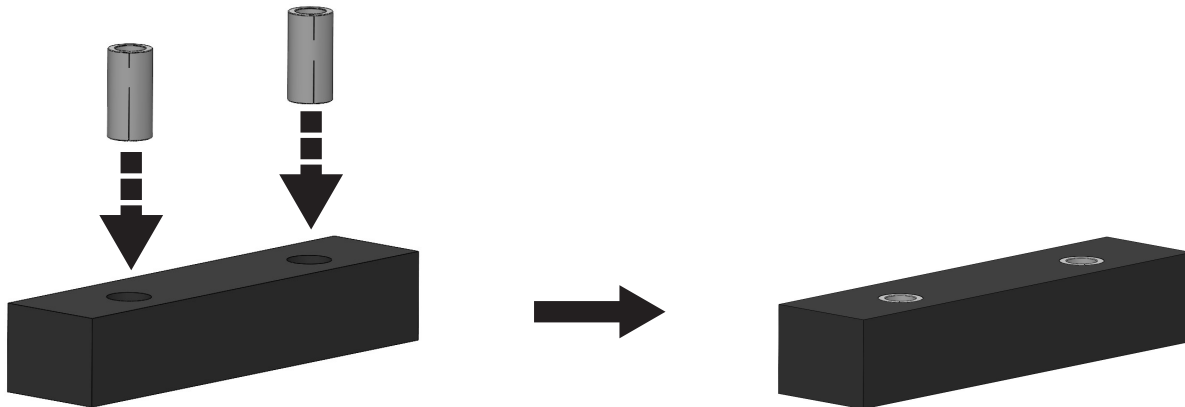

STEP 8

SET TWO RUBBER BLOCK SUB-ASSEMBLIES ONTO THE FRONT MOUNTING PORTS OF THE VEHICLE. PLACE THE DOUBLE ARROW MOUNTING SUBASSEMBLY FROM **STEP 5** ONTO THE RUBBER BLOCKS WITH ARROWS POINTING TOWARDS THE FRONT OF THE VEHICLE. BOLT ON (2) M6 X 45MM HEX HEAD CAP SCREWS AND (2) #14 ID X 5/8" OD STAINLESS STEEL WASHERS ONTO EACH MOUNTING BRACKET. CENTER THE TOP ALUMINUM EXTRUSION AND FASTEN DOWN EACH 14/-20 NYLON LOCK NUTS.

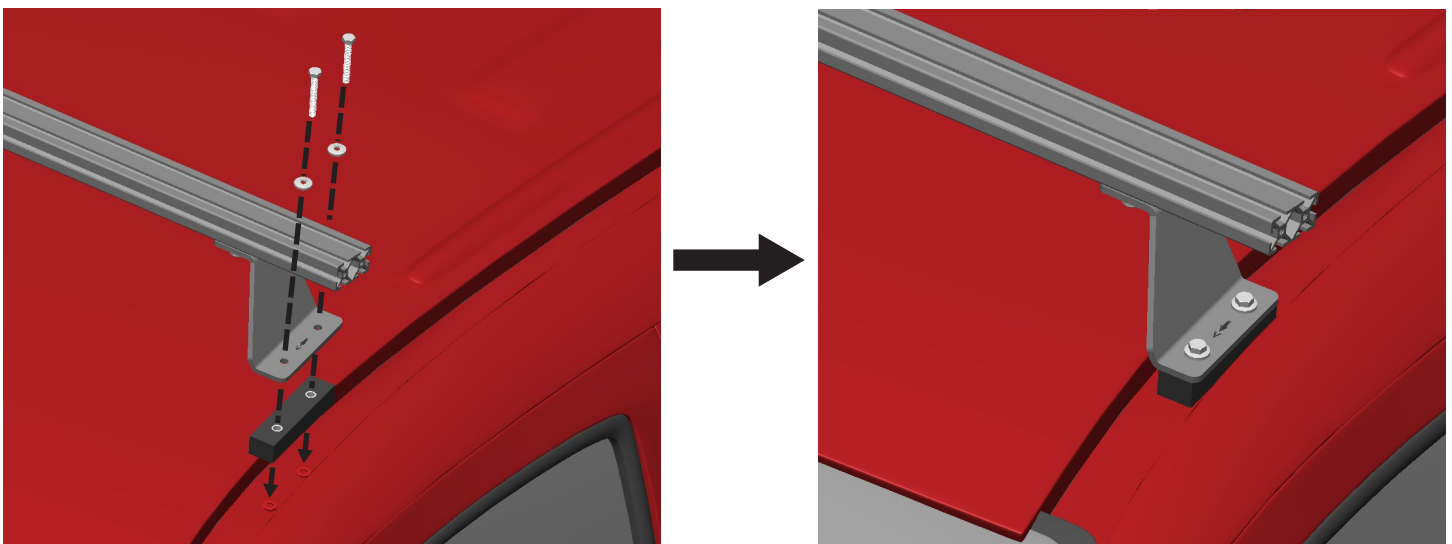

TRMR ROOF RACK ASSEMBLY



STEP 9

PRESS IN (2) 1/4" ID X 3/4" SPACERS INTO EACH RUBBER BLOCK.

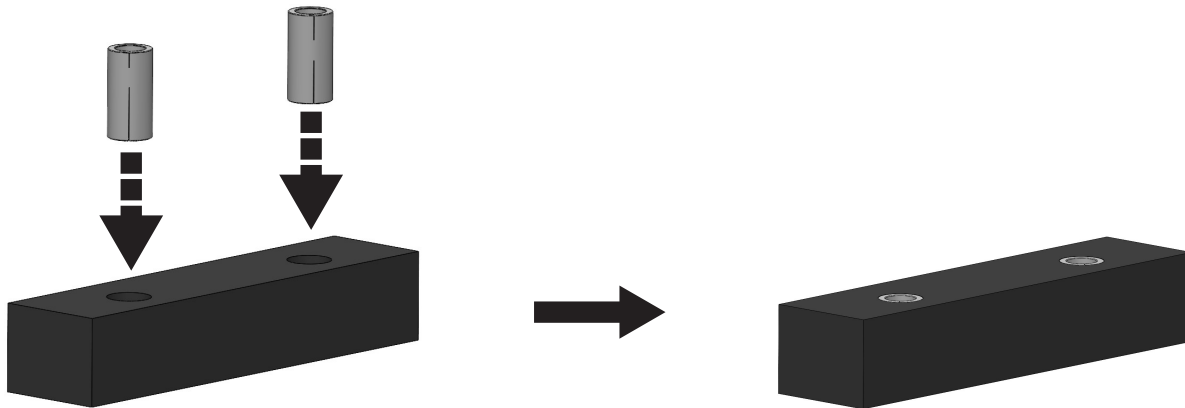

STEP 10

SET TWO RUBBER BLOCK SUB-ASSEMBLIES ONTO THE REAR MOUNTING PORTS OF THE VEHICLE. PLACE THE SINGLE ARROW MOUNTING SUBASSEMBLY FROM **STEP 5** ONTO THE RUBBER BLOCKS WITH ARROWS POINTING TOWARDS THE FRONT OF THE VEHICLE. BOLT ON (2) M6 X 45MM HEX HEAD CAP SCREWS AND (2) #14 ID X 5/8" OD STAINLESS STEEL WASHERS ONTO EACH MOUNTING BRACKET. CENTER THE TOP ALUMINUM EXTRUSION AND FASTEN DOWN EACH 14/-20 NYLON LOCK NUTS.

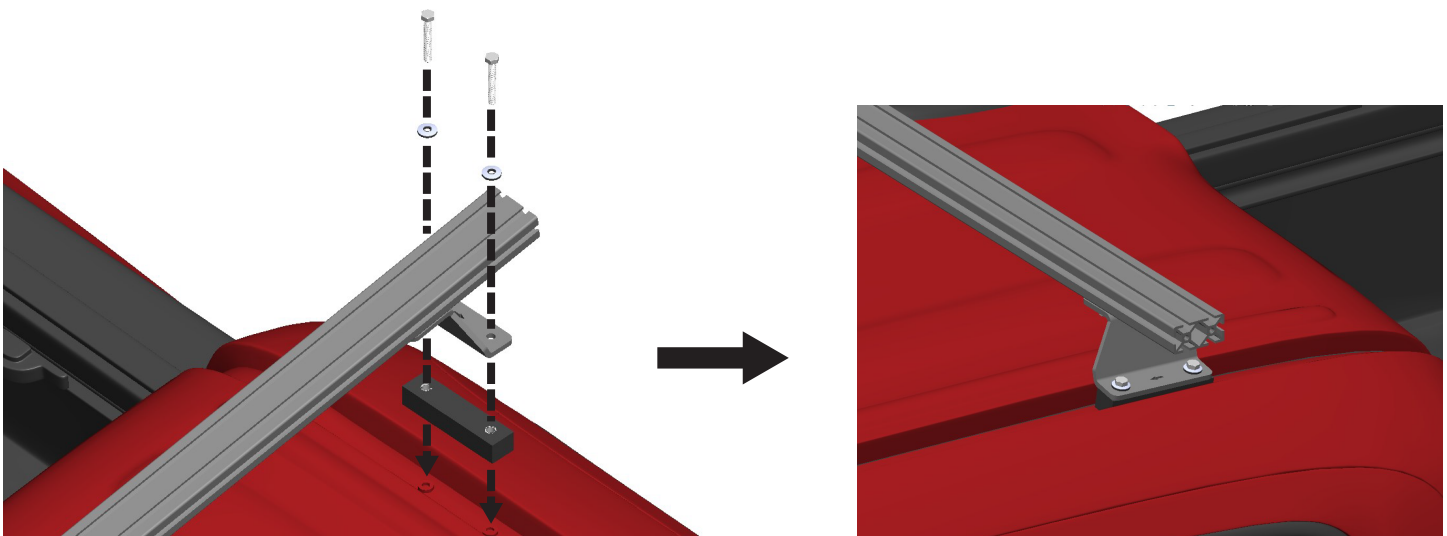

TRMR ROOF RACK ASSEMBLY



STEP 11

WITH AN EXTRA SET OF HANDS PLACE THE PARTIAL ROOF RACK FROM **STEP 3** ONTO THE TWO SUB-ASSEMBLED MOUNT EXTRUSIONS ON THE ROOF.

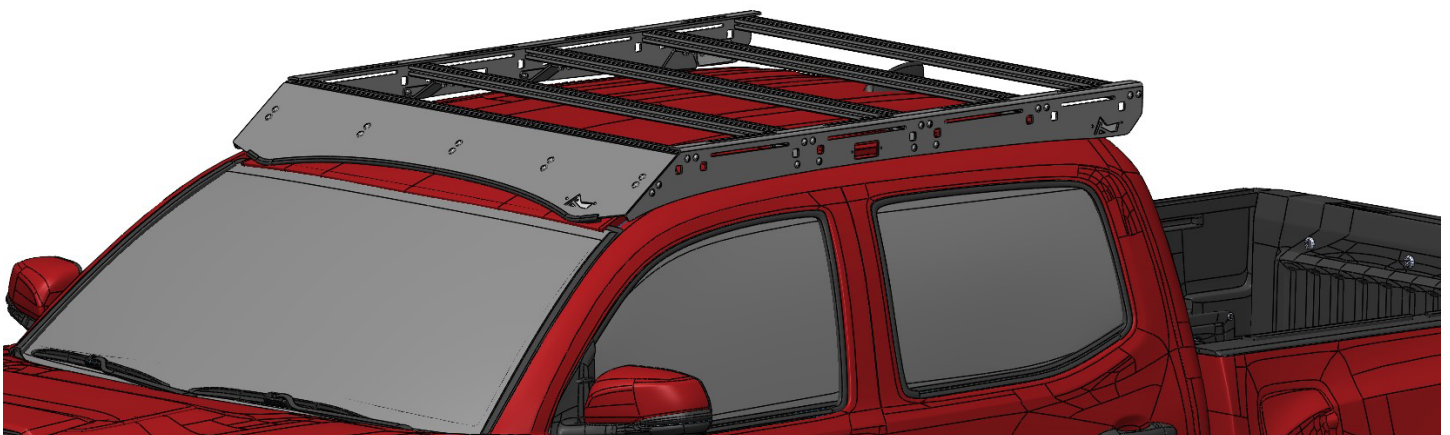
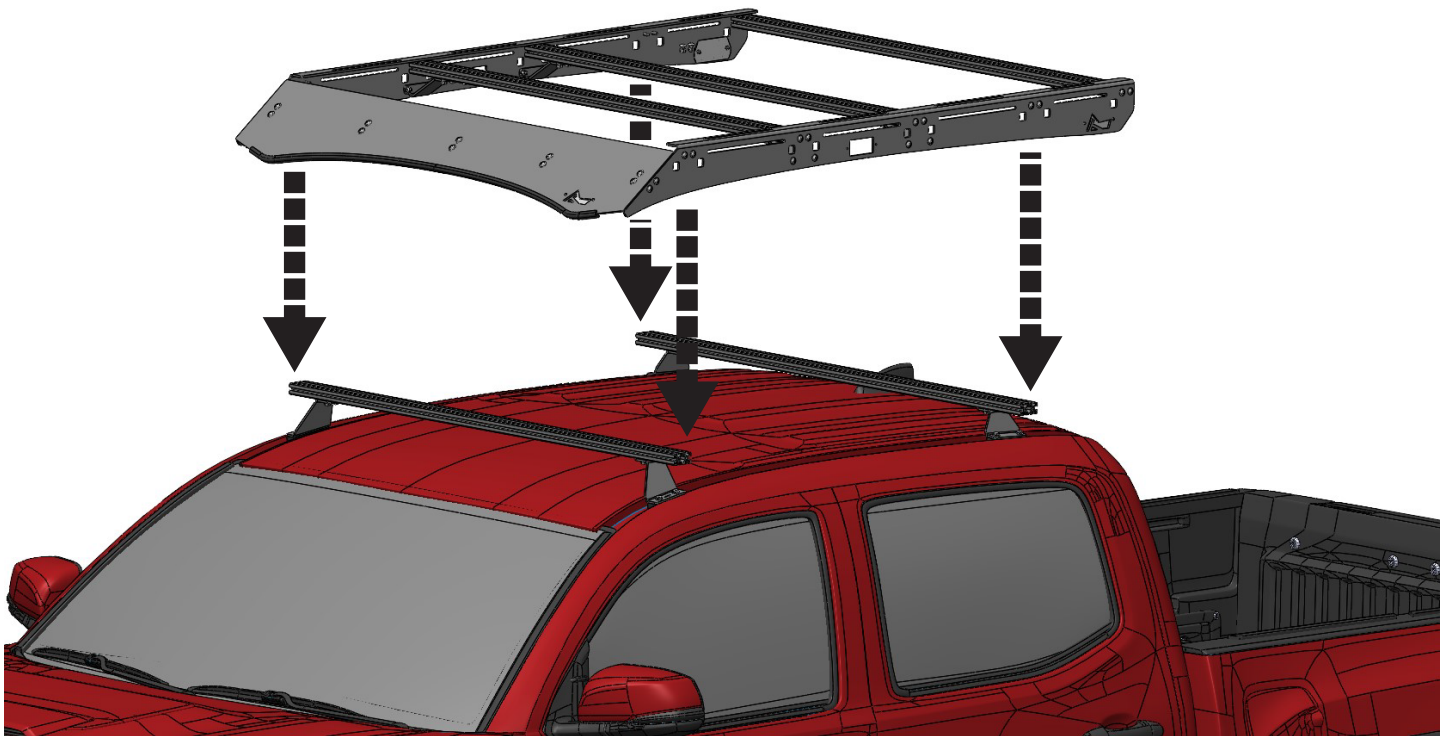

TRMR ROOF RACK ASSEMBLY



STEP 11

LINE UP THE SIDE FAIRING HOLES TO THE SUB-ASSEMBLED MOUNT EXTRUSIONS. USE (4) 1/4"-20 X 3/4" BLACK OXIDE BUTTON HEAD BOLTS AND (4) 1/4" ID BLACK OXIDE WASHERS PER MOUNT EXTRUSION. PLACE LOCTITE ONTO EACH BOLT AND TIGHTEN DOWN ALL LOOSE HARDWARE FROM THE PREVIOUS STEPS.

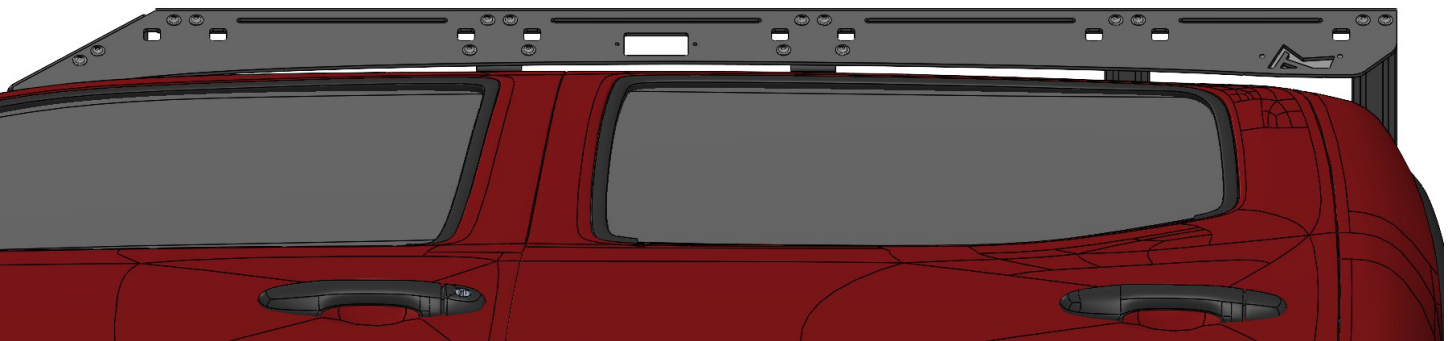
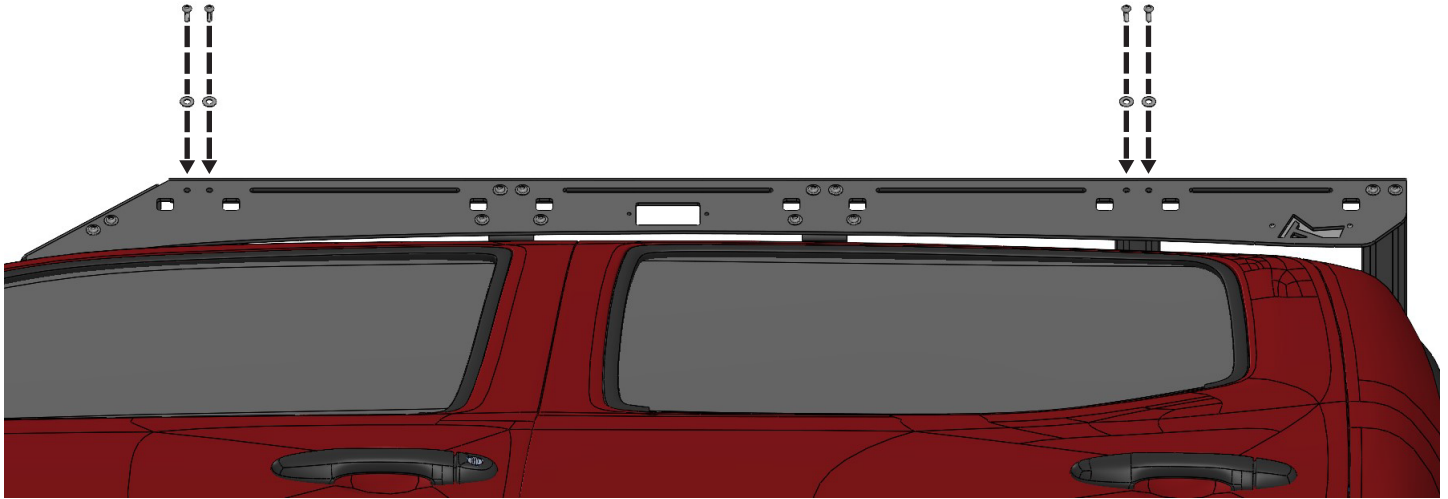

WARNING

AFTER 500 MILES RE-TIGHTEN ALL
HARDWARE ON ROOF RACK.



TRMR ROOF RACK ASSEMBLY



STEP 4

USE (2) 1/4"-20 X 3/4" BLACK OXIDE BUTTON HEAD BOLTS, (2) 1/4" ID BLACK OXIDE WASHERS, AND (2) 1/4"-20 NYLON LOCK NUTS PER SUPPORT BRACKET. LEAVE LOOSE UNTIL **STEP 11**.

