



THE TRMR RACK

BRONCO SPORT ROOF RACK INSTRUCTION GUIDE



HARDWARE LIST



Do not install by yourself! Have a second pair of hands to assist with the installation.

DS = DRIVER SIDE / PS = PASSENGER SIDE

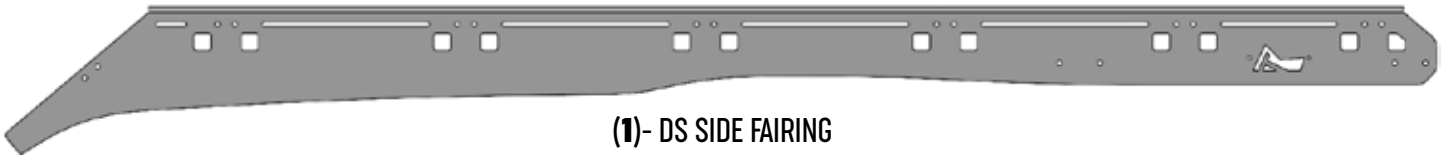

(1)- DS SIDE FAIRING



(1)- PS SIDE FAIRING



(1)- WIND DEFLECTOR PLATE



(7)- 48.5" ALUMINUM EXTRUSION



(1)- DS FRONT CLAMP
(FBS-16)



(1)- DS FRONT CLAMP
(FBS-17)

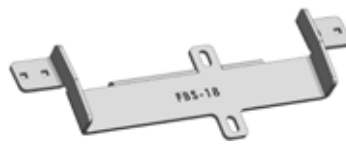

(1)- DS FRONT CLAMP
(FBS-18)

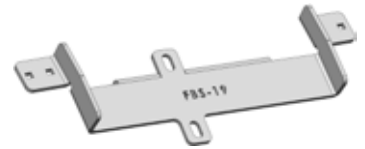

(1)- DS FRONT CLAMP
(FBS-19)



(3)- LOGO PLATE



(4)- 6.5"X 3" OUTER
CLAMP GASKET



(1)- WIND DEFLECTOR
PLATE RUBBER SEAL



(1)- TUBE OF
LOCTITE

(4)

3/8"-16 SQUARE
U BOLT



(28)

1/4"-20 X 3/4"



(10)

1/4"-20 X 1/2"



(10)

1/4"-20
T-NUT



(54)

1/4" ID
WASHER



(16)

1/4"-20
NYLON NUT



(16)

1/4"-20 X 5/8"



(6)

5-40 X 1/2"



(16)

3/8" ID
WASHER



(4)

3/8"-16 NYLON
NUT



(6)

5-40 NUT



TORQUE SPECS

KEEP IN MIND, THE AVERAGE TORQUE SPECS OF A 1/4"-20 BOLT IS 75 INCH POUNDS WHICH EQUALS 6.25 FOOT POUNDS. THE HEAD OF THE BOLT SHEARS AT 15 FOOT POUNDS.

PRE-ASSEMBLY



STEP 1

PLACE RUBBER SEAL ONTO WIND DEFLECTOR. MAKE SURE TO EVENLY SPACE IT ACROSS. PRESS ON FIRMLY, YOU WILL FEEL POSITIVE FEEDBACK ON THE RUBBER SEAL SEATING.

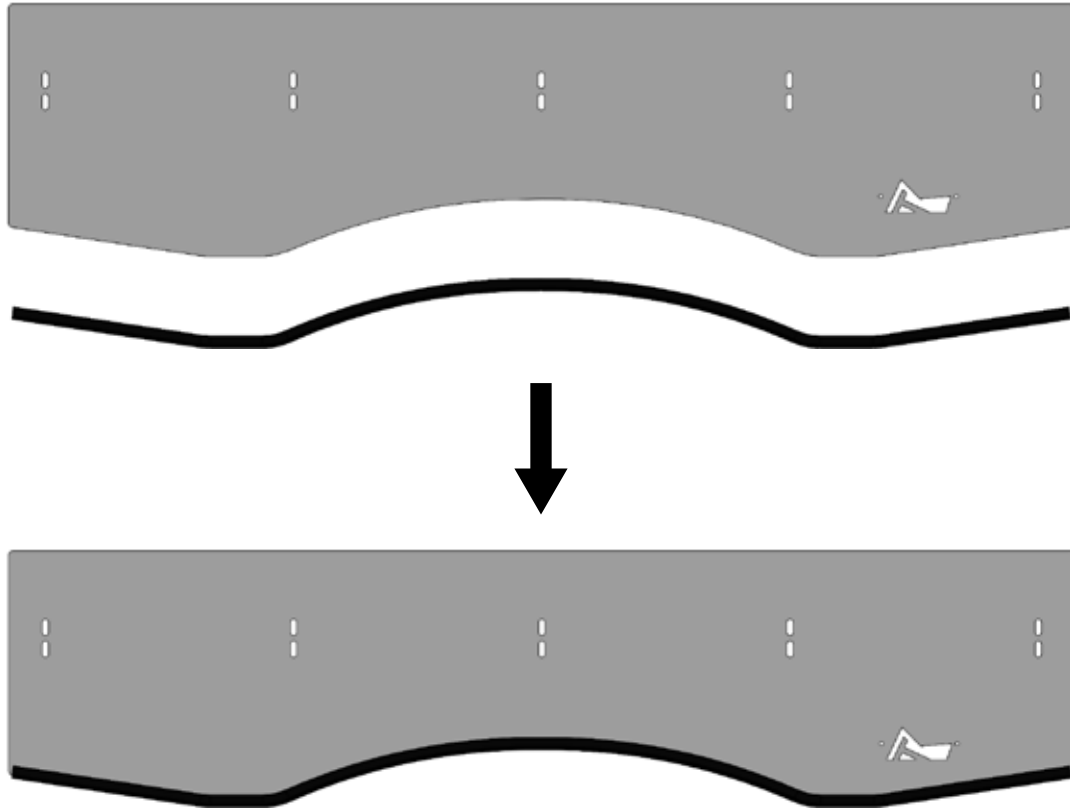

STEP 2

USE (2) 5-40 X 1/2" BOLTS AND (2) 5-40 NUTS TO INSTALL ONE LOGO PLATE TO THE FRONT WIND DEFLECTOR PLATE.

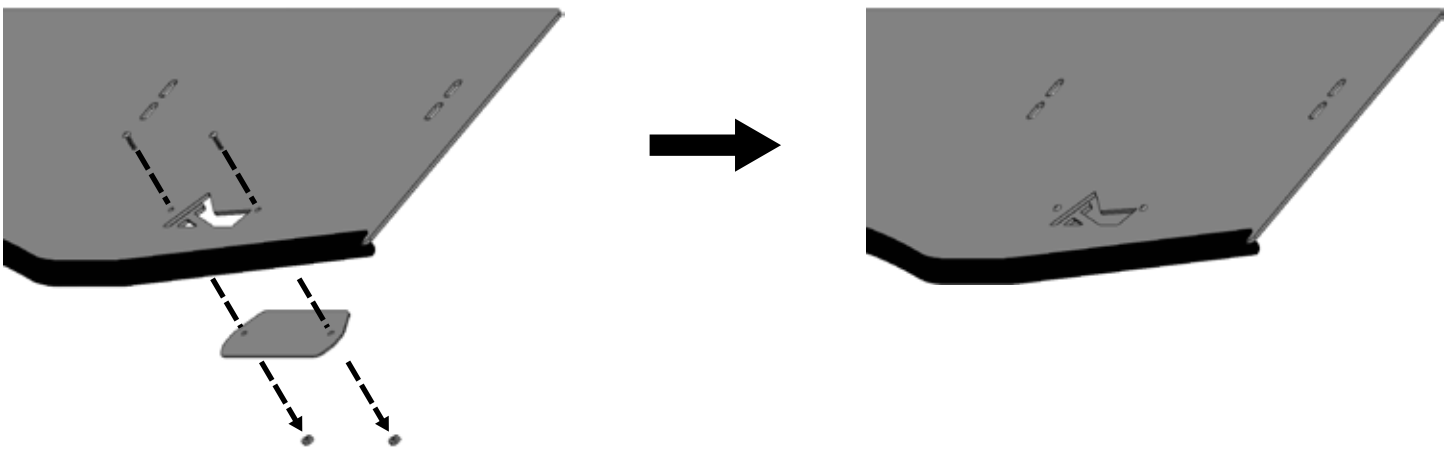

PRE-ASSEMBLY



STEP 3

USE (2) 5-40 X 1/2" BOLTS AND (2) 5-40 NUTS TO INSTALL EACH LOGO PLATE TO THE DRIVER AND PASSENGER SIDE RAILS.

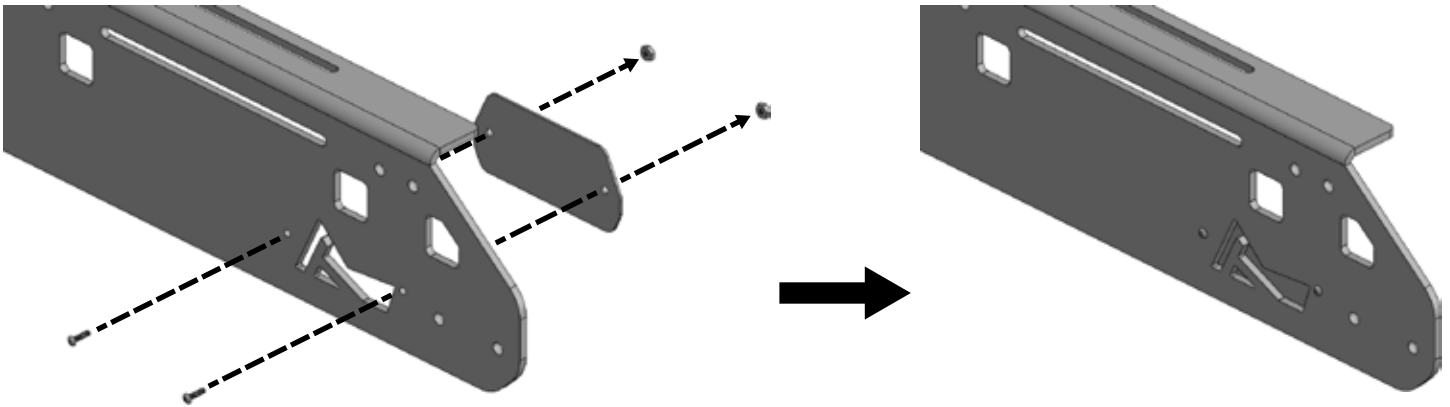

STEP 4

INSERT THE 6.5" X 3" FOAM STRIP BY REMOVING THE ADHESIVE COVER AND PLACING INTO THE GROOVE. DO THIS FOR ALL CLAMPS (FBS-16, FBS-17, FBS-18, AND FBS-19).

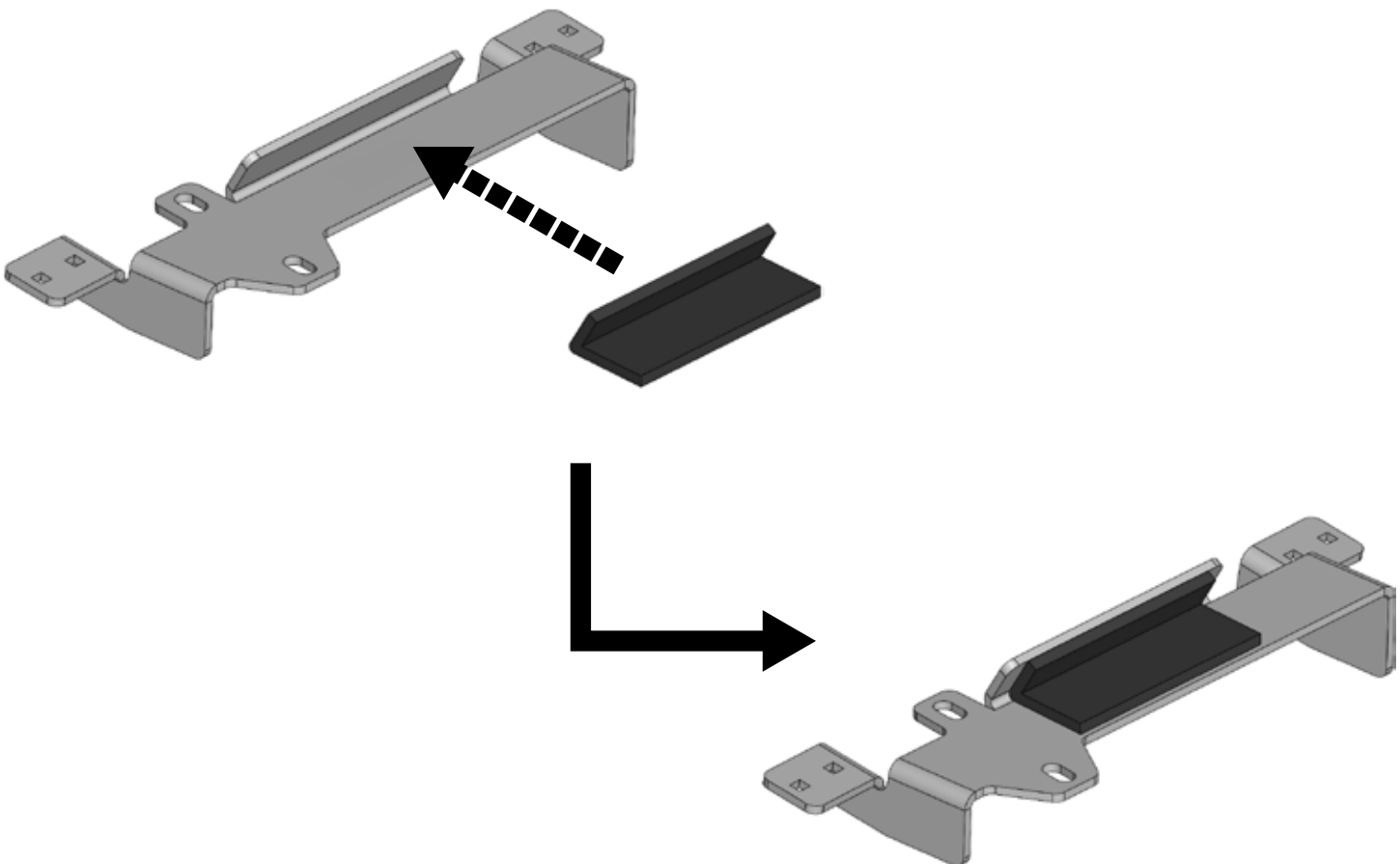



TRMR ROOF RACK ASSEMBLY



STEP 1

WITH THE LOGO CUT OUT ON THE DRIVER SIDE, INSTALL (10) 1/4"-20 X 1/2" BLACK OXIDE BUTTON HEAD BOLTS, (10) 1/4" BLACK OXIDE ID WASHERS, AND (10) 1/4" T-NUTS ONTO WIND DEFLECTOR PLATE. KEEP THE T-NUTS LOOSE FOR THE FOLLOWING STEP.

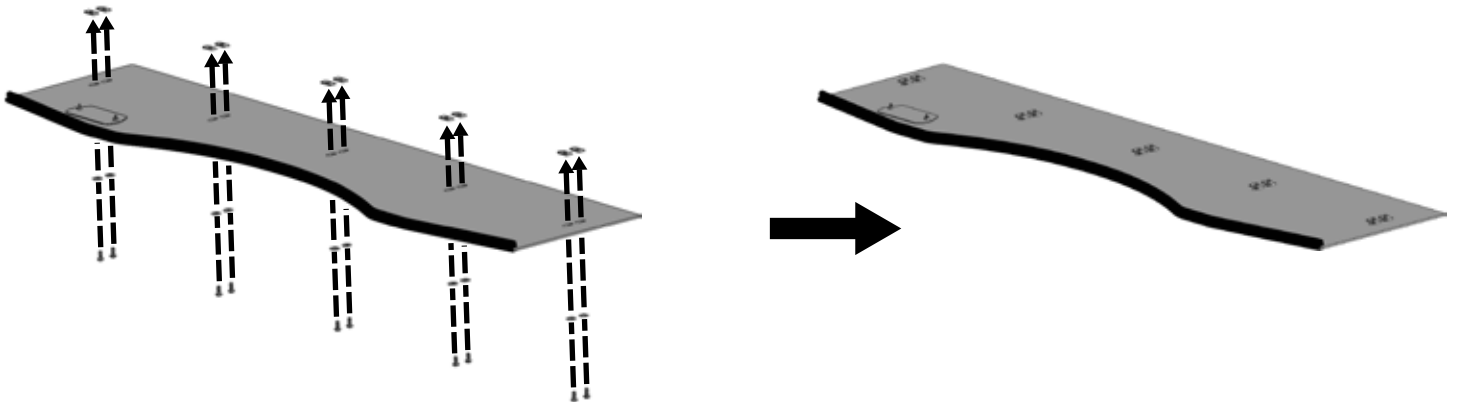

STEP 2

SLIDE ONE ALUMINUM EXTRUSION ONTO THE WIND DEFLECTOR'S T-NUTS. **DO NOT** FASTEN 1/4"-20 BLACK OXIDE BUTTON HEAD BOLTS AT THIS TIME.

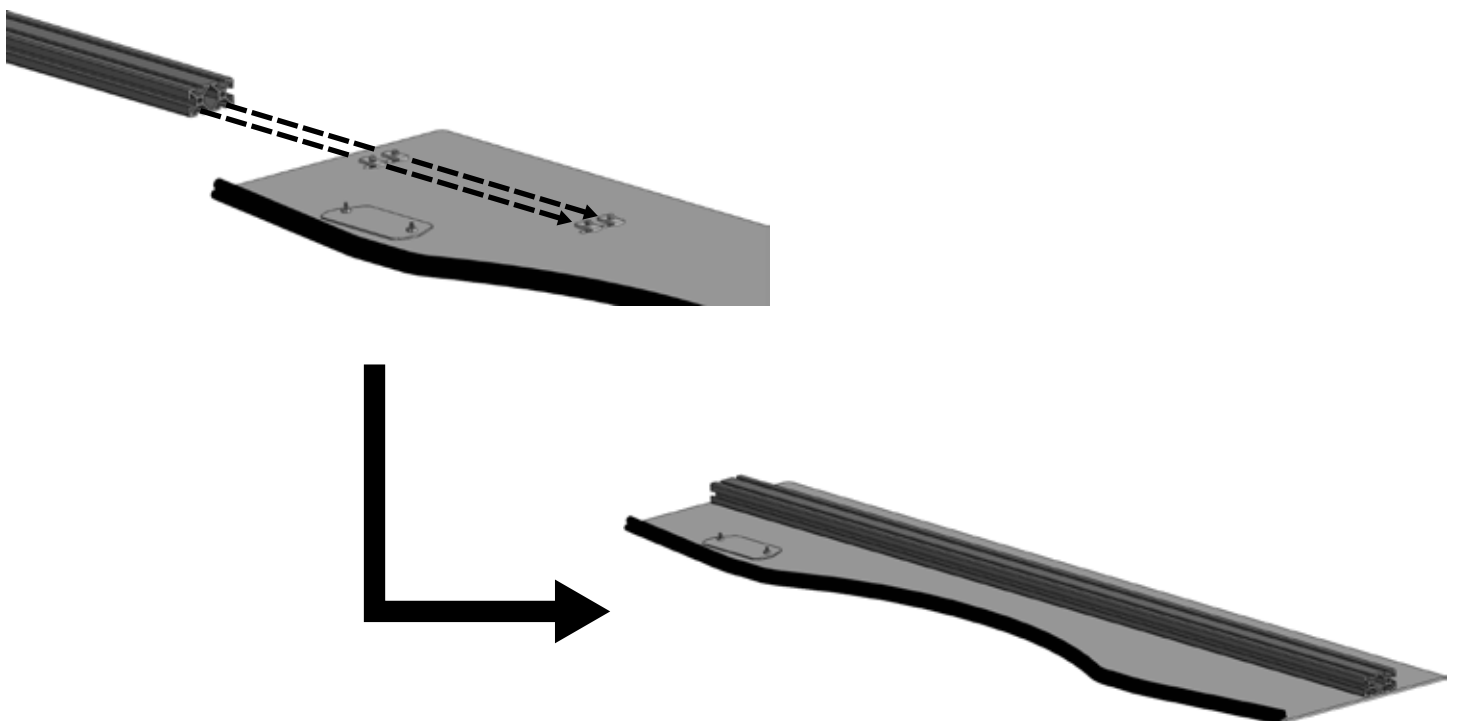



TRMR ROOF RACK ASSEMBLY



STEP 3

SLIDE IN (4) 1/4"-20 X 5/8" CARRIAGE BOLTS INTO THE DOUBLE SLOT FACE (TWO PER SLOT) OF ALUMINUM EXTRUSIONS **1, 2, 4, AND 5**.

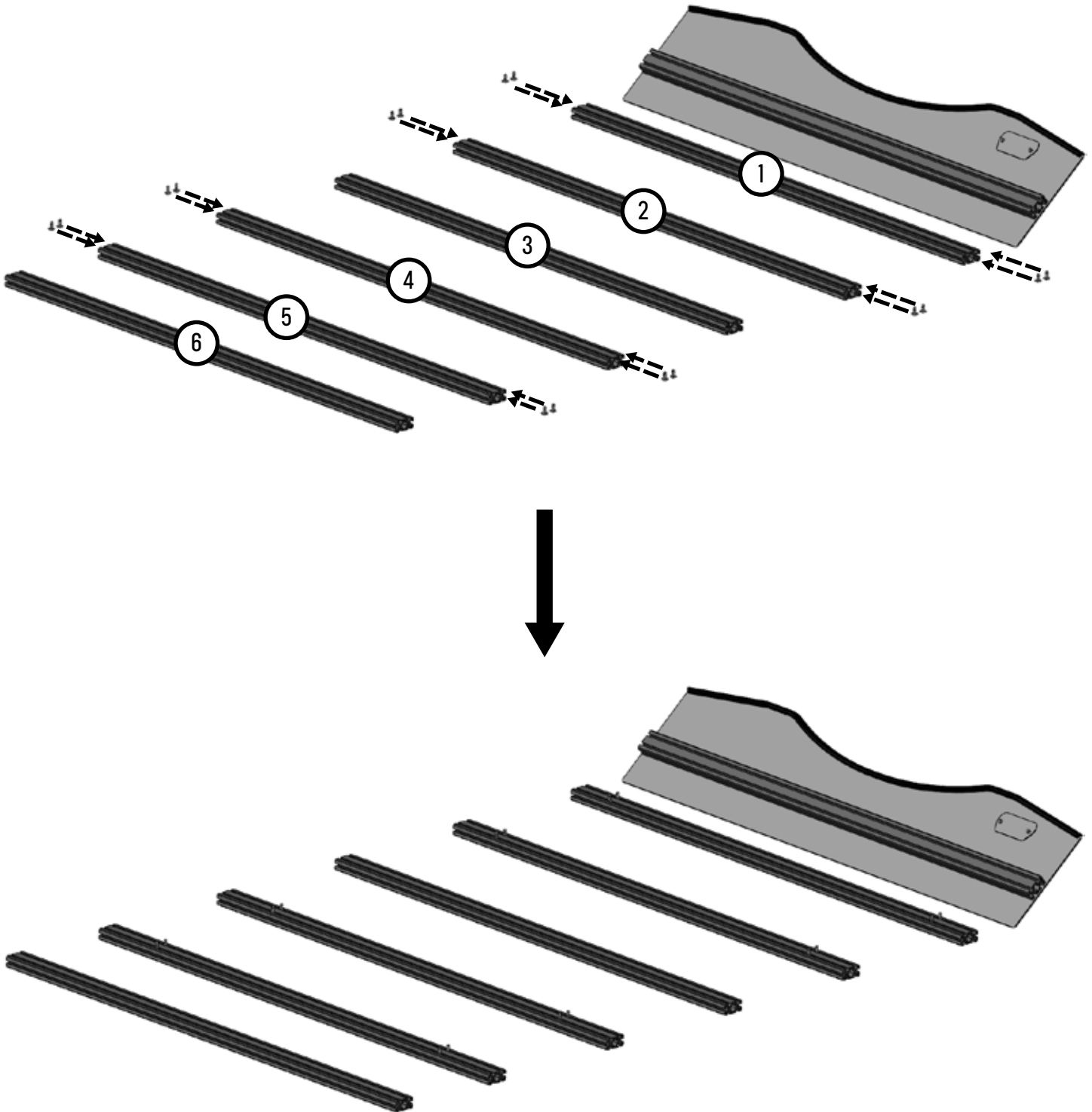



TRMR ROOF RACK ASSEMBLY



STEP 4

INSTALL EACH CLAMP ONTO ITS DESIGNATED CARRIAGE BOLTS. USE (4) 1/4"-20 NYLON LOCKING NUTS, (4) 1/4" BLACK OXIDE ID WASHERS PER CLAMP AND LEAVE LOOSE UNTIL STEP 7.

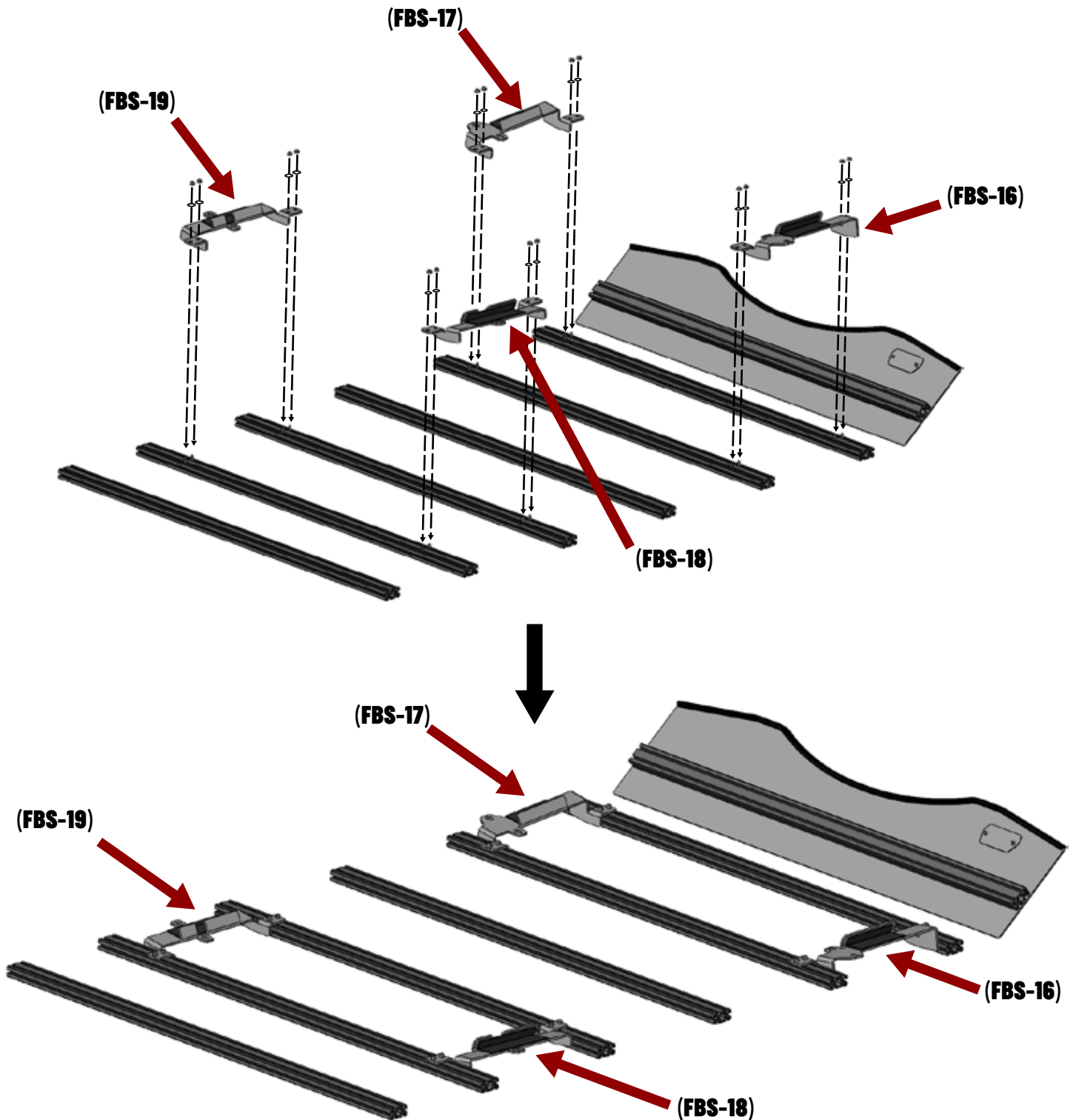



TRMR ROOF RACK ASSEMBLY



STEP 5

INSTALL THE DRIVER AND PASSENGER SIDE FAIRINGS TO EACH ALUMINUM EXTRUSIONS USING (4) 1/4"-20 X 3/4" BLACK OXIDE BUTTON HEAD BOLTS AND (4) 1/4" ID BLACK OXIDE WASHERS PER EXTRUSION. ADD A SMALL AMOUNT OF LOCTITE TO EACH BOLT.

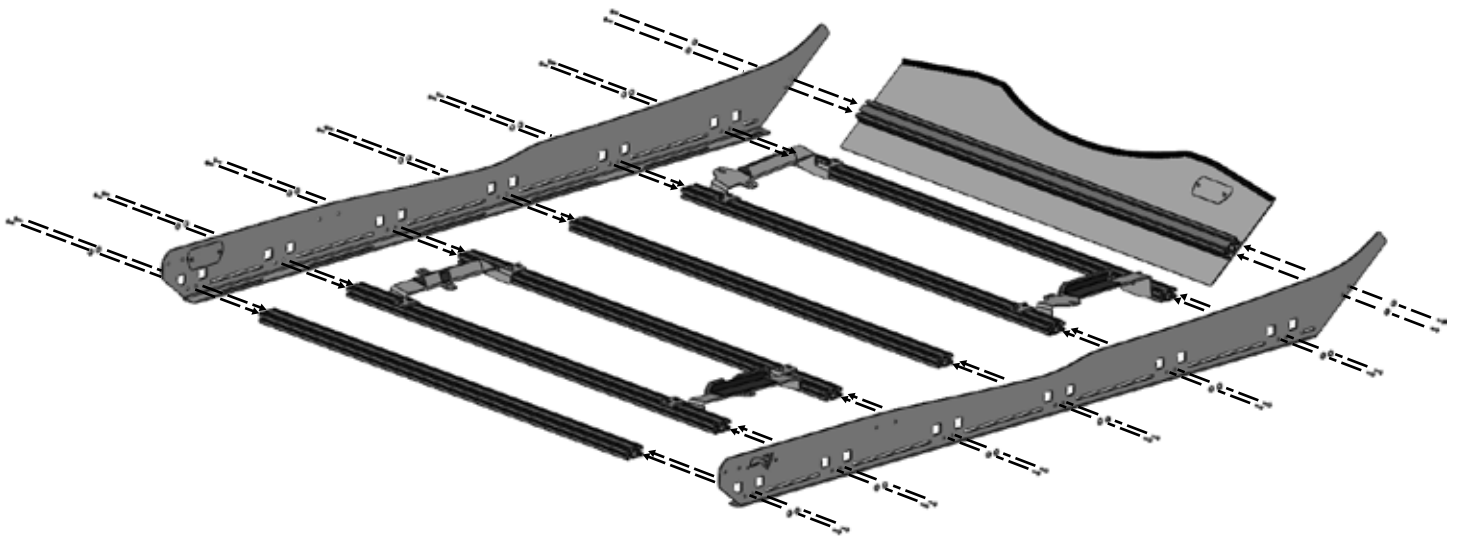

NOTE

MAKE SURE WIND DEFLECTOR REST ON TOP OF THE PASSENGER AND DRIVER SIDE RAILS.





TRMR ROOF RACK ASSEMBLY



STEP 6

PLACE AND POSITION THE TRMR ROOF RACK ONTO THE BRONCO SPORT WITH THE CLAMPS RESTING ON TOP OF THE VEHICLE'S ROOF RAILS. LINE THE ROOF RACK'S SIDE FAIRINGS BOTTOM FACE WITH THE CURVATURE OF THE VEHICLE'S BODY.

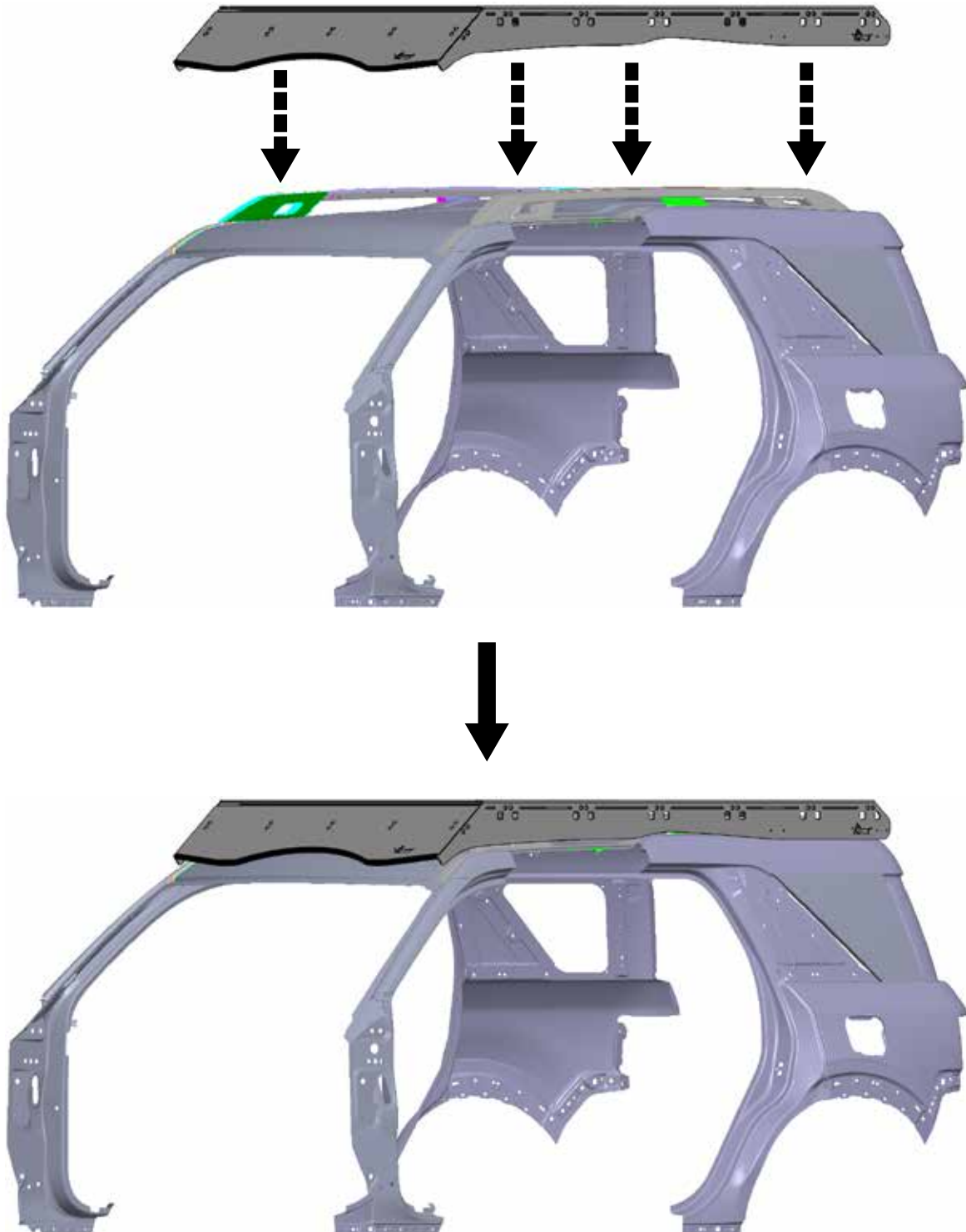

TRMR ROOF RACK ASSEMBLY



STEP 7

SLIDE EACH CLAMP SO THAT THE BOTTOM FACE IS RESTING ON TOP OF THE VEHICLE'S OEM RAIL. PRESS THE CLAMP SO IT'S SNUG AGAINST THE INSIDE FACE OF THE VEHICLE'S OEM RAIL.

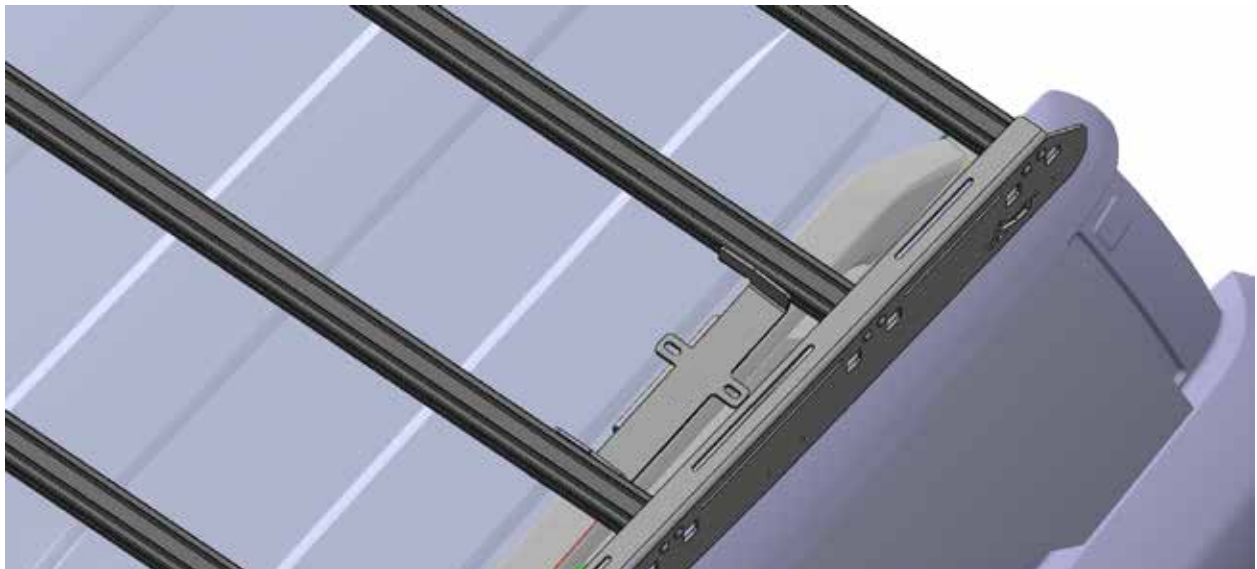
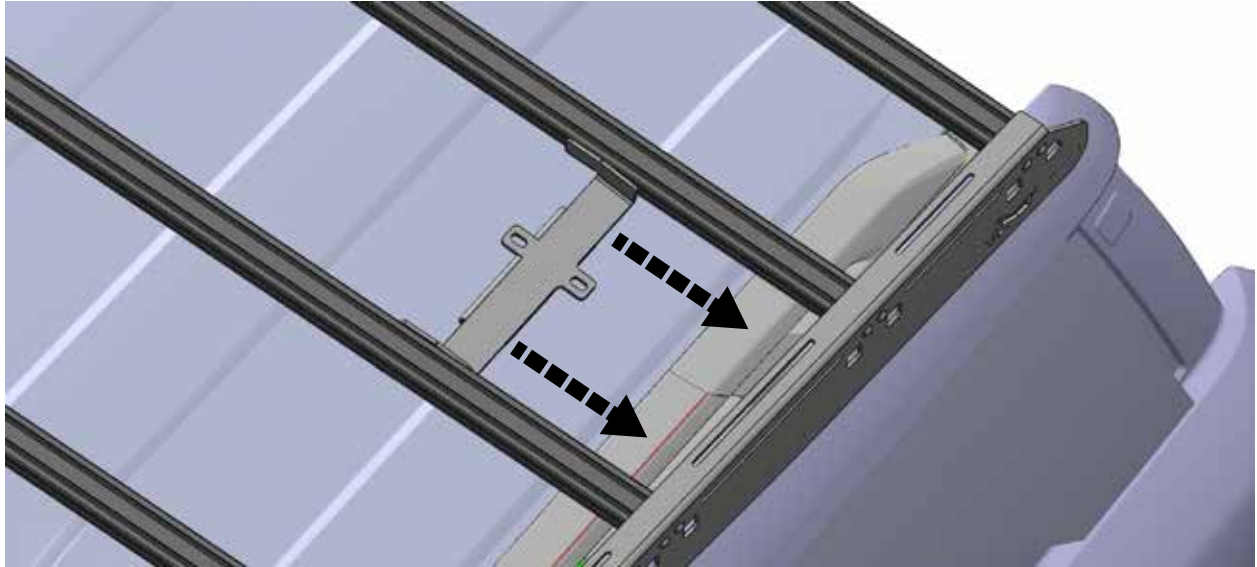

TRMR ROOF RACK ASSEMBLY



STEP 8

CENTER THE BACK PORTION OF THE ROOF RACK. MEASURE THE REAR DRIVER SIDE CLAMP'S OUTER FACE TO THE INSIDE FACE OF THE SIDE FAIRING AT ROUGHLY 7 1/2". REPEAT SAME PROCESS FOR PASSENGER SIDE.

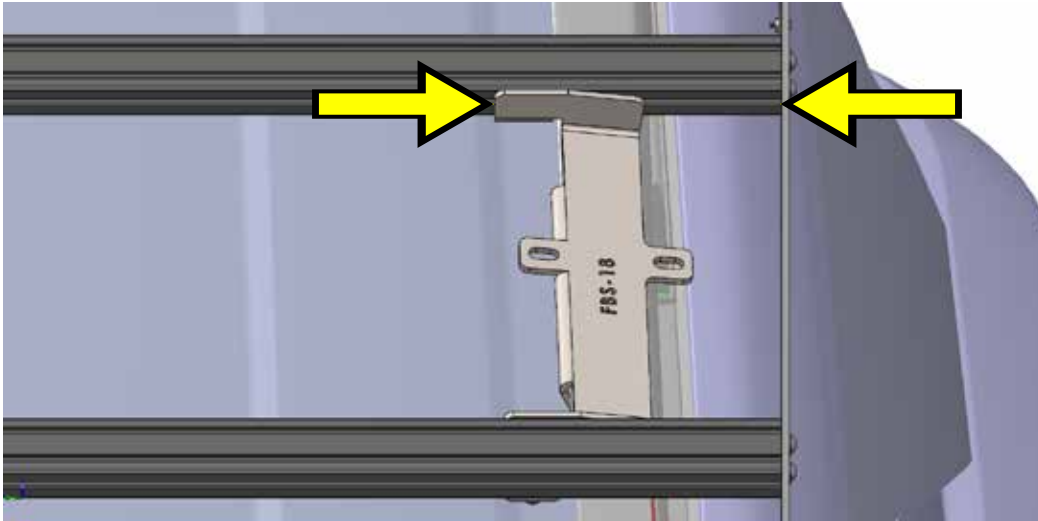

STEP 9

CENTER THE FRONT PORTION OF THE ROOF RACK. MEASURE THE FRONT DRIVER SIDE CLAMP'S OUTER FACE TO THE INSIDE FACE OF THE SIDE FAIRING AT ROUGHLY 5 9/16". REPEAT SAME PROCESS FOR PASSENGER SIDE.

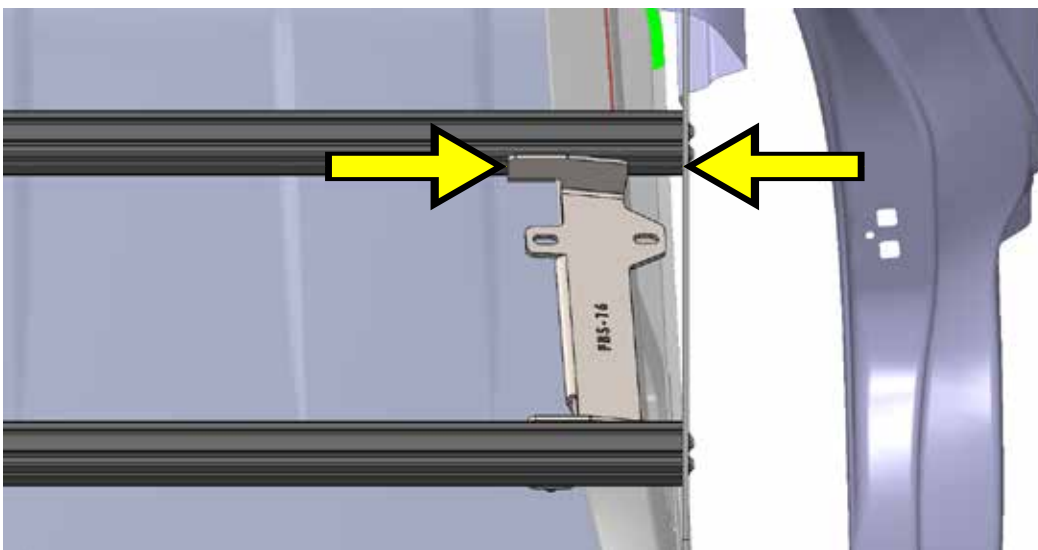

TRMR ROOF RACK ASSEMBLY



STEP 10

SLIDE ONE 3/8"-16 SQUARE U BOLT UNDER THE VEHICLE'S OEM RAIL AND UP INTO EACH CLAMP'S SLOTTED HOLES.

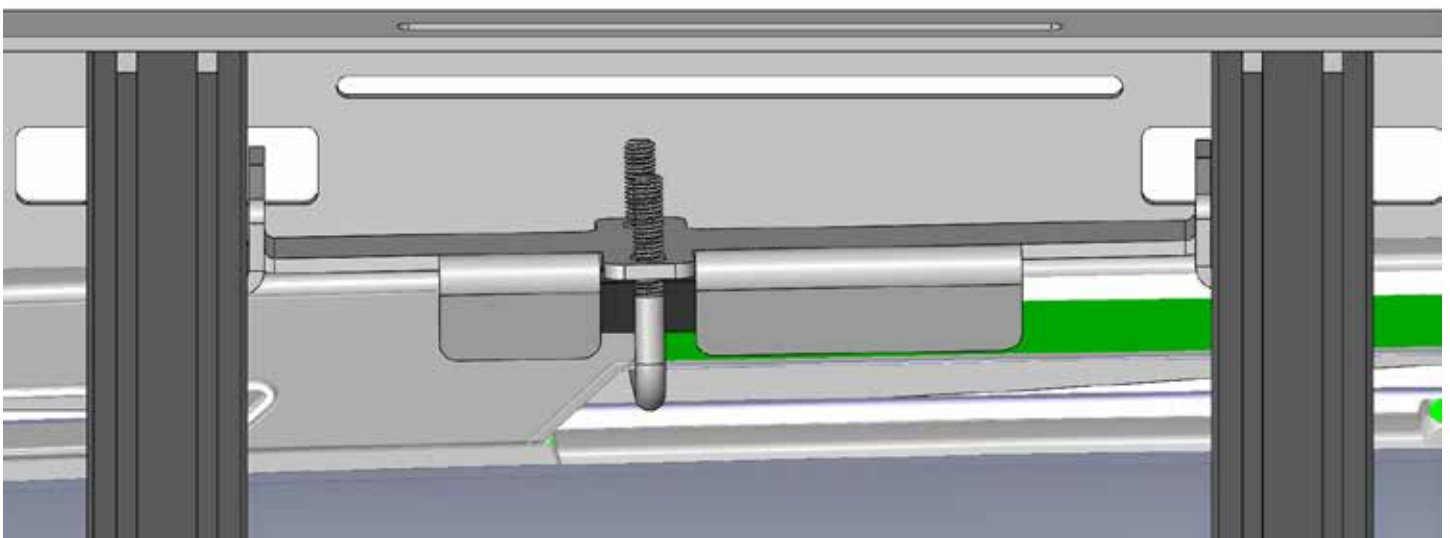
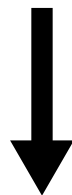
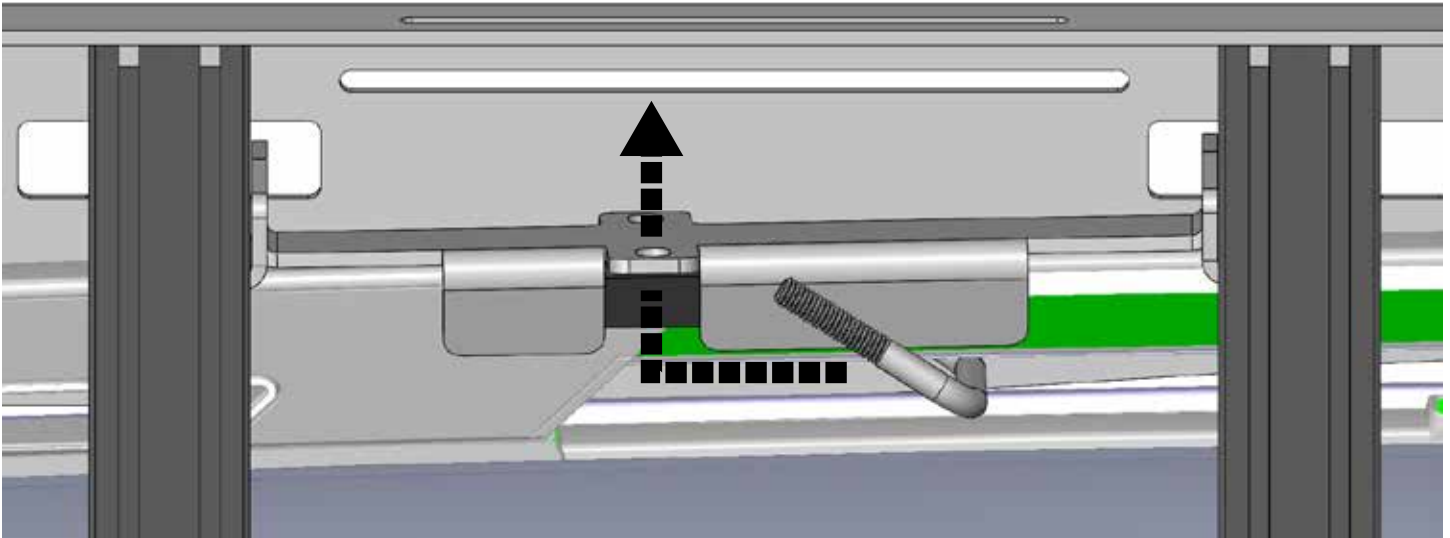

TRMR ROOF RACK ASSEMBLY



STEP 11

INSTALL (2) 3/8"-16 NYLON LOCK NUT AND (2) 3/8" ID WASHER ONTO THE SQUARE U BOLT. TIGHTEN DOWN UNTIL THE SQUARE U BOLT IS TIGHT AGAINST THE VEHICLE'S OEM RAILS. **WARNING**, DO NOT OVER TIGHTEN SQUARE U BOLT TO THE POINT OF DAMAGING THE VEHICLE'S OEM ROOF RAILS. REPEAT PROCESS FOR ALL CLAMPS.

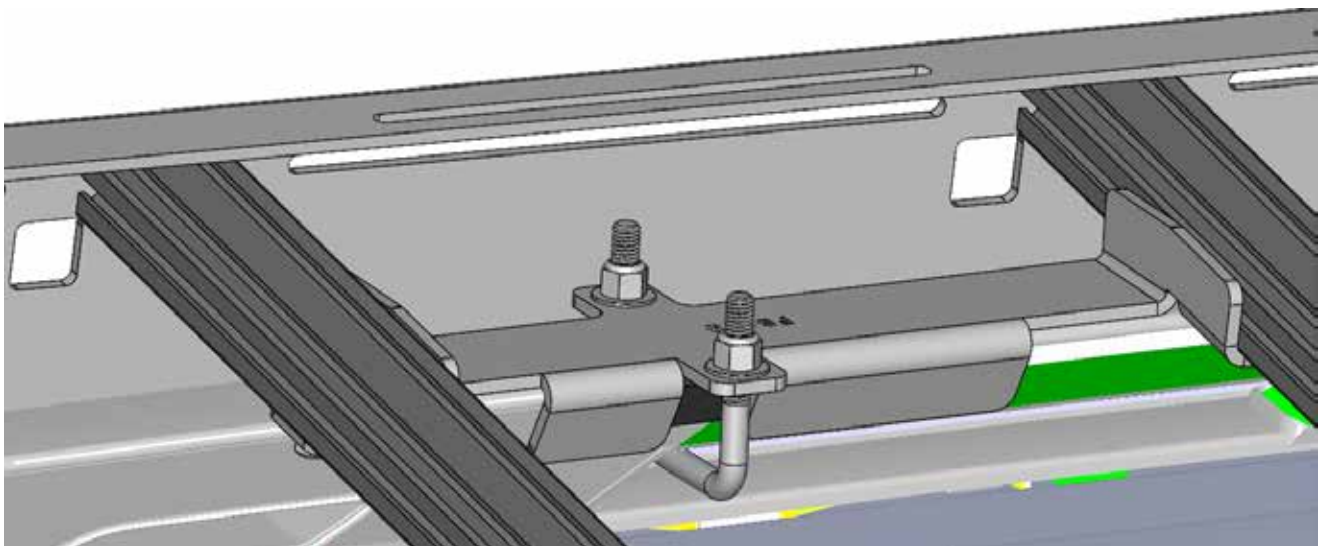
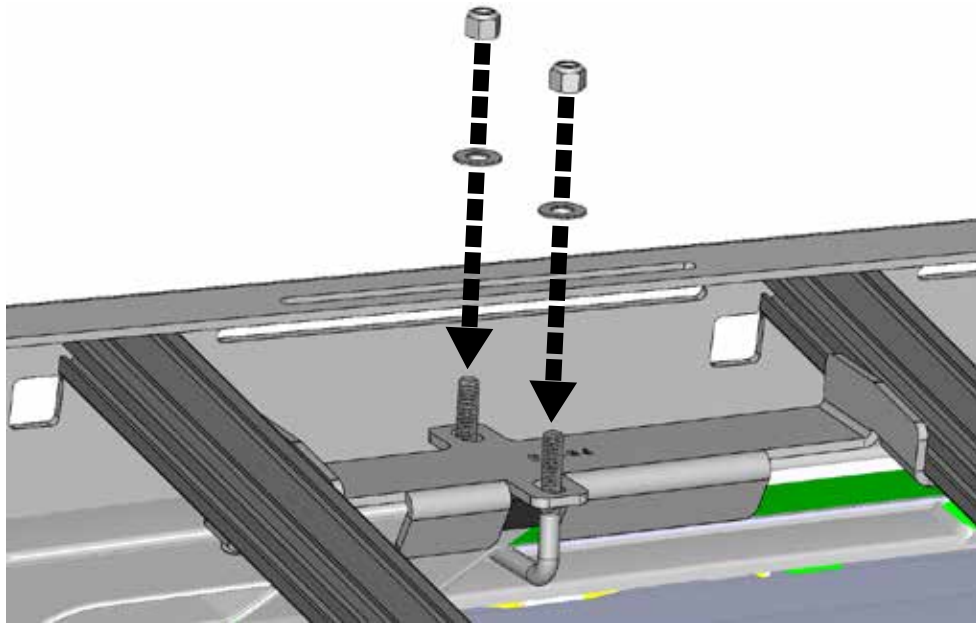



TRMR ROOF RACK ASSEMBLY



STEP 12

ADJUST WIND DEFLECTOR PLATE TO A DESIRED HEIGHT AND FASTEN DOWN ALL HARDWARE. CHECK EACH HARDWARE AND ENSURE EVERYTHING IS TIGHT AND FASTEN DOWN.

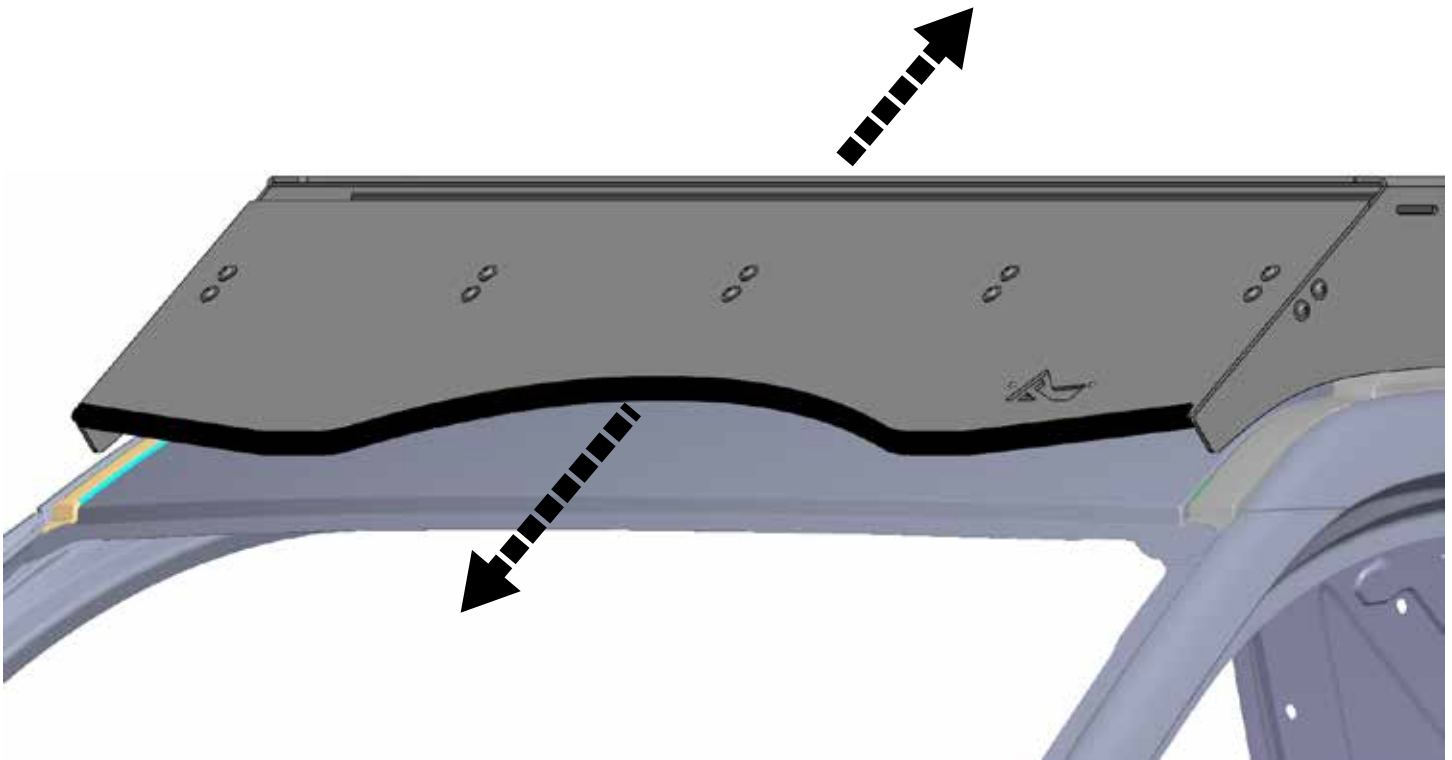

INSTALL COMPLETE

TRMR PAK RAX ASSEMBLY



STEP 1

INSTALL (1) SEASUCKER ONTO THE BOTTOM SLOT OF EACH PAK RAX USING (1) 1/4"-20 X 3/4" BLACK OXIDE BUTTON HEAD BOLT AND (1) 1/4" BLACK OXIDE ID WASHER.

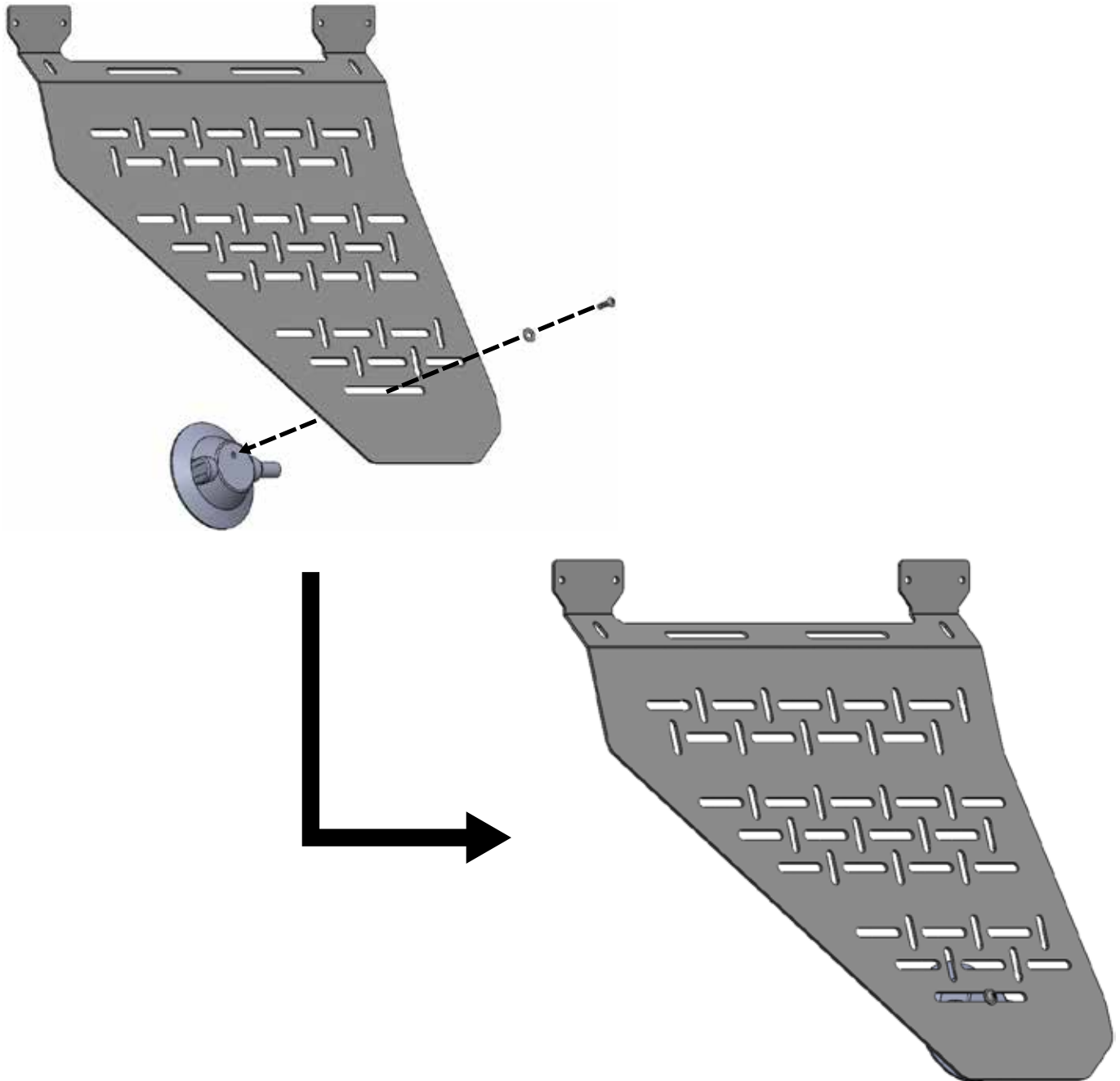

TRMR PAK RAX ASSEMBLY

STEP 2

REMOVE ALL DIRT AND DEBRIS FROM THE REAR SIDE WINDOWS. BOLT EACH PAK RAX TO THE ROOF RACK'S 4 SIDE HOLES USING (4) 1/4"-20 X 3/4" BLACK OXIDE BUTTON HEAD BOLTS, (8) 1/4" BLACK OXIDE ID WASHERS, AND (4) 1/4"-20 LOCK NUTS.

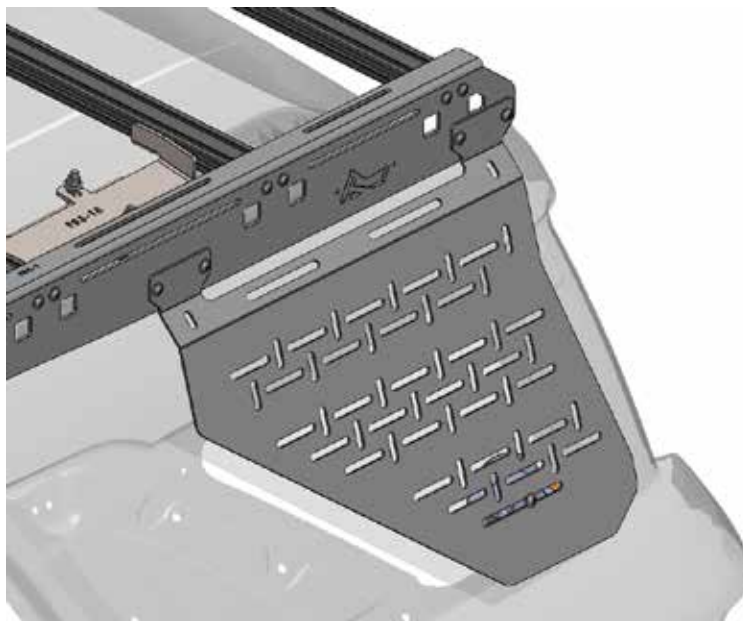
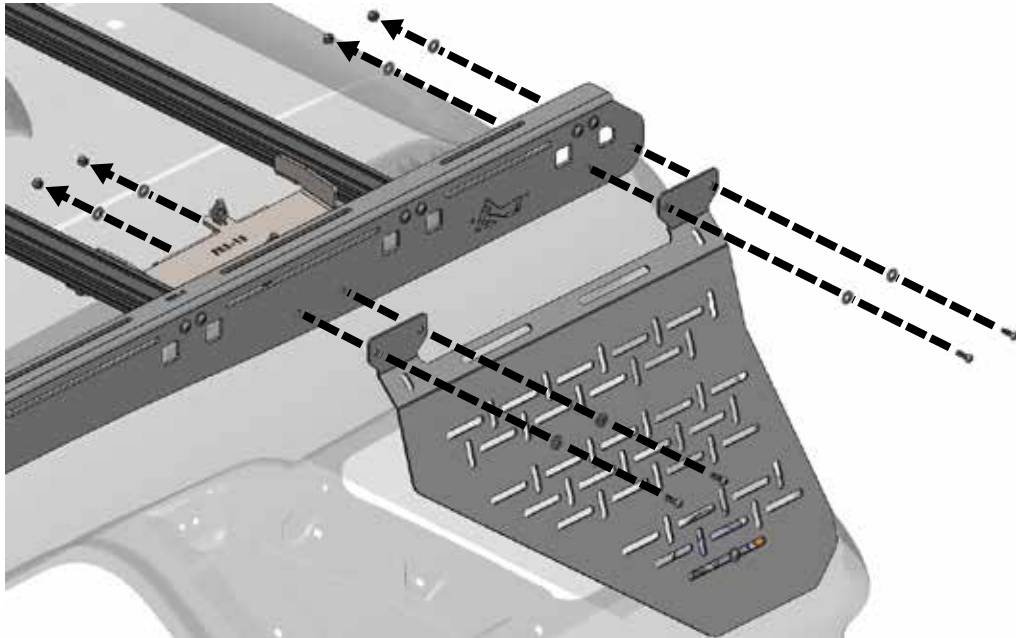

TRMR PAK RAX ASSEMBLY

STEP 3

APPLY SOFT DOWNWARD PRESSURE ONTO THE SEASUCKER ENSURING THE ENTIRE EDGE OF THE MOUNT IS FLUSH AGAINST THE SURFACE OF THE WINDOW. PRESS THE ORANGE PUMP REPEATEDLY UNTIL THE ORANGE INDICATOR BAND COMPLETELY DISAPPEARS. TO DETACH, RAISE THE VACUUM PAD'S EDGE FROM THE SURFACE BY PULLING ONE OF THE TABS LOCATED ON THE TOP OF THE VACUUM PAD UPWARDS AND TOWARDS THE CENTER OF THE VACUUM MOUNT.

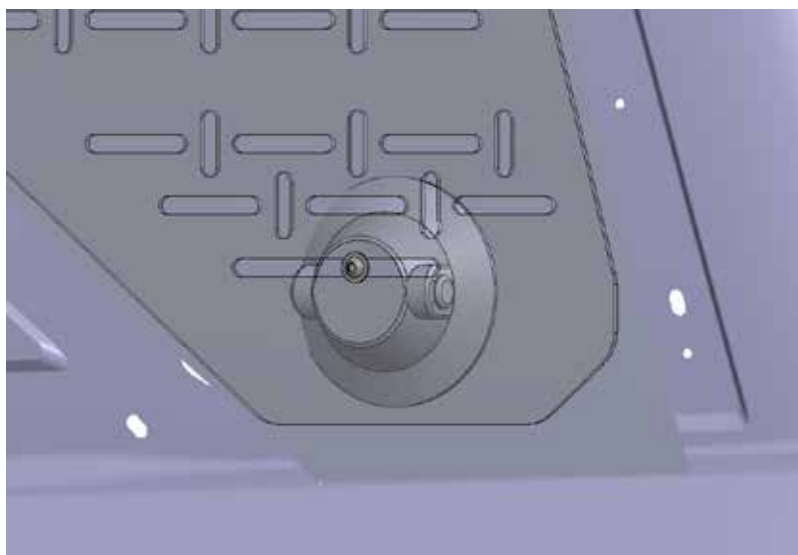
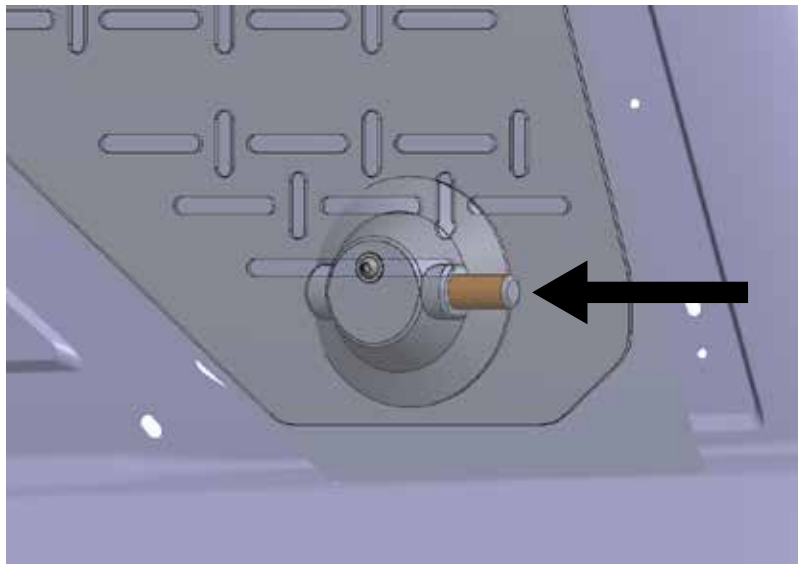



TRMR PAK RAX ASSEMBLY



PAK RAX INSTALL COMPLETE