

cimilre E1

Quick Start Guide

Assembly

For **single pumping**, attach only one of the longer pieces of tubing to the pump.

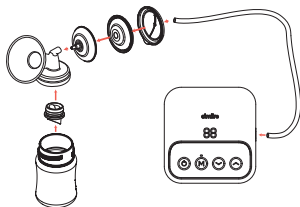

For **double pumping**, attach one end of the small piece of tubing to the pump and the other to the 3-way connector. Then, attach the two long pieces of tubing to the 3-way connector.

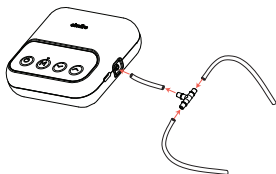

Button Controls

The pump has 4 buttons.

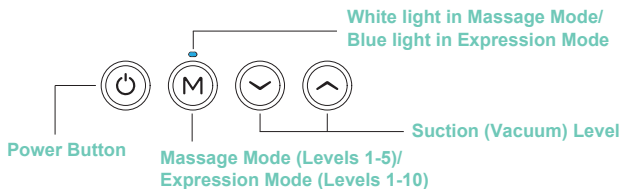

See back for more instructions



Register your pump!

for educational resources and
product updates

Pump Operation

Press the power button to turn pump on.

Press “M” to switch between Massage (white light) and Expression Mode (blue light).

Start sessions in **Massage Mode (white light)**.



Use the arrows to adjust the **suction levels**.

When adjusting suction levels, the screen will blink, indicating what level is selected.



After selecting the preferred level, the screen will blink three more times, then will change to the timer display, which will remain lit, indicating the number of minutes in the pumping session.

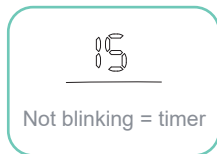

After milk starts flowing, press “M” to begin **Expression Mode (blue light)**. Adjust suction strength for comfort using the arrow level buttons.

The **battery indicator light** is located next to the charging port.

- Green = Full charge
- Yellow = Two-thirds

- Red = One-third
- Blinking red = Low battery

Thanks for choosing Cimilre
to be part of your journey.

