

# CONGRATULATIONS!

You've received the best furniture for your pet.

**FOR ASSEMBLY YOU WILL NEED:**



## CHECK YOUR SET

1 pcs

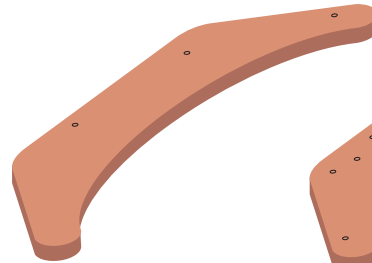

1 pcs

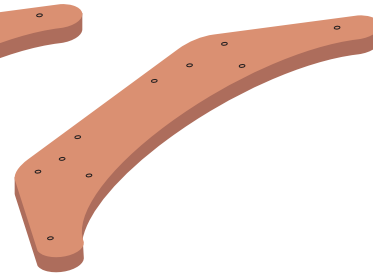

2 pcs

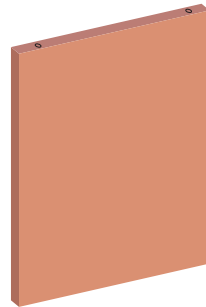

1 pcs



## SCREWDRIVER OR HAMMER DRILL

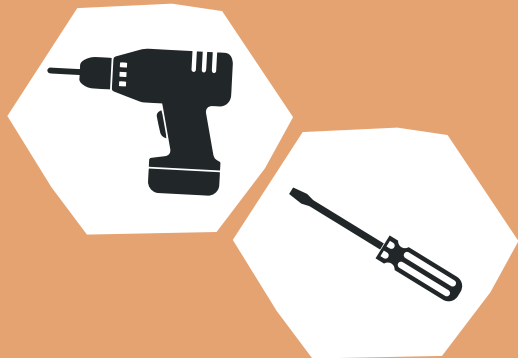

## SCREWS AND DOWELS

Included to the package.

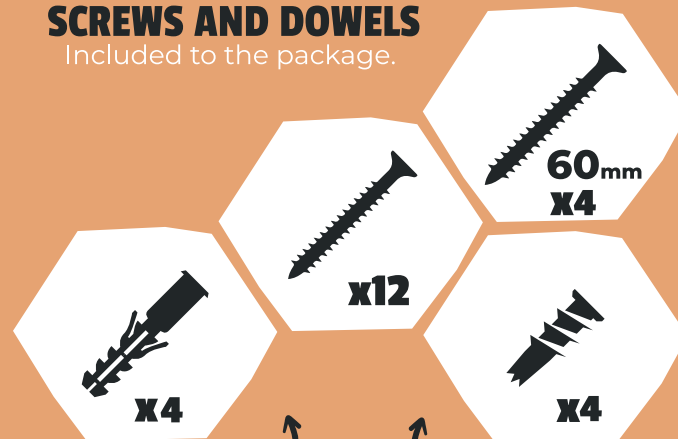

Dowels for concrete & other walls

Dowels for plasterboard walls

# CAT WOODEN BED

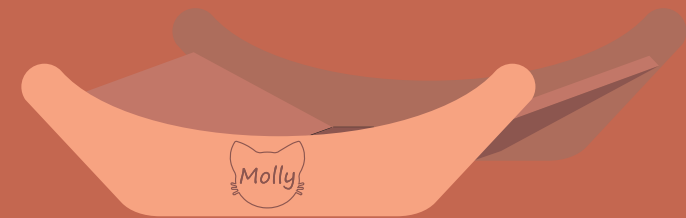

cats  
MODE

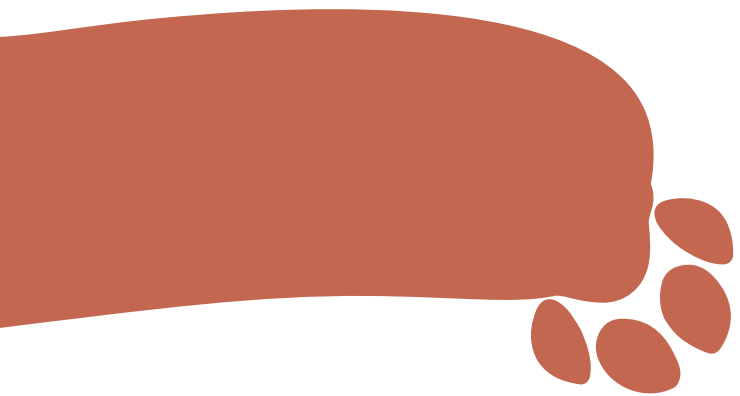

**1** Get yourself comfortable and prepare all of the tools needed for assembling.

**2** Drill three pieces into the front panel.

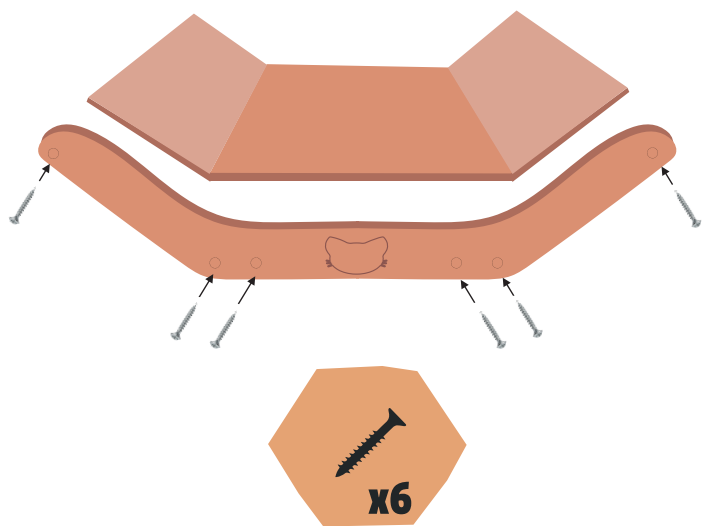

**3** Complete assembly by screwing the other side to the cat bed as shown.

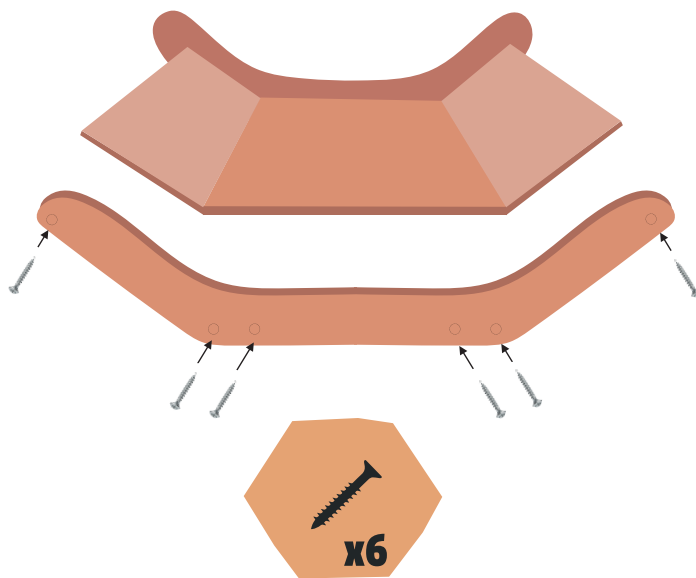

**4** Use dowels to hang your cat bed on the wall. Put dowels into wall and then drill the bed through these 4 holes as shown.

