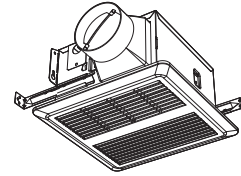

Models: SNP100**SNP100H**

WARNING

TO REDUCE THE RISK OF FIRE, ELECTRIC SHOCK, OR INJURY TO PERSONS, OBSERVE THE FOLLOWING:

1. Use this unit only in the manner intended by the manufacturer. If you have questions, contact the manufacturer at the address or telephone number listed in the warranty.
2. Before servicing or cleaning unit, switch power off at service panel and lock the service disconnecting means to prevent power from being switched on accidentally. When the service disconnecting means cannot be locked, securely fasten a prominent warning device, such as a tag, to the service panel.
3. Installation work and electrical wiring must be done by a qualified person(s) in accordance with all applicable codes and standards, including fire-rated construction codes and standards.
4. Sufficient air is needed for proper combustion and exhausting of gases through the flue (chimney) of fuel burning equipment to prevent backdrafting. Follow the heating equipment manufacturer's guideline and safety standards such as those published by the National Fire Protection Association (NFPA), and the American Society for Heating, Refrigeration and Air Conditioning Engineers (ASHRAE), and the local code authorities.
5. When cutting or drilling into wall or ceiling, do not damage electrical wiring and other hidden utilities.
6. Ducted fans must always be vented to the outdoors.
7. Acceptable for use over a tub or shower when connected to a GFCI (Ground Fault Circuit Interrupter) - protected branch circuit (ceiling installation only).
8. This unit must be grounded.

CAUTION

1. For general ventilating use only. Do not use to exhaust hazardous or explosive materials and vapors.
2. This product is designed for installation in ceilings up to a 12/12 pitch (45 degree angle). Duct connector must point up. **DO NOT MOUNT THIS PRODUCT IN A WALL.**
3. To avoid motor bearing damage and noisy and/or unbalanced impellers, keep drywall spray, construction dust, etc. off power unit.
4. Please read specification label on product for further information and requirements.

CLEANING & MAINTENANCE

For quiet and efficient operation, long life, and attractive appearance - lower or remove grille and vacuum interior of unit with the dusting brush attachment.

The motor is permanently lubricated and never needs oiling. If the motor bearings are making excessive or unusual noises, replace the motor with the exact service motor. The impeller should also be replaced.

OPERATION

See "CONNECT ELECTRICAL WIRING" for details.

For SNP100H the humidity-sensing fan uses a sophisticated humidity sensor that responds to: (a) rapid increases in humidity or (b) humidity above a user-adjustable set-point (30%-80% relative humidity). The humidity sensor may occasionally turn the fan ON when environmental conditions change. If the fan continuously responds to changing environmental conditions, "H" (means "humidity") adjustment may be required. This figure is factory-set for about 80% (Ambient temperature of 25°C).

SENSITIVITY ADJUSTMENT

The "H" has been factory set for most shower applications. However, if the fan is in a tub area or is being used for dampness control, the "H" may need to be increased toward maximum "+". If the control is responding too often to changing environmental conditions, movement toward less "-" "H" may be required.

To adjust the "H":

1. Disconnect power at service entrance.
2. Through the grille, locate the slot marked "H".
3. Carefully rotate the "H" adjustment toward "+" or "-".
4. Turn on power and check operation by turning on the shower or other humidity source until the fan turns on.
5. Repeat above steps if necessary.

When the temperature changes, humidity sensor values will have deviation.

READ AND SAVE THESE INSTRUCTIONS
Installer: Leave this manual with the homeowner.

OPERATION

TIMER ADJUSTMENT

The humidity sensing fan has a "T" (means timer) that can be adjusted from 5 to 60 minutes (factory-set at about 20 minutes). This "T" controls the length of time that the fan remains ON after the sensor has stopped sensing a rise in humidity and the humidity level is below the user-adjustable set-point. To adjust the "T":

1. Disconnect power at service entrance;
2. Through the grille, locate the slot marked "T";
3. Carefully rotate the "T" adjustment to desired setting (from 5 to 60 minutes).
4. Check operation by turning on a humidity source until the fan turns on.
5. Turn humidity source off and time the unit.
6. Repeat above steps if necessary.

PLAN THE INSTALLATION

1. Do not use in a cooking area.

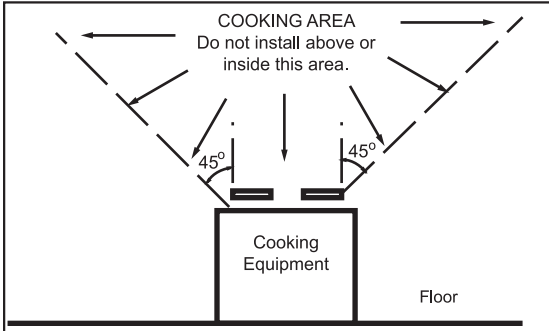

2. Two ways to connect ductwork to a factory-shipped unit.

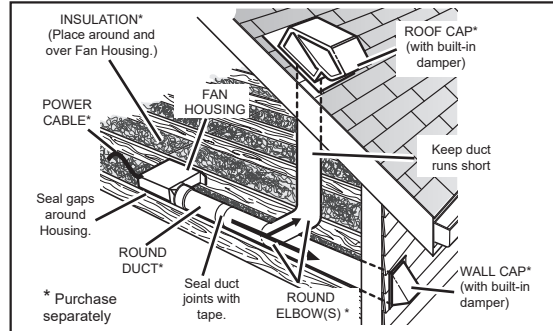

TYPES OF TYPICAL INSTALLATIONS

1. Housing mounted to I-joists (Start at "ASSEMBLY INSTRUCTIONS 1")
2. Housing mounted to joists (Start at "ASSEMBLY INSTRUCTIONS 1")
3. Housing mounted to truss (Start at step "ASSEMBLY INSTRUCTIONS 2")

ASSEMBLY INSTRUCTIONS

1. MOUNT HOUSING TO JOIST OR I-JOIST.

- a. Hold the housing so that it is in contact with the bottom of the joist.
- b. Attach the housing with four (4) screws to the joist through the holes in each mounting flange.

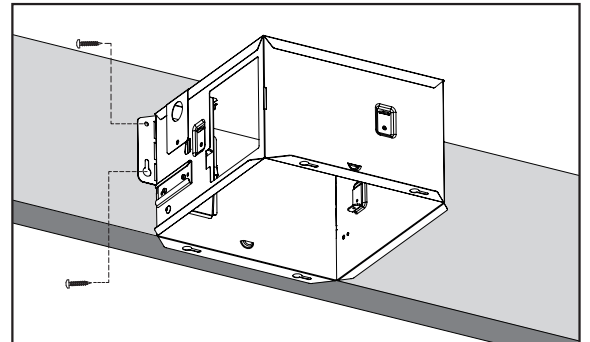

2. Mount with mounion holes and hanger bar

- a. Slide one hanger bar into the channel on the housing and adjust as needed to fit between framing.
- b. Hold housing in place so that the housing contact the bottom of the joist, Screw housing to joist through the hole of the housing .
- c. Screw the hanger bar onto the other side of joist through the hole.
- d. Screw hanger bar to housing with screw.
- e. Refer to the right diagram.

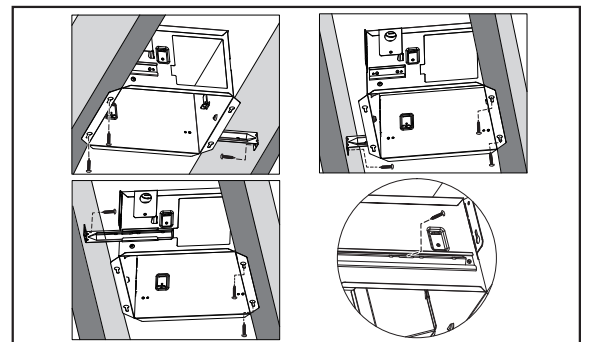

3. Mount to I-joist

- a. Slide one hanger bar into channel on the housing and adjust as needed.
- b. Hold housing in place so that the housing contacts the bottom of the joist.
- c. Screw housing to joist through the hole of the housing.
- d. Screw the hanger bar onto the joist through the hole.
- e. Screw hanger bar to housing with screw .

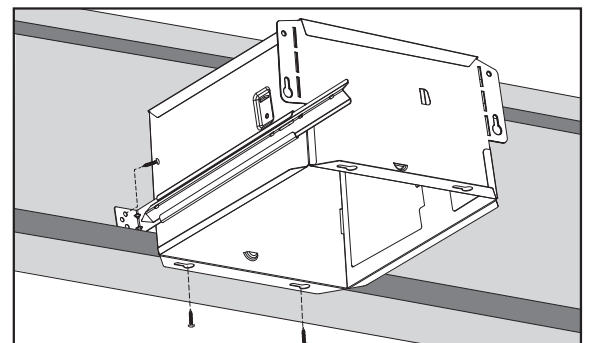

ASSEMBLY INSTRUCTIONS

4. INSTALL DUCT AND BLOWER ASSEMBLY

- Install duct from the inside of the housing; Fix the duct by the tab.
- Fix the BLOWER ASSEMBLY to the housing by 3 screws.

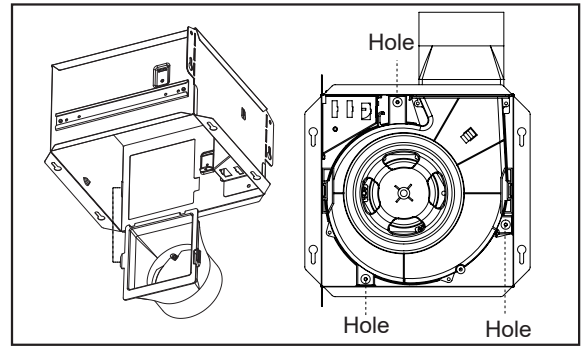

5. INSTALL ROUND DUCTWORK

- Connect the round ductwork (not included) to the damper/duct connector, and run the ductwork to a roof or wall cap (not included).
- Using tape (not included), secure all the ductwork connections so that they are air tight.
- Insulated flexible duct is recommended for the quietest possible installation. If rigid duct is used, a short (1-3 feet) section of insulated flexible duct will ensure quiet operation.

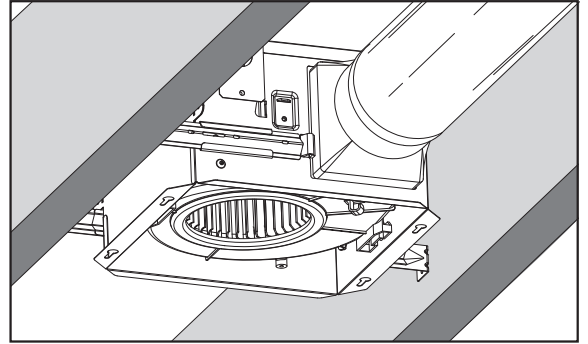

The ducting from this fan to the outside of building has a strong effect on the air flow, noise and energy use of the fan. Use the shortest, straightest duct routing possible for best performance, and avoid installing the fan with smaller ducts than recommended. Insulation around the ducts can reduce energy loss and inhibit mold growth. Fans installed with existing ducts may not achieve their rated air flow.

RETROFIT INSTALLATION

- Remove wire panel and blower assembly before installation.
- Fold mounting ears flat against housing.

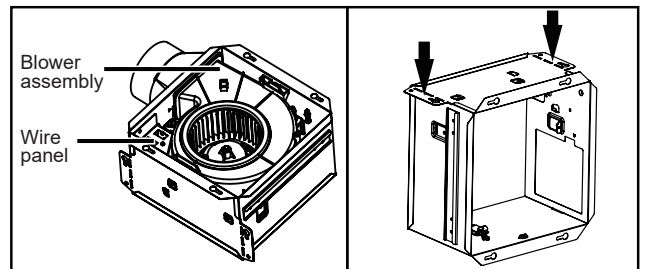

- Enlarge ceiling opening to 9-1/2" by 9-1/2", leave ductwork and wiring in place.
- Connect wiring according to the wiring diagram. Re-install wire panel.
- Mounting fan

- Mount with additional mounting holes

The interior of the fan housing contains additional mounting holes in case exterior mounting is not possible.

Screw or nail the fan housing directly to the framing or joists. Remove the blower assembly as directed in the service parts section of this manual to gain access to the additional mounting holes.

- Mount with hole of the flange

Use screws (included) to screw fans to the ceiling through the holes of the housing.

- Connect duct

Pull existing ducting through housing discharge opening and tape ducting to duct connector. Push connector/ducting back through opening, fix the duct by the tab.

- Install the blower assembly.

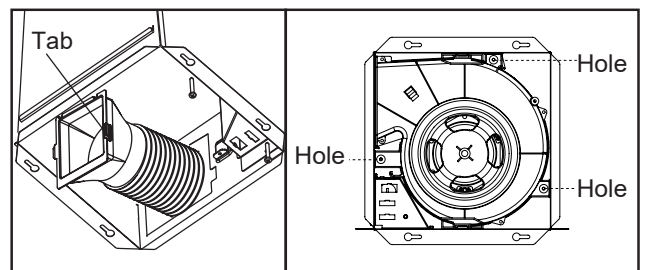
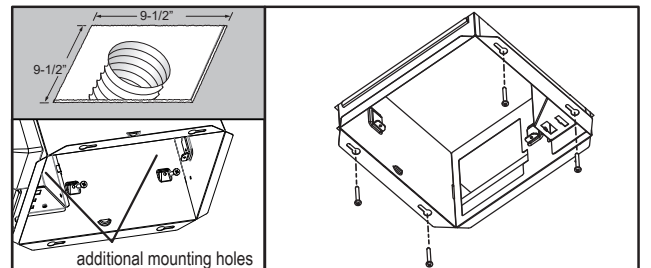

CONNECT ELECTRICAL WIRING

Run 120 V AC house wiring to the location of the fan. Use only UL-approved connectors (not included) to attach the house wiring to the wiring plate. Refer to the wiring diagram, and connect the wires as shown.

SNP100

