



USER MANUAL

Model: U12 Vesla

CONTENTS

EN

Important Safety Instructions	01
Overview	03
Product Assembly	04
Usage of Vacuum Cleaner	07
Maintenance	09
Troubleshooting	10
Specifications	10

DE

Vorsichtsmaßnahmen	11
Produktübersicht	13
Produktmontage	14
Nutzung des Staubsaugers	17
WARTUNG	19
Fehlerbehebung	20
Produktspezifikationen	20

FR

Précautions	21
Description du produit	23
Assemblage du produit	24
Utilisation de l'aspirateur	27
Réparation	29
Dépannage	30
Paramètre du produit	30

IT

Attenzione	31
Introduzione al prodotto	33
Assemblaggio del prodotto	34
Utilizzo dell'aspirapolvere	37
manutenzione	39
Risoluzione problemi	40
Specifiche del prodotto	40

ES

Notas	41
Descripción del producto	43
Montaje del producto	44
Uso de la aspiradora	47
Mantenimiento	49
Solución de problema	50
Dimensiones del producto	50

JP

注意事項	51
製品概要	53
製品組立	54
掃除機の使用	57
メンテナンス	59
トラブルシューティング	60
製品仕様	60

IMPORTANT SAFETY INSTRUCTIONS

Basic precautions should always be observed when using any electrical equipment, including the following:

WARNING:

READ ALL SAFETY INSTRUCTIONS AND THE ENTIRE MANUAL. Failure to heed the warnings and instructions may result in electric shock, fire, or serious injuries. Please read all instructions before using this device.

WARNING:

- This device is intended for children 8 years of age and older. People with reduced physical, sensory, or intellectual abilities, or those who lack experience and knowledge, should be supervised or instructed in safely using the device; they must also be aware of possible hazards. Children should not play with this device. Cleaning and maintenance should not be performed by children without supervision.

To reduce the risk of injury or damage, please observe the following safety precautions when installing, using and maintaining the device:

- Please read all instructions regarding safety and operation before using the device.
- Keep the safety and user manual for future reference. If you accidentally lose the manual, you may visit the official website to download the electronic version. (<http://www.ultenic.com>).
- Follow all operating and usage instructions.



" " The product's labels or packaging indicate that:

Do not dispose of the electrical appliances as unsorted waste or, use a separate waste collector.

Contact your local authority for information on the appropriate disposal method. If electrical appliances are discarded in landfills, hazardous substances can leach into groundwater, enter the food chain, and damage people's health. Contact your local or regional waste management agency for more information on their recycling and reuse programs.

Restrictions

- Please read all contents of this manual carefully before using this product.
- Please do not use the Vacuum Cleaner to vacuum detergent, kerosene, glass dregs, needles, wet items, sewage, matches and other items.
- Please do not use the Vacuum Cleaner to vacuum toys, paper balls and other large objects, otherwise it will cause blockage of the Vacuum Cleaner, motor burnout and other failures.
- Please keep the Vacuum Cleaner away from fire and other hot places.
- Please make sure to install the filter modules and the roller brush of the floor brush.
- Please make sure not to block the suction inlet or block the roller brush, as this may cause motor failure when using the Vacuum Cleaner.
- Please do not pour or spill water or other liquids into the machine to avoid short circuits and burning out the machine.
- Please fully charge the battery when using a new battery or the battery used for the first time after long-term storage. Please ensure that it is charged and discharged at least every three months when the machine is not used for a long time.

- The appliance is only to be used with the power supply unit provided with the appliance.
- The plug must be removed from the socket-outlet before cleaning or maintaining the appliance.
- When cleaning the Vacuum Cleaner, use a dry cloth to wipe it. Do not use gasoline, banana water and other cleaners that are easy to crack or fade the shell.
- Please do not use or store the Vacuum Cleaner in high temperature, low temperature and other adverse conditions, and do not use them outdoors or on wet surfaces. It is recommended to use them indoors at an ambient temperature of 0-30°C. Please store it in a cool and dry place, and do not expose it to sunlight for a long time.
- Do not allow children to use or play with the Vacuum Cleaner.
- When the Vacuum Cleaner can not work, it must be tested and repaired at the designated service center. Do not disassemble the machine by yourself. Waste battery packs should be safely recycled and disposed of, please do not dispose of them at will.
- If the power cord is damaged, in order to avoid danger, you must go to the manufacturer's local maintenance department or similar department to have it replaced by a professional.

FCC Compliance Statement

This device complies with Part 15 of the FCC Rules. Operation is subject to the following two conditions: (1) This device may not cause harmful interference, and (2) this device must accept any interference received, including interference that may cause undesired operation.

Warning: Changes or modifications not expressly approved by the party responsible for compliance could void the user's authority to operate the equipment.

Note: This equipment has been tested and found to comply with the limits for a Class B digital device, pursuant to Part 15 of the FCC Rules. These limits are designed to provide reasonable protection against harmful interference in a residential installation. This equipment generates, uses, and can radiate radio frequency energy and, if not installed and used in accordance with the instructions, may cause harmful interference to radio communications. However, there is no guarantee that interference will not occur in a particular installation. If this equipment does cause harmful interference to radio or television reception, which can be determined by turning the equipment off and on, the user is encouraged to try to correct the interference by one or more of the following measures: (1) Reorient or relocate the receiving antenna. (2) Increase the separation between the equipment and receiver. (3) Connect the equipment into an outlet on a circuit different from that to which the receiver is connected. (4) Consult the dealer or an experienced radio/ TV technician for help.

OVERVIEW

Host

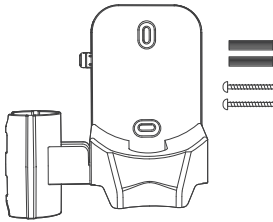
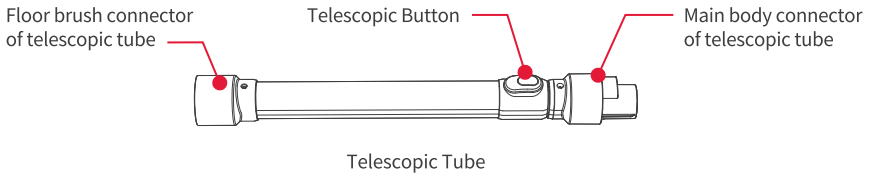
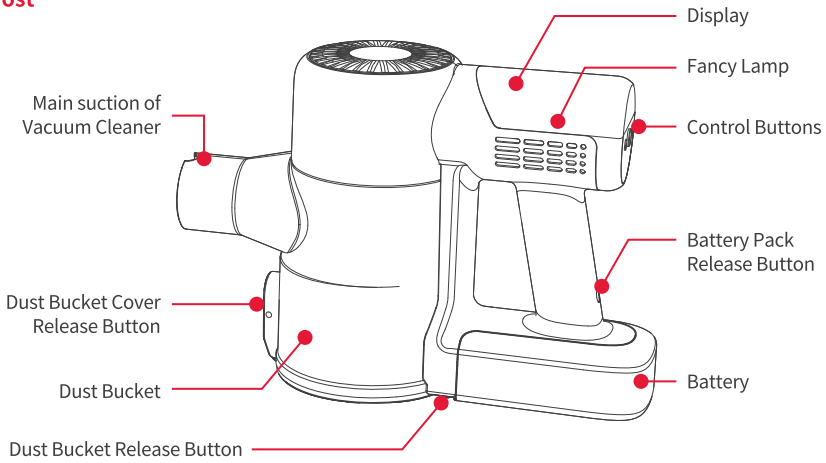

Vacuum Cleaner Storage Rack

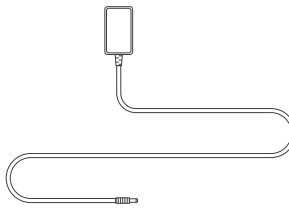

Power Adaptor

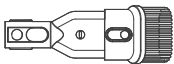

2-in-1 Dusting Brush

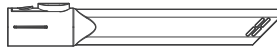

Long Crevice Nozzle

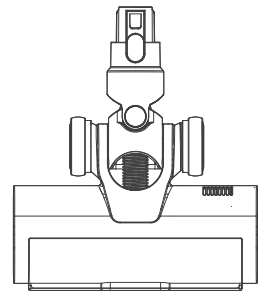

Floor Brush

PRODUCT ASSEMBLY



· The power supply of the vacuum cleaner needs to be shut off before installing and replacing accessories.

Notes

· This product cannot keep itself upright without a fixed support. Please place the machine and accessories firmly!

1. Battery installation and removal

Installation: Insert the battery pack into the main body and hear a click sound of the battery pack release button.

Removal: Press the battery pack release button and pull out the battery pack.

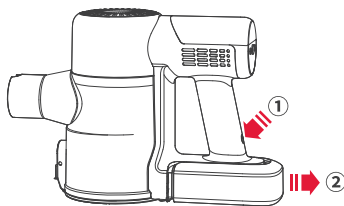
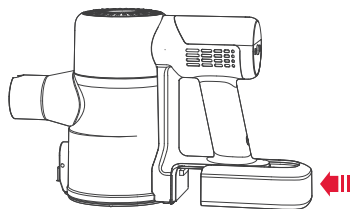

2. Install the metal tube and floor brush

Connect the metal tube and the floor brush to the main body in turn. The clicking sound of the metal tube connection button and the floor brush connection button indicate that the connection is done properly, as shown in the figure.

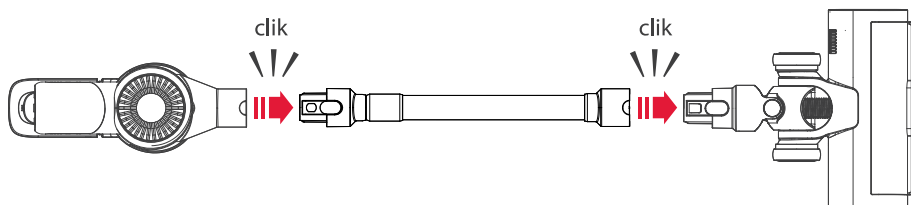

PRODUCT ASSEMBLY

3. Install accessories of vacuum cleaner

Small accessories such as crevice brush and 2-in-1 bristle brush are connected to the main body as shown in the figure. The clicking sound of the connection button indicates that the connection is done properly, as shown in the figure.

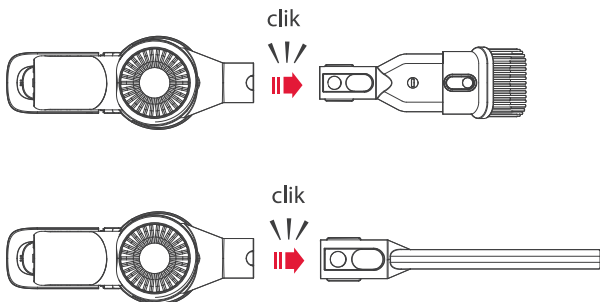

4. Remove and install the dust bucket

Remove the dust bucket: Hold the vacuum cleaner with one hand, hold the dust bucket with the other hand, press the dust bucket release button with a thumb, and pull the dust bucket open, as shown in the following figure.

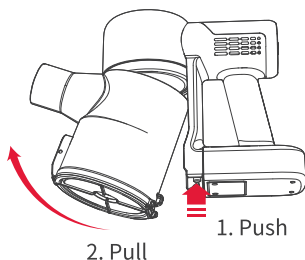

Install the dust bucket: hold the body of the vacuum cleaner with one hand and hold the suction opening of the dust bucket with the other hand, insert the protruding part (A) of the vacuum cleaner into the concave part (B) of the dust bucket, and rotate the dust bucket, and hear a clicking sound, indicating that the connection is done properly, as shown in the figure below.

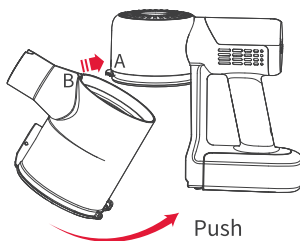

PRODUCT ASSEMBLY

5. Use the telescopic tube

Hold the main body connector of the telescopic tube with one hand, hold the telescopic tube sleeve with the other hand, press the expansion button of the telescopic tube with the index finger, push the telescopic tube sleeve forward to extend the telescopic tube to the required length position, release the index finger and lock the telescopic tube; pull the telescopic tube sleeve in the opposite direction to retract the telescopic tube.

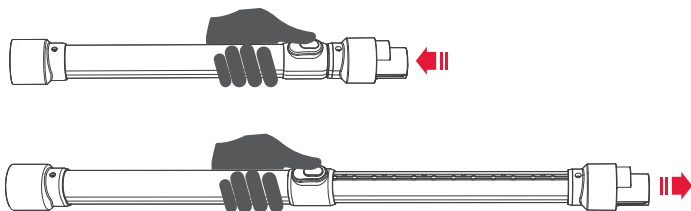

6. Use the wall hanger

Install the wall hanger: Insert the expansion tube into the pre-mounting holes on the wall, thread two fixing screws through the two mounting holes of the wall hanger, align the fixing screws with the expansion tube holes, insert the fixing screws into the expansion tube holes, and tighten the screws clockwise.

Use the wall hanger: After the wall hanger is fixed, the vacuum cleaner body is placed on the wall hanger as shown in the figure, and the accessories of the vacuum cleaner are inserted into the accessory fixing hole on the side of the wall hanger for fixation, as shown in the figure. To charge the battery, insert the charging connector of the vacuum cleaner charger into the charging port of the vacuum cleaner battery pack.

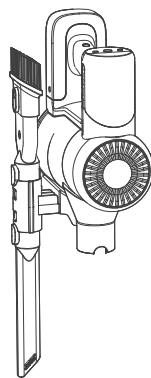
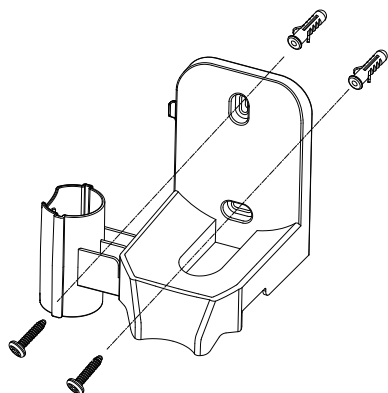



USAGE OF VACUUM CLEANER

1. Charging of Vacuum Cleaner

To charge the vacuum cleaner, plug the adapter into the AC power socket, and plug the DC connector of the adapter charging output cable into the charging port of the battery pack. If the cleaner is in the charging state, the vacuum cleaner fancy lamp (blue lamp) will light up, and the power indicator will flash in turn, indicating that the vacuum cleaner is in the charging state, and the vacuum cleaner fancy lamp (blue lamp) will automatically go out after 1 minute of charging; If the power indicator is fully on and no longer flashing, the vacuum cleaner is fully charged. Do not leave the vacuum cleaner under power for a long time. **Please use the original charger of this product for charging.**

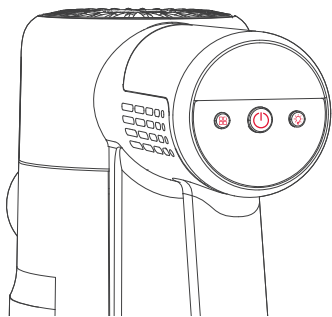
2. Use ON/OFF and speed adjustment buttons



ON/OFF button: press the  to start the vacuum cleaner. The vacuum cleaner works at the speed of 60 by default. When the vacuum cleaner works at any speed, just press the  again to stop the vacuum cleaner.

Speed adjustment button : The working speed (that is, the rotating speed of the vacuum cleaner motor) of the vacuum cleaner can be adjusted by pressing the speed adjustment button. The vacuum cleaner has 5 speeds: 30, 60, 90, 120. Different speeds of 30, 60, 90, 120 and 150 can be switched by the speed adjustment button. 30 is ECO, 150 is AUTO, and the AUTO mode is realized through the

automatic adjustment of the vacuum cleaner. If the air duct of the vacuum cleaner is blocked, the vacuum cleaner will automatically switch to AUTO, and overspeed to 150 position, and the suction (i.e. vacuum degree) of the vacuum cleaner will instantaneously and substantially increase to remove the blockage. After 7 seconds, if the blockage is removed, the vacuum cleaner will return to the original speed and operate. If the blockage fails to be removed after 7 seconds, the air duct blockage warning lamp  will flash, the vacuum cleaner will automatically shut down.

Lamp control button : It can control the working switch between the vacuum cleaner fancy lamp and LED lighting lamp. When the vacuum cleaner is off, press the light control button, and the head lamp of the vacuum cleaner will be on. Press the button again, and the fancy lamp of the vacuum cleaner will light up. When the vacuum cleaner is working, press the lamp control button, the vacuum cleaner fancy lamp will go out, and the LED lighting lamp will light up.

USAGE OF VACUUM CLEANER

3. Display Items





Remaining working time: Start the cleaner, the display will automatically display the remaining working time (in minutes) of the vacuum cleaner. The display will fluctuate in 0.5-2 seconds before the cleaner is started, indicating that the CPU of the vacuum cleaner is calculating and verifying the remaining working time. Due to the changes of the operating environment and temperature of the vacuum cleaner, there will be a little deviation between the display of the remaining working time and the actual display time during the use process, which is normal. If the working power of the vacuum cleaner is low, the time display will flash, indicating that the power is low and the battery must be charged immediately.

Vacuum cleaner power : The power display has four internal cells representing the power level, 100% for 4 cells, 75% for 3 cells, 50% for 2 cells, and 25% for 1 cell. If the vacuum cleaner is charged, the four cells of power display will flash upward in turn, and the four cells will not flash after being fully charged, indicating that the vacuum cleaner is fully charged. If the vacuum cleaner is working, the four cells of power display will flash downward in turn. When the bottom one flashes, it means that the power is insufficient, and the vacuum cleaner needs to be charged as soon as possible.

LED lighting indicator : When the LED lighting indicator is lit, it indicates that the head LED lighting lamp of the vacuum cleaner is in working state.

Fancy lamp indicator : When the fancy lamp indicator is lit, it indicates that the fancy lamp of the vacuum cleaner is in working state.

Floor brush stalling warning lamp : when the floor brush stalling warning lamp is lit (red), it means that the floor brush roller of the vacuum cleaner is in the stalling (blocked) state, and should be cleaned, the blockage should be removed or the contact between the floor brush and the ground should be adjusted to avoid carpets, towels and bed sheet getting involved in the air inlet of the floor brush.

Air duct blockage warning lamp : When the air duct blockage warning lamp is lit (red), it indicates that the air duct of the vacuum cleaner is blocked, and the air duct of the vacuum cleaner should be checked and cleaned: check whether there is any blockage in the telescopic tube of the vacuum cleaner; check whether the air inlet of the vacuum cleaner is blocked; clean the filter in the vacuum cleaner.

Operating speed position indication of vacuum cleaner: 30 represents the working state of the vacuum cleaner as ECO, 60 represents the lower speed working state of the vacuum cleaner, 90 represents the medium speed working state of the vacuum cleaner, 120 represents the high speed working state of the vacuum cleaner, and 150 represents the working state of the vacuum cleaner as AUTO. The speed position (30/60/90/120/150) is positively correlated to the speed of the vacuum cleaner motor, representing the high/low speed of the vacuum cleaner motor. The larger the value, the higher the speed of the vacuum cleaner motor.

Maintenance

Clean the dust bucket and filter

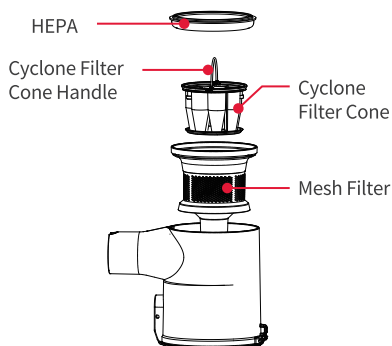

Clean the HEPA

If the vacuum cleaner is blocked or the suction drops significantly during normal operation, the HEPA should be cleaned. Take down the dust bucket of the vacuum cleaner, take out the HEPA from the dust bucket, remove the dust from the HEPA, knock the HEPA or wash it with clean water, and then dry the HEPA in the sun, and then put it back into the dust bucket after the HEPA is completely dried.

Don't bend or twist the HEPA during cleaning or rinsing. The HEPA can only be used after been completely dried.

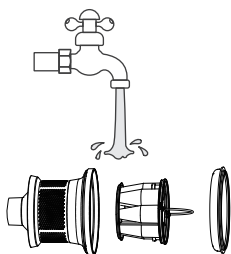

Cleaning of electric floor brush

1. As shown in the picture, push the lock button down to the unlocked state, and take out one end of the roller brush and pull out the whole brush.

Note: when pulled out, some of the dusts will fall.

2. As shown in the picture, clean up the wound hair or debris on the roller brush. If it is washed with water, it must be dried after rinsing before it can be put back to use.

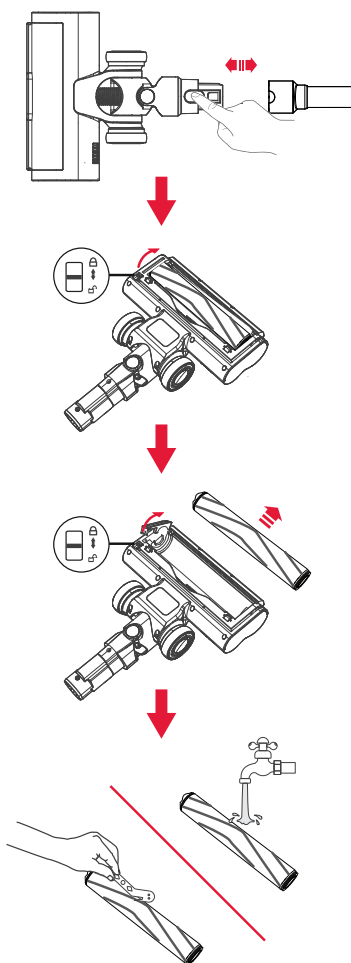

Troubleshooting

Fault	Possible Issues	Solution
The machine can not be started	The battery is not installed correctly	Please install the battery correctly
	The battery is dead	Charge the battery
Vacuum cleaner has no suction/suction becomes smaller	The dustbin is full	Please empty the rubbish in the dustbin
	The suction of the dust pipe or floor brush is blocked by a foreign body	Clean up the suction of the dust pipe or floor brush
	Dustbin or HEPA is not installed correctly	Reinstall the dustbin and HEPA
	Filter HEPA blockage	Clean and filter HEPA, dry it and put it back
Dust is leaking from the air outlet	HEPA is not installed correctly	Install HEPA correctly
The roller brush stops turning, and the floor brush blockage indicator lights up in red	The roller brush is entangled or stuck, resulting in protection	Clear the winding or blockage and turn it back on
The full dust indicator lights up in red	The dustbin is full	The dustbin needs to be dumped

Note:

- This vacuum cleaner must be used with the original battery and power adapter.
- Do not use the battery for any purpose other than this vacuum cleaner.

Specifications

Please use the original charger of this product for charging.

Working Voltage	25.9V
Battery Capacity	2500mAh
Rated Power	420W
Adapter Rated Input	100-240V~50/60Hz
Adapter Rated Output	30V $\overline{=}$ 0.5A