



USER MANUAL

Model: Pooleco 10

TABLE OF CONTENTS

EN

Safety instructions	02
Package contents	03
Product overview	04
Product operation	05
Product maintenance	06
Product specifications	09

DE

Sicherheitshinweise	10
Inhalt der Verpackung	11
Produktübersicht	12
Betrieb des Produkts	13
Produktpflege	14
Fehlersuche	17

FR

Instructions de sécurité	18
Contenu de l'emballage	19
Aperçu du produit	20
Fonctionnement du produit	21
Maintenance du produit	22
Dépannage	25

IT

Istruzioni di sicurezza	26
Contenuto della confezione	27
Panoramica del prodotto	28
Funzionamento del prodotto	29
Manutenzione del prodotto	30
Risoluzione dei problemi	33

ES

Instrucciones de seguridad	34
Contenido del paquete	35
Resumen del producto	36
Funcionamiento del producto	37
Antenimiento del producto	38
Solución de problemas	41

SAFETY INSTRUCTIONS

IMPORTANT SAFETY PRECAUTIONS

Please read this manual carefully and use your robot in accordance with its instructions. We are not responsible for any loss or injury caused by improper use of this equipment.

To reduce the risk of injury or damage, please observe the following safety precautions when installing, using and maintaining your robot.

- Read all safety and operating instructions before operating your robot.
- Keep the safety and operating instructions for future reference. If you accidentally lose the operating instructions, you can download the instructions as an electronic file from the official website (<https://www.ultenic.com>).
- Follow all operating and usage instructions.



The symbols on the product or its packaging indicate that:

Do not dispose of the appliance as unsorted municipal waste, use a separate waste collection method. For information on available collection systems, contact the local authorities. If appliances are disposed of in landfills or dumps, harmful substances can seep into the groundwater and enter the food chain, damaging your health and food. Please contact your local or regional waste management agency for more information on recycling, reuse and recovery programs.

PLEASE FOLLOW THESE INSTRUCTIONS STRICTLY.

- Do not operate your robot while people or animals are in the pool.
- Please turn off your robot when not in use or for maintenance.
- Your robot is not a toy. Do not sit or stand on the robot. Children and pets should be supervised while your robot is operating.
- Use only power adapters authorized by the Division.
- If the adapter power cord or plug is damaged, it must be repaired by the manufacturer or a similarly qualified person.
- Check the battery pack for signs of damage or leakage before each use. Do not charge a damaged or leaking battery pack.
- Before charging, make sure the charging port is dry.
- Do not cover your robot while charging, as this may cause the components to overheat.
- Do not run your robot outside of water as this may cause it to overheat
- Only a certified professional should disassemble your sealed driving kit.
- Do not operate your pool cleaning robot and pool filter at the same time.
- The oil seal around the motor contains grease and may cause significant water contamination if the motor is damaged. If you think there is a leak, stop using the unit immediately.
- Do not squeeze or disassemble the battery pack. Do not heat the battery pack or place it near any heat source
- Do not crush or disassemble the robot.

PACKAGE CONTENTS

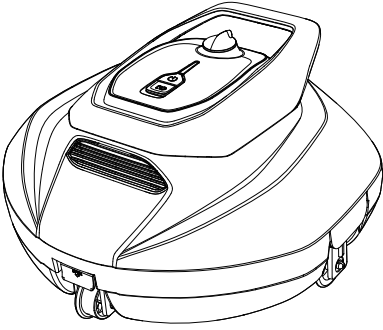

Robot

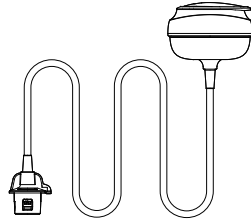

Floating ball

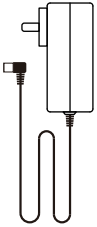

Adapter



Suction port brush

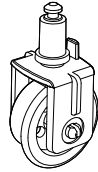

Wheel set

PRODUCT OVERVIEW

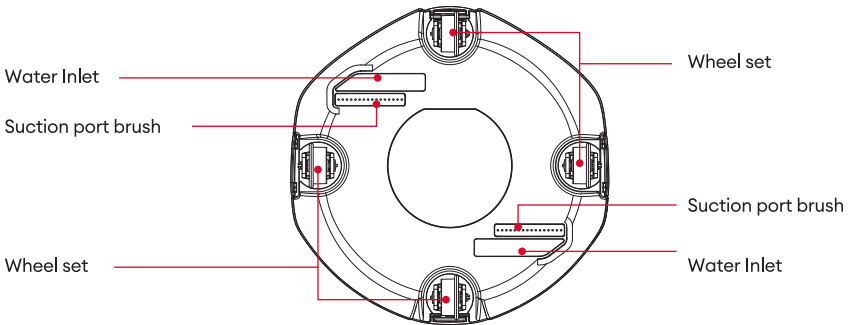
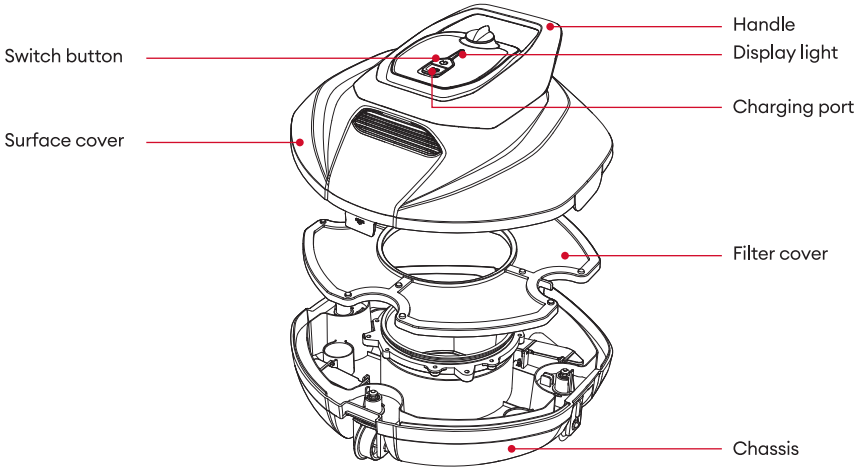

Key Description

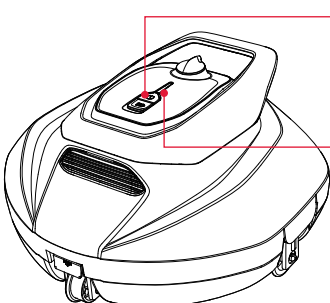

Power button

- Short press the power on button to turn on.
- Long press to turn off

Display light description

- When working, the blue light is fixed.
- When the power is low, the red light is fixed.
- When charging, there is will a breathing green light.
- When fully charged, the green light is fixed.
- When encountering abnormalities, the red light is flashing.

PRODUCT OPERATION

Operation

Note: This robot is best used in an environment where the water temperature is 50-95°F (10-35°C), pH: 7.0-7.4, chlorine: max 4 ppm, NaCl: max 5000 ppm.

- a. Press and hold the power button until the indicator light comes on and beeps.

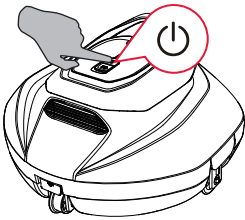

- b. Please place the bottom of the robot facing the wall and gently place it into the water.

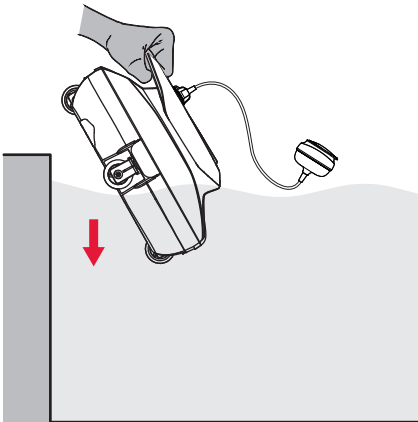

- c. When the robot runs to low power, it will automatically stop next to the pool wall

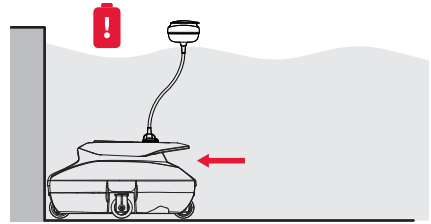

- d. Use the floating ball connected to the robot to pull your robot out of the water.

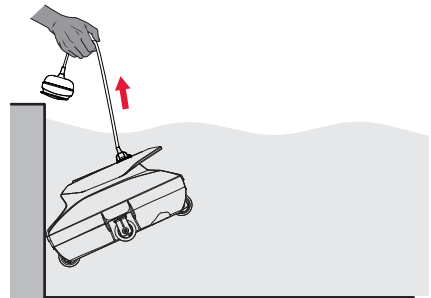

Charging

Before charging, please check that the charging terminals are dry and clean.

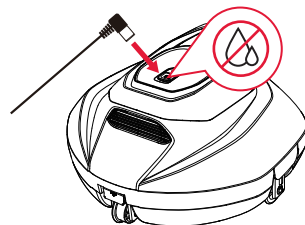

PRODUCT MAINTENANCE

Clean the filter cover and robot chassis

- a. Open the fixed clips at the front and rear of the robot.

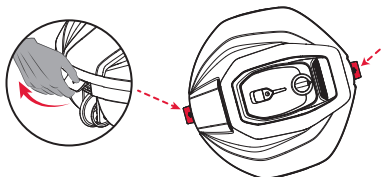

- b. Gently pull the plates on both sides of the housing outward in order to remove the housing, and then remove the plate.

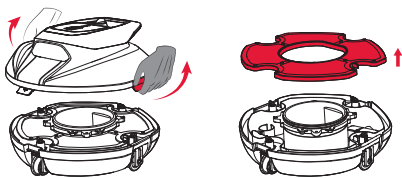

- c. Empty the trash from the chassis and rinse the chassis and filter cover with water.

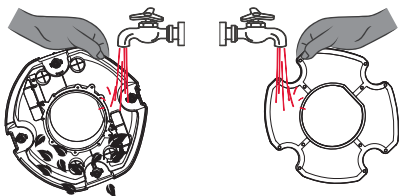

- d. After cleaning, please put the robot back together completely.

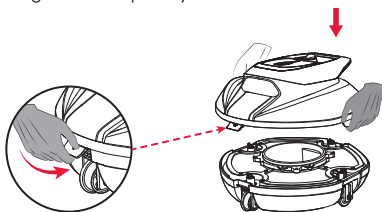

Replace the brushes

If the brushes are worn out, follow the steps below.

- a. Remove the housing of your robot and locate the brushes.

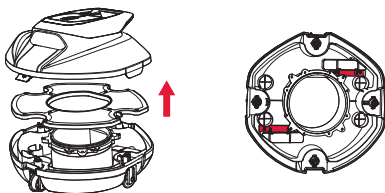

- b. Using a small tool or your fingers, push the two small latches to either side.

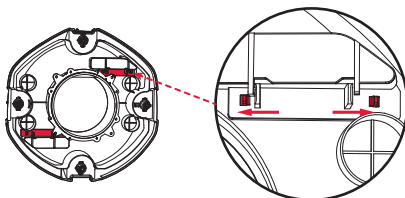

- c. Press the top of the suction port brushes on both sides and push the suction port brushes out.

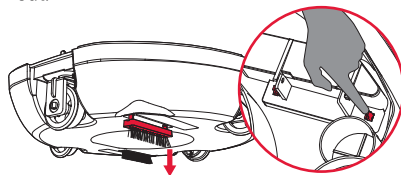

- d. Finally, insert the new suction port brushes into the bottom slot of the robot.

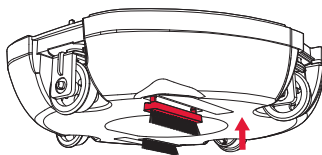

PRODUCT MAINTENANCE

Replace the wheels

If your robot's wheels break, follow the steps below.

- a. Remove the housing of your robot and locate the location of the broken wheel.

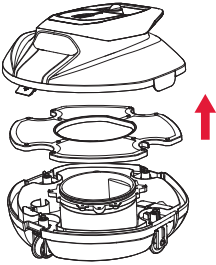

- b. Using a tool or your finger, gently push out toward the slot and push out the robot chassis by pressing on the top of the old wheel.

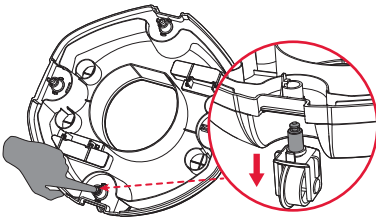
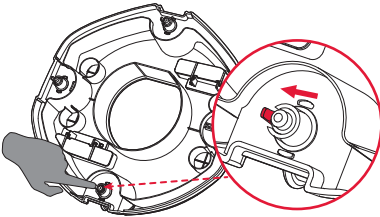

- c. Take out the new wheel, first aligning the two fixed ends on the wheel with the hollow under the robot chassis. Then press gently and if the installation is successful, you will hear a "click".

