

AIR PURIFIER COLIN WIFI+BLE INSTRUCTION MANUAL

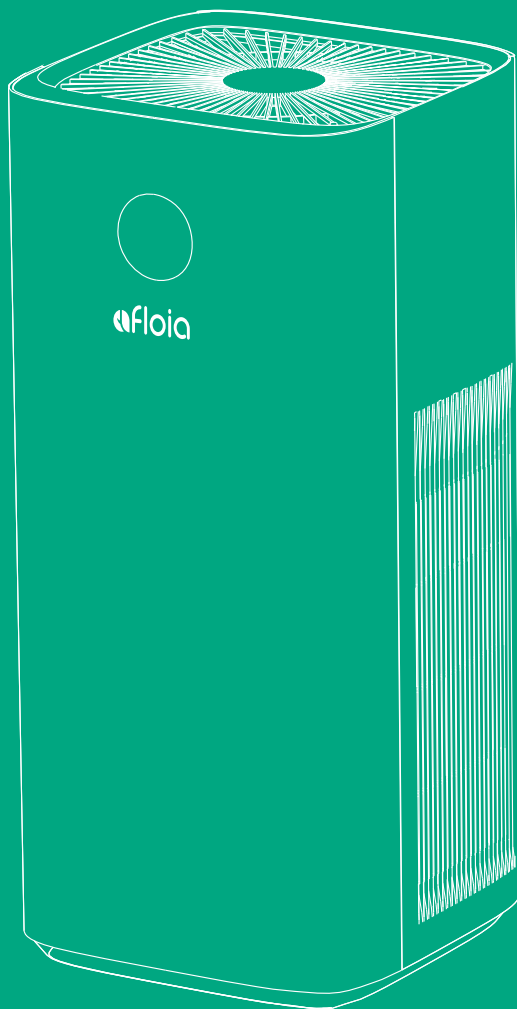

STOP

**PLEASE DO NOT RETURN
THIS PRODUCT TO RETAILER**

If you are missing parts, have ANY
issues when operating this product,
need replacement parts or need
assistance please contact:

✉ Email : service@afloia.com



Facebook messenger



7/24H Quick Reply Within 12 Hours

CONTENTS

POINTS FOR ATTENTION	1
PRODUCT OVERVIEW	2
INSTRUCTION	3
SPECIFICATION	4
WIFI MANUAL	4-5
APP CONNECTION FAQ	5-6
SET UP YOUR SCHEDULE	7
CUSTOMIZE YOUR SMART LIFE	7-8
FILTER REPLACING	9
MAINTENANCE	10
FAQ	10-11

Please read the instructions carefully before using the product and keep them properly

POINTS FOR ATTENTION

Before using, please read this user manual carefully and keep it for future reference.

Danger Warning

1. To avoid electric shock and fire, do not allow water, liquid or any flammable detergent to get into or to clean the product.
2. Do not spray insecticide, perfume, or other flammable sprays around the products.

Safety Warning

1. Before connecting the power supply, please check if the voltage of the product is consistent with the local power voltage.
2. If the power cord is damaged, it must be replaced by electrical technicians or professional personnel to avoid danger.
3. Do not use it when the plug, power cord, or the product is damaged.
4. Do not block the air inlet and air outlet.
5. Do not insert foreign matter into the air inlet.
6. This product should not be used by persons with physical disabilities, mental disabilities, or lack of relevant experience and skills.
7. Do not allow children to play with the product or clean and maintain the product unsupervised.

Notice

1. This product is not a substitute for normal ventilation, daily vacuuming or cooking range hoods.
2. Make sure the connected power socket is in good contact, or the plug may become very hot.
3. Do not place anything on the product.
4. Ensure the product is used on a stable and horizontal level.
5. Please leave at least 10in space on the back and sides of the product, and at least 20in space above the product when using.
6. Do not put the product directly under the air conditioner to prevent condensation from dripping into the product.
7. Before turning on the machine, make sure that the filter and filter cover is installed in place.
8. Please use the filter specially designed for this product.
9. Burning the filter may cause irreversible human harm or endanger other lives. Do not use the filter for fuel or similar purposes.
10. Do not hit the product with hard objects (especially the air outlet and air inlet).
11. Do not insert finger or other things into the air outlet/inlet to prevent physical damage or trouble.
12. Do not use this product when using indoor aerosol repellent or in places filled with oil, flammable gas or chemical fumes.
13. Ensure the device is power-off and unplugged before cleaning, maintaining, and replacing filter.
14. Please unplug the product before moving it.

PRODUCT OVERVIEW

Components



Accessories



INSTRUCTION MANUAL

Control Panel



WiFi button



Wind speed button



Timer button



Power button

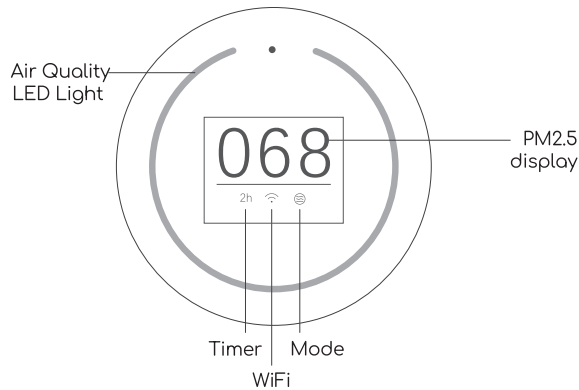

INSTRUCTION

Before starting, please ensure the filter is installed in place (refer to the 9th page of the manual)



Power Button

Press the power button to turn on the device.

The LED panel will display the remaining service life of the filter (e.g. ) , it is convenient for you to know the usage of the filter and replace it in time. And the LED light will show the corresponding color according to the air quality.



Wind speed button

Press this button to adjust working mode, there are 4 modes to choose from: Sleep-Mid-High-Auto.

If the filter expires, the orange indicator will flash. Long-press the wind speed button for 5s to eliminate the expiration prompt.

Auto Mode:

1. If the air quality is good, the indicator will be blue, and the device runs at low mode.
2. If the air quality is average, the indicator will turn yellow, and the device runs at mid mode.
3. If the air quality is poor, the LED light will be red, and the device runs at high mode.



Press this button to set timer: 2H-4H-6H-8H-12H-24H



WiFi button

Long press this button for 5s to turn on/ off the WiFi connection.

The WiFi indicator flashes in different states:

Smart configuration status: WiFi indicator blinks quickly
APP configuration status: WiFi indicator blinks slowly
Connected successful: WiFi indicator is always on.

SPECIFICATION

Model	Colin
Dimension	700x310x310mm
Weight	8.3kg
Rated voltage	100-240v 50/60Hz
Power	65W
Noise	56dB

WIFI MANUAL

Part 1. Crate Afloia Home Account

1. 2 ways to install the "Afloia home" APP: ①Scan the QR code below to download it. ②Or search "Afloia home" in the APP store or Google Play.



2. Open the "Afloia Home" app. Log in and sign up.
3. Follow the in-app instructions to set up your own "Afloia home" account.

Part 2. Connect the device with your phone

1. Connect Automatically

1.1 Turn on the air purifier→ Long press the WiFi button for 5S until a beep, the indicator blinks fast→ Turn on WiFi and Bluetooth of your phone→ Enter Afloia Home app→ Click "Add Device"→ "COLIN" will be detected automatically→ Enter WiFi name and password to finish connection (Only work with 2.4GHz WiFi network).

1.2 If not detected automatically→ Click "Auto Scan" on the top of the phone page→ Click "Next"→ Select "Colin" and Click "+"→ Enter WiFi name and password→ Click "Next" to finish connecting.

If auto connection failed, turn to manual connection

2. Connect Manually

2.1 When the WiFi indicator **blinks rapidly**:

Connect your phone to the 2.4G network→ Enter Afloia Home app→ Click "Add Device"→ Add Manually→ Choose "Small Home Appliances"→ **Air Purifier (Wi-Fi)** → Click "Next" and wait for the connection→ Add the device (COLIN), enter the WiFi name and Password (Only work with 2.4GHz WiFi network).

2.2 When the WiFi indicator blinks slowly (Hold the WiFi button for 5S until a "beep" to change **blink status**):
Open the Bluetooth of you phone→ Enter Afloia Home app→ Click "Add Device" → Add Manually→ Choose "Small Home Appliances"→ **Air Purifier (BLE+Wi-Fi)** → Click "Next"→ Enter your WiFi name and password (Only work with 2.4GHz WiFi network) → Go to the WLAN setting interface, connect the WiFi network named "SmartLife_Colin"→ Return to the "Afloia Home" APP to finish connection.

Note:

1. It only works with 2.4G Gz WiFi Network. Please switch to 2.4G if currently under 5G Network.

2. Status of WiFi indicator & it's meaning:

- ★ On & no blinking--- Connected successfully;
- ★ Blinking fast--WiFi of the air purifier is turned on;
- ★ Blinking slow-- WiFi and Bluetooth of the air purifier are turned on;
- ★ Off-- WiFi and Bluetooth of the air purifier are turned off.

You can respectively switch from blinking fast, slow and off by holding the WiFi indicator each 5 seconds.

* The WiFi indicator will not blink while the machine is powered on or turned on.

* The connection will be cut off when the power or network off. Please restart to connect your device and the air purifier after the power and network get right.

APP CONNECTION FAQ

Q1: When the WiFi indicator blinks slow, a message is displayed showing that the Smartlife network can not be connected or found.

A: It usually takes longer time to connect the air purifier to the mobile phone for the first time. Please exit the App and reconnect it, which should be finished within 2 minutes.

Q2: When the WiFi indicator blinks slow, password is needed for the connection to Smartlife

A: Click settings on your device, go to "Aloia Home", find the Local Network and switch it on.

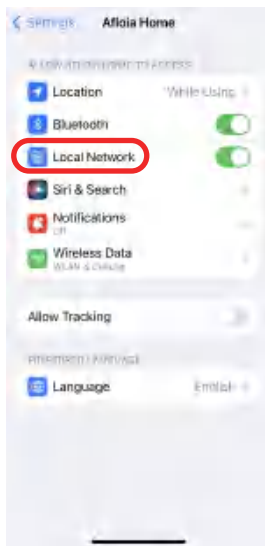

Q3: It is too slow to add devices when the indicator blinks fast.

A: Please exit the App and try again. Please use a faster network, or switch to another connect mode

Q4: Why is my air purifier not working as instructed?

A: Please ensure that the machine is normally connected to the power supply and stable network connection.

You can find more FAQ details from "FAQ & Feedback" in the account profile "Me", as follows.

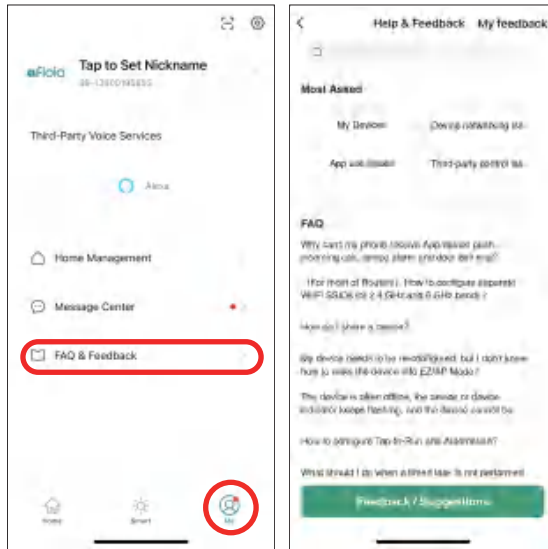

If you want to connect the "COLIN" air purifier to other devices, just click "Share Device" from the page below. The same COLIN can be shared to other mobile devices.

Step 1: Connect the air purifier with your mobile device first.
Step 2:

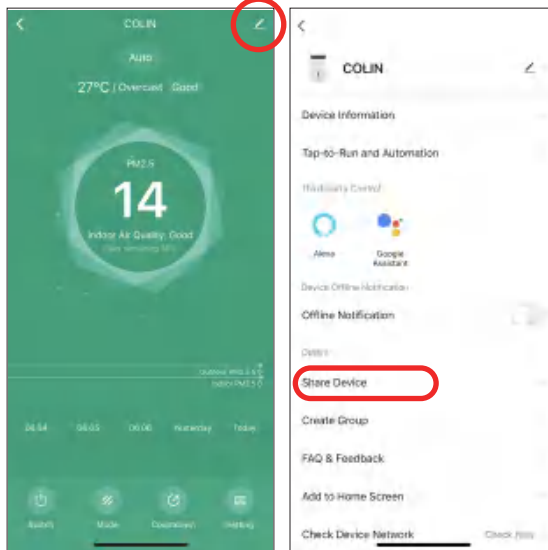

Please note:

1. This air purifier can not connected to more than 1 mobile device at the same time. If it has already been added on one device, it can not be added directly on another Mobile devices. This will cause the air purifier on the original mobile device to go offline.

2. When the mobile phone is connected to the air purifier, the WiFi indicator remains on. When the WiFi indicator flashes, it means that it has been disconnected from the previous mobile phone (the air purifier has changed Web environment or a new phone is connected to the air purifier)

SET UP YOUR SCHEDULE (AUTO SWITCH)

You can set the fixed time every day and turn on/off the machine.

Steps: Setting--Schedule--Add--Save

" If a time still can be activated after removal or change, please reset the timer to update cloud APP data, or remove the air purifier from APP, add again and reset a timer.

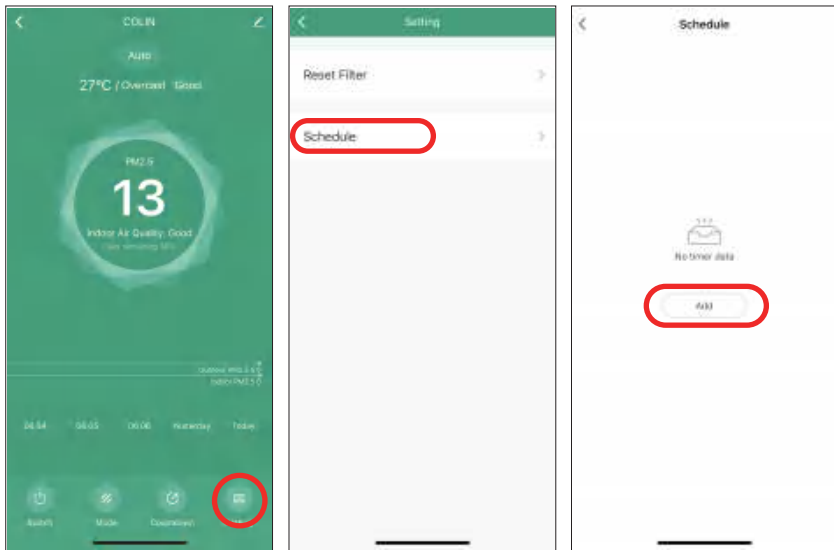

CUSTOMIZE YOUR SMART LIFE

Enter the "Smart" page and click "+" or "Crate Scene" of "Automation" to start creating one-click execution commands and smart setting.

" Set the operation mode of COLIN according to weather changes, which is pretty worry-free and convenient.

" If the scene does nor work as set, please remove the air purifier fro APP and add again first, and then retry to crate a scene.

You can find more FAQ details from "FAQ & Feedback" in the account profile "Me", as follows.

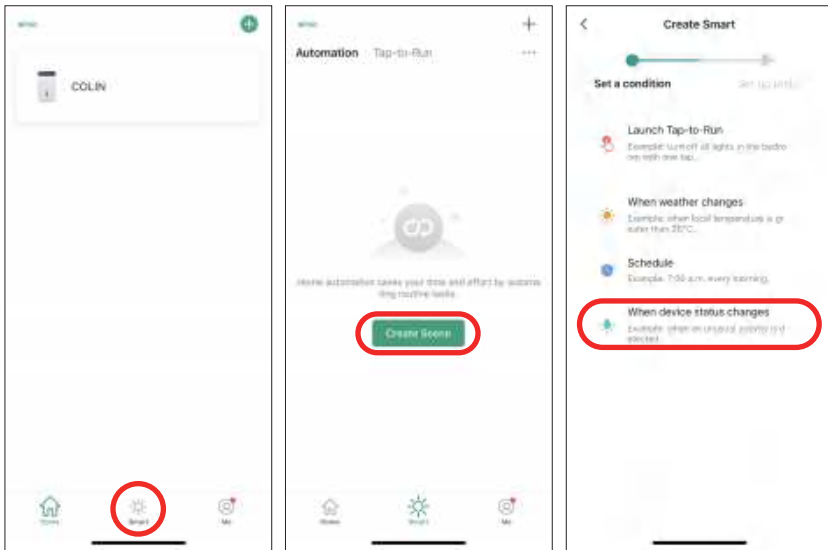

Quickly Bind Alexa

Voice control: The COLIN is compatible with Amazon Alexa, you can use your air purifier without having to lift a finger

Step 1:

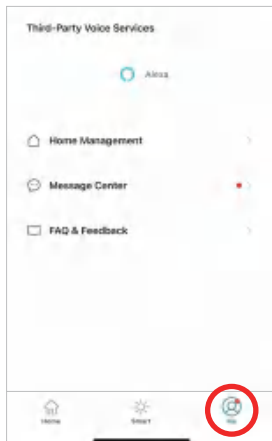

Step 2:

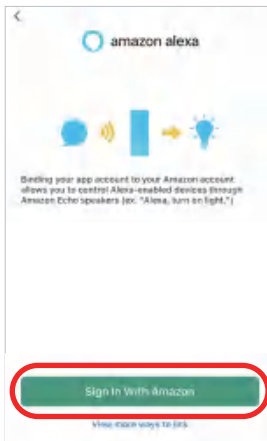

Step 3:

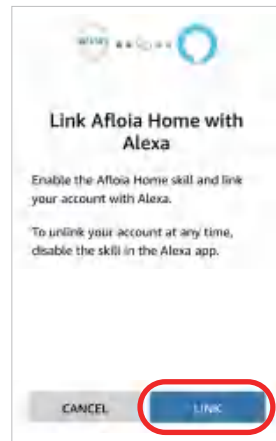

FILTER REPLACING

When the screen displays the remaining service life of the filter is 0%, the indicator will flash in yellow. It indicates that the filter needs to be replaced. Please use Afloua produced filter only to prevent the device damaged.

Notice:

- Please wipe the dust on the filter regularly, do not wash it.
- Do not vacuum the filter.
- Please put the filter in direct sunlight regularly to sterilize bacteria.

Steps to replace the filter:

1. Turn off the device and unplug it
2. Remove the back cover. Open the filter lock counterclockwise



3. Take out the old filter



4. Remove the packing of the new filter



5. Install new filter. Locking the filter clockwise



6. Install the back cover



7. After replacing the filter, plug the device into the socket and press the power-button. The screen will display that the remaining service life of the filter is 100%

MAINTENANCE

Notice:

- Ensure the device is unplugged before maintenance.
- Do not immerse the air purifier into water or any liquid.
- Do not use abrasive, corrosive or flammable cleansers (such as bleach or alcohol) to clean any part of the unit.
- Do not wash the filter.
- Do not use a vacuum cleaner to clean the filter.

Clean:

- Ensure the device is power-off and unplugged.
 - Remove the filter, clean the dust adsorbed on the outer surface of the filter (gently pat the filter outside the house).
 - Use a soft cloth with neutral cleanser to clean away any dust or debris from the surface of the device and air inlet/outlet.
 - After the device completely dry out, put on the bag and place it in a cool and well-ventilated place.
- Notice: Make sure there is no any water drop into the device when clean the air outlet.

Storage:

1. Turn off the device and unplug the power supply, arrange and bundle the power cord.
2. Remove the filter, clean the dust adsorbed on the outer surface of the filter
3. Clean the air inlet/outlet, wipe the body with a neutral detergent and a soft cloth.
4. After the device is completely dried, put on a dust cover/bag and place it in a well-ventilated place not exposed to direct sunlight.
5. If you do not use it for a long time, please turn on the device for a few minutes from time to time.

FAQ

Please stop using the product immediately if any abnormal situation occurs in the using process. Refer to the following FAQ to troubleshoot. If the following FAQ could not solve your problem and need maintenance, please contact after sales service center: service@afloia.com. Please do not disassemble the machine to maintain by yourself.

Issue	Troubleshooting	Solution
Not working	<ol style="list-style-type: none">1. Is it plugged into a power socket? Is there a power outage?2. Is the home leakage switch or fuse cut off?3. Is the service life of filter runs out? Whether the plastic film of the filter is not removed, or the filter is not installed correctly.4. Is the filter installed in place?	<ul style="list-style-type: none">· Make sure the power supply is properly connected.· Please check whether the voltage of the product is consistent with the local power supply voltage.· Check the service life of the filter· Lock the filter clockwise (you can see it on the display panel just after the machine is turned on) Remove the plastic film outside the filter, check whether the filter is installed correctly and whether the filter is locked.
The air volume becomes smaller	<ol style="list-style-type: none">1. Is there any dust on the surface of original filter?2. Is the air inlet/outlet of the device blocked by something?	<ul style="list-style-type: none">· Remove the dust on the filter and replace the filter in time.· Check whether the air inlet and outlet are blocked. Leave at least 30cm of space on the back and sides of the product.

Issue	Troubleshooting	Solution
Excessive noise	<ol style="list-style-type: none"> 1. Is there anything stuck on the fan in the air outlet? 2. Is the device tilted? 3. If not the situation above, you can adjust the device to a lower wind speed. 	<ul style="list-style-type: none"> · The fan has abnormal noise, please contact customer service immediately via service@afloia.com · Please check if there is any foreign matter at the bottom of the device causing unevenness.
Nasty smell	Please identify which kind of smell?	<ul style="list-style-type: none"> · It is normal that air purifiers may smell plastic the first few times they are used. If the filters are dirty, the air purifiers will also give off nasty smell. Please clean or replace the filter in this situation. · If the burning smell emits from the machine, please unplug the power socket and contact with seller or customer service.
The reminder of replacing filter keeps flashing after new filter has been replaced	<ol style="list-style-type: none"> 1. Please confirm whether the filter is produced by Afloia. 2. Please check whether the plastic bag outside the filter has been removed? 	<ul style="list-style-type: none"> · We have gone through a series of tests for Afloia's filters. We cannot guarantee the quality of other filters and whether they are compatible with our machines, so please use Afloia's filters. · Remove the plastic film outside the filter.
The phone can not connect to the device	<ol style="list-style-type: none"> 1. Are both WiFi and Bluetooth of the mobile phone turned on? 2. Make sure the WiFi indicator is flashing slowly, waiting for the connection? 3. Is it a 2.4Ghz WiFi network? 	<ul style="list-style-type: none"> · Turn on the WiFi and Bluetooth of the phone. · Long press the WiFi button 5s, after a "beep", the WiFi indicator will change its status, when the WiFi indicator is blinking slowly, then we can add devices manually or automatically. · Please select 2.4GHz WiFi network, 5G WiFi network is not supported temporarily. · If none of the above problems are found, you can click "ME"--"FAQ&-Feedback" in the Afloia Home App, and then you can find solutions to related problems. You can also contact our customer service to help you solve this problem. service@afloia.com

Inquiry about Malfunction

In the case that

- ① Something other than the symptoms coming under "Troubleshooting";
- ② You can feel electricity when you touch the product;
- ③ The power is supplied, but the fan does not work;
- ④ Other malfunctions occur.

Please stop using the product.

Please unplug the product and contact service@afloia.com

Warranty

For questions about our warranty or to purchase other products, please visit our website:

www.afloia.com



AIR PURIFIER COLIN WIFI+BLE INSTRUCTION MANUAL

We provide satisfying consultation and services concerning your complaints, suggestions, and recommendations upon receiving your troubled product model name, status, and contact information.

- After reading this manual, keep it in a place easily accessible to the user for future reference.
- Caution : Please read this manual carefully to ensure safety and a longer product lifespan.

www.afloua.com

service@afloua.com

Colin USA-SMS-20220218-V02