

# AVI-8

 AVI\_8

# SPITFIRE

**P8331 LAGUNA CHRONOGRAPH  
LIMITED EDITION**

For more details on operating this timepiece please  
refer to the enclosed booklet or visit:

**AVI-8.COM**



For more information  
Pour plus d'informations  
Para más información  
Per maggiori informazioni  
Für mehr Informationen  
想要查询更多资讯  
詳細については



**Instruction Manual**

Vol. 1.105 EN

**AV-4105**

# CHRONOGRAPH WATCH

## Meca-Quartz Chronograph

This watch is powered by a Japanese made “Meca-Quartz” movement. It combines a battery regulated engine with a mechanical chronograph module. The result is a watch which delivers the meticulous pinpoint precision of a quartz movement along with the crisp, flyback handfeel and visual charm of mechanical watches.

For more details on operating this timepiece please refer to the enclosed booklet or visit:

**AVI-8.COM**

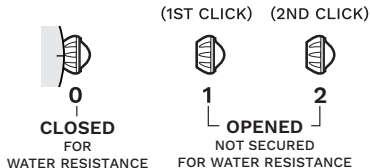
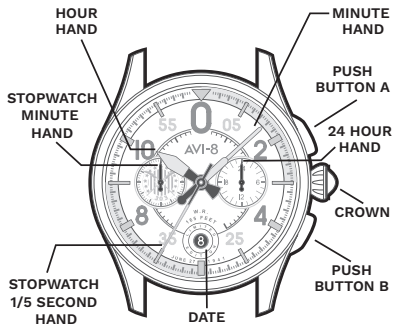

## HOW TO SET THE TIME

1. Pull the crown to position [2]-(2nd click).
2. Turn the crown clockwise to set the correct time.
3. Push the crown in.

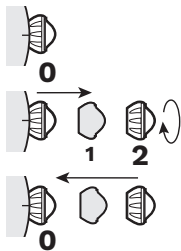

- \* Take A.M./P.M. into consideration when setting the hour and minute hands to the desired time.
- \* When the crown is at the position [2], do not press any button, otherwise the chronograph hands will move.

## HOW TO SET THE DATE

1. Pull the crown to position [1]-(1st click).
2. Turn the crown clockwise to set the correct date.
3. Push the crown in.

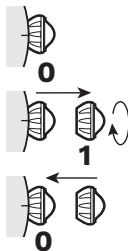

- \* Do not set the date between 9:00 P.M. and 3:00 A.M., otherwise the day may not change properly. If it is necessary to set the date during the time period, first change the time to any time outside it, set the date and then reset the correct time.

## STOPWATCH FUNCTION

- The stopwatch can measure up to 60 minutes.

### STANDARD MEASUREMENT

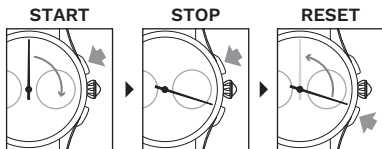

### ACCUMULATED ELAPSED TIME MEASUREMENT

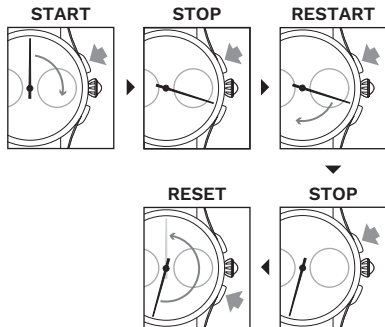

Restart and stop of the stopwatch can be repeated by pressing the button A.

## WATER RESISTANCE

Note that the water resistance chart serves only as a guide (please refer to the water resistance chart on the next page). Actual water resistance may vary depending on a number of factors including water temperature, water salinity and use under water. The water resistance of your timepiece may eventually be compromised over time with general wear and tear and use of your timepiece under adverse conditions.

Note that you should **NEVER** wear your watch in a jacuzzi, hot shower or steam room where steam may enter the case despite the watertight seals used to protect your watch. This may cause condensation inside your watch, which may affect and damage the inner workings of your watch.

<b>WATER RESISTANCE CHART</b>	<b>50M/ 5ATM</b>
<b>SPLASH/ SHOWERING</b>	
<b>SWIMMING/ BATHING</b>	
<b>BRIEF SWIMMING/ WATER SPORTS</b>	
<b>PROLONGED SWIMMING/ FREE DIVING</b>	
<b>SCUBA DIVING</b>	
<b>PROFESSIONAL DEEP SEA DIVING</b>	

Represented By:  
Authorised Rep Compliance Ltd.,  
Ground Floor, 71 Lower Baggot Street,  
Dublin, D02 P593, Ireland.

## **WARNING**

- **INGESTION HAZARD:** This product contains a button cell or coin battery.
- **DEATH** or serious injury can occur if ingested.
- A swallowed button cell or coin battery can cause **Internal Chemical Burns** in as little as **2 hours**.
- **KEEP** new and used batteries **OUT OF REACH** of **CHILDREN**.
- **Seek immediate medical attention** if a battery is suspected to be swallowed or inserted inside any part of the body.



**CE UK  
CA**