

 AVI\_8

For more details on operating this timepiece  
please refer to the enclosed booklet or visit:

**AVI-8.COM**



AVI-8

**HAWKER  
TYPHOON**

**CONINGHAM CHRONOGRAPH  
D-DAY 80 LIMITED EDITION**

For more information  
Pour plus d'informations  
Para más información  
Per maggiori informazioni  
Für mehr Informationen  
想要查询更多资讯  
詳細については



**Instruction Manual**

Vol. 1.93\_D-DAY EN

**AV-4093**

# CHRONOGRAPH WATCH

This watch is powered by a quartz Chronograph movement capable of split micro measurements of time.

With pinpoint accuracy you may use this watch to measure separate periods of elapsed time while simultaneously reading the current time.

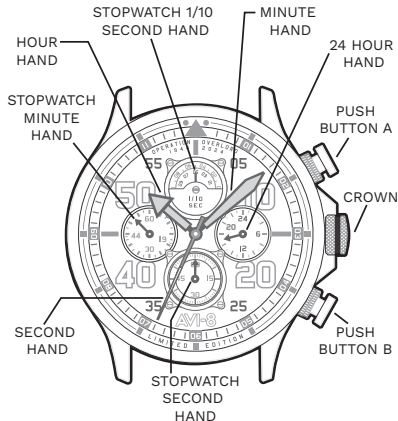

For more details on operating this timepiece please refer to the enclosed booklet or visit:

**AVI-8.COM**

(1ST CLICK)

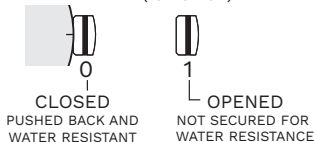

## HOW TO SET THE TIME

1. Pull the crown to position [1]-(1st click).
2. Turn the crown clockwise to set the correct time.
3. Push the crown in.

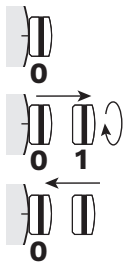

\* Take A.M./P.M. into consideration when setting the hour and minute hands to the desired time.

## STOPWATCH FUNCTION

- The measurement of time is indicated by the stopwatch hands that move independently of the center hands and 24-hour hand.
- The stopwatch can measure up to 60 minutes.
- The stopwatch measures in 1/10 second increments.

### STANDARD MEASUREMENT

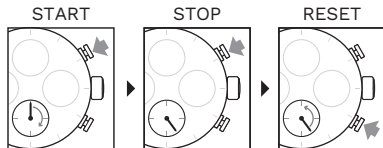

## ACCUMULATED ELAPSED TIME MEASUREMENT

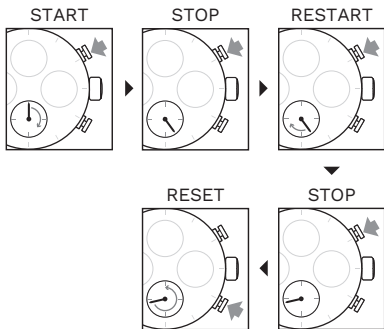

Restart and stop of the stopwatch can be repeated by pressing the button A.

## SPLIT TIME MEASUREMENT

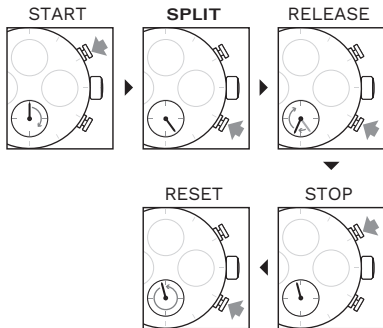

Measurement and release of split time can be repeated as many times as necessary by pressing the button B.

## ADJUSTING STOPWATCH HANDS POSITION

\* Before setting the time, check if all the chronograph hands - 1/10 second (where applicable), second, minute - are at the "0" (12 o'clock) position.

\* If the stopwatch is in use, press the buttons in the following order to reset it, and then, check if the hands return to "0" position.

\* If the chronograph is counting : **A → B**

\* If the stopwatch is stopped : **B**

\* If the split time is displayed : **B → A → B**

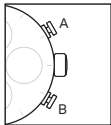

If either of the stopwatch hands are not in the "0" position, reset them following the procedure.

1. Pull the crown out to position [1]-(1st click).
2. Press button A or B to reset all stopwatch hands to "0" position.
  - \* The stopwatch minute hand moves correspondingly with the stopwatch second hand.
  - \* The hands move quickly if the respective buttons are kept pressed.
3. Push the crown back to the normal position.

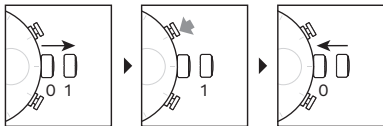

STOPWATCH  
HANDS ZERO  
POSITIONS

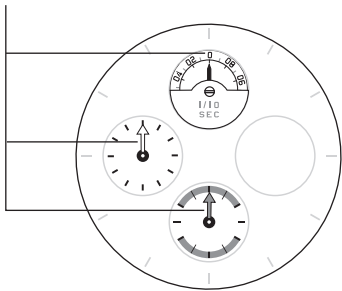

## WATER RESISTANCE

Note that the water resistance chart serves only as a guide (please refer to the water resistance chart on the next page). Actual water resistance may vary depending on a number of factors including water temperature, water salinity and use under water. The water resistance of your timepiece may eventually be compromised over time with general wear and tear and use of your timepiece under adverse conditions.

Note that you should **NEVER** wear your watch in a jacuzzi, hot shower or steam room where steam may enter the case despite the watertight seals used to protect your watch. This may cause condensation inside your watch, which may affect and damage the inner workings of your watch.

## WATER RESISTANCE CHART

50M/  
5ATM

SPLASH/  
SHOWERING



SWIMMING/  
BATHING



BRIEF SWIMMING/  
WATER SPORTS



PROLONGED  
SWIMMING/  
FREE DIVING



SCUBA  
DIVING



PROFESSIONAL  
DEEP SEA DIVING



Represented By: (for EU/UK)  
Authorised Rep Compliance Ltd.,  
Ground Floor, 71 Lower Baggot Street,  
Dublin, D02 P593, Ireland.

## ⚠ WARNING

- **INGESTION HAZARD:** This product contains a button cell or coin battery.
- **DEATH** or serious injury can occur if ingested.
- A swallowed button cell or coin battery can cause **Internal Chemical Burns** in as little as 2 hours.
- **KEEP** new and used batteries **OUT OF REACH** of CHILDREN.
- **Seek immediate medical attention** if a battery is suspected to be swallowed or inserted inside any part of the body.



CE UK  
CA