

Instagram icon *AVI_8*

For more details on operating this timepiece please refer to the enclosed booklet or visit:

AVI-8.COM



AVI-8

**HAWKER
HURRICANE**

**HELP FOR HEROES CHRONOGRAPH
LIMITED EDITION**

CHRONOGRAPH WATCH

Instruction Manual

Vol. 1.85HH EN

AV-4085HH

CHRONOGRAPH WATCH

This watch is powered by a quartz Chronograph movement capable of split micro measurements of time.

With pinpoint accuracy you may use this watch to measure separate periods of elapsed time while simultaneously reading the current time.

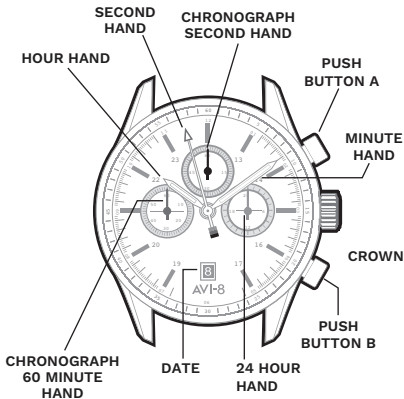

For more details on operating this timepiece please refer to the enclosed booklet or visit:

AVI-8.COM

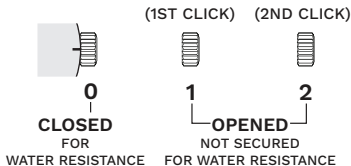

HOW TO SET THE DATE AND TIME

*Before setting the time, check that the chronograph measurement is stopped.

1. Pull the crown out to position [1]-(1st click).
2. Turn the crown clockwise until the preview day's date appears.
3. Pull the crown out to position [2]-(2nd click).

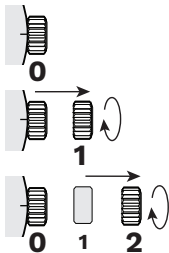

When the second hand is at the 12 o'clock position. It will stop on the spot. Set the hands to the desired time of the day (make sure

A.M./P.M. is set correctly) by turning the crown.
* When the crown is at the position [2]-(2nd click), do not press any pusher. Otherwise the chronograph hands will move.

4. Push the crown in.

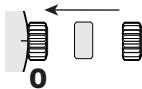

* Do not set the date between 9:00 P.M. and 3:00 A.M., otherwise the date may not change properly. If it is necessary to set the date during the time period, first change the time to any time outside it, set the date and then reset the correct time.

STOPWATCH FUNCTION

- The measurement of time is indicated by the stopwatch hands that move independently of the center hands and 24-hour hand.
- The stopwatch can measure up to 60 minutes.

STANDARD MEASUREMENT

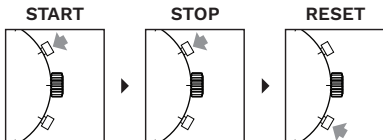

ACCUMULATED ELAPSED TIME MEASUREMENT

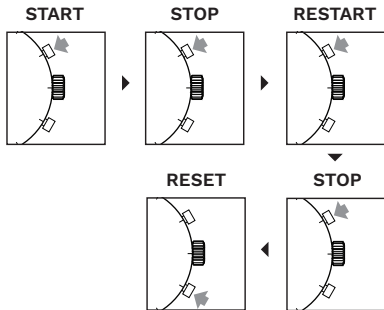

Restart and stop of the stopwatch can be repeated by pressing the button A.

SPLIT TIME MEASUREMENT

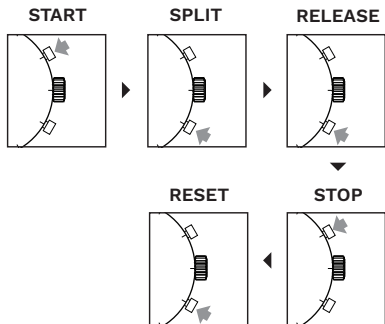

Measurement and release of split time can be repeated as many times as necessary by pressing the button B.

ADJUSTING STOPWATCH HANDS POSITION

* Before setting the time, check if all the chronograph hands - 1/10 second (where applicable), second, minute - are at the “0” (12 o'clock) position.

* If the stopwatch is in use, press the buttons in the following order to reset it, and then, check if the hands return to “0” position.

* If the chronograph is counting : **A → B**

* If the stopwatch is stopped : **B**

* If the split time is displayed : **B → A → B**

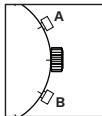

If either of the stopwatch hands are not in the “0” position, reset them following the procedure.

1. Pull the crown out to position [2]-(2nd click).
2. Press button A or B to reset all stopwatch hands to "0" position.
 - * The stopwatch minute hand moves correspondingly with the stopwatch second hand.
 - * The hands move quickly if the respective buttons are kept pressed.
3. Push the crown back to the normal position.

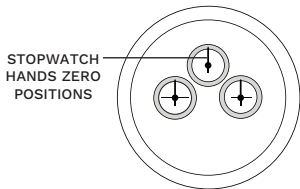

THE HANDS MOVE QUICKLY THE BUTTON IS KEPT PRESSED

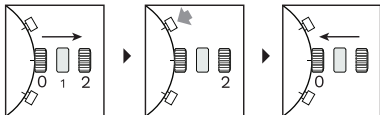

HOW TO CHANGE THE BRACELET TO LEATHER STRAP

1.

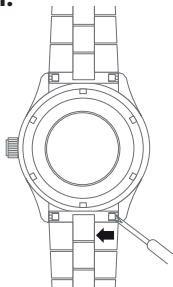

2.



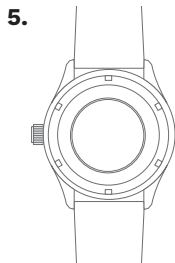
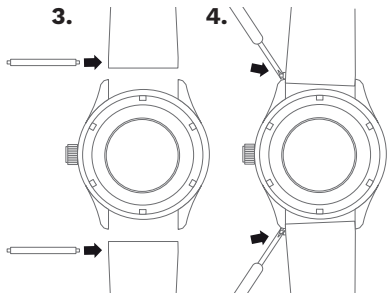

HOW TO USE A DEPLOYMENT CLASP

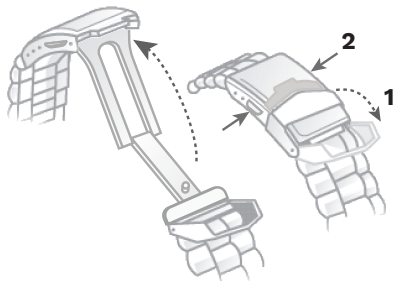

1. Flip the cover.
2. Press the buttons on the clasp sides.

HOW TO RESIZE METAL BRACELET

On the inside of the bracelet, you will see some small arrows engraved on removeable links.

1.

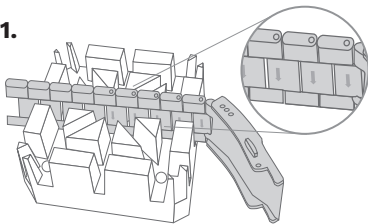

2.

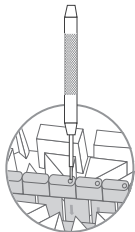

13

3.

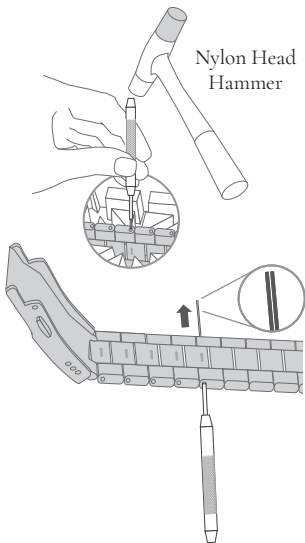

14

5.

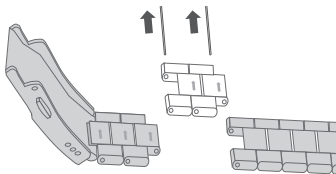

6.

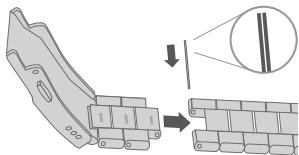

15

7.

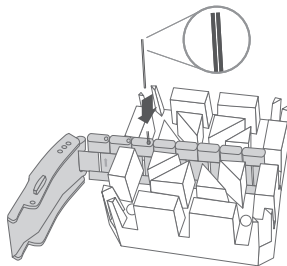

8.

Nylon Head
Hammer

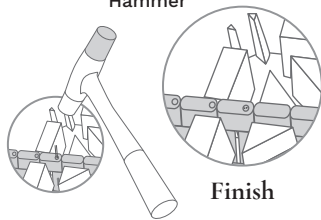

Finish

16

9.

Micro size
adjustment

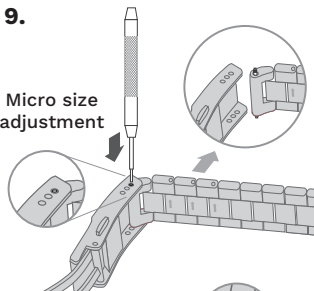

10.

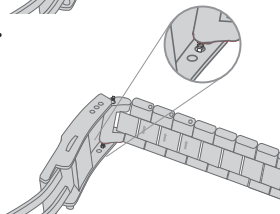

11.

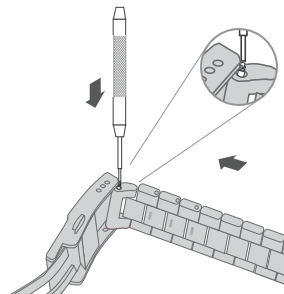

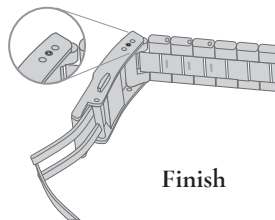

12.



WATER RESISTANCE

Note that the water resistance chart serves only as a guide (please refer to the water resistance chart on the next page). Actual water resistance may vary depending on a number of factors including water temperature, water salinity and use under water. The water resistance of your timepiece may eventually be compromised over time with general wear and tear and use of your timepiece under adverse conditions.

Note that you should **NEVER** wear your watch in a jacuzzi, hot shower or steam room where steam may enter the case despite the watertight seals used to protect your watch. This may cause condensation inside your watch, which may affect and damage the inner workings of your watch.

WATER RESISTANCE CHART	50M/ 5ATM
SPLASH/ SHOWERING	
SWIMMING/ BATHING	
BRIEF SWIMMING/ WATER SPORTS	
PROLONGED SWIMMING/ FREE DIVING	
SCUBA DIVING	
PROFESSIONAL DEEP SEA DIVING	

Represented By:
Authorised Rep Compliance Ltd.,
Ground Floor, 71 Lower Baggot Street,
Dublin, D02 P593, Ireland.

WARNING

- **INGESTION HAZARD:** This product contains a button cell or coin battery.
- **DEATH** or serious injury can occur if ingested.
- A swallowed button cell or coin battery can cause **Internal Chemical Burns** in as little as **2 hours**.
- **KEEP** new and used batteries **OUT OF REACH** of **CHILDREN**.
- **Seek immediate medical attention** if a battery is suspected to be swallowed or inserted inside any part of the body.



**CE UK
CA**