

 *AVI_8*

For more details on operating this timepiece please refer to the enclosed booklet or visit:

AVI-8.COM



AVI-8

**HAWKER
HARRIER**

DUAL RETROGRADE CHRONOGRAPH

For more information
Pour plus d'informations
Para más información
Per maggiori informazioni
Für mehr Informationen
想要查询更多资讯
詳細については



Instruction Manual

Vol. 1.56 EN

AV-4056

CHRONOGRAPH WATCH

This watch is powered by a quartz Chronograph movement capable of split micro measurements of time.

With pinpoint accuracy you may use this watch to measure separate periods of elapsed time while simultaneously reading the current time.

For more details on operating this timepiece please refer to the enclosed booklet or visit:

AVI-8.COM

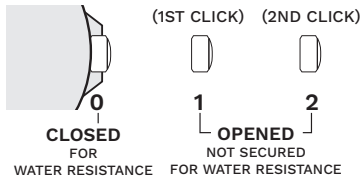
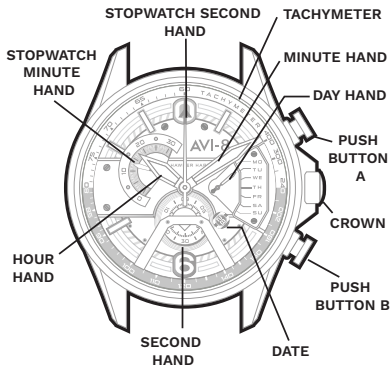

HOW TO SET THE TIME

1. Pull the crown to position [2]-(2nd click).
2. Turn the crown clockwise to set the correct time.
3. Push the crown in.

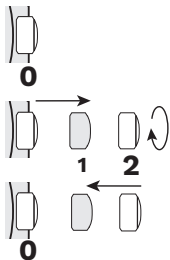

- * Take A.M./P.M. into consideration when setting the hour and minute hands to the desired time.
- * When the crown is at the position [2], do not press any button, otherwise the chronograph hands will move.

HOW TO SET THE DATE

1. Unscrew the crown and pull it out to position [1] -(1st click).
2. Turn the crown clockwise to set the correct date.
3. Push the crown in.

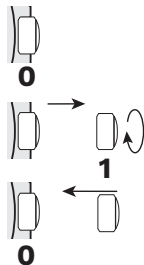

- * Do not set the date between 9:00 P.M. and 1:00 A.M., otherwise the day may not change properly. If it is necessary to set the date during the time period, first change the time to any time outside it, set the date and then reset the correct time.

HOW TO SET THE DAY

1. Pull the crown to position [1]-(1st click).
2. Turn the crown anti-clockwise to set the correct day.
3. Push the crown in.

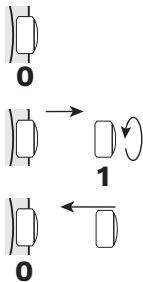

*If the day is set between the hours of 11:00 P.M. and 3:00 A.M., the day may not change on the following day.

STOPWATCH FUNCTION

- This chronograph is able to measure and display time in 1/1 second united up to maximum of 30 minutes.

STANDARD MEASUREMENT

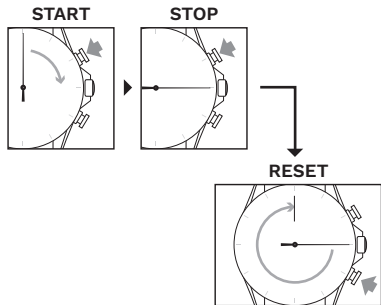

ACCUMULATED ELAPSED TIME MEASUREMENT

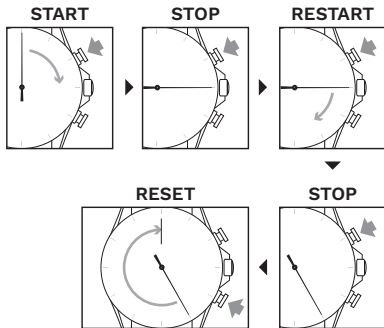

Restart and stop of the stopwatch can be repeated by pressing the button A.

CHRONOGRAPH RESET

(incl. after replacing battery)

This procedure should be performed when the chronograph second hand does not return to the Zero position after the chronograph has been reset, and including after the battery has been replaced.

1. Pull the crown out to the [2]-(2nd click).
2. Press the button "A" once to set the chronograph second hand to the Zero position.
 - * The chronograph hands can be advanced rapidly by continuously pressing button "A".
3. Once the chronograph hands been set at Zero position, readjust the normal hour and minute hands to the correct time and return the crown to its normal position.
 - * Do not return crown to normal position while chronograph second hand returns to 12:00 (ZERO) position. Hand stops on the way when crown is returned to normal position and these positions are recognized as 12:00 (ZERO) position.

**STOPWATCH
SECOND HAND
ZERO POSITION**

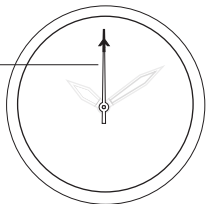

**RESET STOPWATCH
SECOND
HAND TO ZERO**

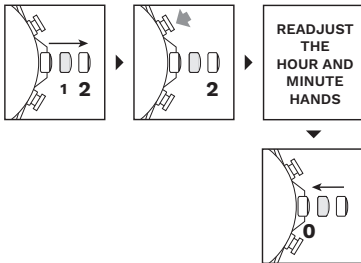

USING THE TACHYMETER

The most common use of a tachymeter is for measuring the approximate speed of a vehicle over a known distance.

(E.g.) Based on how many seconds it takes a vehicle to travel 1 km or 1 mile (the available measuring range is up to 60 seconds), the average speed within the distance can be calculated.

1. Start the chronograph when the vehicles commence travel.
2. After the vehicle has travelled 1 km/1 mile, stop the chronograph.

The approximate average speed within the distance can be determined by observing the present position of the stopwatch second hand and reading the outer bezel.

THE AVERAGE SPEED IS 80 KPH

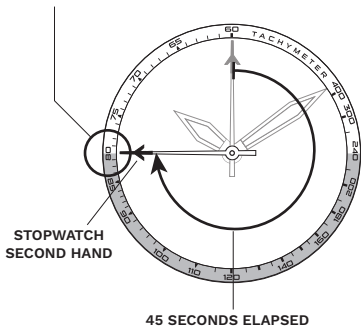

Note: The tachymeter indications may appear on dial ring, rather than on the outer bezel (depending on model).

As shown in the illustration, it takes the vehicle 45 seconds to travel 1 km so the approximate average speed is 80 kph (50 mph).

HOW TO USE A DEPLOYANT CLASP

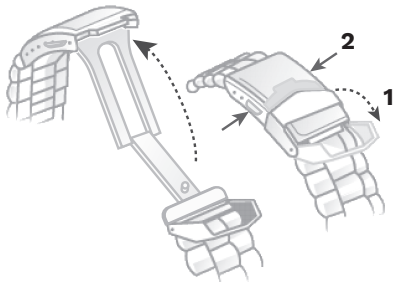

1. Flip the cover.
2. Press the buttons on the clasp sides.

HOW TO RESIZE METAL BRACELET

On the inside of the bracelet, you will see some small arrows engraved on removeable links.

1.

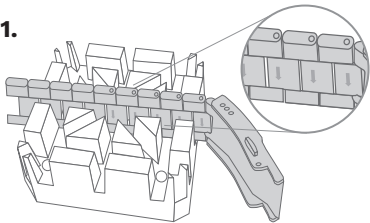

2.

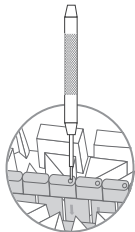

13

3.

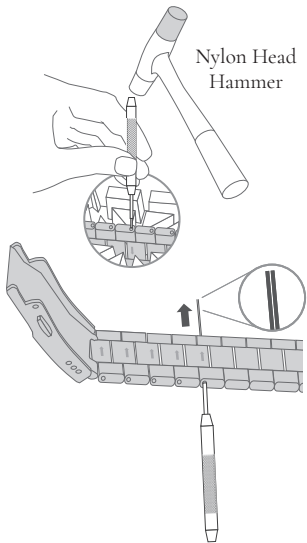

4.

14

5.

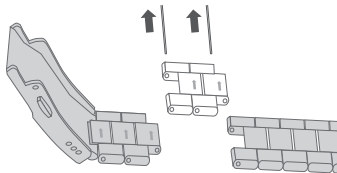

6.

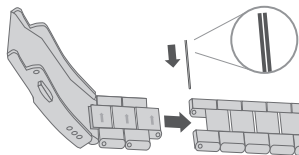

7.

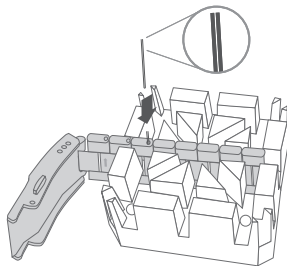

8.

Nylon Head
Hammer

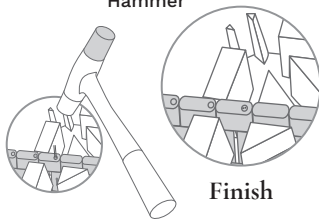

9.

Micro size
adjustment

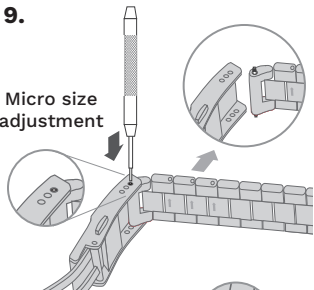

10.

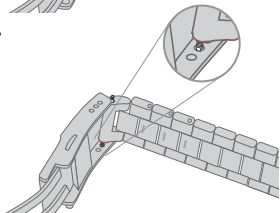

11.

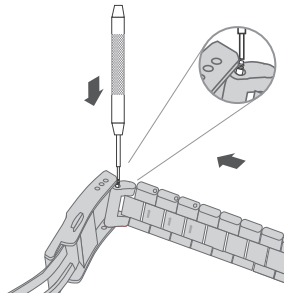

12.

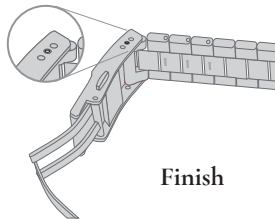





Finish

WATER RESISTANCE

Note that the water resistance chart serves only as a guide (please refer to the water resistance chart on the next page). Actual water resistance may vary depending on a number of factors including water temperature, water salinity and use under water. The water resistance of your timepiece may eventually be compromised over time with general wear and tear and use of your timepiece under adverse conditions.

Note that you should **NEVER** wear your watch in a jacuzzi, hot shower or steam room where steam may enter the case despite the watertight seals used to protect your watch. This may cause condensation inside your watch, which may affect and damage the inner workings of your watch.

WATER RESISTANCE CHART	50M/ 5ATM
SPLASH/ SHOWERING	
SWIMMING/ BATHING	
BRIEF SWIMMING/ WATER SPORTS	
PROLONGED SWIMMING/ FREE DIVING	
SCUBA DIVING	
PROFESSIONAL DEEP SEA DIVING	

Represented By:

Authorised Rep Compliance Ltd.,
Ground Floor, 71 Lower Baggot Street,
Dublin, D02 P593, Ireland.

