

## Alloy Hook Latch Kits

We keep a range of basic latch kits suitable for Alloy hooks. These are a light-weight kit, and we only recommend using these either as a short term solution until the correct manufacturers kit is obtained, or as an alternative if it has not been possible to identify or source the correct manufacturers kit.

***We always recommend fitting the manufacturers recommended latch kit when possible***



Fig. 1

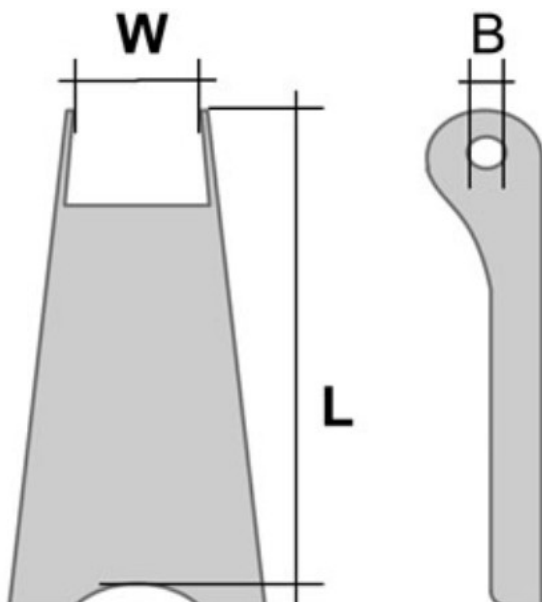

Fig. 2

Figure 1 shows a typical Alloy Hook, with the latch in place.

Figure 2 shows the hook with the latch removed, notice the lug with a hole in it (to which the latch is normally attached), the diameter of the hole and the thickness of the lug correspond to dimensions **B** & **W** in the chart below.

When there are two kits of similar size to your hook we recommend selecting the larger of the two, as long as the bolt size B is correct. The kit can always be trimmed in length to fit correctly.



KIT	W	L	B
L1201	9	34	3
L1202	10	38	3
L1203	13	43	4
L1204	14	47	4
L1205	15	59	4
L1206	15	70	5
L1207	16	87	5

All sizes in mm  
B is the dia. of bolt  
Dimensions are for guidance only.