

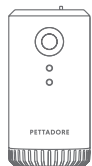

### In the box



Air Eliminator



Foam Sticker

Metal Plate  
StickerMicro USB  
Cable

Manual

### Meet your Air Eliminator

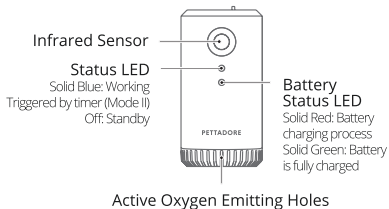

**How it works:** The built-in ozone generator converts  $O_2$  in the air into  $O_3$ .  $O_3$  possesses active oxidizing properties, which can, at the source within the cat toilet, break down odor molecules and convert them into harmless substances. It can also disrupt the cell membrane structure of bacteria, leading to a certain sterilization effect.

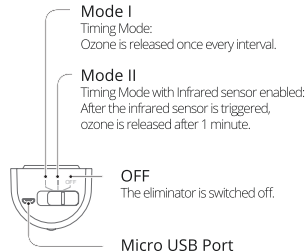

### Operations

1. Attach the metal plate to the foam sticker and affix the sticker to the desired location.



2. **For a closed cat toilet:** Affix the foam sticker to the cat toilet hood. **For an open cat toilet:** Attach the foam sticker to the wall near the cat toilet (approximately 5 cm above the cat toilet). **In other scenarios:** position the device closer to the source of the odor.

3. Press firmly on the metal plate to ensure it is securely attached.

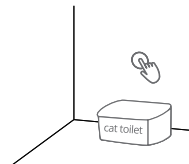

4. The eliminator can be mounted onto the metal plate.

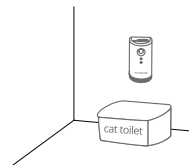

5. Choose the operating mode: Switch from OFF to your preferred mode.



For other languages see  
[pettadore.com/pages/manuals](http://pettadore.com/pages/manuals)  
Please read this manual carefully  
before using. Keep the manual in a  
safe place for future reference.

6. **Charging:** Connect the USB cable to a 5V/1A power source, then plug the A/C adapter into the wall outlet. Charging takes approximately 3 hours.

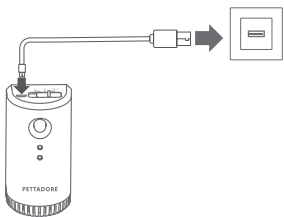

## Specifications

**Model:** AOE010

**Size:** 99.6x51.7x41.5mm  
(3.92x2.04x1.63 inches)

**Weight:** 153 g (5.4 oz)

**Battery:** Lithium 2200 mAh

**Power input:** DC 5V-1A

**Working modes:** Triggered by sensor or continuously emitting

**Infrared Detection Range:** about 1 m (3.3 ft)

**Warranty:** 1 year

[www.pettadore.com](http://www.pettadore.com)

## Precautions

1. This product is not waterproof; NEVER immerse it in water.
2. DO NOT attempt to replace the battery or disassemble it yourself.
3. DO NOT obstruct the air outlet and ensure proper ventilation
4. If children are using the product, ensure that an adult supervises.
5. Mode I is recommended to use ONLY in the environment where no human or pet is present.

## Warranty Terms

During the warranty period, if the product experiences a failure due to no fault of the user's operations, it will be repaired at Pettadore's expense. However, the warranty will not cover product failure in the following examples:

- 1). Intentional damage to the product by the user or a third party.
- 2). Failure to operate or maintain the product in accordance with the instructions provided in the User Manual.
- 3). Failure due to natural wear and tear, including but not limited to scratching, corrosion, oxidation, and rusting.
- 4). Failure due to non-authorized repair or modification of the product, including attempts made by the user or third parties.

All pictures shown in the manual are for illustration purposes only. The actual product may vary due to product enhancements.



**Pettadore (Achievd B.V.)**  
Vasteland 78 unit A2.14  
3011 BN Rotterdam  
The Netherlands



! For other languages see !  
[pettadore.com/pages/manuals](http://pettadore.com/pages/manuals)

CAT TOGETHER