

DAM EASY[®] FLOOD BARRIERS

FLOOD PROTECTION MADE EASY

Instruction Manual



NO TOOLS



NO FIXINGS



NO SILICONE



NO DRILLING

Contents

SECTION A: Getting to know your Flood Barrier P4

SECTION B: Do's and Don'ts – Safety P6

SECTION C: Installing the barrier(s) P7

SECTION D: Removing the barrier(s) P12

SECTION E: Cleaning the barrier P14

SECTION F: Replacing the seal P15

SECTION G: Storing the barrier P18

SECTION H: Troubleshooting P19

SECTION I: Accessories P20

SECTION J: Warranty & Disclaimer P22

SECTION K: End of Life Disposal P23

This instruction manual contains all the necessary information to correctly install, remove, maintain and store the **Dam Easy®** Flood Barrier.

See www.dameasyfloodbarriers.com for demonstration videos.

To avail of a 12 month guarantee, register your barrier within 30 days of purchase at www.dameasyfloodbarriers.com



**CORRECT/
DO**



**CAUTION/
IMPORTANT**



**INCORRECT/
DON'T**



**TOP
TIP**



This product meets
European Flood
Protection Association
Requirements



What's included:



Dam Easy Flood Barrier x 1



Instruction Manual x 1



Adhesive Patches x 4 portions



Replacement Seal x 1



Protectors for storage x 3



Reusable Storage Bag x 1

www.dameasyfloodbarriers.com

DAM EASY[®] FLOOD BARRIERS

FLOOD PROTECTION MADE EASY

Thank you for purchasing the Dam Easy[®] Flood Barrier

Having experienced the devastating effect of flooding (and unable to find an effective solution on the market), All Weather Industries designed the **Dam Easy[®] Flood Barrier**.

The **Dam Easy[®] Flood Barrier** provides temporary flood protection for doorways.

How it works

- Within suitable doorways, the **Dam Easy[®] Flood Barrier** extends to fit securely within reveals 780mm – 1100mm / 30.7in – 43.3in wide
- Inflation of unique, patented inflatable seal creates a watertight seal in seconds

The **Dam Easy[®] Flood Barrier** features include;

- ✓ A unique inflatable seal (patented)
- ✓ Simple and fast to install, no tools or trade skills required
- ✓ No unsightly fixings that damage doorways
- ✓ Reusable in different doorways/properties
- ✓ Extendible, for installation in doorways of various size
- ✓ Peace of mind with independent testing and certification from EFPA/ EVH and CE Marking.

INSTALLATION IN 3 EASY STEPS

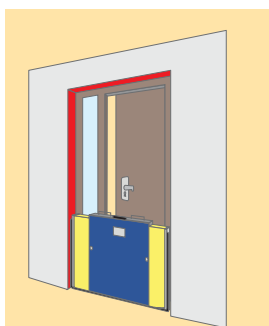

1
POSITION
IN DOOR REVEAL

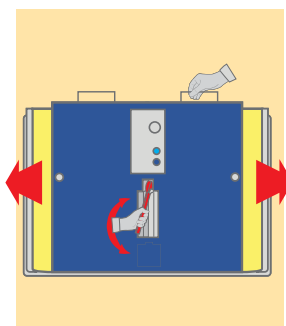

2
EXTEND
SIDE PANELS

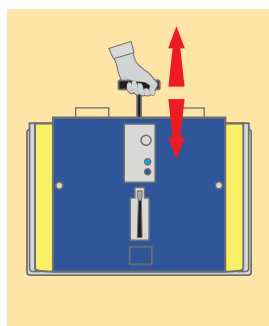

3
INFLATE
SEAL



NO TOOLS



NO FIXINGS



NO SILICONE



NO DRILLING

SECTION A: Getting to know your Flood Barrier

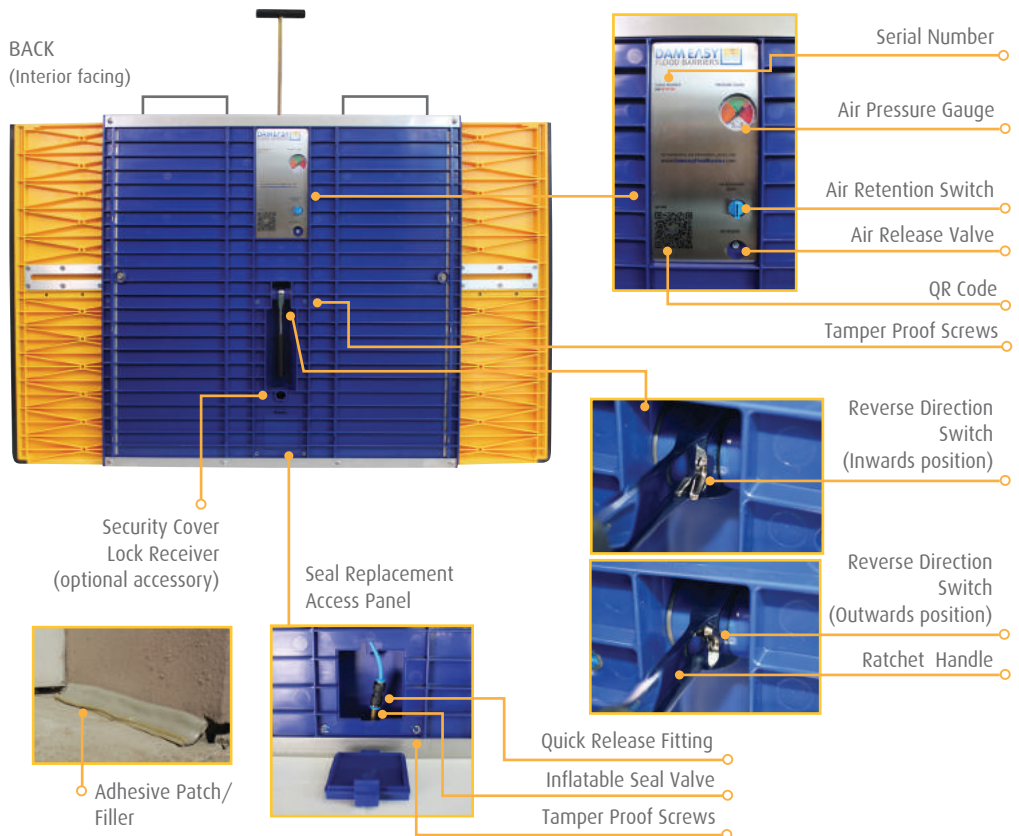

SECTION A: Getting to know your Flood Barrier

FLOOD BARRIER SPECIFICATIONS

Correctly installed, the **Dam Easy® Flood Barrier** creates a watertight seal within the reveals of suitable external doorways, providing flood protection up to 600mm/23.6in

Each barrier comprises of;

- a fixed centre panel and two extendible side panels controlled by a ratchet handle with reverse direction switch, to adjust to the width of suitable doorways
- an inflatable seal, connected to a pump mechanism with built-in air pressure gauge, which surrounds the extended barrier to create a watertight seal

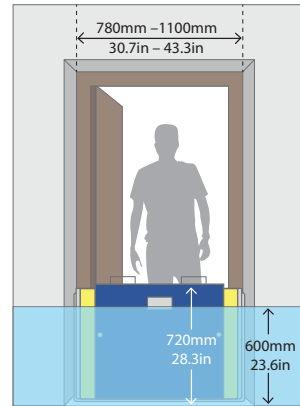

! CAUTION

We recommend not to install the barrier within a door frame (timber, aluminum etc.), install only within solid reveals.

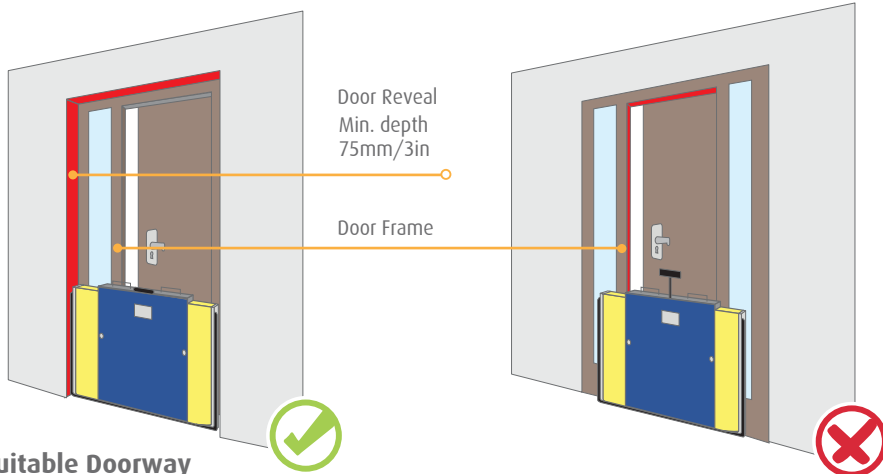

Suitable Doorway

To achieve a watertight seal and allow clearance to close the door, reveals must be smooth, solid, verticle and parallel, minimum size;

- Width 780 – 1100mm / 30.7in – 43.3in (single barrier)
- Width >1100mm+ / >43.3in+ (multiple barriers)
- Height 720mm / 28.3in
- Depth 75mm / 3in (single barrier installation)
- Depth 120mm / 4.7in (multiple barrier installation)

Doorstep must be smooth, solid and horizontal, at right angles to reveals

Unsuitable Doorway

- Reveal depth less than 75mm / 3in
- Door frame flush with exterior wall
- Reveals not parallel
- Uneven finish on reveals



TOP TIP: The Dam Easy® Extension System may be suitable to install multiple barriers in series for reveals greater than 1100mm/43.3in wide, see www.dameasyfloodbarriers.com for further details

SECTION B: Do's and Don'ts – Safety

PLEASE READ CAREFULLY



Basic safety precautions

- This barrier is designed for use within external reveals of suitable doorways. See **Section A Flood Barrier Specifications for description of suitable doorways**
- For installing, removing, maintaining and storing, use as detailed in this instruction manual, retain for future use (available to download www.dameasyfloodbarriers.com)
- The barrier weighs 19.7kg/43.4lb, take care when lifting – 2 people may be needed to lift the barrier safely
- Complete a full trial installation of the barrier in the doorway that requires flood protection, prior to a risk of flooding.
- Flood water may be contaminated, always use gloves and eye protection and carefully clean and dry the barrier thoroughly if it has been in contact with flood water
- Clear dirt and debris from the reveals and repair any cracks or damage to ensure a watertight seal
- Flood water can enter a property from other access points, see Section I Accessories for additional flood protection products and seek professional advice for suitable protection for your property
- Store the barrier as directed, in the original packaging away from direct sunlight and extremes of temperature

While the Barrier is 'in use' (Installing, Removing, Maintaining & Storing)



Do's

- Follow these instructions carefully, see demonstration videos available online www.dameasyfloodbarriers.com
- Wear gloves to prevent injury from pinch points and contamination from flood water
- Lift only from the Lifting Handles indicated to avoid damaging the barrier
- When the barrier is installed and there is a risk of flooding, monitor air pressure regularly
- To avoid damaging the inflatable seal, **always place the barrier on an even surface**



Don'ts

- DO NOT use any tools while installing, removing, maintaining or cleaning the barrier. Use of tools may damage the seal and will invalidate the warranty
- DO NOT install the barrier in a door frame, a watertight seal cannot be guaranteed between the reveal and the frame
- **DO NOT lift by the pump handle**
- Never inflate the seal when the barrier is not secure in a doorway
- DO NOT deflate the seal or retract the side panels when the barrier is installed in a doorway until water recedes
- DO NOT allow any detergents or any chemicals to come into contact with the barrier

SECTION C: Installing the barrier(s)

**FOR SINGLE BARRIER INSTALLATION
FOLLOW STEPS 1A, 2A AND 3**

**FOR MULTIPLE BARRIERS
FOLLOW STEPS 1B, 2B AND 3**



Exterior view of **Dam Easy®**
Flood Barrier installed



Interior view of **Dam Easy®**
Flood Barrier installed

STEP 1A: POSITION A SINGLE BARRIER

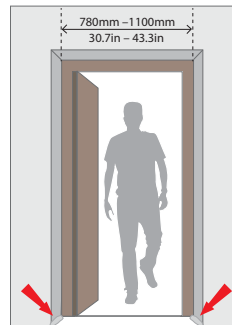

1A.1 Clear any dirt or debris from the doorstep and reveals. For an enhanced seal, double over filler to create a thick strip.

1A.2 Place filler at each corner of the doorstep in line with the barrier position

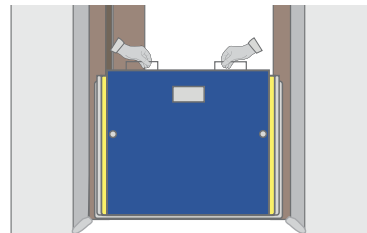
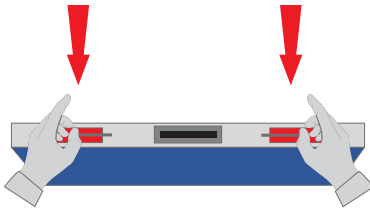

1A.3 Wearing gloves, remove the barrier from the reusable packaging. Help from another person may be needed to lift safely (lift only at the Lifting Handles marked)

1A.4 Position the barrier vertically, between the reveals in the centre of the doorway (Ratchet Handle facing inwards). Hold the Barrier firmly in place at the Lifting Handles until secure within the reveals



**CAUTION/
IMPORTANT**

Wear gloves while installing, removing and maintaining the barrier to avoid injury
Always hold the Barrier firmly at the lifting handles when not secure in a doorway

SECTION C: Installing the barrier(s)

STEP 2A: EXTENDING THE SIDE PANELS – SINGLE BARRIER

CAUTION: WEAR GLOVES TO PREVENT INJURY AT PINCH POINTS

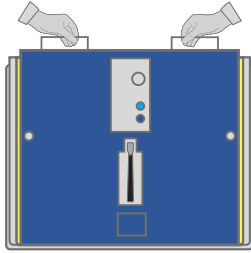

2A.1. Hold Barrier firmly in position, **pressing down** at Lifting Point

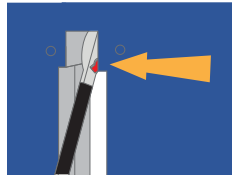

2A.2 Position the Direction Switch outwards on Ratchet Handle (towards user)

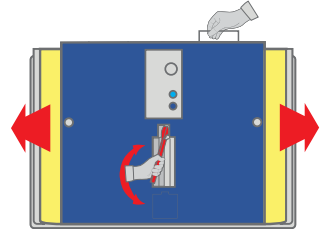

2A.3 Jack the Ratchet Handle to extend the Side Panels, continue until the Barrier is secure within reveals

NOTE: You must push down firmly on the barrier to ensure it is tight to the ground.

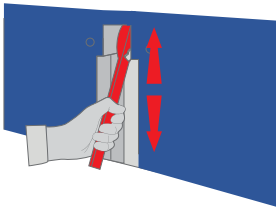

2A.4 Barrier is secure when resistance is felt on the Ratchet Handle, **check that no movement of the Barrier is possible** within the reveals. Return the Ratchet Handle to the vertical position

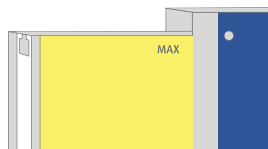

2A.5 'Max' extension is marked at the top of each side panel. If the barrier is not secure at this point, see Section H Troubleshooting



2A.6 Check that the door closes without interference. If there is interference, see Section H Troubleshooting

CONTINUE TO STEP 3, INFLATE THE SEAL



**CAUTION/
IMPORTANT**

The barrier must be secure at this point, to create watertight seal

SECTION C: Installing the barrier(s)

STEP 1B: POSITION EXTENSION POLE AND MULTIPLE BARRIERS

The **Dam Easy® Extension Pole** allows the use of multiple **Dam Easy® Flood Barriers** covering openings beyond 1.7m.67in wide. The installation **Dam Easy® Extension Pole** is undertaken in 2 stages:

- A BASE SOCKET/RECEIVER INSTALLATION** – A one-off installation to secure the base socket/receiver into the ground (tarmac or concrete). Please note Base Socket/Receiver installation will need to be carried out prior to proceeding with installation of multiple barriers.
- B POLE INSTALLATION** – A quick and simple instalation to fix the Extension Pole into the base socket/receiver.

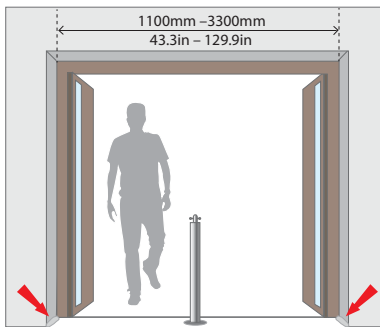

- 1B.1 Clear any dirt or debris from the doorstep and reveals. For an enhanced seal, double over filler to create a thick strip and place at each corner of the doorstep/reveals, in line with the barrier position. Filler is not needed at the extension pole (due to the inbuilt chamfer seals)

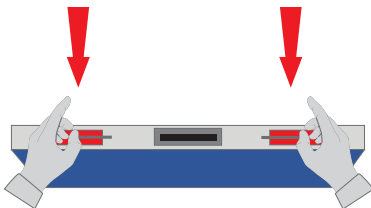

- 1B.2 Wearing gloves, remove the barriers one at a time from the reusable packaging. Hold the Barrier firmly in place at the Lifting handles until securely positioned

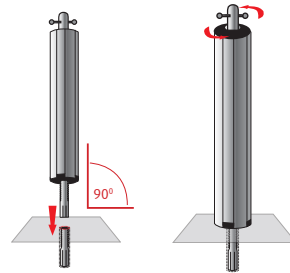

- 1B.2 Remove the lid of the base socket and insert all extension pole(s) into the fixed base(s). Ensure extension pole is at right angles to the ground. Slot into ground and twist/screw into position to create a watertight seal

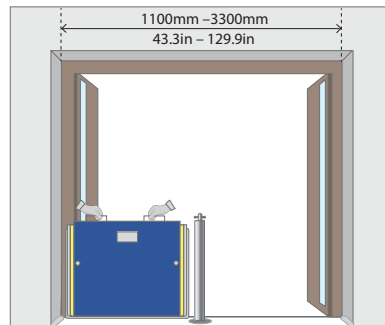

- 1B.3 Position the barriers vertically, between the reveal and extension pole or between 2 extension poles as relevant (Ratchet Handle facing inwards).



**CAUTION/
IMPORTANT**

Help from another person may be needed to lift safely,
lift only at the Lifting Handles marked

SECTION C: Installing the barrier(s)

STEP 2B: EXTENDING THE SIDE PANELS – MULTIPLE BARRIERS

CAUTION: WEAR GLOVES TO PREVENT INJURY AT PINCH POINTS

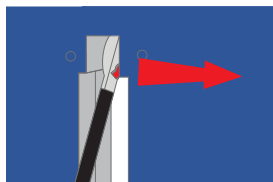

2B.1. Hold Barrier #1 firmly in position, pressing down at Lifting Point. Position the Direction Switch outwards on Ratchet Handle (towards user)

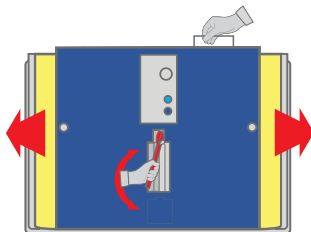

2B.2 Jack the Ratchet Handle to partially extend the Side Panels, until Barrier #1 stands upright in position within the guide rails of the extension pole(s), but no resistance is felt

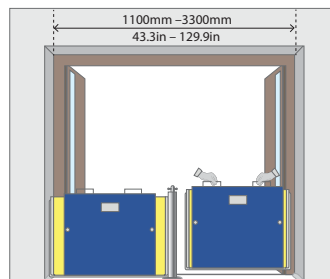

2B.3 Repeat positioning and partial extension of barrier #2, #3 etc. in series (1B.2, 1B.3, 2B1, 2B2)

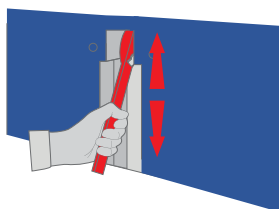

2B.4 Barrier is secure when resistance is felt on the Ratchet Handle, check that no movement of the Barrier is possible. Return the Ratchet Handle to the vertical position

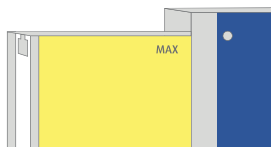

2B.5 'Max' extension is marked at the top of each side panel. If the barrier is not secure at this point, see Section H Troubleshooting

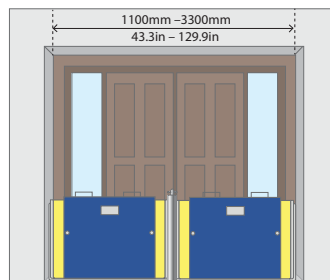

2B.6 Check that the door closes without interference. If there is interference, see Section H Troubleshooting

**CONTINUE TO STEP 3,
INFLATE THE SEAL**



**CAUTION/
IMPORTANT**

Gradually extend each barrier in series to achieve equalisation of pressure by each barrier for performance

SECTION C: Installing the barrier(s)

STEP 3: INFLATING THE SEAL

CAUTION: NEVER INFLATE THE SEAL IF BARRIER(S) NOT SECURE IN A DOORWAY

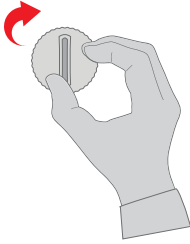

3.1 Open the Air Retention Switch (vertical position)

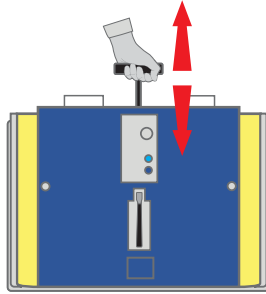

3.2 Inflate the Seal using the Pump Handle



3.3 Continue inflating until the Air Pressure Gauge is approx. 2 bar (green region). If the pressure does not increase, see Troubleshooting

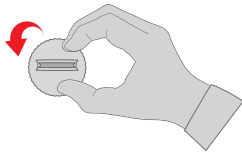

3.4 Close the Air Retention Switch (horizontal position), to avoid accidental deflation

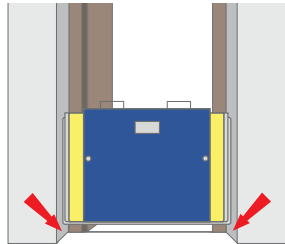

3.5 Check the level of the Barrier. Check that Barrier has not raised from doorstep and is firmly pressed down

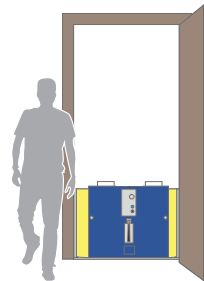

3.6 Repeat for each barrier for multiple barrier installations. Installation of the Barrier(s) is now complete and ready to protect the doorway from flood water.

3.7 **Check the Air Pressure Gauge at least every 2 hours initially, to ensure no drop in pressure.** A drop in pressure may indicate a problem, see Section H **Troubleshooting**



TOP TIP: To prevent accidental deflation of the seal or unauthorised removal of the barrier, optional accessory **Dam Easy®** lockable Security Cover is available for purchase

SECTION D: Removing the barrier(s)

Remove the barrier(s) only after flood water recedes and there is no risk of further flooding

CAUTION: FLOODWATER MAY BE CONTAMINATED, ALWAYS WEAR GLOVES AND EYE PROTECTION WHEN HANDLING ANYTHING THAT HAS COME INTO CONTACT WITH FLOOD WATER

STEP 1: DEFLATE THE SEAL

FOR MULTIPLE BARRIER INSTALLATIONS, DEFLATE EACH SEAL IN SERIES BEFORE CONTINUING TO STEP 2

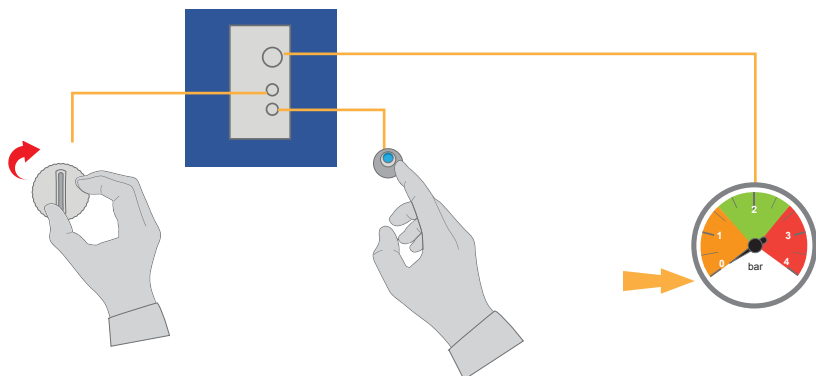

1.1 Open the Air Retention Switch (vertical position)

1.2 Press and hold the Air Release Valve to deflate the seal completely

1.3. The pressure gauge reads 0 bar when the Seal is completely deflated

STEP 2: RETRACT THE SIDE PANELS

CAUTION: WEAR GLOVES AND HOLD THE BARRIER(S) SECURELY AT THE Lifting handles TO AVOID INJURY AS THE SIDE PANELS RETRACT AND BARRIER IS NOT SECURED IN PLACE

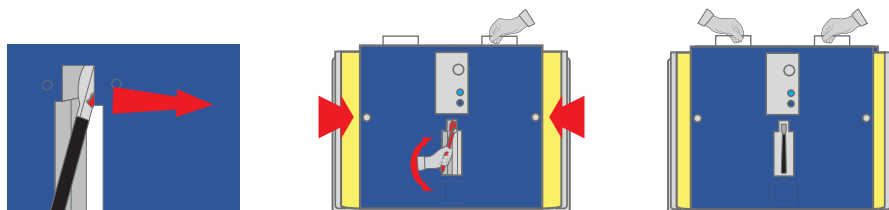

2.1 Position the Direction Switch on the Ratchet Handle inwards (away from the user)

2.2 Hold the barrier firmly at the lifting handles and jack the Ratchet Handle to retract the Side Panels

2.3 For multiple barrier installations, retract barrier #1, #2, etc gradually, in series to avoid excess pressure on the extension pole(s)

SECTION D: Removing the barrier(s)

STEP 3: REMOVE THE BARRIER(S)

BARRIER(S) HAS NOT BEEN IN CONTACT WITH FLOOD WATER, CONTINUE TO STEP 3.1

- 3.1 If the barrier(s) has not been in contact with flood water, hold securely at the lifting point and retract side panels fully (feel resistance on Ratchet Handle)
- 3.2 Carefully remove the barrier(s) and filler discard the filler
Continue to Section F Replacing the seal(s), followed by Section G Storing the barrier(s)

BARRIER(S) HAS BEEN IN CONTACT WITH FLOOD WATER, CONTINUE TO STEP 3.3

- 3.3 If the barrier(s) has been in contact with flood water, retract side panels sufficiently to remove the barrier(s) carefully from the doorway
- 3.2 Carefully remove the barrier(s) and filler Discard the filler
Continue to Section E Cleaning the barrier, followed by Section F Replacing the seal, followed by Section G Storing the barrier



CAUTION/ IMPORTANT

Help from another person may be needed to lift safely,
lift only at the Lifting Handles marked

SECTION E: Cleaning the barrier

If the Barrier has been in contact with flood water, thoroughly clean and dry before storage

STEP 1: EXTEND THE SIDE PANELS FULLY

- 1.1 Place the barrier upright against a solid surface and hold firmly at the lifting handles
- 1.2 Position the Direction Switch outwards on the Ratchet Handle (towards the user) and Jack the Ratchet Handle to extend the Side Panels to the 'max' position



STEP 2: REMOVE THE USED SEAL

- 2.1 See Section F Replacing the seal, Step 1 Remove used seal

STEP 3: CLEAN THE BARRIER

Do not allow any detergent or chemical to come into contact with the barrier

- 3.1 Rinse the barrier thoroughly with clean, fresh water to remove any debris, residue etc.
- 3.2 Allow to air dry completely

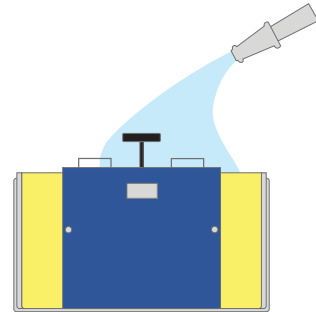

STEP 4: REPLACE THE SEAL

- 4.2 Fit Replacement Seal, see Section F, Step 2 Fitting replacement seal
- 4.3 Fully retract side panels using the Ratchet Handle
- 4.3 Continue to Section G, Storing the barrier



**CAUTION/
IMPORTANT**

Floodwater may be contaminated – use gloves and eye protection. Do not use any detergents or chemicals to clean the barrier, they may damage the seal

SECTION F: Replacing the seal

The Inflatable seal is critical to creating a watertight seal on the **Dam Easy® Flood Barrier**.

The seal is attached to the Barrier at 3 quick release points;

- 2 T-Clips on either end of the seal, secured on top of each side panel of the barrier, labelled 'A'
- A valve in the centre of the seal, labelled 'B', attached by a Quick Release Fitting, accessible from the Seal Replacement Access Panel

1 replacement seal is included in the Flood Barrier Kit, labelled 'C', additional replacement seals are available for purchase online www.dameasyfloodbarriers.com

To avoid accidentally damaging the seal;

- Store the barrier in the original packaging out of direct sunlight and extremes of temperature
- Always place the barrier on a smooth even surface
- Do not inflate the seal unless the barrier is secure in a doorway
- Do not remove the replacement seal from the packaging before use
- Do not use any tools while replacing the seal

WHEN TO REPLACE THE SEAL

To guarantee a watertight seal, **Dam Easy®** recommends replacing the Seal before storing the barrier;

- If there is an indication that the seal is damaged and/or is not capable of sustaining the required air pressure when correctly installed in a suitable doorway
- Every 12 months, whether or not the barrier has been in use in a doorway
- Immediately after use in a doorway, when the barrier has been in contact with flood water

A



B



C



TOP TIP: Avoid damaging the seal by always placing the barrier on a smooth, even surface when not installed in a doorway, and store in the original packaging

SECTION F: Replacing the seal

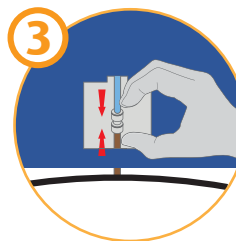
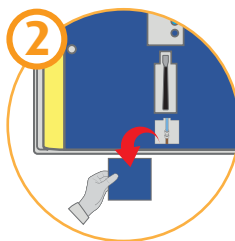
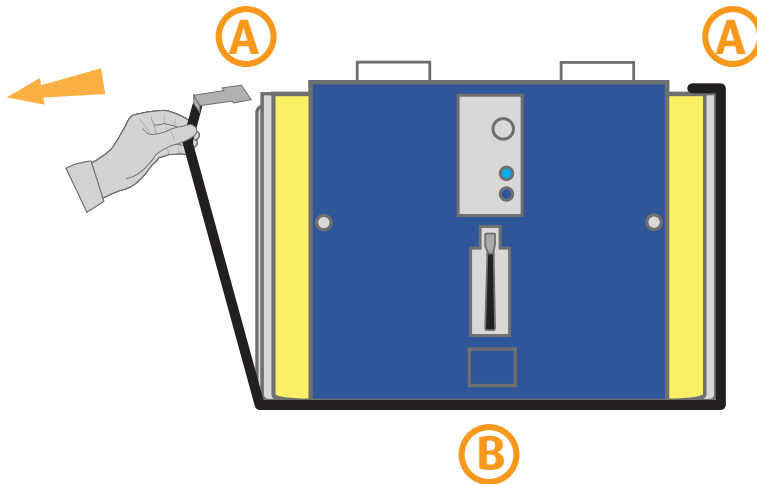

STEP 1: REMOVE USED SEAL



CAUTION/ IMPORTANT

Ensure Seal is deflated and Side Panels extended sufficiently so T-Clips are fully visible on the top of the barrier before removing the seal



Place the barrier flat on a smooth, even surface to safely remove the used seal

1. Lift the Seal at both ends to release the T-Clip on the top of each Side Panel (A)
2. Open the Seal Replacement Panel
3. Decompress the Quick Release Fitting to fully release the Seal (B)
4. Remove seal completely from beneath the barrier, segregate materials and recycle at a registered recycling facility

SECTION F: Replacing the seal

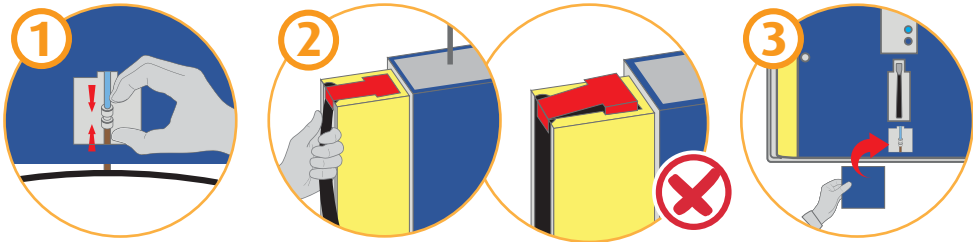
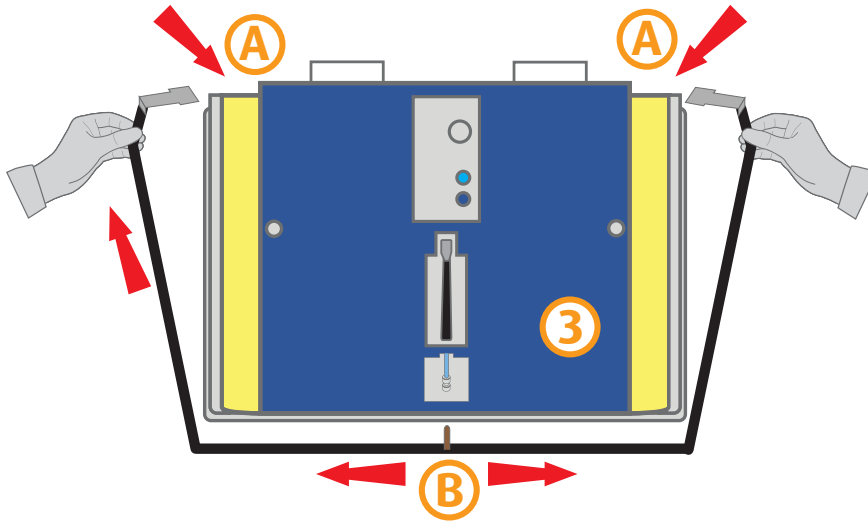

STEP 2: FITTING REPLACEMENT SEAL



CAUTION/ IMPORTANT

Do not remove the replacement seal from packaging until immediately before replacement

Place the barrier flat on a smooth, even surface to safely replace the seal

1. Insert the Seal Valve at the centre of the seal into the opening on the underside of the barrier **B** and carefully secure to the inflation mechanism by compressing the Quick Release Fitting within the Seal Replacement Panel.
2. From the centre, run the Seal along the recess on the underside and along the edge of the side panels, do not twist the seal. Click both ends into place **A**
3. The T-Clips must be flush at the top of each Side Panel
4. Replace Seal Replacement Panel cover. The barrier is now ready for storage.

CONTINUE TO SECTION G, STORING THE BARRIER

SECTION G: Storing the barrier

STORING THE BARRIER

The barrier and all other parts of the kit must be dry and the side panels fully retracted before storing in the original packaging.

CAUTION: Take care when lifting, help may be required

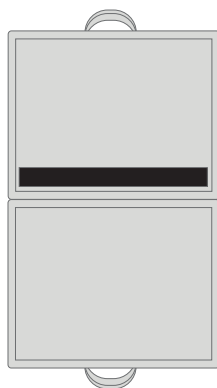

1. Open the zip on the bag completely and place the long Storage Protector at the base of the bag

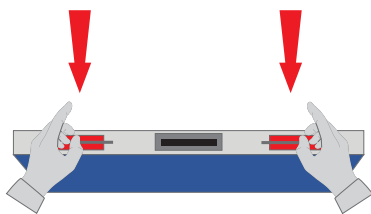

2. At the lifting handles marked, carefully lift the barrier into the bag on top of the Corner Protectors

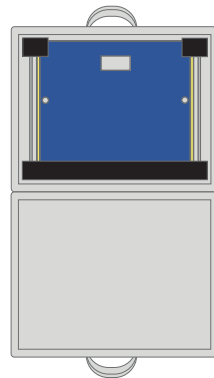

3. Place 2 Corner Protectors on the top corners of the barrier and zip the bag around the barrier



4. Place Filler, Replacement Seal and Instruction Manual into the bag

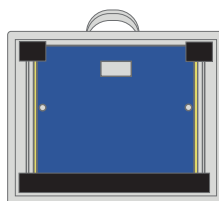

5. Store upright on a smooth surface, in a cool place out of direct sunlight and extremes of temperature



TOP TIP: Retain the corner protectors for future use to safely store the barrier in the reusable bag

SECTION H: Troubleshooting

Problem	Possible Cause(s)	Solution
Barrier is not secure at maximum extension	1. Reveal width is >1100mm	1. The doorway is not suitable for a single barrier flood protection. Consider purchasing an extension system
	2. Reveals are not smooth/solid/parallel	2. Repair imperfections on the surface of the reveals
Interference from door closing	1. Reveal depth is <75mm / 3in	1. The reveals are not suitable for a Dam Easy flood barrier protection.
	2. Barrier is positioned too close to the closed door	2. Reposition the barrier within the reveals further from the door, and repeat barrier installation
	3. Protruding door furniture is causing interference	3. Reposition the barrier within the reveals further from the door or remove the door furniture and repeat barrier installation
Barrier rises when seal is inflated	The barrier is not sufficiently secured in the doorway	Deflate the seal and repeat the installation, pressing down on the lifting handles while extending the side panels
Seal does not inflate OR the air pressure is not maintained at 2bar	1. The connection to the pump mechanism is loose & leaking air	1. Release the seal from the quick release valve within the Seal Replacement Panel and reconnect with care
	2. The seal is punctured	2. If there is no flood water in contact with the barrier, remove the barrier and replace the seal. If flood water is present, do not remove the barrier
Cannot replace the ratchet handle into the starting position	The direction switch is toggled in the wrong direction to allow the handle to move in the desired direction	Manipulate the direction switch and ratchet handle simultaneously
Cannot move the direction switch on the ratchet handle	Position of the handle is preventing the toggle on the direction switch	Jack the ratchet handle and simultaneously manipulate the direction switch
Pump handle is stiff	Needs lubrication	Apply general use lubricant

For further information and demonstrations, please visit:

www.dameasyfloodbarriers.com

SECTION I: Accessories

FLOOD PROTECTION SOLUTIONS For Your Home

LEVELS OF FLOODING



Below
2 in/50mm



**Above 2 in/50mm
& Below
27.5in/700mm**



Extension Pole

For use with the
Dam Easy® Flood Barrier



The **Dam Easy®** Extension Pole allows the use of multiple barriers covering openings from 1660mm/63in to widths beyond 3000mm/118in.

Base socket installation in ground required before Extension Pole can be fixed in place.



Security Cover

For use with the
Dam Easy® Flood Barrier



Security cover is available to purchase for added security, to prevent tampering and removal of the barrier.



Vent Cover **Snorkelvent™**

310mm/12.2in & 450mm/17.7in

A Snorkel for your home
The most effective and simple solution available



Snorkel Vent™ is a simple, affordable and effective device to give you permanent flood protection, without having to close a flap or fit a cover.



Patch It

Prevents flood water
entering exterior openings



A rubber based high performance strip sealant used to patch external openings susceptible to water entering during flooding.

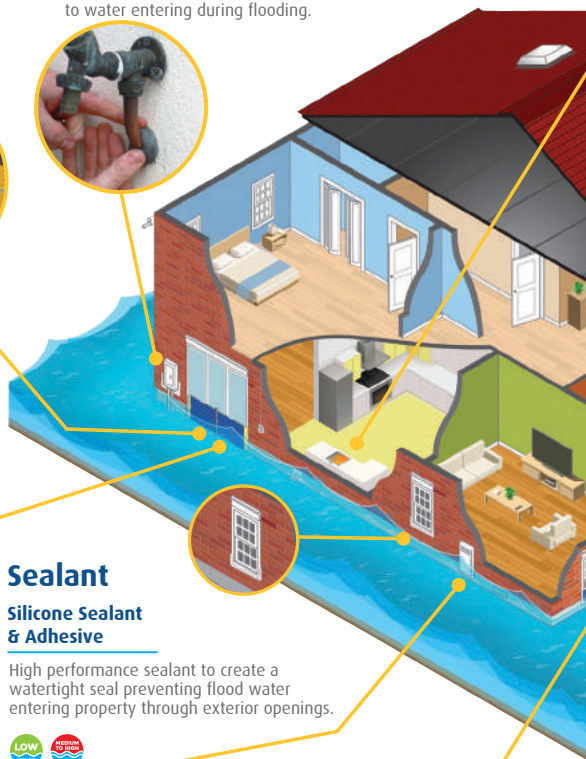

Sealant

Silicone Sealant & Adhesive

High performance sealant to create a watertight seal preventing flood water entering property through exterior openings.



HydroSack®

Sandless bag solution for temporary
protection against low level flooding



The **HydroSack®** is a highly effective, modern method to create a barrier to the threat of flood water in domestic and commercial properties. Each **HydroSack®** unit absorbs up to 20 litres of water. **HydroSack®** is activated with fresh water (not salt water).



Activate with WET

SECTION I: Accessories

HydroPack®

Sandless bag solution for temporary protection against low level flooding

The **HydroPack®** is a highly effective, modern method to create a barrier to the threat of flood water in domestic and commercial properties. Each unit absorbs up to 15 litres of water. **HydroPack®** is activated with fresh water (not salt water).



Replacement Seal

For use with the Dam Easy® Flood Barrier

We recommend that the inflatable seal is replaced after use or every 12 months.

ACCESSORY



HydroSnake®

Sandless bag solution for temporary protection against low level flooding

The **HydroSnake®** is a highly effective, modern method to create a barrier to the threat of flood water in domestic and commercial properties. Each **HydroSnake®** unit absorbs up to 20 litres of water. **HydroSnake®** is activated with fresh water (not salt water).



Shower Stack

Protection for downstairs shower and baths during flooding

The **Dam Easy® Shower Stack** protects downstairs Showers or Baths from flood ingress through the waste pipes.



Toilet Dam

Prevents water rising through toilets during flooding
(Suitable for most makes and models)

The **Dam Easy® Toilet Dam** is an effective tool for blocking any width or shape of toilet pan against sewage backflow during a flood.



Dam Easy® Flood Barrier

Protection for exterior openings from flood water up to 600mm/23.6in high

The **Dam Easy® Flood Barrier** is a unique domestic and commercial flood barrier which creates a watertight seal around the door reveal when installed. Suitable for fitting within smooth door reveals from 780mm to 1100mm / 30.7in to 43.3in.

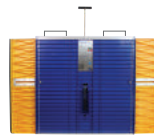

Dam Easy® Flood Barrier expanded position

THE WORLD'S FIRST OFF-THE-SHELF FLOOD DEFENCE SYSTEM WITHOUT FIXINGS & WITH AN INFLATABLE SEAL (PATENTED)

SECTION J: Warranty & Disclaimer

This warranty & disclaimer explicitly forms part of All Weather Industries Limited's terms and conditions of sale.

Disclaimer: Flood water can enter properties through other access points, all such access points in any property must be controlled to prevent flood damage. See www.dameasyfloodbarriers.com for other products supplied by All Weather Industries.

CAUTION: points highlight risks to injury and damage to the equipment

Warranty: All Weather Industries warranty covers defective materials or workmanship for 12 months from the date of purchase, we will replace any barrier found to be defective within 12 months of date of purchase

Purchase must be registered on-line to avail of the **1 year guarantee**

- Exclusions from warranty
- If the barrier has been altered in any way
- If the safety seal has been damaged on any screws
- If any tool has come into contact with the barrier (tamper proof screws)

Our liability to you: All Weather Industries will make all reasonable efforts to ensure that all Dam Easy Flood Barriers will correspond with their relevant description and that they will be of satisfactory quality and fit for the purpose which they are sold. Except as expressly set out in this

instruction manual All Weather Industries Limited does not make any other representations or warranties about the Flood Barrier.

Save in the case of death or personal injury caused by All Weather Industries Limited's negligence or where All Weather Industries has acted fraudulently, All Weather Industries Limited's liability to you for any direct damages suffered by you will never exceed the amount you paid for the Flood Barrier.

In no event shall All Weather Industries Limited its directors, employees, shareholders, agents or subcontractors be liable to you for indirect, incidental, consequential, special or exemplary damages.

All Weather Industries Limited accepts no responsibility for any loss or damage caused by All Weather Industries Limited [or all All Weather Industries Limited's employees, agents or subcontractors] where such loss is [a] not a foreseeable result to you and All Weather Industries Limited [as at the time that you submit your order] of a breach of the relevant legal duty by All Weather Industries Limited [b] related to a business; or [c] related to loss or damage to premises or property unless caused by All Weather Industries' gross negligence or willful misconduct.

The above limitations on All Weather Industries Liability do not affect your non-excludable statutory rights as a consumer.



This product meets European Flood Protection Association Requirements

SECTION K: End of Life Disposal

Depending on the amount of usage, the substances present in the flood water, and the care and attention given to the barrier, it may have to be replaced at some stage in the future.



The **Dam Easy®** Flood Barrier
is 100% Recyclable

Metallic and plastic parts should be separated and taken to a registered recycling center.
In the event of difficulty with disposal, contact All Weather Industries directly.

MODEL: DME01

Due to a policy of continuous improvement
the product may differ from images shown.

Designed and engineered by All Weather
Industries Ireland. Manufactured in China
and Germany. Assembled in Ireland.



CE marked in
accordance with
the 2006/42/EC
The Machinery Directive



**PLEASE
RECYCLE**

Instruction Manual printed in Ireland.



Manufactured by All Weather Industries. All Weather Industries Ltd. retain all intellectual property rights to the Dam Easy® product design, trademark and all marketing/distribution rights.

www.dameasyfloodbarriers.com

Copyright © 2018. All Weather Industries Ltd. All rights reserved. Reproduction and distribution of any material contained herein is strictly prohibited. No part of this communication may be reproduced, distributed or transmitted in any form or by any means including photocopying or electronic methods without the prior written permission of All Weather Industries Ltd. All Weather Industries Ltd. retain all intellectual property rights to the Dam Easy® product range design, trademark, and all marketing/distribution rights. Dam Easy Flood Barriers® is a registered trademark of All Weather Industries Ltd. SnorkelVent™ is a registered trademark of Gravitass (International) Ltd. HydroPack® HydroSack® and HydroSnake® are registered trademarks of Donite Plastics Ltd.



DAM EASY[®] FLOOD BARRIERS

说明书

助您轻松防洪



 无需工具

 无需
固定件

 无需硅胶
粘接剂

 无需打孔

目录

单元A：了解防洪挡板 第4页

单元B：安全须知 第6页

单元C：安装防洪挡板 第7页

单元D：拆除防洪挡板 第12页

单元E：清洁防洪挡板 第14页

单元F：更换密封圈 第15页

单元G：存放防洪挡板 第18页

单元H：故障排除 第19页

单元I：配件 第20页

单元J：保修和免责声明 第22页

单元K：报废处置 第23页

本说明书包含正确安装、拆除、维护和存放
Dam Easy®防洪挡板的所有必要信息。
演示视频请参见www.dameasyfloodbarriers.com。

购买后30天内登录www.dameasyfloodbarriers.com
注册您的防洪挡板，即可享受12个月的保修



正确/该做



小心/重要



错误/不该做



重要提示



本产品符合
欧洲防洪协会
的要求



所含物品：



Dam Easy防洪挡板 1块



说明书 1本



贴片 4份



备用密封圈 1件



存放用防护件 3件



可重复使用的储藏袋 1件

DAM EASY[®] FLOOD BARRIERS

F助您轻松防洪

感谢您购买Dam Easy[®]防洪挡板

由于人们饱受洪灾威胁，在市面上又找不到有效的解决方案，All Weather Industries由此设计了这款Dam Easy[®]防洪挡板。

Dam Easy[®]防洪挡板可为门道提供临时防洪保护。

工作原理

- 在合适的门道内，Dam Easy[®]防洪挡板能够在780毫米 - 1100毫米宽的门侧内延伸至紧紧贴合
- 为独特的专利充气式密封圈充气，短短几秒钟即可形成防水密封

Dam Easy[®]防洪挡板的特性包括：

- ✓ 独特的充气式密封圈 (已获专利)
- ✓ 安装简单快捷，无需工具或专业技能
- ✓ 不使用损坏门道且影响美观的固定件
- ✓ 可在不同的门道/房屋中重复使用
- ✓ 支持延伸，能够在各种尺寸的门道中安装
- ✓ 经过独立测试及认证，获得EFPA/EVH和CE标志，品质让人放心。

3步轻松完成安装

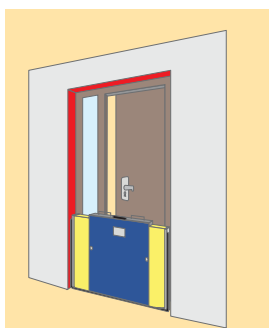

1

置于
门侧内

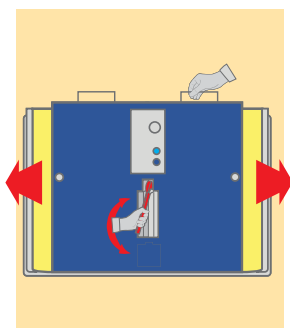

2

伸开
侧面板

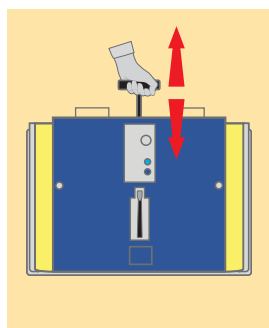

3

为密封圈
充气



无需工具



无需
固定件



无需硅胶
粘接剂



无需打孔

单元A：了解防洪挡板

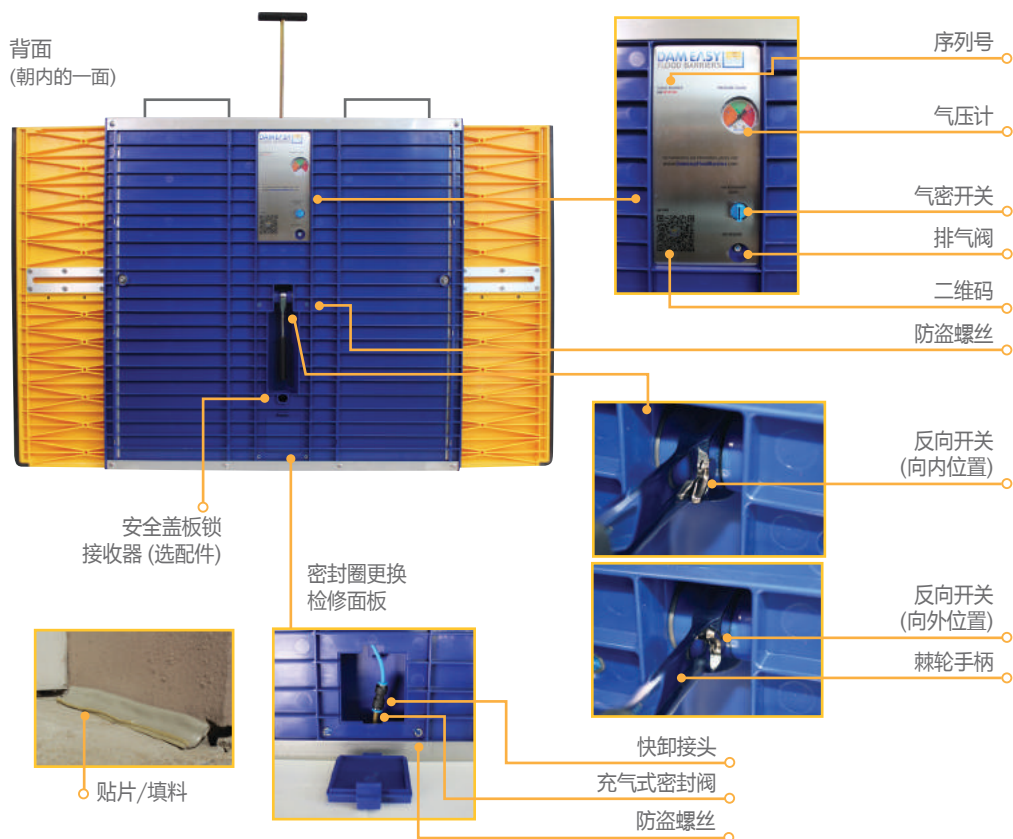

单元A：了解防洪挡板

防洪挡板技术规格

如果安装正确，Dam Easy®防洪挡板可在合适外部门道的门侧内形成防水密封，防洪深度可达600毫米/23.6英寸

每块挡板包括：

- 一块固定的中心面板和两块可伸开的侧面板 (通过带反向开关的棘轮手柄进行控制)，可调整至合适门道的宽度
- 一个连接到泵机构 (带内置气压计) 的充气式密封圈，可围绕伸开后的挡板形成防水密封

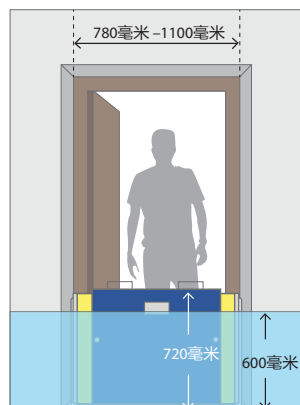

⚠️ 小心

建议不要在门框 (木制、铝制等) 内安装挡板，仅可安装在坚固的门侧内。

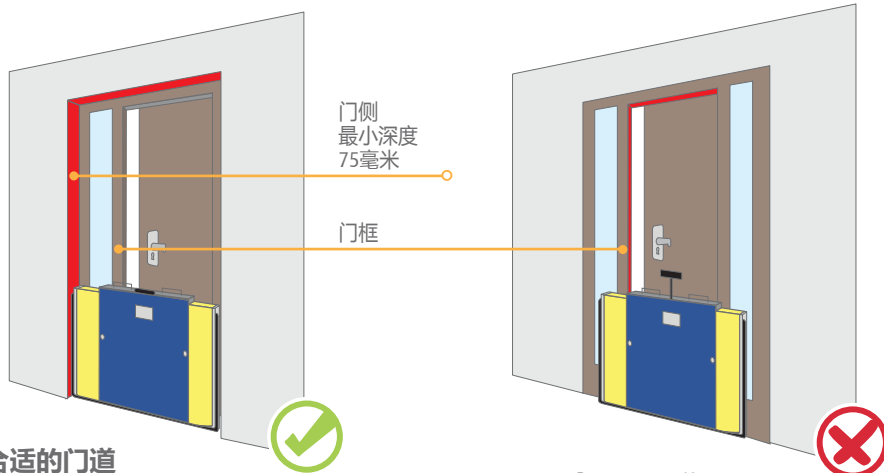

合适的门道

要形成防水密封并留出间隙来关门，门侧必须光滑、坚固、垂直和平行，最小尺寸如下：

- 宽度780 - 1100毫米 (单块挡板)
- 宽度>1100毫米 (多块挡板)
- 高度720毫米
- 深度75毫米 (安装单块挡板)
- 深度120毫米 (安装多块挡板)

门阶必须光滑、坚固且水平，并与门侧成直角

不合适的门道

- 门侧深度小于75毫米
- 门框与外墙齐平
- 门侧不平行
- 门侧表面不平整



重要提示：对于1100毫米以上宽度的门侧，Dam Easy®延伸系统适用于串接多块挡板，更多细节请参见www.dameasyfloodbarriers.com

单元B：安全须知

请仔细阅读

❗ 基本安全注意事项

- 该挡板经设计安装在合适门道的外门侧内。请参见单元A“防洪挡板技术规格”，了解关于合适门道的描述
- 关于防洪挡板的安装、拆除、维护和存放，请遵循本说明书中的具体说明，并妥善保管以备将来使用（可从 www.dameasyfloodbarriers.com 下载）
- 挡板重达19.7千克，抬起时务必小心——可能需要2人才能安全抬起挡板
- 洪水来临前，在需要防洪的门道中完成挡板的全面试装
- 洪水可能受到污染，如果挡板曾与洪水接触，请务必戴上手套和护目用具，仔细清洁并彻底擦干挡板
- 清除门侧内的污垢和碎屑，并修复任何裂缝或损坏，以确保防水密封
- 洪水可能从其他入口进入房屋，请参见单元“配件”了解其他防洪产品并寻求专业建议，以便为您的房屋提供适当保护
- 按照指示将挡板存放在原始包装中，避免阳光直射和极端温度

当挡板“正在使用”时 (安装、拆除、维护和存放)

✅ 该做

- 仔细遵循这些说明，参见 www.dameasyfloodbarriers.com 上提供的在线演示视频
- 戴上手套，以防夹伤以及洪水弄脏双手
- 只能通过所示的把手抬起挡板，以免其受损
- 若有发生洪水的危险，装好挡板后应定期监测气压
- 为避免损坏充气式密封圈，**应始终将挡板放在平整的表面上**

❌ 不该做

- 不要在安装、拆除、维护或清洁挡板期间使用任何工具。使用工具会损坏密封圈，将导致保修失效
- 不要将挡板安装在门框中，门侧与门框之间不能保证防水密封
- **不要通过泵柄抬起挡板**
- 当挡板未在门道中固定好时，切勿对密封圈充气
- 在门道中装好挡板后，不要对密封圈排气或收回侧面板，直至洪水退去为止
- 不要让任何清洁剂或化学品接触到挡板

单元C：安装挡板

若要安装单块挡板，
请遵循步骤1A、2A和3

若要安装多块挡板，
请遵循步骤1B、2B和3

步骤1A：放置单块挡板



- 1A.1 清除门阶和门侧内的任何污垢或碎屑。
为了增强密封效果，加倍使用填料以
增厚密封条带。

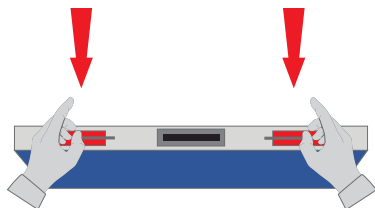

- 1A.3 戴上手套，从可重复使用的包装中取出
挡板。要安全抬起挡板，可能需要他人
协助（仅可通过标记的把手抬起）



Dam Easy®防洪挡板
安装效果外视图



Dam Easy®防洪挡板
安装效果内视图

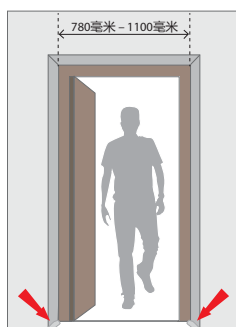

- 1A.2 将填料放在门阶的两角，并与挡板位置
对齐

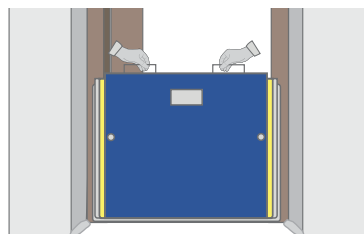

- 1A.4 将挡板竖直地放置在门侧之间的门道中心
(棘轮手柄面朝内)。紧握挡板把手，直到
其在门侧内稳固



小心/重要

安装、拆除和维护挡板时应戴上手套，以免受伤
挡板尚未在门道中稳固时，应始终紧握挡板把手

单元C：安装挡板

步骤2A：伸开侧面板 —— 单块挡板

小心：戴上手套，以免夹伤

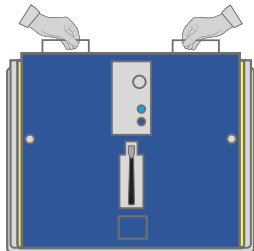

2A.1. 紧握挡板，在抬起点
向下按压

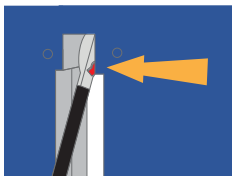

2A.2 将棘轮手柄上的方向开关调到
向外位置 (朝向用户)

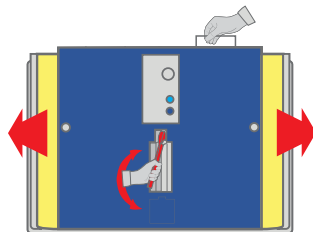

2A.3 摇起棘轮手柄以伸开侧面板，
直到挡板在门侧内稳固



注意：必须用力向下按压挡
板，以确保其紧贴地面。

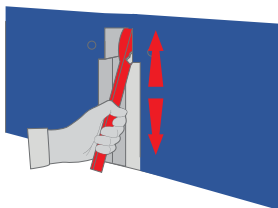

2A.4 当操作棘轮手柄感受到阻
力时，说明挡板稳固，**检
查并确认挡板在门侧内无
法移动**。将棘轮手柄调回
垂直位置

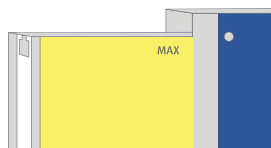

2A.5 每个侧面板顶部均标有
“Max” 延伸标记。如果此
时挡板不稳固，请参见单
元H “故障排除”



2A.6 检查并确认
关门时不受干扰。
如果有干扰，请参见
单元H “故障排除”

继续执行步骤3，
为密封圈充气



小心/重要

此时挡板必须稳固，以形成防水密封

步骤1B：放置延伸杆和多块挡板

Dam Easy®延伸杆支持拼接多块Dam Easy®防洪挡板，可阻挡开口宽度超过1.7米的洪水。

Dam Easy®延伸杆的安装分为2个阶段：

- Ⓐ **底座插口/接收器安装** - 将底座插口/接收器固定到地面（柏油路或混凝土），一次性完成。请注意，在安装多块挡板前，必须先安装底座插口/接收器。
- Ⓑ **延伸杆安装** —— 将延伸杆固定到底座插口/接收器中，整个过程快速简单。

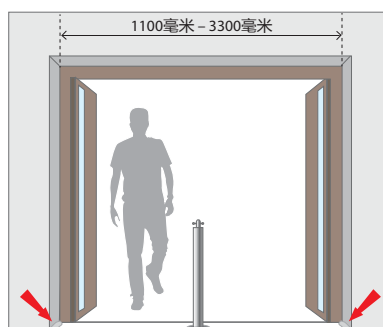

- 1B.1 清除门阶和门侧内的任何污垢或碎屑。为增强密封效果，加倍使用填料以增厚密封条带，并置于门阶/门侧的两角，使其与挡板位置对齐。由于内置倒角密封，延伸杆不需要使用填料

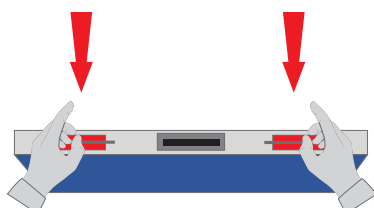

- 1B.2 戴上手套，每次从可重复使用的包装中取出一块挡板。握紧挡板把手，直到挡板稳固就位

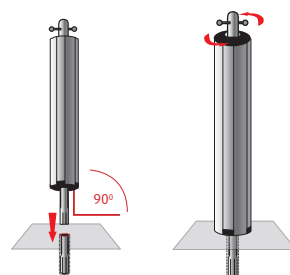

- 1B.2 取下底座插口的盖子，将所有延伸杆插入固定的底座中。确保延伸杆与地面成直角。插入地面并扭转/拧动就位，以形成防水密封

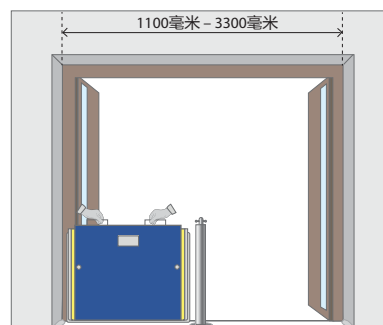

- 1B.3 在门侧与延伸杆之间或2根相关的延伸杆之间竖直放置挡板（棘轮手柄面朝内）。



小心/重要

要安全抬起挡板，可能需要他人协助，仅可通过标记的把手抬起

单元C：安装挡板

步骤2B：伸开侧面板 —— 多块挡板

小心：戴上手套，以免夹伤

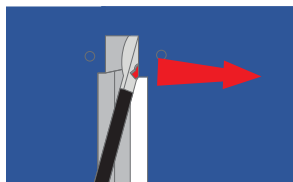

2B.1 紧握挡板1，在抬起点向下按压。将棘轮手柄上的方向开关调到向外位置（朝向用户）

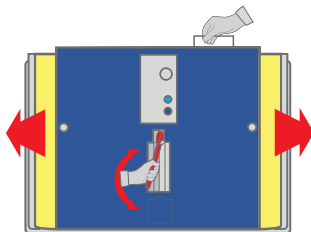

2B.2 摇起棘轮手柄，以部分伸开侧面板，直到挡板1直立在延伸杆的导轨内，但感受不到阻力

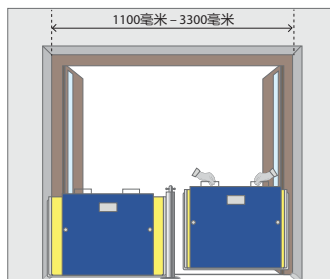

2B.3 重复放置操作，并依次部分伸开挡板2、挡板3等（1B.2、1B.3、2B1、2B2）

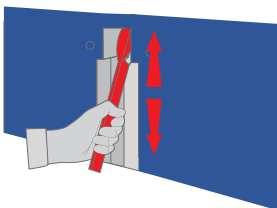

2B.4 当操作棘轮手柄感受到阻力时，说明挡板稳固，检查并确认挡板无法移动。将棘轮手柄调回垂直位置



2B.5 每个侧面板顶部均标有“Max”延伸标记。如果此时挡板不稳固，请参见单元H “故障排除”

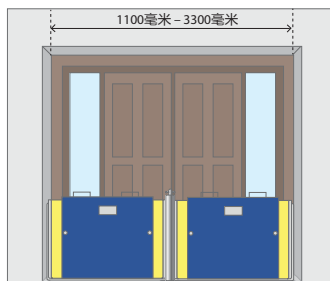

2B.6 检查并确认关门时不受干扰。
如果有干扰，请参见单元H “故障排除”

**继续执行步骤3，
为密封圈充气**



小心/重要

依次逐渐伸开每块挡板，使得压力均匀分散，确保挡板性能良好

步骤3：为密封圈充气

小心：当挡板未在门道中固定好时，切勿为密封圈充气

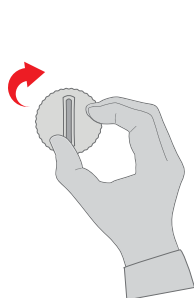

3.1 打开气密开关 (垂直位置)

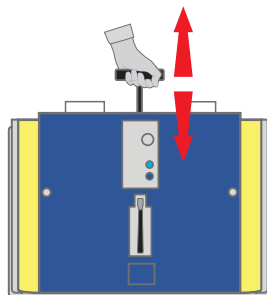

3.2 使用泵柄对密封圈充气



3.3 继续充气，直到气压计读数达到约2 bar (绿色区域)。如果气压不增大，请参见“故障排除”

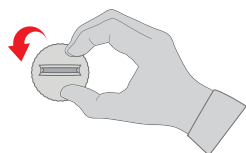

3.4 关闭气密开关 (水平位置)，以免意外放气

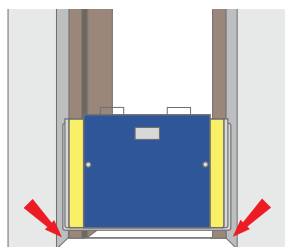

3.5 检查挡板的水平度。检查并确认挡板没有抬高门阶，而是被紧紧按下

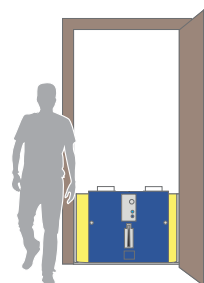

3.6 安装多块挡板时，对每块挡板重复这一操作。挡板现已装好，可随时阻止洪水从门道进入。

3.7 开始时至少每2小时检查一次气压计，确保没有出现压降。

出现压降表明可能存在问题，请参见单元H“故障排除”



重要提示：为防止密封圈意外漏气或未经许可拆除挡板，可购买Dam Easy®可锁定安全盖板(选配件)

单元D：拆除挡板

只有在洪水退去且不存在后续洪涝威胁的情况下，才可拆除挡板

小心：洪水可能受到污染，处理任何与洪水接触的物品时，一定要戴上手套和护目用具

步骤1：为密封圈排气

如果安装过多块挡板，先依次为每个密封圈排气，然后继续执行步骤2

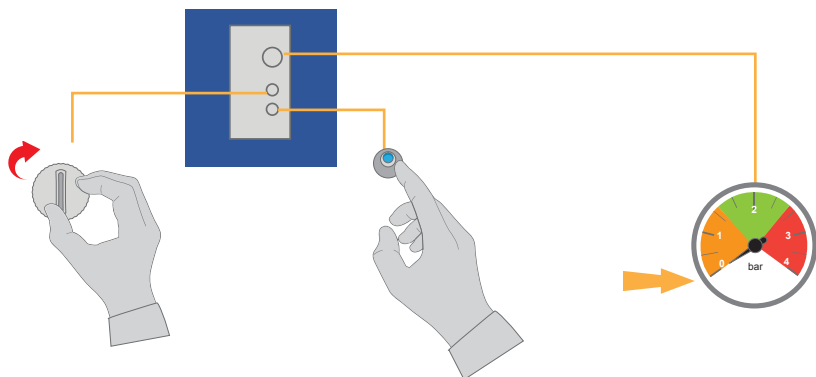

1.1 打开气密开关
(垂直位置)

1.2 按下并按住排气阀，使密封圈
完全排气

1.3 当密封圈完全排气后，
压力计读数为0 bar

步骤2：收回侧面板

小心：戴上手套并牢牢握住挡板把手，以避免由于侧板收回以及挡板没有固定到位而导致受伤

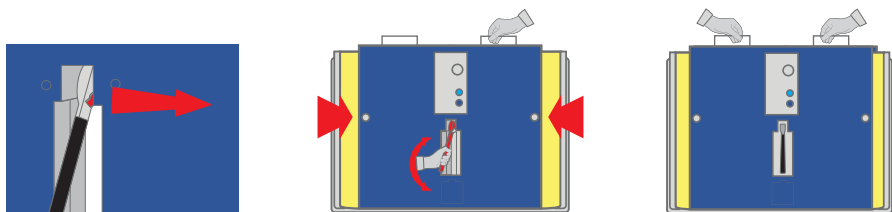

2.1 将棘轮手柄上的方向
开关调到向内位置 (远
离用户)

2.2 紧握挡板把手，并将棘轮
手柄摇起，以收回侧面板

2.3 如果安装过多块挡板，
则依次逐渐收回挡板1、
挡板2等，以避免延伸杆
承受过大压力

步骤3：拆除挡板

如果挡板未曾接触过洪水，继续执行步骤3.1

- 3.1 如果挡板未曾接触过洪水，则牢牢抓住抬起点并完全收回侧面板（操作棘轮手柄感受到阻力）
- 3.2 小心地拆除挡板和填料，并丢弃填料继续执行单元F“更换密封圈”，然后是单元G“存放挡板”

如果挡板曾接触过洪水，继续执行步骤3.3

- 3.3 如果挡板曾接触过洪水，则充分收回侧面板，小心地从门道拆除挡板
- 3.2 小心地拆除挡板和填料，并丢弃填料继续单元E“清洁挡板”，然后是单元F“更换密封圈”，最后是单元G“存放挡板”



小心/重要

要安全抬起挡板，可能需要他人协助，仅可通过标记的把手抬起

单元E：清洁挡板

如果挡板曾接触过洪水，存放前要彻底清洁和干燥

步骤1：完全伸开侧面板

- 1.1 将挡板直立放置在坚固表面上，并紧握把手
- 1.2 将棘轮手柄上的方向开关调到向外位置（朝向用户），并摇起棘轮手柄，将侧面板延伸至“MAX”位置



步骤2：拆卸用过的密封圈

- 2.1 请参见单元F“更换密封圈”中的步骤1“拆卸用过的密封圈”

步骤3：清洁挡板

不要让任何清洁剂或化学品接触到挡板

- 3.1 用干净的淡水彻底冲洗挡板，以清除任何碎片、残渣等
- 3.2 将挡板完全晾干

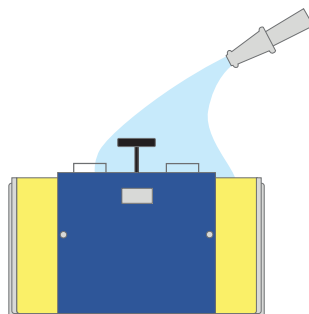

步骤4：更换密封圈

- 4.2 安装备用密封圈，请参见单元F的步骤2“安装备用密封圈”
- 4.3 使用棘轮手柄完全收回侧面板
- 4.3 继续执行单元G“存放挡板”



小心/重要

洪水可能受到污染 - 戴上手套和护目用具。不要使用任何清洁剂或化学品来清洁挡板，它们可能会损坏密封圈

单元F：更换密封圈

充气式密封圈能在Dam Easy®防洪挡板上形成防水密封，起到非常重要的作用。

密封圈通过3个快卸点安装至挡板：

- 密封圈两端各有1个T形夹，固定在挡板的每个侧面板顶部，标记为“A”
- 密封圈中间有一个阀（标记为“B”），其通过快卸接头连接，可从密封件更换检修面板触及

防洪挡板套件包含1个备用密封圈（标记为“C”），如需更多备用密封圈，请登录 www.dameasyfloodbarriers.com 在线购买

为避免密封圈意外损坏：

- 请将挡板存放在原始包装中，避免阳光直射和极端温度条件
- 始终将挡板放置在光滑平整的表面上
- 不要对密封圈充气，除非挡板在门道中固定好
- 如果不使用，则不要从包装中取出备用密封圈
- 更换密封圈时，不要使用任何工具

何时更换密封圈

为保证防水密封，Dam Easy®建议按以下要求更换密封圈，随后再存放挡板：

- 如果有迹象表明密封圈损坏，和/或正确安装在合适门道后无法维持所需的气压
- 每12个月更换一次，无论挡板是否在门道中使用过
- 如果挡板曾接触过洪水，在门道中使用后立即更换

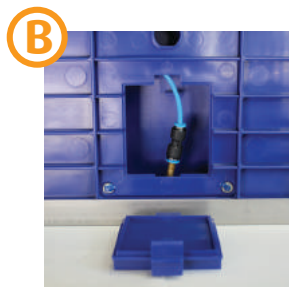

重要提示： 当未安装在门道中时，务必将挡板放在光滑平整的表面上，并存放在原始包装内，以免损坏密封圈

单元F：更换密封圈

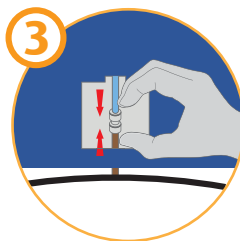
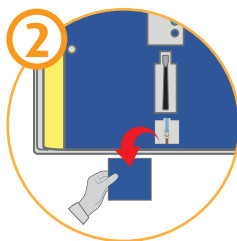
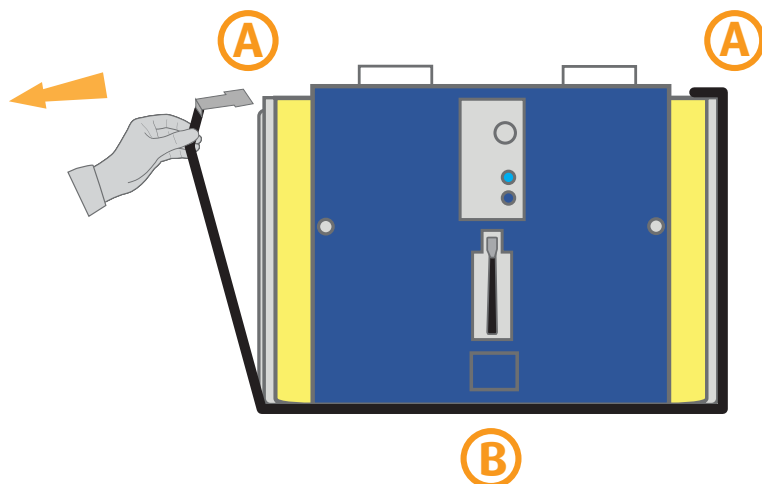

步骤1：拆除用过的密封圈



确保密封圈已排气且侧面板充分伸开，使得T形夹在挡板顶部完全可见，然后再拆卸密封圈



将挡板平放在光滑平整的表面上，以便安全拆卸用过的密封圈

1. 从两端提起密封圈，以释放每个侧面板顶部的T形夹 **A**
2. 打开密封圈更换面板
3. 拨下快卸接头，以便充分释放密封圈 **B**
4. 从挡板下方完全拆下密封圈，将材料分离，并送至登记在册的回收站进行回收

单元F：更换密封圈

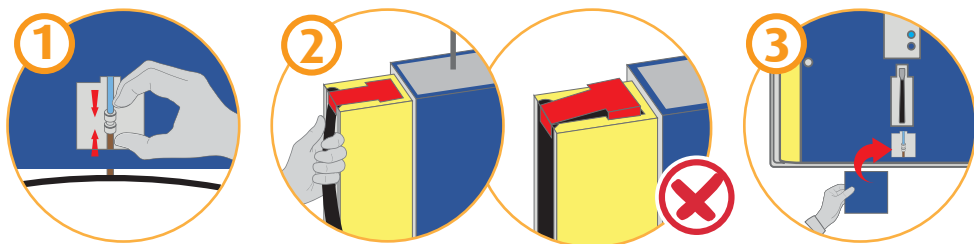
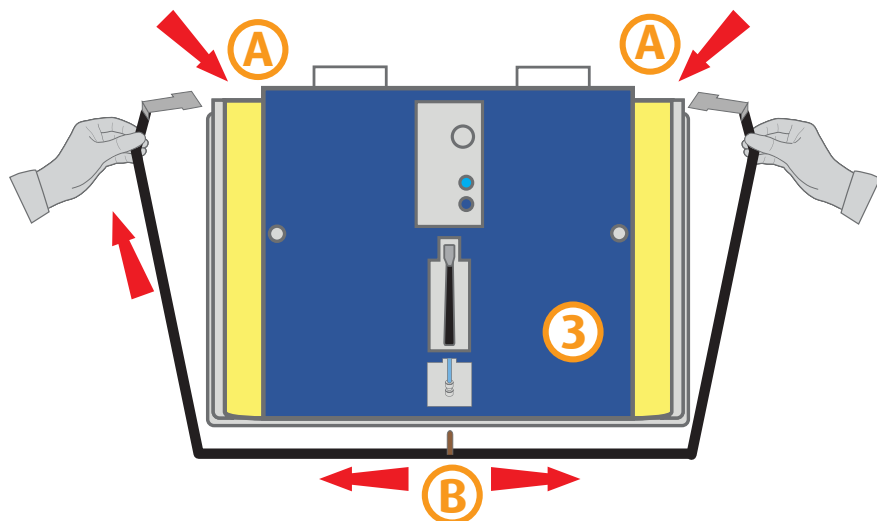

步骤2：安装备用密封圈



小心/重要

务必到使用前的一刻才从包装中取出备用密封圈

将挡板平放在光滑平整的表面上，以便安全更换密封圈

1. 将密封圈中间的密封阀插入挡板**B**下侧的开口中，并通过按压密封圈更换面板中的快卸接头，将阀小心地固定到充气机构。
2. 从中心沿着下部凹槽和侧面板边缘安装密封圈，不要扭绞密封圈。将两端卡入就位**A**
3. T形夹必须在每个侧面板顶部齐平
4. 将密封圈更换面板盖装回。挡板现可进行存放。

继续执行单元G“存放挡板”

单元G：存放挡板

存放挡板

存放到原始包装之前，必须确保挡板和套件其他部分均干燥，且侧面板完全收回。

小心：抬起时要小心，可能需要他人协助

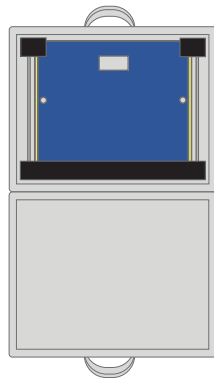
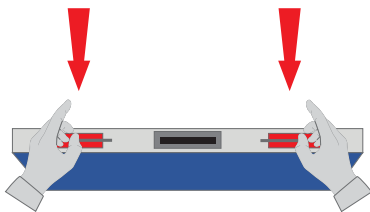
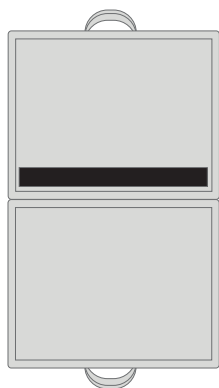

1. 将袋子拉链完全拉开，然后将较长的存放用防护件放在袋子底部
2. 在标记的把手处，小心地将挡板抬至袋中的边角防护件顶部
3. 在挡板的顶角处放置2个边角防护件，并绕着挡板拉上袋子的拉链



4. 将填料、备用密封圈和说明书装入袋中

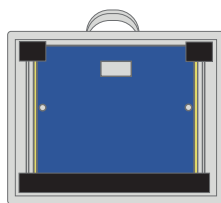

5. 垂直放在阴凉位置的光滑表面上，避免阳光直射和极端温度条件



重要提示：保留边角防护件，以便将来用于将挡板安全存放在环保袋中

单元H：故障排除

问题	可能原因	解决方案
挡板在充分伸开时不稳固	1. 门侧宽度大于110毫米	1. 门道不适合用单块挡板防洪。考虑购买延伸系统
	2. 门侧不光滑/坚固/平行	2. 修复门侧表面的瑕疵
关门时有干扰	1. 门侧深度小于75毫米	1. 门侧不适合使用Dam Easy防洪挡板。
	2. 挡板位置离关闭的门太近	2. 将挡板重新放置在门侧中离门更远的位置，然后重复挡板安装过程
	3. 突出的门配件造成干扰	3. 将挡板重新放置在门侧中离门更远的位置或拆除门配件，然后重复挡板安装过程
密封圈充气后挡板升起	挡板未在门道中充分稳固	对密封圈排气并重复安装过程，在伸开侧面板的同时向下按压把手
密封圈不能充气，或气压不能维持在2 bar的水平	1. 与泵机构的连接松动且漏气	1. 通过密封圈更换面板中的快放阀来释放密封圈，并小心地重新连接
	2. 密封圈被刺破	2. 如果洪水未接触到挡板，则拆除挡板并更换密封圈。如果洪水未退，请勿拆除挡板
无法将棘轮手柄复位到起始位置	方向开关切换到错误的方向，使得手柄朝着所需方向移动	同时操纵方向开关和棘轮手柄
无法移动棘轮手柄上的方向开关	手柄的位置阻碍了方向开关的切换	摇起棘轮手柄，同时操纵方向开关
泵柄操作不灵活	需要润滑	涂抹通用润滑剂

更多信息和演示，敬请访问：

www.dameasyfloodbarriers.com

单元I：配件

捍卫您家园的防洪利器

洪水位



低于50毫米



50毫米到
700毫米之间



延伸杆

与Dam Easy®防洪挡板
搭配使用



Dam Easy®延伸杆支持使用多块挡板，
可阻挡开口宽度1660毫米到
3000毫米以上的洪水。

需要先在地面上安装底座插口，然后方可将
延伸杆固定就位。



安全盖板

与Dam Easy®防洪挡板
搭配使用



可以购买安全盖板以增强
安全性，以防止篡改和拆除
挡板。



通风盖

Snorkel Vent™

310毫米和450毫米规格

为您的住宅装上“呼吸器”
市面上最简单有效的解决
方案



Snorkel Vent™是一款简单、实惠且有效的装置，
可为您提供持续的防洪保护，无需关闭翻门或
盖上盖子。



Patch It

可防止洪水进入外部开口



一种基于橡胶的高性能密封条，用于在洪涝期
间修补容易进水的外部开口。



密封胶

硅酮密封剂和
粘合剂

可形成防水密封的高性能密封胶，
用于防止洪水通过外部开口进入房屋。



HydroSack®

免装沙防洪解决方案，临时抵御
低位洪水



HydroSack®是一种高效、
现代化的防洪屏障构建解决
方案，旨在抵御住宅和商业建筑
中的水害。每件HydroSack®最多
可吸收20升水。HydroSack®通过
淡水（而非盐水）激活。



打湿
激活

HydroPack®

免装沙防洪解决方案，
临时抵御低位洪水

HydroPack®是一种高效、现代化的防洪屏障构建解决方案，旨在抵御住宅和商业建筑中的水害。每件HydroPack®最多可吸收15升水。HydroPack®通过淡水（而非盐水）激活。



低
水位

配件

备用密封圈

与Dam Easy®防洪挡板搭配使用

我们建议在使用后或每12个月更换一次充气式密封圈。



HydroSnake®

免装沙防洪解决方案，
临时抵御低位洪水

HydroSnake®是一种高效、现代化的防洪屏障构建解决方案，旨在抵御住宅和商业建筑中的水害。每件HydroSnake®最多可吸收20升水。HydroSnake®通过淡水（而非盐水）激活。



低
水位

Shower Stack

在洪涝期间保护楼下的
淋浴和浴缸设施

Dam Easy® Shower Stack
可保护楼下的淋浴和浴缸设施，防止洪水通过污水管道进入。



中到高
水位

Toilet Dam

在洪涝期间防止污水通过
马桶溢出（适合大多数品牌和型号）

Dam Easy® Toilet Dam是一种有效的工具，可在洪涝期间封堵任何宽度或形状的坐便器以防止污水回流。



中到高
水位

Dam Easy®防洪挡板

保护外部开口抵御高达600毫米的洪水

Dam Easy®防洪挡板是一种独特的民用和商用防洪挡板，安装后可在门侧周围形成防水密封。适合安装在宽度780至1100毫米的光滑门内侧。

低
水位

中到高
水位

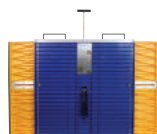

伸开后的Dam Easy®防洪挡板

全球首款无需固定件且搭载
充气式密封圈（已获专利）的
现成防洪系统

单元J：保修和免责声明

本保修和免责声明明确构成All Weather Industries Limited的销售条款和条件的一部分。

免责声明：洪水可以通过其他入口进入房屋，任何房屋中的所有此类入口都必须加以控制，以防止水害。请参见www.dameasyfloodbarriers.com，了解All Weather Industries提供的其他产品。

小心：突出强调人员受伤和设备损坏的风险

保修：All Weather Industries保修涵盖自购买之日起12个月内出现的材料或工艺缺陷，我们将在这段时间内更换任何发现有缺陷的挡板。

购买后必须在线注册才能享受**1年保修**

- 保修例外情况
- 如果以任何方式改动了挡板
- 如果任何螺丝上的安全密封件已损坏
- 如果有任何工具与挡板接触（防盗螺丝）

我们对您的责任：All Weather Industries将尽一切合理的努力确保所有Dam Easy防洪挡板都符合相关描述、质量令人满意且适合其出售目的。除非本说明书中明确规定，否则All Weather Industries Limited不作任何其他关于防洪挡板的声明或保证。

除非因All Weather Industries Limited的疏忽或欺诈行为导致人员伤亡，否则All Weather Industries Limited对您所遭受的任何直接损害的赔偿责任绝不超过您购买本防洪挡板所支付的金额。

在任何情况下，All Weather Industries Limited的董事、员工、股东、代理商或分包商均不对您承担间接、偶然、结果性、特殊或惩罚性赔偿责任。

All Weather Industries Limited对自身或其所有员工、代理人或分包商因下列情况造成的任何损失或损害不承担任何责任：[a] 在您提交订单时，此类损失是您和All Weather Industries Limited不可预见的，并且这不是因为All Weather Industries Limited违反相关法定义务所导致；[b] 此类损失与业务相关；或者 [c] 此类损失与房屋或财产方面的损失或损害有关，除非这是由于All Weather Industries的重大疏忽或蓄意不当行为所导致。

上述对All Weather Industries责任的限制不会影响您作为消费者的非排他性法定权利。



本产品符合
欧洲防洪协会
的要求

单元K：报废处置

根据使用程度、洪水中存在的物质以及对挡板的关注和养护，可能需要在将来的某个阶段进行更换。



Dam Easy®防洪挡板

100%可回收

应将金属和塑料部件分开并送到登记在册的回收中心。如果在处置方面遇到困难，请直接联系All Weather Industries。

型号：DME01

由于我们会持续改进产品，产品可能与所示图片有所不同。

由All Weather Industries Ireland设计和研制。
在中国和德国制造。在爱尔兰组装。



已获得
CE认证标志，
符合2006/42/EC
机械指令



**PLEASE
RECYCLE**

说明书在爱尔兰印制。



由All Weather Industries制造。All Weather Industries Ltd.
保留Dam Easy®产品设计与商标的所有知识产权以及所
有营销/分销权。

www.dameasyfloodbarriers.com

© 2018版权所有。All Weather Industries Ltd.保留所有权利。严禁复制和分发此处包含的任何材料。未经All Weather Industries Ltd事先书面许可，不得以任何形式或通过任何方式(包括影印或电子方式)复制、分发或传播本材料的任何部分。All Weather Industries Ltd保留Dam Easy®产品系列设计与商标的所有知识产权以及所有营销/分销权。Dam Easy Flood Barriers®是All Weather Industries Ltd.的注册商标。SnorkelVent™是Gravitas (International) Ltd.的注册商标。HydroPack®、HydroSack®和HydroSnake®是Donite Plastics Ltd.的注册商标。

