

Assembly Instructions for "European Watermill"

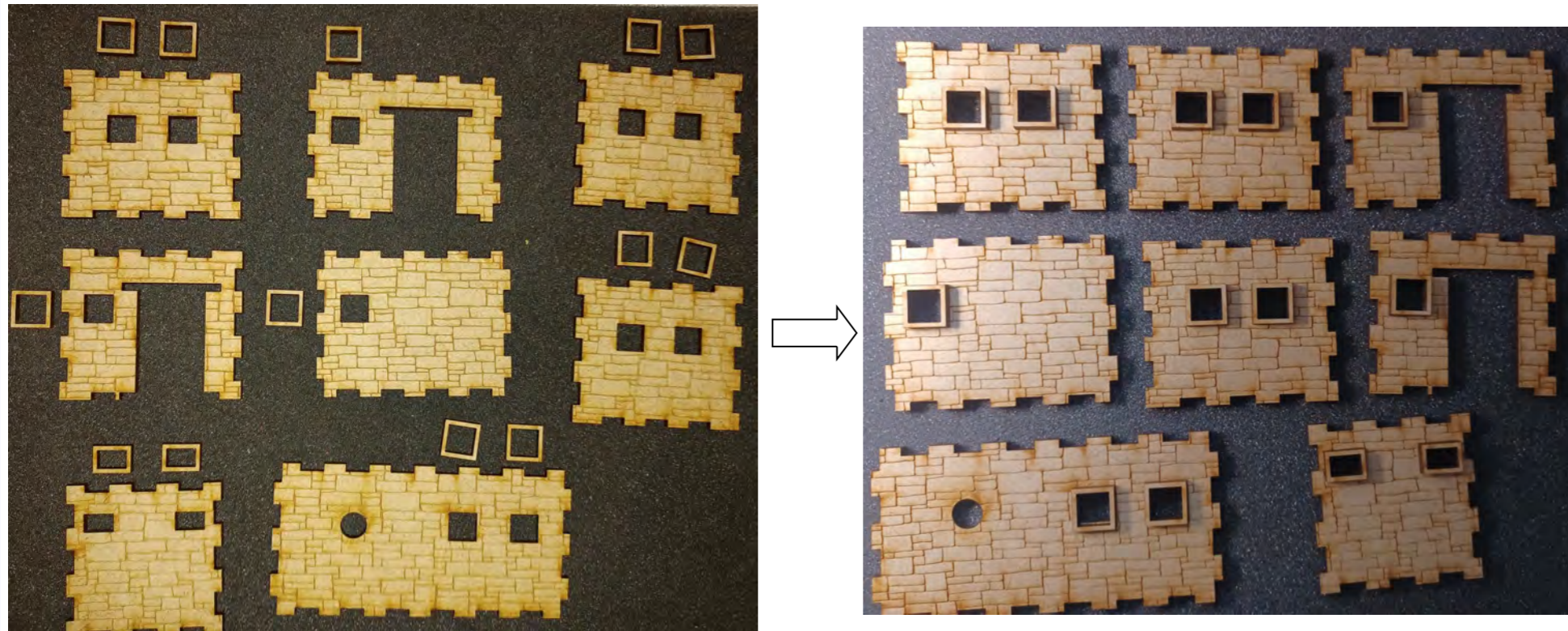

1: Glue windows onto wall pieces.



2: Glue together shown pieces. When glue is dry, use sandpaper to make the edge (red circle) sloping.

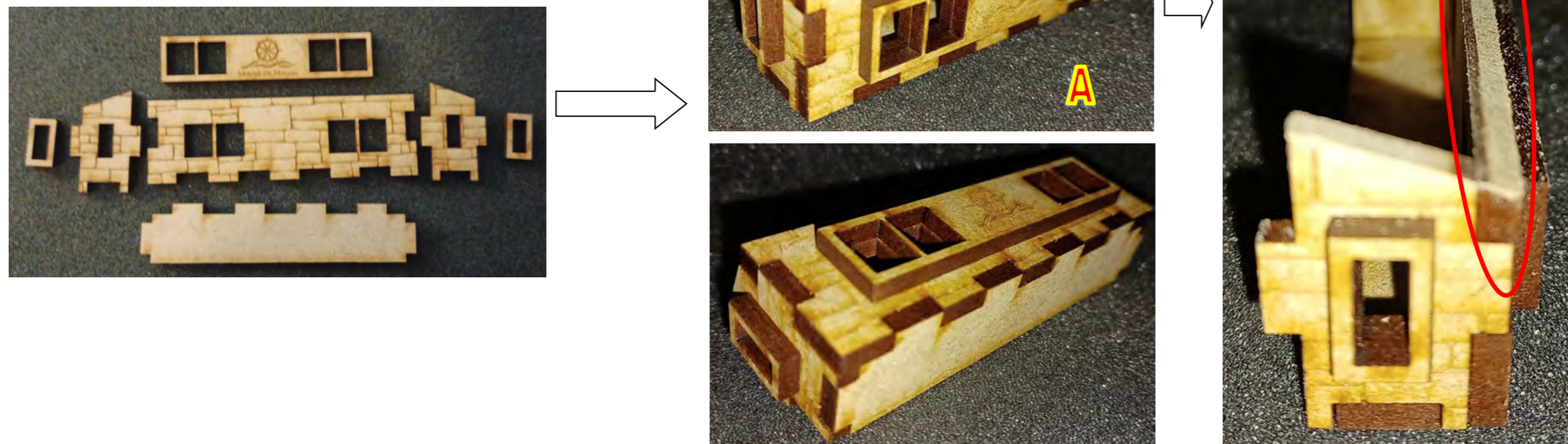

3: Glue together shown pieces (sandwich). When glue is dry, grind the four long sides a bit using sandpaper.

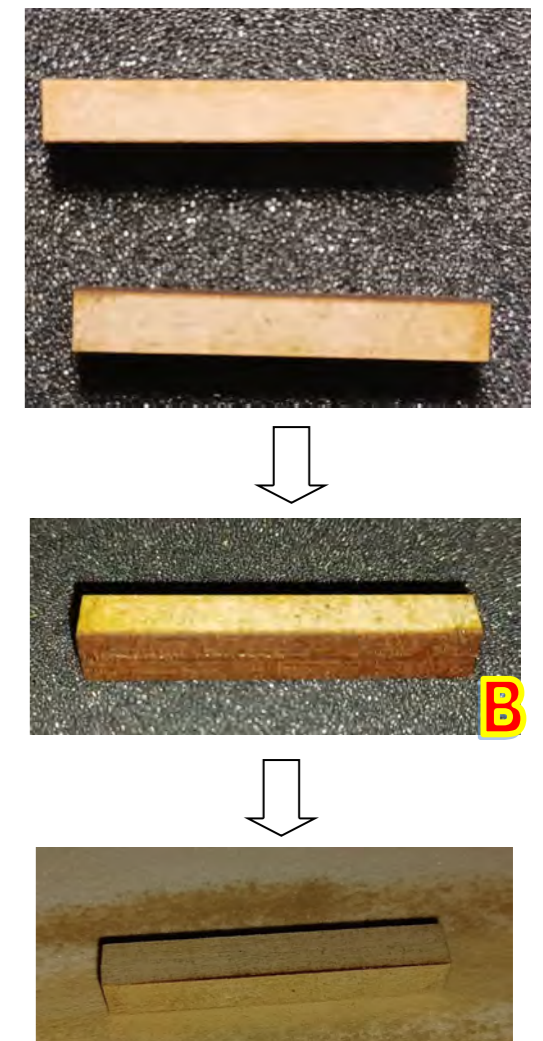

Assembly Instructions for "European Watermill"



4: Glue together shown pieces for the fireplace.

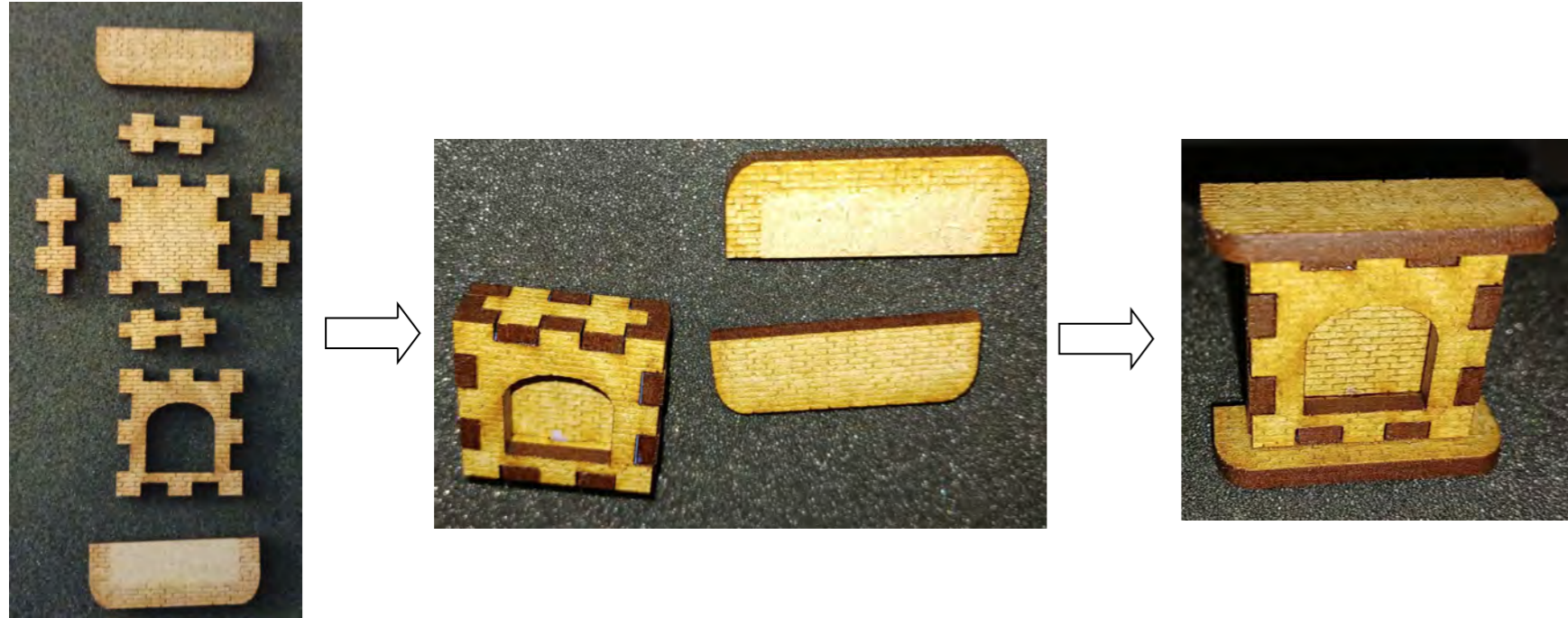

5: Glue together shown pieces for the top of the chimney.

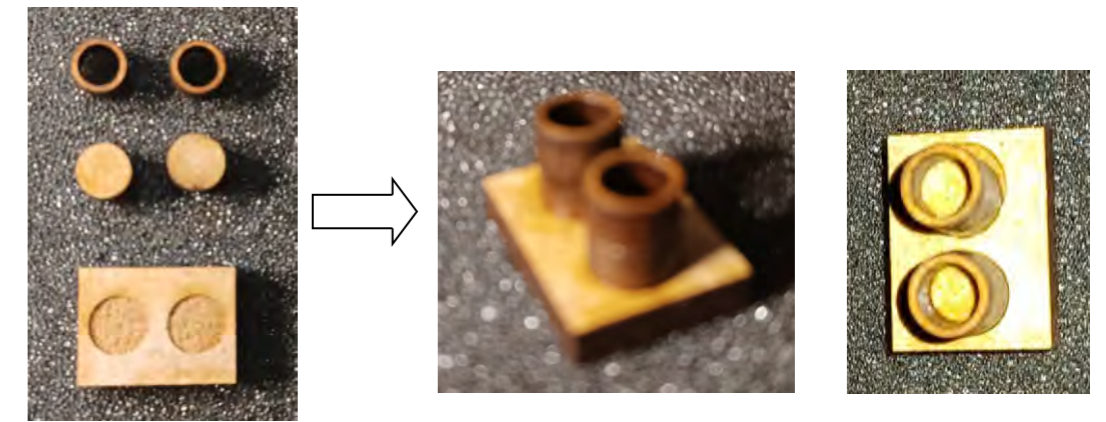

6: Glue together shown pieces for the stairs.

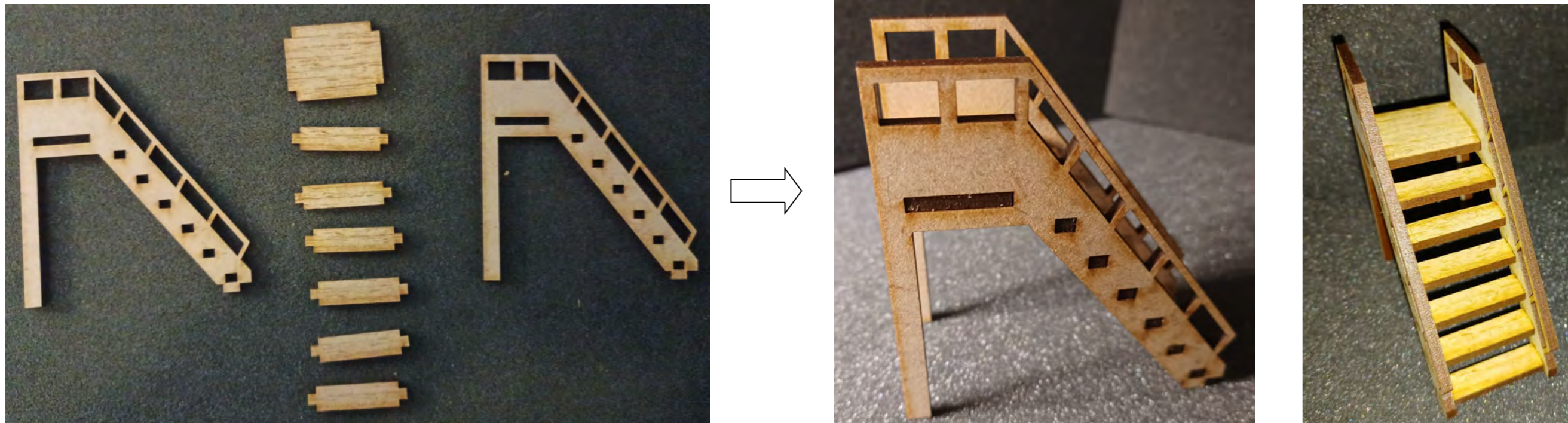

Assembly Instructions for "European Watermill"



7: Glue shown pieces for the water wheel onto piece B. Glue in the shown order. Notice that nr. 10 is smaller than the other circles. Leave out nr. 11 and 12 for now.

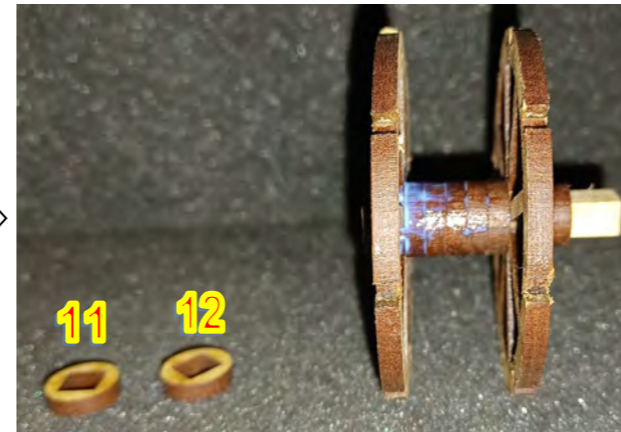
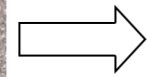
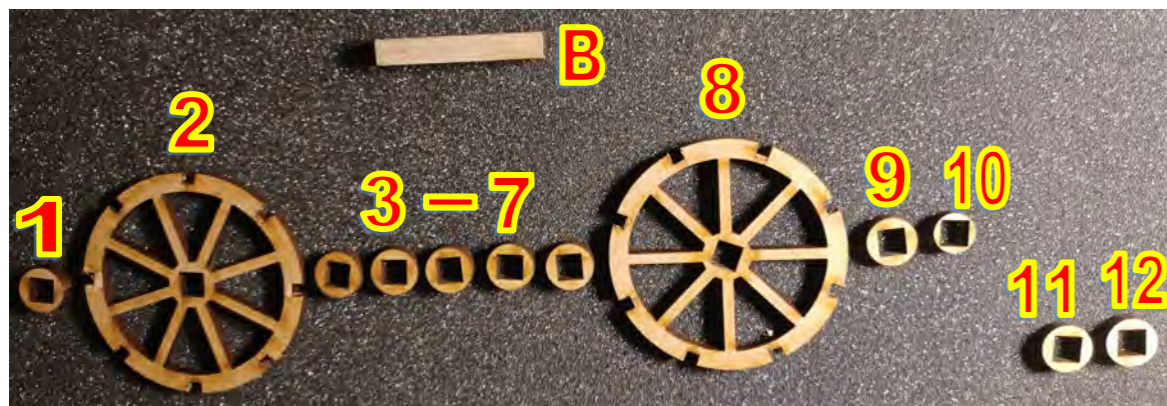

8: Glue shown pieces onto the wheel.

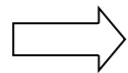

9: Glue together shown pieces for the chimney.

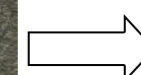
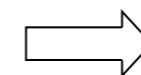

Assembly Instructions for "European Watermill"



10: Glue the top onto the chimney.

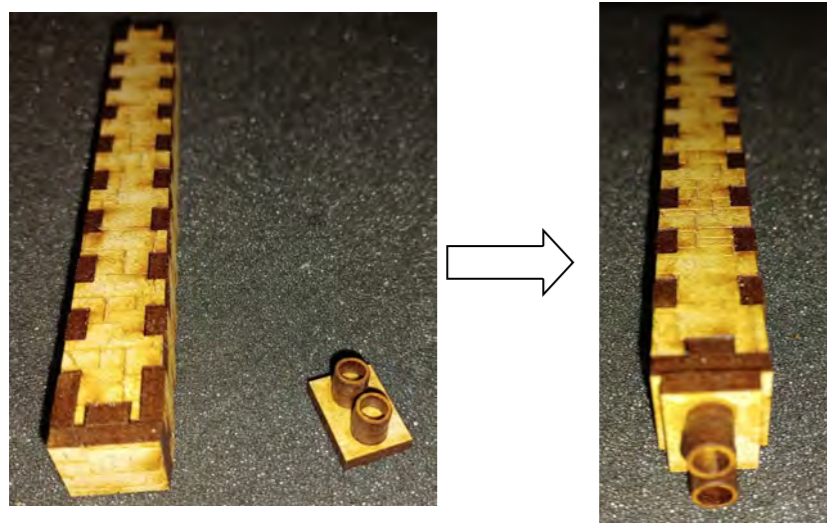

11: Glue pieces C onto the shown wall pieces. The hole in pieces C (green circle) must be to the left. Make sure Piece C is centered in wall piece.

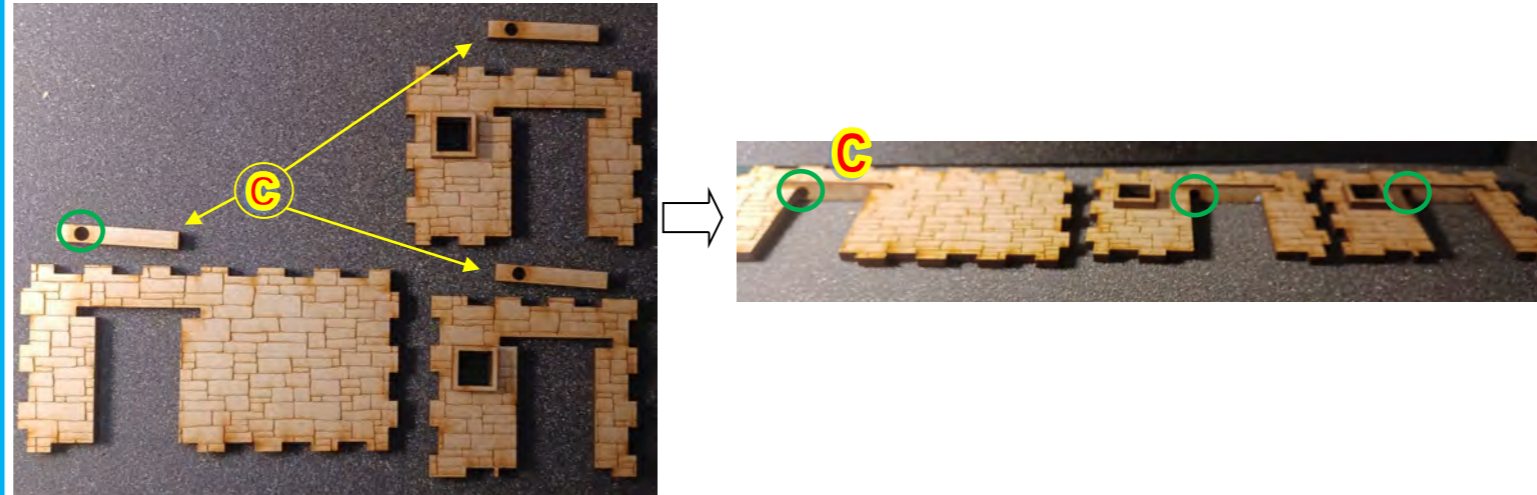

12: Glue together shown pieces for roof 1.

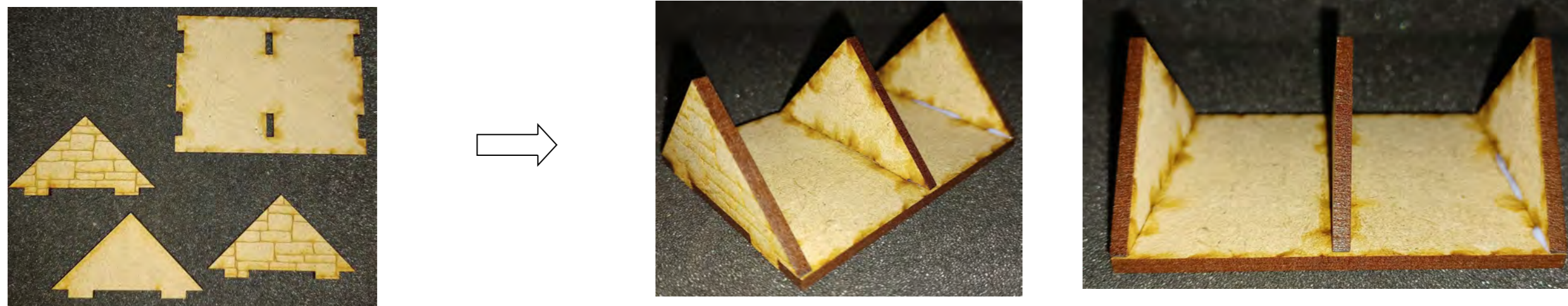

13: Glue together shown pieces for roof 2.

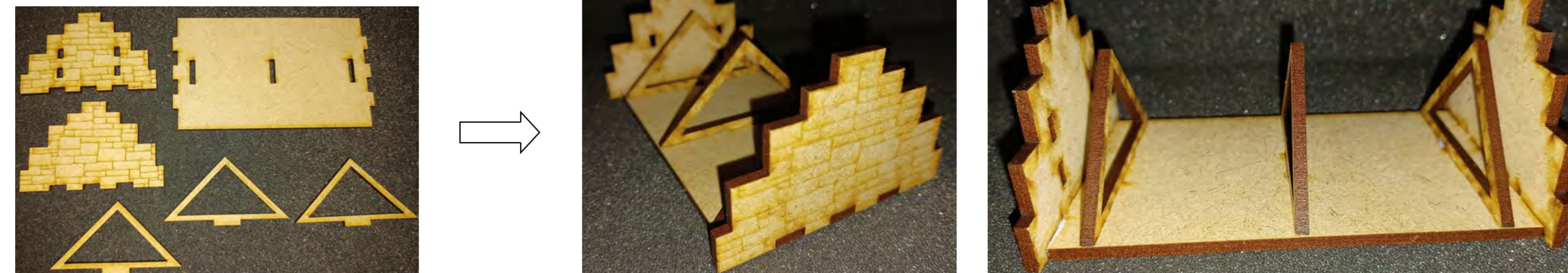

Assembly Instructions for "European Watermill"



14: Glue together shown pieces.

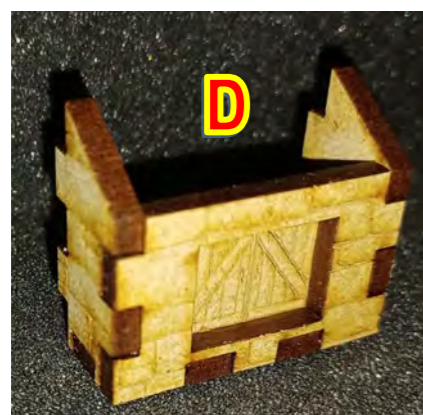
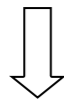

15: Glue shown pieces onto the bottom of roof 1. Make sure piece is centered. You can use piece E for this. Do NOT glue piece E.

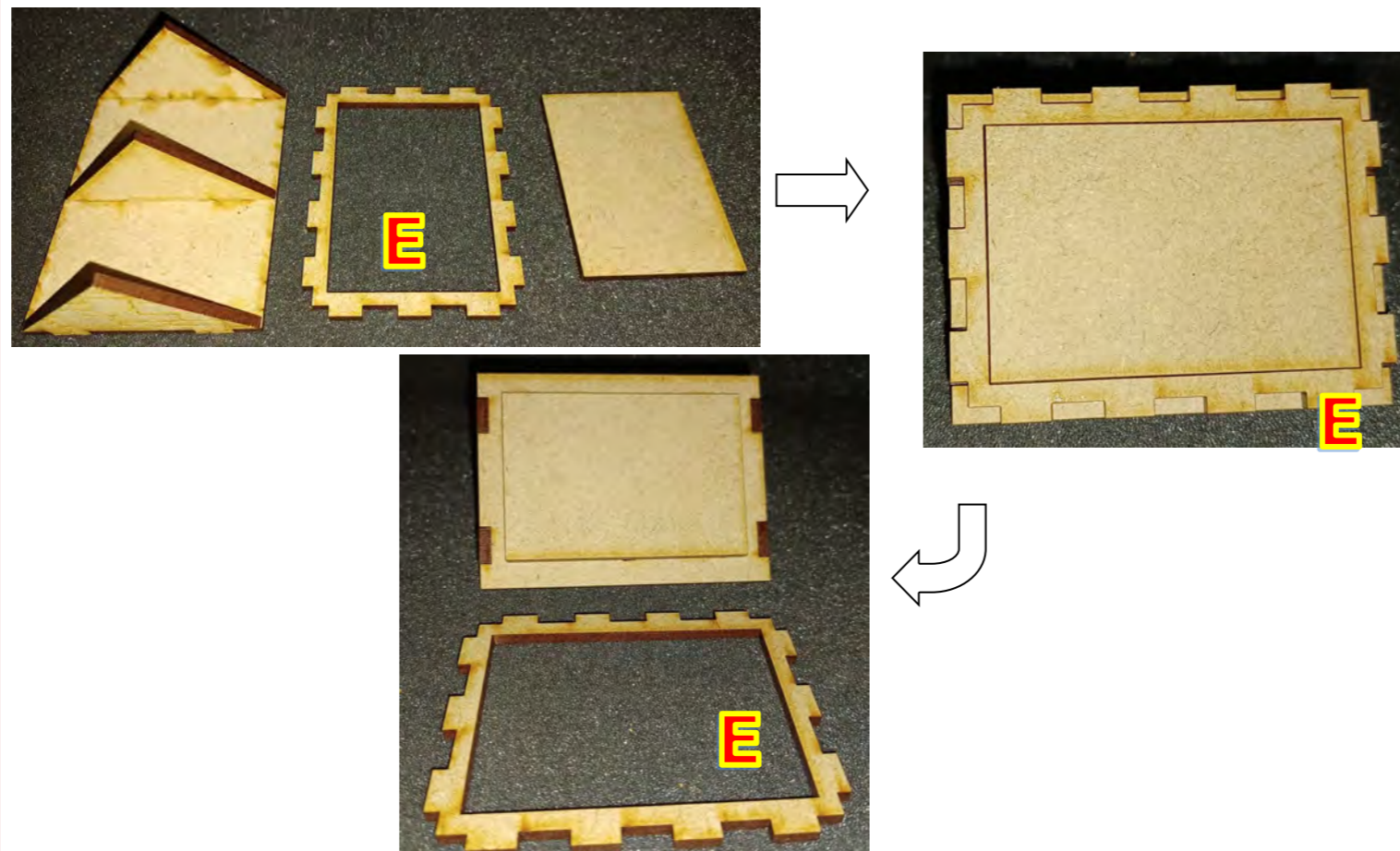

16: Glue shown pieces onto the bottom of roof 2. Make sure piece is centered. You can use piece F for this. Do NOT glue piece F.

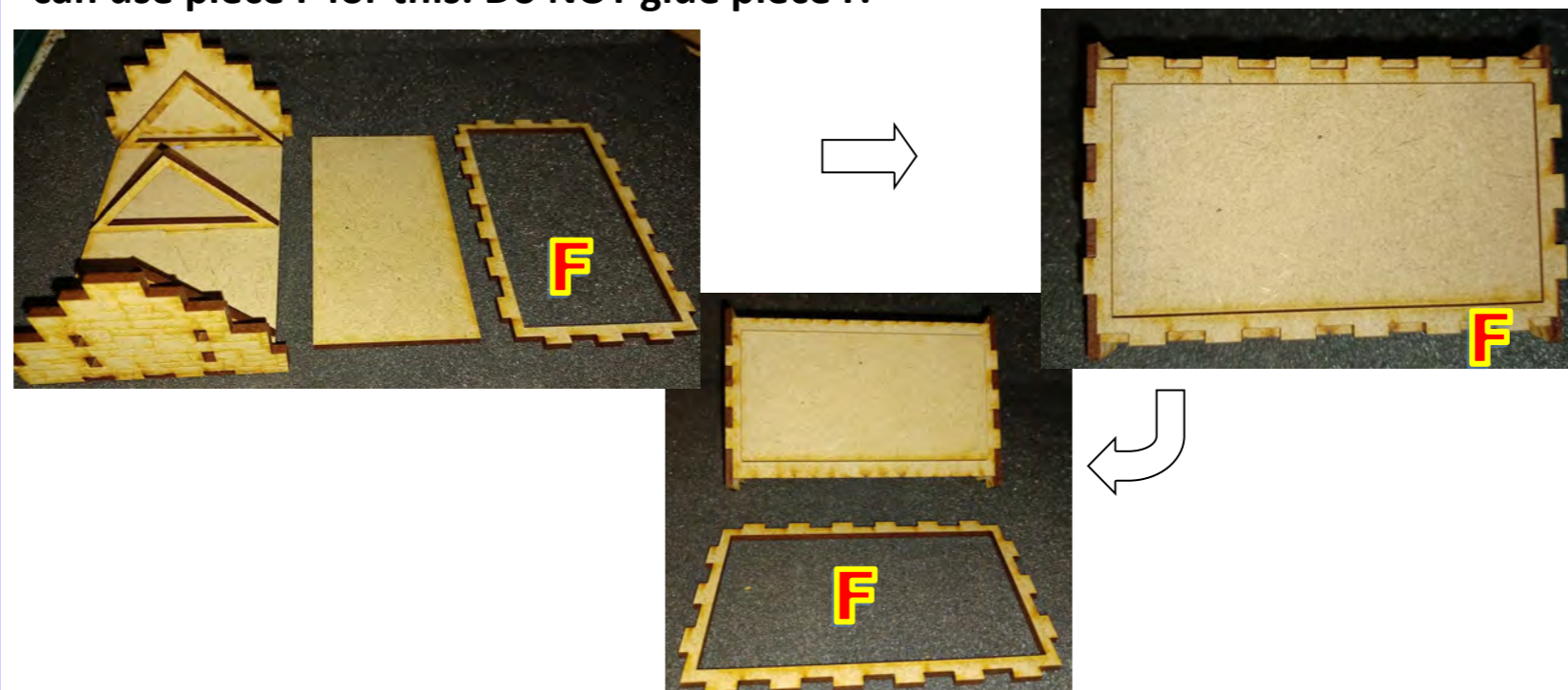

Assembly Instructions for "European Watermill"



17: Glue shown pieces onto roof 1.

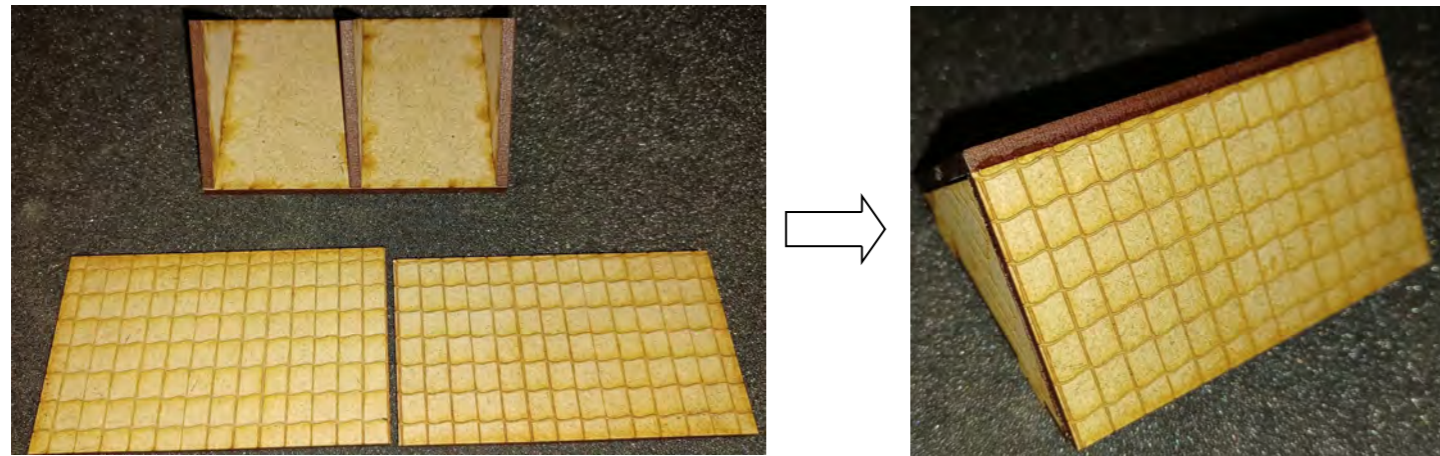

18: Glue shown pieces onto roof 2.

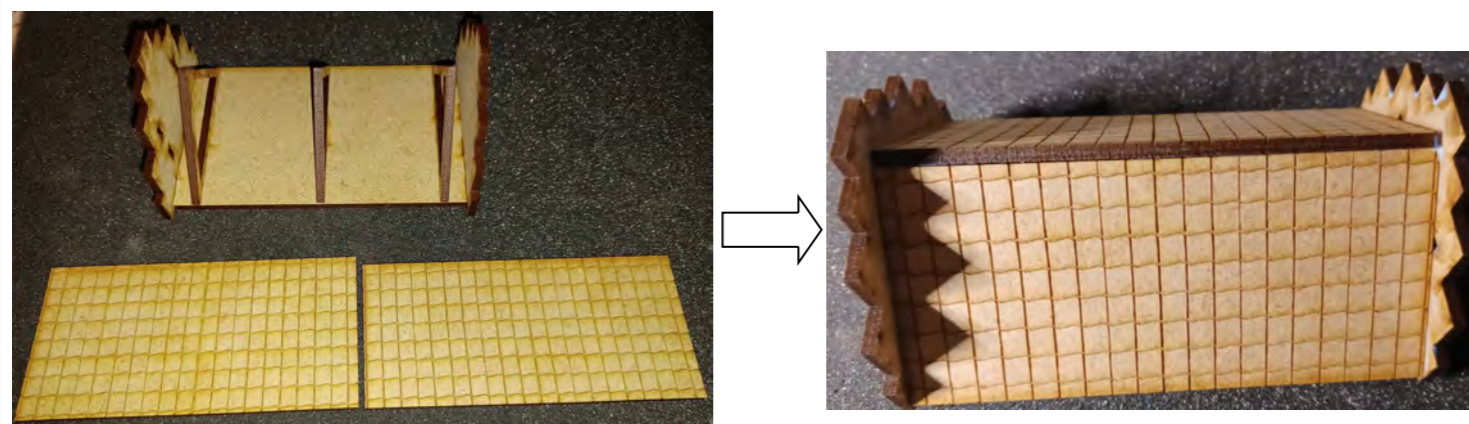

19: Turn shown pieces up side down. On one of the long edges (Red circle) use sandpaper to make the edge sloping.

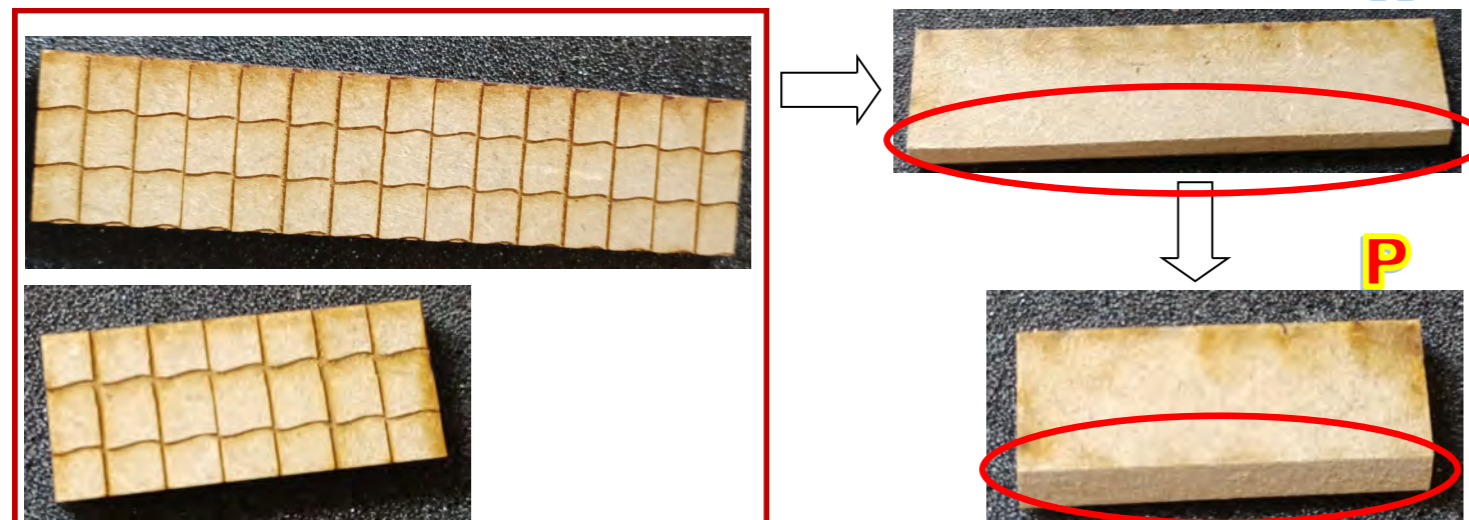

20: Glue together shown pieces.

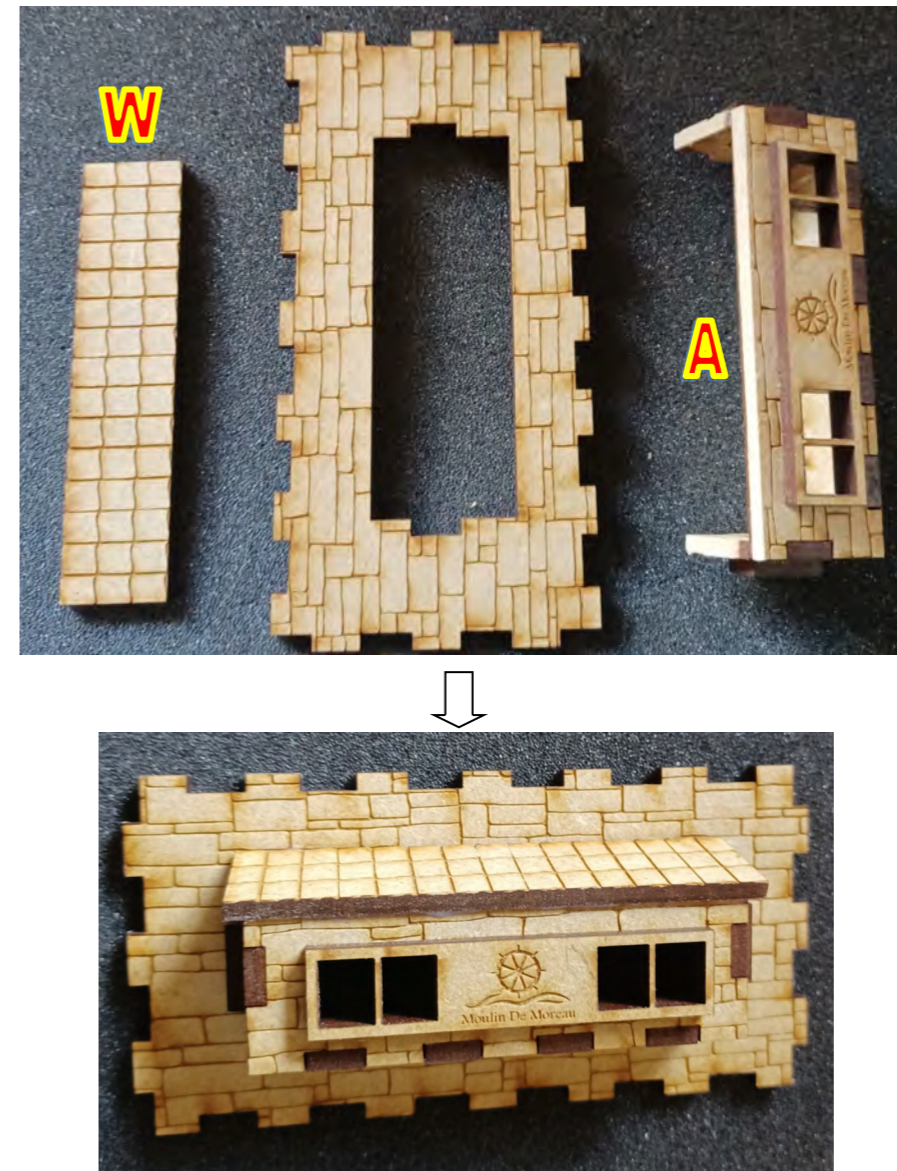

21: Glue together shown pieces.

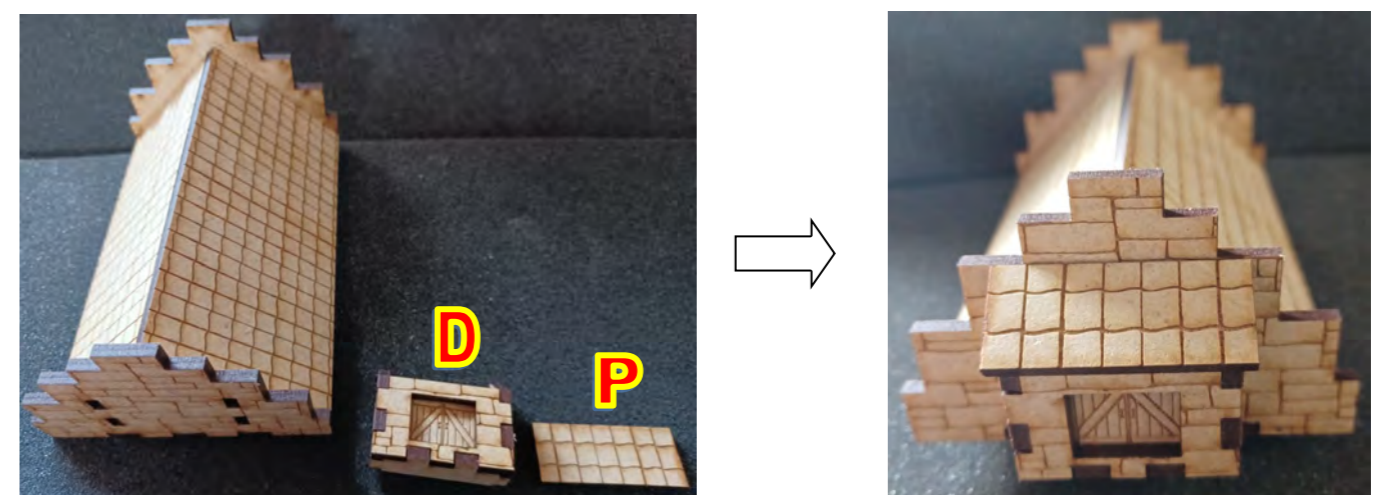

Assembly Instructions for "European Watermill"



22: Glue together shown pieces for the 1st floor of the water mill. Do NOT glue door. Taps on door goes into holes on Floor and piece C in wall. (Yellow circles)

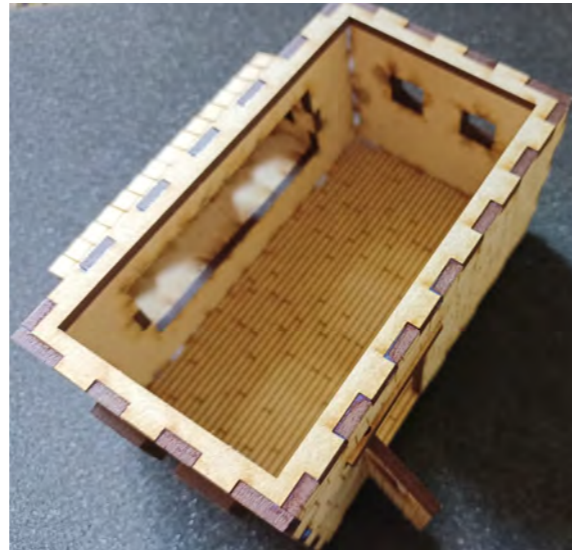
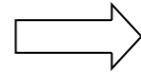
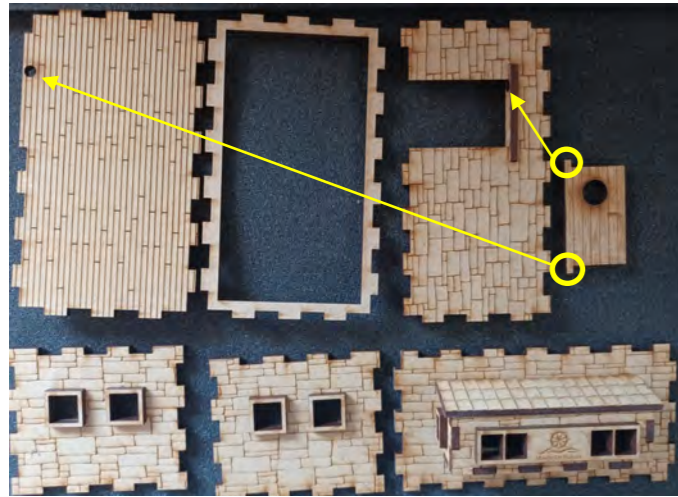

23: Glue shown pieces onto the bottom the 1st floor. Make sure piece is centered. You can use piece G for this. Do NOT glue piece G.

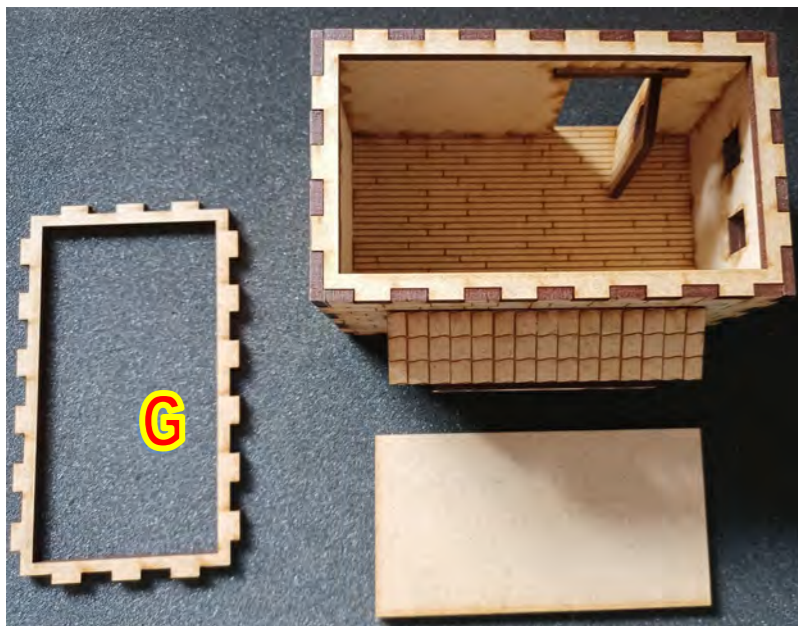

Assembly Instructions for "European Watermill"



24: Glue shown pieces for the ground floor 1 of the watermill onto the bottom piece. Do NOT glue door. Taps on door goes into holes on bottom piece and piece C in wall.

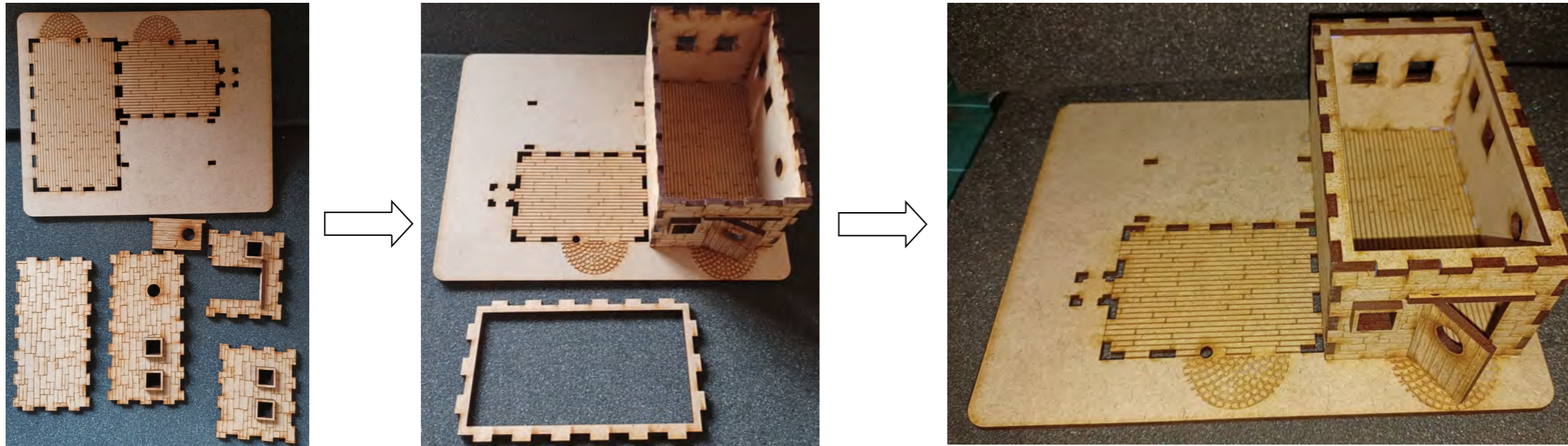

25: Glue shown pieces for the ground floor 2 of the watermill onto the bottom piece. Add glue to the place where the wall pieces on ground floor 1 and 2 connect. Add a clamp (In red circle) until glue is dry. Do NOT glue door. Taps on door goes into holes on bottom piece and piece C in wall.

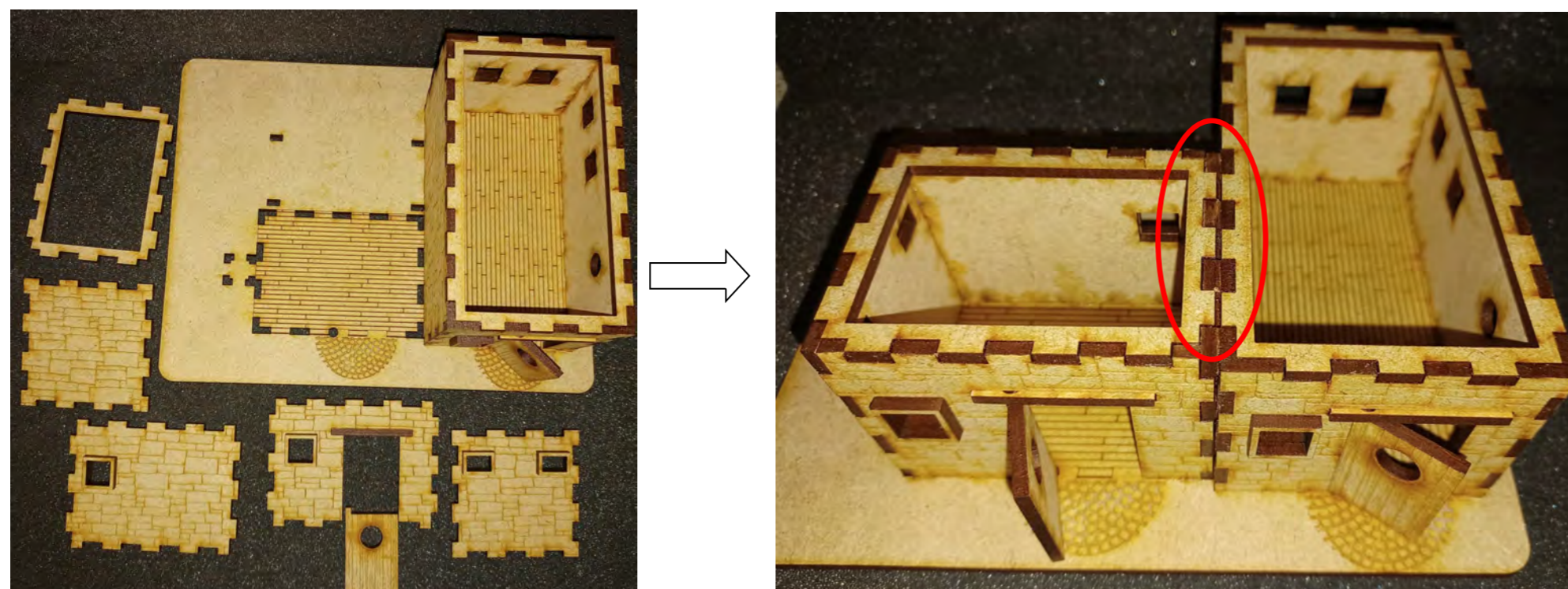

Assembly Instructions for "European Watermill"



25: Glue chimney onto the bottom piece. Add glue to the place where the chimney and the wall piece on ground floor 2 connect. Add a clamp until glue is dry.

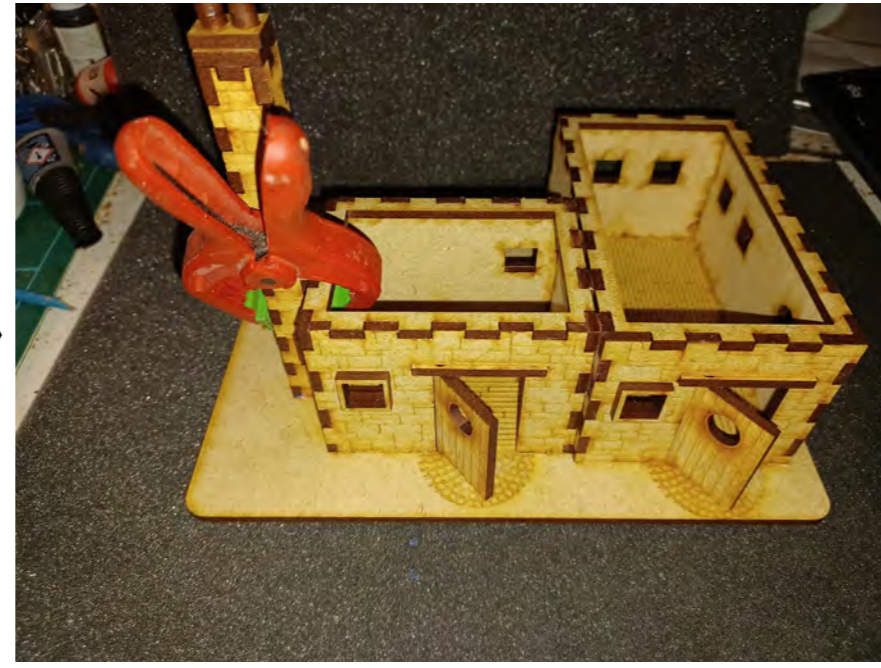
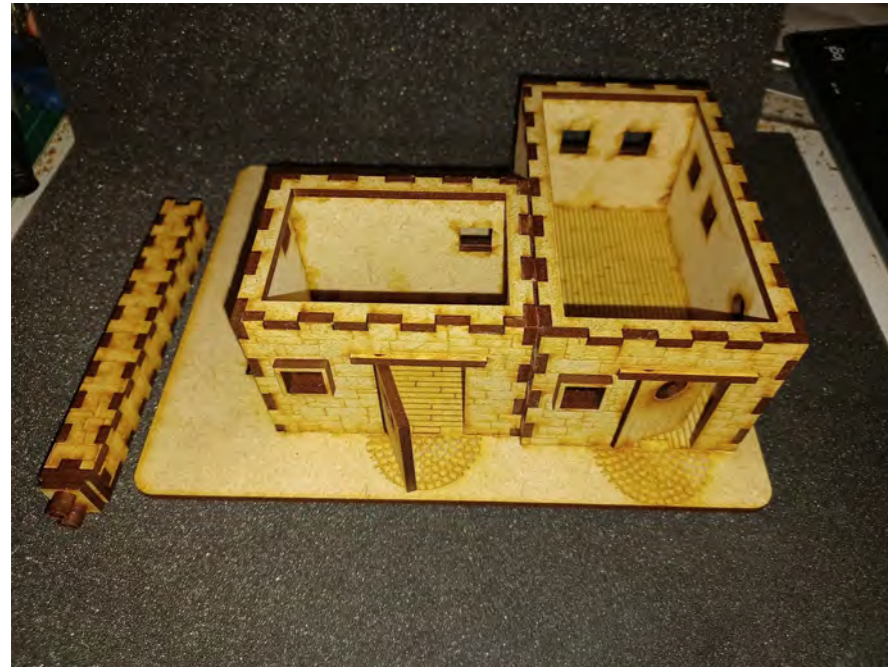

26: Glue stairs onto the bottom piece. Add glue to the place where the stairs and the wall piece on ground floor 1 connect.

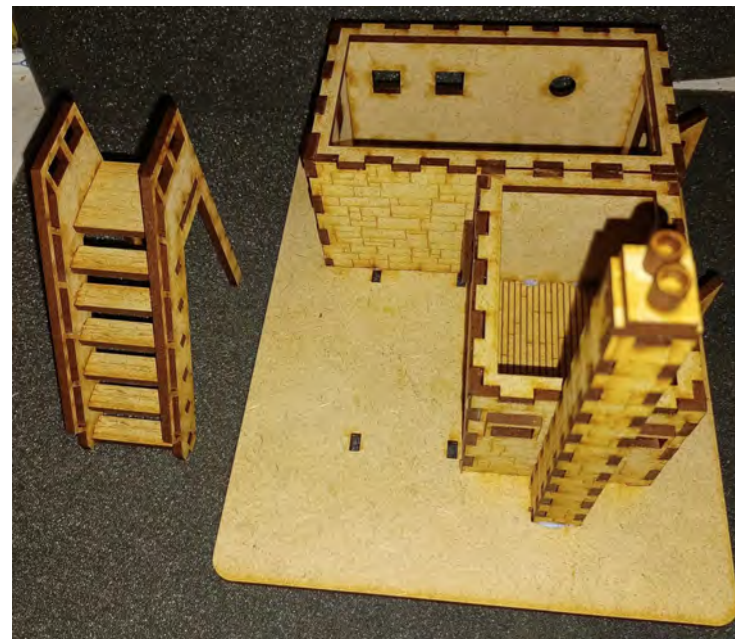

Assembly Instructions for "European Watermill"



27: Glue fireplace onto the wall connected to the chimney. Add glue to the places where the fireplace connects with the wall piece and the floor. Add a clamp until glue is dry.

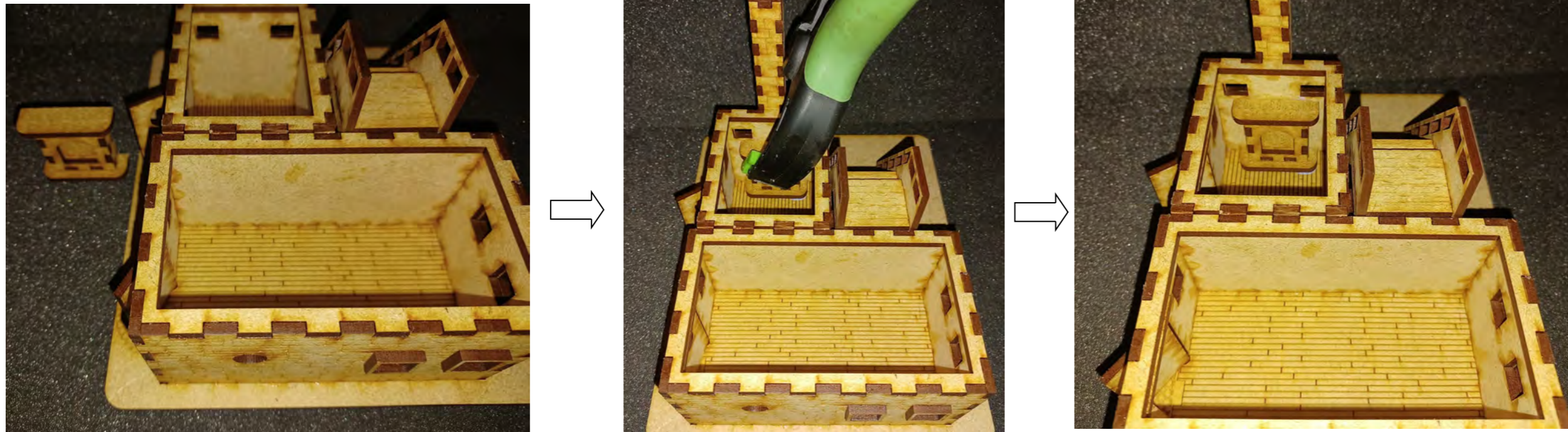

28: Glue waterwheel onto the wall. First stick piece B trough hole in wall piece. Then add piece 11 on the backside, and then add glue onto piece B, 11 and 12. Be careful NOT to get glue between piece 11 and the wall, as this would make the wheel unable to turn.

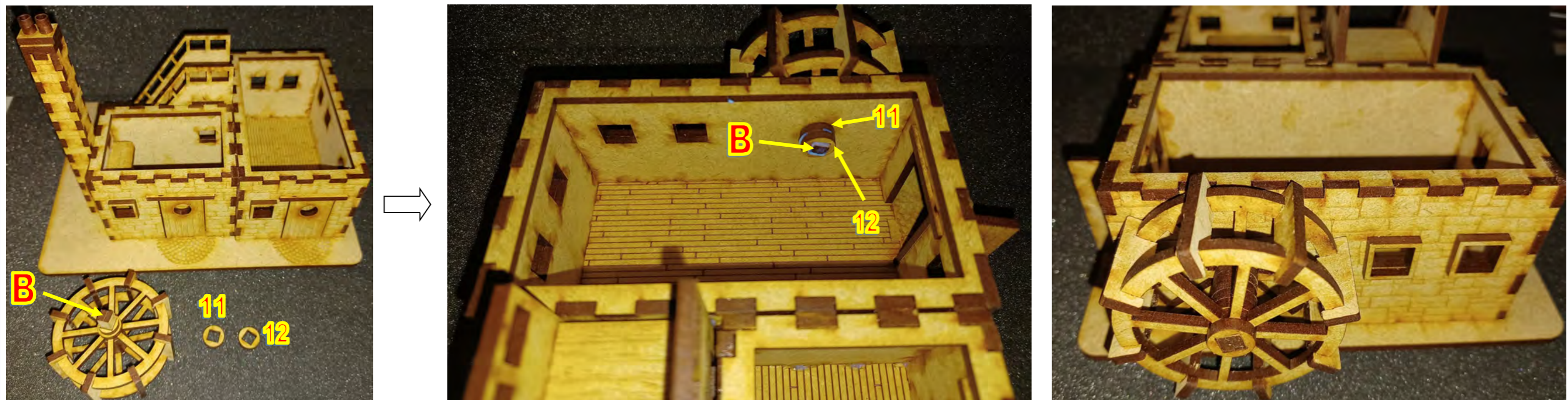

Assembly Instructions for "European Watermill"



Assembly Instructions for "European Watermill"

