

Assembly Instructions for Water Tower and Windmill

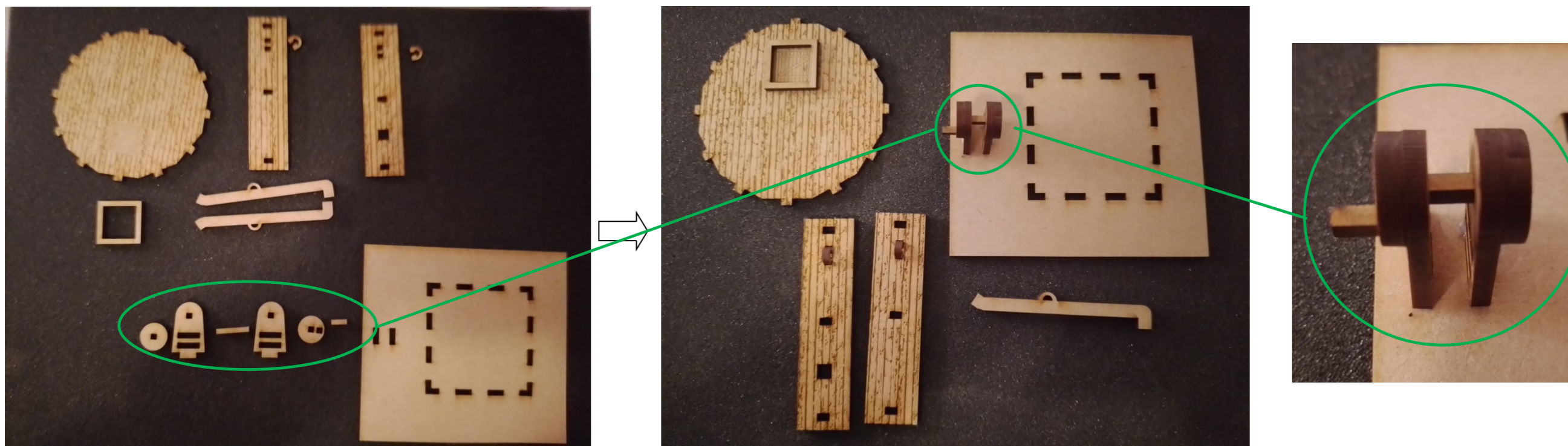

1: Glue together shown pieces for the water tower. Glue together pieces for water pipe (sandwich). Glue together pieces for the crank in the shown order. (Green circle)



2: Glue together shown pieces for the water tower chassis. Add a rubberband until glue is dry.

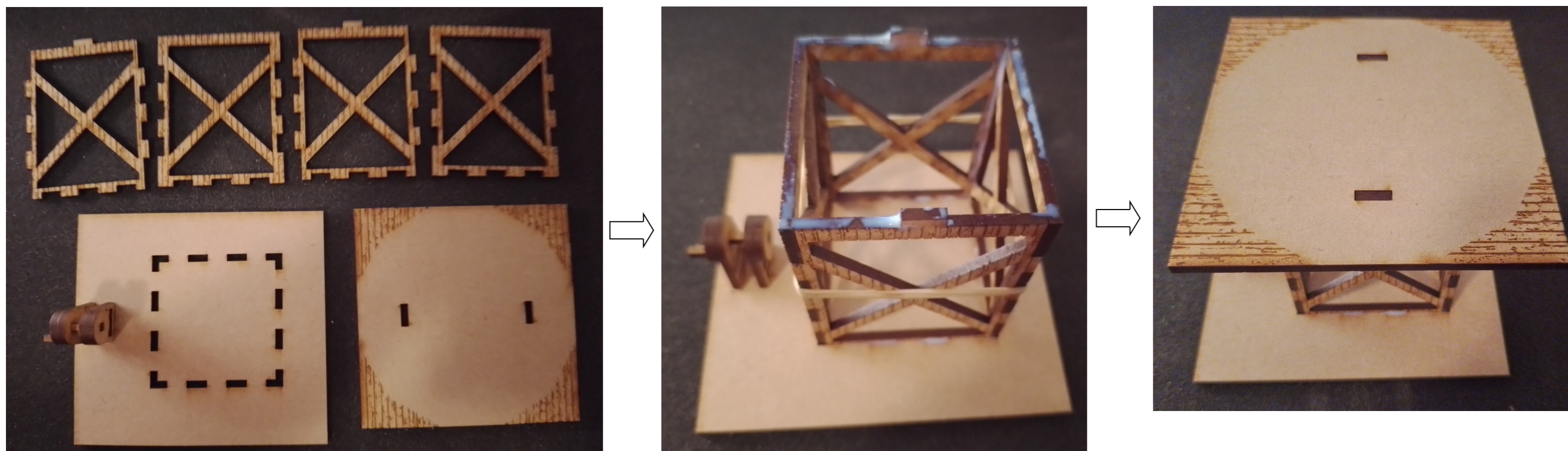

Assembly Instructions for Water Tower and Windmill



3: Glue together shown pieces for the top of the water tower. Glue in the order shown. Add a rubberband until glue is dry.

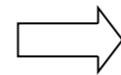
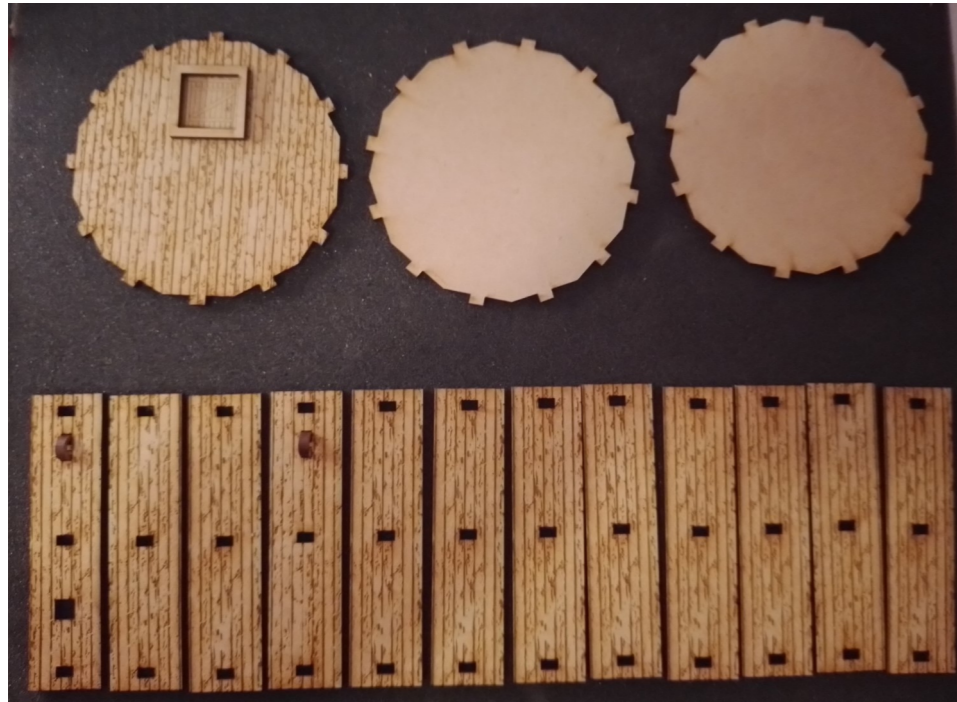

4: Glue together shown pieces into 3 x "sandwich". When dry, glue the three rings onto water tower.

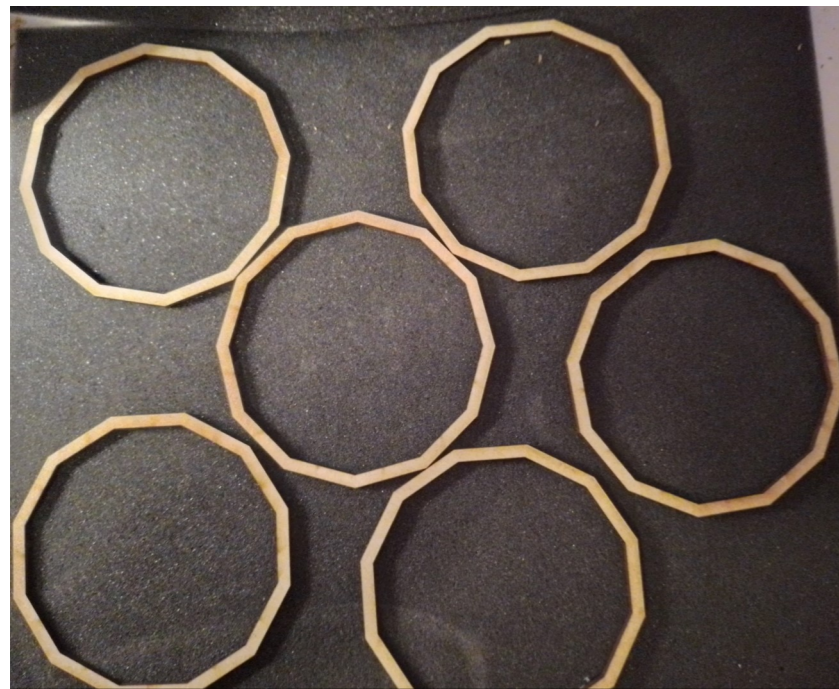

Assembly Instructions for Water Tower and Windmill



5: Glue top of Tower onto chassis. Make sure piece is centered. Also make sure, that piece 1 is above the crank. (Green circles). Add the ladder and the water pipe.

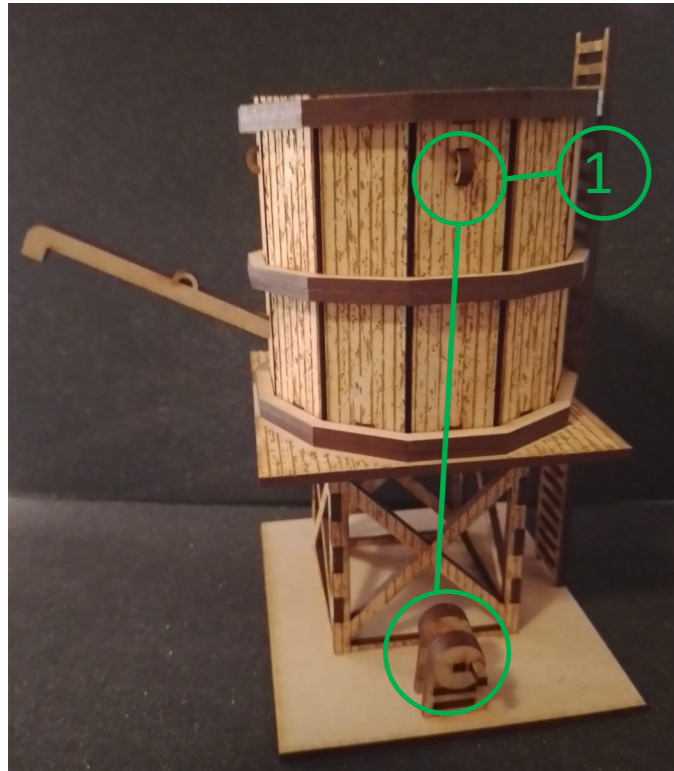

6: Finally add a little paint and a string. (Not included.)



Assembly Instructions for Water Tower and Windmill

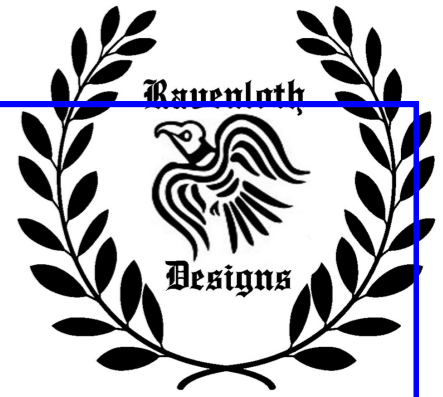

7: Glue together shown pieces for the windmill chassis. Make sure that piece A is centered. Add a rubberband until glue is dry.

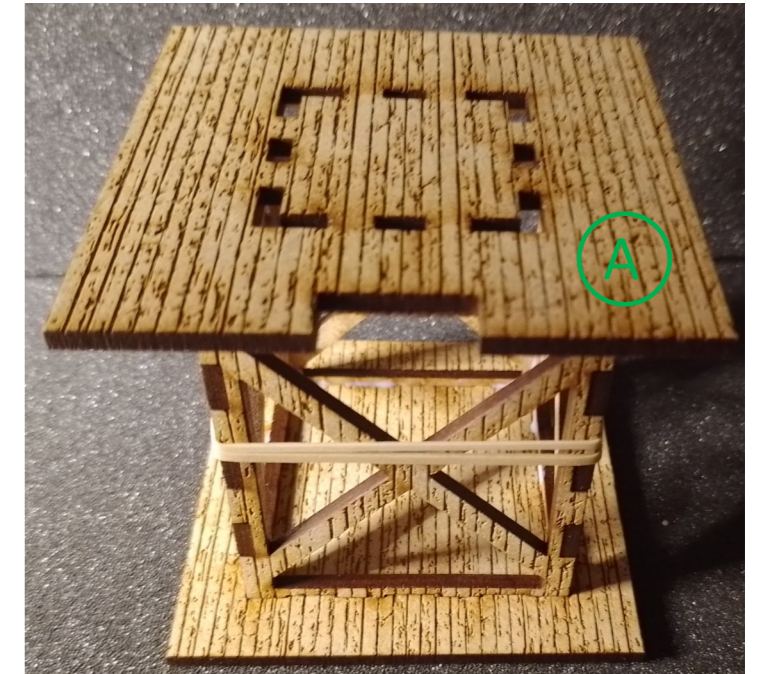
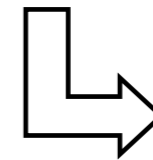
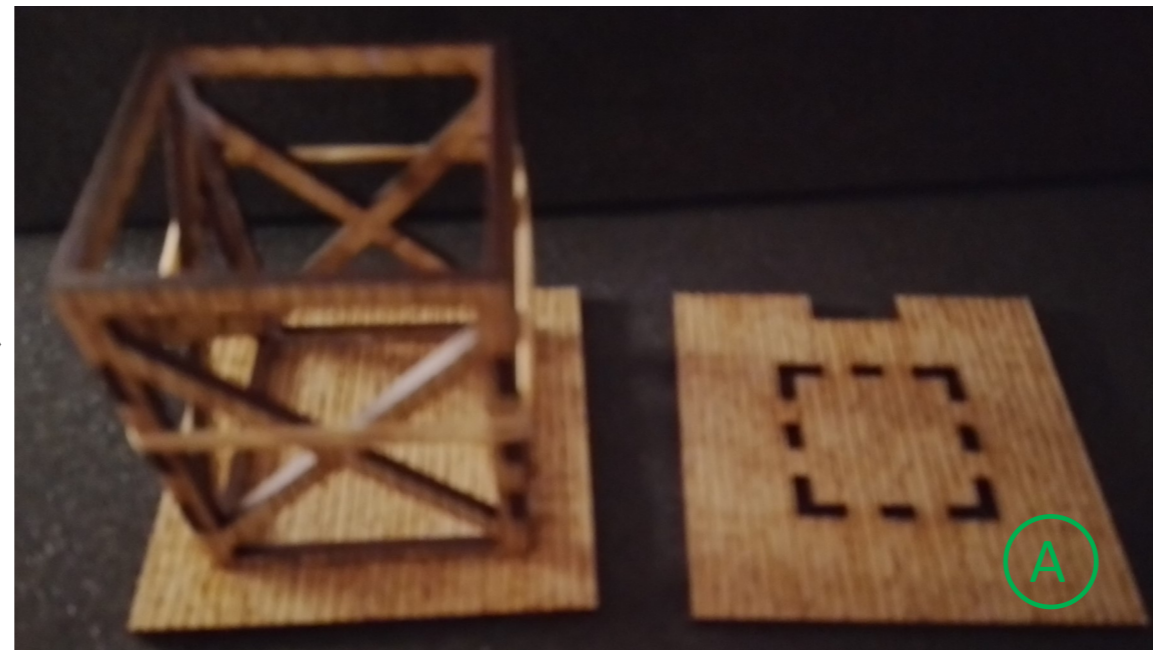
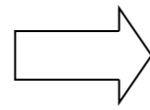
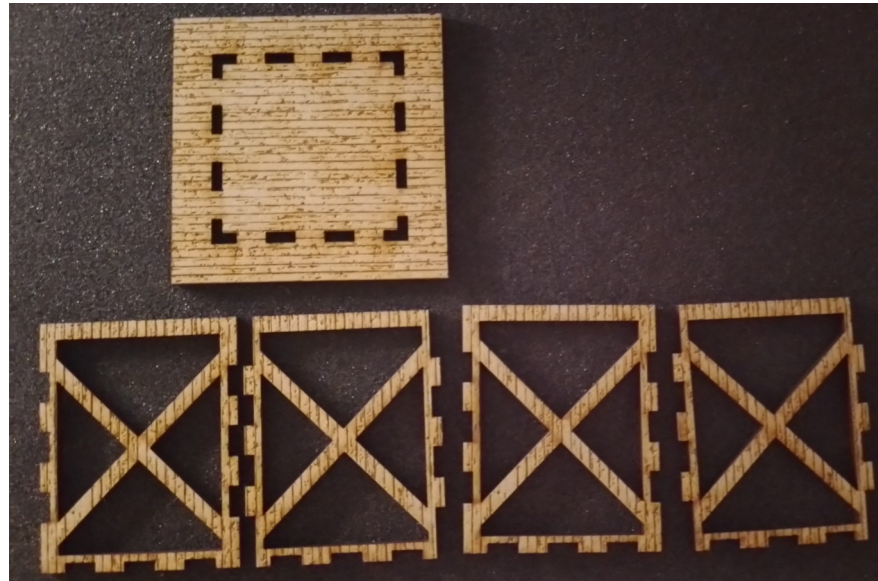

8: Glue together shown pieces for the windmill top. Add a rubberband until glue is dry. Then glue top onto chassis.

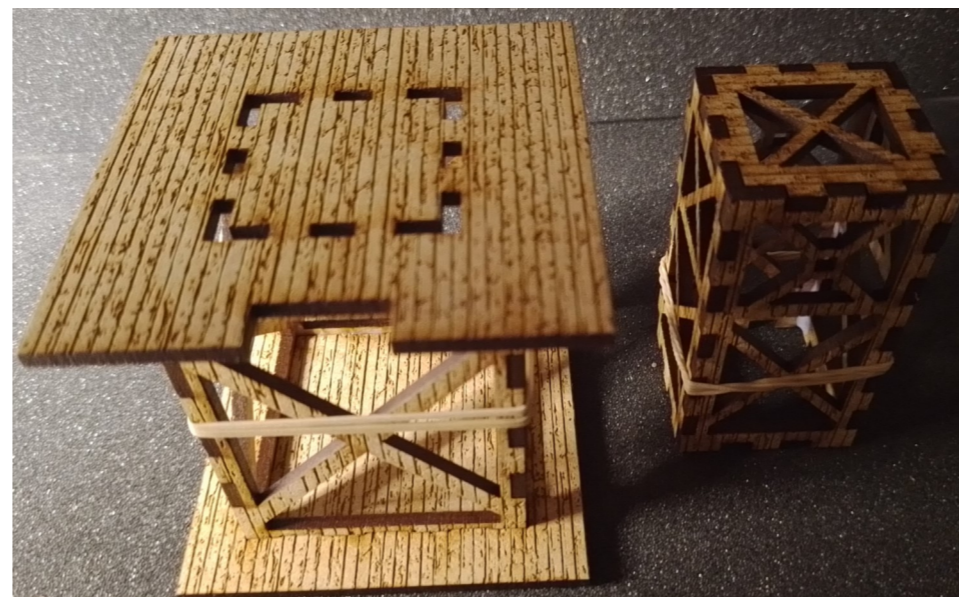
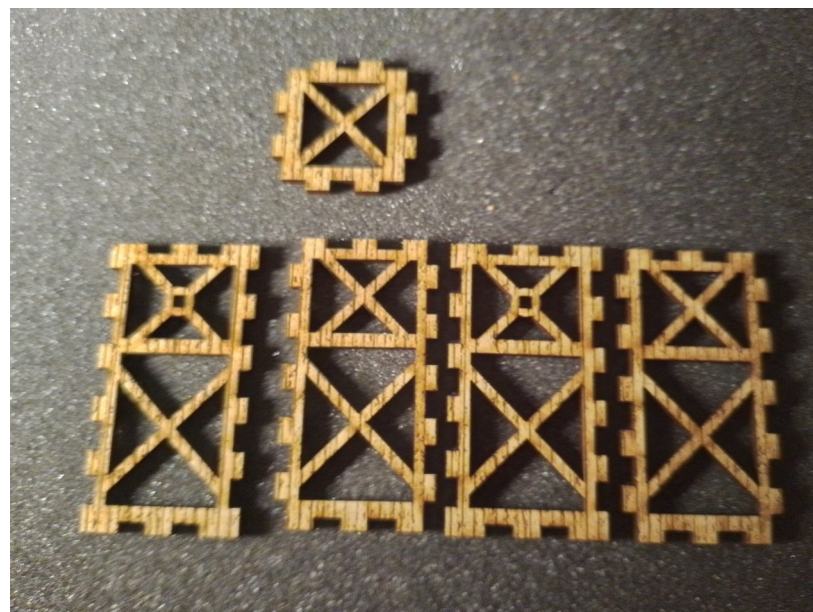

Assembly Instructions for Water Tower and Windmill

9: Glue shown piece onto the windmill wings.

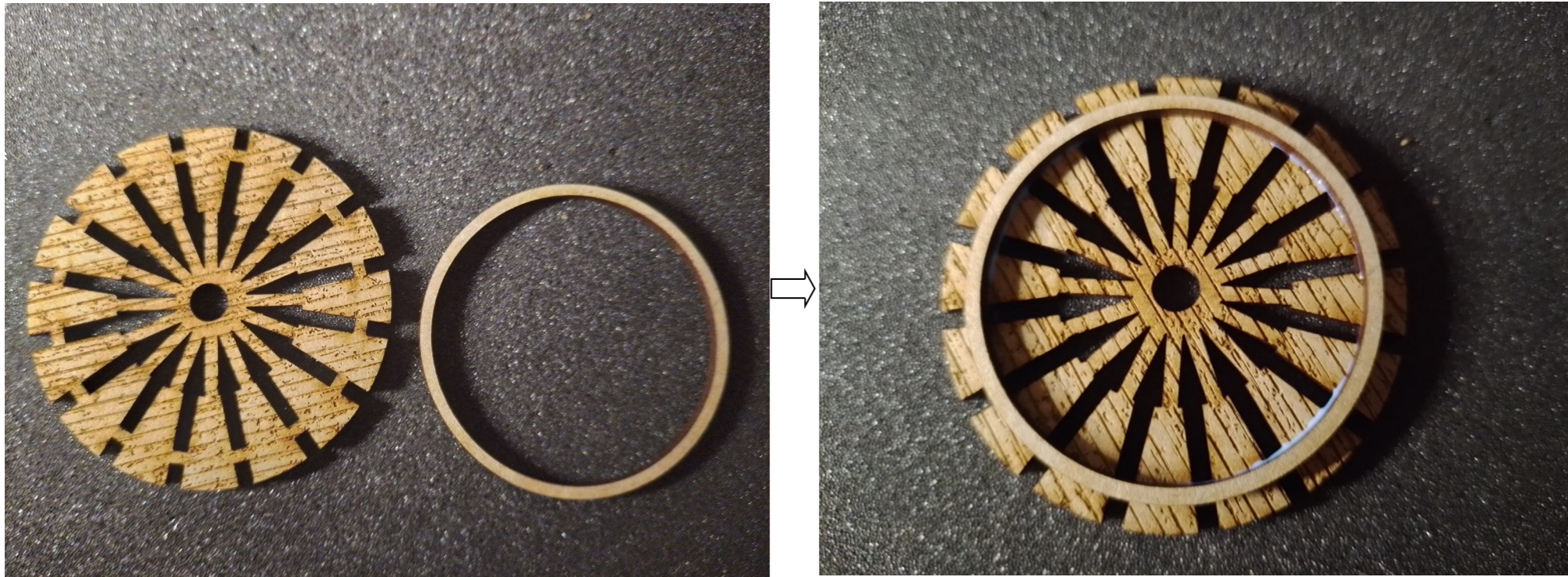

Assembly Instructions for Water Tower and Windmill

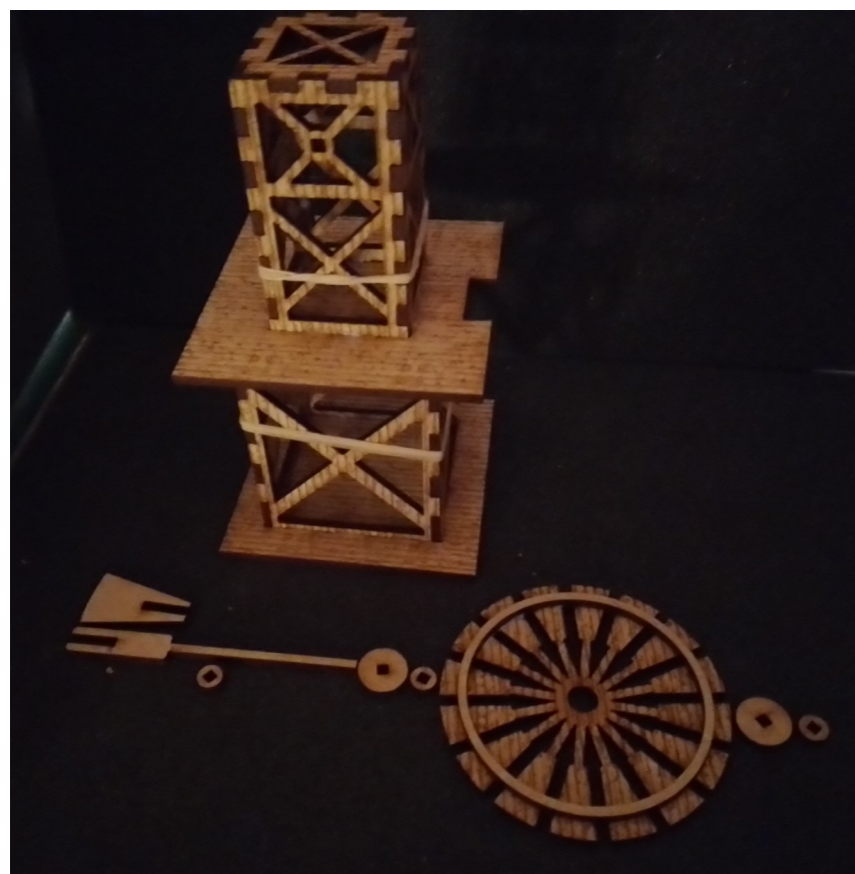

10: Add wings to top using shown pieces. Glue in order shown. Only add glue to wings as shown.



Add glue.

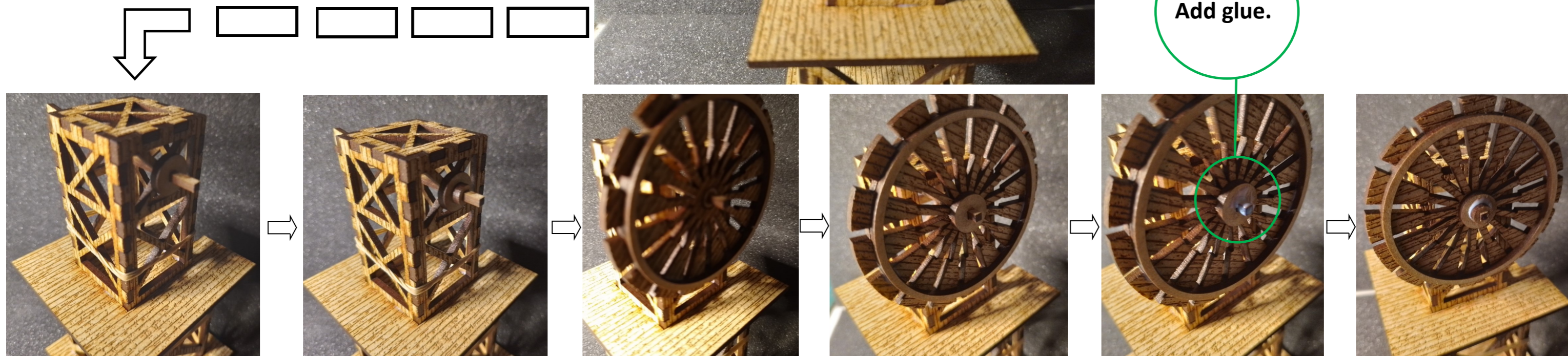

Assembly Instructions for Water Tower and Windmill



10: Add the ladder.

