

# Assembly Instructions for "Small Normandy Chateau"

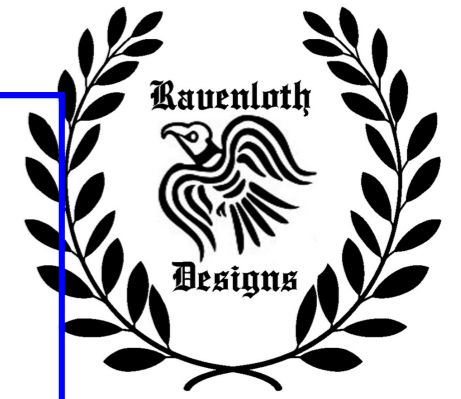

1: Glue window frames onto wall pieces and bay window pieces.

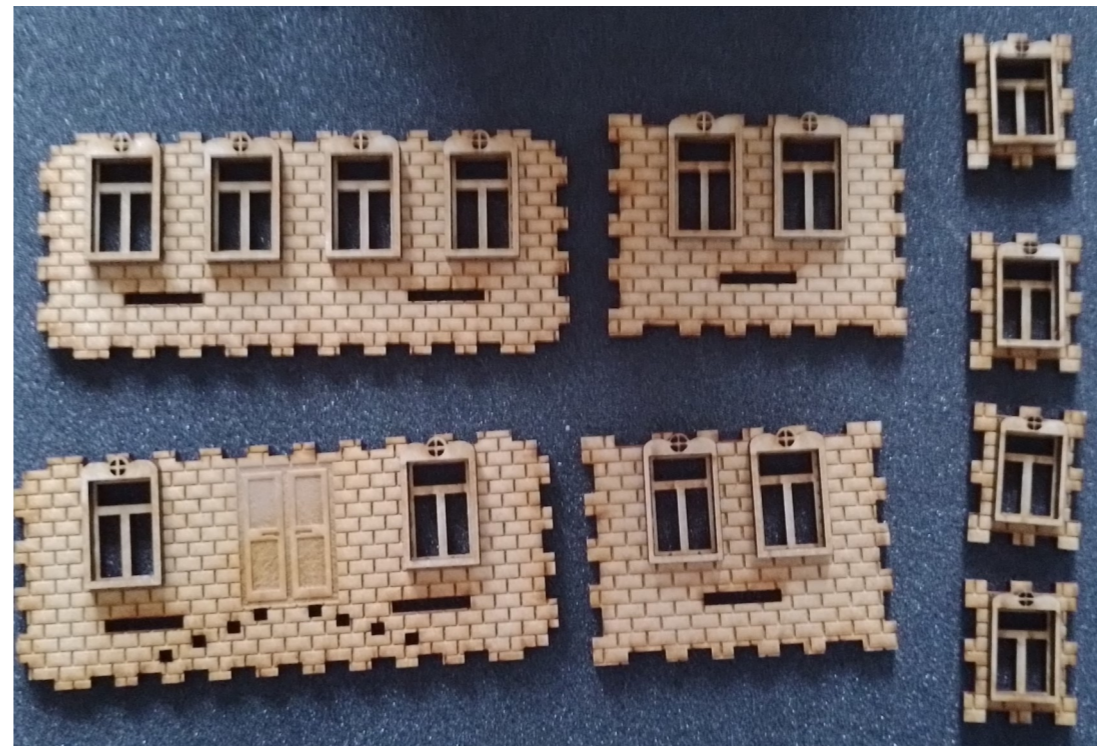
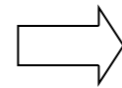
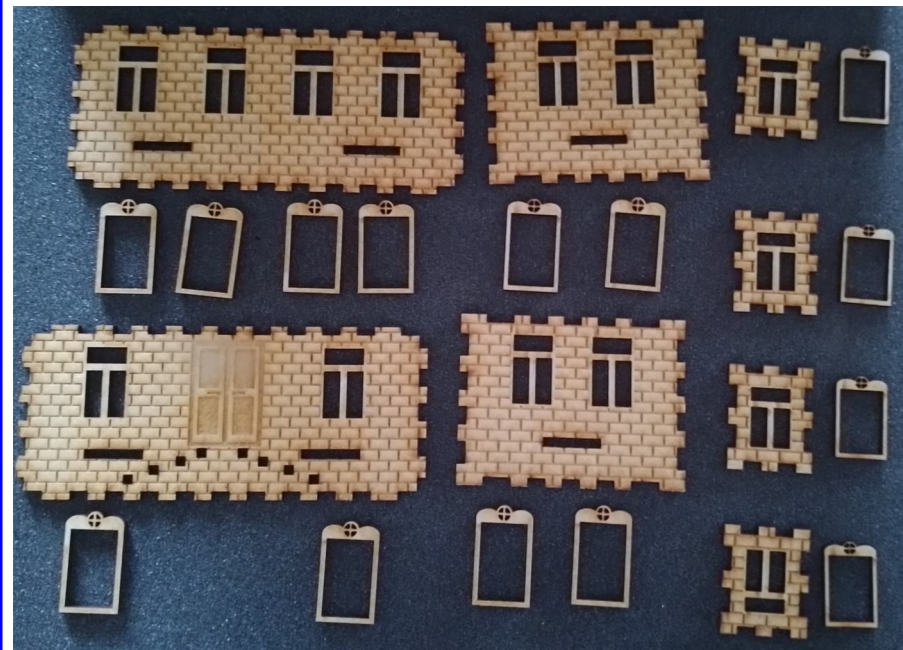

2: Glue piece A to the bottom of piece B. You can use piece C to better align piece A on B.

Do NOT glue piece C.

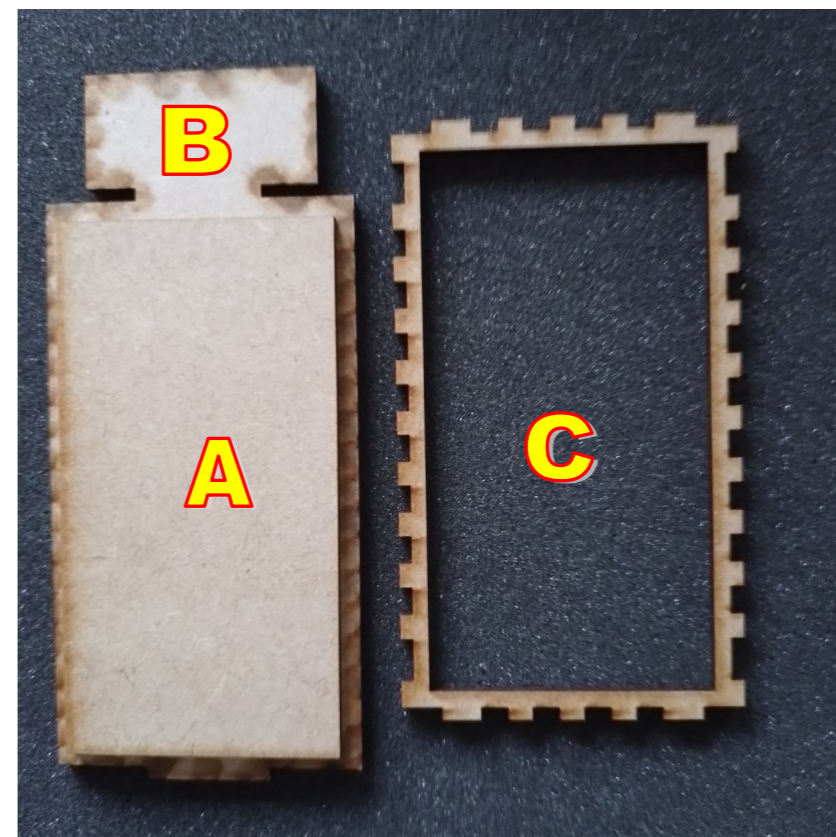
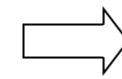
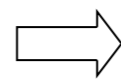
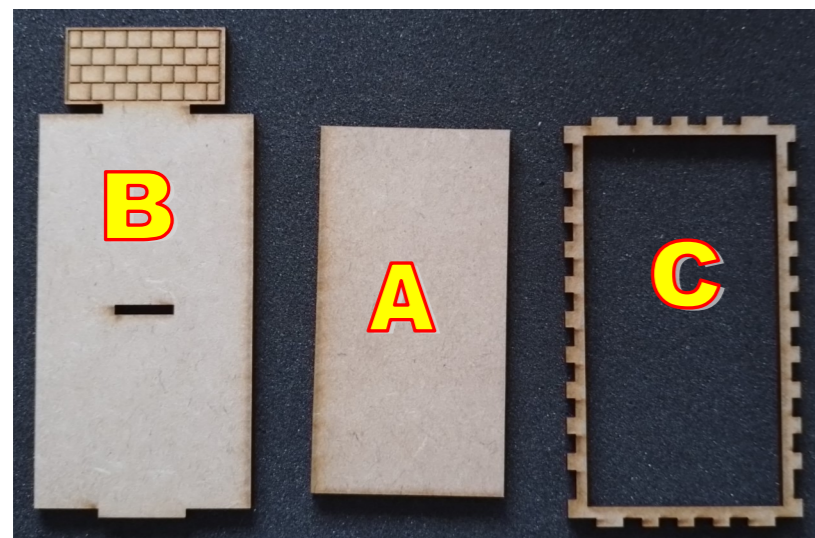

# Assembly Instructions for "Small Normandy Chateau"



3: Glue together shown pieces for the ground floor. Taps on piece E goes into holes on wall pieces.

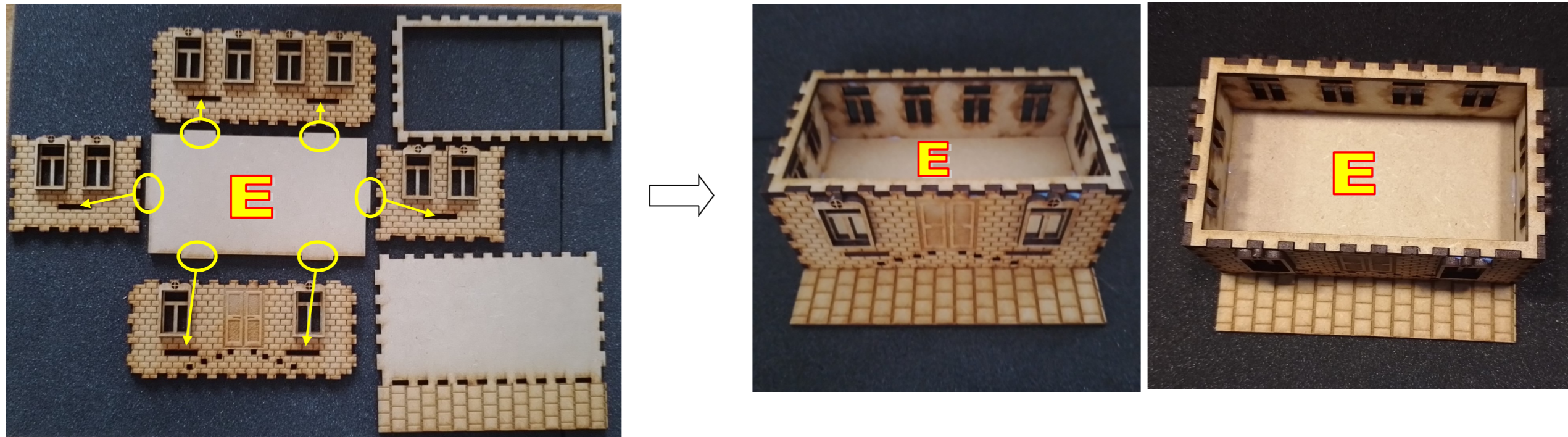

4: Glue stairs onto the front of the ground floor. Taps on stairs goes into holes in wall piece. Glue frame onto front door.

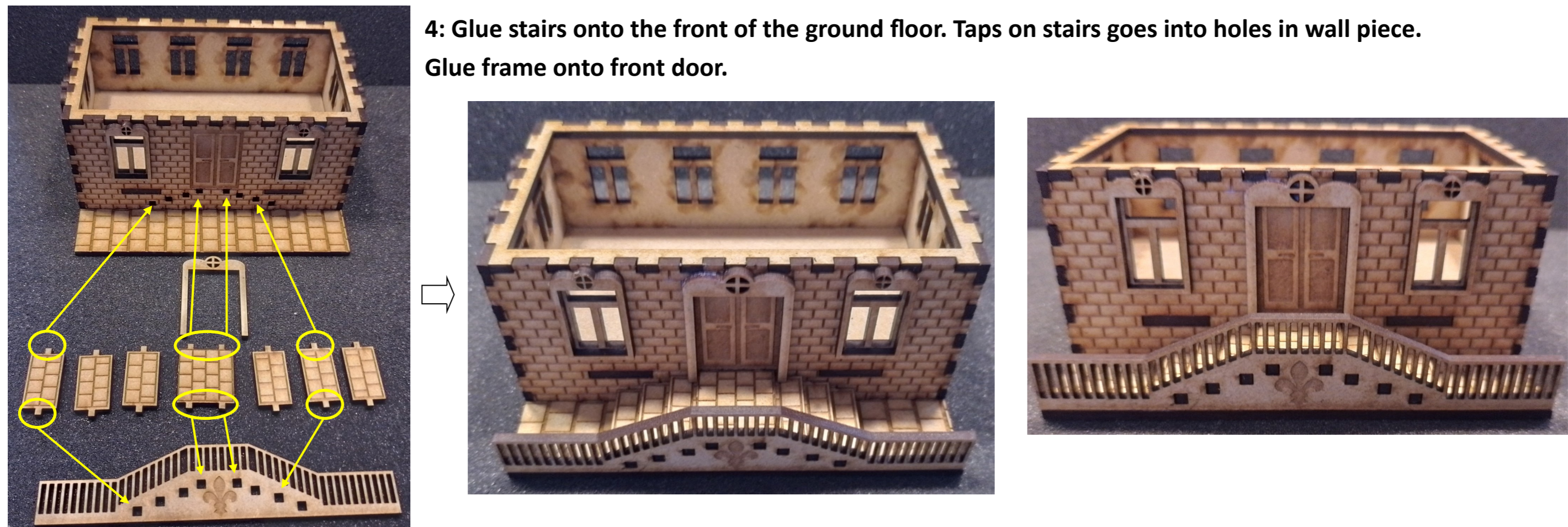

# Assembly Instructions for "Small Normandy Chateau"



5: Glue together shown pieces for the four bay windows on the 1st floor.

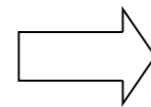
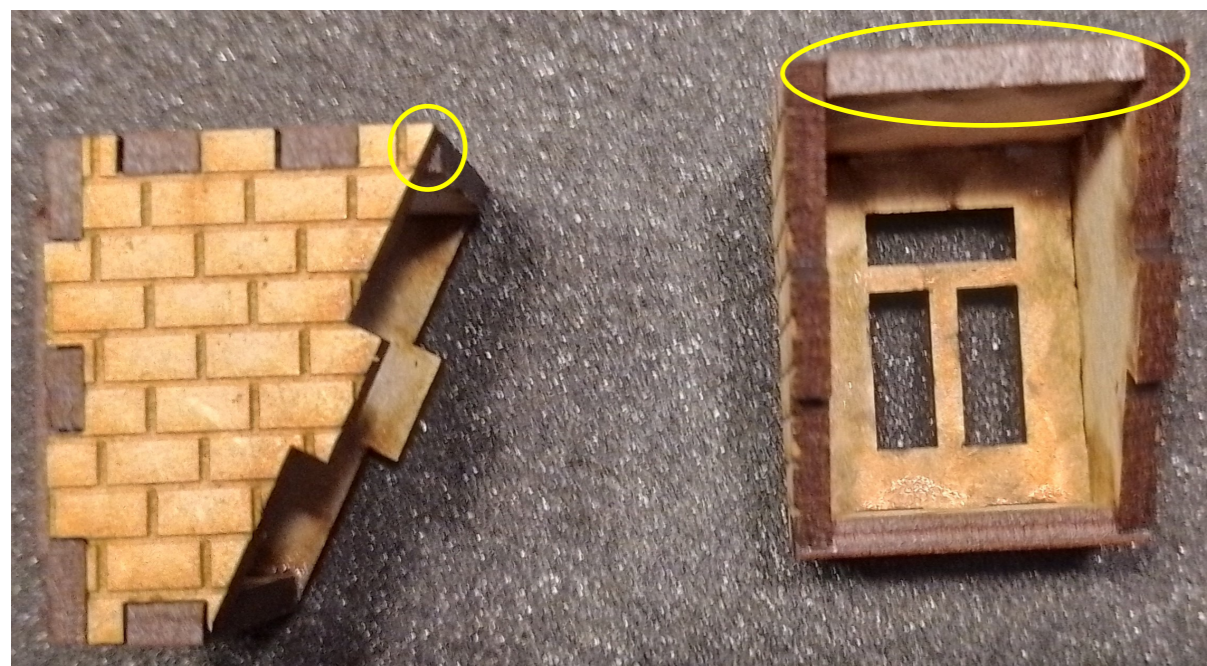
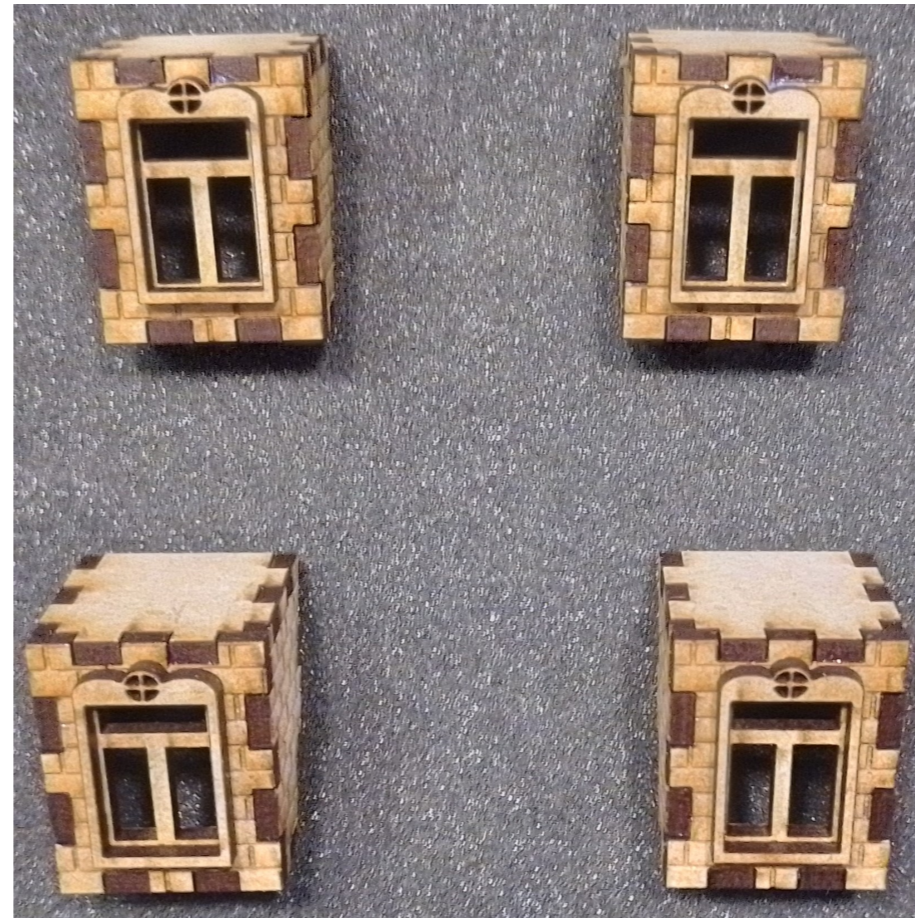
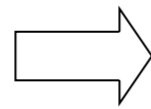

6: Cut the top edge on bay window, or use sandpaper to make it diagonal.

# Assembly Instructions for "Small Normandy Chateau"

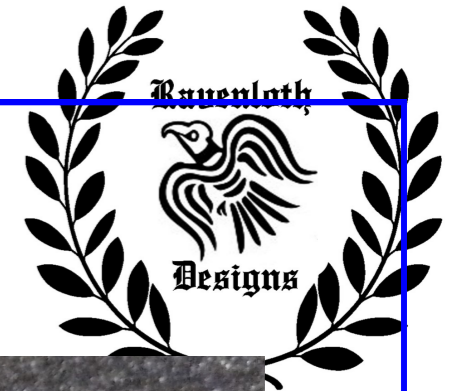

7: Glue door and window frame onto 1st floor gables.

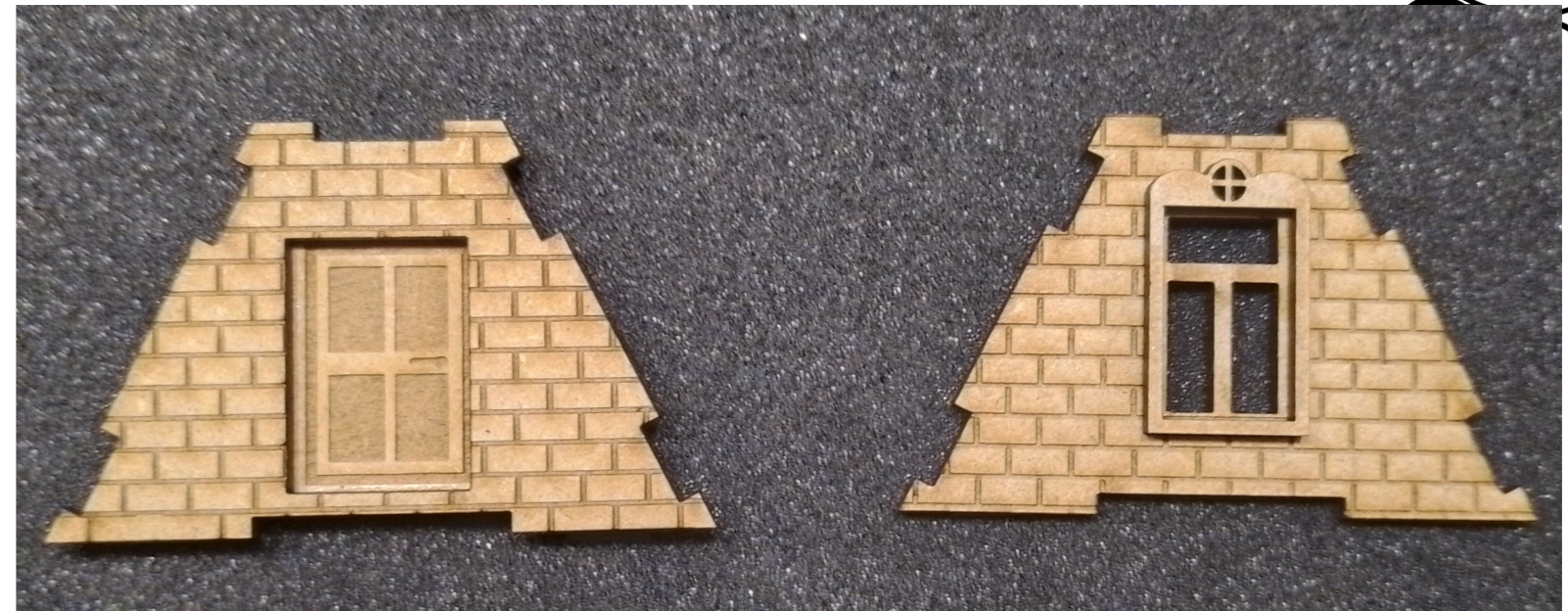
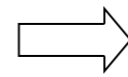
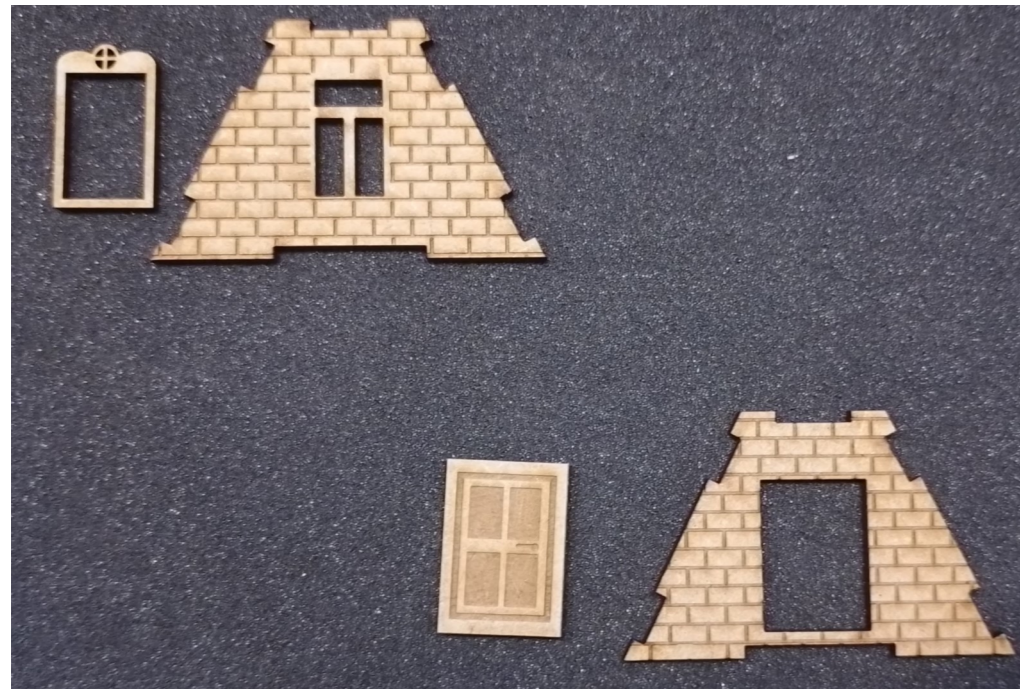

8: Glue together shown pieces for the chimneys (x2). Glue in the shown order.

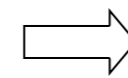
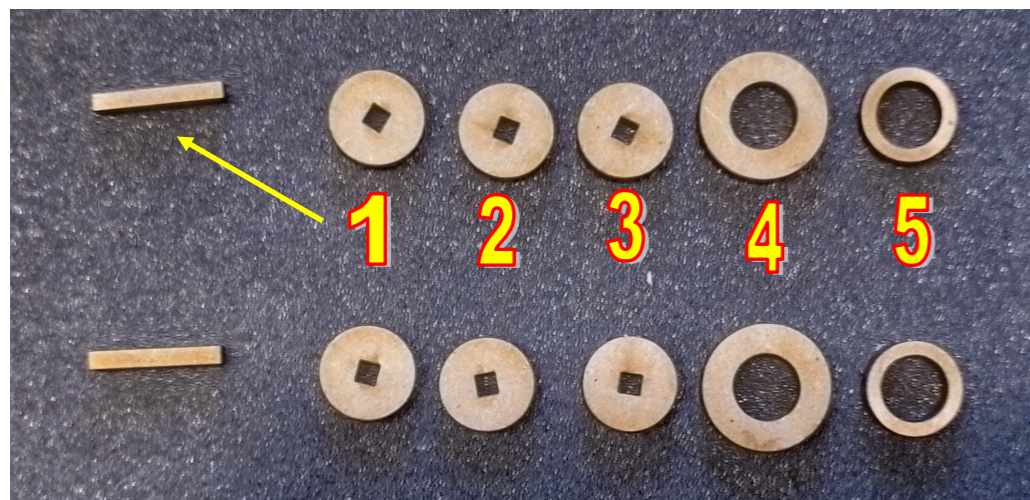

# Assembly Instructions for "Small Normandy Chateau"



9: Glue bay windows onto roof pieces for the 1st floor.

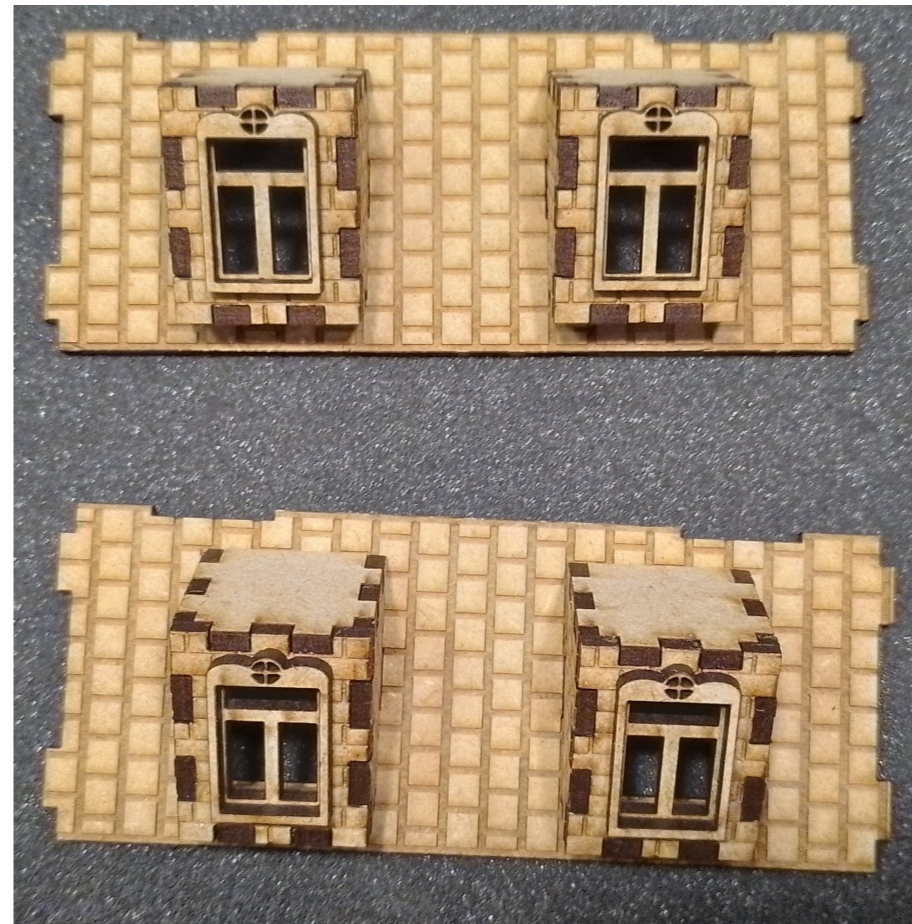
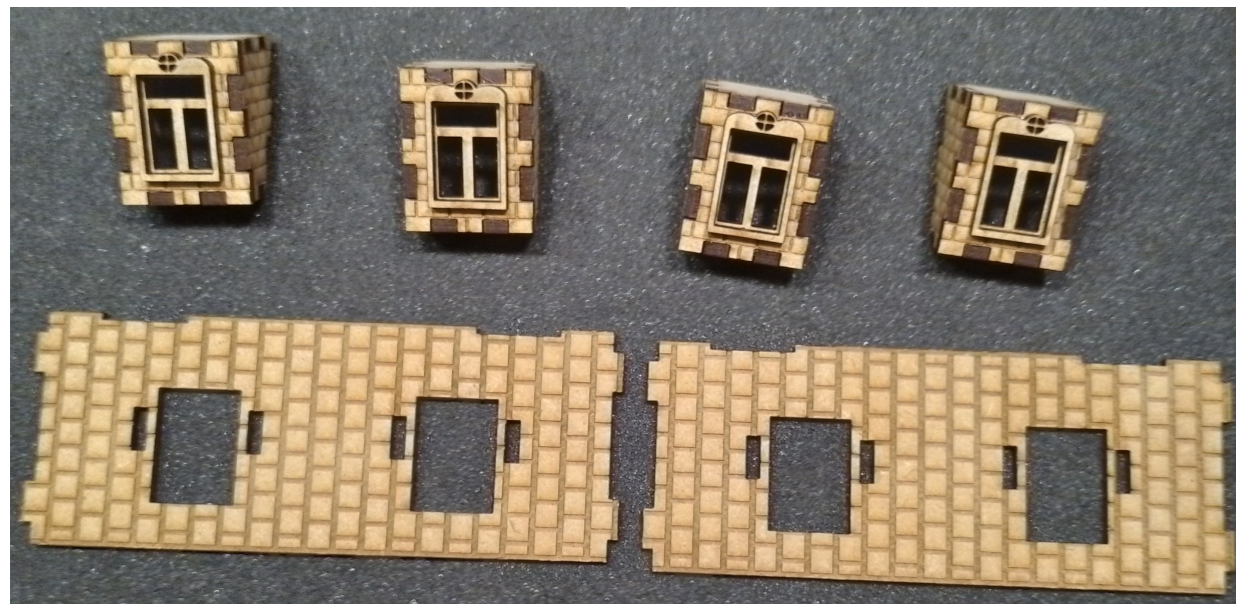

9: Glue small roof pieces onto bay windows.

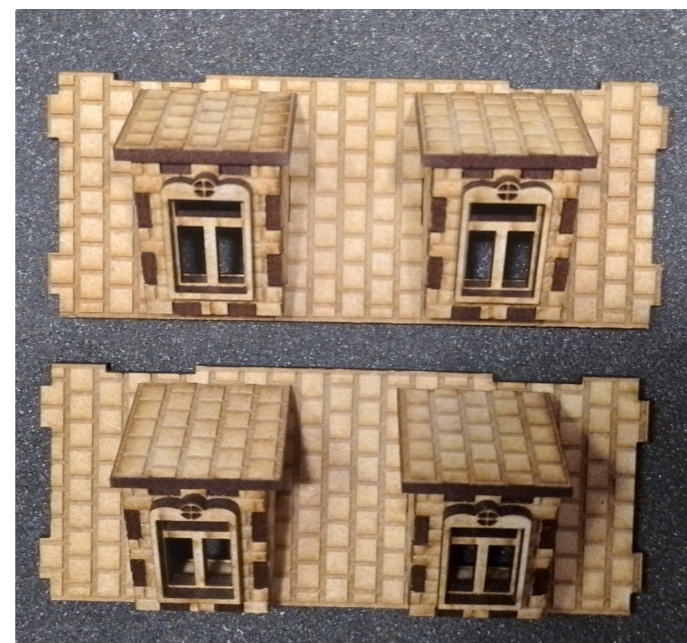
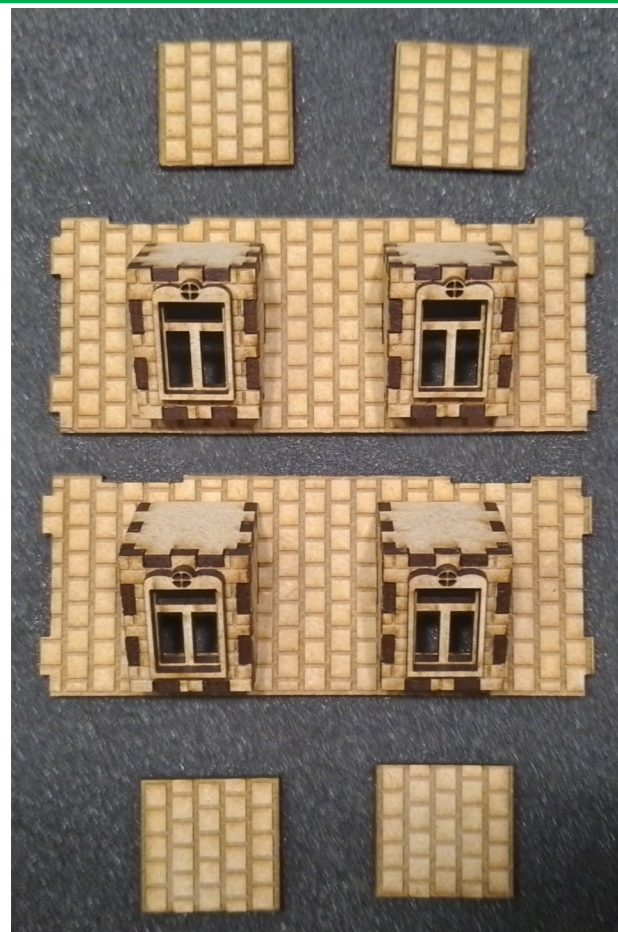

# Assembly Instructions for "Small Normandy Chateau"



10: Cut the two edges on shown piece, or use sandpaper, to make it diagonal.

11: Glue gables onto 1st floor.

**IMPORTANT!** If you want to be able to place miniatures on 1st floor during gameplay do NOT glue both sides of roof but only one.

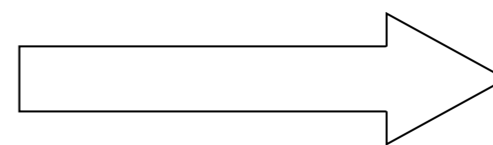

12: Glue together shown pieces for the roof.

## Assembly Instructions for "Small Normandy Chateau"

13: Glue chimneys and balcony onto 1st floor.

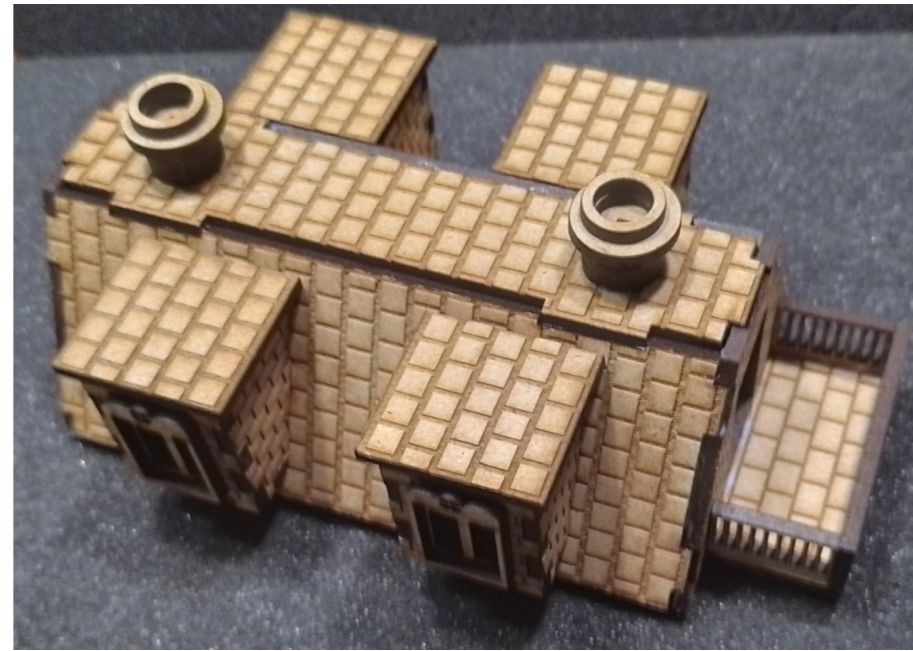
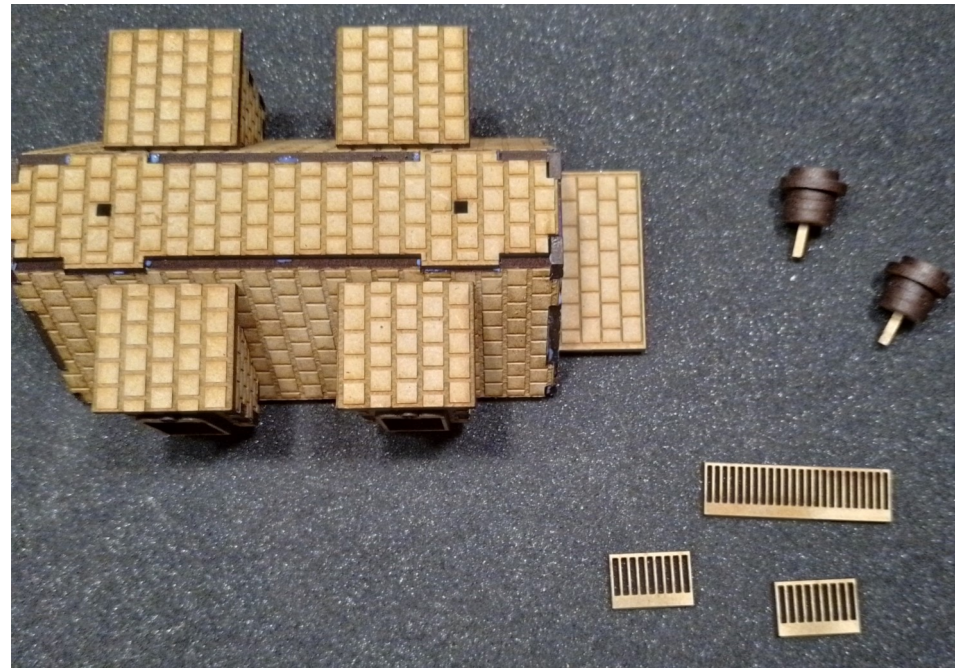

The French word chateau has a wider meaning than the English *castle*: it includes architectural entities that are properly called palaces, mansions or vineyards in English. The number of chateaus in France is estimated to about 45,000.

During ww2 in France, chateaus were often used by both axis and allies as headquarters for senior officers, Gestapo or military police. Some also functioned as headquarters for the Resistance. Escaping Allied pilots and important arms depots were also hidden at chateaus.

