

# Assembly Instructions for "French Greengrocer and Cheese Stores"

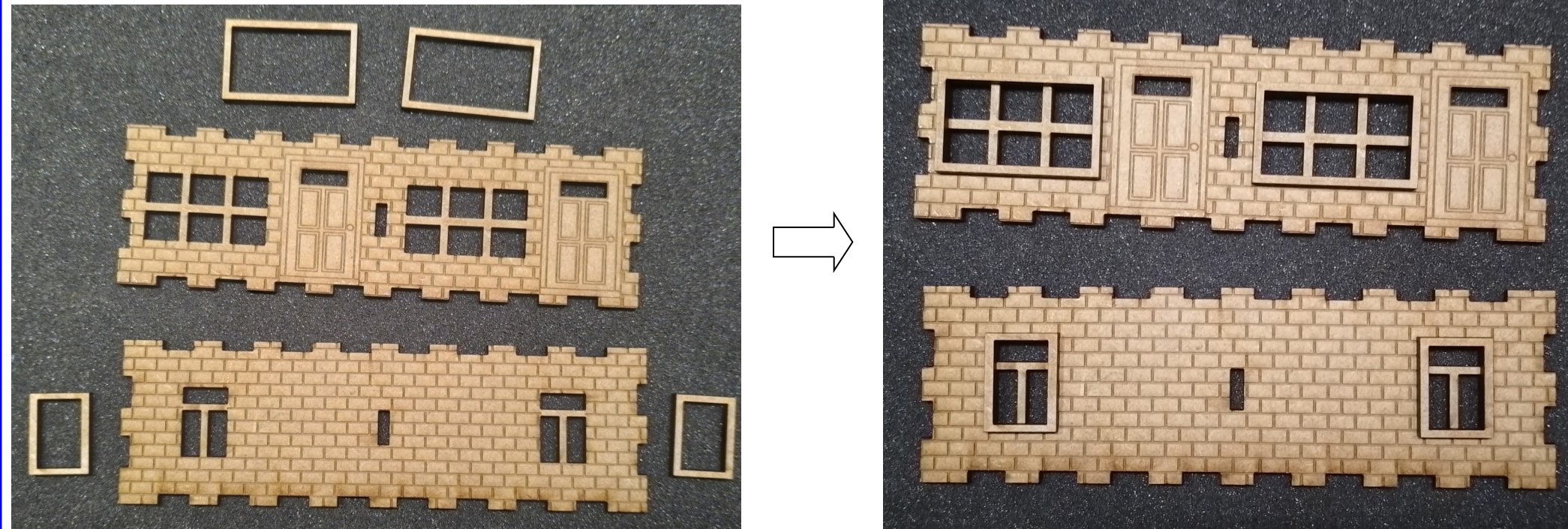

1: Glue window frames onto wall pieces.



2: Glue piece A to the bottom of piece B. Make sure it is centered. You can use piece C to better align piece A on B. Do NOT glue piece C.

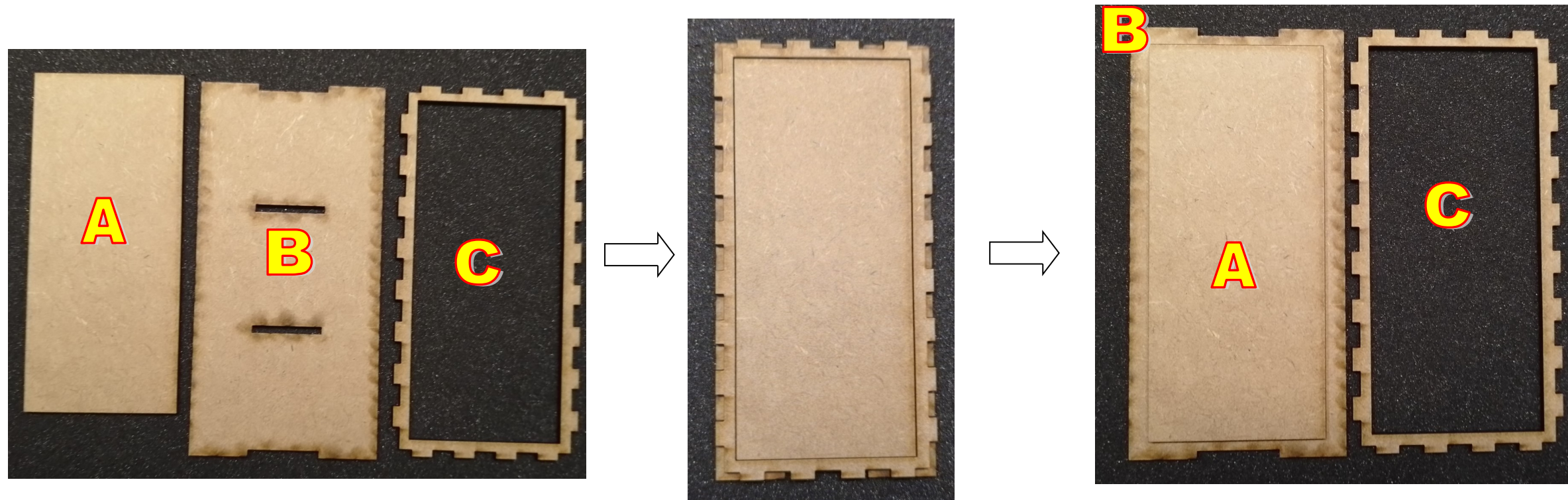



# Assembly Instructions for "French Greengrocer and Cheese Stores"



3: Glue together shown pieces for the ground floor. Taps on piece E goes into holes on wall pieces and ground floor.

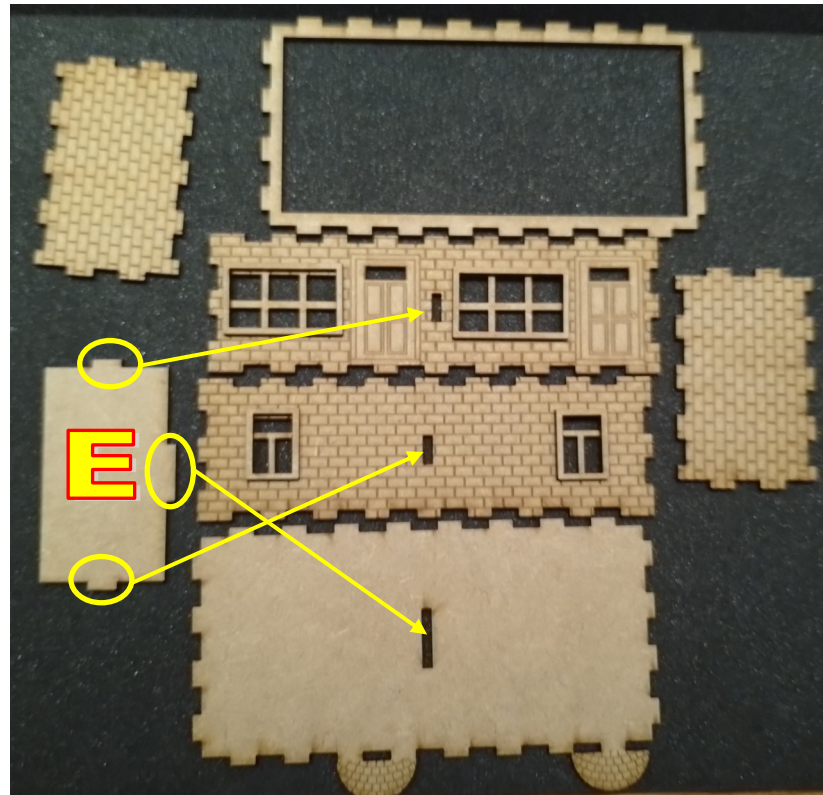

N.B. Add a rubber-band until glue is dry.

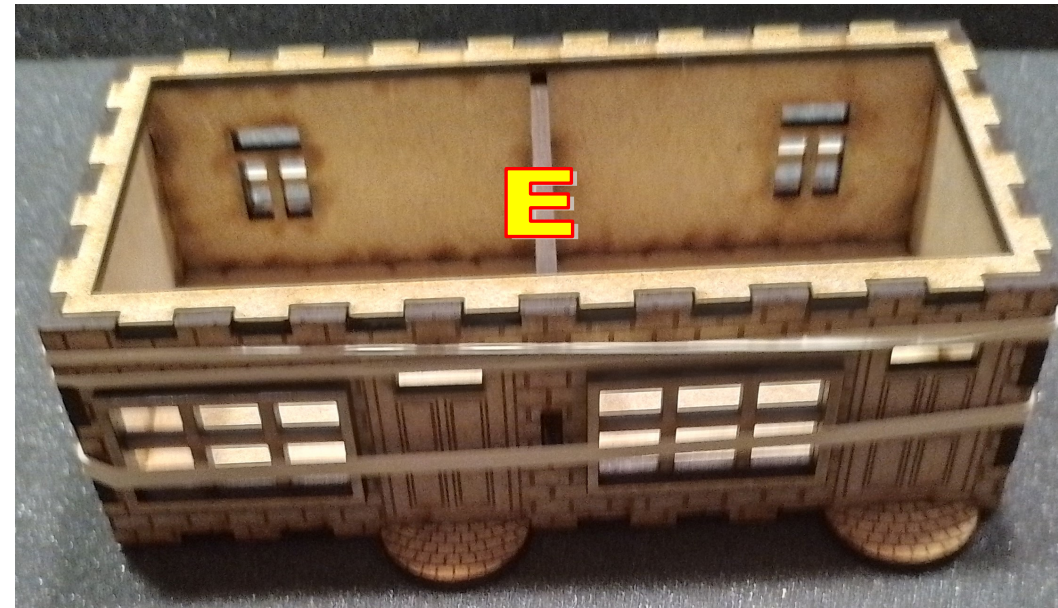
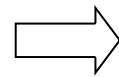

4: When glue is dry, remove rubberband and add door frames and shop signs.

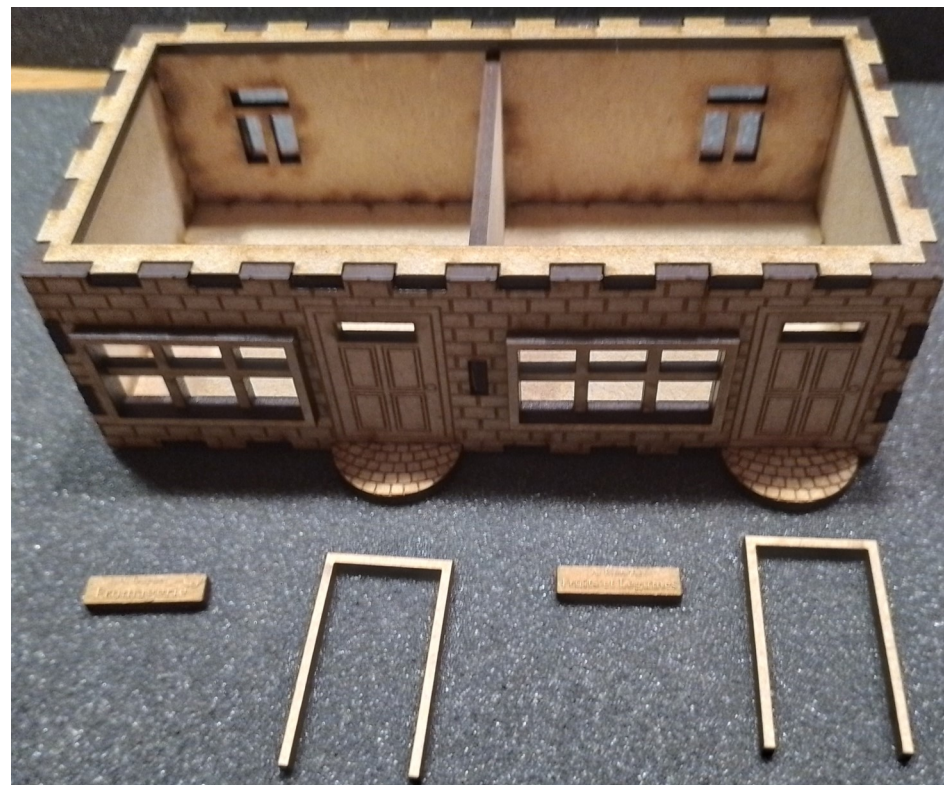



# Assembly Instructions for "French Greengrocer and Cheese Stores"



5: Glue together shown pieces for the roof.

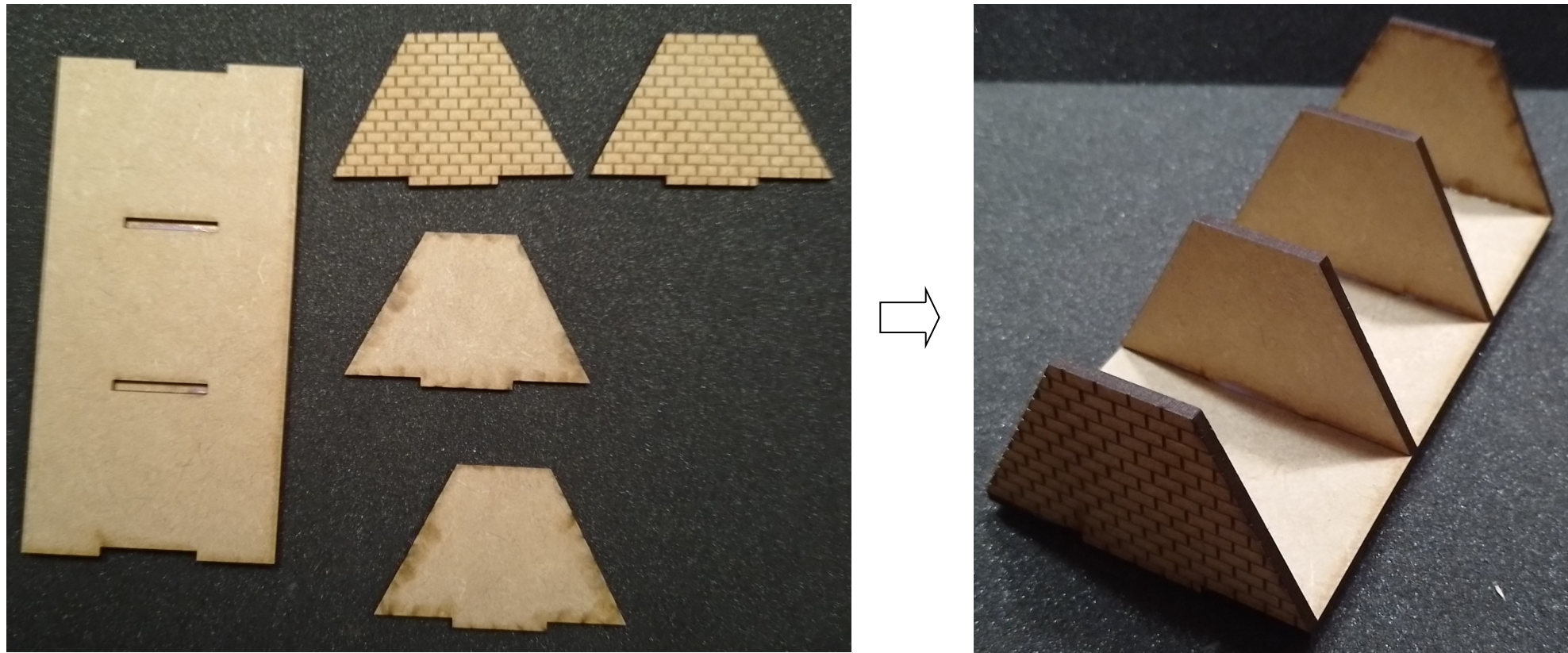

6: Glue top piece onto roof. Add rubberband, and let dry. Finally glue on the last pieces, and add rubberband until glue is dry.

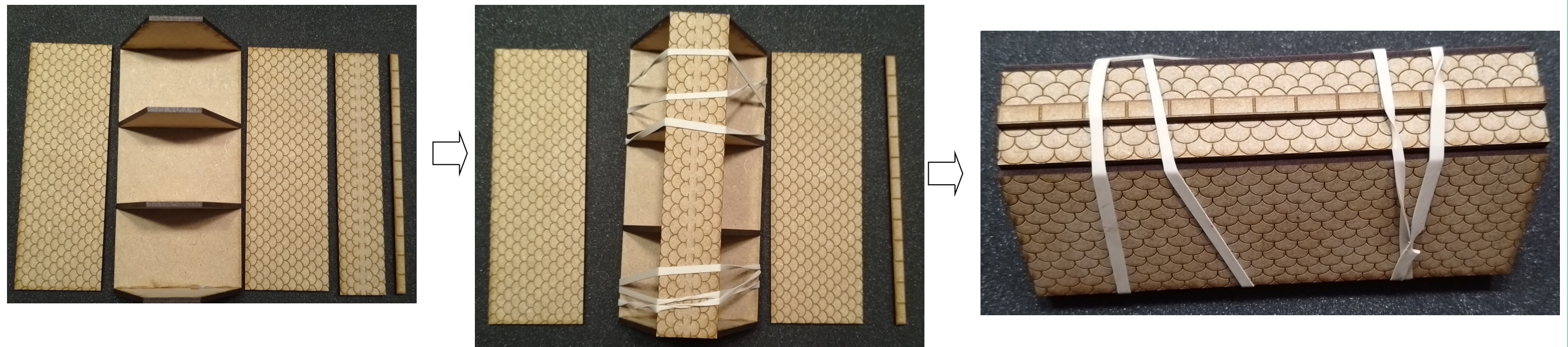



# Assembly Instructions for "French Greengrocer and Cheese Stores"

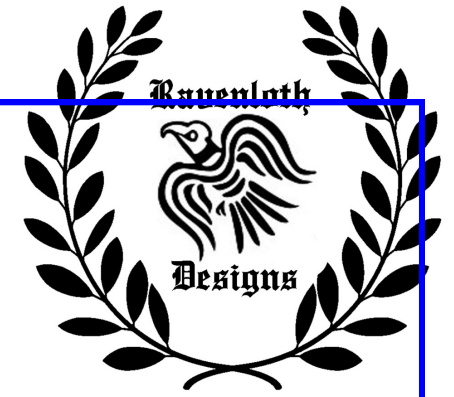

The signs for the shops reads:

H. Dupont—Fromagerie (Cheese Shop)

A. Blancher—Fruits et L'égumes (Fruit and vegetables)

N.B. If you want to add furniture such as store counters and shelves to the model, we recommend our Furniture Pack.

<https://fatherandsongaming.org/products/furniture-pack>

