

Assembly Instructions for "Corvette"

1: Glue together shown pieces 5 x A & 5 x B (sandwich)

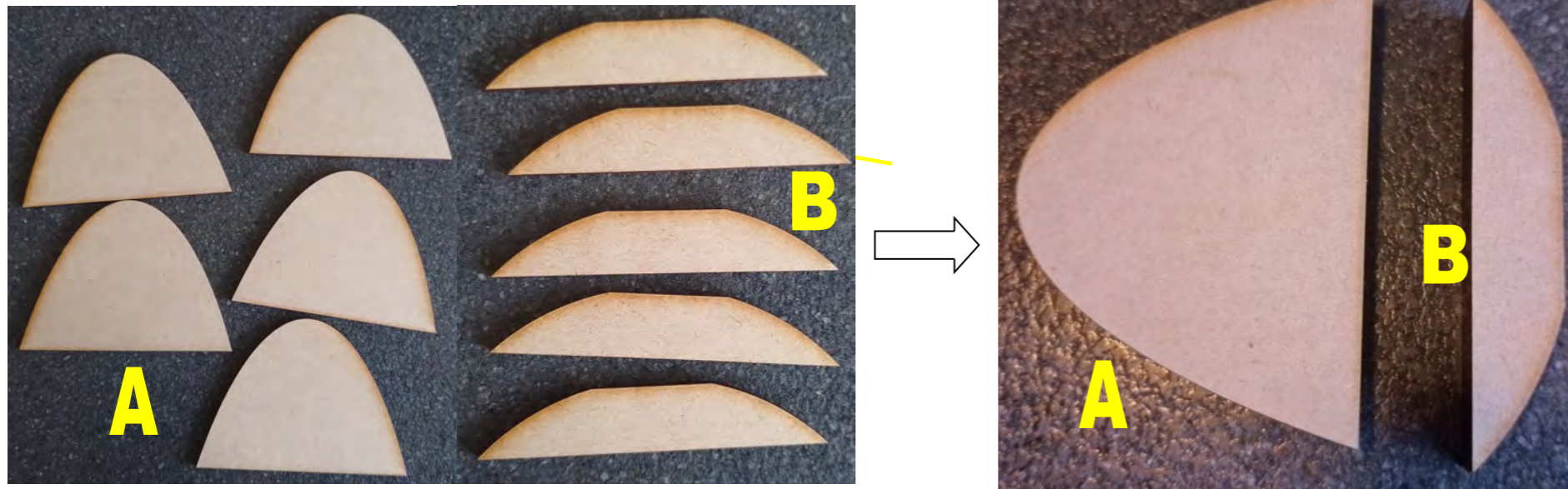

2: Glue together shown pieces for the ship sides. (sandwich x 2) N.B. Notice, that there is a slight difference in the 3 holes in both ends. (Green and red circles.)

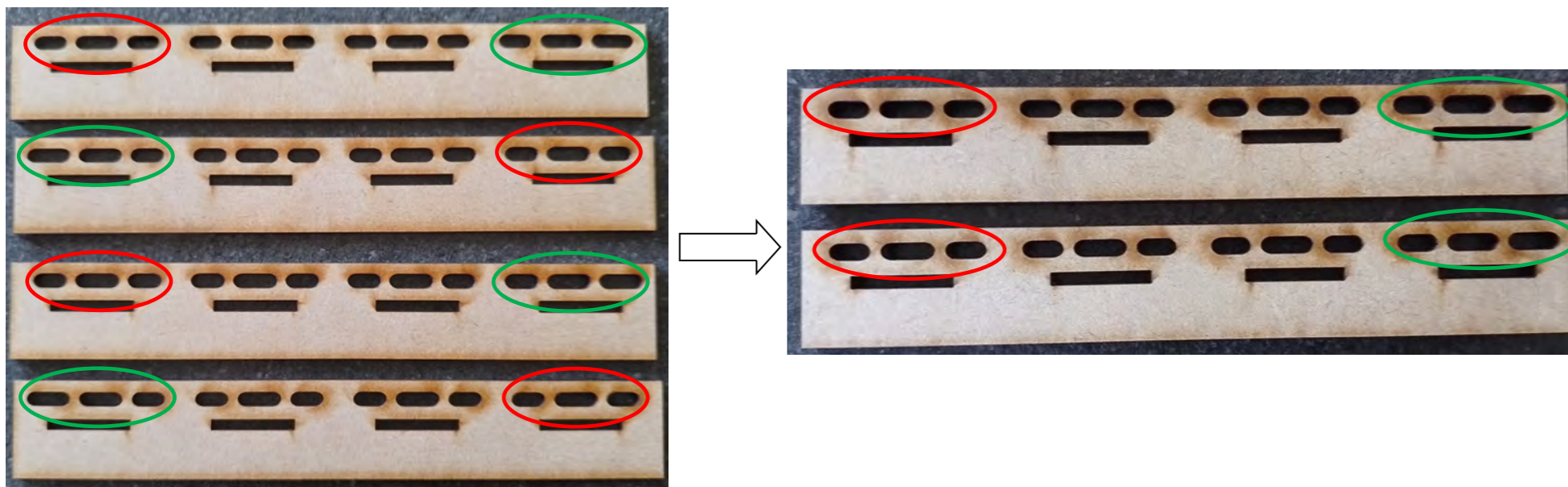

3: Glue together shown pieces for the depth charges. When glue is dry, use sandpaper to make the "bottom" a little flat/plane.



4: Glue together shown pieces for the main funnel. Glue pieces 4 onto 5. Six mm of piece 5 will be visible. Then glue on 1, 2, 3 in said order to the opposite end of where 5 is visible.



Assembly Instructions for "Corvette"



5: Glue together shown pieces E + 3 x C & 4 x D (sandwich)

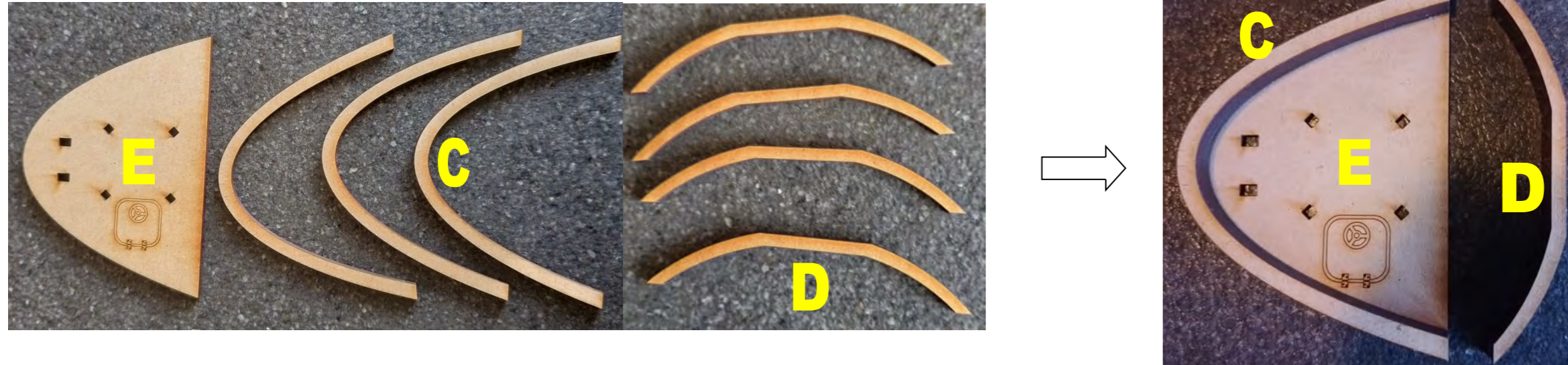

6: Glue shown pieces together for the cable hoist

Glue in the order shown.

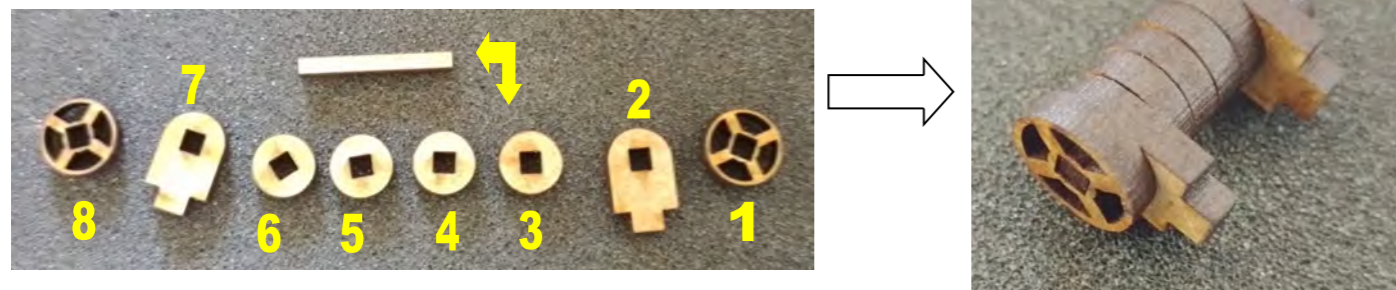

7: Glue together shown pieces for the marker lights and the Air/Surface warning radar.

Marker lights position: Front starboard (Green), Front port side (Red), Aft (White).

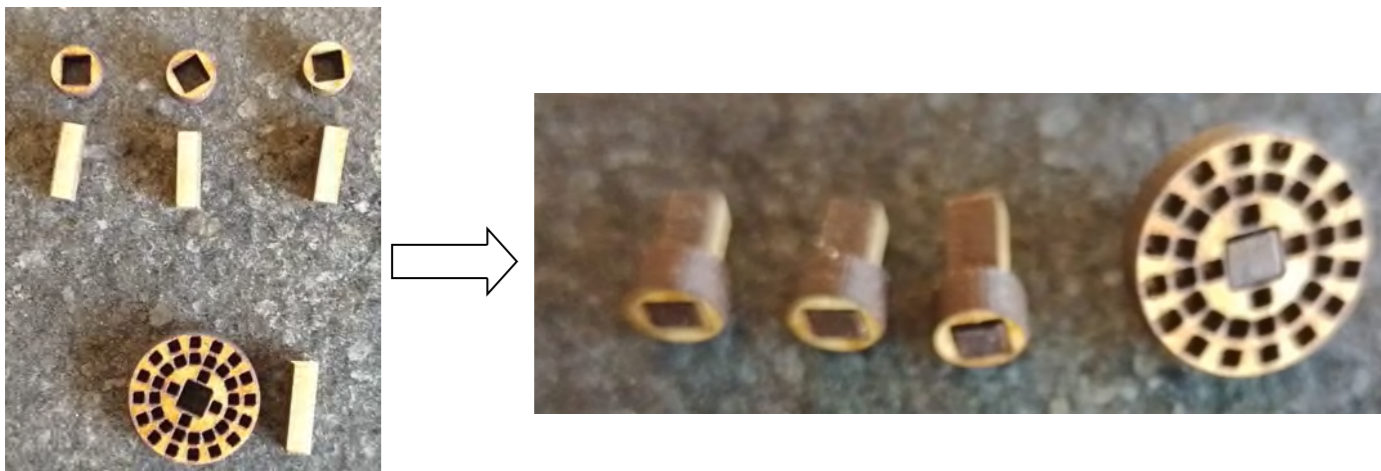

8: Glue together shown pieces for the air intake funnels.

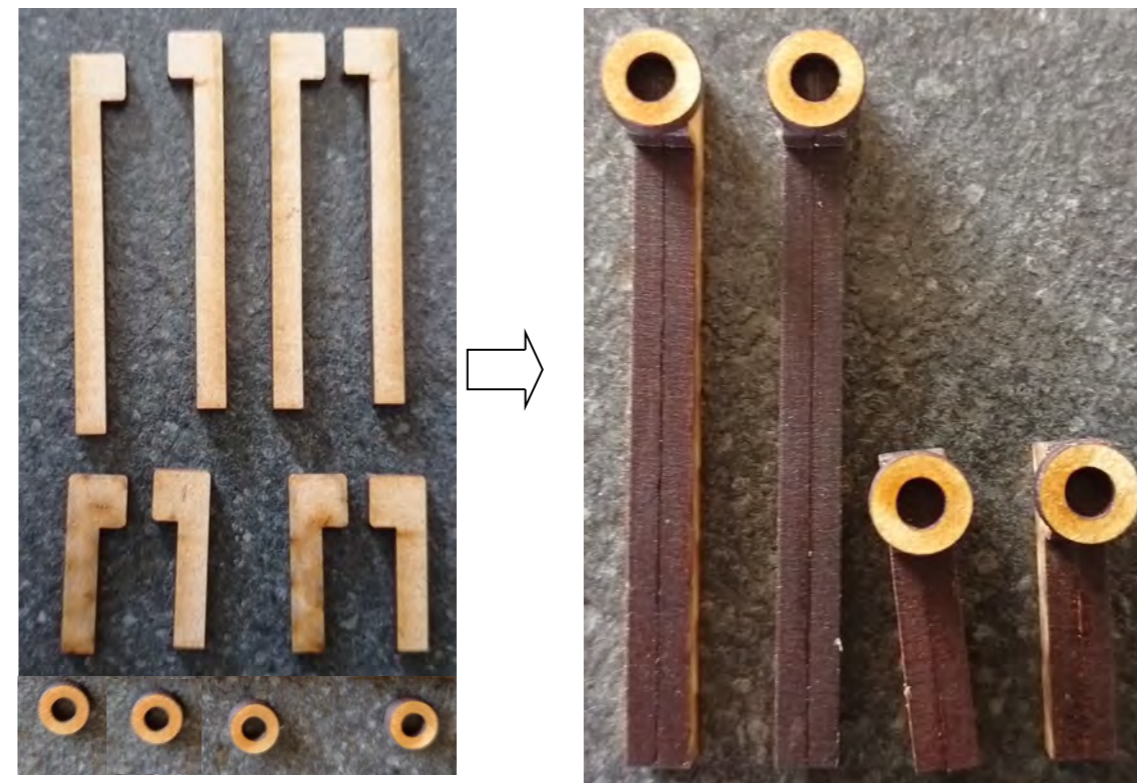

Assembly Instructions for "Corvette"

9: Glue posts for the cable railing and mooring gear onto the ship railing. Glue on parts as shown.

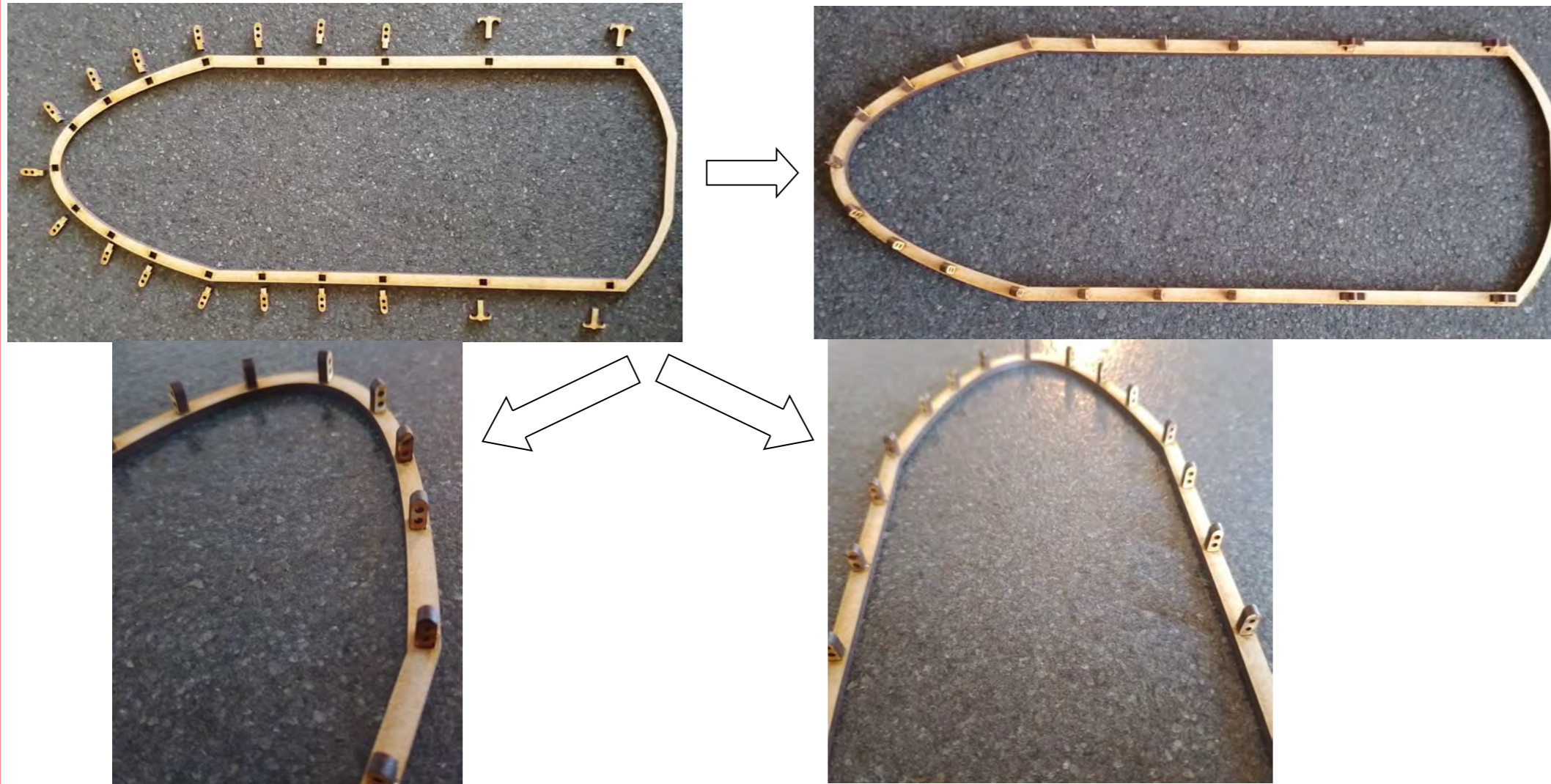

11: Glue together shown pieces for the surface search radar.



10: Glue together shown pieces for the deck guns (x2). Glue in the shown order. Wait with part 7 for now.

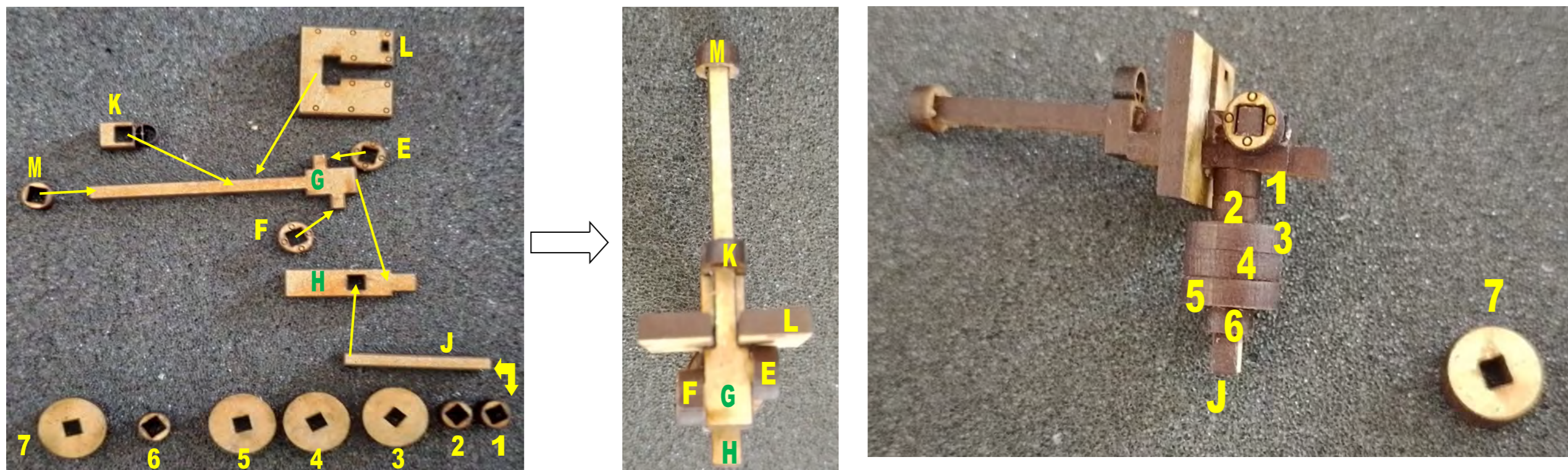

Assembly Instructions for "Corvette"

12: Glue together shown pieces for the two weapon platforms.

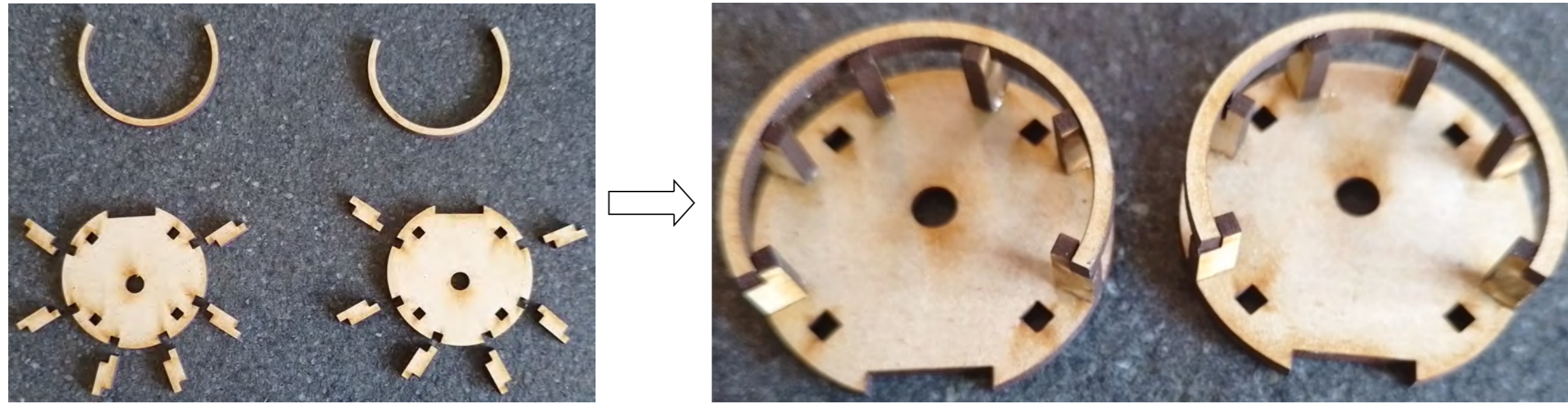

13: Glue together shown pieces for the depth charges platform.

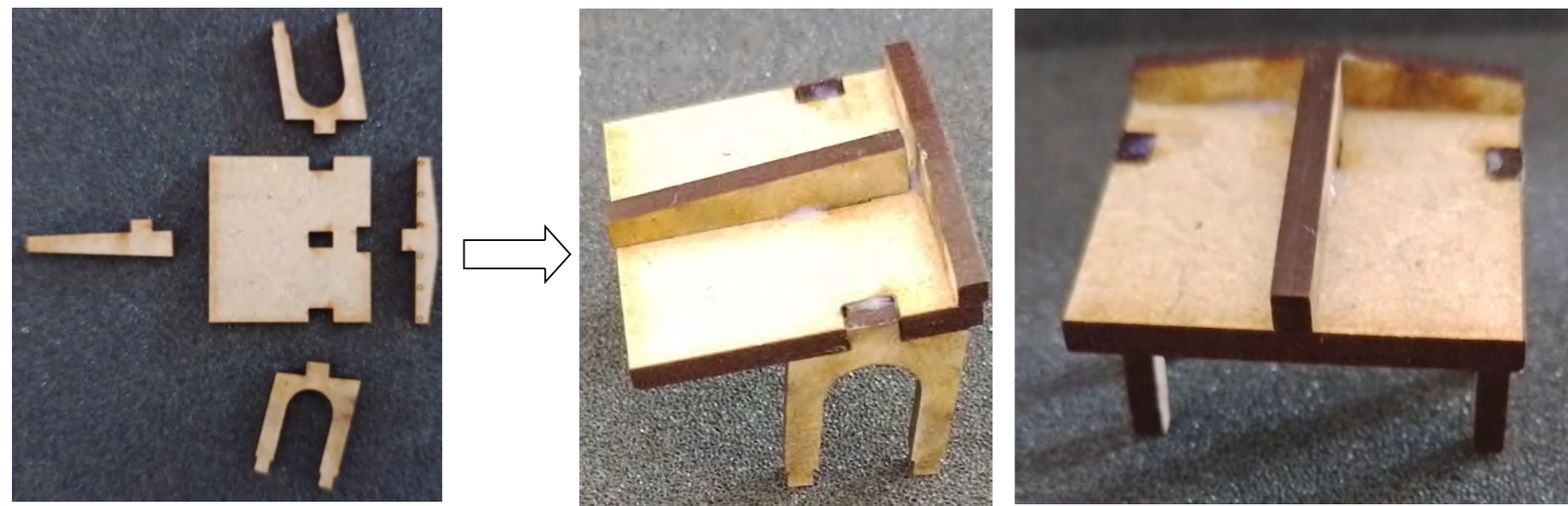

15: Glue together shown pieces for the search light.

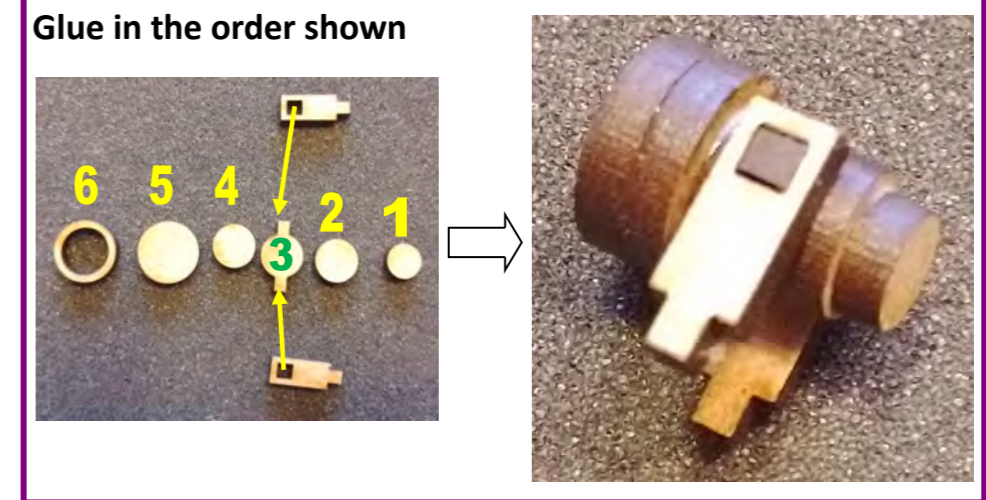

14: Glue together shown pieces for the two staircases to the bridge.

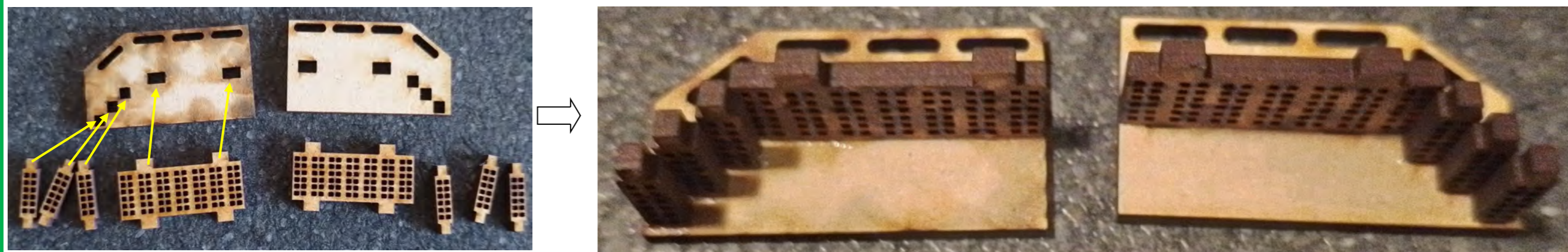

Assembly Instructions for "Corvette"

16: Glue window frames onto the bridge parts

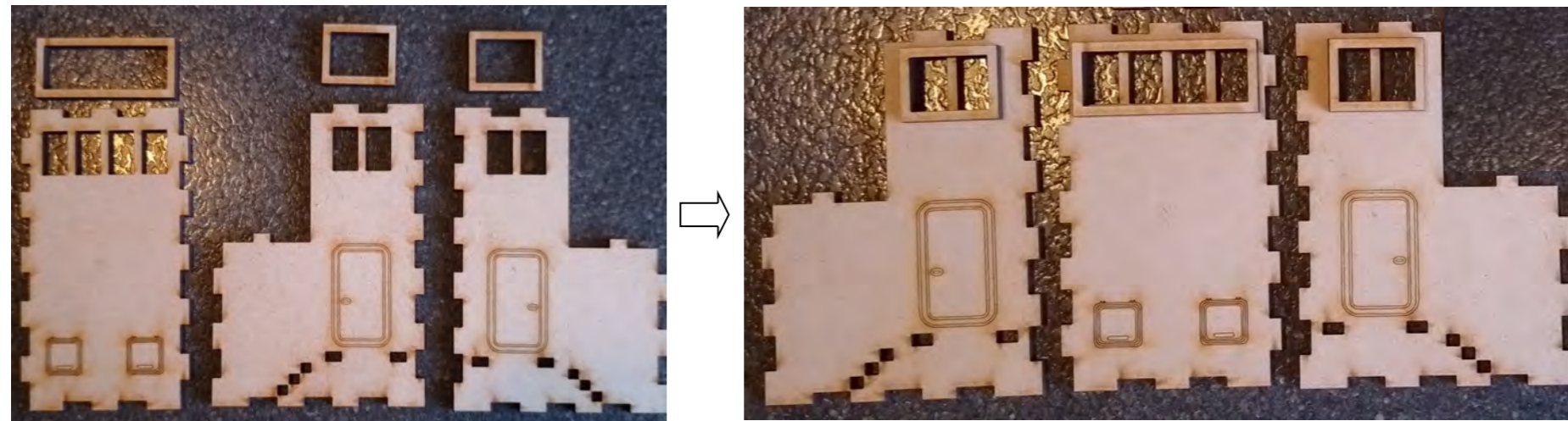

17: Glue together shown pieces for the Bridge.

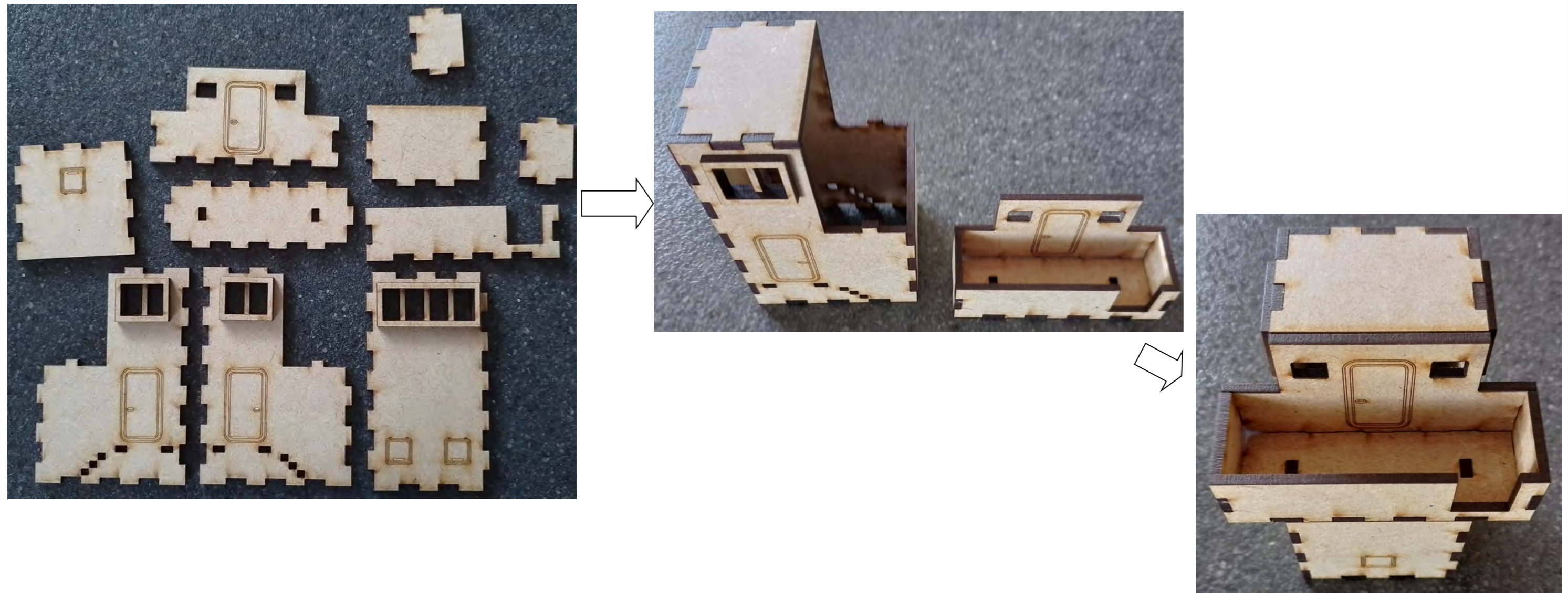

Assembly Instructions for "Corvette"

18: Glue the search light onto the roof for the Bridge.

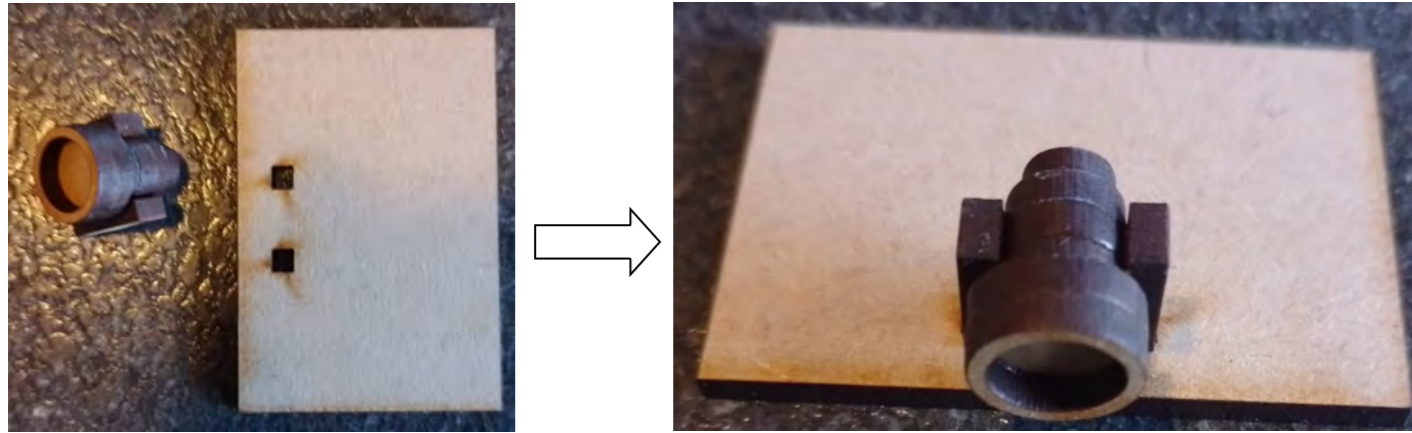

19: Glue the deck gun onto the weapon platform. ONLY add glue onto the squared tap, so that the gun can turn. Glue on part 7.

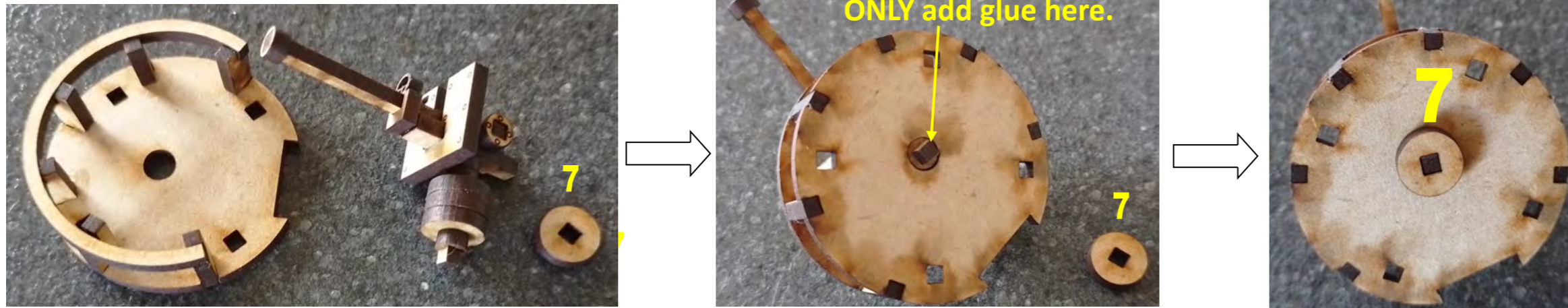

20: Glue the sides onto the side of the ship's deck . The sides may need "gentle strokes" from a hammer to get on. Then glue on parts A and B to the bottom of the ship's deck.

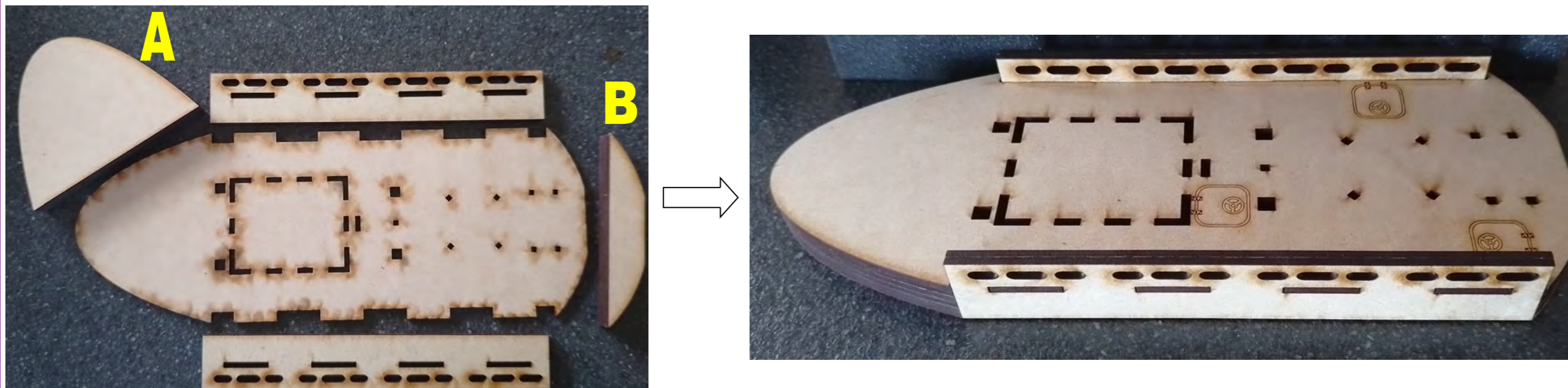

Assembly Instructions for "Corvette"



21: Glue shown parts onto the ship's mast. Marker light 1 and 2 face forward. Marker light 3 face backwards as well as piece 4. The two radars face forward.

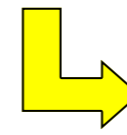
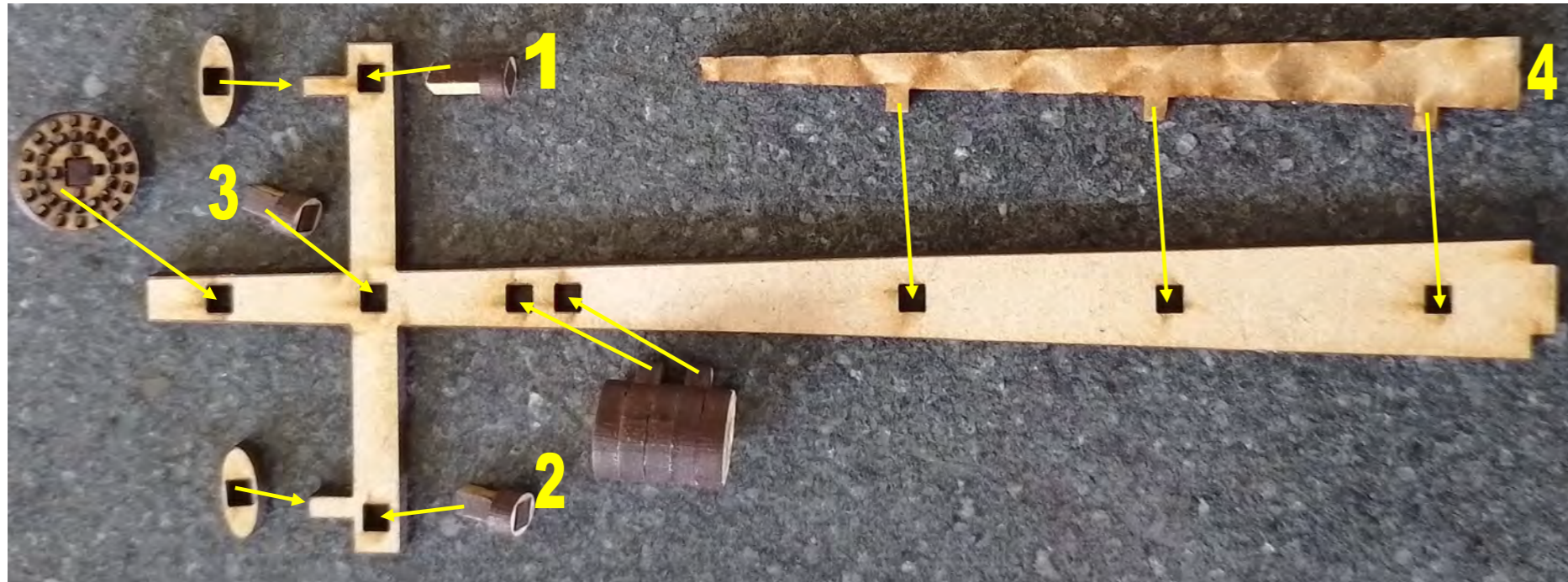

22: Glue staircases onto both sides of the ship's Bridge.

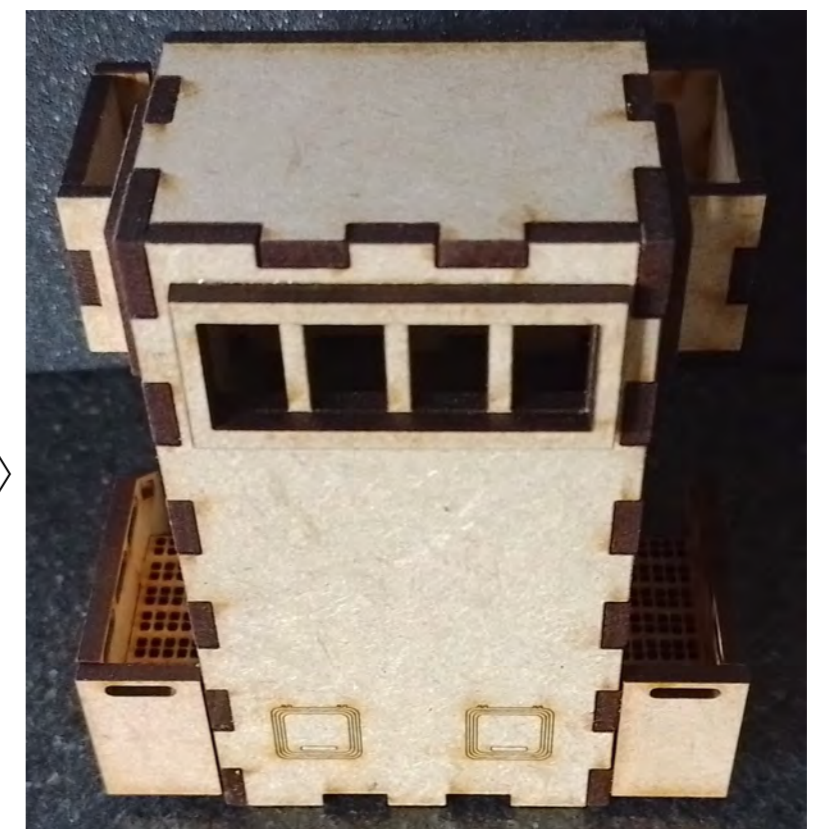
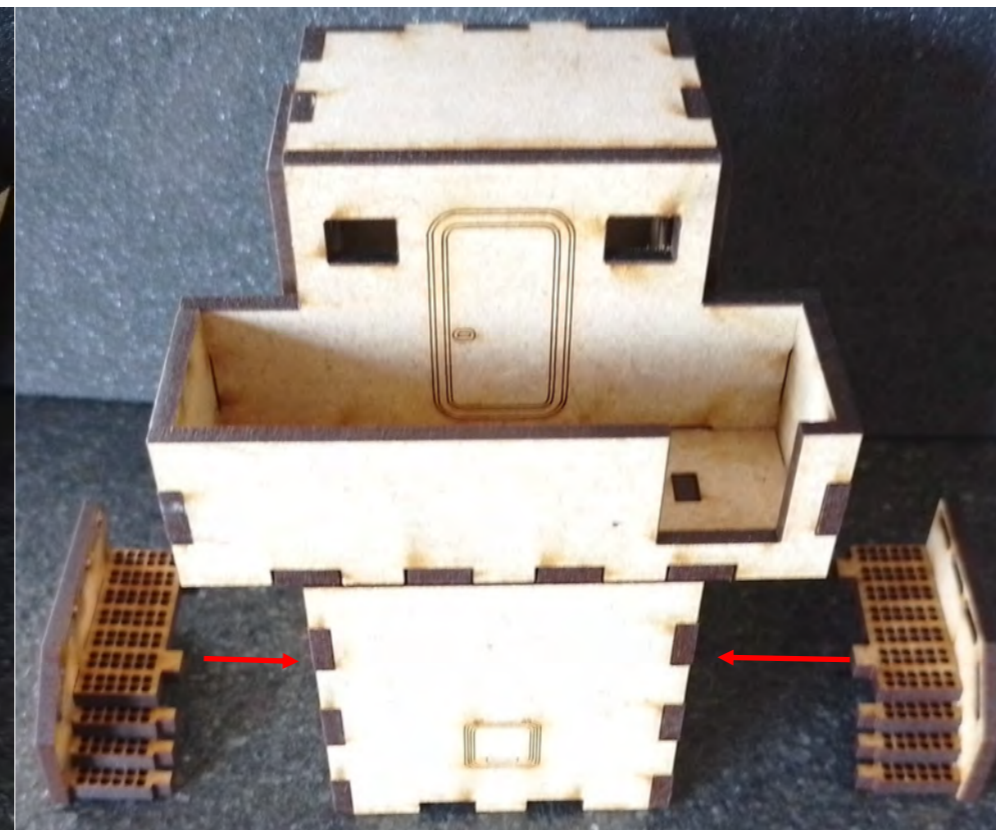
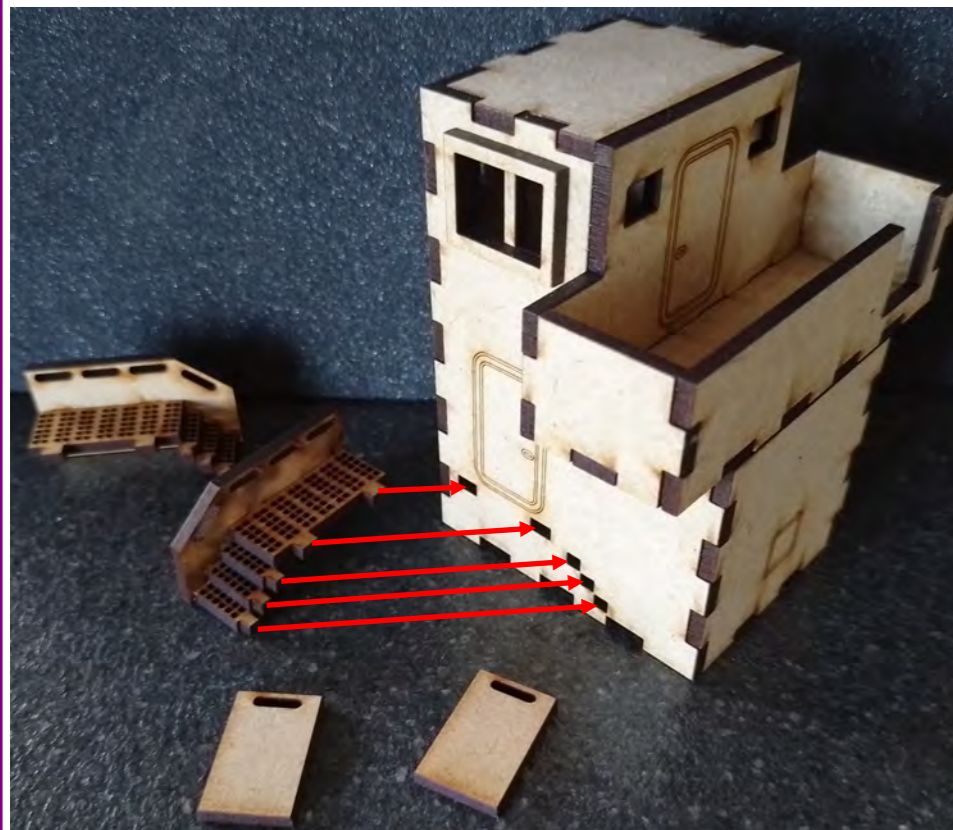

Assembly Instructions for "Corvette"



23: Glue pieces C+E and D onto the ship's deck.

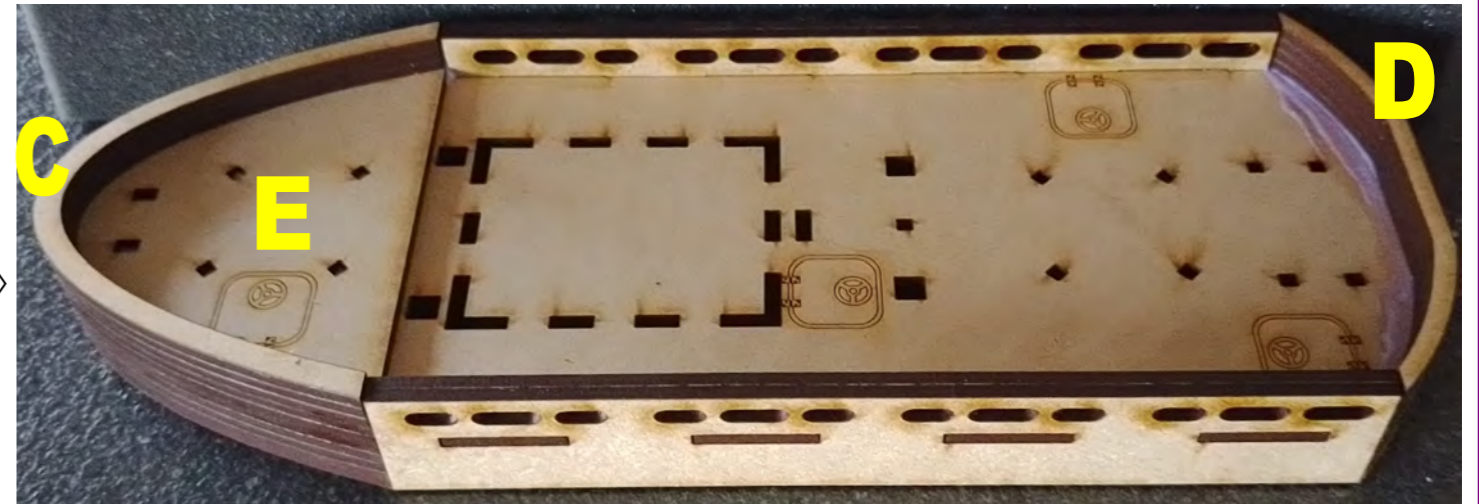
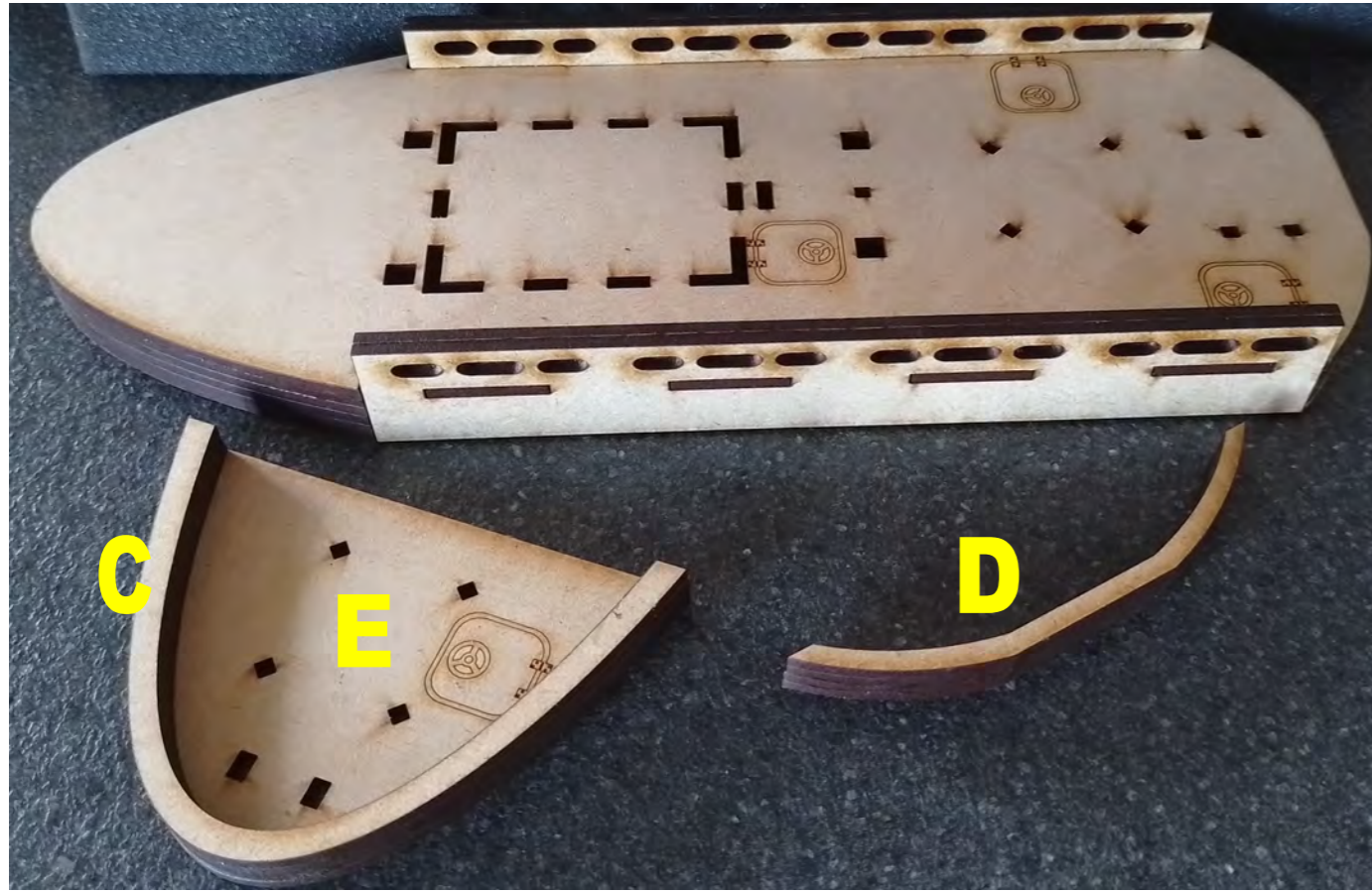

24: Glue the railing onto the ship's deck. Use clamps until glue is dry.

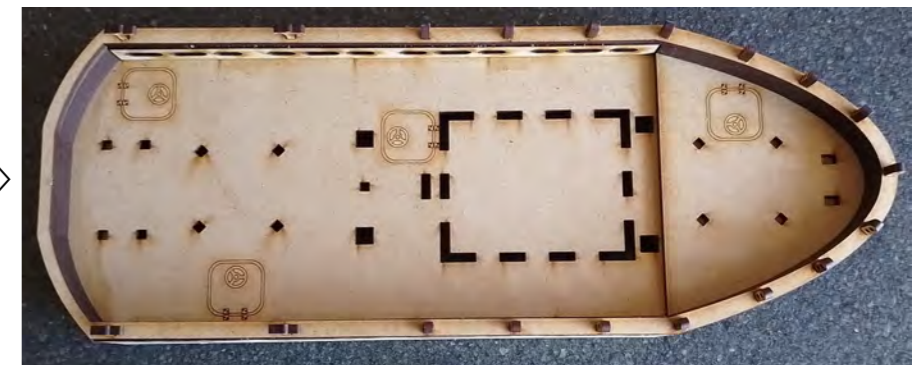
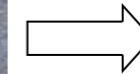
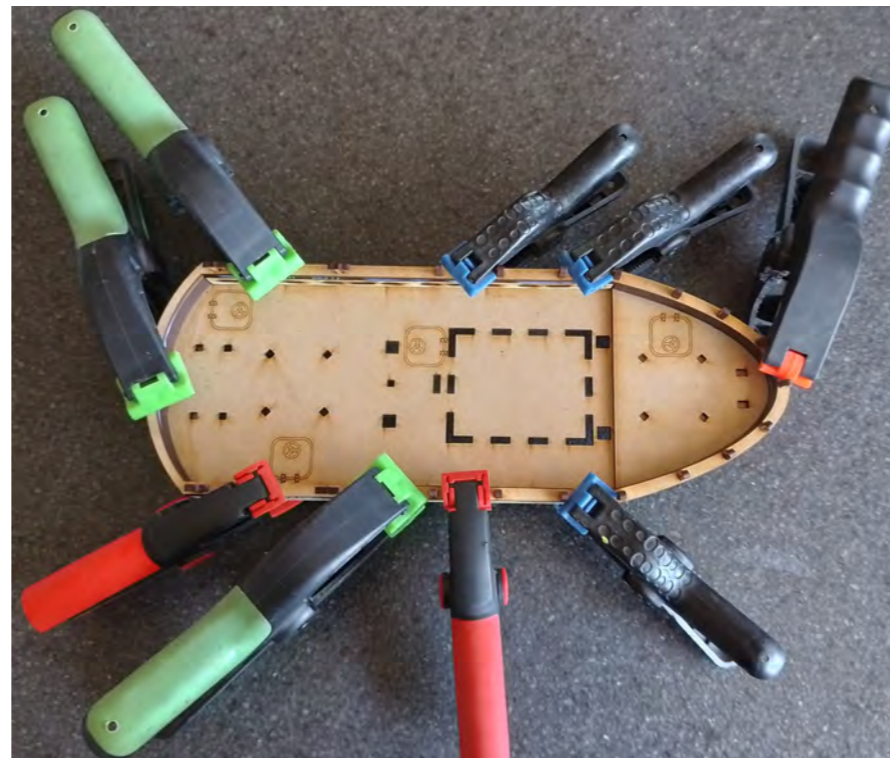
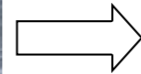
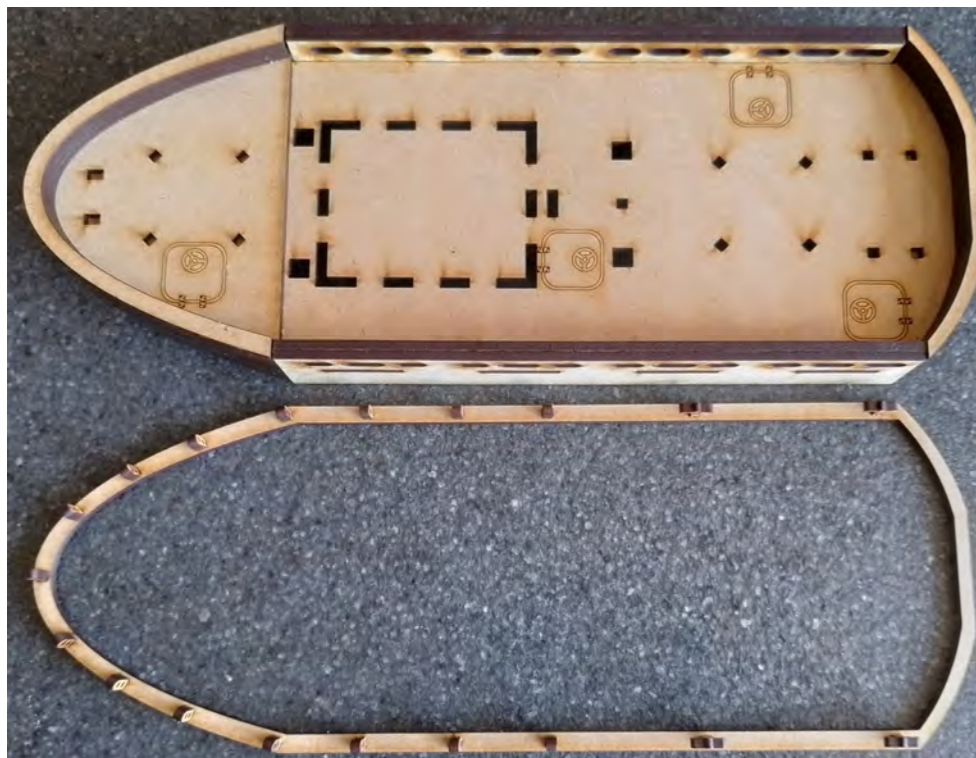

Assembly Instructions for "Corvette"



25: Glue depth charges onto the platform.

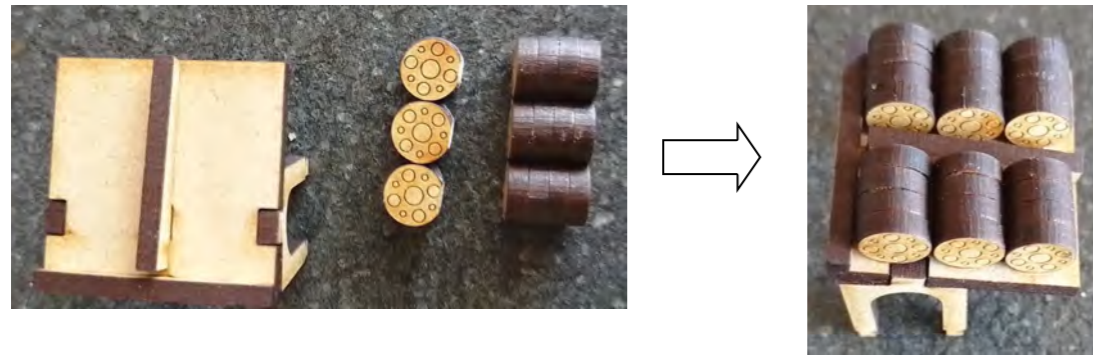

26: Glue the roof onto the Bridge.

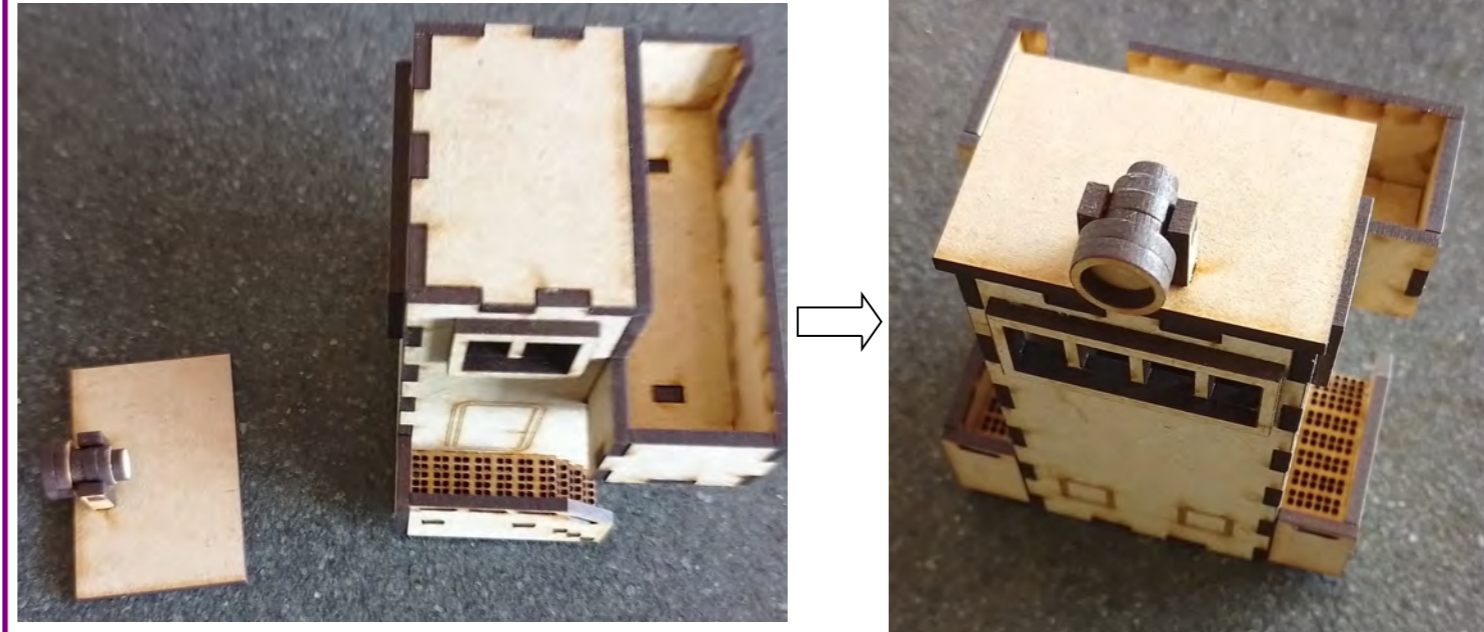

27: Glue shown pieces onto the bottom of the weapon platforms.

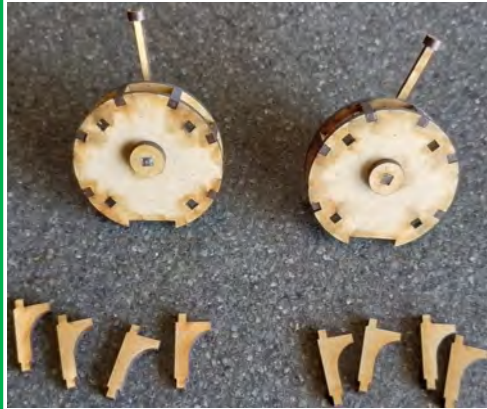

28: Glue the Bridge, cable hoist, and depth charges platform onto the ship's deck.

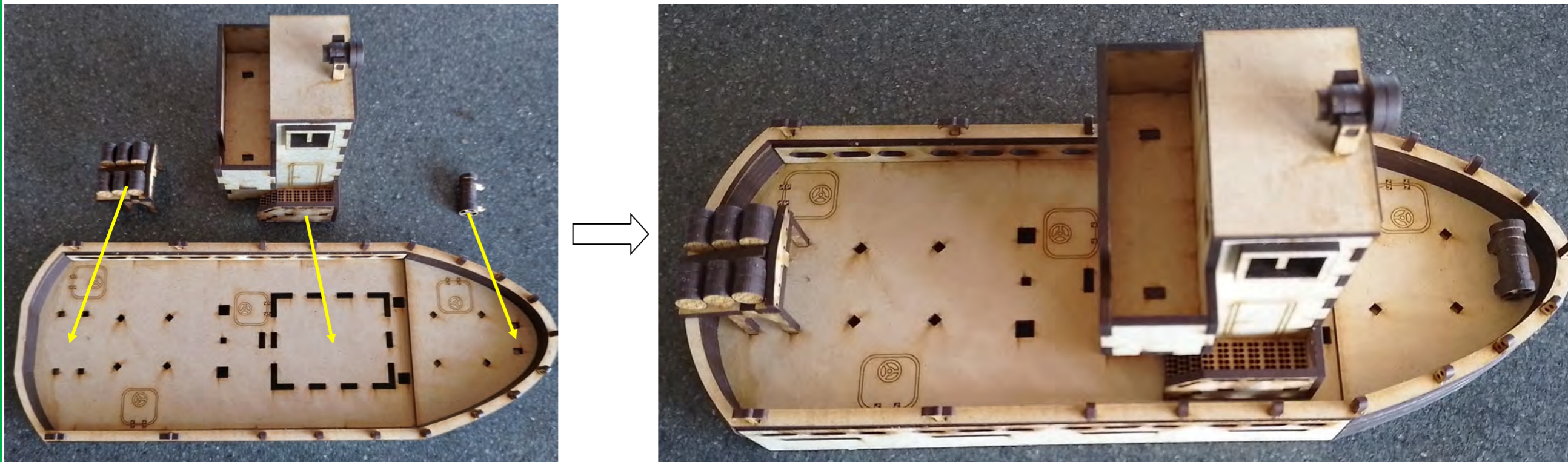

Assembly Instructions for "Corvette"

29: Glue the funnels, gun platforms and mast onto the ship's deck.

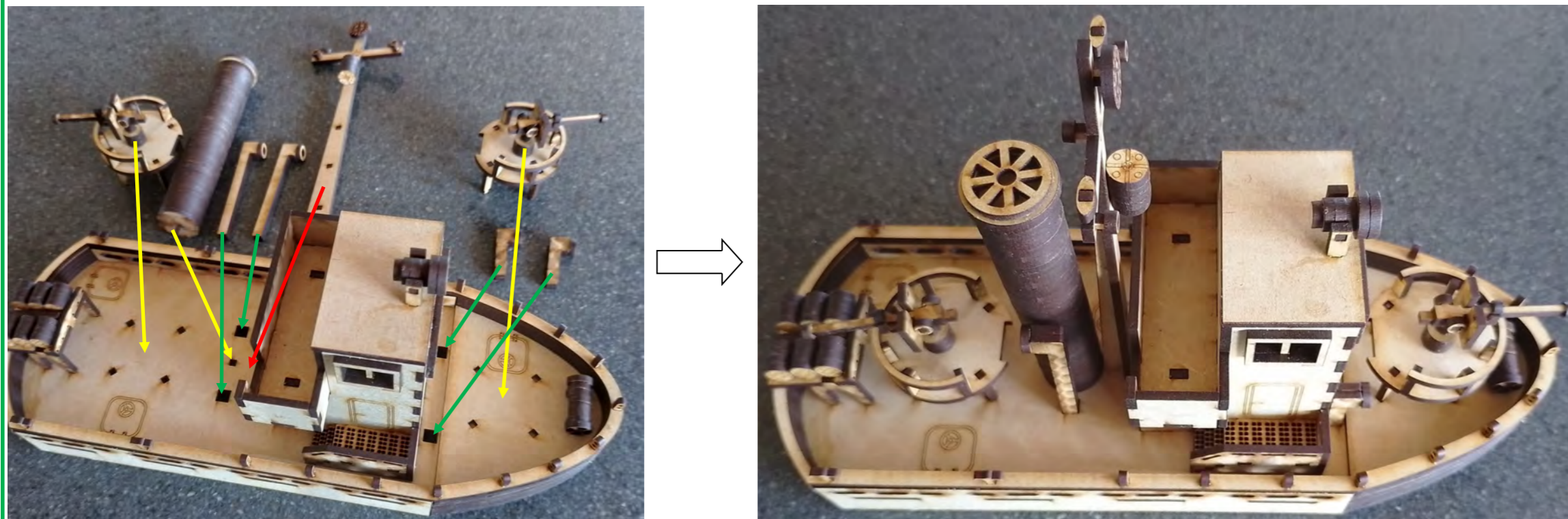

30: Glue the on the ladders and life lines.

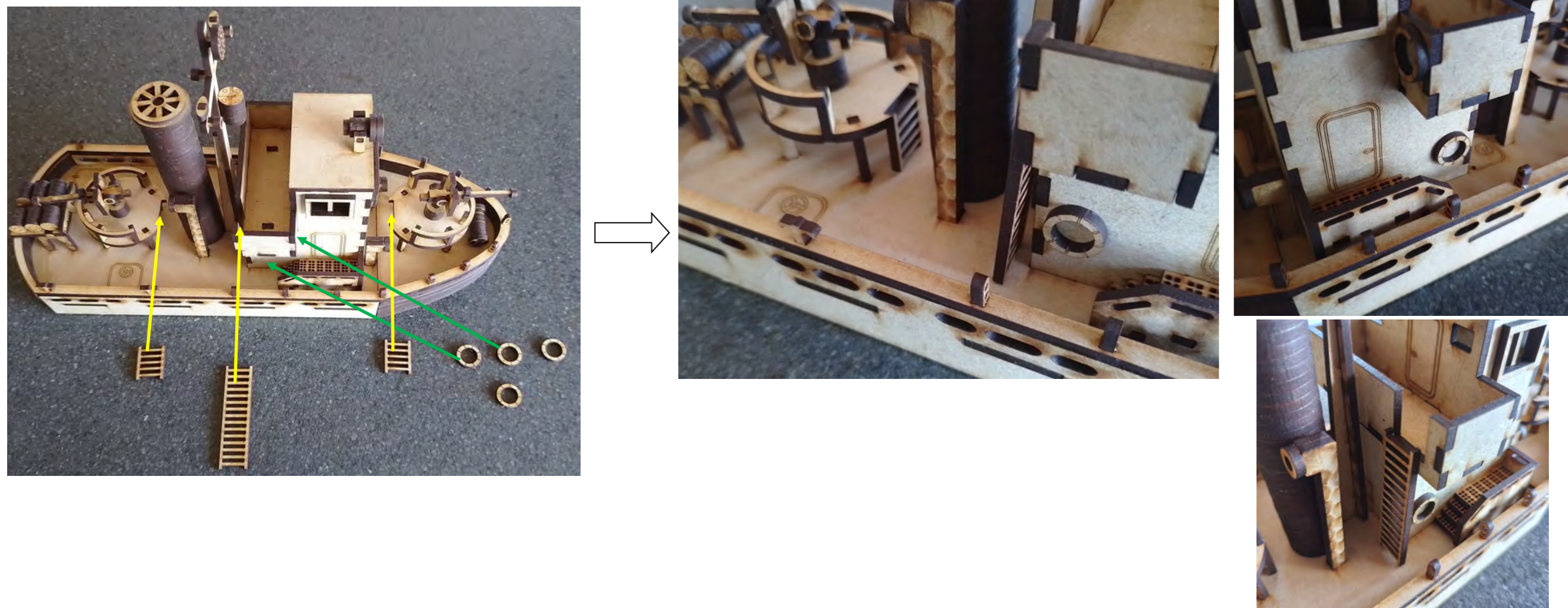

Assembly Instructions for "Corvette"



31: Using string, a thin wire or elastic cord (Not Included) to make the cable railing.

