

K 150 XL sileo

Centrifugal circular duct fan, <125W

Item Number: 25363

Variant: 230V 1~ 50Hz



- Speed-controllable
- Quiet-running
- Increased efficiency
- Integral thermal contacts
- Can be installed in any position
- Can be installed outdoors
- Maintenance-free and reliable

The K Sileo series is designed for installation in ducts. All K-fans have a minimum 25 mm long spigot connections.

The fans have backward-curved blades and external rotor motors. To simplify the installation the K Sileo fan has a fixing bracket together with screws for mounting the bracket included as standard. The FK mounting clamp facilitates easy installation and removal, and prevents the transfer of vibration to the duct. The fans can be speed-controlled via a stepless thyristor or a 5-step transformer.

To protect the motor from overheating the fan has integral thermal contacts with manual reset.

The casing is manufactured from galvanised sheet steel and folded which gives the fan a close to air tight casing. Duct connected outdoor and wet room applications of the fan are possible due to the air tight casing



Technical parameters

Nominal data		
Voltage (nominal)	230	V
Frequency	50	Hz
Phase(s)	1~	
Input power	100	W
Input current	0.443	A
Impeller speed	2,523	r.p.m.
Air flow	max 0.201	m³/s
Capacitance of capacitor	2.5	µF
Temperature of transported air	max 70	°C
Max temperature of transported air, when speed controlled	70	°C
Sound data		
Sound pressure level at 3m (20m² Sabin)	48	dB(A)

Protection/Classification

Enclosure class, motor	IP44
Insulation class	F

Data according to ErP

Energy class, Basic unit	E
Energy class, Local demand	C
ErP ready	ErP 2016; ErP 2018

Dimensions and weights

Duct dimension; Circular, inlet	150	mm
Duct dimension; Circular, outlet	150	mm
Weight	4.1	kg

Others

Duct connection type	Circular
Motor type	AC

Performance

Performance curve

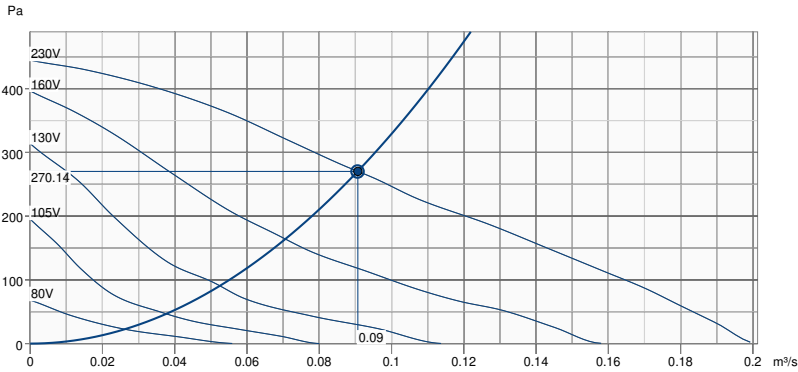

Hydraulic data	
Required air flow	0.09 m³/s
Required static pressure	270 Pa
Working air flow	0.09 m³/s
Working static pressure	270 Pa
Air density	1.204 kg/m³
Power	96.7 W
Fan control - RPM	2555 rpm
Current	0.43 A
SFP	1.067 kW/m³/s
Control voltage	230.0 V
Supply voltage	230 V

Sound power level		63	125	250	500	1k	2k	4k	8k	Total
Inlet	dB(A)	50	75	67	71	67	62	59	49	78
Outlet	dB(A)	53	72	62	68	64	61	55	47	74
Surrounding	dB(A)	15	33	37	50	46	47	44	30	54
Sound pressure level at 3m (20m² Sabine)	dB(A)	-	-	-	-	-	-	-	-	47
Sound pressure level at 3m free field	dB(A)	-	-	-	-	-	-	-	-	33

Dimension

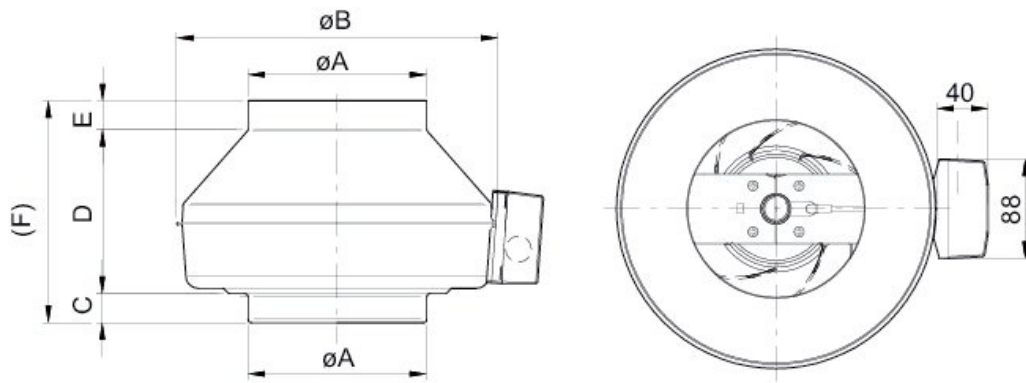

	$\varnothing A$	$\varnothing B$	\uparrow C	D	E	F
K 150 M sileo	149	286	25	152	25	202
K 150 XL sileo	149	336	29	171	26	226

Wiring

230V 1~

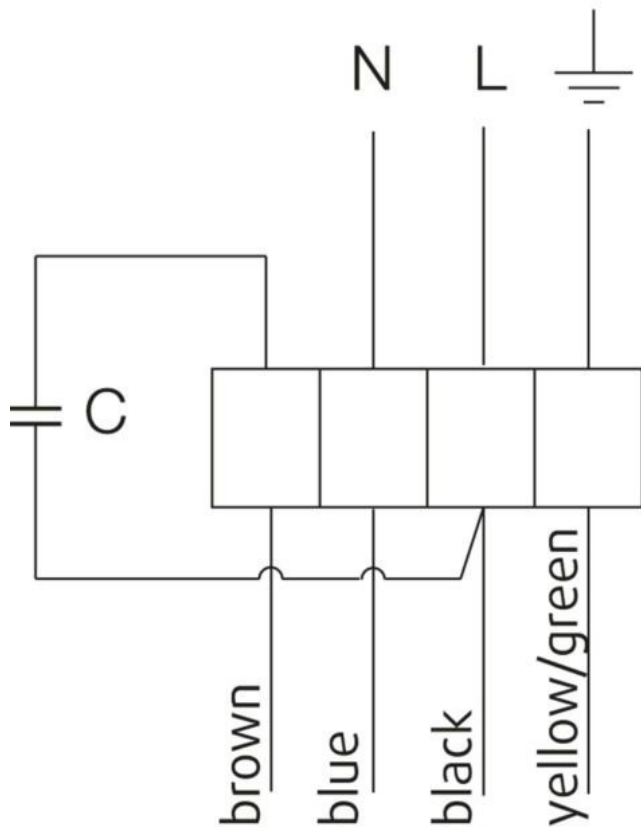

Ecodesign

Product		
Trade name	Systemair	
Product name	K 150 XL Sileo	
Basic unit		
ErP compliance	2016	
SEC Average	-12.1	kWh/(m ² .a)
SEC Cold	-28.6	kWh/(m ² .a)
SEC Warm	-2.8	kWh/(m ² .a)
SEC Class	E	
Unit category	RVU	
Unit type	UVU	
Drive	External MSD or VSD	
Heat recovery type	None	
Temperature ratio (UVU)	Not applicable	
qv max	594	m ³ /h
P max	99	W
Sound power level LWA	45	dB(A)
qv ref	0.115	m ³ /s
Ps ref	50	Pa
SPI	0.16	W/(m ³ /h)
CTRL	1	
MISC	1.1	
x-value	1.5	
External Leakage	0	%
AEC average	200.1	kWh
AHS Cold	200.1	kWh
AEC warm	200.1	kWh
AHS Average	1,715.2	kWh/a
AHS Cold	3,355.3	kWh/a
AHS Warm	775.6	kWh/a

Units with local demand control

ErP compliance	2018
SEC Average	-25.7 kWh/(m ² .a)
SEC Cold	-52.7 kWh/(m ² .a)
SEC Warm	-10.2 kWh/(m ² .a)
SEC Class	C
Unit category	RVU
Unit type	UVU
Drive	External MSD or VSD
Heat recovery type	None
Temperature ratio (UVU)	Not applicable
qv max	592 m ³ /h
P max	99 W
Sound power level LWA	45 dB(A)
qv ref	0.1152 m ³ /s
Ps ref	50 Pa
SPI	0.16 W/(m ³ /h)
CTRL	0.65
MISC	1.1
x-value	1.5
External Leakage	0 %
AEC average	104.9 kWh
AEC cold	104.9 kWh
AEC warm	104.9 kWh
AHS Average	2,830 kWh/a
AHS Cold	5,536.2 kWh/a
AHS Warm	1,279.7 kWh/a

Accessories

- FRQ5S-E-6A (37421)
- RE 1,5 Speed control (5000)
- REPT 6 Digital regulator (5698)
- REU 1.5 Speed control (5004)
- SG 150 Protection guard (5555)
- DTV500A (96807)
- HR1 Room Humidistat (215150)
- RT 0-30 Room Thermostat (5151)
- CB 150-2,1 230V/1 Duct heater (5379)
- CB 150-5,0 400V/2 Duct heater (5381)
- CBMF 150-2,1 230V/1 Duct heater (12243)
- FGR 150 Filter cassette (1807)
- LDC 150-300 Silencer (53723)
- RSK-150 Back draft damper (5599)
- THB 160 Hood w.cover pl. black (1764)
- THS 160 Hood w.cover pl. black (1839)
- IGK-160 Wall Grid (1632)
- REE 1 Speed control (5314)
- RETP 6 Temp/Pressure regulator (32293)
- REV-3POL/03-7,5kW R/Y (33978)
- CO2RT-R-D Transmitter (6993)
- FRQS-E-6A (37419)
- Presence detector/IR24-P (6995)
- CB 150-1,2 230V/1 Duct heater (5378)
- CB 150-2,7 230V/1 Duct heater (5380)
- CBM 150-2,1 230V/1 Duct heater (5481)
- FFR 150 Filter cassette (1769)
- FK 150 Fast clamp (1609)
- LDC 150-600 Silencer (5199)
- THB 160 Hood w. cover pl. Red (2034)
- THS 160 Hood w. cover pl. Red (2044)

Documents

- Fans_Operating and Maintenance_instr_202341_CE_multilingual.pdf
- K fan mounting.wmv