



# TD-SILENT

5211366500 - TD-800/200 SILENT T 3V (220-240V 50/60) N8 - IN-LINE DUCT FANS



Low profile "Mixed-flow" fans with sound-absorbent insulation. Extremely quiet Certified of Approval Noise Abatement Society. Manufactured in plastic material, with a specifically designed internal skin to direct the sound waves at the right angle for them to be captured by the sound-absorbent material. Fitted with rubber gaskets on the inlet and outlet to absorb vibrations, a body that can be dismantled. Connection box can be rotated 360°, to facilitate easy connection of the power cable.

### Motors

Speed controllable 230V-50Hz motor, of three-speed motors. IP44. Motors are class B, with ball bearings and safety thermal overload protection.

### Additional information

The models offer solutions to ventilation problems, especially in places where people work and low sound level is required.

Brand S&P model TD-800/200 SILENT T 3V (220-240V 50/60) N8.

## Theoretical Working Point

Airflow	-
Static Pressure	0,000 N/m <sup>2</sup>
Temperature	20 °C
Altitude	0 m
Density	1,2 kg/m <sup>3</sup>
Frequency	50 Hz

## Construction

Discharge diameter	200 mm
Fan size	200
Weight	7,83 kg

## Motor Characteristics

Number of poles	2
Voltage	1-230V-50Hz
Maximum absorbed current	0,5 A
IP Rating	IP44
Motor insulation class	B

## Working Point

Fan speed	2170
-----------	------

## Drawing

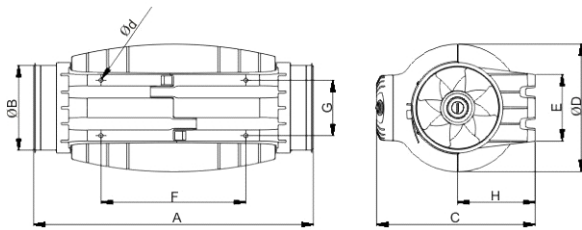

A	B	C	D	E	F	G	H	d
568	198	327	264	145	340	129	164	5.4

## Performance Chart

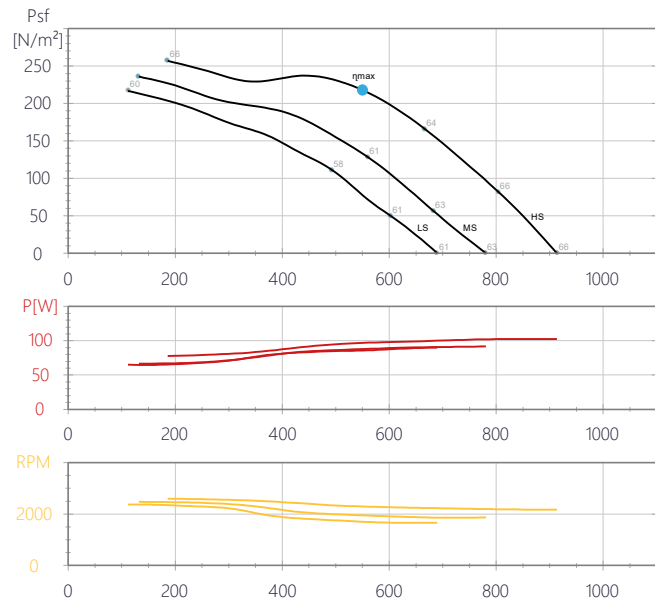



# TD-SILENT

5211366500 - TD-800/200 SILENT T 3V (220-240V 50/60) N8 - IN-LINE DUCT FANS

## Sound Performance

	63	125	250	500	1k	2k	4k	8k	Overall
<b>Inlet (LwA)</b>	26	40	50	60	61	60	56	50	66
<b>Inlet LpA @ 1m</b>	15	29	39	49	50	49	45	39	55
<b>Outlet (LwA)</b>	33	40	51	60	61	59	55	49	65
<b>Outlet LpA @ 1m</b>	22	29	40	49	50	48	44	38	54
<b>Surrounding (LwA)</b>	18	33	36	43	44	40	30	23	48
<b>Surrounding LpA @ 1m</b>	7	22	25	32	33	29	19	12	37





# TD-SILENT

5211366500 - TD-800/200 SILENT T 3V (220-240V 50/60) N8 - IN-LINE DUCT FANS

## ErP Data

Ecodesign	
Commission regulation (EU) N°1253/2014 of July 2014	
Information requirements (Annex V)	
Product description	TD-800/200 SILENT T 3V (220-240V 50/60) N8
Manufacturer's Info	S&P
Identifier	-
Typology	NRVU unidirectional
Drive	3-speed
Type of HRC	None
Thermal efficiency (%)	NA
Qnom (m3/s)	0,15
Pelec (kW)	0,1
SFPint (W/m3/s)	NA
Face velocity (m/s)	6,9
$\Delta p_{s,ext}$ (Pa)	216,8
$\Delta p_{s,int}$ (Pa)	NA
$\Delta p_{s,add}$ (Pa)	NA
Static efficiency fans (%)	34,2
External leakage rate (%)	3
Internal leakage rate (%)	NA
Filter performance	NA
Filter warning	NA
LWA dB(A)	48
<a href="https://www.solerpalau.com/">https://www.solerpalau.com/</a>	