

# Unity FIRE PIT

Copper / Corten Steel / Stainless Steel / Powder Coated

## SPECIFICATION

COPPER	CORTEN STEEL	STAINLESS STEEL	POWDER COATED	A	B	C	D	BTU
OPT-UNYCP42	OPT-RCRTN42	OPT-UNYSS42	OPT-UNYPC42	42"	19"	12"	24"	65,000
OPT-UNYCP48	OPT-RCRTN48	OPT-UNYSS48	OPT-UNYPC48	48"	25"	18"	24"	65,000
OPT-UNYCP60	OPT-RCRTN60	OPT-UNYSS60	OPT-UNYPC60	60"	37"	30"	24"	160,000
OPT-UNYCP72	OPT-RCRTN72	OPT-UNYSS72	OPT-UNYPC72	72"	43"	36"	24"	190,000
OPT-UNYCP4218	OPT-RCRTN4218	OPT-UNYSS4218	OPT-UNYPC4218	42"	19"	12"	18"	65,000
OPT-UNYCP4818	OPT-RCRTN4818	OPT-UNYSS4818	OPT-UNYPC4818	48"	25"	18"	18"	65,000
OPT-UNYCP6018	OPT-RCRTN6018	OPT-UNYSS6018	OPT-UNYPC6018	60"	37"	30"	18"	160,000
OPT-UNYCP7218	OPT-RCRTN7218	OPT-UNYSS7218	OPT-UNYPC7218	72"	43"	36"	18"	190,000

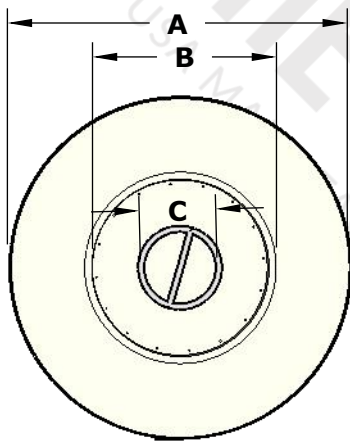

TOP VIEW

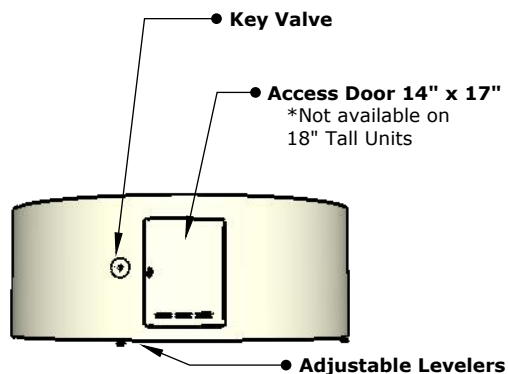

FRONT SIDE VIEW

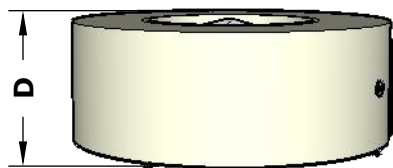

RIGHT SIDE VIEW

## Gas Requirements

**Gas Type:** Natural Gas or Propane  
**Gas Inlet:** 1/2" NPT Female  
**Total BTU:** 65K - 125K

\*All Match Lit Units up to 65K BTU are LC Certified  
\*All Electronic Units are CSA Certified



## What's Included?

### Match Lit Unit:

- Fire Pan, Burner, Gas Orifice, Gas Hose, Key Valve with Key

### Low Voltage Unit:

-Fire Pan, Burner, Gas Orifice, Gas Hose, Key Valve with Key, Low Voltage Electronic Valve, Pilot Ignitor

### Plug & Play Unit:

-Fire Pan, Burner, Gas Orifice, Gas Hose, Key Valve with Key, Plug & Play Electronic Valve, Pilot Ignitor - ANSI Z21.97-(2017) / CSA 2.41-(2017)

### Spark Glow Unit:

-Fire Pan, Burner, Gas Orifice, Gas Hose, Key Valve, Spark Button, Pilot Ignitor

### Fire Glow Unit:

-Fire Pan, Burner, Gas Orifice, Gas Hose, Built-In Key Valve, Spark Button, Pilot Ignitor

Standard 1" Flange on all pans  
Standard 2" Depth on all pans

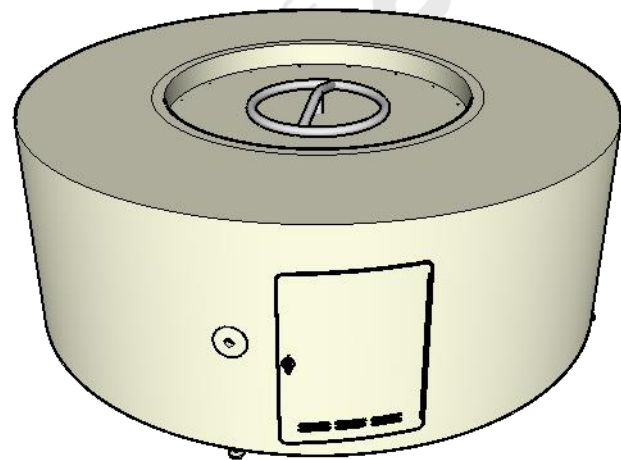

ISOMETRIC VIEW

Drawn By	Mia L.
Date Created	August 3, 2023