

CAROL ROSE

• COASTAL COLLECTION •

by Empire Comfort Systems



Linear Outdoor Fireplaces

linear

OUTDOOR LINEAR FIREPLACES

Stainless steel construction, an integrated LED lighting system, and a 55,000 Btu burner ensure that Empire's 48-inch Outdoor Linear Fireplace will light up your patio party for any occasion. Or choose the 60-inch model with 65,000 Btu burner.

These single sided and see-through models conceal a gas burner beneath a large bed of clear-frost crushed glass. While the flames dance atop the bed of glass, the lighting system illuminates the glass from beneath. A glass deflector shield helps protect the flame from wind. (Optional taller deflectors are available for fireplaces installed in windier locations.)

A tilt-up cover conceals all controls – including pushbutton ignition and flame control knob with Hi, Medium and Low – plus intuitive buttons to control the changing pattern and color of the LED lighting. The buttons let you select from seven LED colors and vary the intensity. Two “program” settings cycle through the colors automatically – either quickly or gradually.

*Carol Rose Coastal Collection
48-inch Outdoor Stainless Steel
Linear See-Through Fireplace*





Carol Rose Coastal Collection
48-inch Outdoor Stainless Steel
Linear Fireplace

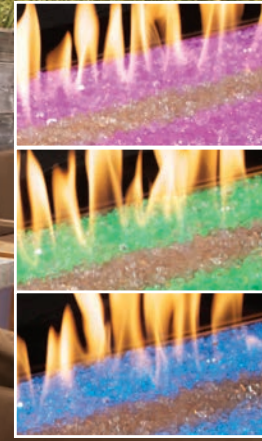

Multi-color LED Lighting System

FIREPLACE CONTROLS

Outdoor Linear Fireplaces feature a manual, three-position gas valve and pushbutton ignition. The burner is concealed beneath a bed of crushed glass.

Each fireplace includes a flame sensor that shuts off gas to the system if the flame is extinguished. All are available in LP and Natural Gas.

OUTDOOR LINEAR FIREPLACE ACCESSORIES

Stainless steel Weather Doors install in seconds without tools to help protect your fireplace from the elements and provide a clean look when it's not in use. See-through fireplaces need two doors. Outdoor Fireplaces are designed to allow rainwater to drain through onto the area beneath the unit. The optional Drain Tray lets you control this water and direct it (via plastic tubing) to an appropriate location – such as a gutter or garden.

The E-Stop Timer allows you to set an automatic shut-off time while using your outdoor fireplace. Choose the 1-hour timer or the 1-1/2 hour timer. E-Stop Timers can be purchased separately, or add the stainless steel timer compartment for a complete kit.

Carol Rose

These special outdoor products are named for customer service manager Carol Rose Burtz, who has been with Empire for more than 59 years. As the first time we have named a product for an employee, this represents an appropriate honor recognizing Carol's exceptional history with the company.



OUTDOOR LINEAR FIREPLACE SPECIFICATIONS

Outdoor Linear Fireplace includes two metal studs and noncombustible backer board. Additional materials may be required for installation.

Model	Framing Height	Framing Width	Framing Depth
OLL48FP	40 13/16	52	19 1/16
OLL48SP	40 13/16	52	22 5/16
OLL60FP	31	64	19 1/8
OLL60SP	31	64	22 1/2

Model	A	B	C	D	E	H	K	L	M	N	O	Q	S
OLL48FP	24 5/16	51 3/4	19 1/16	16 3/16	48	6 1/2	2 9/16	5 3/16	13 21/32	3 1/2	47 3/8	6 11/16	N/A
OLL48SP	24 5/16	51 3/4	22 5/16	16 3/16	48	6 1/2	2 9/16	5 3/16	N/A	3 1/2	47 3/8	6 11/16	N/A
OLL60FP	24 1/2	63 3/4	19 1/8	16 3/16	60	6 1/2	2 9/16	5 3/16	13 21/32	3 1/2	59 3/8	6 11/16	40 13/16
OLL60SP	24 1/2	63 3/4	22 1/2	16 3/16	60	6 1/2	2 9/16	5 3/16	N/A	3 1/2	59 3/8	6 11/16	40 13/16

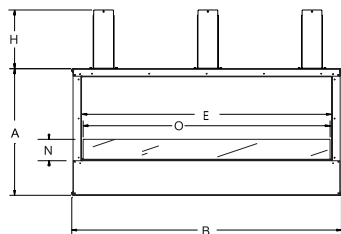

Single-Sided 48-inch Fireplace

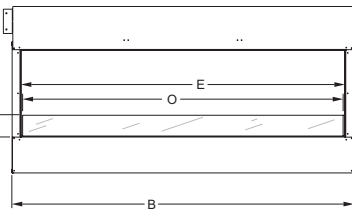
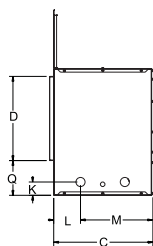

Single-Sided 60-inch Fireplace

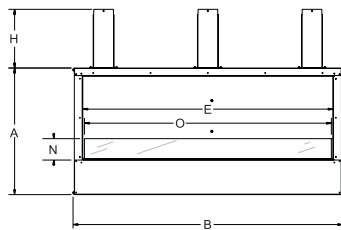
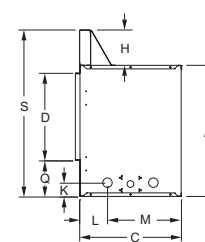

See-Through 48-inch Fireplace

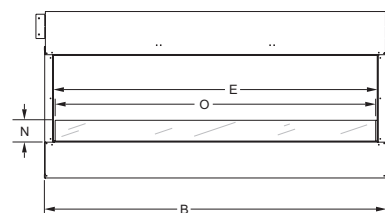
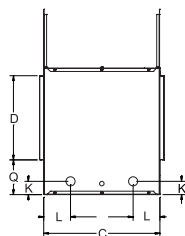

See-Through 60-inch Fireplace

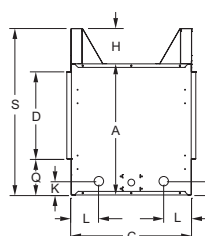

Warranty: All outdoor products carry a five-year limited warranty. All remote controls and lighting systems carry a one-year limited warranty.

Empire is committed to continuous product improvement; specifications are subject to change without notice. Dimensions in this brochure are approximate; read and follow the framing dimensions in the owners manual supplied with your Empire product. Flame size, shape, and color will vary from photos. Refer to your Owner's Manual for complete installation and safety information.

Member of the following industry associations:



This appliance is design-certified to the ANSI standard by:



SINCE 1932

Empire Comfort Systems
918 Freeburg Ave.
Belleville, IL 62220-2623

E-mail: info@empirecomfort.com
00972 10/10/18

The Empire Comfort Systems name and logos are registered U.S. trademarks.