

There is
so much to tell...



4326 Series
Matrix
Front-facing Built-in Gas Fireplace

Faber helps you create the atmosphere and look you desire for your unique space. Our built-in Matrix models let you design your fireplace - to viewing angles and finishes.



Front-facing Gas Fireplace



Logs
Realistic charred log set to maximize the illusion of depth and the appearance of burning firewood. Combine with loose embers for a custom display.



Burners
With a total of five burners, the gas flame has never been more versatile with the ability to adjust the height and width while, the flame uniquely wraps around the logs for an ultra-realistic effect.



Light Module
Provides a pulsating burn on logs for a truly lifelike effect.



Rear Wall Steel
Provides a solid dark interior finish.



Invisimesh
A protective layer of Invisimesh surrounds the glass barrier of the fireplace and provides a warm touchable surface safe for children and pets.



Remote Control
Uses radio frequency to control all fireplace features from the comfort of your chair.



29,500 - 45,000 BTU

Product Dimensions:

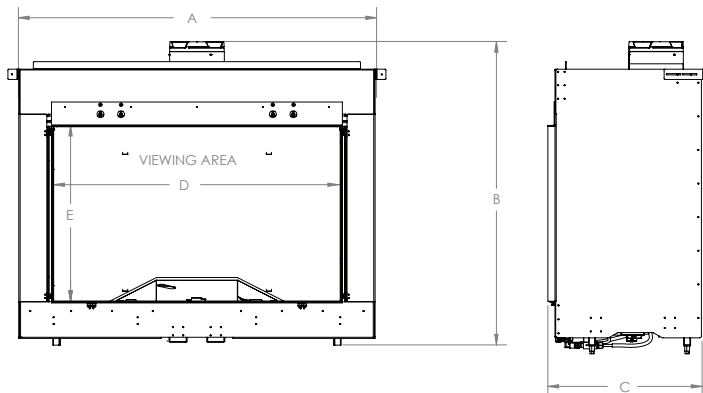

Also available



Model #	Description	BTU	UPC	Wty. ¹	Product Dimensions		Viewing Area		Packaging Dimensions		Weight	
FMG4326F	Front-facing Built-in Gas Fireplace	29,500-45,000	781052 137585	5 yr.	A (Width)	52-1/8" (132.3 cm)	D (Width)	41-7/8" (106.4 cm)	Width	TBD	Lbs	TBD
					B (Height)	45-13/16" (116.4 cm)	E (Height)	25-3/8" (64.5 cm)	Height	TBD		
					C (Depth)	22-1/2" (57.2 cm)	F (Depth)	NA	Depth	TBD	Kg	TBD

Specifications, finishes and dimensions are subject to change. ¹Lifetime Limited warranty.
©2020 Glen Dimplex Americas
SE-540-R01-121120